

REVISION HISTORY

REV	DESCRIPTION	BY/DATE	ECO NO.	APPROVED
AAA	RELEASE TO PRODUCTION FROM DWG. AND PART NO 1353230 REV. 5	CDP 12/16/13	-	-

PLACE LABEL HERE

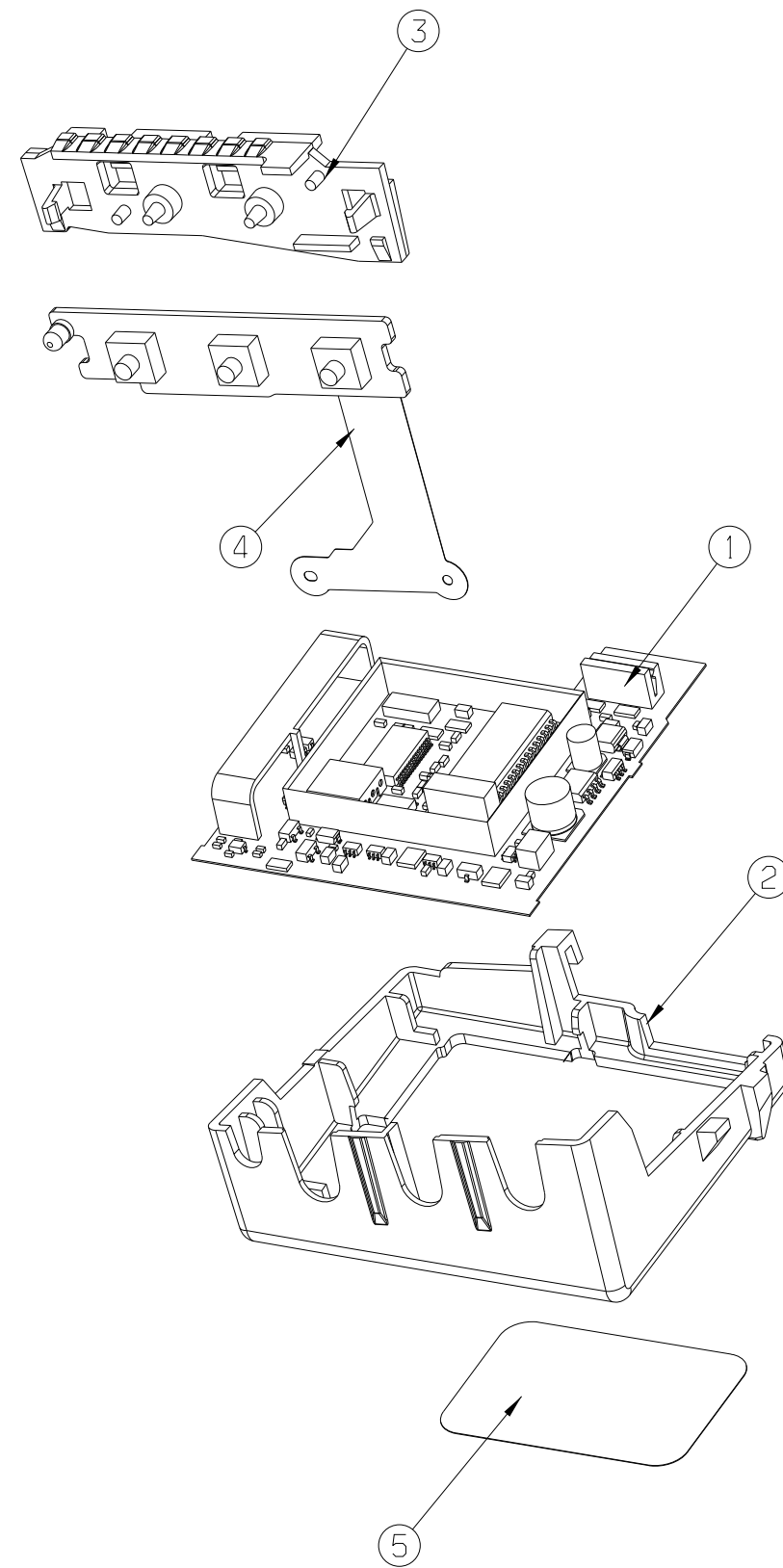
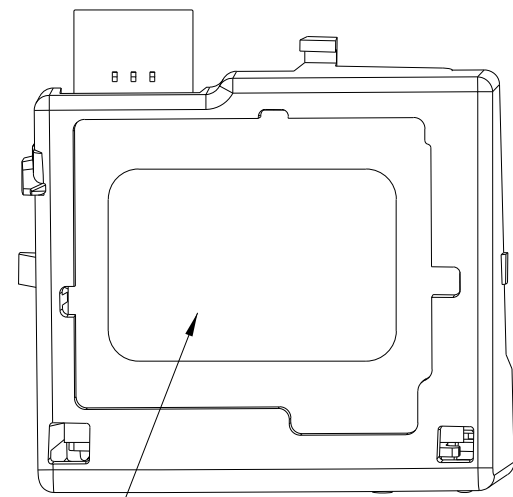

ISOMETRIC REFERENCE VIEW

QTY	ITEM	DESCRIPTION	GENTEX PART NO.
1	5	LBL. STOCK 1.0 x 1.5	375-0765-000
1	4	FLEX SWBD, E46, PCB ASM	725-0023-000
1	3	HOLDER, BMW HOMELINK - SWITCH	345-0249-000
1	2	HOLDER, BMW HOMELINK	345-0248-000
1	1	SA PCB, HL4 BMW MODULAR	605-4726-001

ITEM	DESCRIPTION
1	FINAL ASM, HMLK BMW MIRROR
AAA	REV.
605-4729-000	GENTEX ASSY NO.

NOTES:

- INDIVIDUAL COMPONENTS ON PCB ASSEMBLY ARE FOR REFERENCE ONLY.
- ADHESIVE LABEL FORMAT AND INFORMATION IS TO MATCH AS SHOWN IN THE LABEL VIEW(S) AND BOM.
- REFERENCE IPC-A-610 CLASS 2 FOR ASSEMBLY PRACTICES AND PROCEDURES, UNLESS OTHERWISE SPECIFIED.
- THE BAR CODE CONTAINS THE FOLLOWING; GENTEX PART NO., THREE DIGITS FOR TESTER AND AN 8-DIGIT SERIAL NO. AN EXAMPLE IS BELOW; 960000100100012345678
- ASSEMBLY MUST COMPLY TO TEST SPECIFICATION TDE-ELE-049.
- ATTACH FLEX ASSEMBLY TO PCB ASSEMBLY USING HOT BAR SOLDER PROCESS.
- AFTER HOT BAR SOLDER, ASSEMBLY SHALL BE FUNCTIONALLY TESTED.

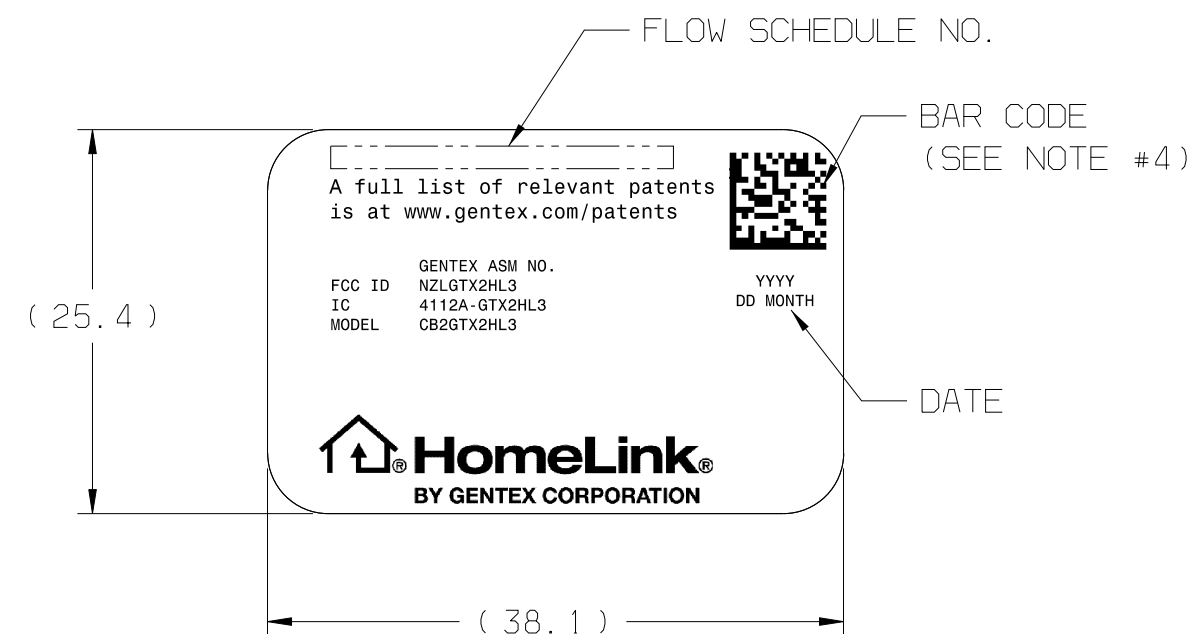

LABEL VIEW
SCALE: 2:1

GENTEX CORPORATION 600 NORTH CENTENNIAL ST
ZEELAND, MICHIGAN 49464
(616) 772-1800

TITLE
FINAL ASM, HMLK BMW MIRROR

NVS SPECIFIES FEATURES REQUIRING SPECIAL CONSIDERATION. SEE CONTROL PLAN. INTERPRET DIMENSIONS AND TOLERANCE PER ASME Y14.5M - 1994		SIZE D	DWG NO. 605-4729	REV AAA
THIRD ANGLE PROJECTION 		MATERIAL SEE COMP DWGS.	MASS (CALCULATED) 29 g	
SCALE 1:1 & AS NOTED		DRAWN BY CPOLLACK	DATA FORMAT CATIA V5	
		DATE 12/10/2013	SHEET 1 OF 1	