

SPEC	
EC	O
COMPASS	O (COLOR: GREEN)
MICROPHONE	X
HOMELINK	O (BACKLIGHT: WHITE)
SMARTBEAM	X
RCD	X
FRNDL LAMP	X
PG	SEE TABLE B

MATING CONNECTOR ON VEHICLE HARNESS	
HOUSING	TOYOTA P/N 90980-12368
TERMINAL	TOYOTA P/N 90980-09895

NO.	TOYOTA P/N	GENTEX P/N	PART NAME	MATERIAL	SURFACE TREATMENT	QUANTITY	MATERIAL TS
1	SEE TABLE B		CELL SUB-ASSY, INNER MIRROR W/DRIVER			1	
2	625-0731		CASE FRONT S.A., INCLUDING BUTTONS	PC+ABS (COLOR: BLACK)	GNTX-130	1	TSM5526G-1L
3	340-1124		CASE REAR	PC+ABS (COLOR: BLACK)	GNTX-130	1	TSM5526G-1L
4	343-0203		LENS, AMBIENT	POLYCARBONATE		1	TSM5513G-1
5	350-0173		MOUNT	ZINC	BLACK PAINT	1	
6	355-0010		TUBE	STEEL	BLACK PAINT	1	
7	350-0158		PIVOT BALL	ZINC	BLACK PAINT	1	
8	345-0822		BEARING CUP, MOUNT	PP TALC		1	
9	345-0821		BEARING CUP, PIVOT	HOPE		1	
10	418-0071		SPRING	STEEL		1	
11	409-0027		WASHER	STEEL		1	
12	400-0037		SCREW, TORX	STEEL	BLACK PAINT	1	
13	401-0114		SCREW	STEEL		3	
14	375-0493		"SEE TABLE B" ID LABEL (REMOVABLE)			1	
15	90980-12367			HOUSING CONNECTOR MALE		1	
16	82711-1E360		CLAMP, WIRE			1	

MODEL	ISS.	MASS	E.C.No.	MODEL	ISS.	MASS	E.C.No.
600A		540gMC		600A		540gMC	

Q/S	AM	ISS	REV	MASS	REV. NO.	REVISION RECORD	E.C.No.	DATE	REVR
			1	540g		RELEASE FOR PRODUCTION PER R.D.D.P.: 1K72-0013	620WS0002	6/19/2013	LUNDY

TABLE B:

PART NO.	CELL SUB-ASSY	NON-PG	PG	LABEL MARK
87810-0WN00	87809-0WB90	O		TBD
87810-0WL50	87809-0WC00		O	TBD

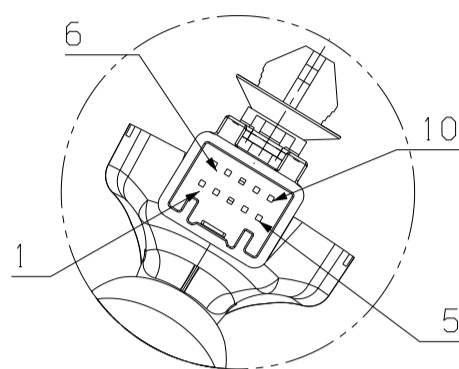
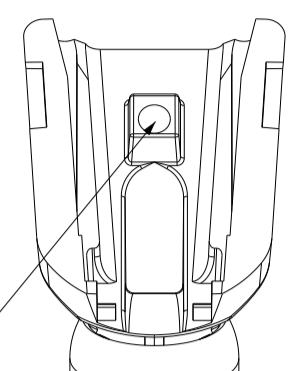

VIEW IN DIRECTION OF ARROW D

PIN	FUNCTION	CURRENT
1	IGNITION	1500mA MAX
2	GROUND	1500mA MAX
3	REVERSE	15mA MAX
4	OEC FEED (+)	300mA MAX *
5	OEC FEED (-)	300mA MAX *
6	BATTERY	100mA MAX
7	OPEN	NA
8	OPEN	NA
9	OPEN	NA
10	OPEN	NA

*PER ELEMENT

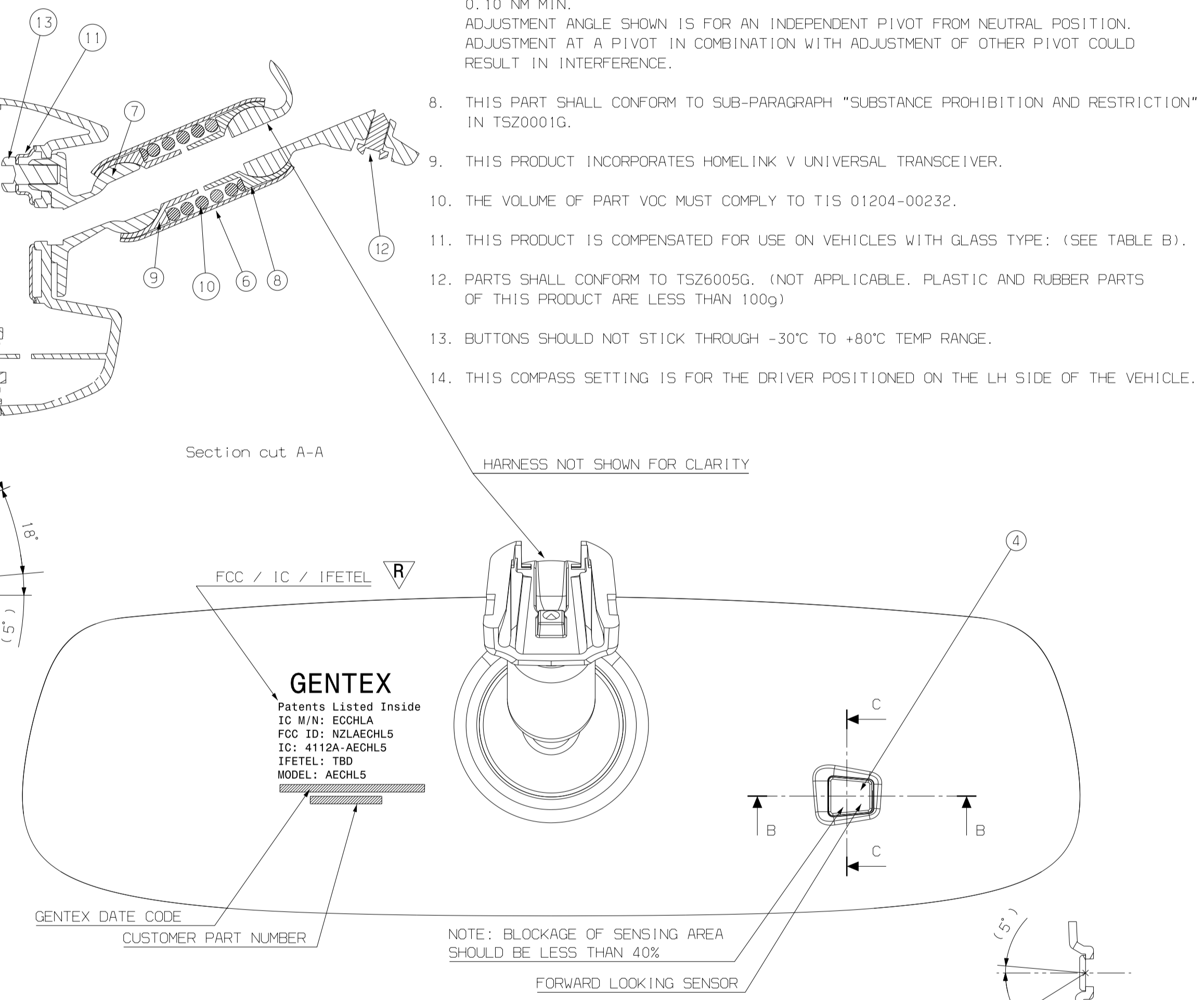
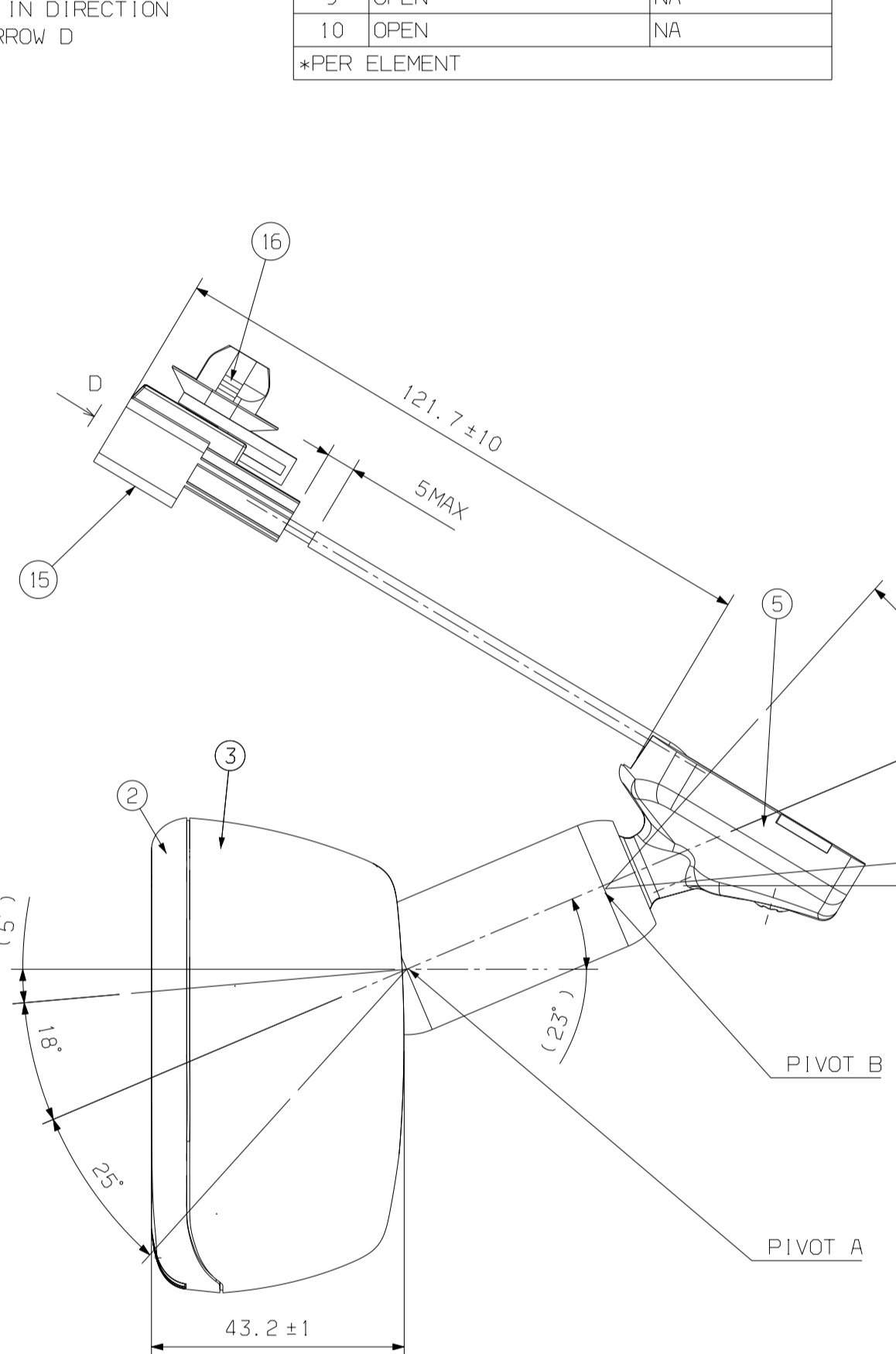
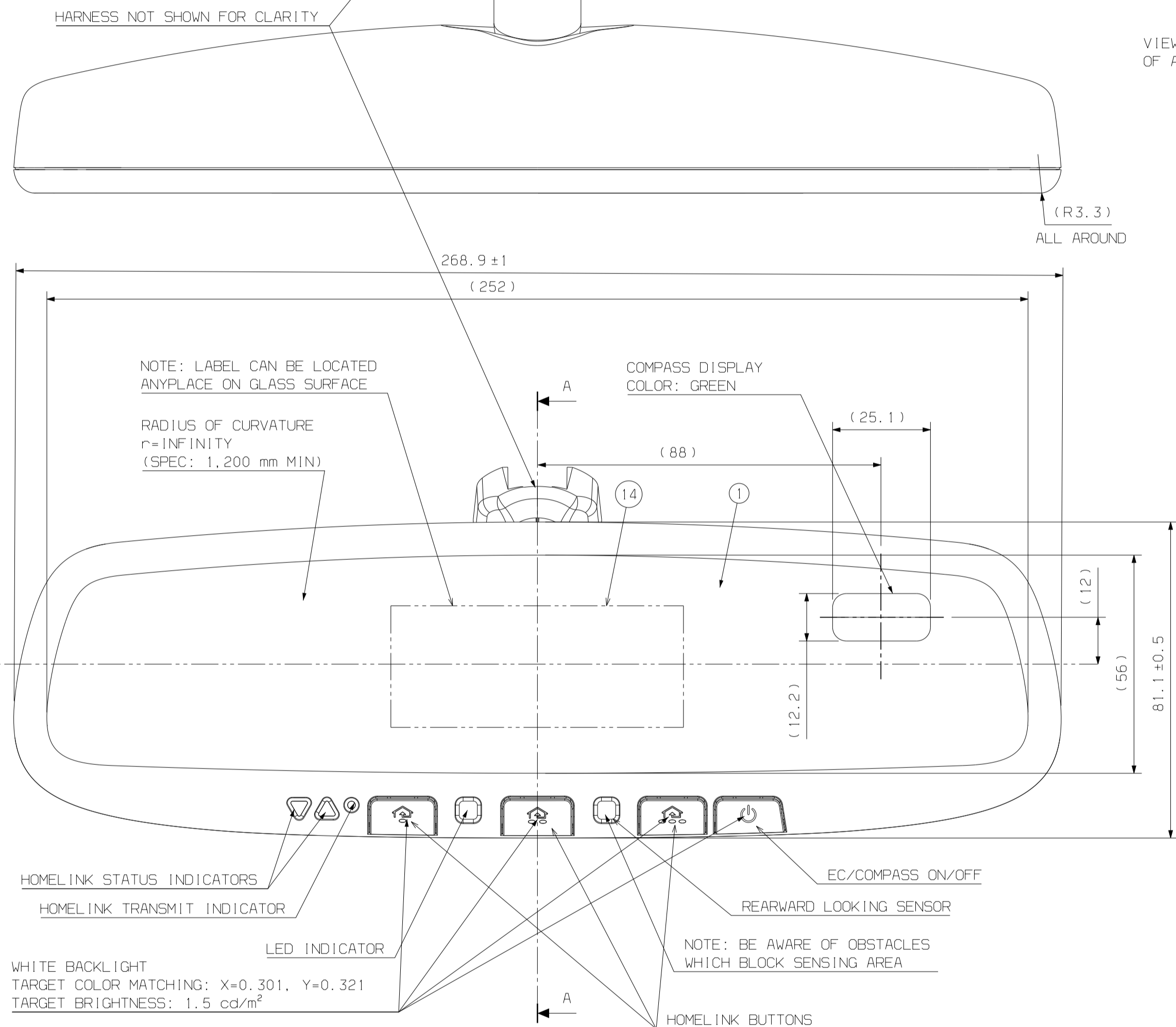
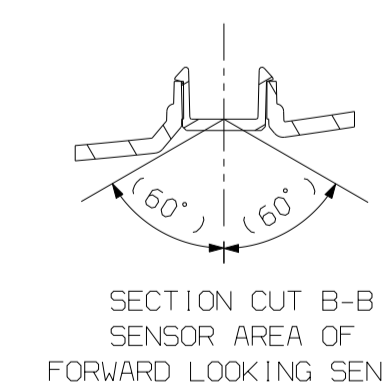

TABLE A:

No.	Test Item	Test Method	Criteria	Responsibility
1	Mirror quality	As per TSC 3900G	As per TSC 3900G-1 (bubbles, inclusion, scratch and others).	0
2	Mirror curvature	As per TSC 3900G	Concave face: R9000 MIN. Convex face: R3000 MIN.	0
3	Mirror distortion factor	As per TSC 3900G	Within 2%	0
4	Mirror angle adjustment range	As per TSC 3900G	Instruction in the drawing MIN.	0
5	Mirror angle adjustment force	As per TSC 3900G	See Note #7.	0
6	Chattering	As per TSC 3900G (Sweep from 20 to 200 Hz)	In range of the following graph (shaded area). Report results only. Actual pass/fail per vehicle test (No. 20).	0
7	Wobbling	As per TSC 3900G	Shall be 1mm MAX.	0
8	Angle adjustment durability	As per TSC 3900G (1500 cycles)	#1 to #7 shall be met.	0
9	Vibration durability	As per TSC 3900G (4 hours vertical, 2 hours lateral, 2 hours longitudinal)	(1) Initial sample: #1 and #4 to #7 shall be met. No such defects as discoloration and cracking shall be found on the mirror surface. (2) High temp exposed sample: Rotational looseness shall not occur at the fastening part. #7 shall be met. Same as those in #9 (1).	0
10	Thermal cycle	As per TSC 3900G (-30° C X 7.5h, +23° C X 0.5h, +80° C X 15.5h, +23° C X 0.5h) X 4 cycles	Same as those in #9 (1).	0
11	High temperature storage	As per TSC 3900G (+80° C X 240 hours)	Same as those in #9 (1).	0
12	Low temperature storage	As per TSC 3900G (-30° C X 240 hours)	Same as those in #9 (1).	0
13	Light resistance	As per TSL 0601G METHOD E	#1 shall be met. No such defects as discoloration and cracking shall be found on the mirror surface.	0
14	Ozone resistance	As per TSC 3900G (Ozone weatherometer; 72 hours)	Same as those in #13.	0
15	Chemical resistance	As per TSC 3900G	Same as those in #13.	0
16	Steam resistance	As per TSC 3900G (+90° C X 5 hours)	#1 shall be met.	0
17	Energy absorbing	As per TSC 3902G	As per TSC 3902G-1	0
18	Flammability	Per FMVSS 302	Burning speed 10 cm/min. MAX.	0
19	Change in color by aging	As per TSL 0601G METHOD E	Measured color value: E*; 3.0 MAX.	0
20	Chattering (vehicle drive test)	As per TSC3907G	Sensory evaluation: Grade 3 or better.	0



SECTION CUT B-B
SENSOR AREA OF
FORWARD LOOKING SENSOR

CAD DATA IS MASTER			
3D DATA LEVEL	DA	DATA PATTERN	0:2D (1):3D+2D
E.CI NO.	REVISION RECORD	MASS	MASS TOL.
620WS0002	RELEASE FOR PRODUCTION PER R.D.D.P.: 1K72-0013	540g	±MC
TOYOTA PART NAME		TOYOTA PART NO.	
MIRROR ASSY, INNER RR VIEW		87810-0WN00 1/1	
MIRROR ASSY, INNER RR VIEW		87810-0WL50 1/1	
APPROVED	CHECKED	CHECKED	
IK700		TOYOTA MOTOR CORPORATION A1	

APPROVED *Mike DeHaan*
MIKE DEHAAN

DATE 6/19/2013

GENTEX CORPORATION
600 NORTH CENTENNIAL ST
ZEELAND, MICHIGAN 49464
(616) 772-1800

INTERPRET DIM AND TOL PER
ASME Y14.5M - 1994
THIRD ANGLE PROJECTION

NVS SYMBOLS SPECIFY
FEATURES REQUIRING
SPECIAL CONSIDERATION.
SEE CONTROL PLAN.

TITLE
MIRROR ASSY, INNER RR VIEW

DRW BY E.LUNDY
DATA FORMAT Catia V5

SIZE Dwg No
A1 CP 87810-0WN00, 87810-0WL50

REV 1
SCALE 1:1 DATE 6/19/2013 SHEET 1 OF 1