

SPEC	
EC	O
COMPASS	X
MICROPHONE	X
HOMELINK	O
	(BACKLIGHT: WHITE)
SMARTBEAM	X
RCD	X
FRNDL LAMP	X
PG	SEE TABLE B

MATING CONNECTOR ON VEHICLE HARNESS	
HOUSING	TOYOTA P/N 90980-12368
TERMINAL	TOYOTA P/N 90980-09895

NO.	TOYOTA P/N	GENTEX P/N	PART NAME	MATERIAL	SURFACE TREATMENT	QUANTITY	MATERIAL TS
1	SEE TABLE B		CELL SUB-ASSY, INNER MIRROR W/DRIVER			1	
2		625-0731	CASE FRONT S.A., INCLUDING BUTTONS	PC+ABS (COLOR: BLACK)	GNTX-130	1	TSM5526G-1L
3		340-1124	CASE REAR	PC+ABS (COLOR: BLACK)	GNTX-130	1	TSM5526G-1L
4		343-0203	LENS, AMBIENT	POLYCARBONATE		1	TSM5513G-1
5		350-0142	MOUNT	ZINC	BLACK PAINT	1	
6		355-0010	TUBE	STEEL	BLACK PAINT	1	
7		350-0143	PIVOT BALL	ZINC	BLACK PAINT	1	
8		345-0822	BEARING CUP, MOUNT	PP TALC		1	
9		345-0821	BEARING CUP, PIVOT	HDPE		1	
10		418-0071	SPRING	STEEL		1	
11		409-0027	WASHER	STEEL		1	
12		400-0037	SCREW, TORX	STEEL	BLACK PAINT	1	
13		401-0114	SCREW	STEEL		3	
14		375-0493	"SEE TABLE B" ID LABEL (REMOVABLE)			1	
15	90980-12367		HOUSING CONNECTOR, MALE				

MODEL	ISS.	MASS	E.C.NO.	MODEL	ISS.	MASS	E.C.NO.
600A		510gMC		600A		510gMC	

REV. NO.	REVISION RECORD	E.C.NO.	DATE	REVR
1	RELEASE FOR PRODUCTION PER R.D.D.P.: IK72-0013	620WS0002	6/19/2013	LUNDY

TABLE B:

PART NO.	CELL SUB-ASSY	NON-PG	PG	LABEL MARK
87810-0WM90	87809-0WC70	O		TBD
87810-0WM80	87809-0WC80	O	O	TBD

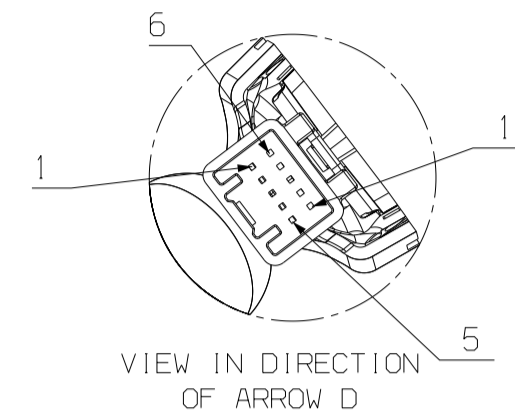
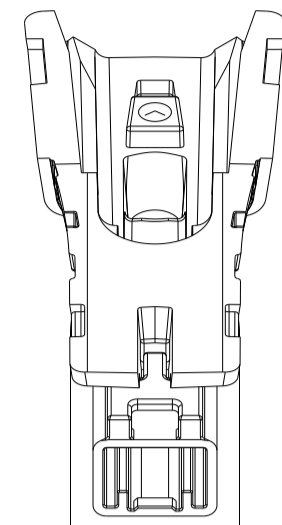

PIN	FUNCTION	CURRENT
1	IGNITION	1500mA MAX
2	GROUND	1500mA MAX
3	REVERSE	15mA MAX
4	OEC FEED (+)	300mA MAX *
5	OEC FEED (-)	300mA MAX *
6	BATTERY	100mA MAX
7	OPEN	NA
8	OPEN	NA
9	OPEN	NA
10	OPEN	NA

*PER ELEMENT

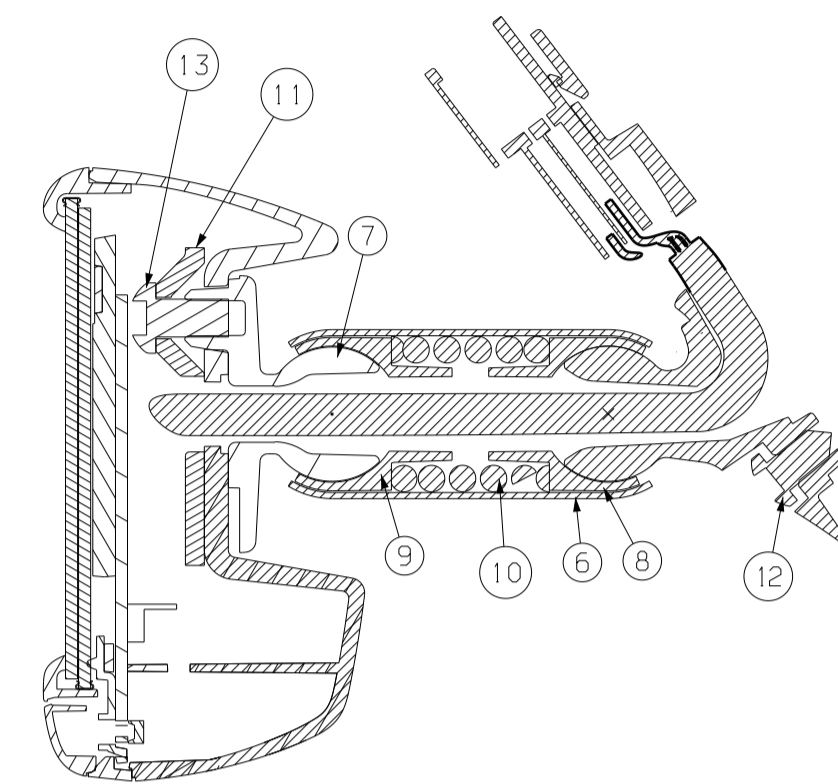

SECTION CUT A-A

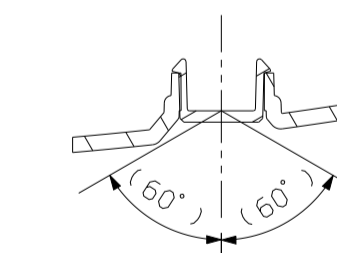
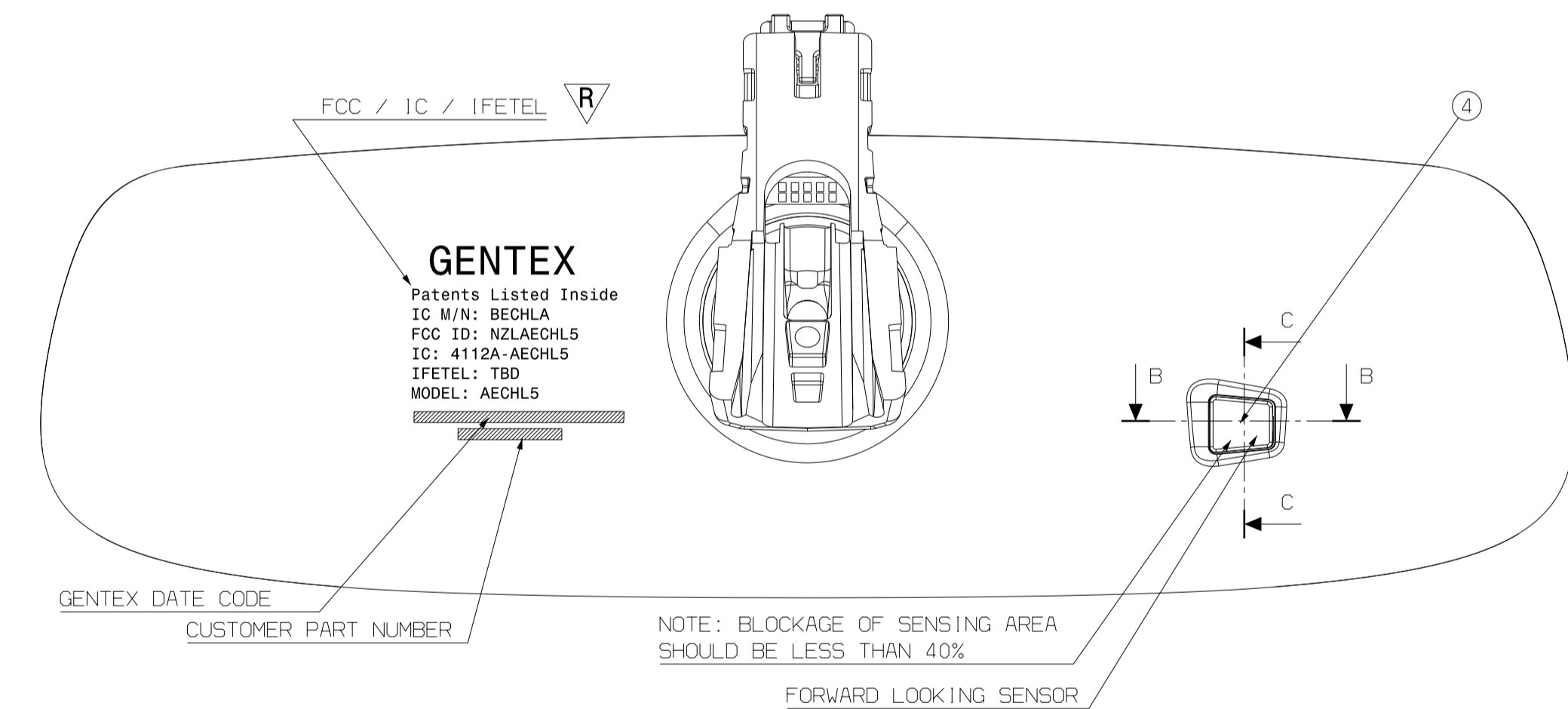
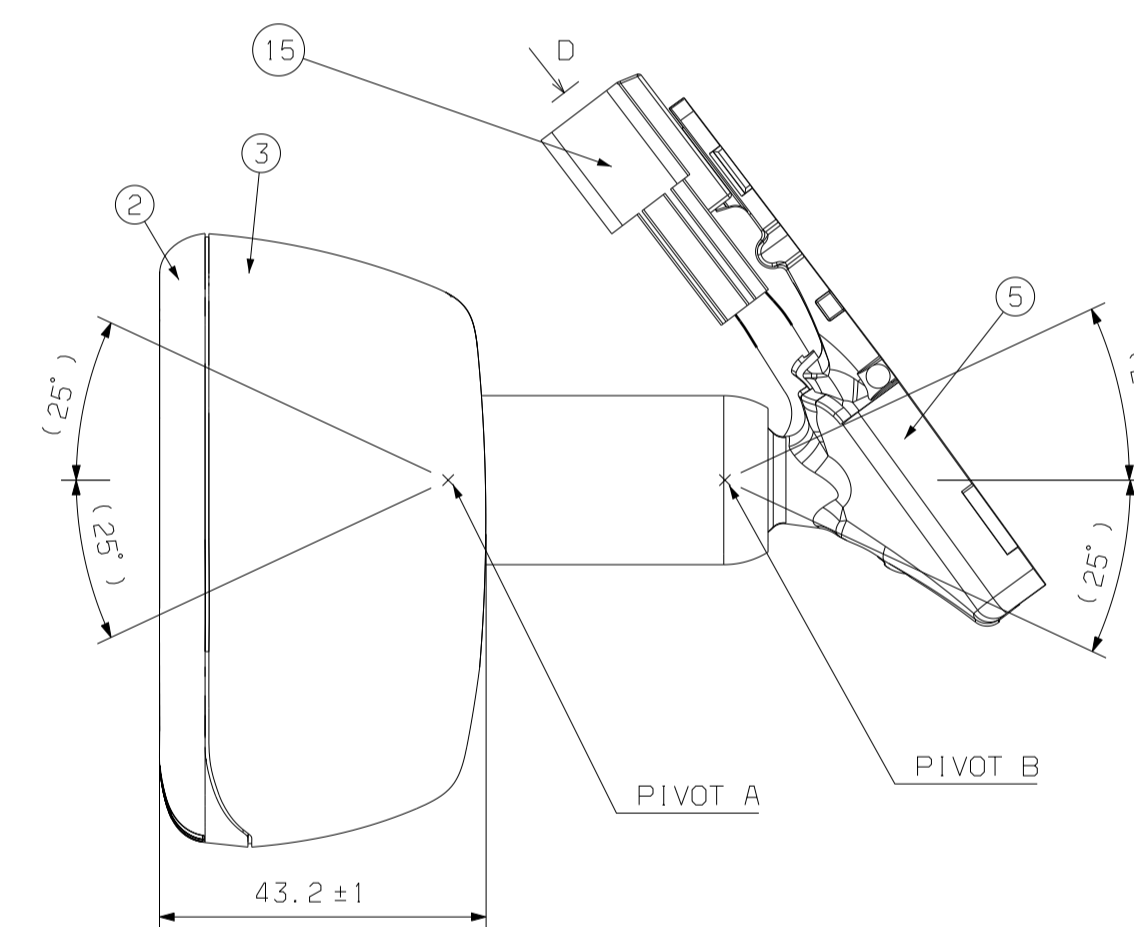
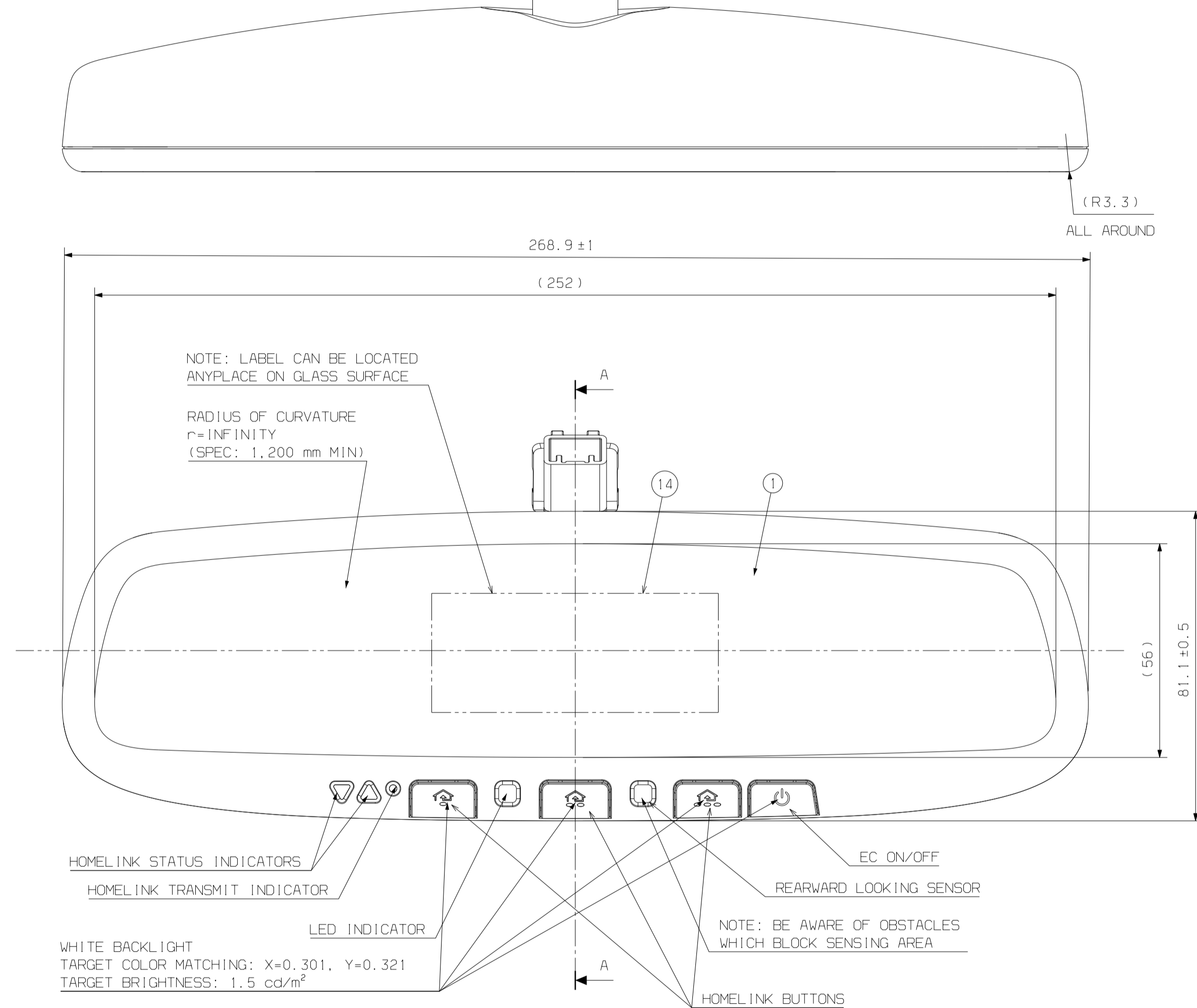

SECTION CUT B-B
SENSOR AREA OF
FORWARD LOOKING SENSOR

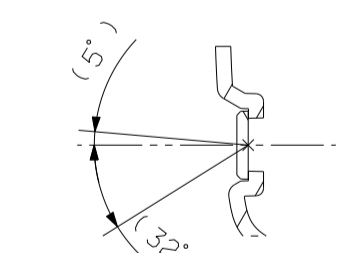

SECTION CUT C-C
SENSOR AREA OF
FORWARD LOOKING SENSOR

TABLE A:

No.	Test Item	Test Method	Criteria	Responsibility Supplier	Toyota
1	Mirror quality	As per TSC 3900G	As per TSC 3900G-1 (bubbles, inclusion, scratch and others).	0	0
2	Mirror curvature	As per TSC 3900G	Concave face: R9000 MIN. Convex face: R3000 MIN.	0	0
3	Mirror distortion factor	As per TSC 3900G	Within 2%	0	0
4	Mirror angle adjustment range	As per TSC 3900G	Instruction in the drawing MIN.	0	0
5	Mirror angle adjustment force	As per TSC 3900G	See Note #7.	0	0
6	Chattering	As per TSC 3900G (Sweep from 20 to 200 Hz)	In range of the following graph (shaded area). Report results only. Actual pass/fail per vehicle test (No. 20).	0	0
7	Wobbling	As per TSC 3900G	Shall be 1mm MAX.	0	0
8	Angle adjustment durability	As per TSC 3900G (1500 cycles)	#4 to #7 shall be met.	0	0
9	Vibration durability	As per TSC 3900G (4 hours vertical, 2 hours lateral, 2 hours longitudinal)	(1) Initial sample: #1 and #4 to #7 shall be met. No such defects as discoloration and cracking shall be found on the mirror surface. (2) High temp exposed sample: Rotational looseness shall not occur at the fastening part. #7 shall be met.	0	0
10	Thermal cycle	As per TSC 3900G (-30° C X 7.5h, +23° C X 0.5h, +80° C X 15.5h, +23° C X 0.5h) X 4 cycles	Same as those in #9 (1).	0	0
11	High temperature storage	As per TSC 3900G (+80° C X 240 hours)	Same as those in #9 (1).	0	0
12	Low temperature storage	As per TSC 3900G (-30° C X 240 hours)	Same as those in #9 (1).	0	0
13	Light resistance	As per TSL 0601G METHOD E	#1 shall be met. No such defects as discoloration and cracking shall be found on the mirror surface.	0	0
14	Ozone resistance	As per TSC 3900G (Ozone Weatherometer; 72 hours)	Same as those in #13.	0	0
15	Chemical resistance	As per TSC 3900G	Same as those in #13.	0	0
16	Steam resistance	As per TSC 3900G (+90° C X 5 hours)	#1 shall be met.	0	0
17	Energy absorbing	As per TSC 3902G	As per TSC 3902G-1	0	0
18	Flammability	Per FMVSS 302	Burning speed 10 cm/min. MAX.	0	0
19	Change in color by aging	As per TSL 0601G METHOD E	Measured color value: E*; 3.0 MAX.	0	0
20	Chattering (vehicle drive test)	As per TSC3907G	Sensory evaluation: Grade 3 or better.	0	0

APPROVED *Mike DeHaan*
MIKE DEHAAN

DATE 6/19/2013

INTERPRET DIM AND TOL PER ASME Y14.5M - 1994
THIRD ANGLE PROJECTION

NVS SYMBOLS SPECIFY FEATURES REQUIRING SPECIAL CONSIDERATION. SEE CONTROL PLAN.

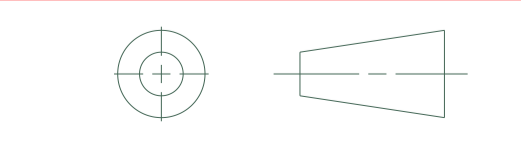

GENTEX CORPORATION
600 NORTH CENTENNIAL ST
ZEELAND, MICHIGAN 49464
(616) 772-1800

TITLE
MIRROR ASSY, INNER RR VIEW

SIZE DWG NO. CP 87810-0WM90, 87810-0WM80
SCALE 1:1 DATE 6/19/2013 SHEET 1 OF 1

ECI NO.	REVISION RECORD	MASS	MASS TOL.
620WS0002	RELEASE FOR PRODUCTION PER R.D.D.P.: IK72-0013	510g	±MC
TOYOTA PART NAME		TOYOTA PART NO.	
MIRROR ASSY, INNER RR VIEW		87810-0WM90 1/1	
MIRROR ASSY, INNER RR VIEW		87810-0WM80 1/1	
APPROVED	CHECKED	CHECKED	
IK700		TOYOTA MOTOR CORPORATION A1	