

REVISION HISTORY				
REV	DESCRIPTION	BY/DATE	ECO NO.	APPROVED
AAA	RELEASE TO PRODUCTION FROM	CDP 12/16/13	-	-

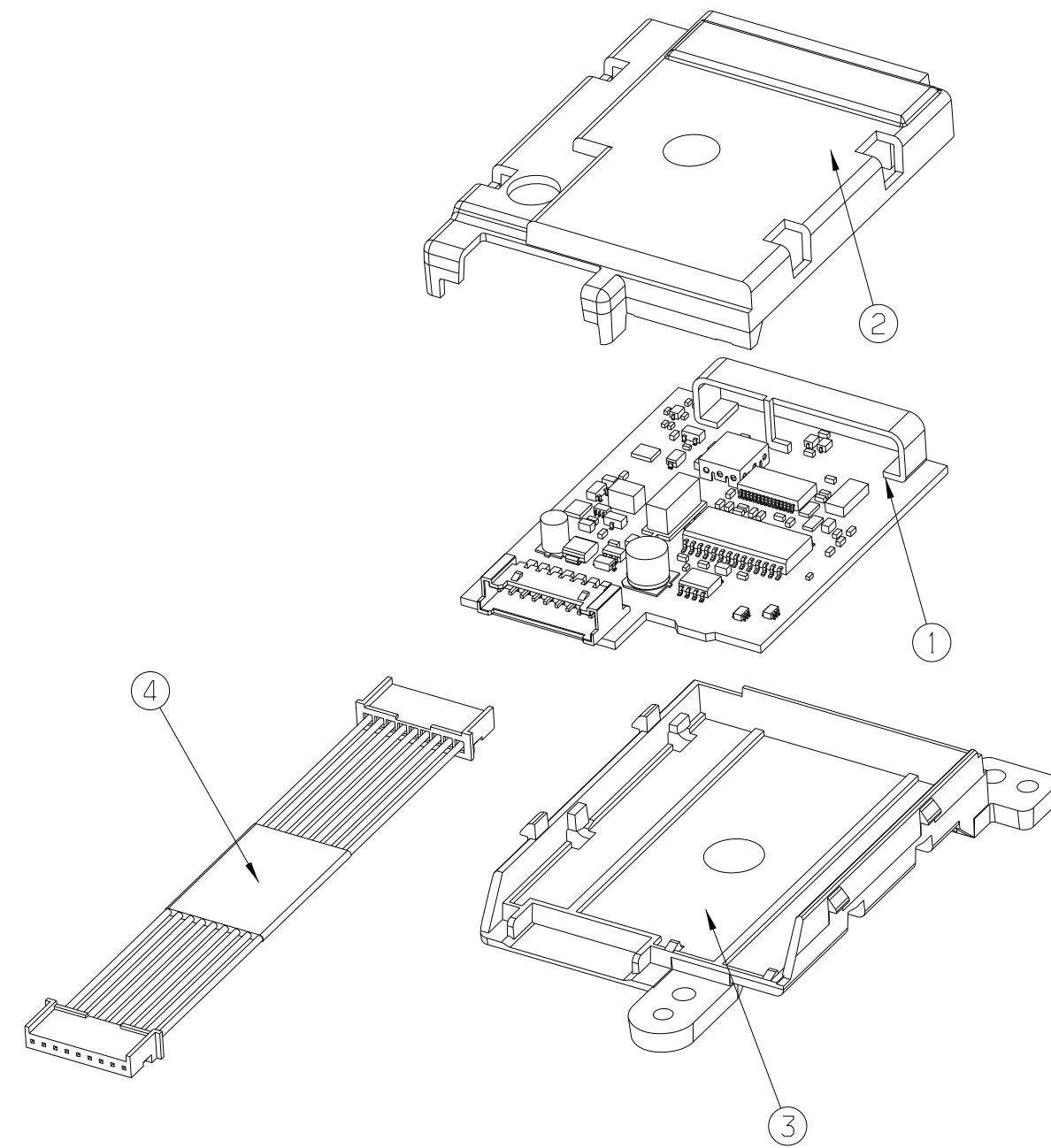
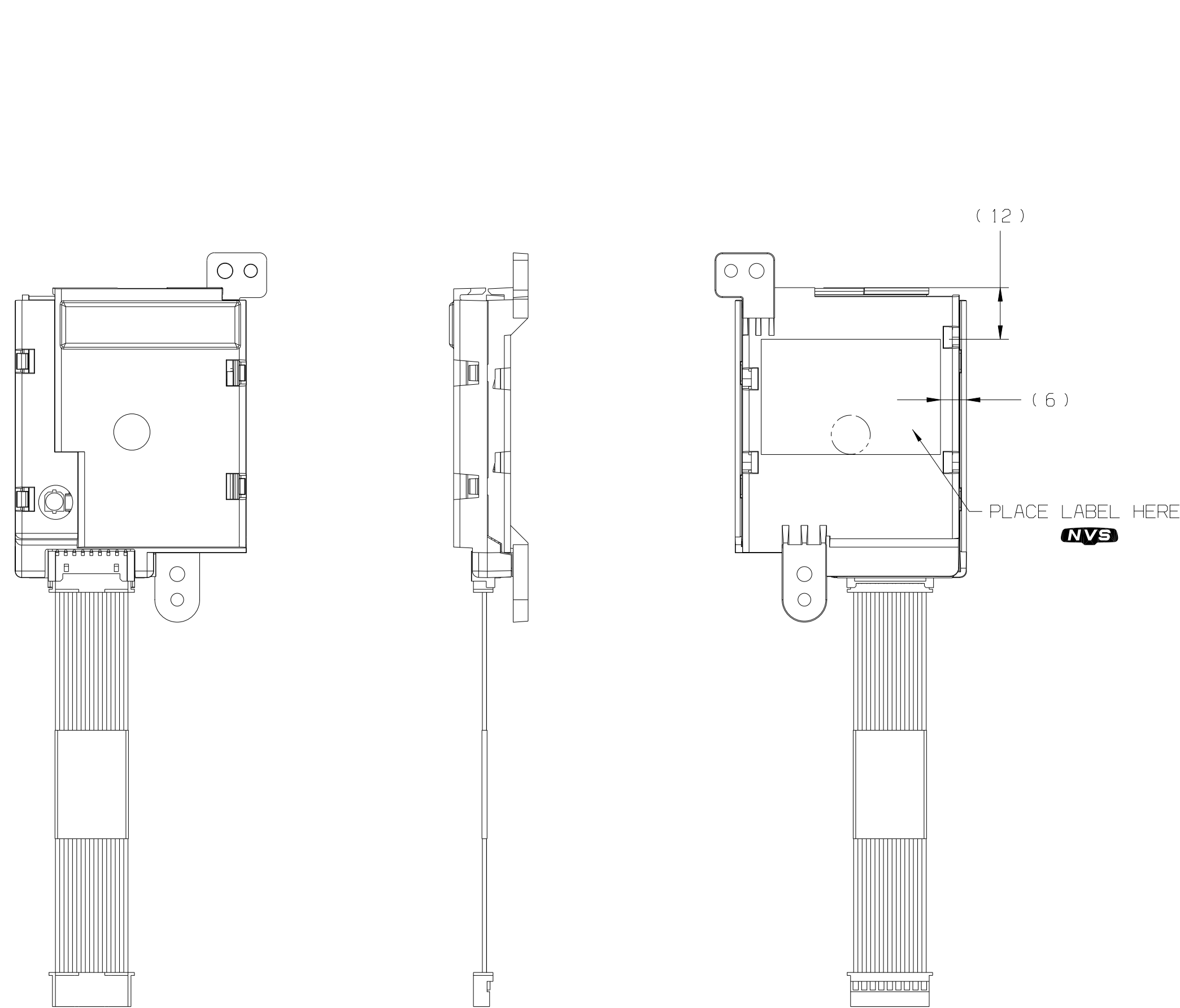

ISOMETRIC REFERENCE VIEW

C	C	B	A	ITEM	DESCRIPTION	GENTEX PART NO.
1	1	1	1	7	LABEL, BAR CODE 4X6 (NOT SHOWN)	375-0369-000
1	1	1	1	6	LBL, STOCK 1.0 x 1.5	375-0765-000
1	1	1	-	5	TAPE, HMLK 3M 850 3/4	637-0089-000
1	-	1	-	4	SA WIRE HARNESS, HMLK JMPR	625-0881-000
-	1	-	1	4	SA WIRE HARNESS, HMLK 070N JMPR	625-0880-000
1	1	1	1	3	HSG, HMLK, 070N LWR	340-1322-000
1	1	1	1	2	HSG, HMLK 070N UPR2	340-1323-000
1	1	-	-	1	SA PCB, HMLK4 340W POSLOCK	605-4741-001
-	-	1	-	1	SA PCB, HL4 070N POSLOCK	605-4740-001
-	-	-	1	1	SA PCB, 070N HMLK3, POSLOCK	605-4739-001

QTY	QTY	QTY	QTY	ITEM	DESCRIPTION	GENTEX ASSY NO. REV.
4	3	2	1	ITEM	DESCRIPTION	GENTEX ASSY NO. REV.
AAA	AAA	AAA	AAA	AAA	FINAL ASM, 460W HMLK4	960-0066
AAA	AAA	AAA	AAA	AAA	FINAL ASM, TRANSMITTER GDO 340W	960-0065
AAA	AAA	AAA	AAA	AAA	FINAL ASM, TRANSMITTER GDO	960-0063
AAA	AAA	AAA	AAA	AAA	FINAL ASM, TOYOTA 070N	960-0062

NOTES:

- INDIVIDUAL COMPONENTS ON PCB ASSEMBLY ARE FOR REFERENCE ONLY.
- ADHESIVE LABEL FORMAT AND INFORMATION IS TO MATCH AS SHOWN IN THE LABEL VIEW(S) AND BOM.
- NVS** ASSEMBLY MUST COMPLY WITH FMVSS 302 & CMVSS 302.
- THE BAR CODE CONTAINS THE FOLLOWING; 'PL' FOLLOWED BY AN 8-DIGIT BAR CODE. AN EXAMPLE IS BELOW; PL12345678
- ASSEMBLY ITEM 1, MUST COMPLY TO TEST SPECIFICATION TDE-ELE-049. ASSEMBLY ITEMS 2, 3, AND 4 MUST COMPLY TO TEST SPECIFICATION TDE-ELE-100.
- ANY MATING COMPONENTS, OR COMPONENTS IN CLOSE PROXIMITY TO THIS ASSEMBLY, MUST BE FREE FROM ANY PERMANENT OR TEMPORARY MATERIALS (LUBRICANTS, CUTTING OILS, MOLD RELEASE, RUST INHIBITORS, FASTENER COATINGS, PVC, ETC) THAT ARE INCOMPATIBLE WITH AMORPHOUS THERMOPLASTIC POLYMERS (PC, PC-BLENDS, ABS, PPO/PS, ETC.).
- REFERENCE IPC-A-610 CLASS 2 STANDARDS FOR ASSEMBLY PRACTICES AND PROCEDURES, UNLESS OTHERWISE SPECIFIED.
- ALL COMPONENTS MUST MEET SPECIFICATIONS CALLED OUT ON COMPONENT LEVEL DRAWINGS.
- ENCLOSE ELECTRONICS IN HOUSINGS (COMPONENT ITEMS 2 AND 3).
- CHARACTER HEIGHT THE "TOYOTA" AND TOYOTA PART NUMBER SHALL BE 1.27MM [0.050"].

Label Type "A" is utilized for NZL070AHL4

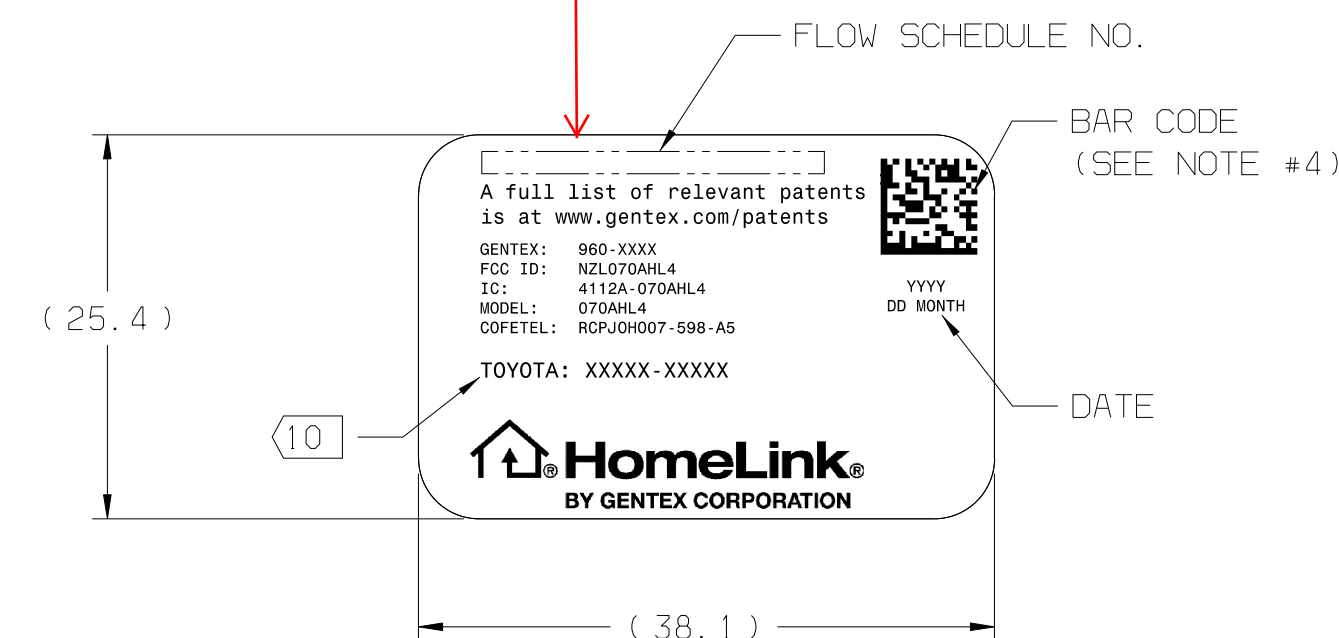

LABEL TYPE 'C'  
SCALE: 2:1  
LABEL VIEW

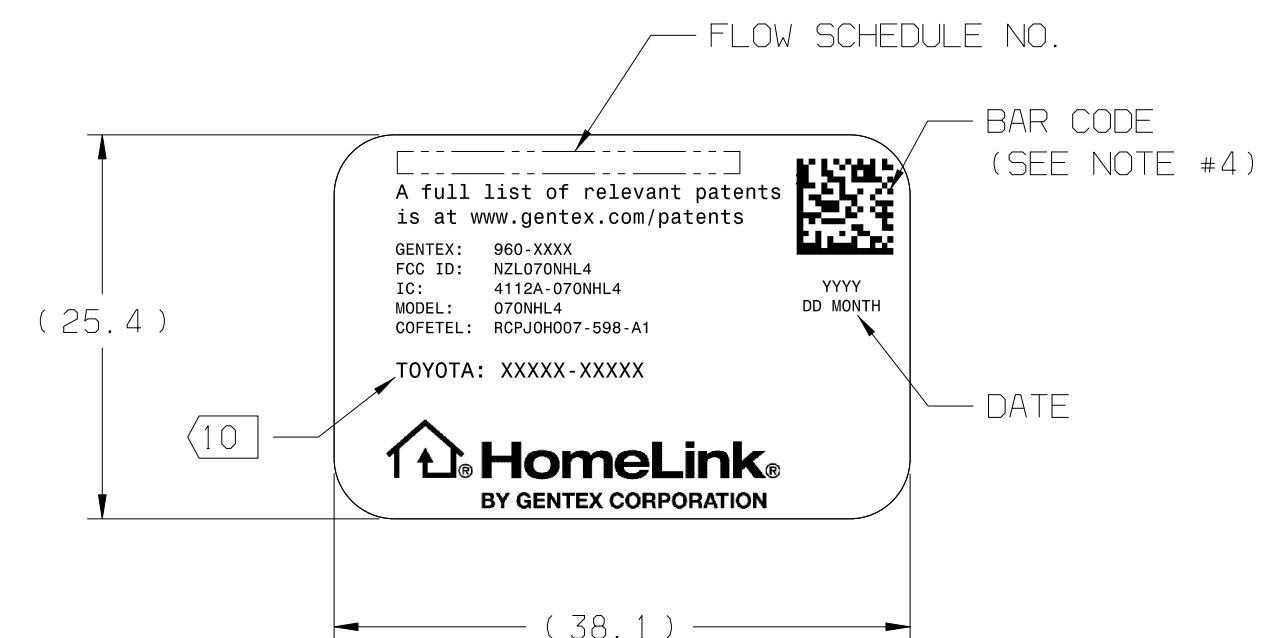

LABEL TYPE 'B'  
SCALE: 2:1  
LABEL VIEW

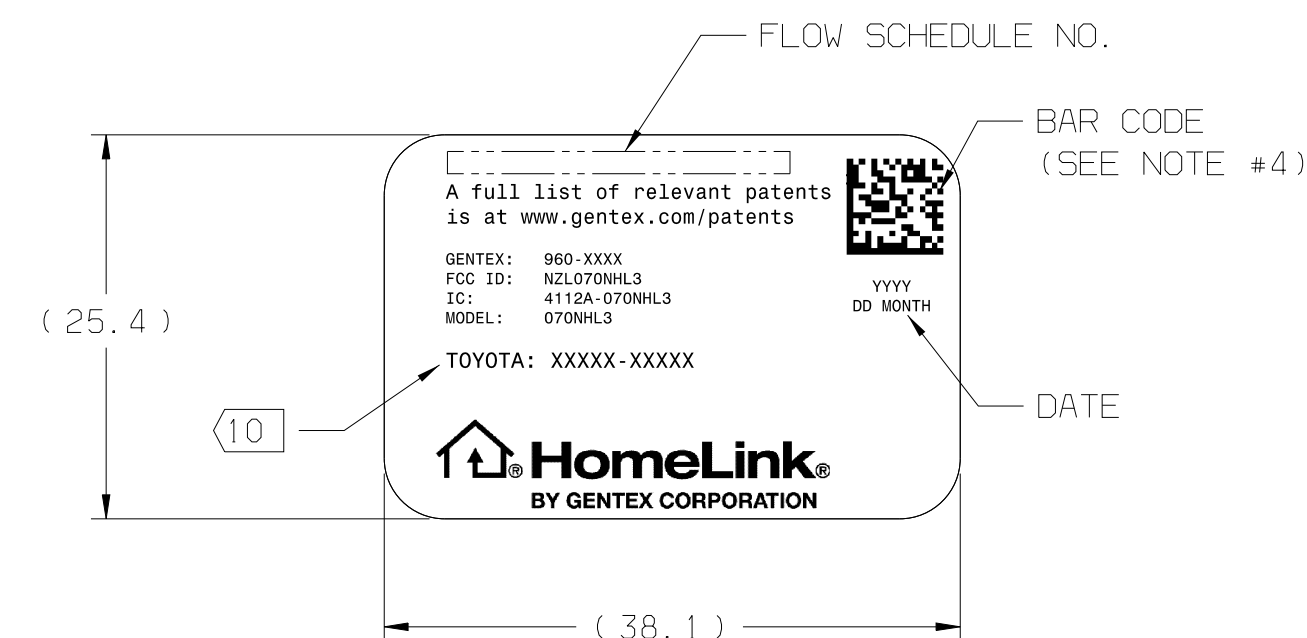

LABEL TYPE 'A'  
SCALE: 2:1  
LABEL VIEW

**GENTEX CORPORATION**  
600 NORTH CENTENNIAL ST  
ZEELAND, MICHIGAN 49464  
(616) 772-1800

TITLE  
FINAL ASM, HMLK, TOYOTA

<b>NVS</b> SPECIFIES FEATURES REQUIRING SPECIAL CONSIDERATION. SEE CONTROL PLAN. INTERPRET DIMENSIONS AND TOLERANCE PER ASME Y14.5M - 1994	SIZE D 960-D	REV AAA
THIRD ANGLE PROJECTION 	SEE COMP DWGS.	DATA FORMAT CATIA V5
SCALE 1:1 & DATE AS NOTED 12/10/2013	MASS (CALCULATED) 19.5 g	SHEET 1 OF 1