

WaveTEAMS

Digital Wireless Full-Duplex Communication System

- 3~6 full-duplex conversation per team
- Hands-free



[Product Manual]

■ Overview

WaveTEAMS is a duplex communication system which allows 1 Master and 2~5 Sub-Masters to perform full-duplex communication at a time. Two roles can be set in a team:

- **Master (M)** -
This is used by Chairman/Team Leader.
- **Sub-Master (S)** -
This is used by Participants.

■ Application sample

1 Chairman (**Master**) and two to five Participants (**Sub-Masters**) talk freely in a team.

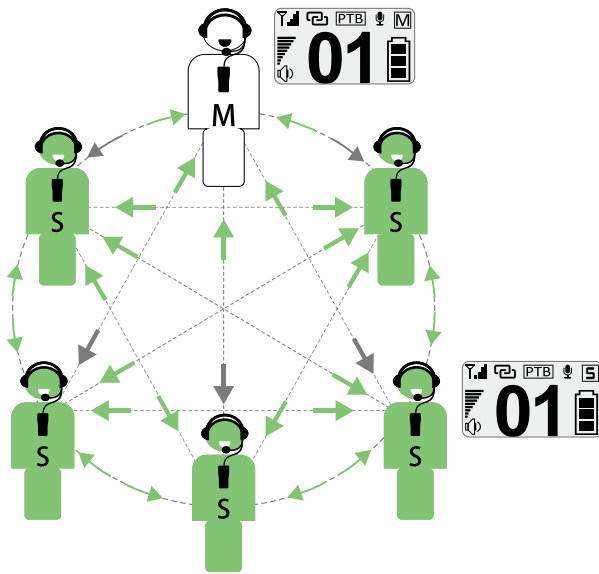

■ Interface

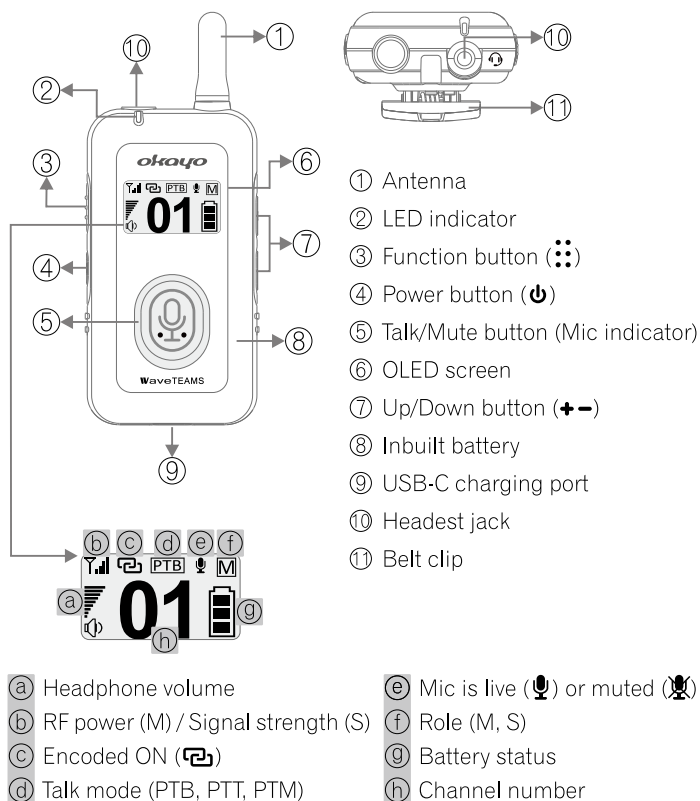

■ Create a (confidential) team

1st step – Create a Master to send pairing signal. Press both function and power buttons simultaneously to create a **Master**.

① Press the ± = button to choose a live channel and confirm with a press of function button. ② Then, “Encoded” screen shows up and press the ± = button to decide if a confidential (🔒) team is needed and press the function button to confirm. ③ Its LED indicator starts to flash quickly. This **Master** is ready and sending pairing signal. *Do not press any button on Master now.*

2nd step – Power on Sub-Masters to receive pairing signal.

Press the power button of any unit to turn on. Its screen shows same live channel as **Master's**. If different live channel shows up, power it off and then on again. **Sub-Masters** are created now.

Note Get Sub-Masters close to Master within 2 meters.

Last step – Your (confidential) team is ready! When pairing of all **Sub-Masters** is finished, short press the function button on **Master** to leave and start your team.

Note Your live channel is secured and unchangeable if in a confidential team (🔒).

■ Operation at a glance

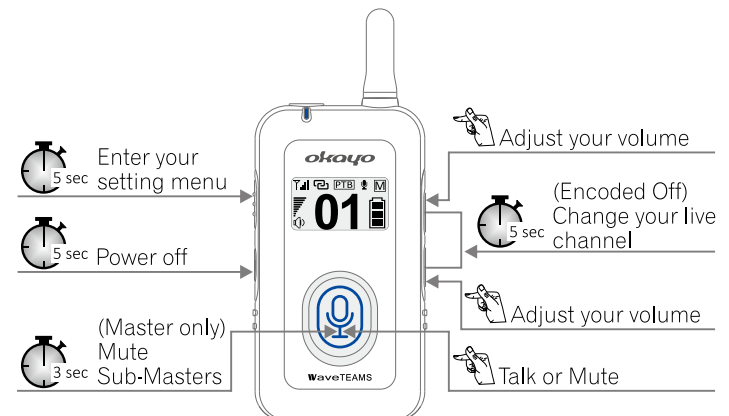

■ Operation

◆ Mute Sub-Masters (Master Priority, MP)

Master can mute all **Sub-Masters** by pressing and holding its talk/mute button for **3 seconds** during the conversation. All mic indicators start to flash and MP symbol (⦿) shows up on screens. Simply press **Master's** talk/mute button again to unmute all **Sub-Masters**.

Note Only Master with PTB mode can mute Sub-Masters.

◆ Change your live channel

All units in an open team (Encoded Off) can manually adjust their live channel, if needed. Press both ± and = buttons simultaneously for **5 seconds** until symbol 🔒 disappears. Then, press the ± = button to select another channel and confirm with a press of function button.

◆ Adjust headphone volume



Short press the \pm button on any unit to adjust the volume during your conversation. *Note listening at high volume for long periods may damage your hearing.*

◆ Power off

Press the power button for **5 seconds** to turn off. In addition, **Sub-Masters** will be off automatically when receiving no **Master's** signal for **20 minutes**. When Encoded On, shut **Master** off will also turn **Sub-Masters** off.

◆ Setting menu

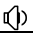
Press and hold the function button for **5 seconds** to enter setting menu. Then, press the \pm button to scroll the menu or change each setting and confirm with a press of function button. Remember to select "Save & Exit" after all setting changes are completed.

Ear out	Regular  , HAC 
Mic gain	Low, <u>Medium</u> , High
Side tone	Off, <u>Low</u> , High
Talk	PTB, <u>PTT</u> , PTM
Save & Exit	—

◆ Mic indicators

Blue	Mic is live
Red	Mic is muted
No light	No right to make a speech
Flash	Master Priority activated (Sub-Masters are being muted)

◆ LED indicators

Blue	Encoded Off
Purple	Encoded On
Red	Battery low
Solid	Signal received
Flash slowly	No signal received
Flash quickly	Pairing (Master)

■ Troubleshooting tips

◆ No audio is heard

- Make sure headphone volume is set correctly.
- Make sure headset is correctly plugged in.
- Make sure your channel is set correctly in the team.
- You are not authorized in this confidential team ()

◆ Cannot talk in the team

- Make sure correct headset is plugged in.
- Make sure Master Priority is not activated by **Master**.
- Make sure your talk button lights up. If it doesn't, wait till one of **Sub-Master** releases its talk right.

◆ Cannot mute Sub-Masters

- Make sure Talk mode PTB is correctly set on **Master**.

Manufacturer's Declaration

◆ Federal Communications Commission Interference Statement

This equipment has been tested and found to comply with the limits for a Class B digital device, pursuant to Part 15 of the FCC Rules. These limits are designed to provide reasonable protection against harmful interference in a residential installation.

This equipment generates, uses and can radiate radio frequency energy and, if not installed and used in accordance with the instructions, may cause harmful interference to radio communications. However, there is no guarantee that interference will not occur in a particular installation. If this equipment does cause harmful interference to radio or television reception, which can be determined by turning the equipment off and on, the user is encouraged to try to correct the interference by one of the following measures:

- . Reorient or relocate the receiving antenna.
- . Increase the separation between the equipment and receiver.
- . Connect the equipment into an outlet on a circuit different from that to which the receiver is connected.
- . Consult the dealer or an experienced radio/TV technician for help.

FCC Caution: To assure continued compliance, any changes or modifications not expressly approved by the party responsible for compliance could void the user's authority to operate this equipment. (Example - use only shielded interface cables when connecting to computer or peripheral devices).

RF Exposure Information (SAR):

This device meets the government's requirements for exposure to radio waves. This device is designed and manufactured not to exceed the emission limits for exposure to radio frequency (RF) energy set by the Federal Communications Commission of the U.S. Government.

The exposure standard for wireless devices employing a unit of measurement is known as the Specific Absorption Rate, or SAR. The SAR limit set by the FCC is 0.242W/kg.

This device complies with Part 15 of the FCC Rules. Operation is subject to the following two conditions:

(1) This device may not cause harmful interference, and (2) This device must accept any interference received, including interference that may cause undesired operation.

Disclaimer

This manual was made for the purpose to provide detailed product information about WaveTEAMS that Okayo Electronics Co., Ltd. (Okayo) builds and delivers to the market at the time on its birth. Okayo promises its best effort was made to give accurate, complete, and informative product information to the contents disclosed above. However, users shall be aware of the fact that improvement and up-to-date of the product could be made from time to time. Okayo reserves the right to amend, revise and change in part or in total of the product information at the time it believes there is a must. The publication of this manual and products are given as it is. Okayo is not accountable for the change/error on contents and text contained in this manual and involved products taking place in the future.



OKAYO ELECTRONICS CO., LTD.

No. 2, Gongye 10th Rd., Dali Dist., Taichung 41280, Taiwan

Tel: +886-4-2491-4666 Fax: +886-4-2491-4755

E-mail: okayo@okayo.com

www.okayo.com