

**AIPTEK<sup>®</sup>**

# SecuCam AV100

## User's Manual

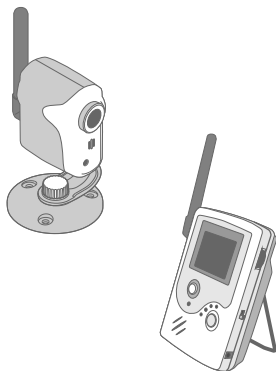

## **| WELCOME |**

Dear user, thanks for purchasing this product. Much investment in time and effort has gone into its development, and it is our hope that it will give you many years of trouble-free service. If you have any problems, please contact any AIPTEK office listed inside back cover.

---

### **WARNING MESSAGE**

- \* This device complies with Part 15 of the FCC Rules. Operation is subject to the following two conditions:
  - (1) this device may not cause harmful interference, and
  - (2) this device must accept any interference received, including interference that may cause undesired operation.

**Any changes or modifications not expressly approved by the party responsible for compliance could void the authority to operate equipment.**

- \* This equipment must be installed and operated in accordance with provided instructions and the antenna(s) used for this transmitter must be installed to provide a separation distance of at least 20cm from all persons and must not be co-located or operating in conjunction with any other antenna or transmitter. End-users and installers must be provided with antenna installation instructions and transmitter operating conditions for satisfying RF exposure compliance.

**CAUTION**

All the caution and safety instructions should be read before the product is operated.

1. Do not drop, puncture or disassemble the product; otherwise the warranty will be voided.
2. Avoid all contact with water and dry hands before using.
3. Do not expose the product to high temperature or leave it in direct sunlight. Doing so may damage this product.
4. Use this product with care. Avoid pressing hard on the product.
5. For your own safety, avoid using this product when there is a storm or lightning.
6. Avoid using batteries of different brands or types at the same time. There is potential for serious damage by using different cells.
7. Remove the batteries during long periods between usage, as deteriorated batteries may affect the functionality of this product.
8. Remove the batteries if they show signs of leaking or distortion.
9. We suggest using only the accessories supplied by the manufacturer.



## **SAFETY**

### **General**

1. Do not use the product at a voltage other than the specified voltage.
2. Do not attempt to disassemble or modify the product for reducing the risk of a fire or electric shock.
3. Do not subject the products to strong impacts or allow it to drop onto a hard surface. This can cause a malfunction.
4. This product is suggested for indoor use.

### **AC Adapter**

1. Use only the AC adapter supplied by the manufacturer.
2. Do not place heavy objects on the AC adapter cord. An excessively distorted cord may cause damage or injury.
3. Do not touch the output terminal of the plug while it is still plugged in an outlet.
4. When unplugging the AC adapter, do not pull on the power cord. Hold the adapter unit when removing it from an outlet.

### **Batteries**

1. Use specified rechargeable batteries only.
2. ***Do not use Alkaline batteries as this may result in an explosion if the AC adapter is plugged in for recharging.***
3. Never throw the batteries in an open fire. The batteries may explode.
4. Keep the batteries out of the reach of small children.

# Table of Contents

EN

<b>WELCOME</b>	2
<b>WARNING MESSAGE</b>	2
<b>CAUTION</b>	3
<b>SAFETY</b>	4

Table of Contents	5
-------------------	---

Introduction	6
--------------	---

1. Overview	6
2. Package Contents	6

Part Names	7
------------	---

1. Wireless Camera	7
2. LCD Monitor	8

Installation	9
--------------	---

1. Wireless Camera	9
2. LCD Monitor	10
Loading the batteries	10
Plugging the AC adapter	10
Charging the batteries	11
Disabling Power Saving mode	11

Troubleshooting	12
-----------------	----

Specifications	13
----------------	----

# Introduction

## 1. Overview

This product is one of the smallest 2.4GHz wireless audio/video monitors. It contains a CMOS camera and a wireless LCD monitor. The compact hand-held 1.8" wireless LCD monitor makes it easy to keep an eye on your love ones wherever you are in the house, providing you with the convenience of mobility.

With its unique wireless design, it is easy to set up the product. The wireless camera can be mounted on walls, ceilings or moved freely and placed on a flat surface.

It also comes with a remarkable auto trigger function. In power saving mode, the LCD monitor will be automatically activated as soon as the camera detects any sound within effective range.

This product can be used as a baby monitor, security monitor, burglary detection or home monitoring device.

## 2. Package Contents



Camera



LCD monitor

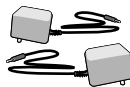

AC power adapters x 2



AA Ni-MH rechargeable  
batteries x 4



Users manual



Screws x 3

# Part Names

EN

## 1. Wireless Camera

Front View

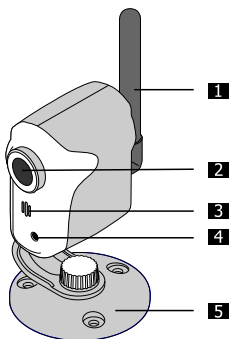

Rear View

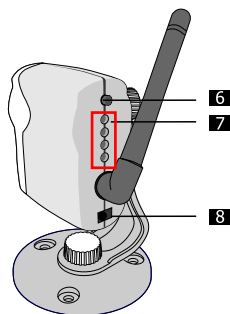

- 1** Antenna
- 2** Lens
- 3** Microphone
- 4** Power On LED
- 5** Universal Mounting
- 6** Channel Selection Button
- 7** LED Indicator (CH1 ~ CH4)
- 8** Power Adapter Plug

## 2. LCD Monitor

Front View

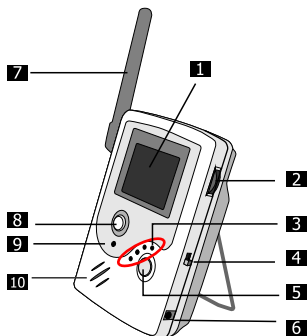

Rear View

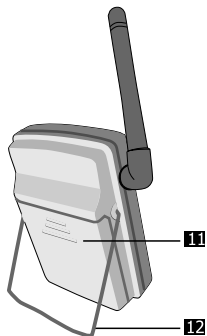

- 1** LCD Monitor
- 2** Volume Control Switch
- 3** LED Indicator (CH1 ~ CH4)
- 4** Power On/Off Switch
- 5** Channel Selection Button
- 6** Power Adapter Plug
- 7** Antenna
- 8** Wake Up Button
- 9** Battery Status LED
- 10** Speaker
- 11** Battery Compartment Lid
- 12** Stand Clip

# Installation

EN

## 1. Wireless Camera

- 1 Fix the camera to the wall or ceiling with the screws provided or place it on a flat surface.

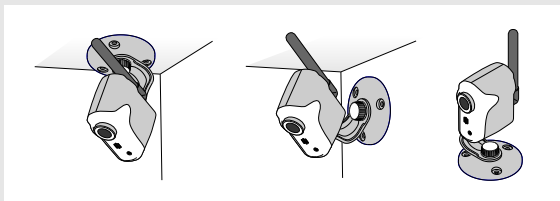

- 2 Connect the wireless camera with AC adapter and plug in to an outlet.

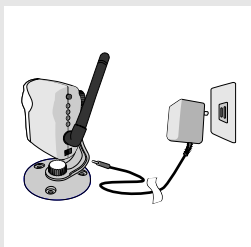

- 3 Press the Channel Selection button to setup camera channel. If more than one camera is used, set each camera to a different channel.

Camera	Monitor
Channel 1	Channel 1
Channel 2	Channel 2
Channel 3	Channel 3
Channel 4	Channel 4

## 2. LCD Monitor

The LCD Monitor can be powered by way of the AC adapter, or by four AA Ni-MH rechargeable batteries.

### Loading the batteries

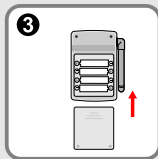
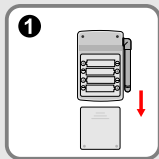

- 1 Slide open the battery compartment lid.
- 2 Place the batteries in accordance with the anode and cathode (- +) marks.
- 3 Replace the battery compartment lid.

### Plugging the AC adapter

Connect the LCD monitor with the AC adapter and plug in to an outlet.

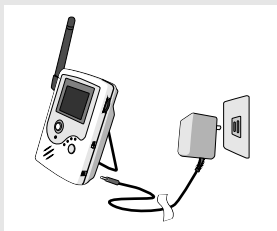

### Controls and Operation

The monitor must be set to the same channel as the camera to receive the camera signal. Press the Channel Selection button to watch and listen between desired cameras.

## Charging the batteries

Place the batteries in the battery compartment. Connect the LCD monitor with the AC adapter and plug in the outlet. The batteries will be automatically recharged. For the first time, please charge the batteries for 10 hours.

**Note:** When the LCD power is off, the battery status LED will light up until the batteries are fully charged. (Please refer to the table below)

**Battery Status LED**

Power	In Charging	Fully Charged	Time required
Off	Light up	Light off	Approx. 3 hours (depending on battery capacity)
On	Light off	Light off	Approx. 10 hours

## Disabling Power Saving mode

**Power Saving mode** is only available when using batteries. When the LCD monitor is idle for over 30 seconds, it will switch into **Power Saving mode**. When the camera detects a sound, the LCD monitor will be automatically activated at once.

To disable **Power Saving mode**, press the Wake Up button for three seconds, and the battery status LED will blink once. (Please refer to the table below)

Condition	Power Saving mode	
	Enabling	Disabling
Using Batteries	Press the Wake Up button for 3 seconds	
Using Power Adapter	Not available	

**Note:** In **Power Saving mode**:

- (1) You may press the Wake Up button slightly to activate the LCD monitor.
- (2) The battery status LED will blink.

# Troubleshooting

Question	Answer 
<b>❶</b> Image or sound is not clear.	<ul style="list-style-type: none"><li>• Switch both Camera and LCD monitor to another channel. (E.g. From CH1 to CH4)</li><li>• Adjust the orientation of antenna.</li><li>• Adjust the volume.</li><li>• Re-orient the camera and LCD monitor slowly to obtain better reception.</li><li>• Check if there is any radio interference (such as any 2.4GHz electronic products) near the LCD monitor.</li><li>• This may be a temporary phenomena caused by unstable electricity current.</li></ul>
<b>❷</b> No image on LCD monitor.	<ul style="list-style-type: none"><li>• Check if the batteries are installed correctly or the AC power adapter is plugged in.</li><li>• Check if the batteries are exhausted.</li><li>• Check if the Power On/Off switch is turned on.</li><li>• Check if the camera and monitor are set to the same channel.</li><li>• Check if the LCD monitor is in Power Saving mode.</li></ul>

# Specifications

EN

<b>CMOS Camera &amp; Transmitter</b>	
Pick Up Elements	Color CMOS sensor, 300,000 pixels
Transmit Frequency 4 Channels	2.400 GHz ~ 2.483 GHz
Frequency Deviation	$\pm 100\text{KHz}$ ( $10^{\circ}\text{C} \sim 50^{\circ}\text{C}$ )
Demodulation Method	FM
RF Output Power	Vcc = 5V, output impedance = 75 ohm, 10dBm
Antenna	DIPOLE (85mm)
Minimum Illumination	3 Lux (at F2.8)
Built-in	Microphone
Power Source	6V DC 1A
Operation Temperature	$10^{\circ}\text{C} \sim 50^{\circ}\text{C}$
Operation Humidity	5% ~ 85%
Transmission Range	30Meters (open space)

<b>1.8" TFT LCD Wireless Monitor &amp; Receiver</b>	
Screen Size	1.8" TFT LCD monitor
Receiver Frequency 4 Channels	2.400 GHz ~ 2.483 GHz
Power Source	6V DC 1A or 4 x AA Ni-MH rechargeable batteries
Power Consumption	2.3W
Environmental Condition	$10^{\circ}\text{C} \sim 50^{\circ}\text{C}$
Dimension	72mm x 108mm x 31mm (WxHxD)