

MODEL:EMR211X
TITLE: COLOR SP.
VERSION:
REV.: 1.0 DATE: 28APR2018
REMARK: PAGE 1 OF 1
PREPARED BY: VICKY LIN/ VALENTINO CHOW
FILE:
APPROVED BY
PMGT <input type="checkbox"/>
MKTR <input type="checkbox"/>
CU <input type="checkbox"/>
DATE:

A3

IDT IDT Technology Limited

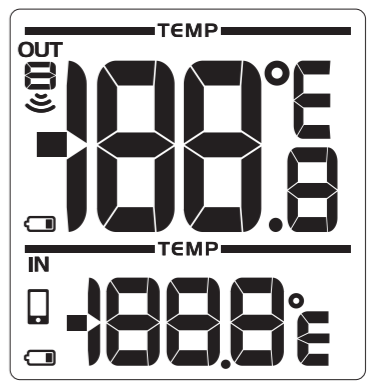

FULL SEGMENT
VA. SIZE: 47X49mm

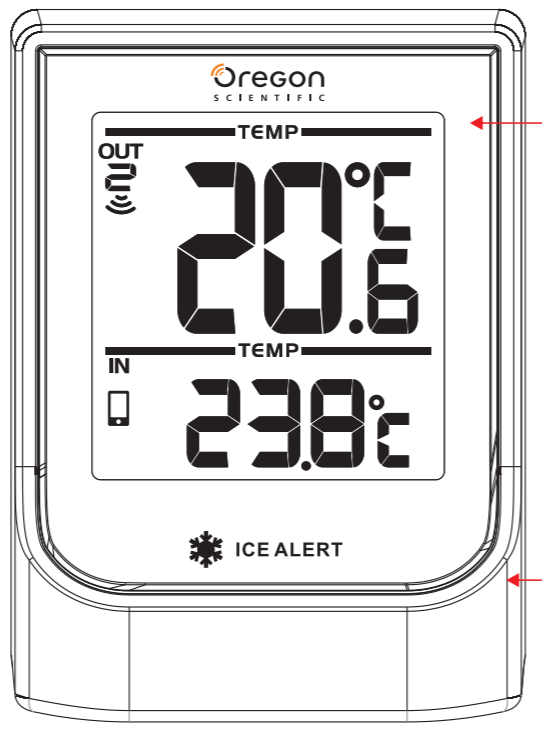
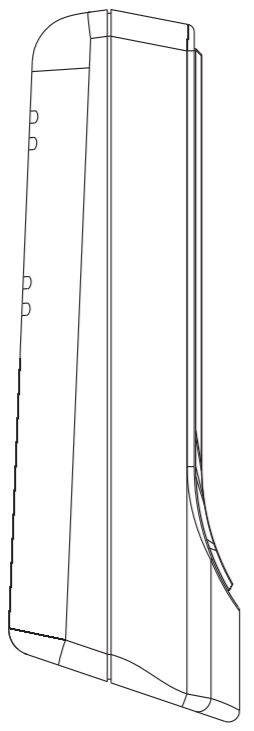

LENS-

INJ. COL: CLEAR
 SPRAY COL: NIL
 S/S COL ON LENS BACK:
 -B/G: MG-04 (METALLIC CRAY)
 -LOGO: PMS144C/ PMS427C
 -❄️ ICON AND TEXT ON LENS FRONT:
 TRANSLUCENT WHITE
 TEXTURE: HIGH GLOSSY

REAR CAB & BATT. DOOR & STAND-

INJ. COL: PROCESS BLACK C
 SPRAY COL: NIL
 S/S COL: PMS877C SILVER
 TEXTURE: YS20001B

FRONT CAB-

INJ. COL: PROCESS BLACK C
 SPRAY COL: NIL
 S/S COL: NIL
 TEXTURE: HIGH GLOSSY

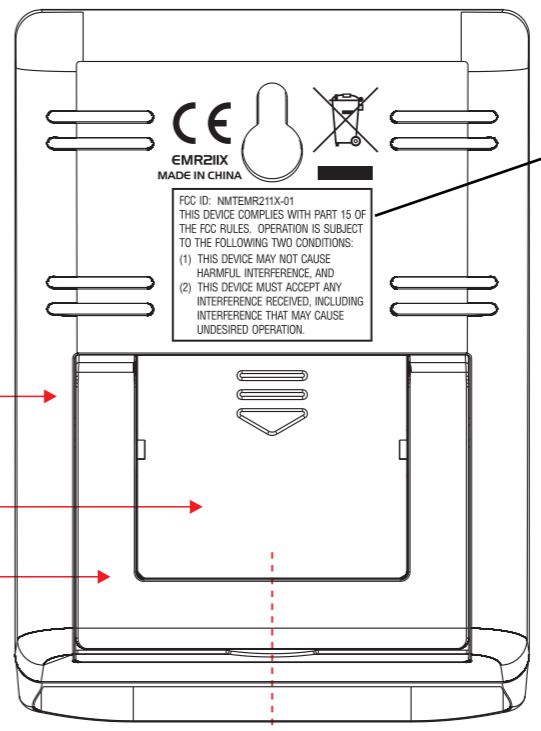

Size: 26mm * 22mm

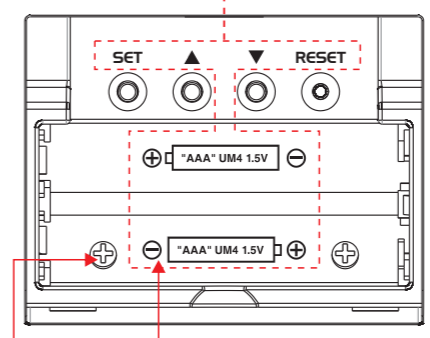

EMBOSS TEXT AND GRAPHIC
SCREW X 2- COL: BLACK