

COOL GRAY 2C

MODEL: CP100
TITLE: COLOR SP.
VERSION:
REV.: 01 DATE: 25JUL2016
REMARK: PAGE 1 OF 1
PREPARED BY: VALENTINO CHOW
FILE:
APPROVED BY
PMGT <input type="checkbox"/>
MKTR <input type="checkbox"/>
CU <input type="checkbox"/>
DATE:

A3

IDT IDT Technology Limited

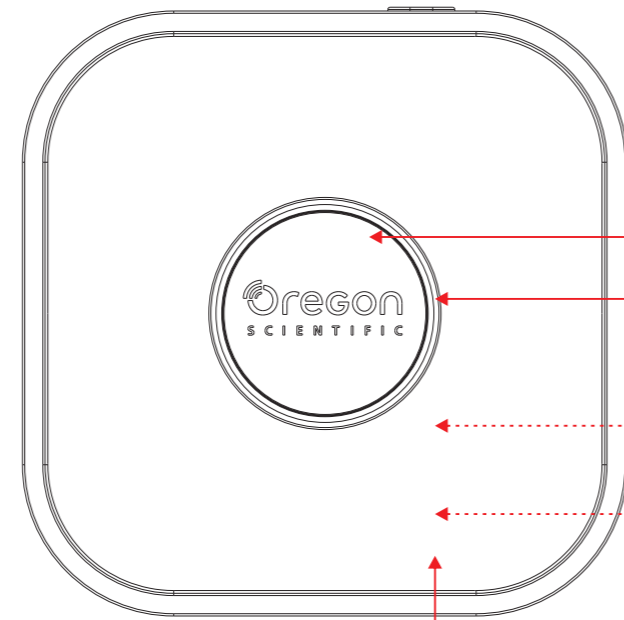

- BRAND PLATE-
COL: ALUMINUM
SPRAY: SAND BLAST
S/S COL: NIL
TEXTURE: SAND BLAST
- COSMETIC PLATE-
INJ. COL: COOL GRAY 1C
FINISHING: ELECTROPLATE
- TOP CAB (INNER)-
INJ. COL: PROCESS BLACK C
- HOLDER (INNER)-
INJ. COL: PROCESS BLACK C
- SPEAKER NET-
COL: STEEL
SPRAY: PMS877C

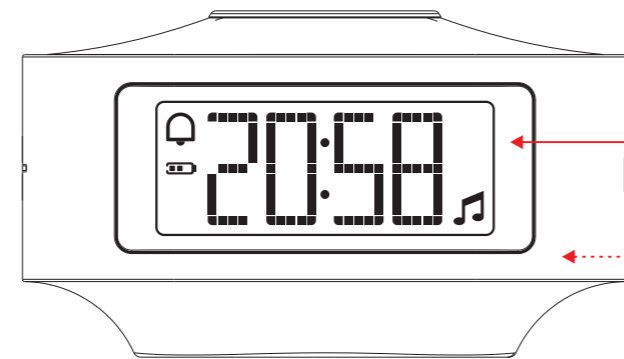
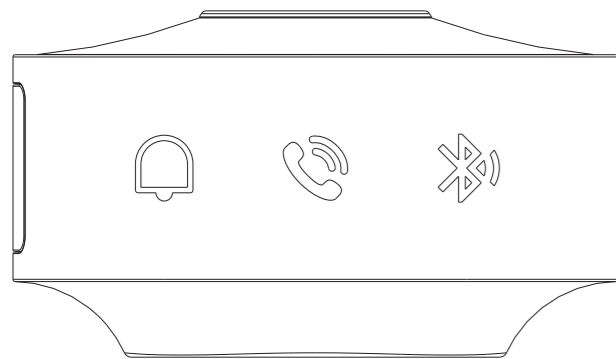

- LENS-
INJ. COL: CLEAR
SPRAY: NIL
S/S COL: COOL GRAY 1C
TEXTURE: HIGH GLOSSY
- BOTTOM CAB (INNER)-
INJ. COL: COOL GRAY 1C
SPRAY COL: NIL
S/S COL: NIL
TEXTURE: FINE MATT.

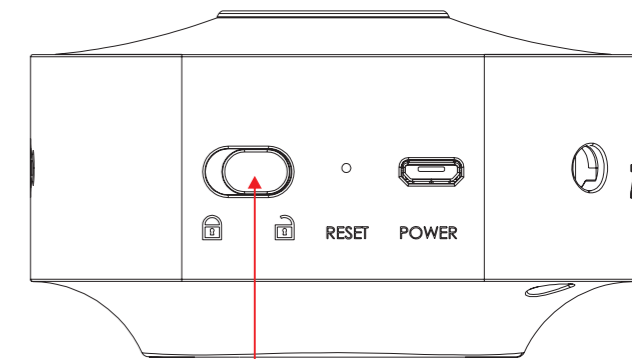
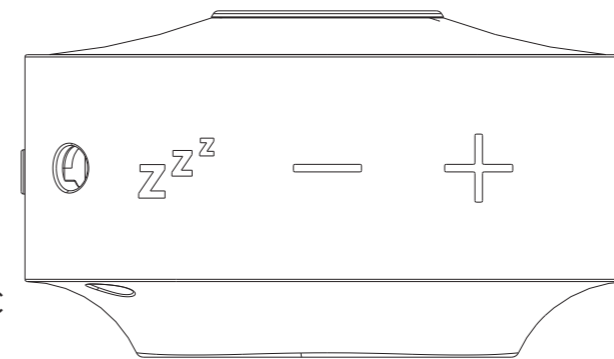

- KEY-
INJ. COL: COOL GRAY 1C
SPRAY: NIL
S/S COL: NIL
TEXTURE: YS20002B

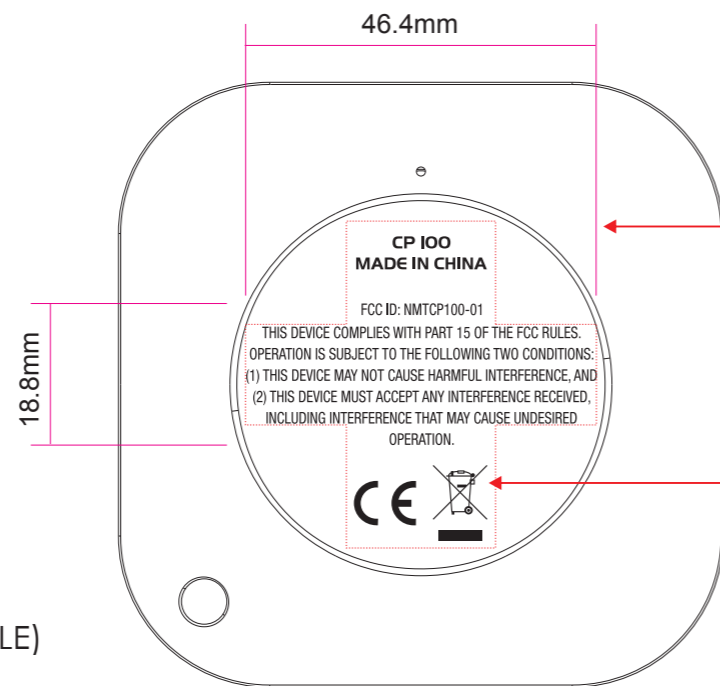

- SILICONE-
COL: COOL GRAY 2C
SPRAY COL: CLEAR
S/S COL: NIL
TEXTURE: FINE MATT.

ENGRAVED

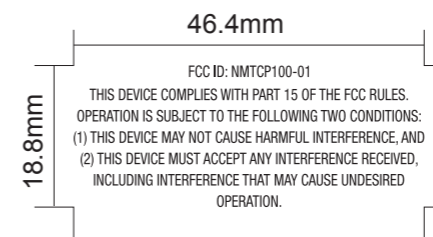

STRING-
COL: GRAY (REFER TO SAMPLE)

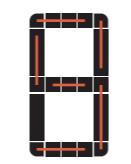

7 segment

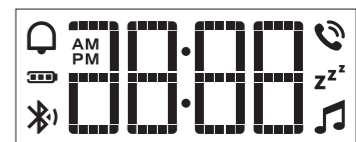
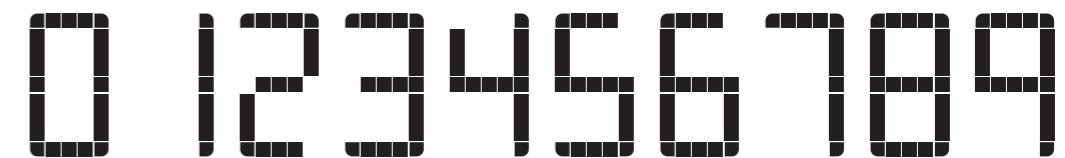

VA SIZE: 45x 18 mm
FULL SEGMENT