

MODEL: CIR600
TITLE: COLOR SP.
VERSION:
REV.: 18 DATE: 25SEP2017
REMARK: PAGE 1 OF 1
PREPARED BY: VICKY/ RICCI/ VALENTINO
FILE:
APPROVED BY
PMGT <input type="checkbox"/>
MKTR <input type="checkbox"/>
CU <input type="checkbox"/>
DATE:

A3

IDT IDT Technology Limited

- ▲ Update main body and battery door finishing
- ▲ Update rubber foot outline

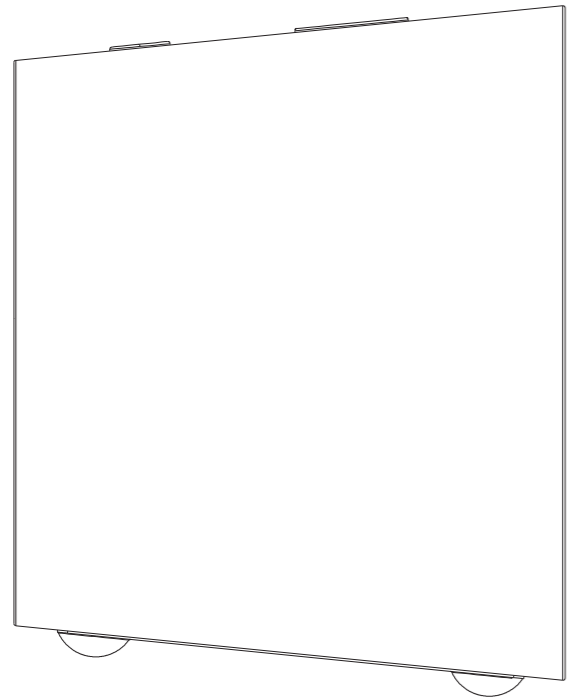

FULL SEGMENT
VA.: 84X34mm

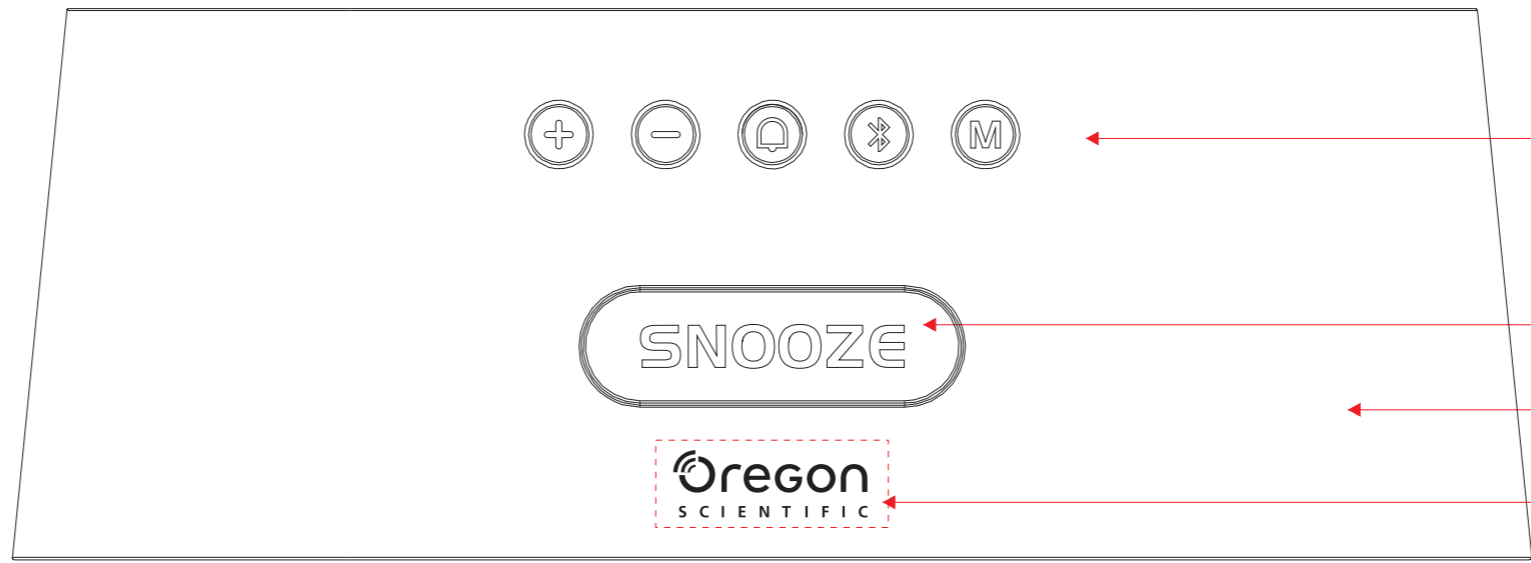

KEYS-
C: PANTONE 877C
M: SILICON RUBBER
F: MATT
ICON & TEXT-ENGRAVING

MAIN BODY (OUT CASE)-
C: INJ. - PANTONE BLACK C
SPRAY - PANTONE 877C
S/S LOGO- PANTONE 8404C
M: ABS
F: YS20038C



FRONT NET COVER-
C: REFER SAMPLE
M: FABRIC
F: MATT

BOTTOM COVER-
C: INJ. - PANTONE BLACK C
M: ABS
F: YS20038C

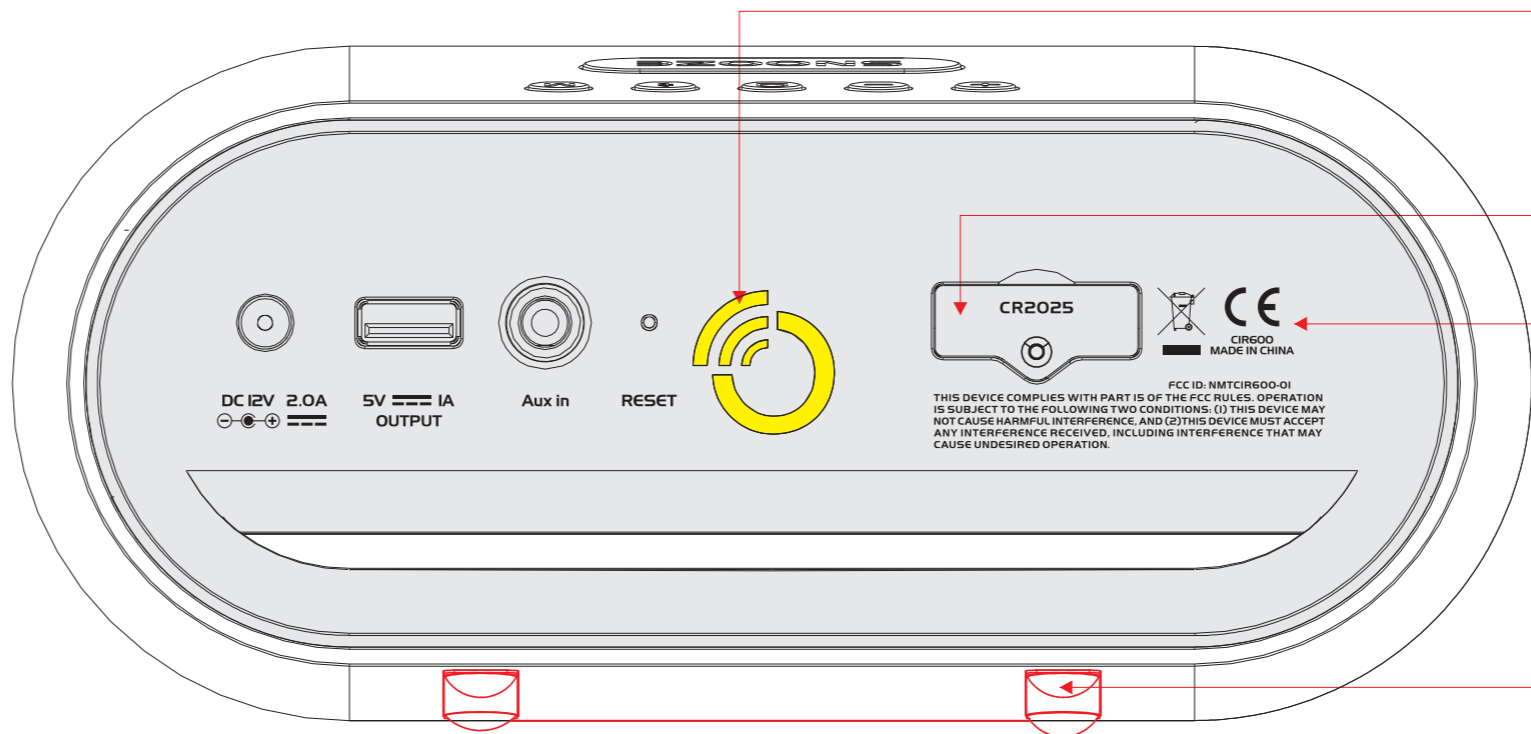

LOGO- ENGRAVING
F: HIGH GLOSSY

▲ **BATTERY DOOR-**
C: INJ. - PANTONE BLACK C
S/S - PANTONE COOL GRAY 1C
M: ABS
F: YS20048C

▲ **MAIN BODY (OUT CASE)-**
C: INJ. - PANTONE BLACK C
SPRAY - NIL
S/S - PANTONE COOL GRAY 1C
M: ABS
F: YS20048C

▲ **RUBBER FOOT**
C: PANTONE BLACK C
M: SILICON
F: MATT