

5. Enter the ISP server phone number, then tap **Next**.
6. Enter your user name, password, and any other information required by your ISP, then tap **Finish**.

## 8.2 Starting a Data Connection

After setting up a data connection such as GPRS/3G or ISP dial-up on your device, you can now connect your device to the Internet. The connection is started automatically when you begin using a program that accesses the Internet such as Opera Mobile.

### To manually start a data connection

If you have set up multiple types of data connections on your device, you can manually start a connection.

1. On the Home screen, slide to the **Settings** tab and then tap **All Settings**.
2. On the **Connections** tab, tap **Connections**.
3. Tap **Manage existing connections**.
4. Tap and hold the name of the desired connection, then tap **Connect**.

### To disconnect active data connections

1. Tap **Start > Programs > Comm Manager**.
2. Tap the **Data Connection** button.

**Note** You cannot reconnect a data connection in Comm Manager.

## 8.3 Using Opera Mobile™

**Opera Mobile™** is a full-featured Internet browser, optimized for use on your device.

**Note** You can also use Internet Explorer® Mobile to browse the web. To open Internet Explorer Mobile, tap **Start > Internet Explorer**.

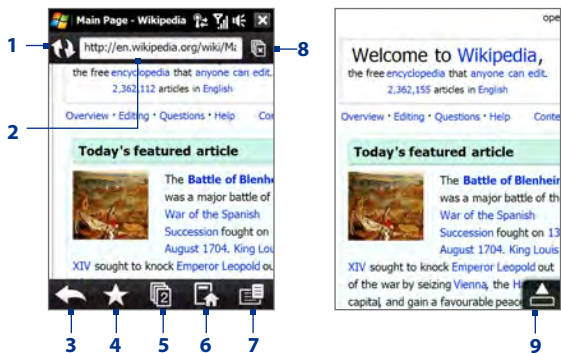

- 1 Refresh.** Tap to reload the web page being viewed.
- 2 Address bar.** Enter the URL of the web site here.
- 3 Back.** Tap to go back to the previous web page viewed.
- 4 Favourites.** Tap to go to the Favourites screen where you can add a favourite, edit favourite web pages, and send the favourite URL link via one of the Messaging accounts.
- 5 Tabs.** Tap to add a new browsing tab or switch to another existing browsing tab.
- 6 Home.** Tap to go to the Home page.
- 7 Menu.** Tap to open a list where you can change Opera Mobile settings, check downloads, view History, and more.
- 8 Close tab.** Tap to close the current tab. This is only enabled if you have more than one tab opened.
- 9 Exit Full Screen mode.** When browsing the web, Opera Mobile automatically switches to Full screen mode. Tap to show the address and Menu bars again.

## To open Opera Mobile

On the Home screen, slide to the **Internet** tab and then tap **Browser**.

### To go to a web site

1. On the Opera Mobile screen, tap the address bar.
2. Enter the URL address and tap 

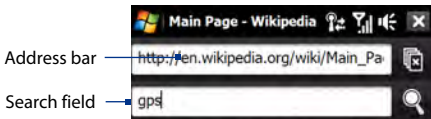

**Tip** When you tap the address bar, a search field also appears. Quickly search the web by entering the search item and tapping 

## View web pages

While browsing web pages, use finger gestures to pan and zoom on the web page. To zoom in, tap your finger twice on the screen. To zoom out, tap your finger twice on the screen again.

**Tip** Touch and hold an empty area on a web page to open a shortcut menu that lets you go back to the previous page, reload the page, add the page as a Favourite, and more. You can also tap and hold a link or image on a web page to open a menu with different options.



## To change the screen orientation

Change the screen orientation by simply turning your device sideways.



## Opera Mobile menu

On the menu bar, tap  to open the menu.



Tap to open the Settings screen where you can set the default home page, change display settings, set privacy settings, and more.

Tap to view items being downloaded. You can also resume or stop current downloads.

Tap to view information about the Web page you are browsing.

Tap to see web pages that you have viewed.

Tap to manage and view web pages that you have saved.

Tap to open the Opera Mobile help file.

Tap to close Opera Mobile completely. Opera Mobile will not run in the background.

**Note:** For more information about using Opera Mobile, go to:  
<http://www.opera.com/products/mobile/>

## 8.4 Using YouTube™

YouTube™ lets you browse, search, and watch video clips from the YouTube server.

**Note** You need an active connection to use YouTube. If you are using a GPRS/3G connection, your data connection bill may increase significantly due to large file sizes of the videos.

### To open YouTube

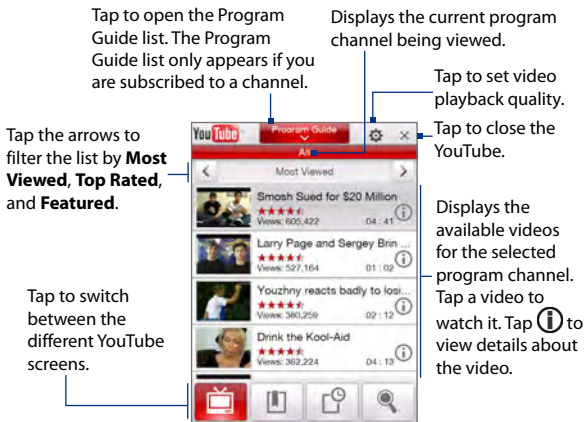

Tap **Start > Programs > YouTube**.





### Browse for videos

The Program Guide list lets you change the program channel so you can browse different types of videos available on the YouTube server. By default, there is only one channel in the Program Guide.

### To add a new program channel into the Program Guide list

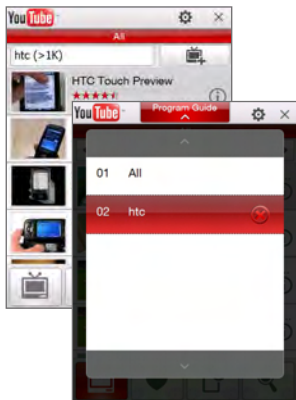
1. On the YouTube screen, tap .
2. On the **Search** screen, enter the channel you want to add to the Program Guide list.
3. Tap **Search**. YouTube searches for the channel and then displays the available videos from it.
4. Tap  and then on the confirmation screen, tap **OK**. The channel you just subscribed to will now be shown when you tap **Program Guide**.



**Tip** You can also add a YouTube user as a program channel. To add, tap  in any of the YouTube screens and then tap .

### To change the program channel

1. On the **Videos** screen, tap **Program Guide** at the top of the screen.
2. On the Program Guide list, select a channel.
3. The video list refreshes to display the available videos for the newly selected channel.

### To delete a program channel from the Program Guide list

You can only delete program channels that you have added to the Program Guide list.

1. On the **Videos** screen, tap **Program Guide**.
2. Scroll down to the channel you want to delete and then tap .
3. On the confirmation screen, tap **Yes**.

## Watching videos

On the Videos, Bookmarks, or History screen, tap a video to launch the YouTube Video Player.

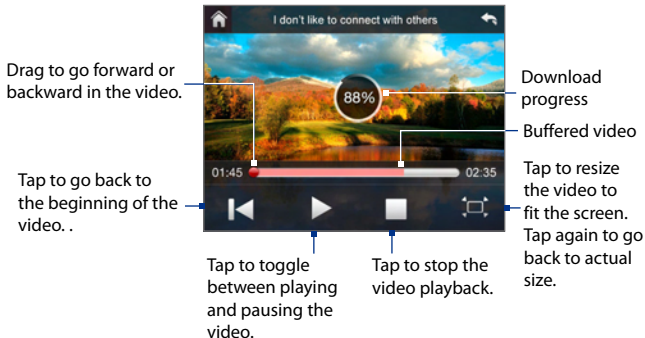

**Tip** To adjust the volume, press the **VOLUME CONTROLS** on the side of the device.

## Navigation Control

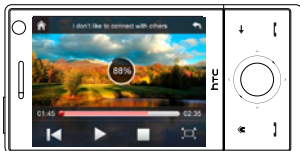

This control	Does this
ENTER	Toggle between playing and pausing video playback.
NAVIGATION RIGHT (Landscape orientation)	Press and hold to go forward in the video.
NAVIGATION LEFT (Landscape orientation)	Press and hold to go back in the video
VOLUME BUTTONS	Press to adjust the volume.

When you tap **Stop** (□) or finish watching the entire video, you are presented with options on what you can do next.

Tap to go back to the previous page of related videos.

Tap to send the link to the video you just watched to another person using one of the Messaging accounts.

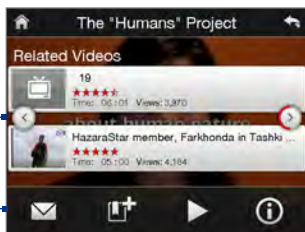

Tap to add the video to your Bookmarks.

Tap to play back the video again.

Tap to go to the next page of related videos. If no action is taken, it automatically goes to the next page after 10 seconds. Tap to view details about the video you just watched.

## Bookmarks



You can store frequently viewed videos into Bookmarks for quick access.

### To view Bookmarks

On the YouTube screen, tap . Tap a video to watch it.

### To add a video into Bookmarks

Do one of the following:

- After watching a video, tap .
- On the list of videos, tap  on the video you want to add to Bookmarks and then tap **Bookmark**.

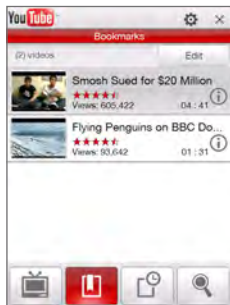

### To delete a video from Bookmarks

1. On the **Bookmarks** screen, tap **Edit**.
2. Tap  on the video you want to remove from Bookmarks.
3. On the confirmation screen, tap **Yes**.
4. Tap **Done**.



## History

View recently watched videos on the History screen.

### To view History

On the YouTube screen, tap . Tap a video to watch it.

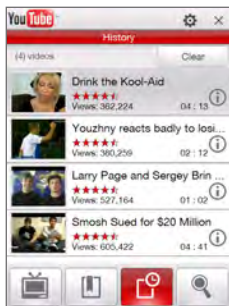

**Note** To clear the History list, tap **Clear**.

## 8.5 Using Streaming Media

**Streaming Media** lets you stream live broadcasts or on-demand media content from the web. The media is sent in a continuous stream to your device and is played as it arrives, along with the audio.

The Streaming Media program allows you to play **3GP** and **MPEG-4** files. It also supports playback of **SDP** (Session Description Protocol) files.

### To access streaming content via Opera Mobile

In Opera Mobile, you can open a web page containing RTSP (Real Time Streaming Protocol) links to streaming media content then play the content in the Streaming Media program.

1. On the Home screen, slide to the **Internet** tab and tap **Browser**.
2. In the address bar, enter the URL address of the web page that contains the RTSP link to the desired \*.3gp, \*.mp4, or \*.sdp file.

3. On the web page, tap the RTSP link.
4. Streaming Media then automatically opens and starts playing the file. During playback, use the button controls to play/pause, switch to full screen, rewind, and fast forward.

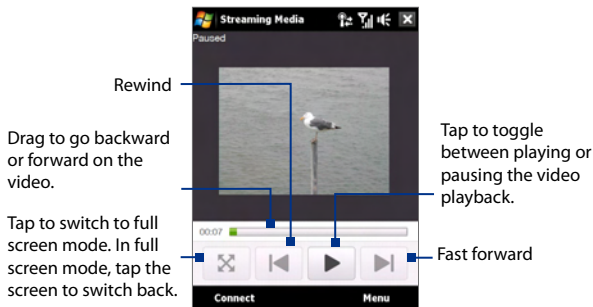

### To stream media files directly on the Streaming Media Player

Streaming Media only supports RTSP links when you stream \*.3gp and \*.mp4 files directly on the program.

**Note** Before you launch the Streaming Media program, make sure that you are connected to the Internet.

1. Tap **Start > Programs > Streaming Media**.
2. From the program, tap **Connect**.
3. Enter the URL for the web site (rtsp://) and the file name.
4. Tap **Connect**.
5. Streaming Media then starts playing the file. During playback, use the button controls to play/pause, switch to full screen, rewind, and fast forward.

### To view streaming video information

Tap **Menu > Properties** to view the properties and general information of a streaming video clip, such as video codec, audio codec, dimension, frames, and duration of the video.

### To configure streaming video connection settings

Tap **Menu > Options** to configure the following settings:

- **Connect via.** Choose whether you want to connect to the Internet or corporate network (intranet) to locate a streaming video clip.
- **UDP port range.** Specify a range of port numbers to use for streaming.
- **Media buffer.** Specify the memory space (in terms of duration) to allot for storing video and audio data while streaming media.

## 8.6 Using Windows Live™

**Windows Live™** gives you a full Internet experience on your device. Windows Live™ helps you to find information, pursue your interests, and get in touch with friends and family on the Internet easier.

Windows Live™ offers the following key features:

- **Live Search Bar**, which lets you search for information on the web.
- **Live Messenger**, the next generation of MSN Messenger Mobile.
- **Live Mail**, the next generation of Hotmail.
- **Live Contacts**, your address book for storing Live Mail, Live Messenger and Hotmail contacts.

### Set up Windows Live™

The first time you use Windows Live™, sign in using your Windows Live™ ID, which is your Windows Live™ Mail or Hotmail address, and password.

#### To set up Windows Live™ for the first time

1. Tap **Start > Programs > Windows Live** and then tap **Sign in to Windows Live.**
2. Tap the links to read the Windows Live™ Term of Use and the Microsoft Privacy Statement. After reviewing them, tap **Accept.**

3. Enter your Windows Live™ Mail or Hotmail address and password, select the **Save password** checkbox, then tap **Next**.
4. Tap **Next**.
5. Choose what information you want to sync online with your device.

If you select **Store Windows Live contacts in your mobile phone's contact list**, your Windows Live™ contacts will be added to the contact list and to Windows Live™ Messenger on your device.

If you select **Sync e-mail**, your Windows Live™ Mail or Hotmail inbox messages will be downloaded to your device.

6. Tap **Next**.
7. After synchronization is complete, tap **Done**.

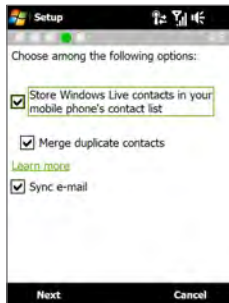

## The Windows Live™ interface

On the Windows Live™ main screen, you will see a search bar, navigation buttons, and an area where you can show and customize your profile.

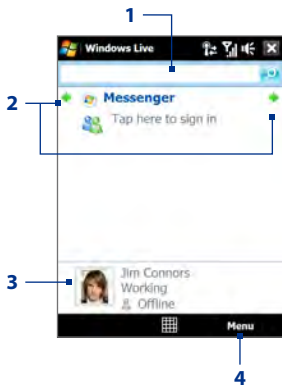

- 1 Search bar
- 2 Navigation buttons. Tap the left or right arrow to switch between Windows Live™ Messenger, Windows Live™ Mail, and Sync status.
- 3 Tap to change the display name, picture, or personal message.
- 4 Tap **Menu** to access and change settings.

## Windows Live™ Messenger

With this mobile version of **Windows Live™ Messenger**, you enjoy many of the same cool features that you get from the desktop version, which include the following:

- Instant messaging via text and voice
- Multiple conversations
- Insert emoticons
- Contact list with presence
- Send and receive files including photos
- Change status/display name
- View contacts by online status, groups, and more
- Send messages even when a contact is offline

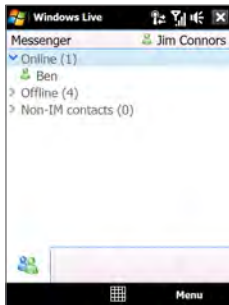

**Note** Before you can use Windows Live™ Messenger, your device must be connected to the Internet. For information about setting up an Internet connection, see “Ways of Connecting to the Internet” in this chapter.

## Launch Messenger and sign in

### To open Windows Live™ Messenger

Do one of the following:

- Tap **Start > Programs > Messenger**.
- On the Windows Live™ main screen, tap the left or right arrow until you see **Messenger**, then tap it.

### To sign in and out

1. Tap **Sign in** on the Messenger screen.
2. If this is your first time to sign in, a message appears to inform you that your messenger contacts will be added to the contact list on your device. Tap **OK** to add them.

Signing in may take several minutes, depending on your connection speed.

3. To sign out, tap **Menu > Sign Out**.

### To start and end conversations

1. In the contact list, select a contact, then tap **Send IM** to open a message screen.
2. Enter your text message in the text entry area of the message screen.
3. To add an emoticon, tap **Menu > Add emoticon** then tap an icon from the list.
4. Tap **Send**.
5. To end a conversation with the current contact, tap **Menu > End conversation**.

- Tips**
- To send a file, tap **Menu > Send**. You can choose to send a picture, voice clip or any file.
  - To invite one or more contacts to the conversation, tap **Menu > Options > Add participant**.
  - To send a voice message, tap Voice Clip on a message screen then start talking. After you have recorded a message, tap **Send**.

### Add Windows Live™ contacts

You can add new Windows Live™ contacts in Windows Live™ Messenger or in Contacts.

#### To add a Windows Live™ contact in Live Messenger

1. Tap **Menu > Add new contact**.
2. Enter the e-mail address of the contact, then tap **OK**.

#### To add a Windows Live™ contact in Contacts

1. On the Home screen, slide to the **People** tab and then tap **All People**.
2. Tap **New**, then tap **Windows Live**.
3. In the **IM** box, enter the e-mail address of the contact, which can be a Windows Live ID or any other e-mail address.

**Tip** You can fill in other information about the contact, if desired. This is not necessary if you will communicate with the contact only through Windows Live™ Messenger or Live Mail.

4. Tap **OK**.
5. Follow the remaining instructions to add the new contact to your Windows Live™ contact list.

## 8.7 Using Your Device as a Modem (Internet Sharing)

**Internet Sharing** connects your desktop or notebook computer to the Internet by using your device's data connection (GPRS or EDGE, for instance). You can choose to connect via USB or Bluetooth.

- Notes**
- Make sure your device has a SIM card installed, and your device has a GPRS/3G or phone dial-up modem connection. If your device has not been set up with a data connection yet, tap **Menu > Connection Settings** on the Internet Sharing screen. For more information about setting up these connections, see "GPRS/3G" and "Dial-up" in this chapter.
  - If you want to use a USB cable connection, you must first install Windows Mobile Device Center or Microsoft ActiveSync version 4.5 or later on the computer.
  - If you want to use a Bluetooth connection, make sure your computer has built-in Bluetooth capability. If your computer does not have Bluetooth, you can connect and use a Bluetooth adapter or dongle.
  - Before using Internet Sharing, disconnect from Windows Mobile Device Center or ActiveSync on your computer.

### To set up your device as a USB modem

1. On your device, tap **Start > Programs > Internet Sharing**.
2. In the **PC Connection** list, select **USB**.
3. In the **Network Connection** list, select the name of the connection that your device uses to connect to the Internet.
4. Connect your device to the computer using the USB cable.
5. Tap **Connect**.



### To use your device as a Bluetooth modem

For the computer to use the Internet connection of your device, activate Internet Sharing on your device, then set up a Bluetooth Personal Area Network (PAN) between the computer and your device.

1. On your device, turn on Bluetooth and set it to visible mode by following the steps in “To turn Bluetooth on and make your device visible” section in Chapter 9.
2. Initiate a Bluetooth partnership from your device by following the steps in “To create a Bluetooth partnership”
3. Tap **Start > Programs > Internet Sharing**.
4. Select **Bluetooth PAN** as the **PC Connection**.
5. From the **Network Connection** list, select the name of the connection that your device uses to connect to the Internet.
6. Tap **Connect**.
7. On your computer, set up a Bluetooth Personal Area Network (PAN) with your device:

**For Windows Vista:**

- a. Click **Start > Control Panel > Network and Internet > Network and Sharing Center**.
- b. Click **Manage network connections** and then under **Personal Area Network**, double-click **Bluetooth Network Connection**.
- c. In the Bluetooth Personal Area Network Devices dialog box, select your device, then click **Connect**.

**For Windows XP:**

- a. Tap **Start > Control Panel > Network Connections**.
- b. Under **Personal Area Network**, click the **Bluetooth Network Connection** icon.
- c. Under **Network Tasks**, click **View Bluetooth network devices**.
- d. In the Bluetooth Personal Area Network Devices dialog box, select your device, then click **Connect**.

**Note** If the Bluetooth adapter or dongle on your computer was installed using a third-party provided driver, open the Bluetooth software that came with the Bluetooth adapter/dongle to connect your computer and device via Bluetooth. Refer to the Bluetooth adapter/dongle documentation for more information.

8. On the Internet Sharing screen on your device, check if a connected status message is displayed, which indicates that your computer has



been successfully connected to the Internet using your device as a Bluetooth modem.

### To end the Internet connection

On the Internet Sharing screen, tap **Disconnect**.

## 8.8 Using RSS Hub

**RSS Hub** is an RSS reader that keeps you up-to-date with the latest news from the Internet. It monitors Internet news channels and downloads the most current news updates and podcasts so you are instantly informed of breaking news and events.

For more information and tips on using RSS Hub, see Help on your device.

**Note** Make sure you have an active Internet connection (such as EDGE or GPRS) before using RSS Hub.

### Subscribe to and organize news channels

You must subscribe to news channels before you can receive RSS feeds.

#### To subscribe to news channels

1. Tap **Start > Programs > RSS Hub**, then tap **Continue**.
2. In the New Channel Wizard screen, select the **Choose from a list of known Channels** option, then tap **Next**. A list of RSS channels is displayed.

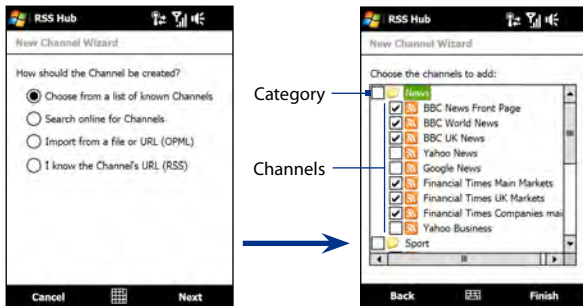

Tap to load pre-selected RSS channels.

**Note** If the RSS channel you want to subscribe to is not in the list of known channels, tap **Back**, then select another option on the **New Channel Wizard** screen. For more information on these other options, see the **Help** on your device.

3. Select the checkboxes of the RSS channels you want to subscribe to, then tap **Finish**.

**Tip** Channels are grouped by categories. If you want to select all channels in a category, select the category check box.

4. The channel list appears. Tap **Refresh** to update the channels.

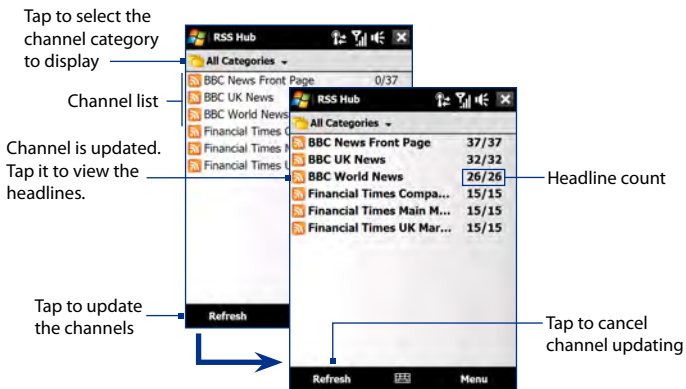

### To add new channels

1. In the channel list, tap **Menu > Channel > New** to open the **New Channel Wizard** screen.
2. Select an option, then follow screen instructions to add new channels. For more information on **New Channel Wizard** options, see **Help** on your device.

### To filter the channels in the display

In the channel list, tap **Menu > View**, then select:

- **Updated** to display only those channels with unread headlines.
- **All** to display all subscribed channels.

## Manage channel categories

To view all the channels in a particular category, tap **All Categories** in the upper left area of the channel list, then tap the category you want to display.

To add a new category, tap **Menu > Categories** in the channel list to display all categories, then tap **Menu > New**.

To rename or delete a category, tap **Menu > Categories** in the channel list to display all categories, select a category, then tap **Menu > Rename** or **Menu > Delete**.

If you want to change the channel category, tap and hold the channel in the channel list, then tap **Change Category**. Select a new category and tap **OK**.

## View and organize headlines

Tap a channel in the channel list to display the headlines for that channel.

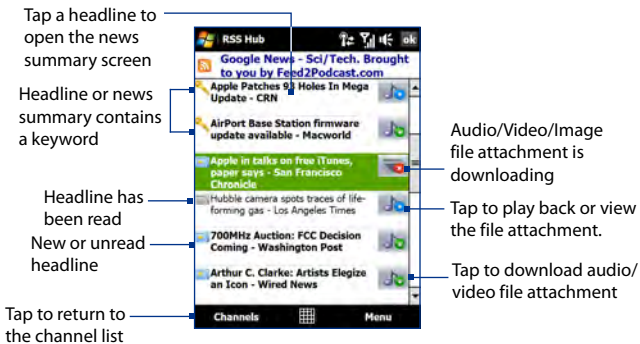

New or unread headlines display in bold and are marked with a blue newspaper icon. Headlines that have been read are marked with a gray newspaper icon.

## View the news summary

Tap a headline in the headline list to display the news summary.

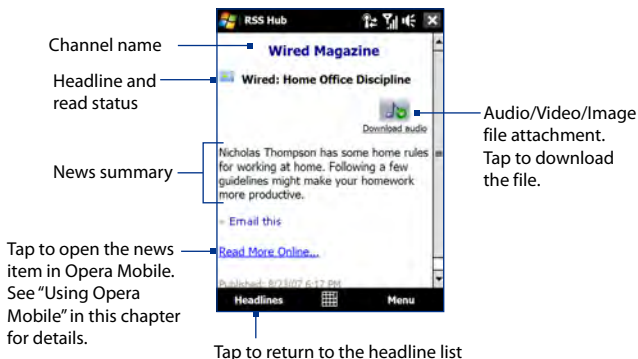

## To change view options

In the news summary screen, tap **Menu** to change the text size, fit the text to the screen (text wrap), or enable **ClearType** for better viewing.

## To download, play, or save podcasts

1. When you see an audio or video file attachment in the news summary, do one of the following to download the file:

- Tap **Menu > Podcasts > Start Download**.
- Tap the **Download audio/Download video** link below the audio/video file icon.

**Tip** To cancel the file download, tap **Menu > Podcasts > Cancel Download**, or tap **Cancel download** below the audio/video file icon.



2. After downloading the file, do one of the following:
  - Tap **Menu > Podcasts > Play** or tap **Play audio/Play video** below the audio/video file icon to play back the file.
  - Tap **Menu > Podcast > Save** to save a copy of the file to the device main memory or internal storage.

#### To send the headline link via e-mail

1. In the news summary screen, tap **Menu > Send Link via Email**.
2. Messaging opens and displays the Account Picker screen. Tap the e-mail account you want to use to send the headline link.  
A new e-mail message is then created with the headline link.
3. Specify the e-mail recipients, then send it.

**Note** For more information on how to compose e-mails, see “Using E-mail” in Chapter 6.

#### To view the next or previous news summary

In the news summary screen, tap **Menu > Next** or **Menu > Previous**, or press NAVIGATION left or right.

For more information about the features and configuring RSS Hub, refer to the online help. To open the online help, tap **Start > Help** while in RSS Hub.



# Chapter 9

## Bluetooth

**9.1 Bluetooth Modes**

**9.2 Bluetooth Partnerships**

**9.3 Connecting a Bluetooth Hands-free or  
Stereo Headset**

**9.4 Beaming Information Using Bluetooth**

**9.5 Bluetooth Explorer and Bluetooth  
File Sharing**

**9.6 Printing Files via Bluetooth**

## 9.1 Bluetooth Modes

Bluetooth is a short-range wireless communications technology. Devices with Bluetooth capabilities can exchange information over a distance of about eight meters without requiring a physical connection.

Bluetooth on your device operates in three different modes:

- **On.** Bluetooth is turned on. Your device can detect other Bluetooth-enabled devices, but not vice versa.
- **Visible.** Bluetooth is turned on, and all other Bluetooth-enabled devices can detect your device.
- **Off.** Bluetooth is turned off. In this mode, you can neither send nor receive information using Bluetooth.

- Notes**
- By default, Bluetooth is turned off. If you turn it on, then turn off your device, Bluetooth also turns off. When you turn on your device again, Bluetooth automatically turns on.
  - Turn off Bluetooth when not in use to conserve battery power, or in places where using a wireless device is prohibited, such as on board an aircraft and in hospitals.

### To turn Bluetooth on and make your device visible

1. On the Home screen, slide to the **Settings** tab and then tap **Menu > Bluetooth Devices > Mode** tab.
2. Select the **Turn on Bluetooth** and **Make this device visible to other devices** check boxes.
3. Tap **OK**. The Title bar will show  to indicate that the device is in Visible mode.

### To turn off Bluetooth visibility after a certain period of time

You can automatically turn off Bluetooth visibility after a specified period of time.

1. On the Home screen, slide to the **Settings** tab and then tap **Menu > Bluetooth Devices > Timeout** tab.
2. In **Turn off Visible mode**, select the time before your device's Bluetooth visibility turns off. Tap **OK**.



## 9.2 Bluetooth Partnerships

A Bluetooth partnership is a relationship that you create between your device and another Bluetooth-enabled device in order to exchange information in a secure manner.

### To create a Bluetooth partnership

1. On the Home screen, slide to the **Settings** tab and then tap **Menu > Bluetooth Devices > Devices** tab.
2. Tap **Add new device**. Your device displays the names of other Bluetooth devices within range.
3. Tap the device name in the box, then tap **Next**.
4. Specify a passcode to establish a secure connection. The passcode can be 1 up to 16 characters.
5. Tap **Next**.
6. Wait for the paired device to accept the partnership. The receiving party needs to enter the same passcode that you specified.
7. The name of the paired device is then displayed. You may edit and enter a new name for that device.
8. Select the check boxes of services that you want to use from the paired device, then tap **Finish**.

**Note** Creating a Bluetooth partnership between two devices is a one-time process. Once a partnership is created, the devices can recognize the partnership and exchange information without entering a passcode again.

### To accept a Bluetooth partnership

1. Ensure that Bluetooth is turned on and in visible mode.
2. Tap **Yes** when prompted to establish a partnership with the other device.
3. Enter a passcode (the same passcode that is entered on the device requesting the partnership) to establish a secure connection. The passcode must be between 1 and 16 characters.
4. Tap **Next**.
5. Tap **Finish**. You can now exchange information with the paired device.

- Tips**
- To rename a Bluetooth partnership, tap and hold the partnership's name on the **Devices** tab of the Bluetooth screen, then tap **Edit**.
  - To delete a Bluetooth partnership, tap and hold the partnership's name on the **Devices** tab, then tap **Delete**.

## 9.3 Connecting a Bluetooth Hands-free or Stereo Headset

For hands-free phone conversations, you can use a Bluetooth hands-free headset such as a car kit with your device. Your device also supports A2DP (Advanced Audio Distribution Profile) which allows you to use a Bluetooth stereo headset for hands-free phone conversations and for listening to stereo music.

### To connect a Bluetooth hands-free or stereo headset

1. Make sure that both your device and the Bluetooth headset are turned on and within close range, and that the headset is visible. Refer to the manufacturer's documentation to find out how to set the headset in visible mode.
2. On the Home screen, slide to the **Settings** tab and then tap **Menu > Bluetooth Devices > Devices** tab > **Add new device**.
3. Tap the name of the Bluetooth headset, then tap **Next**. The device will automatically pair the device with the Bluetooth headset.

Windows Mobile will automatically try one of the preconfigured passcodes (0000, 1111, 8888, 1234) to pair the Bluetooth headset with the device. If this fails, you have to enter the passcode delivered with your headset manually.

- Note** If the Bluetooth stereo headset becomes disconnected, turn the headset on and repeat step 1 to 2 above. Tap and hold the name of the Bluetooth stereo headset and tap **Set as Wireless Stereo**.

## 9.4 Beaming Information Using Bluetooth

You can beam information, such as contacts, calendar items, tasks, and files from your device to your computer or to another Bluetooth-enabled device.

**Note** If your computer does not have built-in Bluetooth capability, you need to connect and use a Bluetooth adapter or dongle on your computer.

### To beam information from your device to a computer

1. Turn on Bluetooth on your device, and make your device visible. For information about this, see “To turn Bluetooth on and make your device visible”.
2. Set Bluetooth on your computer to visible mode, create a Bluetooth partnership, then enable your computer to receive Bluetooth beams.

**Note** If the Bluetooth adapter or dongle on your computer was installed using a third-party provided driver, open the Bluetooth software that came with the Bluetooth adapter/dongle and enable the adapter/dongle to be discovered by other devices. Refer to the Bluetooth adapter’s documentation for more information.

If your computer has **Windows Vista** or **Windows XP SP2** and your computer’s Bluetooth adapter is supported by your Windows version, do the following steps:

- a. On your computer, open **Bluetooth Devices** from the Control Panel, then click the **Options** tab on the **Bluetooth Devices** window.
- b. For **Windows Vista**, select **Allow Bluetooth devices to find this computer**.  
For **Windows XP**, select **Turn discovery on** and **Allow Bluetooth devices to connect to this computer**.
- c. Create a Bluetooth partnership between your device and computer. For information about creating a partnership, see “Bluetooth partnerships”.
- d. In the **Options** tab of **Bluetooth Devices**, select **Show the Bluetooth icon in the notification area**.
- e. To enable your computer to receive Bluetooth beams, right-click the Bluetooth icon  in the notification area at the bottom-right corner of your computer screen and select **Receive a File**. You are now ready to beam.

3. On your device, select an item to beam. The item can be an appointment in your calendar, a task, a contact card, or a file.
4. To beam a contact, tap **Menu > Send Contact > Beam**.  
To beam other types of information, tap **Menu > Beam [type of item]**.
5. Tap the device name to which you want to send the item.
6. If you beamed a calendar, task, or contact item to your computer and it is not automatically added to Outlook, select **File > Import and Export** in Outlook to import it.

To beam information to a Bluetooth-enabled device such as another Windows Mobile-powered device, follow steps 1 to 5 in the above procedure.

- Tips**
- The default folder on your computer where beamed items are stored may be C:\Documents and Settings\your\_username\My Documents in Windows XP or C:\Users\your\_username\My Documents in Windows Vista.
  - For your device to receive Bluetooth beams, tap **Start > Settings > Connections** tab > **Beam** and make sure the **Receive all incoming beams** check box is selected.

## 9.5 Bluetooth Explorer and Bluetooth File Sharing

**Bluetooth Explorer** searches for other Bluetooth devices that have file sharing enabled and lets you access their Bluetooth shared folder. You can copy files from and to their shared folder, and create subfolders in it. When you enable **Bluetooth file sharing** on your device, other Bluetooth-enabled devices will also be able to access your Bluetooth shared folder.

### To enable Bluetooth Explorer and Bluetooth file sharing on your device

1. On the Home screen, slide to the **Settings** tab and then tap **Menu > Bluetooth Devices > FTP** tab.
2. Select the **Enable Bluetooth Explorer** check box. This makes the **\Bluetooth** device folder visible in the File Explorer.

3. Select the **Enable File Sharing** check box.

You can use the default Bluetooth shared folder, or tap **Browse** to use another folder as your shared folder.

4. Tap **OK**.

### To use Bluetooth Explorer

1. Bluetooth Explorer is integrated with the File Explorer program. You can open it by tapping **Start > Programs > Bluetooth Explorer** or by tapping the down arrow (▼) on the upper left of File Explorer screen then tapping **Bluetooth**.

2. Bluetooth Explorer then scans for other Bluetooth devices that have file sharing enabled. From the list, tap to select a Bluetooth device you want to connect to. You may need to enter a passcode in order for you to connect to the selected device.

If there are files contained in the Bluetooth shared folder on the other device, you will be able to see them on the Bluetooth Explorer screen.

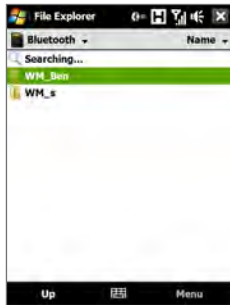

3. Select one or more files, then tap **Menu > Edit** and choose to cut or copy the files.
4. Tap **Up** twice.
5. Navigate to the folder where you want to paste the files on your device, then tap **Menu > Edit > Paste**.

## 9.6 Printing Files via Bluetooth

Connect your device to a Bluetooth printer to print contact information, appointment details, images, and other file types.

**Note** You can print files in the **.txt**, **.jpg**, **.xhtml**, **.vcf**, **.vcs** file formats.

Before you start printing, make sure to turn on the Bluetooth printer and to turn on Bluetooth on your device. To turn on Bluetooth, tap **Start > Programs > Comm Manager**, then tap the **Bluetooth** button.

### To print contact information

1. On the Home screen, slide to the **People** tab and then tap **All People**.
2. Select the contact whose information you want to print.
3. Tap **Menu > Print via Bluetooth > Menu > Search Devices**. Your device starts to search for Bluetooth devices.
4. Select the Bluetooth printer and tap **Menu > Send File**.
5. Set the printing options you want, then tap **Print**.

### To print a calendar appointment

1. Tap **Start > Calendar**, then select (highlight) the appointment whose details you want to print.
2. Follow steps 3 to 5 in the “To print contact information” procedure.

### To print a JPEG file

1. In Pictures & Videos, locate the JPEG file you want to print.
2. Tap and hold the JPEG image file and then on the menu, tap **Print via Bluetooth**.
3. Follow steps 3 to 5 in the “To print contact information” procedure:

### To print a text file

1. In File Explorer, locate the text file you want to print.
2. Tap and hold the txt file and then on the menu, tap **Print via Bluetooth**.
3. Follow steps 3 to 5 in the “To print contact information” procedure:

# Chapter 10

## Navigating on the Road

**10.1 Google™ Maps  
(Available by Country)**

**10.2 Guidelines and Preparation  
for Using GPS**

**10.3 Downloading Satellite Data  
via QuickGPS**

## 10.1 Google™ Maps (Available by Country)

**Google™ Maps** lets you track your current location, view real-time traffic situations, and receive detailed directions to your destination. It also provides a search tool where you can locate places of interest or an address on a vector or a satellite map.

**Note** You need an active data connection or Wi-Fi connection to use Google Maps.

### Open Google Maps

Tap **Start > Programs > Google Maps**.

**Note** The first time you open Google Maps, you will be asked to accept terms and conditions when using Google Maps. You must agree to the terms and conditions for you to be able to run Google Maps.

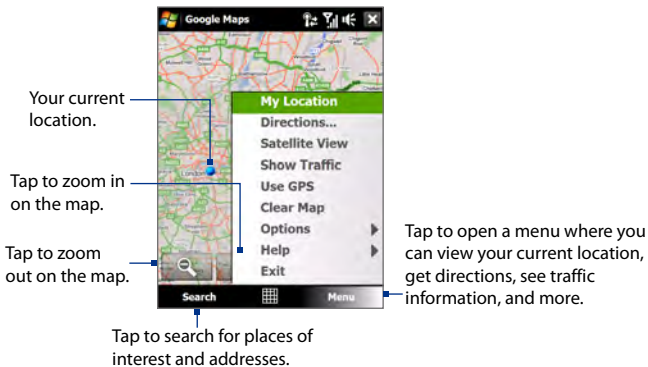

- Notes**
- Currently, traffic information is only available for the U.S.
  - Tap **Menu > Options > Reset Google Maps** to reset the Google Map cookies, history of search terms, preferences, and image cache.
- Tip** Tap **Menu > Help > Tips** to learn more about the program and its many features



## Search for a place of interest

You can search and locate a place of interest using Google Maps. Google Maps also shows the contact information and gives directions on how to get to the place of interest from your current location.

**Note** You can also search for keywords, addresses, and postal codes.

1. On the Google Maps screen, tap **Search**.
2. Enter the place of interest you want to go to (for example, museums in London), then tap **OK**.
3. On the **Search Results** tab, tap an item to view its contact information.

**Note** If the place of interest you want is the first item, just tap the **Address** tab to view the contact information.

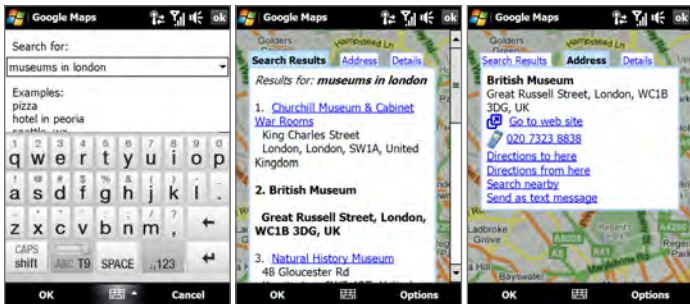

4. On the **Address** tab, you can:
  - Tap **Go to web site** to open the web site of the place of interest.

**Note** This information only appears when the web site of the place of interest is available.

- Tap the [**phone number**] to call the place of interest that you have selected.
- Tap **Directions to here** or **Directions from here** to get directions on how to get to the place of interest from your current location or vice versa.

- Tap **Search nearby** to search for other places of interest near your current location.
- Tap **Send as text message** to send the contact information to a contact saved on your device via SMS.

For more information about Google Maps, go to <http://www.google.com/gmm/index.html>.

## 10.2 Guidelines and Preparation for Using GPS

If you install a GPS software on your device, please follow these guidelines before and when using your device as a GPS device.

- Do not operate the GPS system while driving. The plotted GPS route is only for driving reference. It should not interfere with actual driving behavior.
- When using the device inside a vehicle, use the car holder to mount the device securely in place. Avoid placing the device in the areas shown in the following diagram:

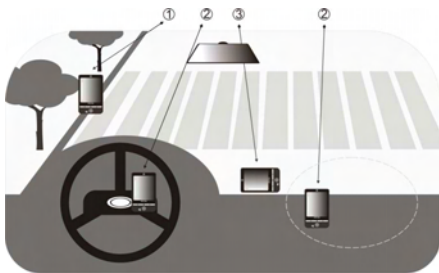

- 1 Do not place where it will block the driver's vision.
- 2 Do not place where air bags could deploy.
- 3 Do not place anywhere in the vehicle without securing the device in the holder.

- Please use the GPS system cautiously. Users shall be liable for any damages resulting from negligent operation of the system.
- The GPS signal cannot pass through solid non-transparent objects. Signal reception may be affected by obstructions such as high-rise buildings, tunnels, bridges, forests, weather (rainy or cloudy days), etc. If the vehicle's visor contains metal, it will be difficult for the GPS signal to pass through.
- Wireless communication products (such as mobile phones or radar-detecting devices) may interfere with the satellite signal, resulting in unstable signal reception.
- The Global Positioning System (GPS) is built and operated by the US Defense Department. The Department is responsible for the accuracy and maintenance of the system. Any changes that the Department makes may affect the accuracy and function of the GPS system.
- Do not leave your device in a vehicle or expose the device to direct sunlight to avoid overheating the battery, which could pose damage to the device or risk to the vehicle.

## 10.3 Downloading Satellite Data via QuickGPS

Before you start using your device for GPS navigation, open the **QuickGPS** program first to download ephemeris data (current satellite position and timing information) onto your device. This data is needed to determine the GPS position of your current location.

QuickGPS downloads ephemeris data from a web server, instead of from the satellites, using the Internet connection on your device, which can be via Wi-Fi, ActiveSync or GPRS/3G. This significantly speeds up the time for determining your GPS position.

### To open QuickGPS

Tap **Start > Programs > QuickGPS**.

### To download data

Tap **Download** on the QuickGPS screen.

On the screen, initially, you will see the **Valid time** of the downloaded data. As time passes, the remaining days and hours of validity will be shown.

To speed up GPS positioning, download the latest ephemeris data when the validity of the data expires.



### Download options

To configure download times, tap **Menu > Options** and choose from the available options:

- Remind me when data expires.**  
Enables your device to display a reminder message when the validity of the ephemeris data has expired.

When you see the reminder message, tap **Menu** to dismiss the reminder or to set the snooze time so that you will be reminded again. Tap **OK** to open the QuickGPS program and download the latest data.
- Autodownload when data expires.** Allows ephemeris data to be automatically updated onto your device when the data has expired.
- Autodownload when connected to PC via ActiveSync.** Allows ephemeris data to be automatically downloaded via ActiveSync to your device when your device is connected to your computer. Your computer must be connected to the Internet in order to download data.

**Note** The ephemeris data is stored on HTC web servers. QuickGPS is preconfigured to connect to these servers.

# Chapter 11

## Experiencing Multimedia

**11.1 Taking Photos and Videos**

**11.2 Viewing Photos and Videos Using Album**

**11.3 Using Windows Media® Player Mobile**

**11.4 Using FM Radio**

**11.5 Using Audio Booster**

**11.6 Using MP3 Trimmer**

## 11.1 Taking Photos and Videos

Use **Camera** to take photos and record video clips. You can either use the main (back) camera or second (front) camera to take photos or shoot videos.

### To open the Camera screen

On the Home screen, slide to the **Photos and Videos** tab and then tap the camera icon (  ). The screen orientation automatically switches to landscape mode when you open Camera.

**Tip** You can also tap **Start > Programs > Camera** to open the Camera program.

### To exit the Camera

Tap the **Exit** icon (  ) on the Camera screen. Tap the screen to show the Camera screen icons.

## Capture modes

The camera on your device allows you to capture pictures and video clips by using various built-in modes that provide you flexibility in taking your shots.





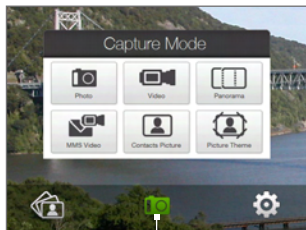

### To change the capture mode

- Press **NAVIGATION** left or right (Landscape orientation).
- Tap the middle icon at the bottom of the screen (the icon displayed is based on the current Capture mode.)  
On the on-screen menu, tap the Capture mode you want to use.



Current Capture mode

You can select from the following capture modes:

Icon	Capture Mode
	<b>Photo</b> Captures standard still images.
	<b>Video</b> Captures video clips, with or without accompanying audio.
	<b>Panorama</b> Captures a sequence of still images continuously in one direction, and allows stitching of all the images to create a panoramic view of a scenery.
	<b>MMS Video</b> Captures video clips suitable for sending with MMS messages.
	<b>Contacts Picture</b> Captures a still image and gives you the option to immediately assign it as a Photo ID for a contact.
	<b>Picture Theme</b> Captures still images and places them within frames.



**Note** When using the second camera to capture, you can only use Photo, Video, MMS Video, Contacts Picture, and Picture Theme modes.

### Supported file formats

Using the available capture modes, the camera in your device captures files in the following formats:

Capture mode	Format
<b>Photo / Contacts Picture / Picture Theme / Panorama</b>	JPEG
<b>Video / MMS Video</b>	H.263 (.3gp) ; MPEG-4 (.mp4)

## Camera controls

The camera comes with an auto-focus function to let you capture sharp and crisp photos and videos of your subjects. Depending on the **Shoot Option** you have chosen, you will need to either touch or press the ENTER button to activate auto-focus. When auto-focus is activated, it is indicated by a flashing white bracket (  ). When focus is set, the bracket changes to a steady green bracket (  ).

**Note** For more information about the different shoot options, see “Advanced Options” in this chapter.

By default, you only need to press the ENTER button once to activate auto-focus and to take the photo or start capturing video. For example, in **Photo** mode, press ENTER to activate auto-focus; when focus is set, Camera automatically takes the shot.



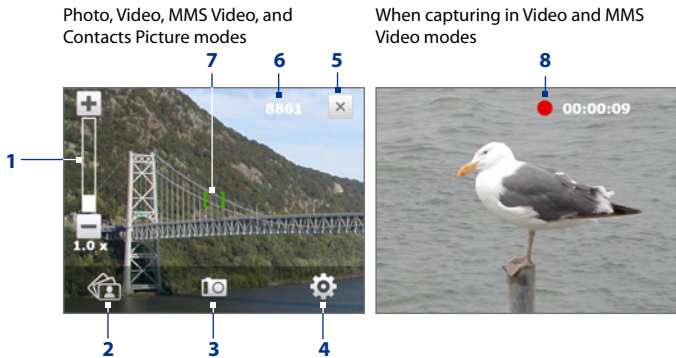

- Notes**
- In **Video** or **MMS Video** mode, press ENTER again to stop recording.
  - In **Picture Theme** or **Panorama** mode, press ENTER for each shot you need to take.

## On-screen controls and indicators

Tap the screen to display the controls and indicators.





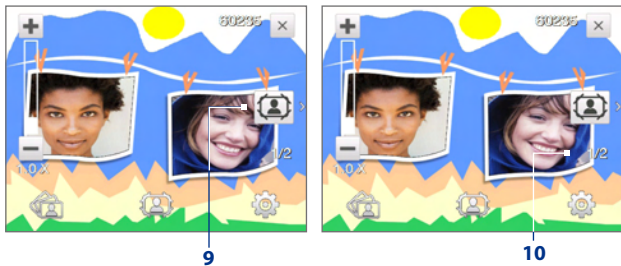

- Zoom control.** Tap  to zoom in, or  to zoom out.  
**Tip** You can also press NAVIGATION up/down (Landscape orientation) or slide your finger clockwise or counterclockwise on the center NAVIGATION CONTROL to zoom in or out.
- Album.** Tap to open Album. See “Viewing Photos and Videos Using Album” for details.
- Capture mode.** Displays the current capture mode. Tap to open an on-screen menu where you can choose the capture mode.
- Menu.** Tap to open the Camera Settings screen. See “Menu Panel” for details.
- Exit.** Tap to exit the Camera program.
- Remaining information indicator.** In Photo, Contacts Picture, Picture Theme, and Panorama modes, this shows the remaining/available shots of pictures based on the current settings.  
 In Video and MMS Video modes, this shows the remaining duration that can be recorded. While recording video, this shows the recorded duration.
- Auto-focus indicator.** Displays a flashing bracket () when focusing. When focus is set, the flashing bracket changes to a steady green bracket ()
- Recording indicator.** Flashes when recording a video.

Picture Theme mode







- 9 Template Selector icon.** In Picture Theme mode, tap to toggle among different templates.
- 10 Progress indicator.** In Picture Theme and Panorama modes, this shows the number of consecutive shots.



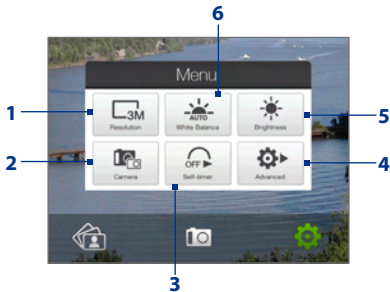



## Menu Panel

The Menu Panel provides a quick way of adjusting most common camera settings and lets you access more advanced camera settings. On the Camera screen, tap  to open the Menu Panel. To adjust a setting, keep tapping a button on the panel, for instance, **Resolution**, to cycle through the available settings. To access advanced options, tap .

**Note** The available settings on the panel depend on the selected Capture mode.



- 1 Resolution.** Tap to change the resolution (capture size). See the table in the following pages for the supported resolutions.
- 2 Camera.** Tap to select the camera to use. You can choose from main camera () , second camera () , and second camera flip () .
- 3 Self-timer.** Tap to set the self-timer to **2 seconds**, **10 seconds**, or **Off** when in the Photo or Contacts Picture mode. When you press the ENTER button to capture a still image, it starts to count down, then captures a still image after the time expires.
- 4 Advanced.** Tap to open the advanced camera settings. See “Advanced Options” for details.

- 5 Brightness.** Tap to open the Brightness bar at the bottom of the screen. On the Brightness bar, tap  to decrease, or  to increase the brightness level. Tap outside the Brightness bar to apply the change.
- 6 White Balance.** White balance enables the camera to capture colors more accurately by adjusting to different lighting conditions. White balance settings include: Auto () , Daylight () , Night () , Incandescent () , and Fluorescent () .

## Zooming

Before capturing a photo or a video clip, you can zoom in to make the object in focus move closer, or zoom out to make the object move farther away.

### To zoom in

Slide your finger around the NAVIGATION CONTROL clockwise, press NAVIGATION up (Landscape orientation), or tap .

### To zoom out

Slide your finger around the NAVIGATION CONTROL counterclockwise, press NAVIGATION down (Landscape orientation), or tap .

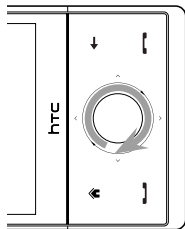



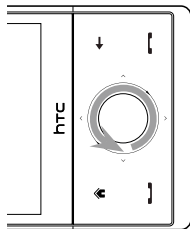









Zoom In



Zoom Out

The camera zoom range for a photo or a video clip depends on the capture mode and resolution. Refer to the table for more information.

Capture mode	Resolution	Zoom range
<b>Photo</b>	 3M 3M (2048 x 1536)	1.0x to 2.0x
	 2M 2M (1600 x 1200)	1.0x to 2.0x
	 1M 1M (1280 x 960)	1.0x to 2.0x
	 L Large (640 x 480)	1.0x to 2.0x
	 M Medium (320 x 240)	1.0x to 4.0x
<b>Video</b>	 CIF CIF (352 x 288)	1x and 1.5x
	 L Large (320 x 240)	1x and 1.5x
	 M Medium (176 x 144)	1x and 1.5x
<b>Panorama</b>	 L Large (640 x 480)	1x and 2x
	 M Medium (320 x 240)	1x, 2x and 4x
<b>MMS Video</b>	 M Medium (176 x 144)	1x and 1.5x
	 S Small (128 x 96)	1x and 1.5x
<b>Contacts Picture</b>	 M Medium (240 x 320)	1.0x to 4.0x
<b>Picture Theme</b>	Determined by the current template	Depends on the size of the selected template



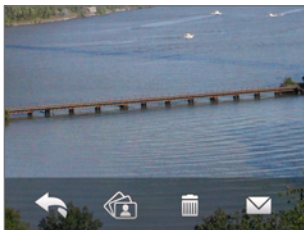

**Note** For capture size settings and zoom ranges when using the second camera, please refer to the online help.

## The Review screen

After capturing, the Review screen lets you view, send, or delete the photo or video clip by tapping an icon at the bottom of the screen.



Review screen icons

Icon	Function
	<b>Back</b> Return to the live Camera screen.
	<b>Delete</b> Delete the captured image or video.
	<b>View</b> View the captured image or video in the Album program.
	<b>Send</b> Send the captured image or video via e-mail or MMS.
	<b>Assign to Contact</b> After capturing in Contacts Picture mode, tap this icon to assign the photo to a selected contact.

## Advanced Options

The Advanced Options let you adjust options for your selected capture mode and set Camera program preferences. Access the Advanced Options by tapping **Advanced** on the Menu Panel.

You can either tap on-screen or press NAVIGATION up/down (Landscape orientation) to navigate through the Advanced Options screen.

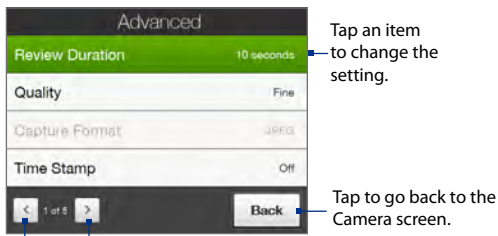

Tap to go through the different Advanced Camera Settings screens.

- **Quality.** Select the JPEG image quality level for all captured still images. Choose from **Basic**, **Normal**, **Fine**, and **Super Fine**.
- **Capture Format.** Select the desired file format.
- **Time Stamp** (Photo mode). Choose whether or not to include the shooting date and time on captured photos.
- **Storage.** Select where you want to save your files. You can either save the files to the main memory or to the internal storage.
- **Keep Backlight.** Turn the backlight on or off. This overrides your device backlight settings while you are using the camera.
- **Shutter Sound.** Choose whether or not you want the camera to make a shutter sound when you press the ENTER button.
- **Shoot Option.** The camera comes with an auto-focus feature that is activated when the ENTER button is either touched or pressed.

- **Touch and Press.** Requires you to touch the ENTER button to activate the auto-focus; when focus is set, press the ENTER button to take the shot.
- **Touch.** Requires you to touch the ENTER button to activate auto-focus; when focus is set, Camera automatically takes the shot.
- **Full Press.** Requires you to press the ENTER button to activate auto-focus; when focus is set, Camera automatically takes the shot.
- **Review Duration.** Set a time length for displaying the captured image/video on the Review screen. Select **No Limit** if you do not want to impose a time limit. Select **No Review** to immediately return to the live Camera screen after capturing and saving.
- **Image Properties.** This option lets you adjust the capture properties, such as **Contrast**, **Saturation**, and **Sharpness**.

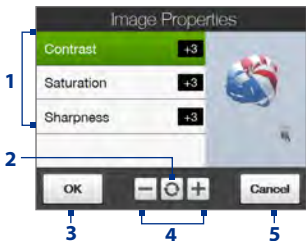

- 1 Tap a property to adjust.
- 2 Tap to reset all properties to their default values.
- 3 Tap to save the settings.
- 4 Tap  $\oplus$  /  $\ominus$  or press NAVIGATION left/right (Landscape orientation) to increase/decrease the value.
- 5 Tap to close the submenu without applying and saving the changes.

- **Effect.** Choose a special effect such as Grayscale, Sepia, or others, to apply to your photos or video clips.
- **Metering Mode.** Select a metering mode to allow the camera to measure the amount of light and calculate the best-fit exposure value before capturing. Choose either **Center Area** to measure light using the center area of the subject, or **Average** to measure light using the area around the subject.
- **Prefix.** When **Default** is selected as the prefix, the file name of each new captured file is set to "IMAGE" or "VIDEO" followed by a sequential

number, for example: IMAGE\_001.jpg. You may also choose to name files using either the current **Date** or **Date & Time** as the prefix.

- **Counter.** To reset the file naming counter back to 1, tap **Reset**.
- **Flicker Adjustment.** When taking indoor shots, flicker on the camera screen may be caused by inconsistencies between the vertical scan rate of the camera display and the flicker frequency of fluorescent lighting. To reduce flicker, you can change the flicker adjustment setting to **Auto** or to the proper frequency (**50Hz** or **60Hz**) of the power in the country where your device is being used.
- **Grid** (Photo mode). Choose whether or not to show a grid on the Camera screen. Showing a grid helps you frame and center your subject easily and accurately.
- **Record with Audio** (Video and MMS Video mode). Select **On** to record audio with the captured video clips, or select **Off** to capture video without audio.
- **Template** (Picture Theme mode). Select a template.
- **Recording Limit** (Video mode). Set the maximum duration or file size for recording video.
- **Template Folder** (Picture Theme mode). By default, templates are stored in the **\My Documents\Templates** folder on the device's **Main Memory**. If you transferred some templates to the internal storage (via File Explorer), set this option to **Main + Card** to specify that templates are located in both the main memory and the internal storage.
- **Show Reminder** (Contacts Picture mode). Select **On** if you want the Camera to always display a message that confirms whether or not to assign the captured picture to a contact.
- **Help.** Tap to open the Camera program help file.
- **About.** Tap to display version and copyright information.

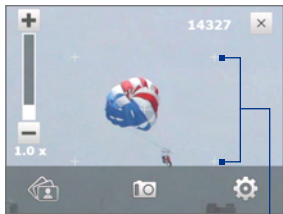

Grid marks



## 11.2 Viewing Photos and Videos Using Album

Use **Album** to view images and videos in your device. Album offers a host of features that let you rotate images, view your images as a slideshow, use images as contact pictures, and more.

**Note** Album can only display files in the BMP, GIF, PNG, JPG, Animated GIF, 3GP, MP4, and WMV formats.

### To open Album

Do one of the following:

- On the Home screen, slide to the **Photos and Videos** tab and tap **Album**.
- In the Camera program, tap .
- Tap **Start > Programs > Album**.

**Note** When you open Album from the Camera program, the screen orientation of Album is switched to landscape mode.

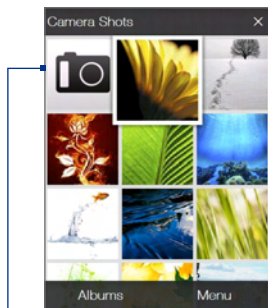

Tap to open the Camera program.

### Select a photo or video to view

1. On the main Album screen, tap **Albums** and then select the album to view. The contents of the album are then displayed on the main Album screen.
2. Browse through the files by sliding your finger upward or downward.
3. Do one of the following:
  - Tap an image to view it in full screen mode. See “View an image” for details.
  - Tap a video file (files with the  icon) to play back the video file. See “Play back video” in this chapter for details.

- Select a still image and then tap **Menu > Slideshow** to view the images in the album as a slideshow. Animated GIF and video files will not be played back in the slideshow. See “To view still images as a slideshow” in this chapter for details.

## View an image

While viewing an image in full screen, tap the screen or press ENTER to open the on-screen menu.

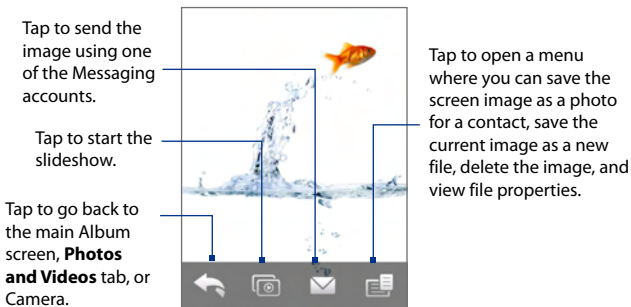

**Tip** You can delete multiple files at once by selecting **Menu > Delete Items** on the main Album screen and then selecting the files to delete.

## To rotate the image

While viewing images, you can automatically rotate the image by simply turning your device sideways.



### To view the next or previous image

When viewing images in Portrait or Landscape mode, go to the next image by swiping your finger across the screen from right to left. Go back to the previous image by swiping your finger from left to right.

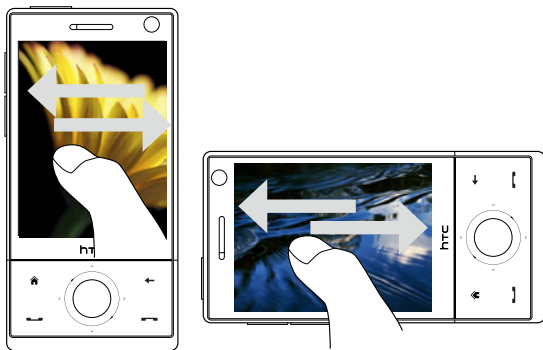

### To zoom in or out of an image

While viewing an image, make a full circle motion on the screen with your finger.

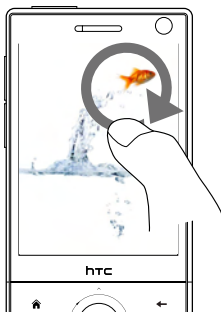

Slide your finger clockwise on an area to zoom in on that area.



Slide your finger counter-clockwise to zoom out.

- Tips**
- When you zoom in on an image, double tap the screen to automatically zoom out and fit the image to the screen.
  - When you zoom in on an image, tap and hold the screen so you can pan the image.
  - You can also zoom in and out of the image by sliding your finger around the NAVIGATION CONTROL clockwise/counterclockwise.
  - When you zoom in on an image, tap the screen to open the on-screen menu. On the on-screen menu, tap  and then select **Save Screen Image** to save the image on-screen as a new file.

### To view still images as a slideshow

While viewing the slideshow, tap the screen to show playback controls.

**Note** The screen orientation automatically switches to landscape mode when viewing a slideshow.

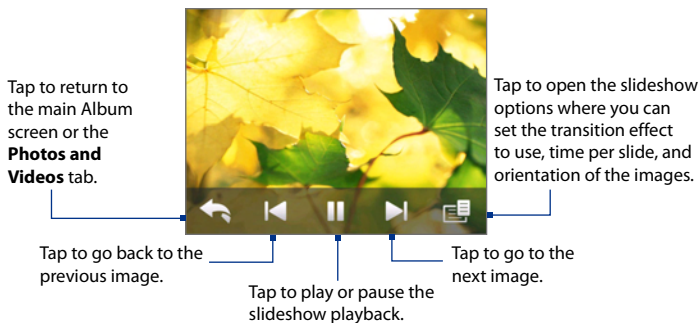

**Tip** If the images are in your favourite album, you can start the slideshow from the **Photos and Videos** tab on the Home screen. On the Photos and Video tab, tap **Slideshow**.

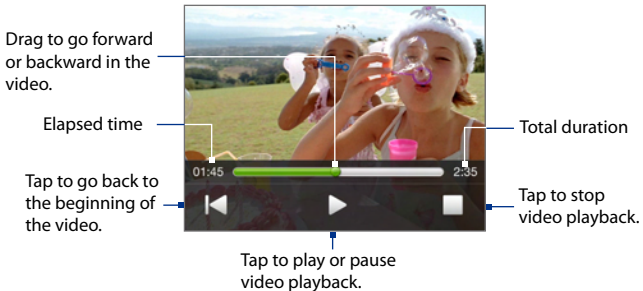

## Play back video

While playing back video, tap the screen to show the playback controls.



**Tip** If the video is in your favourite album, you can start the video playback from the **Photos and Videos** tab on the Home screen. On the Photos and Video tab, tap **Play**.

## Close Album

Close Album by tapping  on the main Album screen. When viewing files in full screen mode, tap the screen to show the on-screen menu or playback controls and then tap  to go back to the main Album screen.

## 11.3 Using Windows Media® Player Mobile

**Windows Media® Player Mobile** plays digital audio and video files that are stored on your device or on a network, such as on a web site.

Video File Formats Supported	File Extensions
Windows Media Video	.wmv, .asf
MPEG4 Simple Profile	.mp4
H.263	.3gp, .3g2
H.264	.mp4, .3gp, .3g2, .m4v
Motion JPEG	.avi

Audio File Formats Supported	File Extensions
Windows Media Audio	.wma
WAVE	.wav
MP3	.mp3
MIDI and SP MIDI	.mid, .midi, .rmi
AMR Narrow Band	.amr, .3gp
AMR Wide Band	.awb, .3gp
AAC, AAC+, and eAAC+	.aac, .mp4, .m4a, .3gp
MPEG4 audio	.m4a
QCELP	.qcp, .3g2
EVRC	.qcp

### To open Windows Media® Player Mobile

Tap **Start** > **Programs** > **Windows Media**.

### About the controls

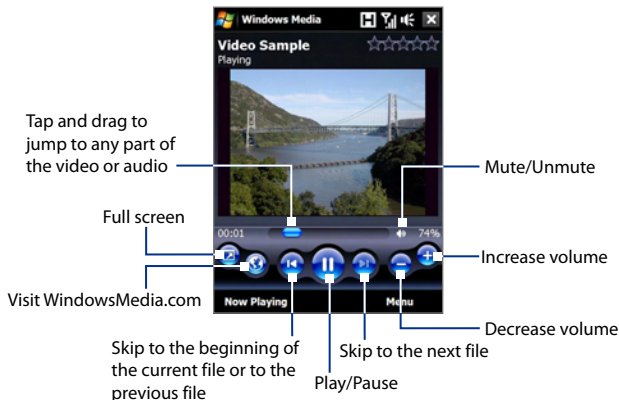

## About the screens and menus

Windows Media® Player Mobile has three primary screens:

- **Playback screen.** The screen that displays the playback controls (such as Play, Pause, Next, Previous, and Volume) and the video window. You can change the appearance of this screen by choosing a different skin.
- **Now Playing screen.** The screen that displays the Now Playing playlist. This special playlist indicates the current file being played and any files that are “queued up” to play next.
- **Library screen.** The screen that lets you quickly find your audio files, video files, and playlists. It contains categories such as My Music, My Videos, My TV, and My Playlists.

At the bottom of each screen, you can open a **Menu**. The commands on this menu vary, depending on which screen you are viewing. For more information about the commands in these menus, see Help on your device.

## Synchronize video and audio files

Use the latest version of Windows Media® Player on your computer to synchronize digital media files from your computer to your device. This ensures that protected files and album art (for skins) are copied to your device correctly.

### To synchronize content to your device automatically

1. On your computer, open Windows Media® Player, then connect your device to your computer.
2. In the Device Setup Wizard, select **Yes, search my computer now**.  
**Note** If you have previously opened Windows Media® Player and searched for media on your computer, you will not be prompted to search your computer in Step 2.
3. On the Device Setup dialog box, enter a name for your device and click **Finish**. Windows Media starts synchronizing the music files in the PC with the device.
4. Click **Stop Sync** and then on the left panel of Windows Media® Player, right-click the name of your device and click **Set Up Sync**.

5. Select the playlist(s) that you want to sync between your computer and device, then click **Add**.

**Note** On the Device Setup dialog box, make sure that the **Sync this device automatically** check box is selected.

6. Click **Finish**.

The files will begin synchronizing to your device. The next time you connect your device to your computer while Windows Media® Player is running, synchronization will start automatically.

### To synchronize content manually to your device

1. If you have not set up media synchronization between your device and computer, follow steps 1 to 3 in “To synchronize content to your device automatically”.
2. Click the **Sync** tab on the Windows Media® Player of your computer. Select a Playlist or a Library on the left panel of the Windows Media® Player.
3. From the Content List, drag the media files that you want to sync to your device and drop them to the Sync List.



4. Click **Start Sync** to start synchronizing the selected files to your device.



- Notes**
- Use Windows Media® Player 11 or higher on your computer to synchronize media files to your device.
  - Audio files copy faster if Windows Media® Player is configured to automatically set the quality level for audio files copied to your device. For more information, see the Windows Media® Player Help.

## Play media

Use the Library to find and play songs, videos, and playlists that are stored on your device or internal storage.

### To update the Library

1. If you are not on the Library screen, tap **Menu > Library**.
2. On the Library screen, tap the Library arrow (near the top of the screen), then tap the media storage that you want use, for example, internal storage.
3. In most cases, Windows Media® Player Mobile automatically updates the library. However, you can manually update the library to ensure that it contains new files that you recently copied to your device or internal storage. Tap **Menu > Update Library** to manually update the library list.

### To play video and audio files on your device

1. Select a category (for example, My Music or My Playlists).
2. Tap and hold the item that you want to play (such as a song, album, or artist name), then tap **Play**.

- Tips**
- To play a media file that is stored on your device but is not in a library, on the Library screen, tap **Menu > Open File**. Tap and hold the item that you want to play (such as a file or a folder), then tap **Play**.
  - To play a media file from the Internet or a network server, tap **Menu > Library** then tap **Menu > Open URL**.

## Playlists

In Windows Media® Player Mobile, you can create a new playlist by saving the current Now Playing playlist and giving it a new name.

### To save a new playlist

1. If you are not on the Library screen, tap **Menu > Library**.
2. Tap to select a category (for example, My Music or My Playlists).
3. Select a media file that you want, then tap **Menu > Queue Up**. This adds the file to the Now Playing list.

Repeat this step until you have added all desired media files to the Now Playing list.

**Note** You cannot select multiple files simultaneously.

4. After adding the media files, tap **Menu > Now Playing**.
5. On the Now Playing screen, tap **Menu > Save Playlist**.
6. Enter the playlist name, then tap **Done**.
7. To play back the playlist you created, tap My Playlists in the Library, select your playlist, then tap **Play**.

## Troubleshooting

If you encounter a problem while using the Windows Media® Player Mobile, a number of resources are available to help you troubleshoot the issue.

For more information, see the Troubleshooting Windows Media® Player Mobile page at the Microsoft web site (<http://www.microsoft.com/windows/windowsmedia/player/windowsmobile/troubleshooting.aspx>).



## 11.4 Using FM Radio

**FM Radio** allows you to listen to FM radio stations on your device. Since FM Radio uses the provided stereo wired headset as an antenna, you must plug in the headset first onto the earphone jack of your device before you open the program.

### To open FM Radio





Tap **Start > Programs > FM Radio**.





The first time this program is used, it will automatically scan for available FM channels in your area, save them as presets, then play the first FM station found. For information about saving favourite stations as presets, see “Save presets.”

When you tap  on the FM Radio screen, the program continues to run in the background and allows you to continue listening to the radio while you use other programs. To turn off the FM radio, tap  on the upper right corner of the FM Radio screen.

## FM Radio controls

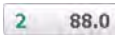

This control	Does this
1 	Turns off FM radio.
2 	See “Radio display” for details.
3 	Searches the FM band for the next higher FM channel.
4 	Increases the radio frequency by 0.1MHz.
5 	Turns the sound on or off.

This control	Does this
6 	Allows you to save up to six favourite FM stations as presets. Tap a button to tune in to a favourite station.
7 	Switches between headset and speaker output.
8 Stereo/Mono	Allows you to switch between Mono and Stereo modes.
9 	Decreases the radio frequency by 0.1MHz.
10 	Searches the FM band for the next lower FM channel.

**Tip** Tap **Menu** to choose more options for FM Radio, such as **Scan & Save** to perform a rescan of the FM band for available FM stations and save them as presets, and more.

### Radio display

- Shows the station name when the RDS (Radio Data System) or RDBS (Radio Data Broadcast System) signal is available.
- Shows the preset number when you select a preset FM station.
- Shows the received signal strength.
- Shows the radio frequency.



## Device controls used in FM Radio

### Navigation

- Press NAVIGATION left/right to search the FM band for the next lower/higher FM channel. When the search reaches the last station, it cycles back to the beginning of the FM band.
- Press NAVIGATION up/down to select the previous/next available preset station.
- Press the ENTER button to toggle mute on and off.

## Volume Control

Press the VOLUME CONTROL on the side of the device to adjust the FM Radio volume.

## Save presets

Presets are favourite FM stations that you can save for easy access. You can save up to six FM stations to the preset buttons on the main FM Radio screen, or save up to 20 presets on the Presets screen.

### To save FM stations

1. Tune to the desired FM frequency, then tap **Presets**.
2. On the Presets screen, tap  that appears on the desired preset number where you want to save the FM station.

You can save up to 20 preset radio stations. Radio stations that are saved on Presets 1 to 6 can be accessed on the main FM Radio screen.

**Tip** Tap  to remove a favourite FM station from the list.

3. When done, tap **OK**.

### To listen to a preset FM station

Do one of the following:

- On the main FM Radio screen, tap the preset button that shows your favourite station.
- On the Preset screen, select a preset number that shows your favourite station, then tap **Listen**.

## FM Radio Main Menu

Tap **Menu** on the FM Radio screen to access options for the FM Radio program.

- **Scan & Save** Automatically scan radio stations that can be picked up by the device and save them as presets. Existing presets will be cleared and replaced with the newly scanned radio stations. You can have a maximum of 20 preset radio stations.
- **Stereo** Toggles between using Stereo or Mono mode when listening to an FM radio station.
- **Mute** Toggles between muting and restoring the volume.

- **Output** Select whether to use the device **Speaker** or **Wired Headset** to listen to the radio.
- **Sleep** Set how much time must pass before FM Radio goes into sleep mode. The Sleep option is switched to **Off** every time you launch FM Radio.
- **Exit** Select to turn off FM Radio.

## 11.5 Using Audio Booster

**Audio Booster** optimizes sound for a better listening experience. It provides preset moods, such as hip hop, jazz, rock, etc., and several enhancement presets that suit different types of music.

### To access Audio Booster

Tap **Start > Programs > Audio Booster**.

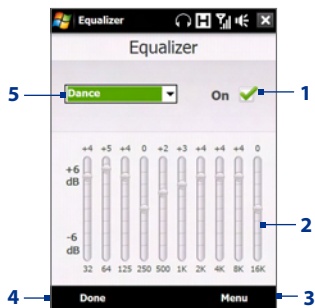

This control	Does this
1 <b>On</b>	Select the check box to enable or disable the equalizer.
2 <b>Frequency band</b>	Drag the sliders to adjust the frequency.
3 <b>Menu</b>	<ul style="list-style-type: none"> <li>• Tap <b>Menu &gt; Cancel</b> to exit Audio Booster without applying the modified settings:</li> <li>• Tap <b>Menu &gt; Save as Preset</b> or <b>Delete Preset</b> to save or delete preset equalizer settings.</li> </ul>
4 <b>Done</b>	Tap to apply the modified settings.
5 <b>Equalizer presets</b>	Tap to choose the Equalizer preset to use.

**To use a Equalizer preset**

Tap the list box then select a desired preset.

**To create a custom equalizer preset**

1. Adjust the frequency bands to your desired values by dragging the equalizer controls. The selected values are indicated on top of the sliders.
2. Save your equalizer settings as a preset by tapping **Menu > Save as Preset**.
3. Enter a preset name and then tap **Done**. The preset you created will be added to the list box.

**To delete a custom equalizer preset**

1. Tap the list box then select the Equalizer preset you want to delete.
2. Tap **Menu > Delete Preset**.

**Note** You can only delete custom equalizer presets. Equalizer presets that are pre-installed cannot be deleted.

## 11.6 Using MP3 Trimmer

Use **MP3 Trimmer** to trim MP3 files. You can choose to save it as a new file or set it as a ring tone.

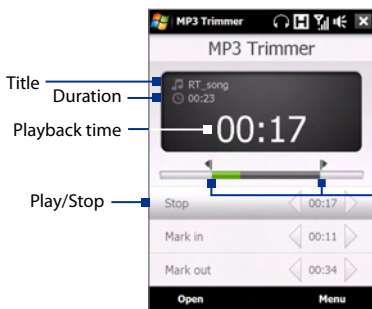
**Mark in / Mark out points**

Mark the part of the music that will be used as the ring tone. Drag the left handle to mark the start time (mark-in point), then drag the right handle to mark the end time (mark-out point).

**Mark in / Mark out**

For more precise marking, you can also tap these controls to step backward/forward one step and mark it.

### To trim the MP3 file

1. Tap **Start > Programs > MP3 Trimmer**.
2. Tap **Open** to find the MP3 file in the device.
3. On the MP3 Trimmer screen, use the stylus to adjust the **Mark in point** and **Mark out point**.

After you set the Mark in point, the song will play back starting from the Mark in point.

After you set the Mark out point, the song will play back starting from 5 seconds before the Mark out point.

4. Tap **Play** to play back the trimmed song.
5. Tap **Menu** and select to whether set the file as the default ring tone, save the file to the ring tone folder, or save it using another file name.

**Tip** If you only want to save the song to the ring tone folder for future use, tap **Save to Ring Tone Folder**. Later on, you can tap **Start > Settings > Personal tab > Phone** to set it as your ring tone.



# Chapter 12

## Programs

**12.1 Programs on your Device**

**12.2 Adding and Removing Programs**

**12.3 Adobe® Reader® LE**

**12.4 Calendar**

**12.5 Contacts**

**12.6 Comm Manager**

**12.7 Microsoft® Office Mobile**

**12.8 Notes**

**12.9 Java**

**12.10 SIM Manager**

**12.11 Spb GPRS Monitor (Available by Country)**

**12.12 Sprite Backup**

**12.13 Tasks**

**12.14 Voice Recorder**











**12.15 Voice Speed Dial**

**12.16 ZIP**

## 12.1 Programs on your Device

The following are programs you can find on your device or install from the Applications disc.

### Programs in the Start Menu

Icon	Description
	<b>Office Mobile</b> Use the complete suite of Microsoft® Office applications for your mobile device.
	<b>Excel Mobile</b> Create new workbooks or view and edit Excel workbooks.
	<b>OneNote Mobile</b> Create notes with text, photos, and voice recordings.
	<b>PowerPoint Mobile</b> View PowerPoint slides and presentations.
	<b>Word Mobile</b> Create, view, and edit Word documents.
	<b>Calendar</b> Keep track of your appointments and create meeting requests.
	<b>Contacts</b> Keep track of your friends and colleagues.
	<b>Internet Explorer Mobile</b> Browse web and WAP sites as well as download new programs and files from the Internet.
	<b>Messaging</b> Send and receive e-mail, MMS, and text messages.
	<b>Phone</b> Make and receive calls, switch between calls, and set up conference calling. See Chapter 2 for details.
	<b>Help</b> See Help topics for the current screen or program.