



Specification No. AEC_MCB_160316_01

Messrs : Mobile Compia

Approval Sheet for Product Specification

Issued Date : June. 23. 2004

Product Description : SMD Type Chip Antenna

Customer Part No. :

AUTO Part No. : AEC MCB 001

Date :	
Company :	Mobile Compia.
Dept. :	
Approved by (Signature)	Choi Ki Moon.
(Type)	

The duplicate of this specification shall be returned to us with your authorized signature. Unless it reaches us by July. 30, 2004 it shall be mutually understood that this specifications have been duly approved by you.

Technical Dept.

Prepared by

Hong Sung Ok (Signature)
(Type)

Approved by

(Signature)
(Type)

Manager

Product Engineering Section
Antenna Products Department
Auto Electronic Corp.

(Company name/Dept.)

AUTO ELECTRONIC CORP.

Specification Sheet

Object	Chip Antenna	REV.	3.0	Page	1 of 6
Model Name	AEC_MCB_001	Date		Jun. 23, 2004	
System	Bluetooth Module	Written by		S.O.Hong	

Electrical Specification

Frequency	2.4 ~ 2.485(GHz)
Bandwidth	200(MHz)
V.S.W.R	1.9:1(max)
Gain (max)	0(dBi)
Input Impedance	50(Ω)
Polarization	Linear

Mechanical Specifications

Size	16×3×1.6(mm)
Weight	0.22(g)
Radiator Material	Copper
Operation Temperature	-30 ~ 30($^{\circ}$ C)
Operation Humidity	10 ~ 30(%)

Option	
Others	

1. Dimension

- 16mm(L)×3(W)×1.6(H)

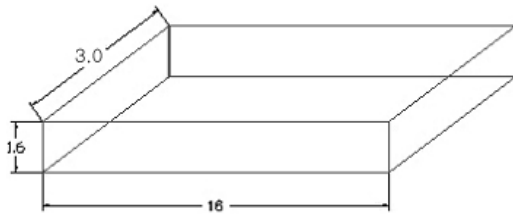

Dimension



Bottom land pattern

- * The chip antenna is required to be used on our suggested PCB.

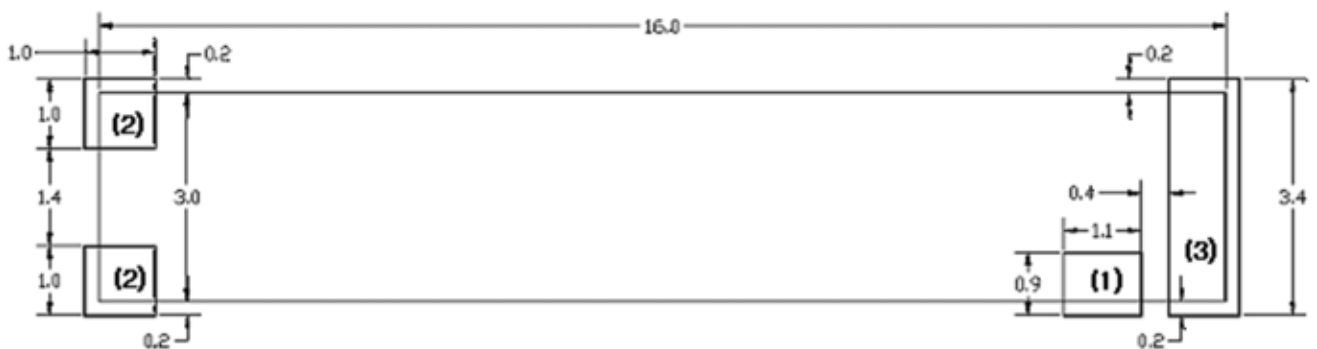

- (1) Feed point
- (2) NC(Mount points)
- (3) GND

2. Characteristic

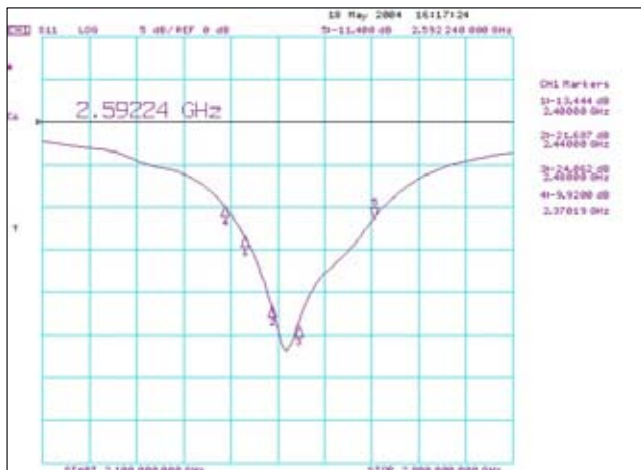

< Tuning Ant. : AEC_IJM_004-S11 >

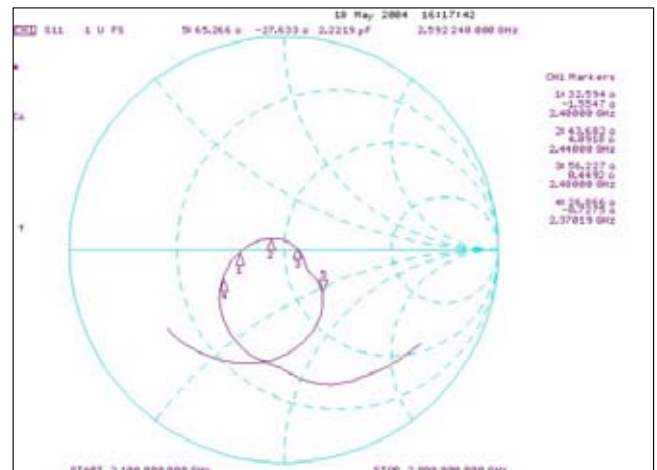

< Tuning Ant. : AEC_IJM_004-Smith Chart >



< Tuning Ant. : AEC_IJM_004-VSWR >

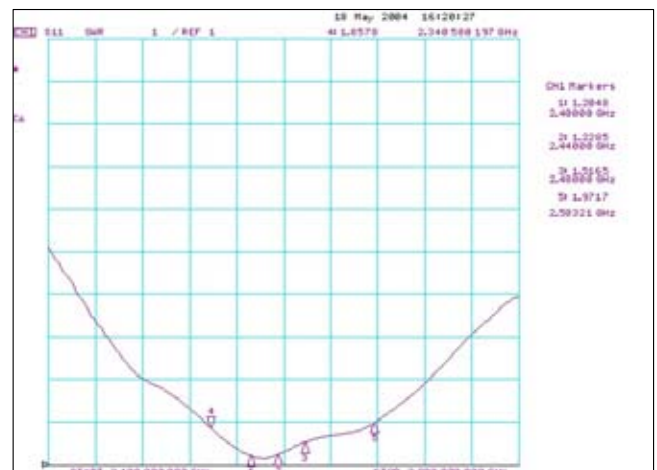

< Tuning Ant. : AEC_IJM_004-Smith Chart >
< PDA >

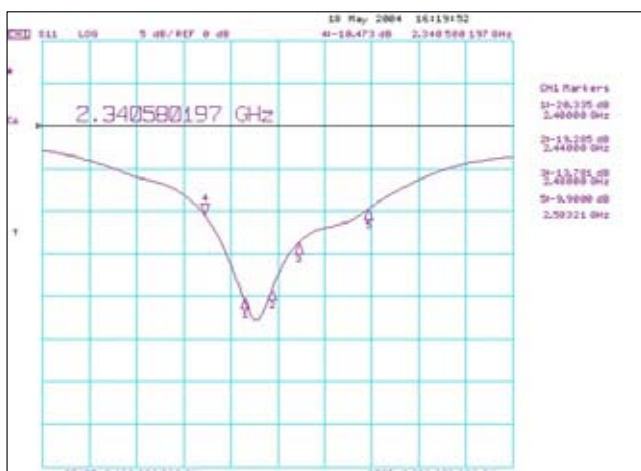

< Tuning Ant. : AEC_IJM_004-S11 >
< PDA >

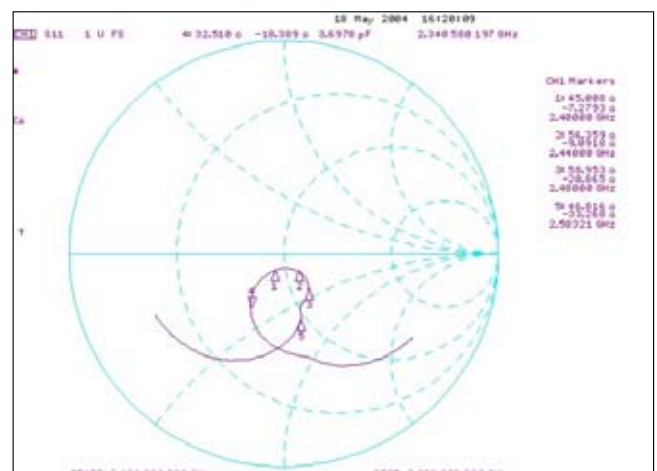

< Tuning Ant. : AEC_IJM_004-Smith Chart >
< PDA >

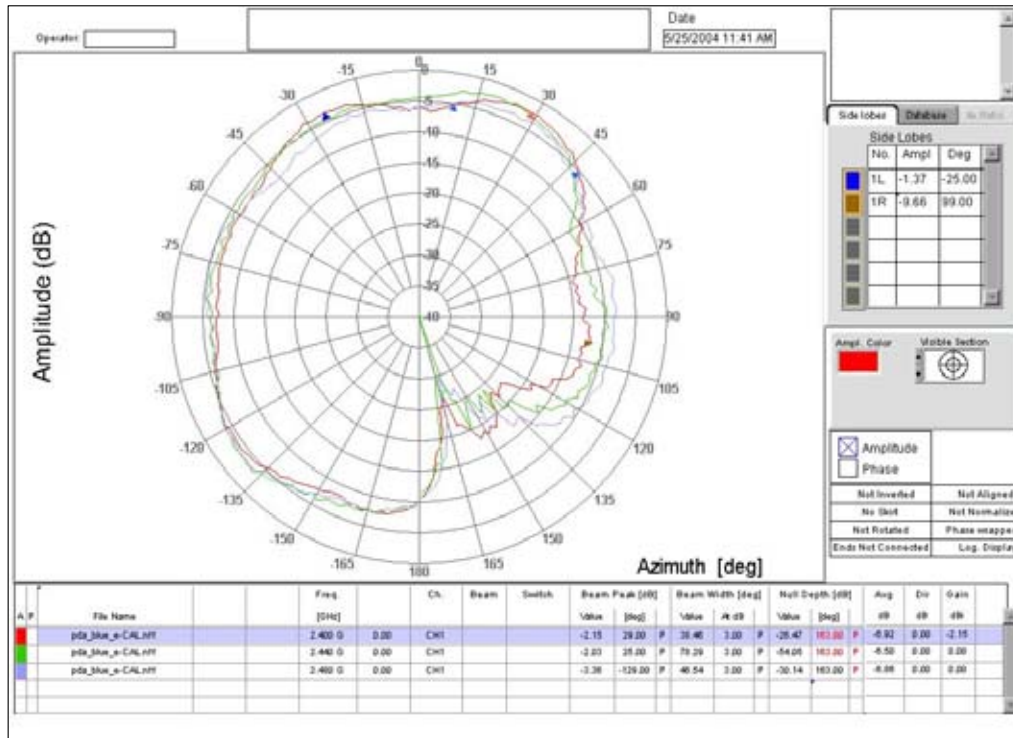

< AEC_MCB_001 : E-Plane >

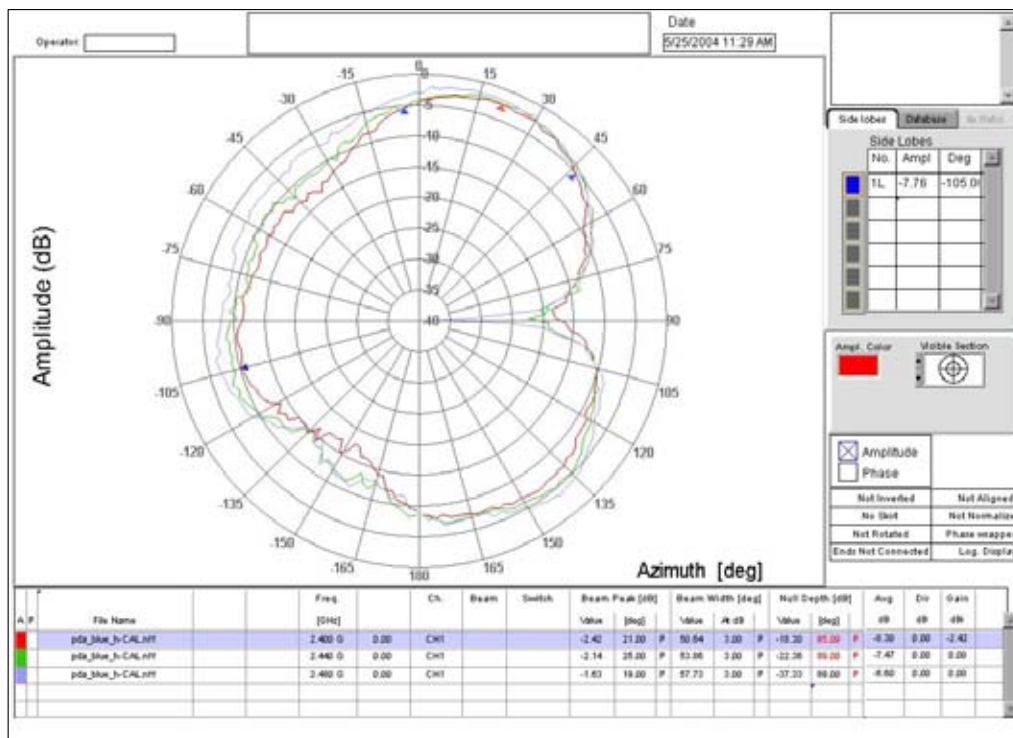

< AEC_MCB_001 : H-Plane >

2. Taping

• Dimension of Tape (Plastic Case)

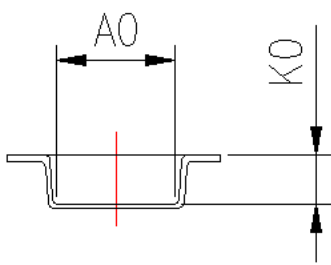
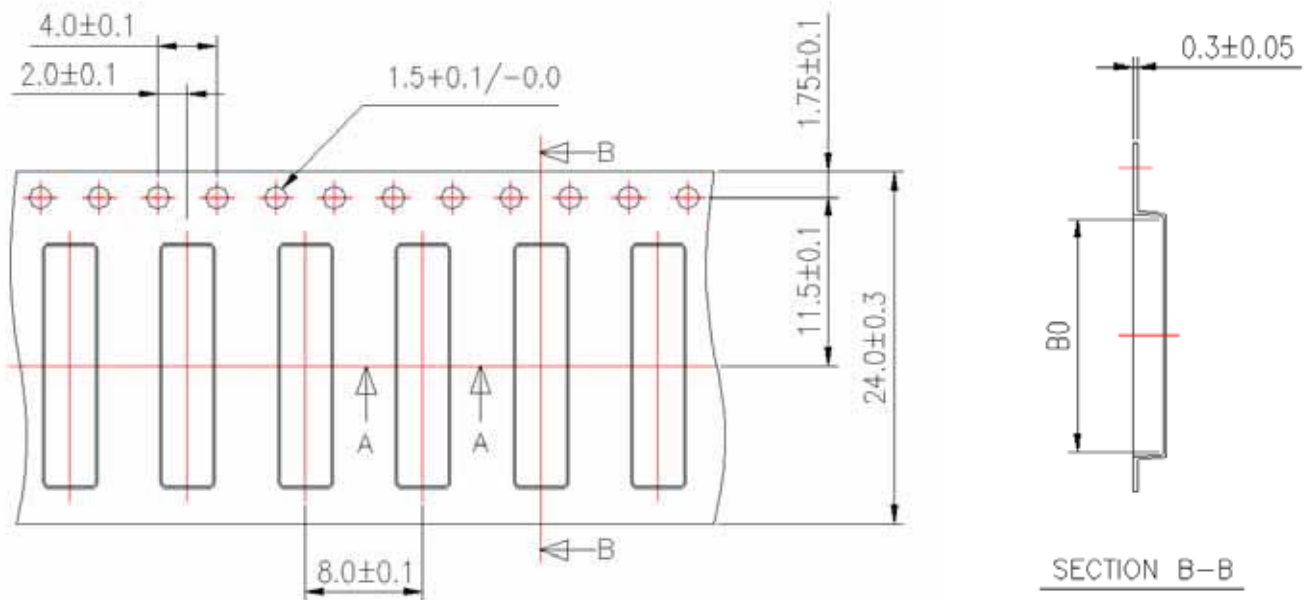

SECTION A-A

주]

1. 지시없는 라운딩 Max R0.5

2. 빠짐기울기 Max 5°

A0 : 3.40 ± 0.10

B0 : 16.40 ± 0.10

K0 : 2.10 ± 0.10

• Dimension of Reel (Plastic Reel)

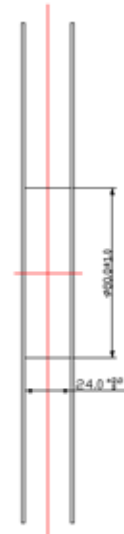
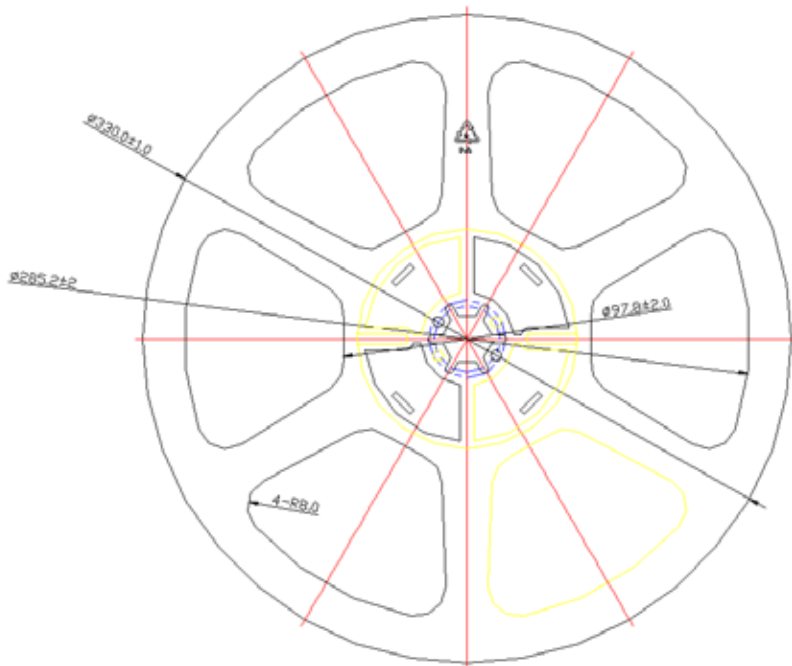

주)
 1. 지시없는 공차는 0.5
 2. 표면저항 : $10^{-3} \sim 10^{12} \Omega$

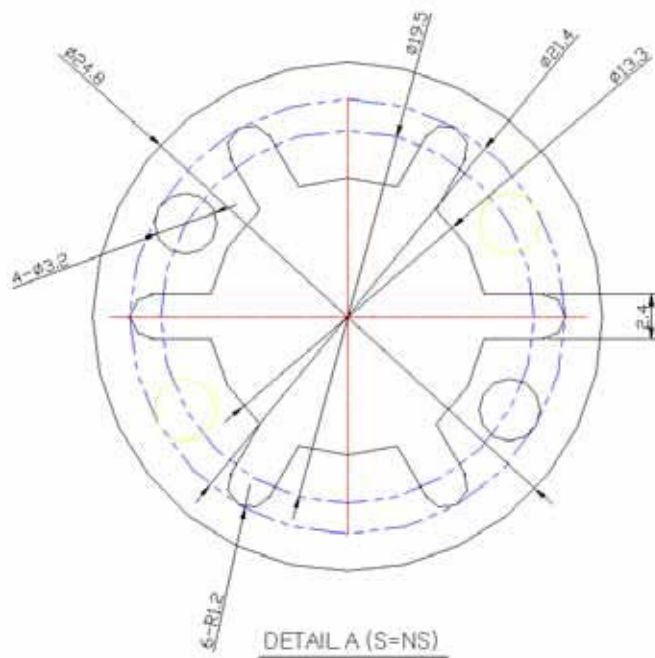



TC25

ANT1

AEC_MCB_001

HANA
HBM2X1M
C3M730F
P6060285

TC4

U5

R26

C23

TP1

1R5

C7

C11

R41

R23

TC10

U1

U6

D10

B115

U10

U20

R21

R28

R29

R30

R31

K