

# APPS Power R9P627 Near Field Control Timer Strip MANUAL (iOS)



V1.3

# **TABLE OF CONTENTS**

<b>1.....INTRODUCTION.....</b>	<b>3</b>
<b>2.....Hardware FEATURES.....</b>	<b>4</b>
<b>3.....App installation and setting .....</b>	<b>5</b>
<b>4.....Operation Guide .....</b>	<b>8</b>
<b>4.1 Basic Control .....</b>	<b>8</b>
<b>4.2 Near Field Control.....</b>	<b>9</b>
<b>4.3 Schedule Timer .....</b>	<b>10</b>
4.3.1 Add New Timer .....	11
4.3.2 Edit Timer.....	12
<b>4.4 Setting.....</b>	<b>12</b>
4.4.1 Device Name .....	12
4.4.2 Setting Password .....	13

# 1 INTRODUCTION

APPS Power is a perfect product for smart home concept and power management idea, without complex setup and operation, home automation becomes convenient for everyone.

You don't need to kneel down to find your device and set the timer. Timer setting can be easily completed on the devices in few steps. Simple and clever schedule timer helps you turn off appliances to save energy and money.

Following are three major aspects

## 1. Convenience -

Base on the wireless technology of Bluetooth, when you enter the place where APPS Power is equipped, you can easily control the electronic appliance "ON" and "OFF" without the need finding the power switch or even unplug from wall outlet, means power can be "ON" and "OFF" automatically in few seconds.

## 2. Smart home automation is highly integrated with friendly UI.

You can use the APPS Power Bluetooth feature on your smart phone / tablet device, by guiding form our friendly user interface

## 3. Multi-function timer to reduce to cost of your home electricity bill

Another advance function in our APPS Power is the multi-function timer, consumer can scheduling the timer setup on their smart phone device and turn on or off the power of the outlet.

In addition, with integrating NFCControl (Near Field Control) technology, you can also trigger device by follow the "Master"/"Slave" scenario, which is when you (Master) near the APPS Power, Slave outlet will be power "ON", when you leave the APPS Power, the APPS Power "OFF".

## 2 Hardware FEATURES

Bluetooth SMART STRIP	
●	Electrical rating: 15A, 120VAC, 60Hz, 1800 Watts
●	Always on Outlet : 1
●	NFControl Outlet : 3
●	Timer Outlet : 2
●	AC power surge protection (1080J)
●	Bluetooth : Bluetooth 3.0 EDR compliant
●	App Support OS : iOS 5.0 or higher
●	Near Field Control (NFControl) Function
●	Wireless Range : 10 Meter in open space
●	Multi-Function Timer : Weekly/Daily/Hourly

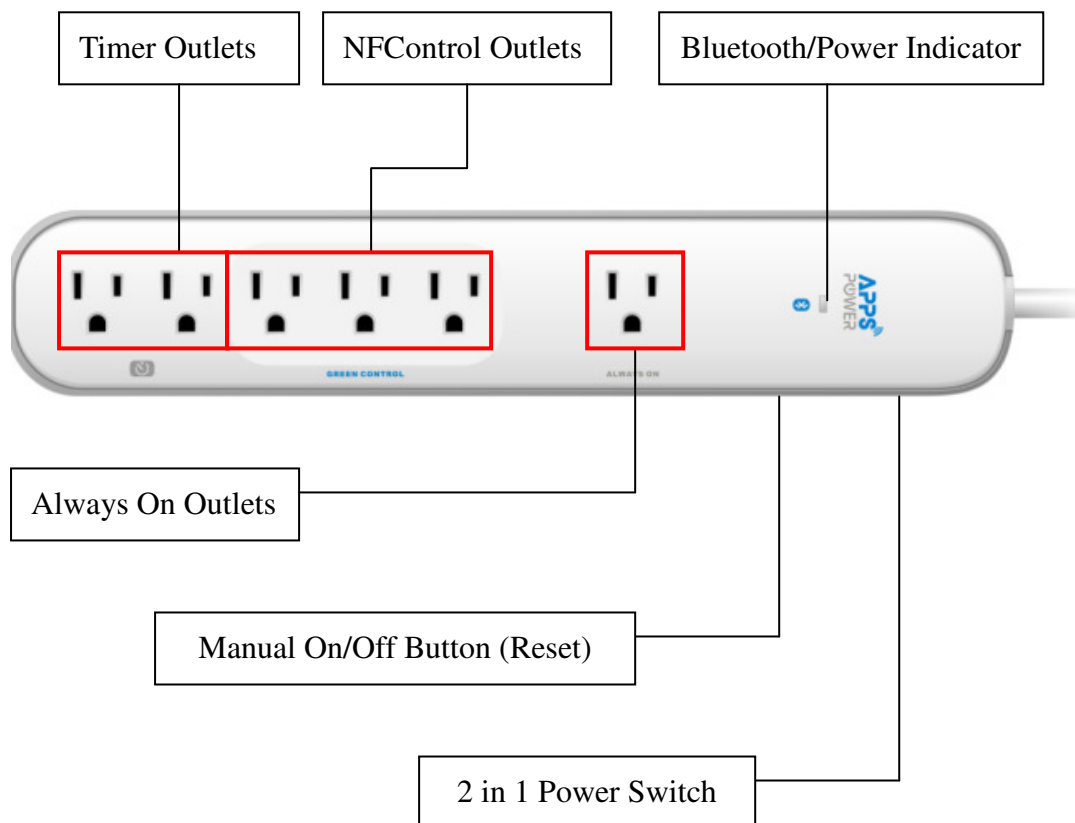

## 3 App installation and setting

### 3.1 Download Software from App Store

Search and download Apps from App Store with key word “APPSPower”  
You can see the download page as below and install Apps for free.



### 3.2 Setting Bluetooth Connection

Step1 Go to setting



Step2 Select Bluetooth

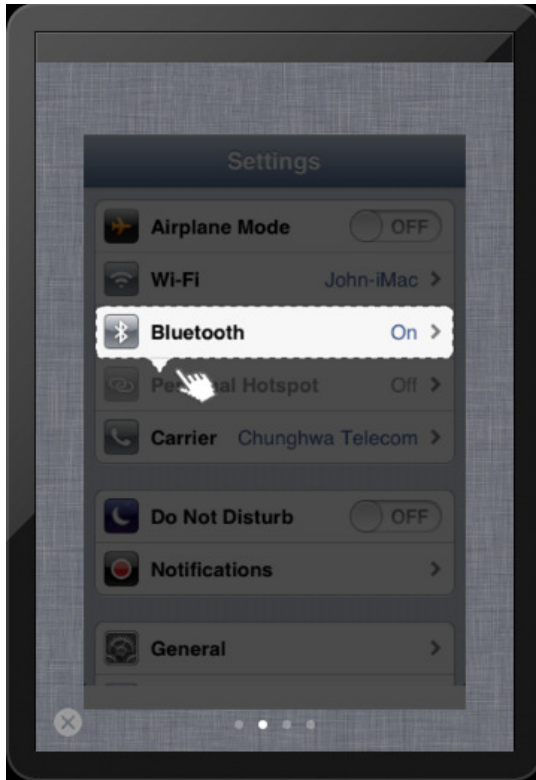

Step3 Select APPS Power device named "AppPower\_XX"

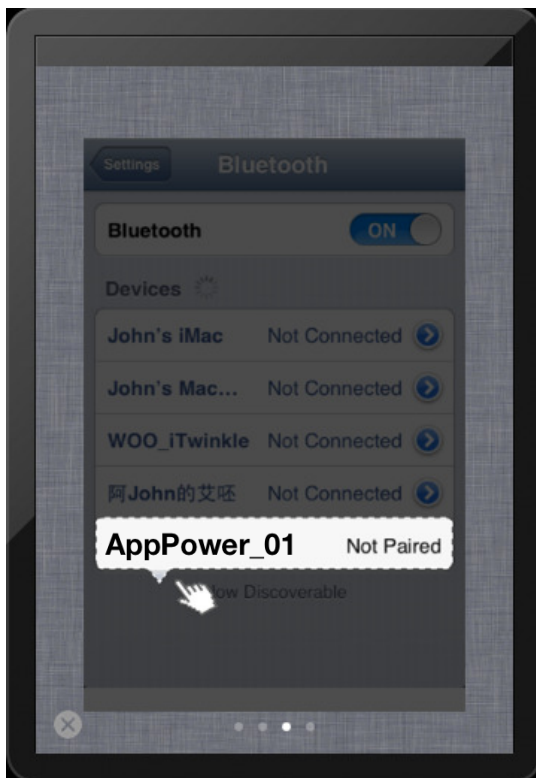

Step4 Connected.

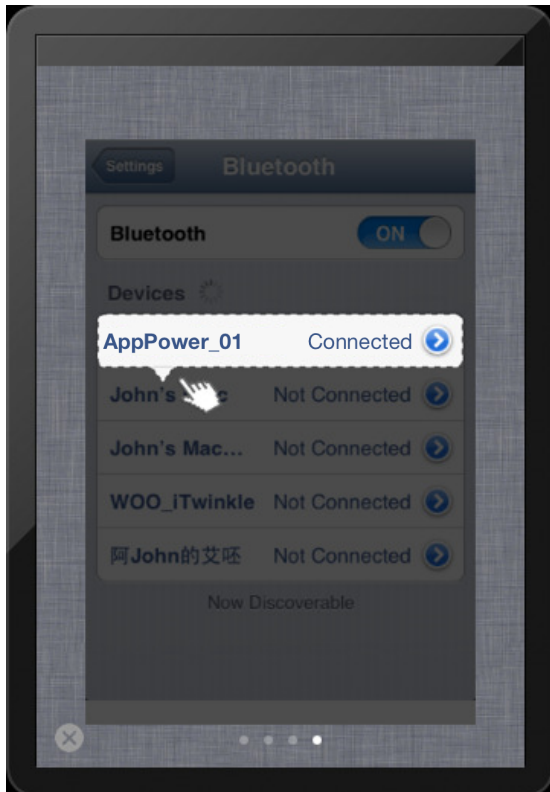

Step5 Open apps and you will see APPS Power devices list.

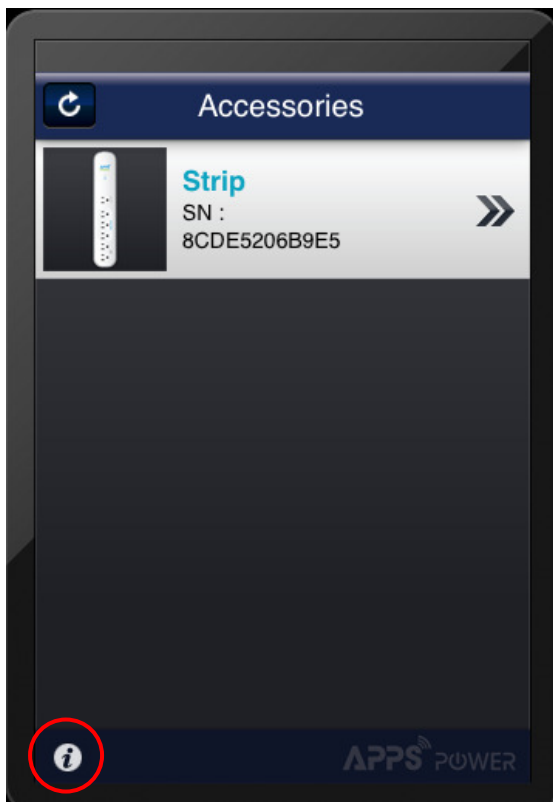

PS. You also can see the setting instructions on help pages.

# 4 Operation Guide

## 4.1 Basic Control

You can directly do the ON/OFF control by clicking the “INSTANT NFControl”

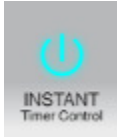
button  for NFControl outlets, and “INSTANT Timer” button 

for Timer outlets showed on display.

OFF



NFControl outlet ON



Timer outlet ON





## 4.2 Near Field Control

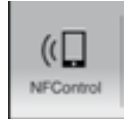

Click NFCControl button to enter NFCControl Setting page.

When the NFCControl (Near Field Control) Feature is enabled, the APPS plug will automatically turn on as iDevices connected via Bluetooth and turn off as iDevice is out of access range.

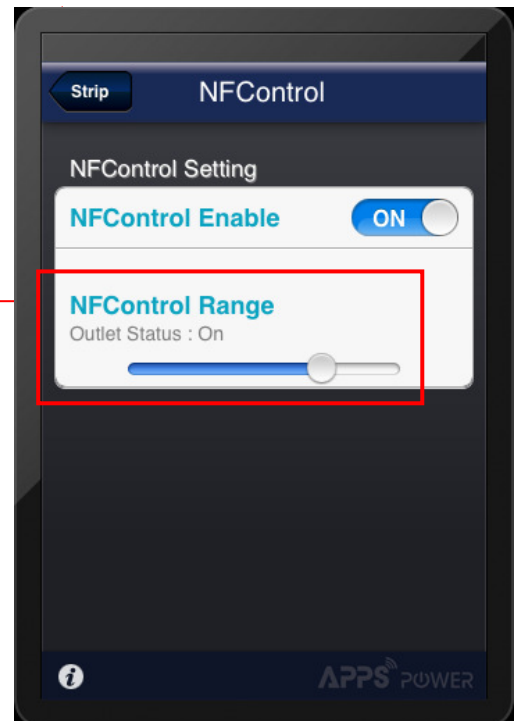
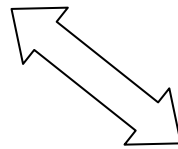
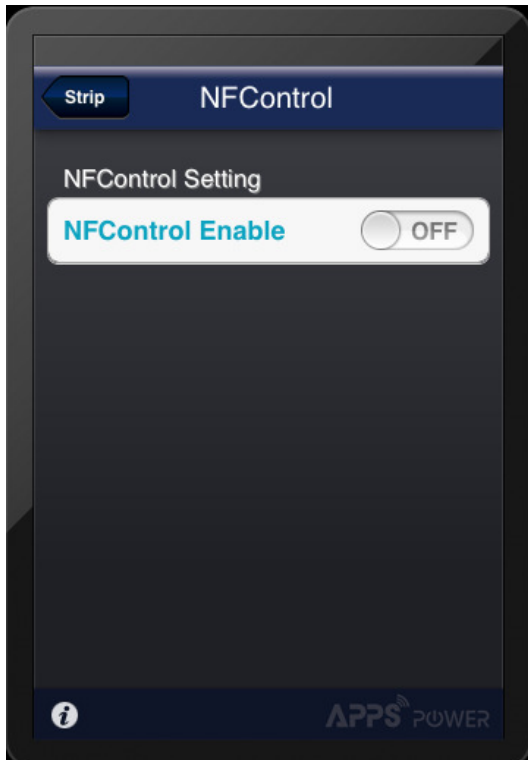

The range of NFCControl is able to be set by slide bar.

### 4.3 Schedule Timer

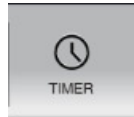

Click Timer button to enter Timer setting page.

APPS Power provides schedulable Timers for flexible use. User can set several timers for different requirements.

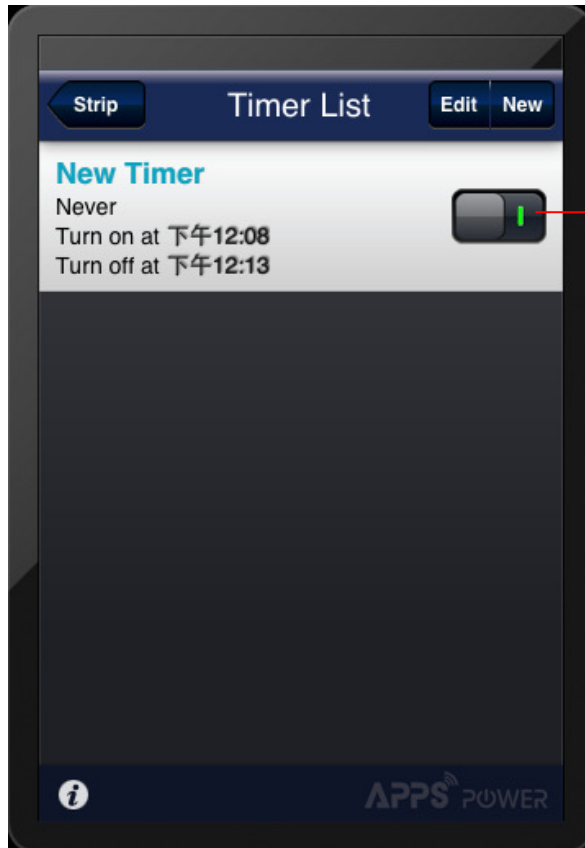

Click the slide button to turn on/off the preconfigured timers

### 4.3.1 Add New Timer



To create a timer, please click “New” button

Enter Timer name, Start Time and Stop Time. Select days which you want to enable timer regularly.

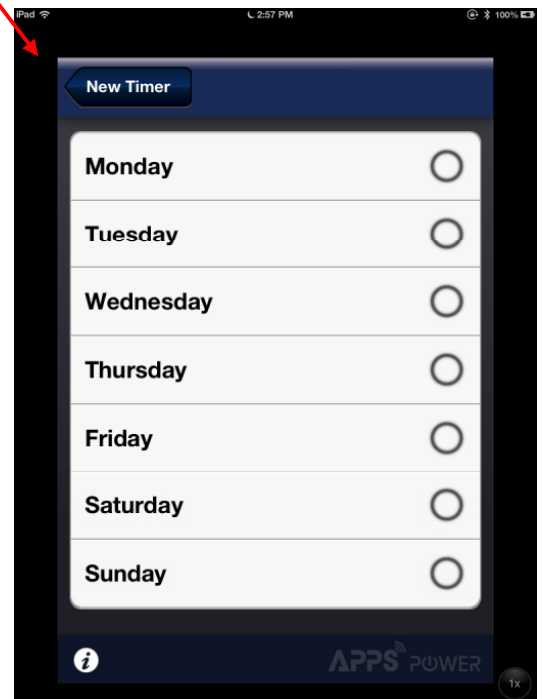
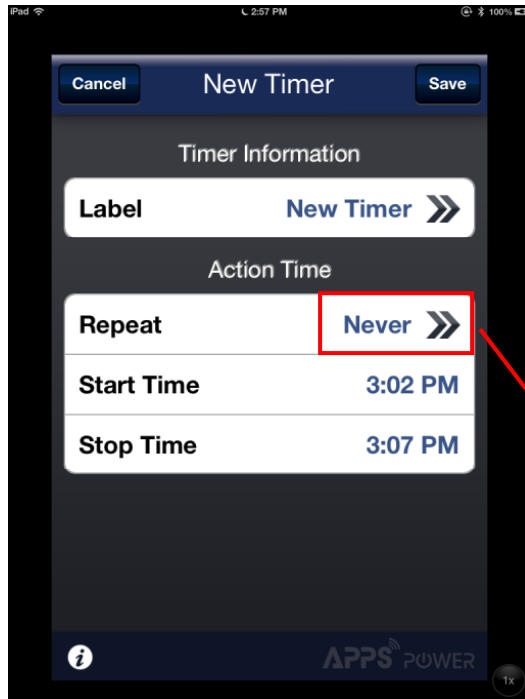

### 4.3.2 Edit Timer

Click Edit button  to change the settings of timers or delete them.

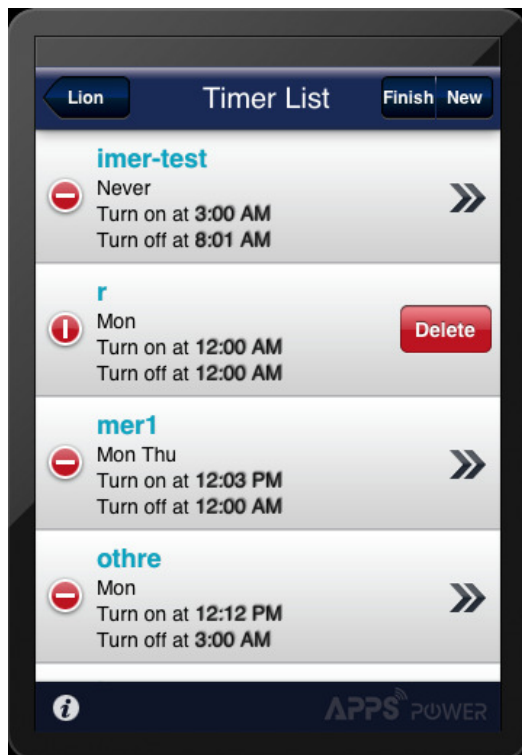

## 4.4 Setting

### 4.4.1 Device Name

The device name is able to be edited on setting page. Just tap the column of Device name to enter new name.



## 4.4.2 Setting Password (PIN Code)

The Password feature protects connection safety. The Password is required before entering control page.

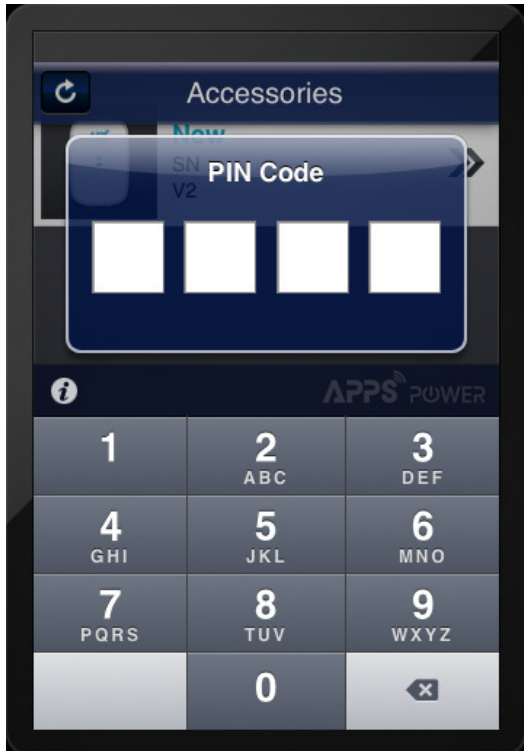

Click Setting button to enter setting page.

You also can disable this feature by turning off "Enable" button.

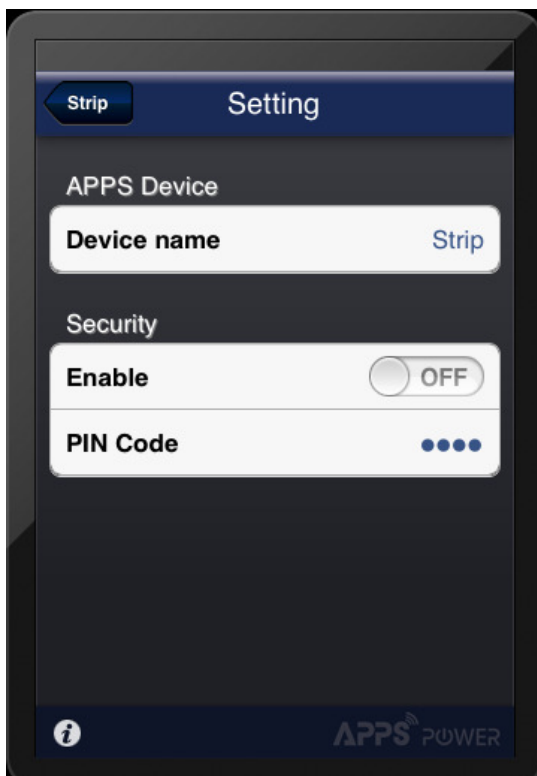

Turn on “Enable” button then Security Setup page is shown as below.  
Please key in 4 digital number as password.

**Note** : Default PIN code is “1234”



Changes or modifications not expressly approved by the party responsible for compliance could void the user's authority to operate the equipment.

#### Part 15B compliance statement:

NOTE: This equipment has been tested and found to comply with the limits for a Class B digital device, pursuant to part 15 of the FCC Rules. These limits are designed to provide reasonable protection against harmful interference in a residential installation.

This equipment generates, uses and can radiate radio frequency energy and, if not installed and used in accordance with the instructions, may cause harmful interference to radio communications. However, there is no guarantee that interference will not occur in a particular installation.

If this equipment does cause harmful interference to radio or television reception, which can be determined by turning the equipment off and on, the user is encouraged to try to correct the interference by one or more of the following measures:

- Reorient or relocate the receiving antenna.
- Increase the separation between the equipment and receiver.
- Connect the equipment into an outlet on a circuit different from that to which the receiver is connected.
- Consult the dealer or an experienced radio/TV technician for help.