

DP-301 Digital Pen Instruction Manual

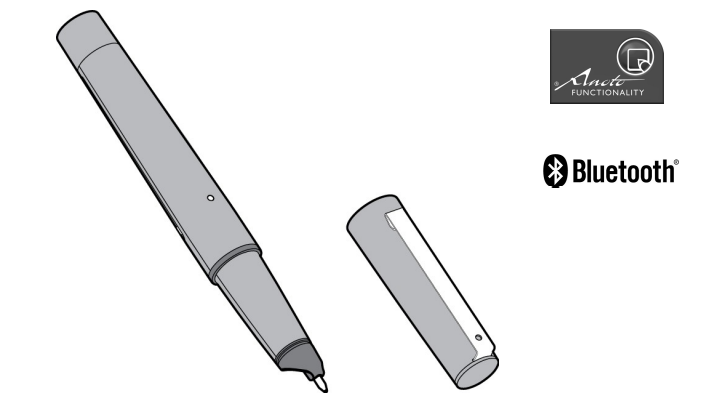

Thank you for your interest in the Hitachi Maxell Digital Pen. Reading and frequently referencing to this instruction manual will help you get the most out of using the digital pen. The serial number and Bluetooth PIN code are written on a label that is packed with the digital pen. Firstly, please paste it in the ‘Digital Pen Data Record Column’ below.

The information contained in this manual may be necessary when using the digital pen. Please keep this instruction manual in an easily accessible place.

Digital Pen Data Record Column
--------------------------------

Safety Precautions

Caution Notations

The three safety cautions levels used in this manual are described below:

<b>Danger</b>	This indicates items that lead to incorrect use of the product. Ignoring danger indications can cause serious injury, and/or result in death* <sup>1</sup> .
<b>Warning</b>	This indicates incorrect procedures used on the product and can cause serious injury and/or result in death* <sup>1</sup> .
<b>Caution</b>	This indicates items that lead to incorrect operation of the product. Ignoring these cautions can cause serious injuries* <sup>2</sup> , and/or cause damage to property* <sup>3</sup> .

* <sup>1</sup> Serious Injuries	Indicates loss of sight, severe burns, electric shock, bone fractures, etc. These injuries can lead to hospitalization, or have long-term effects.
* <sup>2</sup> Injuries	Indicates injuries, burns, electric shock, etc. These injuries do not require hospitalization, nor have any long-term effects.
* <sup>3</sup> Property Damage	Indicates extended damage to property, or animals and pets.

Important Explanation Signs

The below signs show important explanations used in this manual:

	Use high caution.
	Indicates activities which are prohibited with this product.
	Indicates disassembly is prohibited.
	Do not use in the bath or shower room.
	Indicates you must not handle the product with wet hands.
	Indicates mandatory procedures you must do to use this product.

<b>Danger</b>	
<b>Main Body (Pen)</b>	
<b>Do not use in areas that get exposed to high temperatures.</b> <ul style="list-style-type: none"><li>Do not use in areas that get exposed to high temperatures.</li><li>Do not use in areas that get exposed to flammable gasses or fires.</li><li>Do not put in electric ovens, or products that create high-pressure.</li><li>Do not throw in the fire and do not heating.</li></ul> Doing so could cause an explosion, breakdown, electric shock or fire.	
<b>Does not enter in the eyes attentively.</b> <p>When the liquid in the dry cell enters into the eyes, there is loss of eyesight and a possibility of obstacle of the eyes. Without rubbing washing away with clean water such as tap water, please receive the remedy of a physician immediately.</p>	
<b>Warning</b>	
<b>Main Body (Pen)</b>	
<b>Do not look inside the pen through the writing point.</b> <p>Directly looking at the infrared light of the pen could damage your eyesight.</p>	
<b>Do not subject the digital pen to strong impacts.</b> <p>The digital pen is a precision device. Take great care not to hit it against a hard object or drop it. It will cause explosion, breakdown and fire.</p>	
<b>Main Body (Pen) / Battery</b>	
<b>Do not use the pen when there is a malfunction.</b> <p>If the pen generates smoke or an odor, immediately stop using the pen, then remove the power supply. Continuing to use the pen could cause a fire or electric shock.</p>	
<b>Do not disassemble or modify the pen in any way, or remove the cover.</b> <p>Disassembling or modifying the pen or the battery could cause a fire or electric shock.</p> <p>WARNING: Never attempt to repair the pen yourself. This is always dangerous.</p>	 
<b>No water or oil !</b> <p>If water or oil enters the pen or the battery, it will cause an electric shock or a malfunction.</p> <p>Do not use at the place that becomes in the degree of much moisture and the bathroom. As for use pay attention especially in the rainy weather, the snowfall, the seashore and the waterside. It will cause the electric shock, short-circuit and breakdown with corrosion.</p>	  
<b>Does not make penetrate the foreign materials inside the pen.</b> <p>Does not make penetrated the water, metals and combustibles inside the pen. It will cause the fire and electric shock. If the foreign materials penetrated inside the pen, please discontinue use at once.</p>	
<b>Battery</b>	
<b>Do not charge the battery.</b> <p>Do not charge the battery. There is a possibility of bursting.</p>	
<b>Do not disassemble.</b> <p>Do not disassemble the battery.</p>	
<b>Do not overheat and do not throw into the fire.</b> <p>Do not overheat and do not throw into the fire. There is a possibility of bursting.</p>	
<b>Others</b>	
<b>Do not use the digital pen in an airplane.</b> <p>Never use the pen in an airplane because it could interfere with in-flight safety (be sure to put the cap on the pen and turn it off before boarding a plane).</p>	
<b>Do not use the digital pen near a high-precision electronic device.</b> <p>Turn the digital pen off near any high-precision electronic device so as not to interfere with it. Examples of devices the pen could affect include-pacemakers, hearing aids and other electronic medical devices, fire alarms, and automatic doors. If you are using an electronic medical device, consult the manufacturer or dealer for information on the effects of radio waves on such a device.</p>	
<b>Caution</b>	
<b>Main Body (Pen)</b>	
<b>This product is for domestic use.</b> <p>This digital pen is intended for use only within a pre-determined country/area. The pen’s specification and software provided with this digital pen are based on the aforementioned assumption. The warranty for the pen is valid only within such pre-arranged country/area. Hitachi Maxell shall be free from any responsibility for after-sales service outside the intended country/area if the digital pen malfunctions or is faulty beyond the pre-determined territory, and shall accept no claim for compensation of any repair fees. Reselling this digital pen beyond the pre-arranged country/area may violate laws of the government in a recipient’s country/area.</p>	

<b>Do not use this pen for any other purpose than writing.</b> <p>Do not use this pen for any other purpose than writing.</p>	
<b>Be careful with oil-based ink.</b> <p>Oil-based ink stains on clothes may not be removable.</p>	
<b>Do not write with the pen point facing up.</b> <p>Holding the pen with the point facing up may cause the ink to leak.</p>	
<b>Use only specified refills.</b> <p>Use only specified refills.</p>	
<b>Pay attention to the retention place.</b> <p>Do not expose the digital pen to a very high temperature for a long period of time. The temperature inside a closed vehicle or trunk can rise as high as 164 °F (73 °C) on a hot day. If exposed to such conditions, the digital pen could malfunction or the pen body could be deformed. Also, do not expose the pen to direct sunlight or place it near a heater. Dust entering the pen could cause a malfunction. Humidity could cause the lens to become moldy, making the pen unusable.</p>	
<b>Do not point the digital pen at the sun.</b> <p>Direct sunlight entering the lens could cause the pen to malfunction.</p>	
<b>Do not given the strong impact to the nib.</b> <p>When the impact that is strong in the nib with falling is given, it will cause of breakdown the nib or inside the pen.</p>	
<b>Battery</b>	
<b>Do not leave the battery in the place where the hand of the infant and the young child reaches.</b> <p>Do not leave the battery in the place where the hand of the infant and the young child reaches.</p> <p>If the battery was swallowed, consult a physician immediately.</p>	
<b>Remove the battery when long time do not use.</b> <p>Remove the battery when long time do not use. When you leave the battery into the pen not used for a long term, the liquid begins to leak from the battery and the equipment might break down.</p>	
<b>Insert the battery correctly.</b> <p>Adjusting to the polarity indication of the holder (+, -), insert the battery correctly.</p>	
<b>Others</b>	
<b>Keep product away from children.</b> <p>It may cause injuries. Keep the pen out of the reach of children.</p>	
<b>Be careful of itching, rash and eczema.</b> <p>This pen might cause itching, rash or eczema. If this happens, stop using the pen immediately and consult a physician.</p>	

Attention in Regard to Use

**Do not use the writing tools other than the digital pen to the special paper.**  
Do not use the writing tools other than the digital pen to the special paper. The part which is written with the pencil is done misconception recognition and it does not be able to record correct handwriting. In addition, please do not use also the cover-up liquid and the plastic erasers.

**Do not wipe the digital pen case with benzene or thinner.**  
The coating of the case could peel off or be damaged if it comes in contact with benzene or thinner.

**No sand or dust !**  
If sand or dust enters the pen or the charger, it will cause a malfunction.

**Do not use the digital pen near a TV or radio.**  
The digital pen may interfere with TV and radio broadcasts.

**Do not use the digital pen near strong radio waves or magnetic fields.**  
Calcium and other chemicals dissolved in water and dispersed through the air via a humidifier could adhere to the lens of the pen and cause a malfunction. If moisture enters the pen, condensation could cause the pen to operate abnormally.

**Do not use the digital pen near corrosive gas.**  
The parts inside the pen could corrode when used in a place where there is dense exhaust gas generated by gasoline or diesel engines, or corrosive gas such as hydrogen sulfide, which could cause the pen to malfunction.

**Do not use the digital pen near an ultrasonic humidifier.**  
Calcium and other chemicals dissolved in water and dispersed through the air via a humidifier could adhere to the lens of the pen and cause a malfunction. If moisture enters the pen, condensation could cause the pen to operate abnormally.

**No extreme ambient temperature.**  
In extremely hot or cold temperatures, the digital pen may not operate normally. Do not leave the pen in a closed vehicle for a long period of time as this may cause the pen to malfunction.

**Do not use the digital pen where there is thick soot or steam.**  
Thick soot or steam could damage the pen case or cause malfunctions.

**Note on handling refills.**  
Do not reuse damaged refills as this could cause ink leakage. When replacing refills, take special care not to damage the tip of the pen.  
**Use the "AAA Cell" alkaline battery.**  
Use the "AAA Cell" alkaline battery at the exchange.

**Do not cover the nib with the fingers**  
The digital pen photographs the picture, which is written on the papers with the camera that is in the nib. Do not cover the nib with the fingers that hold the pen.

**Do not push the switch with the fingers.**  
The power source becomes off when the cap is attached to the digital pen. Do not push the switch with the fingers that hold the pen, because this detection switch is a position in the right figure. When the switch is pushed approximately a few seconds, power source becomes off.

Attention in Regard to Storage

**Pay attention to that children do not swallow the cap, replacement refills and dry cell by mistake.**  
Those mistaking when being swallowed, consult a physician immediately.

**Do not store the digital pen in a place subject to strong magnetic fields or intense vibrations.**  
Strong magnetic fields or vibrations could cause malfunctions.

**Use the cap**  
By all means doing the cap turn off the power of the digital pen, when carrying and no using. What does the cap is useful to also the preventing the invasion of the dust.

**Keep in the place where the hand of the child does not reach**  
The digital pen's nib has sharp pointed. When it directs to the person it is very dangerous.

Take Note of the Following

**Repair & Disposal.**  
Please consult Hitachi Maxell, our sales partner or reseller if you want to repair or dispose of your digital pen.

**No recorded contents shall be subject of compensation.**  
Hitachi Maxell shall be free from any responsibilities for any improper recording, and any damages from abnormal recording shall not be subject of compensation if the digital pen is faulty, or if it is mistakenly used by you.

**Product liability:**  
The digital pen is designed and manufactured for home and general business use only. Hitachi Maxell cannot accept any responsibility for any accident that might cause damage to human life or loss to property due to use of the product in such applications as chemical plant controls, life-support, and air traffic control systems, where a very high-level of responsibility is required.

\* These disclaimers are times when it modifies without notice, please acknowledge beforehand.

How to Insert the Battery

- Closing the cap, turn off power.
- Making the lock lever▶ direction slide, open the battery holder’s cover.

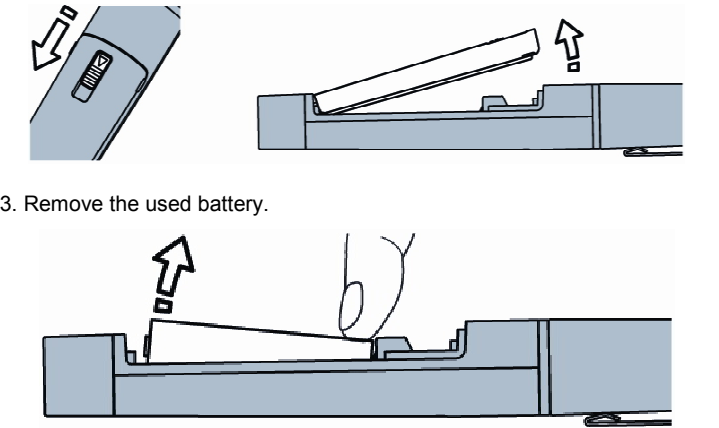

The indicators in the operation display will inform you of the status of the digital pen.

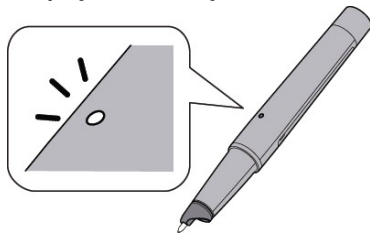

Pen State	LED	Comment
Pen Down (User writes on paper)	LED OFF	User writes on paper.
Sniff1 Mode (Bluetooth connected)	LED FLASH (1sec/10sec)	Battery OK, Bluetooth idle mode.
Sniff2 Mode (Bluetooth connected)	LED FLASH (1sec/10sec)	Battery OK, Bluetooth idle mode.
Standby Mode	LED FLASH (1sec/10sec)	Battery OK. If Bluetooth connected, user can start writing at anytime. If Bluetooth not connected, try to connect when a pen down on a paper.
Wait Pairing (Cap off)	LED ON	User removes the pen's cap.
Pairing	LED FLASH (0.5sec/1sec)	Pen is pairing with the remote device.
Connecting	LED OFF	Pen try to connect to the paired device.
Battery Low	LED FLASH (0.5sec/2sec)	Battery capacity decreases.
Hardware Error	LED FLASH (0.1sec/0.5sec × 10times)	Hardware error / Initialize error
Connect Error	LED FLASH (0.1sec/0.5sec × 3times)	Fail to connect with the paired device.
Pairing Error	LED FLASH (0.1sec/0.5sec × 5times)	Fail to pair with the device.
Cap on	LED FLASH (0.2sec/0.2sec)	Power off

Models	DP-301 : Bluetooth model
Weight	39g (with the battery installation)
Dimensions	159 <sup>-4</sup> x 20 <sup>-4</sup> x $\phi$ 18 <sup>-3</sup> mm (with a cap, except a clip) 147 <sup>-9</sup> x $\phi$ 18 <sup>-3</sup> mm (without a cap)
Data communication	Bluetooth 2.0 standard
Operating temperature	0 to 40°C (with no condensation)
Dry Cell	“AAA cell” Alkaline battery
Continual operation time	5 hours or longer
Battery standby time	150 hours (without a cap)

Changes or modifications not expressly approved by the party responsible for compliance could void the user's authority to operate the equipment.

This equipment has been tested and found to comply with the limits for a class B digital device, pursuant to part 15 of the FCC Rules. These limits are designed to provide reasonable protection against harmful interference in a residential installation.

This equipment generates, uses and can radiate radio frequency energy and, if not installed and used in accordance with the instructions, may cause harmful interference to radio communications. However, there is no guarantee that interference will not occur in a particular installation. If this equipment does cause harmful interference to radio or television reception, which can be determined by turning the equipment off and on, the user is encouraged to try to correct the interference by one or more of the following measures:

- Reorient or relocate the receiving antenna.
- Increase the separation between the equipment and receiver.
- Connect the equipment into an outlet on a circuit different from that to which the receiver is connected.
- Consult the dealer or an experienced radio/TV technician for help.

### About the RF Exposure

- This transmitter must not be co-located or operated in conjunction with any other antenna or transmitter.
- This equipment complies with FCC/IC radiation exposure limits set forth for uncontrolled equipment and meets the FCC radio frequency (RF) Exposure Guidelines in Supplement C to OET65 and RSS-102 of the IC radio frequency (RF) Exposure rules. This equipment has very low levels of RF energy that it is deemed to comply without testing of specific absorption ratio (SAR).

• This class B digital apparatus complies with Canadian ICES-003.  
• Cet appareil numérique de la classe B est conforme à la norme NMB-003 du Canada.

We, **Hitachi Maxell, Ltd.** of  
**6-20-1 Kinunodai, Tsukubamirai-shi, Ibaraki 300-2496, Japan**  
 declare under our sole responsibility that the production

to which this declaration relates is in conformity with the following standards  
Following the provision of R&TTE Directive 1999/5/EC



( Applicable in the European Union and other European countries with collection systems )

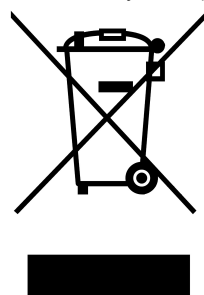



This symbol on the product or on its packing indicates that this product shall not be treated as household waste. Instead it shall be handed over to the applicable collection point for the recycling of electrical and electronic equipment.

By ensuring this product is disposed of correctly, you will help prevent potential negative consequences for the environment and human health, which could otherwise be caused by in appropriate waste handling of this product.

The recycling of materials will help to conserve natural resources. For more detailed information about recycling of this product, please contact your

The Bluetooth Qualification information of this product could be referred to Bluetooth identifier B013766.

-  and  are trademarks owned by Anoto AB, Sweden.
- “Bluetooth” and  **Bluetooth** are the trademarks of Bluetooth SIG, Inc. Hitachi Maxell is a member of Bluetooth SIG and is a licensed user of these trademarks.
- All company names, brand names and product names are trademark or registered trademark of each company.