

# M10-3N Quick Start Guide

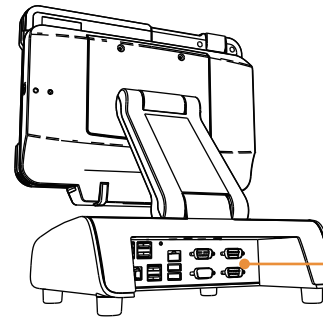

## Identifying components

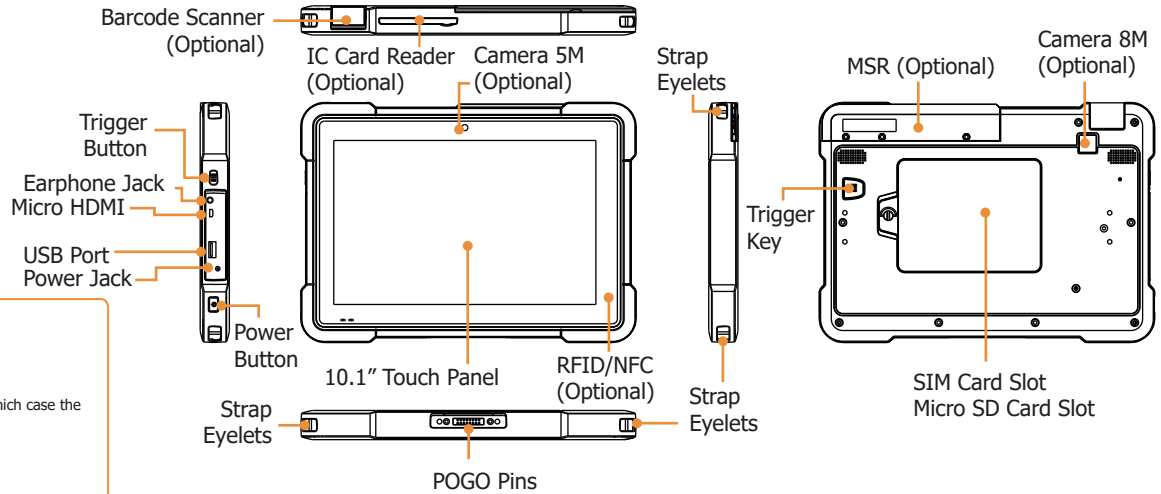

**POS Base (X3-10, X3-20)**

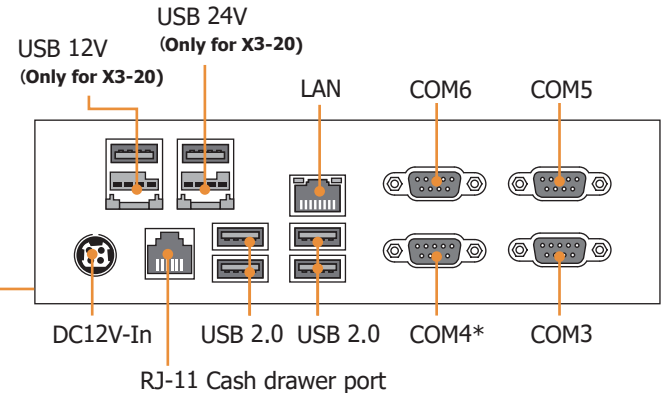

### 警告

使用過度恐傷視力。

### 注意事項

使用30分鐘請休息10分鐘。未滿2歲幼兒不看螢幕，2歲以上每天看螢幕不要超過1小時。

### WARNING

This is Class A Product. In domestic environment this product may cause radio interference in which case the user may be required to take adequate measures.

### 警告使用者

警告：為避免電磁干擾，本產品不應安裝或用於住宅環境。

### Federal Communications Commission (FCC) Statement

This equipment has been tested and found to comply with the limits for a Class A digital device, pursuant to Part 15 of the FCC Rules. These limits are designed to provide reasonable protection against harmful interference when the equipment is operated in a commercial environment. This equipment generates, uses, and can radiate radio frequency energy and, if not installed and used in accordance with the instruction manual, may cause harmful interference to radio communications. Operation of this equipment in a residential area is likely to cause harmful interference in which case users will be required to correct the interference at their own expense.

### Safety information

- Before installing and using the machine, take note of the following precautions:
- Do not place the unit on an unstable surface, cart, or stand.
- Do not block the slots and opening on the unit, which are provided for ventilation.
- Only use the power source indicated on the marking label. If you are not sure, contact your dealer or the Power Company.
- When replacing parts, ensure that your service technician uses parts specified by the manufacturer.
- Do not place anything on the power cord. Place the power cord where it will not be in the way of foot traffic.

### Non-modification Statement

Changes or modifications not expressly approved by the manufacturer responsible for compliance could void the user's authority to operate the equipment.

### Taiwan NCC

一般設備(低功率電波輻射性電機管理辦法第 12、14 條)

- 經型式認證合格之低功率射頻電機，非經國家通訊傳播委員會 (NCC) 許可，公司、商號或使用者均不得擅自變更頻率、加大功率或變更原設計之特性及功能。
- 低功率射頻電機之使用不得影響飛航安全及干擾合法通信；經發現有干擾現象時，應立即停用，並改善至無干擾時方得繼續使用。

前項合法通信，指依電信法規定作業之無線電通信。低功率射頻電機須忍受合法通信或工業、科學及醫療用電波輻射性電機設備之干擾。

### SAR notice

The highest SAR value for the device is not over FCC requirement (limit set by the FCC is 1.6W/kg) when placed next to the body. The FCC has granted an Equipment Authorization for this device with all reported SAR levels evaluated as in compliance with the FCC RF exposure guidelines.

### Battery notice

Li-ion batteries can be dangerous. There is a danger of explosion if the battery is incorrectly replaced. Do not expose to fire or water.

To reduce the risk of fire or burns, do not disassemble, crush, puncture, or short external contacts. Dispose of used batteries according to state or local hazardous waste requirements.

### FCC 5.925-7.125 GHz Caution Statement

Operation of transmitters in the 5.925-7.125 GHz band is prohibited for control of or communications with unmanned aircraft systems.

### NOTE

1. POS Base is sold separately.
2. COM4 Only support Tx / Rx, doesn't support CTS/RTS/DSR/DTR/DCD/RI.
3. COM4 doesn't apply for Burn-in Test program.

## M10-3N Specification

Item	M10-3N
Display	10.1" 16:10 800x1280 350nits (800nits optional)
Touch	PCAP Touch
CPU	Intel® Alder Lake N200
Memory	LPDDR5 8GB
Storage	Emmc 128GB
I/O Interface	1 x Type-A USB 3.0 1 x Micro HDMI 1 x Headphone+Mic 1 x DC Jack 1 x Micro SIM slot 1 x Micro SD card 1 x Power button 2 x Function Key 1 x POGO Pins
Speaker	2 x Speaker (1W)
Camera (option)	Front Camera 5.0Mp FF , Ambient Light Rear Camera 8.0Mp AF
Battery	Main Battery: 7.4V,4600mAh Hot swap battery: 3.8V/250 mAh (3.7V/320 mAh optional)
Peripheral Options	MSR, EMV reader, RFID/NFC reader, 5MP & 8MP camera, 2D barcode scanner, POS Base, Payment bracket (Ingenico moby5500, ID Tech Link 2500, ID Tech VP3300) 5G, GPS
Wi-Fi / BT	Wi-Fi 6E Intel AX210 / BT5.3
Drop	3 Foot (1meter)
Spill & Dust Resistant	IP54 Certified
Operation System	Windows 11 IoT Enterprise GAC Linux (Ubuntu 22.04)
TPM	HW TPM 2.0
Power Adaptor	AC-In 100~240V / DC-Out 12V, 36W
Reliability	System operating temperature: 0~40°C / 32~104°F System humidity: 15% ~ 80% Storage temperature: -20~60°C / -4~140°F
Dimensions (Wx Hx D)	278 x 199 x 24.2 mm / 10.95 x 7.83 x 0.95 in
Weight	1.2 Kgs / 2.64 Ib

### 聯絡資訊 / Contact Information

拍檔科技股份有限公司 / Partner Tech Corporation  
 新北市新店區寶橋路233之1號10樓  
 10F., 233-1, Baoqiao Road, Xindian, New Taipei City 231, Taiwan

Phone: +886-2-29188500  
<https://www.partnertechcorp.com/>

## POS Base Specification

Item	X3-10	X3-20
USB	4	4
COM	4	4
Ethernet	1(10/100 Mbps)	1(10/100 Mbps)
Cash Drawer	1	1
DC in	12V 7.5A 90W	12V 15A 180W
Power USB	X	1*12V 1.5A, 1*24V 2.3A
Dimension WxLxT (mm)	278 x 225.25 x 321.1	278 x 225.25 x 321.1

## Installing Hand Strap

Secure the hand strap to the rear of the device with four screws.

### NOTE

Hand strap is sold separately.

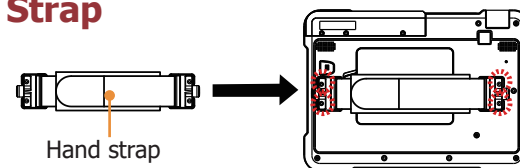

## Installing Power Adapter

There are two power supply specifications 90W and 180W. Only the 90W power adapter can be installed into the compartment of the POS Base. Please follow the steps below:

1. Connect the power cable to the DC-IN connector located on the I/O panel.
2. Connect the AC power cable to the power adapter.
3. Put the power adapter and cables into the compartment.
4. Secure the compartment cover with two screws.
5. Plug the power cable into an electrical outlet.

### Note

You can use cable clamps to secure cables to the bottom of the POS Base.

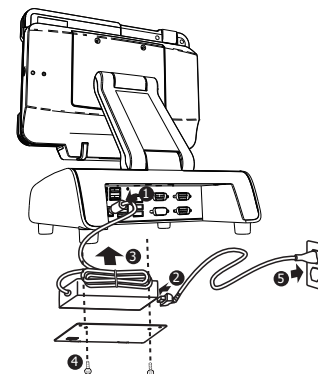

單元	設備名稱: 移動POS終端機 型號(型式): M10-3N					
	限用物質及其化學符號					
	鉛(Pb)	汞(Hg)	鎘(Cd)	六價鉻(Cr+6)	多溴聯苯(PBB)	多溴二苯醚(PBDE)
金屬機構件	○	○	○	○	○	○
塑料機構件	○	○	○	○	○	○
顯示模組	○	○	○	○	○	○
電路板模組	○	○	○	○	○	○
電源線/其他線材	○	○	○	○	○	○
喇叭	○	○	○	○	○	○

備考1. “超出0.1 wt %”及“超出0.01 wt %”係指限用物質之百分比含量超出百分比含量基準值。  
 備考2. “○”係指該項限用物質之百分比含量未超出百分比含量基準值。  
 備考3. “—”係指該項限用物質為排除項目。