

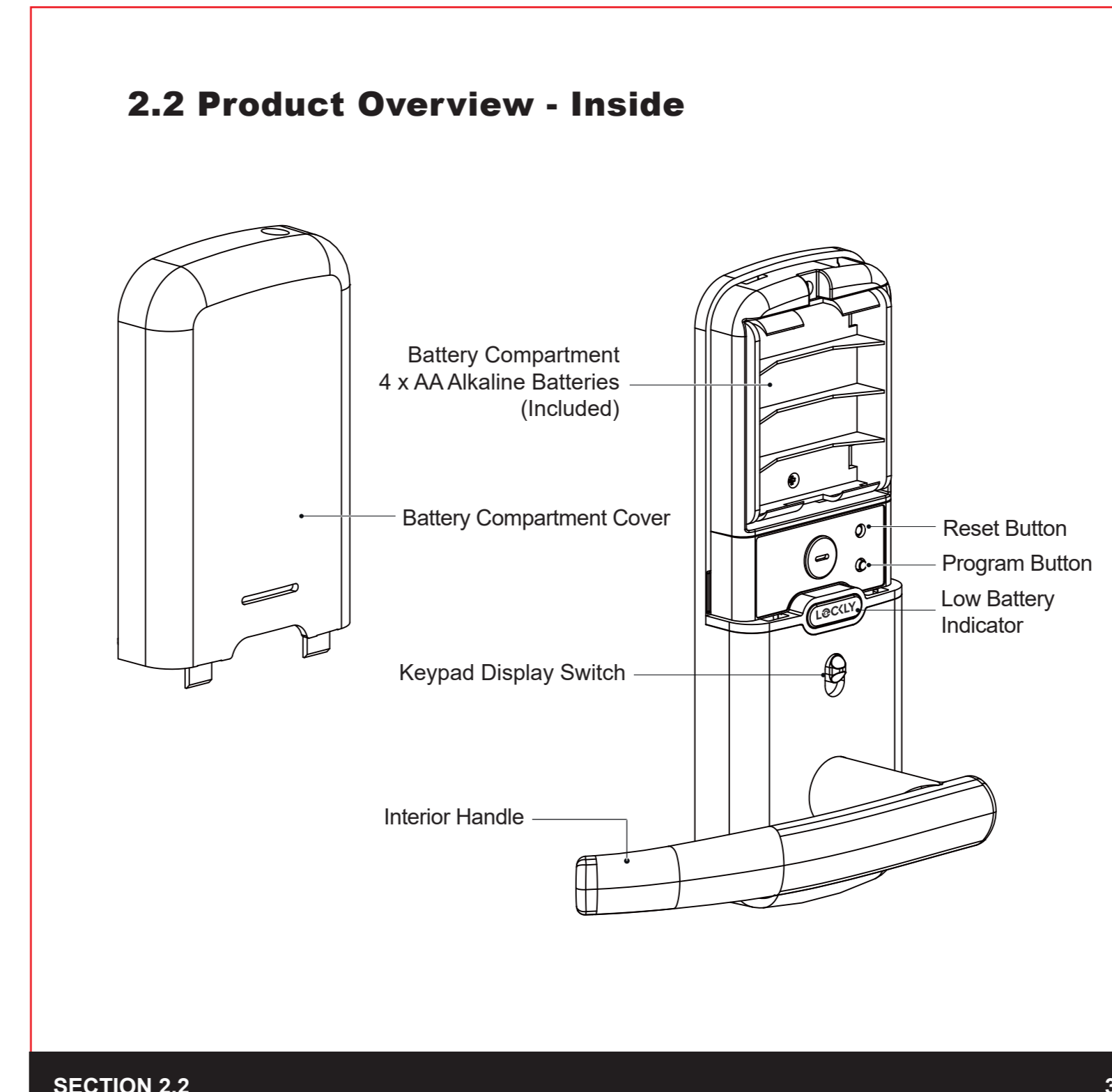

Lockly Smart Lock - Secure Plus (PGD628) Lockly Smart Lock - Secure Pro (PGD628P) U.S. Patent No. 9,665,706

Table of Contents listing sections 1.1 through 3.8.

1.1 Product Features: Patented Anti-Pick Keypad, Multiple Access Codes & Monitoring, Advanced 2D Fingerprint Recognition (Secure Pro Only).

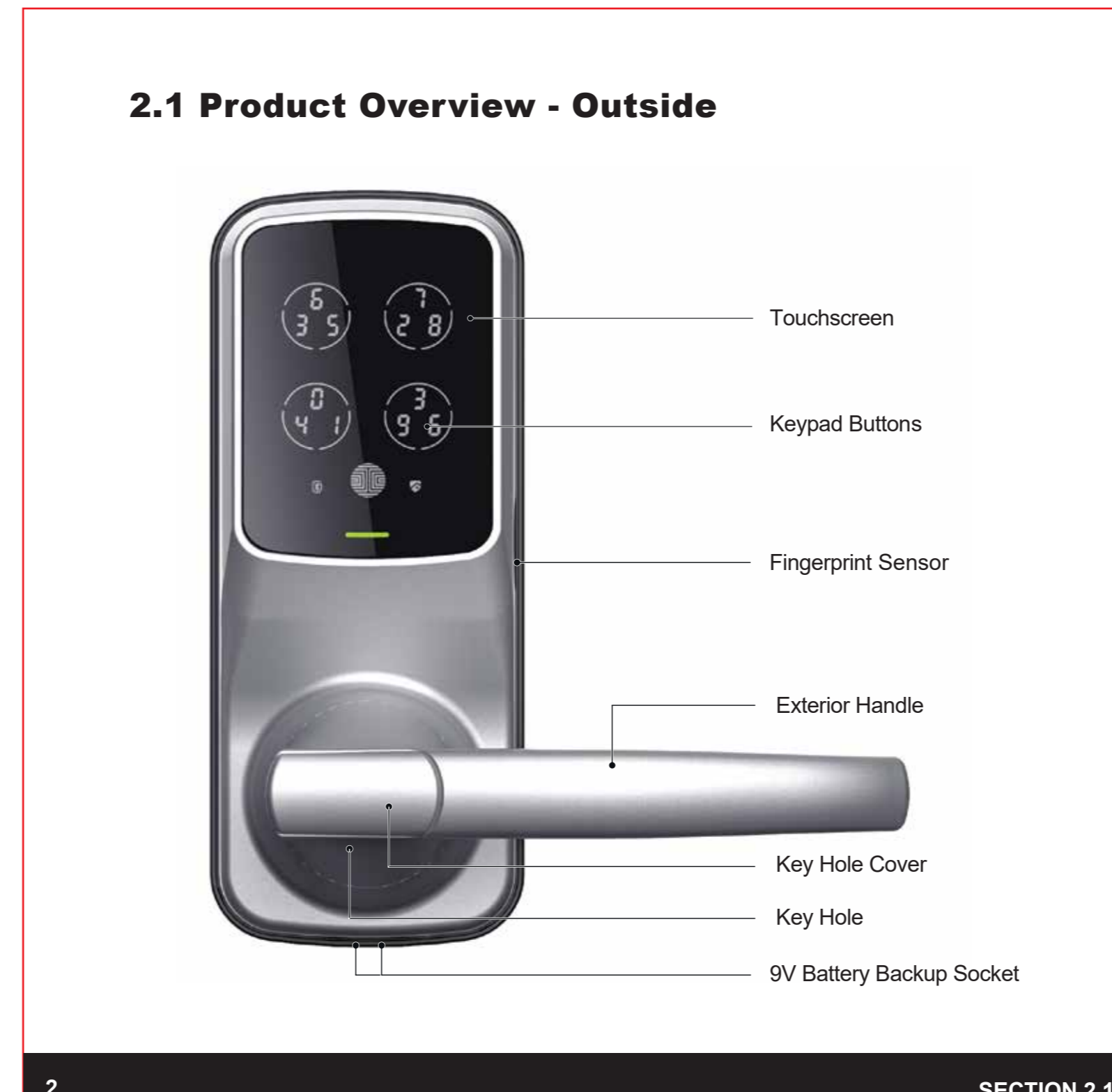

2.3 Understanding Your New Lock: NOTICE - The Default Access Code is 123456. After installation, you will see the default code on the keypad.

2.4 Factory Reset: To return the lock to factory default settings, you must have your 'Initial Code' available. Press the Reset button on the back panel.

2.6 Rebooting Lockly Secure: NOTICE - Reboot Lockly in case of dead battery or malfunction. Press and hold the Reboot button for 10 seconds.

2.7 Low Battery: When the battery is in critically low condition, Lockly Secure will make continuous beeping sounds to notify you. The lock will automatically enter a low battery mode.

2.8 Changing The Battery: Under normal use, the Lockly Secure's battery will last up to a year. Please check battery levels regularly and change your batteries when the low battery notification is issued.

2.5 Keypad Display Switch: The exterior keypad screen can be locked and turned off by using the ON/OFF switch at the back panel of the smart lock.

2.6 Rebooting Lockly Secure (Continued): To enter Programming Mode, remove the battery compartment cover and press the Reboot and Program buttons.

3.3 Adding an Access Code: While in Programming Mode, select 'ADD' to add an Access Code. Press the OK button to confirm.

3.3 Adding an Access Code (Continued): If you have successfully entered your new Access Code, you will see the code on the keypad.

3.1 Configuring Access: NOTICE - The Default Access Code is 123456. Your new Lockly Access Code can be any combination of 6 to 8 digit digits.

3.2 Entering Programming Mode: To enter Programming Mode, remove the battery compartment cover and press the Reboot and Program buttons.

3.3 Adding an Access Code (Continued): Enter your new 6-8 digit Access Code and press OK when you are finished.

3.6 Adding a Fingerprint (Secure Pro Only): In this section, you will learn how to register a fingerprint to your new smart lock. Fingerprint registration is only available in the Lockly Secure Pro.

3.4 Deleting an Access Code: While in Programming Mode, select 'DEL' to delete an Access Code. Press the OK button to confirm.

3.4 Deleting an Access Code (Continued): Once you have selected the Access Code you want to delete, Lockly will ask you to confirm deletion.

3.5 Checking the Access Codes: Rotate through the different Access Codes by touching any number on the screen.

3.7 Fingerprint Scanning Directions (Continued): The fingerprint sensor is located on the lock's exterior. Place your finger on the sensor.

3.6 Adding a Fingerprint (Continued): While in Programming Mode, select 'ADD' to add a Fingerprint. Press the OK button to confirm.

3.6 Adding a Fingerprint (Continued): NOTICE - Please make sure your finger is clean from dirt and oil before scanning your fingerprint.

3.7 Fingerprint Scanning Directions: The fingerprint sensor is located on the lock's exterior. Place your finger on the sensor.

4.2 Locking/Unlocking Lockly with Fingerprint: Unlocking - Place a registered finger in the fingerprint scanner. Locking - To lock the Lockly Secure, press the OK button.

4.3 Locking/Unlocking Lockly with App: You must have the Lockly iOS or Android app installed in order to lock and unlock with the smart lock.

4.4 Locking/Unlocking Lockly with Physical Key: To unlock your Lockly using the physical key, insert the key into the keyhole.

4.1 Locking/Unlocking Lockly with Access Codes: Lockly Secure series can be unlocked using 1 of 4 ways - via your stored Access Code, registered Fingerprint (Secure Pro only), smartphone with Bluetooth, or with the physical key.

4.5 Safe Mode - Overview: Lockly will enter Safe Mode when three (3) consecutive wrong Access Codes are entered within 5 minutes.

5.1 OMK - Offline Magic Key: The Offline Magic Key (OMK) is a unique feature of the Plus and Pro Series. It allows you to gain access to your smart lock without needing a mobile device.

6.1 Important Notes: Auto Lock Feature - Lockly Secure is programmed to auto-lock after five (5) seconds of opening the door.

7.1 Cleaning: Making sure your Lockly is clean is best practice to ensure optimal product use. Follow the DOs and DON'Ts.

8.1 Safety Precautions: Please read all instructions carefully. Rermed all Lockly users of the safety precautions. Read the following instructions for your own safety.

FC Compliant: This device complies with Part 15 of the FCC Rules. Operation is subject to the following two conditions: (1) This device may not cause harmful interference, and (2) this device must accept any interference.