

MVAC Description

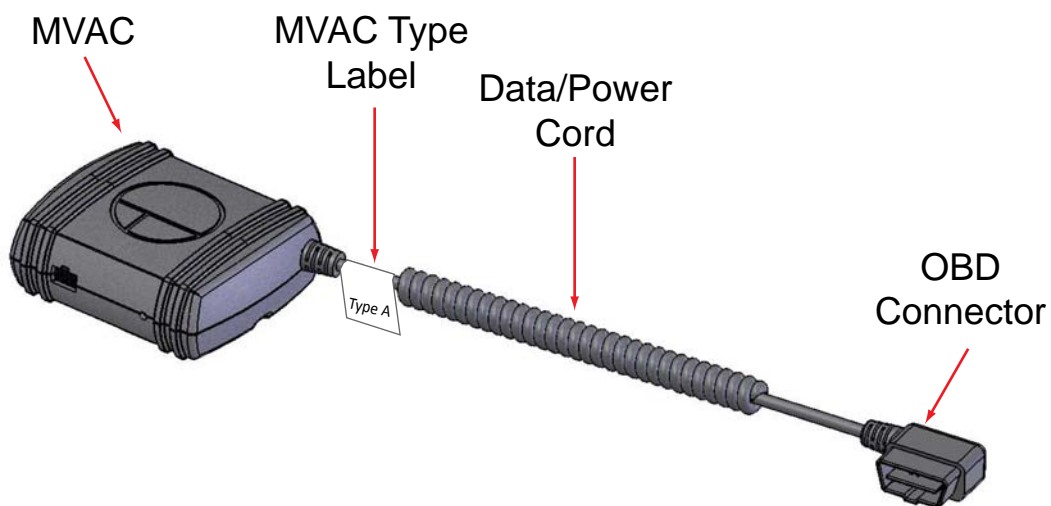
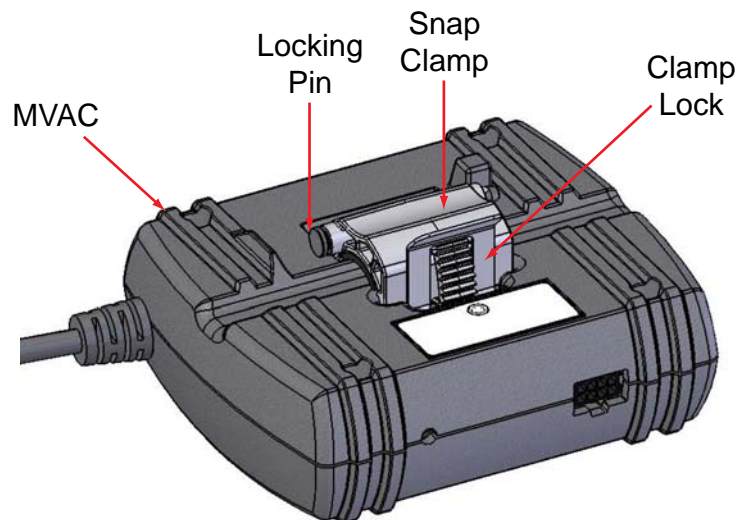

Required Tools

Some tools that may be required for installing the MVAC:

- Portable lighting
- Standard tools for panel removal (if required)

Prior to Installation

Before starting the installation, take a minute to survey the area underneath and directly behind the dashboard. Select the best mounting location before you start to work. The harness should be the appropriate diameter (step 6) and high up behind the dashboard.



WARNING: IT IS CRITICAL TO VERIFY THAT THE MVAC TYPE (TYPE A/TYPE B) MATCHES THE VEHICLE MODEL IT IS BEING INSTALLED ON. CONSULT THE APPROVED VEHICLES LIST FOR COMPLETE DETAILS ON WHICH MVAC TYPE IS APPROVED FOR THE VEHICLE MODEL BEING INSTALLED. EACH MVAC WILL BE MARKED AND LABELED ON THE DATA/POWER CORD.

This device complies with Part 15 of the FCC and RSS-210 of Industry Canada Rule. Operation is subject to the following two conditions:

- (1) This Device may not cause harmful interference, and
- (2) This device must accept any interference received, including interference that may cause undesired operation.

Note: This equipment has been tested and found to comply with the limits for digital device, pursuant to Part 15 of FCC Rules.

These limits are designed to provide reasonable protection against harmful interference when the equipment is operated in a commercial environment. This equipment generates, uses and can radiate radio frequency energy and, if not installed and used in accordance with the instructions, may cause harmful interference to radio communications. However, there is no guarantee that interference will not occur in a particular installation. If this equipment does cause harmful interference to radio or television reception, which can be determined by turning the equipment off and on, the user is encouraged to try correct the interference by one or more of the following measures:

- 1.1. Reorient or relocate the receiving antenna.
- 1.2. Increase the separation between the equipment and receiver.
- 1.3. Connect the equipment into an outlet on a circuit different from that to which receiver is connected.
- 1.4. Consult the dealer or experienced radio/TV technician for help.

WARNING

Changes or modifications not expressly approved by the manufacturer could void the user's authority to operate the equipment.

Configuring the MVAC Before Installation

- 1** Insert the key into the ignition and turn the key to the Accessory position so the vehicle will have power. Locate the vehicle's OBD port. On most models, the OBD port will be located on either side or underneath the steering column. On some models, the OBD port may be located behind an access panel. Note: If the OBD port has plug in it, remove the plug and tape it to the wire harness.

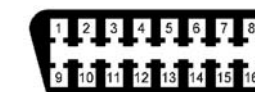
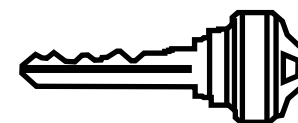

OBD port

- 2** Make sure the vehicle's driver door is open. Plug the MVAC into the vehicle's OBD connector. Wait for the door to lock and unlock, and then wait for the LED to turn Green.



If the LED turns Green

Move to step 3



If the LED blinks or turns Amber, remove the MVAC and place it on a reprogramming station.



If the LED turns Red, or does not light up at all



Place this unit to the side and repeat Step 2 with a different MVAC



WARNING: ENSURE THAT THE INSTALLED MVAC CANNOT INTERFERE WITH THE VEHICLE OPERATOR AT ANY TIME



Electrical Connections (Cont.)

3



Unplug the MVAC from the OBD port.



Remove the the key from the ignition.

4

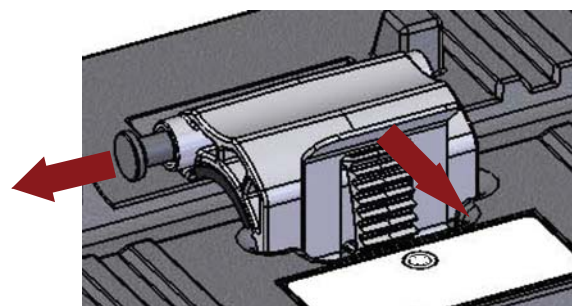

Slide back the locking pin and push back on the clamp lock to release the snap clamp.

When open, the MVAC will look like this with the pin out and the clamp released

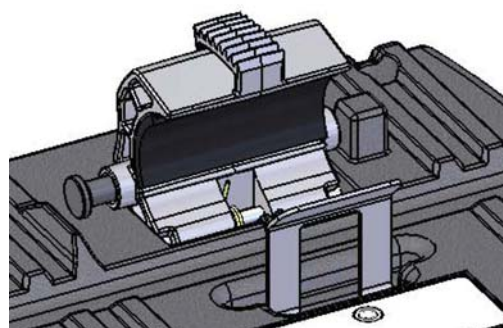

5

Find a wire harness for mounting the MVAC within 2 feet of the OBD port. Once installed, the MVAC must NOT interfere with the driver's operation of the vehicle (pedals, steering, etc.). Make sure the weight of the MVAC will not damage or pull out the cables from their connectors. If the MVAC is installed against a vehicle surface (e.g. metal plate), verify that the I.D. Systems logo is facing against the surface, so that the clip side is visible and accessible after installation.

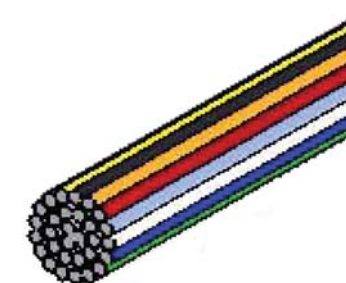

3/8-inch actual



3/4-inch actual



MINIMUM SIZE <--- BUNDLE ---> MAXIMUM SIZE

6

Tightly clip the MVAC latch around the cable/wire harness that has a diameter of 3/8" to 3/4". Make sure the MVAC does not slide or rub against the wires. If it does, use a thicker bundle.

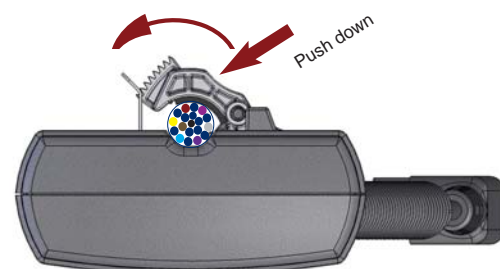

NOTE: Secure the MVAC so that it will not cause rattles, knocks, or vibrations. Carefully avoid contact or interference with the Park Brake Mechanism, Steering Knuckles, or any other moving parts. Avoid areas near heater outlet vents. If needed, use large nylon cable ties to mount the MVAC in a safe and secure position.

7

Route the MVAC cord to the OBD port. Wrap the cord around cables and the OBD port where possible to ensure it does not interfere with the driver's operation of the vehicle. Then plug it into the OBD port.

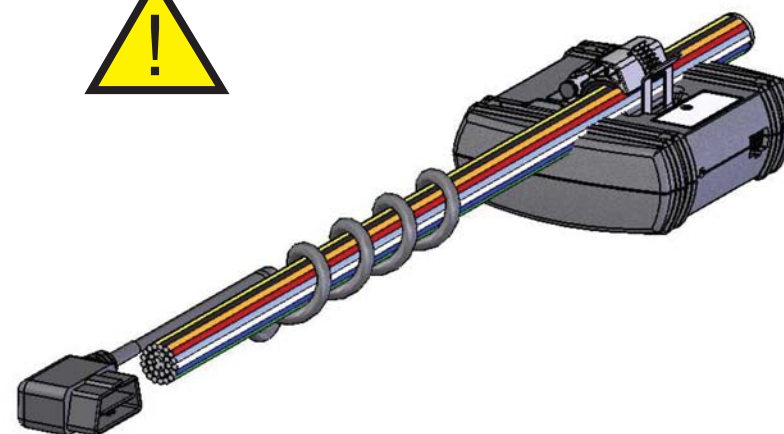

Slide the pin back in place to lock the clamp

Removing the Unit from the Vehicle (refer to install instructions for image references)

- Remove key from vehicle
- Unplug MVAC from OBD port
- Put the OBD plug taped to the MVAC harness back into the OBD port (if it exists)
- Unwrap MVAC cord as required
- Pull back the locking pin
- Open the mounting latch
- Remove MVAC
- Store MVAC for future use