



LEICA 6376

QUICK START GUIDE



Download the full scope instruction manual here:

<https://en.leica-camera.com/Service-Support/Support/Downloads>

Please register via the following link if you would like to receive a printed copy of the full scope instruction manual:

www.order-instructions.leica-camera.com

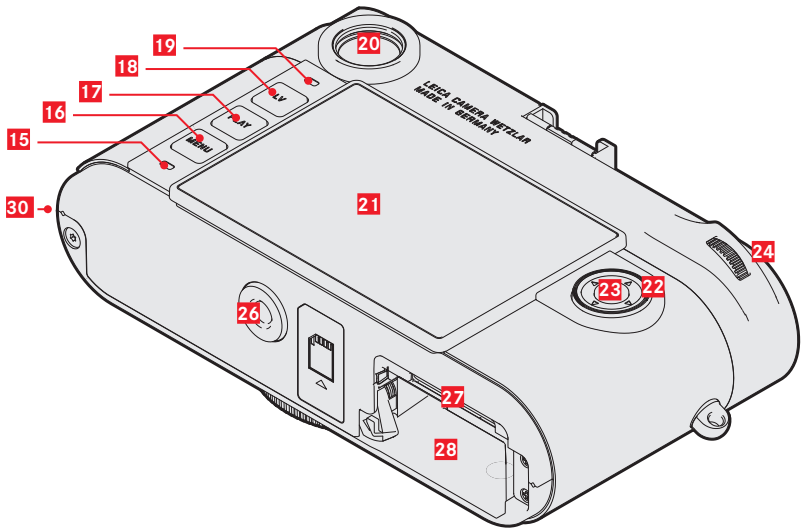
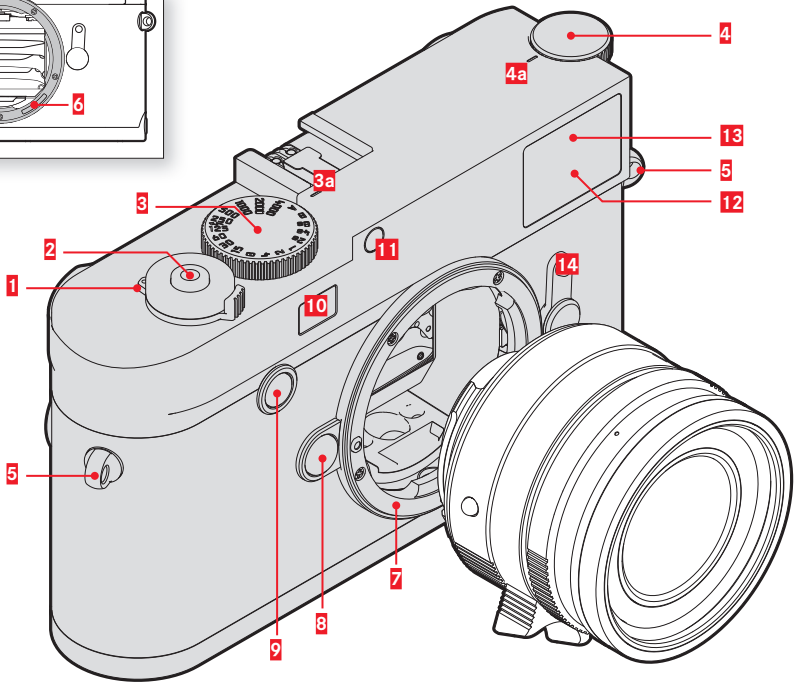
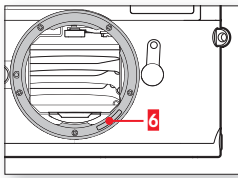

TOP VIEW

1 Main switch

Switching the camera ON/OFF

2 Shutter button

- Tap:
activates exposure metering and control
- Press down fully:
the picture is taken
- In standby mode:
The camera is reactivated

3 Shutter speed setting wheel with stop positions

- **A**: Automatic shutter speed control
- **8s - 4000**: Shutter speeds
(inc. intermediate values)
- **B**: Long-term exposure
(8 s - 4 min via menu control, in full increments or Bulb)
- **⚡**: Flash sync speed (1/180 s)

a Index

4 ISO setting wheel

- **A**: Automatic ISO sensitivity control
- **100 - 6400**: Fixed ISO values
- **M**: Manual ISO sensitivity control

a Index

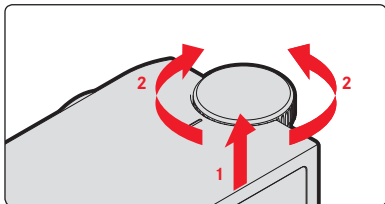

5 Strap lugs

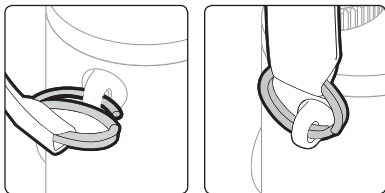

6 6-bit encoding

sensor for lens detection

7 Bayonet

8 Lens release button

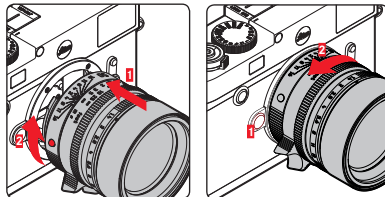

9 Focus button

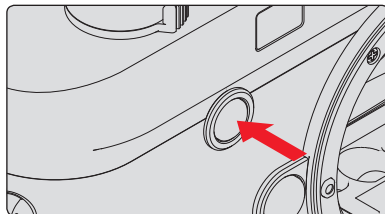

10 Rangefinder viewing window

11 Brightness sensor

12 Viewfinder viewing window

13 Self-timer LED

14 Image field selector

for the selection of bright-line frame pairs
35/135 mm, 50/75 mm and 28/90 mm

15 LED for recording / data storage

16 MENU button

- for accessing the **FAVORITES** menu/**MAIN MENU**
- for exiting the **FAVORITES** menu,
the **MAIN MENU** or any of the submenus

17 PLAY button

- for (continuous) playback mode
activation/deactivation
- for return to full-screen display

18 LV button

- for Live View mode activation/deactivation

19 Brightness sensor for LCD panel

20 Viewfinder eyepiece

21 LCD panel

22 Directional pad

- for menu navigation
- for menu item/function selection
- for scrolling through the picture memory

23 Center button

- to access the status display
- to apply menu settings
- to display settings/data during exposure
- for display of picture data during picture review

24 Thumbwheel

- for menu navigation
- for menu item/function selection
- for exposure compensation value selection
- for enlarging/reducing viewed pictures
- for scrolling through the picture memory

BOTTOM VIEW

25 Locking toggle for bottom cover

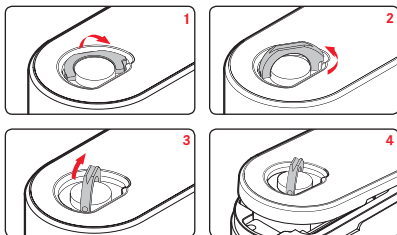

26 Tripod thread A 1/4, DIN 4503 (1/4")

27 Memory card slot

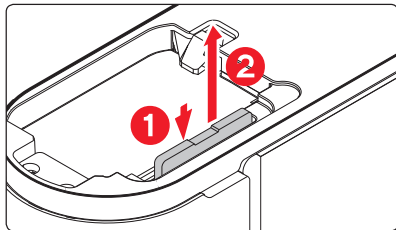

28 Battery compartment

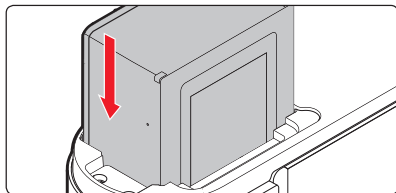

29 Battery locking latch

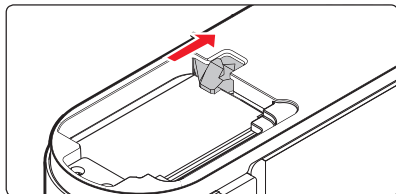

30 Bottom cover locking point

CHARGING THE BATTERY

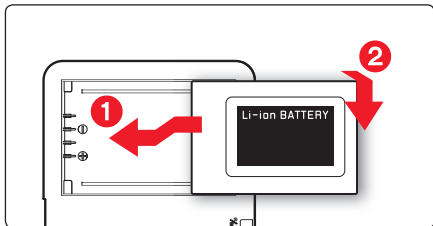

A flashing green status LED indicates a correctly functioning charging process. A fully charged battery is indicated by a steady green light.

DISPLAYS IN THE VIEWFINDER

The bright-line frame rangefinder of this camera is not just particularly bright viewfinder – it also doubles as a lens-coupled rangefinder. All Leica M lenses with focal lengths between 16 and 135 mm are coupled automatically.

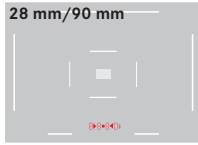
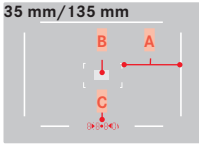

- A** Bright-line frame
- B** Metering field for focusing
- C** Digital display

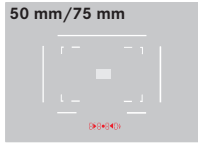

FOCUSING

SUPERIMPOSED IMAGE METHOD (DOUBLE IMAGE)



out of focus

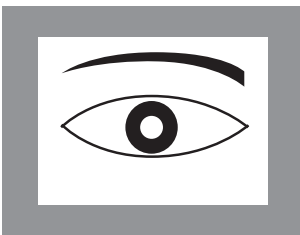

in focus

DISPLAYS ON THE LCD PANEL

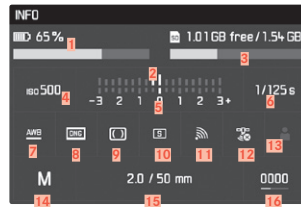

- 1** Battery capacity
- 2** Exposure compensation scale
- 3** Remaining memory card capacity
- 4** ISO Sensitivity
- 5** Light balance
- 6** Shutter speed
- 7** White Balance mode
- 8** File format/compression level/resolution
- 9** Exposure metering method
- 10** Shutter button/Drive Mode
- 11** WLAN status
- 12** GPS status
- 13** User profile
- 14** Exposure mode
- 15** Light intensity/focal length or lens type
- 16** Remaining number of pictures

SPLIT IMAGE METHOD

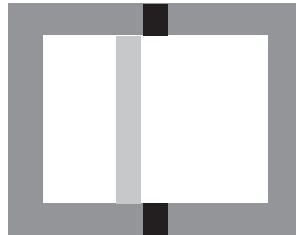

out of focus



in focus

GESTURE CONTROL



Tap
briefly



Tap
twice



horizontal/vertical
swipe



Two-finger
pinch/spread

PICTURES

FOCUS AID IN LIVE VIEW



SHIFT FOCUS POINT FOR FOCUS AID¹ AND EXPOSURE METERING²

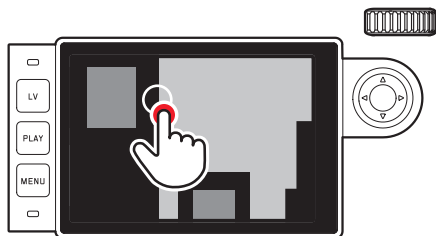

¹ Focus Aid is activated by turning the lens

² In combination with spot exposure metering

REVIEW

SWITCHING BETWEEN PICTURE MODE/REVIEW



MAGNIFY/REDUCE

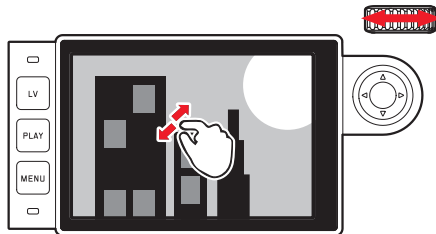

SCROLL

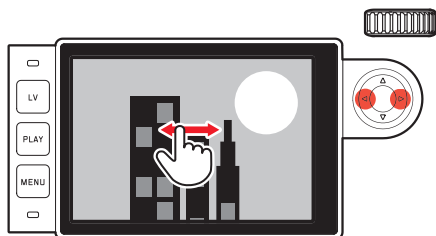

DELETE/RATE

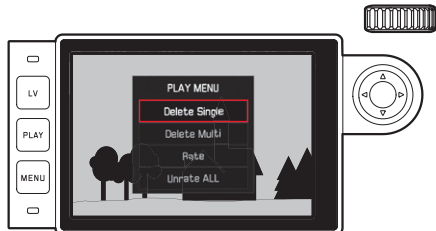

All other operations are accessible by invoking the relevant function from the menu list.

JOINING A WLAN

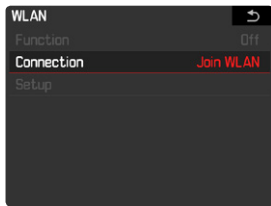

- ▶ Select **WLAN** in the main menu
- ▶ Select **Connection** in the same submenu
- ▶ Select **Join WLAN**
- ▶ Select **Configuration** in the same submenu
- ▶ Select the desired WLAN from the network list or enter a hidden network via the **Add network** option
- ▶ Press the center button to confirm the selected network

DIRECT CONNECTION WITHOUT WLAN

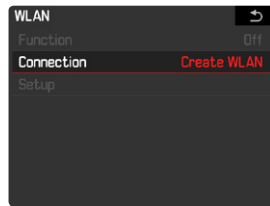

- ▶ Select **WLAN** in the main menu
- ▶ Activate **(ON)** **Function** in the submenu
- ▶ Select **Connection** in the same submenu
- ▶ Select **Create WLAN**

MENU OVERVIEW

	Factory settings FAVORITES	Available for FAVORITES
Lens Detection		✘
Drive Mode	✘	✘
Exp. Metering		✘
Exp. Compensation	✘	✘
Flash Settings	✘	✘
ISO Setup		✘
	✘	M-ISO also available
White Balance	✘	✘
File Format	✘	✘
JPG Settings		✘
	✘	JPG Resolution also available
Auto Review		✘
Capture Assistants		✘
EVF/Display Control		✘
User Profiles		✘
		Load Profile also available
Customize Control		✘
Display Brightness		✘
EVF Brightness		✘
Auto Power Saving		✘
WLAN		✘
GPS		✘
Date & Time		✘
Language		✘
Reset Camera		✘
Format SD card		✘
Image Numbering		✘
Sensor Cleaning		✘
Camera Information		✘

¹ This menu item is only available if the Leica Visoflex viewfinder is attached (available as an accessory).

TECHNICAL DATA

Camera name

Leica 6376

Camera type

Digital camera with rangefinder system

Type No.

6376

Order No.

20 002 (black), 20 003 (silver)

Lens mount

Leica M bayonet

Compatible lenses

Leica M lenses, Leica R lenses via adapter

Sensor

CMOS chip, active surface approx. 24 x 36 mm

Storage media

SD cards 1-2 GB / SDHC cards up to 32 GB / SDXC cards up to 2 TB

Viewfinder

Large, bright-line frame rangefinder and automatic parallax compensation

LCD panel

3" TFT LCD, 1.04 MP, touch control available

WLAN

The Leica FOTOS app is required to use of the WLAN function. The Leica app is available from the Apple App Store™ or the Google Play Store™. Complies with WiFi standard IEEE802.11b/g/n, 2.4 GHz, channel 1-11, frequency range 2412-2462 MHz, max. output power <9 dBm. Standard WLAN protocol, encryption method: WLAN-compatible WPA™/WPA2™

Power supply (Leica BP-SCL5)

1 lithium-ion rechargeable battery, rated voltage 7.4 V; capacity 1100 mAh, max. charging voltage/current: 1000 mA DC, 7.4 V; operating conditions (in the camera): +0 to +40°C; manufacturer:

PT. VARTA Microbattery, Made in Indonesia

Charger (Leica BC-SCL5)

Inputs: 100-240 VAC, 50/60 Hz, 300 mA with automatic switch-over or 12 VDC, 1.3 A, output: DC, rated voltage 7.4 V, 1000 mA / max.

8.25 V, 1100 mA, operating conditions: +10 to +35°C, manufacturer: Guangdong PISEN Electronics Co. Ltd., Made in China

Housing

Full metal housing: Magnesium die-cast, synthetic leather covering

Top cover and bottom cover: Brass, black or silver chrome-plated finish

Dimensions (WxHxD)

139 x 38.5 x 80 mm

Weight

approx. 675 g (with battery)

You will find the manufacturing date of your camera on the stickers in the Warranty Card and/or on the packaging. The format is year/month/day. Subject to changes in design and production.

SAFETY REMARKS

GENERAL INFORMATION

- Do not use your camera in the immediate vicinity of devices with powerful magnetic, electrostatic or electromagnetic fields (e.g. induction ovens, microwave ovens, television sets or computer monitors, video game consoles, cell phones, broadcasting equipment). Their electromagnetic fields can interfere with recordings.
- Image recording may be affected if you place the camera on a television set or operate the camera in its vicinity or near a cell phone.
- Strong magnetic fields, e.g. from speakers or large electric motors, can damage the stored picture data or disrupt recording.
- Switch off the camera, remove the battery and switch the camera back on if the camera malfunctions due to the effects of electromagnetic fields.
- Do not use the camera in the immediate vicinity of radio transmitters or high-voltage power lines. Their electromagnetic fields can also interfere with recordings.
- Always store small parts e.g. the accessory shoe cover as follows:
 - out of the reach of children
 - in a safe location, where they will not get lost or stolen
- State-of-the-art electronic components are sensitive to static discharge. You can easily pick up charges of several 10,000 volts by simply walking on synthetic floor coverings. A static discharge can occur when you touch the camera, and especially if it is placed on a conductive surface. A static discharge on the camera housing poses no risk for the electronics. Despite built-in safety circuits, you should avoid direct contact with external camera contacts like those in the flash shoe.
- Take care not to soil or scratch the sensor for lens detection (6-bit encoding) in the bayonet. You must similarly prevent direct contact of the bayonet with grains of sand or similar particles, as these could cause irreparable damage. This camera component must only be cleaned with a dry cloth.
- Use a cotton or linen cloth instead of an optical micro-fiber cloth (synthetic). Before touching the contacts, you can make sure you discharge any electrostatic charge by deliberately touching a heating or water pipe (conductive, grounded material). Dirt deposits and oxidation on the contacts can be avoided by storing your camera in a dry location with the lens cap and flash shoe cap attached.
- Use only accessories specified for this model to prevent faults, short circuits or electric shock.
- Do not attempt to remove parts of the housing (covers) yourself. Repairs must be done at authorized service centers only.
- Protect the camera against contact with insect sprays and other aggressive chemicals. Petroleum spirit, thinner and alcohol must not be used for cleaning. Some chemicals and liquids can damage the camera housing or the surface finish.
- Rubber and plastics are known to expel aggressive chemicals and should therefore not be kept in contact with the camera for extended periods of time.
- Prevent any sand or dust or water penetration into the camera, e.g. during snowfall or rain or on the beach. Be extra careful when changing the lens and inserting or removing the memory card and battery. Sand and dust can damage the camera, the lens, the memory card and the battery. Moisture can cause malfunctions and irreparable damage to the camera and memory card.

LENS

- A camera lens can have the effect of a magnifying glass when exposed to direct frontal sunlight. The camera must therefore be protected against extended exposure to direct sunlight. Using the lens cap and keeping the camera in the shade or ideally in its camera case will help prevent damage to the interior of the camera.

BATTERY

- Improper use of the batteries or the use of unapproved battery types may result in an explosion!
- Do not expose the rechargeable battery to sunlight, heat, humidity or moisture for prolonged periods of time. Likewise, the batteries must not be placed in a microwave oven or a high-pressure container as this would pose a fire or explosion hazard.
- Do not under any circumstances charge or insert a damp or wet battery!
- A safety valve in the battery ensures that any excess pressure caused by improper handling is discharged safely. It is nevertheless important to dispose of a bloated battery immediately. This battery will pose an explosion hazard!
- Keep the battery contacts clean and easily accessible. Although lithium-ion batteries are secured against short circuits, they should still be protected against contact with metal objects like paper clips or jewelry. A short-circuited battery can get very hot and cause severe burns.
- When a battery is accidentally dropped, make sure to check the housing and the contacts immediately for any damage. A damaged battery can damage the camera.
- In case of noise, discoloration, deformation, overheating or leaking fluid, the battery must be removed from the camera or charger immediately and replaced. Continued use of the battery may result in overheating, which can cause fire and/or explosion!
- Never throw batteries into a fire as they might explode!
- Keep the battery away from sources of heat in case of a leak or a smell of burning. Leaked fluid can catch fire!
- The use of other chargers not approved by Leica Camera AG can cause damage to the batteries and, in extreme cases, may cause serious or life-threatening injuries.
- Connect the charger to a freely accessible power socket.
- The car charging cable supplied must never be connected while the charger is connected to the mains.
- Battery and charger must not be opened. Repairs must only be carried out by authorized service centers.
- Keep batteries out of the reach of children. Batteries can cause suffocation when swallowed.

CHARGER

- Using the charger in the vicinity of broadcasting receivers may interfere with the reception of the device. Ensure a distance of at least 1 m (3 ft) between the charger and the receiver.
- When the charger is in use, it may emit a buzzing sound – this is normal and not a malfunction.
- Disconnect the charger from the mains when it is not in use, because it consumes some (a very small amount) electricity, even when no battery is inserted.
- Always keep the charger contacts clean, and never short circuit them.
- The car charging cable supplied must only be operated in 12V in-car grids and must never be connected while the charger is connected to mains electricity.

MEMORY CARDS



- Never remove the memory card during a datasave or card reading process. The camera must not be switched off or be subjected to impact or vibrations while working.
- Do not open the cover/remove the memory card or the battery while the status LED is lit, which indicates memory access. Data on the card may otherwise be destroyed and camera malfunctions may occur.
- Do not drop or bend memory cards as this will cause damage and result in the loss of the stored data.
- Do not touch the connections on the reverse of the memory card and keep them clean and dry.
- Keep memory cards out of the reach of children. Swallowing a memory card may cause suffocation.

SENSOR

- Cosmic radiation (e.g. during flights) may cause pixel defects.

CARRY STRAP

- Once you have attached the carry strap, please make sure that the clips are mounted correctly to prevent the camera from falling.
- Carry straps are usually made of very robust material. You should therefore keep it out of the reach of children. A carry strap is not a toy and poses a strangulation risk.
- Use the carry straps only for their intended purpose on a camera or on binoculars. Any other use poses the risk of injury and may possibly result in damage to the carry strap and is therefore not permitted.
- Carry straps should also not be used for cameras/binoculars during sports activities with a high risk of getting entangled in the carry strap (e.g. mountain climbing and similar outdoor activities).

 Alternating current (AC)	 Class II devices (the product has a double-insulated design)
 Direct current (DC)	

REGULATORY INFORMATION

Specific regional approvals for this device can be found in the camera menu.

- ▶ Select **Camera Information** in the main menu
- ▶ Select **Regulatory Information** from the submenu



DISPOSAL OF ELECTRIC AND ELECTRONIC EQUIPMENT

(Applies within the EU and for other European countries with active waste separation policies)

This device contains electric and/or electronic components which must not be disposed of in general household waste. Instead, it should be disposed of at a recycling collection point provided by your local authority. This service is free of charge. Any standard or rechargeable batteries used in this device must be removed and disposed of separately in accordance with local regulations.

Please contact your local authorities, waste disposal collection point or the retailer, from whom you purchased the device for more information on correct waste disposal.

English		
Declaration of Conformity (DoC)		
Hereby, "Leica Camera AG" declares that this product is in compliance with the essential requirements and other relevant provisions of Directive 2014/53/EU.		
Customers can download a copy of the original DoC to our RE products from our DoC server: www.cert.leica-camera.com		
In case of further questions, please contact: Leica Camera AG, Am Leitz-Park 5, 35578 Wetzlar, Germany		
Product dependent (see technical data)		
Type	Frequency band (central frequency)	Maximum power (dBm e.i.r.p.)
WLAN	2412-2442/5180-5240 MHz/ 5745-5925/5925-5970 MHz	20
Bluetooth® Wireless Technology	2402-2480 MHz	20

The CE mark on our products documents compliance with the fundamental requirements of applicable EU directives.

FOR UNITED ARAB EMIRATES ONLY:

UAE-TRA REGISTERED No.: ERXXXX/XX DEALER No.: DA0112968/13

FOR SINGAPORE ONLY:

Complies with IMDA Standards DA106734
--

FOR US ONLY:**FCC NOTE:**

This equipment has been tested and found to comply with the limits for a Class B digital device, pursuant to Part 15 of the FCC Rules. These limits are designed to provide reasonable protection against harmful interference in a residential installation. This equipment generates, uses, and can radiate radio frequency energy and, if not installed and used in accordance with the instructions, may cause harmful interference to radio communications. However, there is no guarantee that interference will not occur in a particular installation. If this equipment does cause harmful interference to radio or television reception, which can be determined by turning the equipment off and on, the user is encouraged to try to correct the interference by one or more of the following measures:

- Reorient or relocate the receiving antenna.
- Increase the separation between the equipment and receiver.
- Connect the equipment into an outlet on a circuit different from that to which the receiver is connected.
- Consult the dealer or an experienced radio/TV technician for help.

FCC CAUTION:

To assure continued compliance, follow the attached installation instructions and use only shielded interface cables with ferrite core when connecting to computer or peripheral devices. Any changes or modifications not expressly approved by the party responsible for compliance could void the user's authority to operate this equipment.

Declaration of Conformity

Trade Name: Leica

Model No.: 6376

Responsible party/Support contact:

Leica Camera Inc.

1 Pearl Court, Unit A

Allendale, New Jersey 07401

Tel.: +1 201 995 0051

Fax: +1 201 995 1684

technicalinfo@leicacamerausa.com

Type No.: 6376



Tested To Comply
With FCC Standards

FOR HOME OR OFFICE USE

This device complies with Part 15 of the FCC Rules. Operation is subject to the following two conditions: (1) This device may not cause harmful interference, and (2) this device must accept any interference received, including interference that may cause undesired operation.

FCC ID: N5A6376

This transmitter must not be co-located or operated in conjunction with any other antenna or transmitter. This equipment complies with FCC radiation exposure limits set forth for an uncontrolled environment and meets the FCC radio frequency (RF) Exposure Guidelines. This equipment is tested for specific absorption ratio (SAR) and complies with FCC/IC radiation exposure limits set forth for an uncontrolled environment. This device complies with FCC/IC SAR limit of 1.6 W/kg. For body worn operation, this equipment has been tested and meets the FCC/IC RF exposure guidelines when used with the Leica Camera AG accessories supplied or designated for this product that have no metallic component in the assembly. Use of other accessories may not ensure compliance with FCC/IC RF exposure guidelines.

FOR CANADA ONLY:**CAN ICES-3 (B)/NMB-3(B)**

This device complies with Industry Canada licence-exempt RSS standard(s).

Operation is subject to the following two conditions:

- (1) This device may not cause harmful interference,
- (2) This device must accept any interference received, including interference that may cause undesired operation of the device. This equipment complies with IC radiation exposure limits set forth for an uncontrolled environment and meets RSS-102 of the IC radio frequency (RF) Exposure rules.

This equipment is tested for specific absorption ratio (SAR) and complies with FCC/IC radiation exposure limits set forth for an uncontrolled environment. This device complies with FCC/IC SAR limit of 1.6 W/kg. For body worn operation, this equipment has been tested and meets the FCC/IC RF exposure guidelines when used with the Leica Camera AG accessories supplied or designated for this product that have no metallic component in the assembly. Use of other accessories may not ensure compliance with FCC/IC RF exposure guidelines.