

8610 Einfetten mit Shell Gadus S2 V100 2
grease with Shell Gadus S2 V100 2

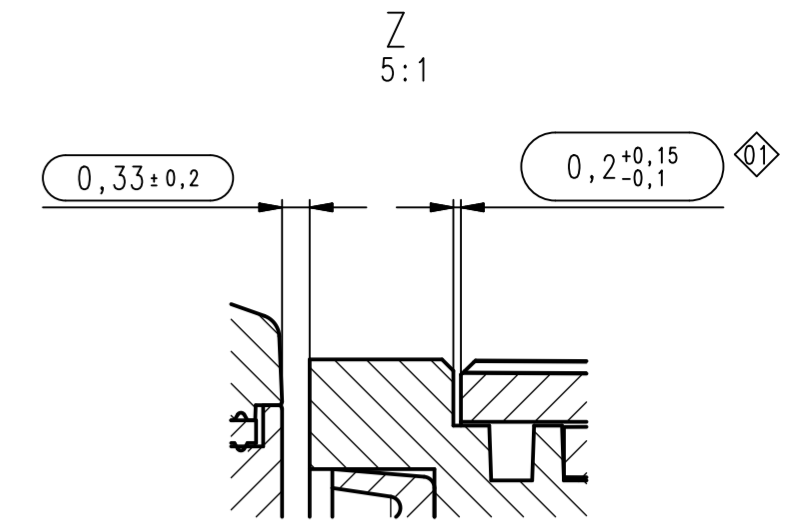

4191468 - 4191470
Radio Type is without data slot

Anziehdrehmoment
Torque
30 ±3 Ncm

Anziehdrehmoment
Torque
15 ±2 Ncm

Einkleben mit Loctite 222
glued with Loctite 222

8600

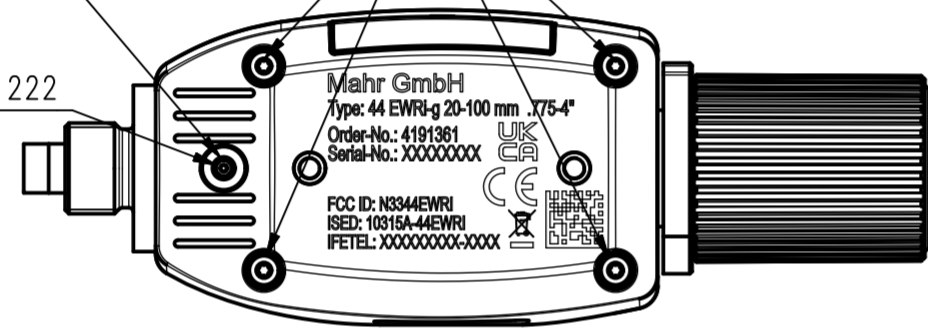

Mahr GmbH
Type: 44 EWR-g 20-100 mm „75-4“
Order-No.: 4191361
Serial-No.: XXXXXXXXX
FCC ID: N3344EWR1
ISED: 10315A-44EWR1
P/ETEL: XXXXXXXXX-XXXX

A-A

Z

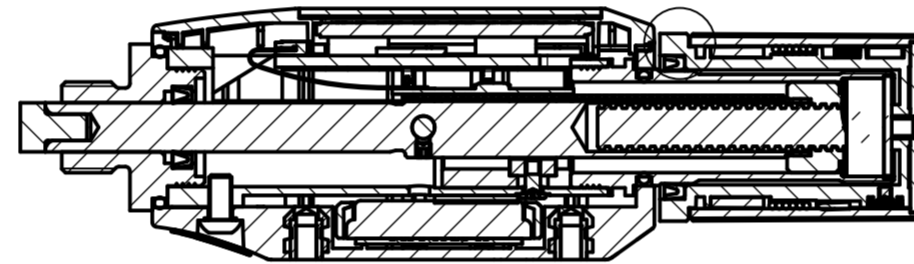

Anziehdrehmoment
Torque
3 ±1 Ncm

Einkleben mit Loctite 222
glued with Loctite 222

8600

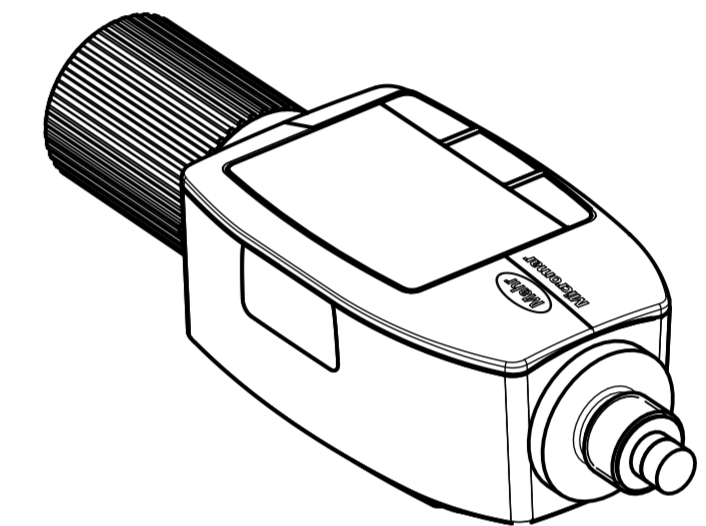

Top@B Messbolzen ausgefahren / measuring bolt pulled out

Top@C Messbolzen eingefahren/measuring bolt pulled in

6 - 20 mm

20 - 100 mm and 100 - 200 mm

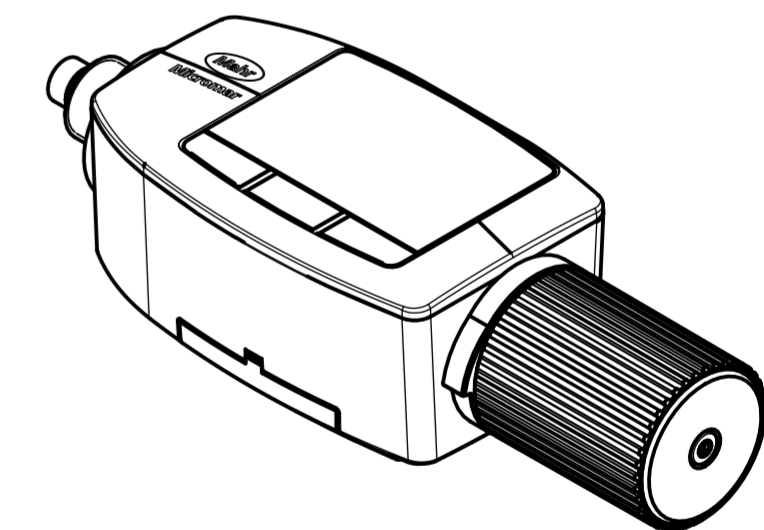
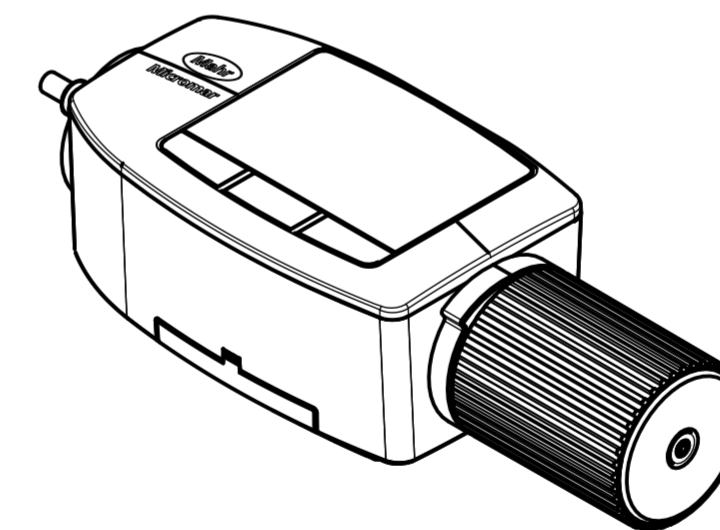
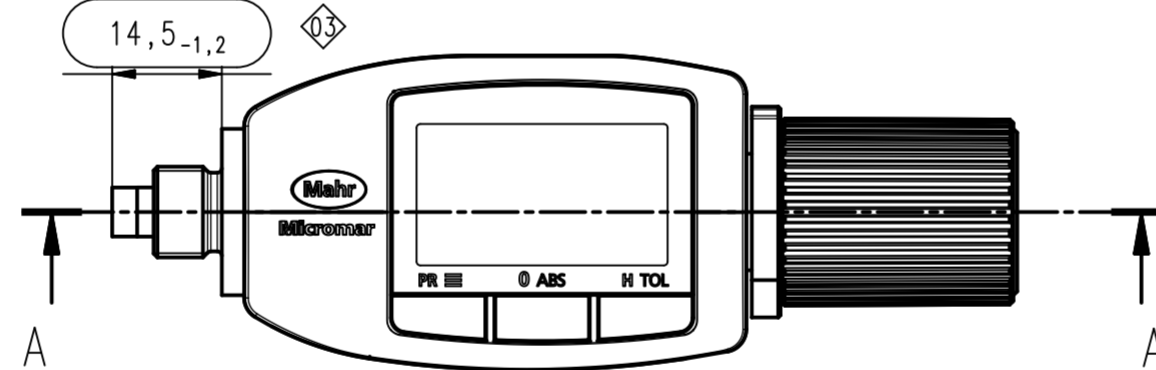
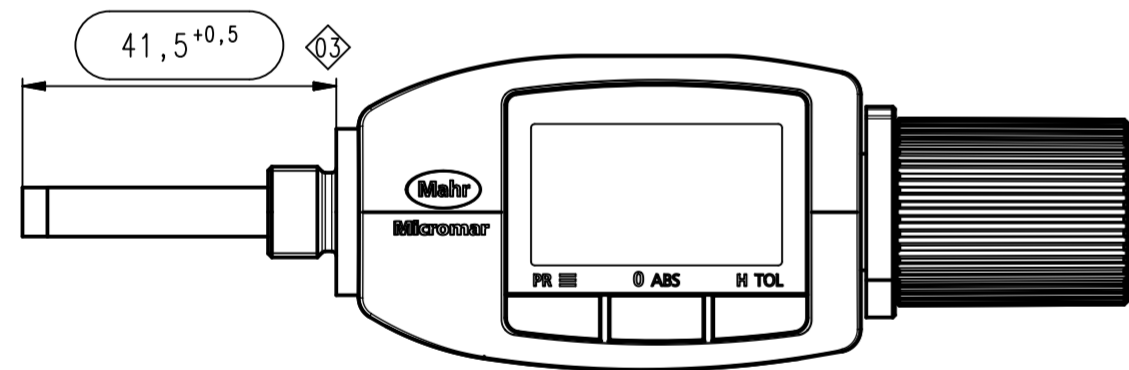

6 - 20 mm Messbolzen ausgefahren / measuring bold pulled out

6 - 20 mm Messbolzen eingefahren / measuring bold pulled in

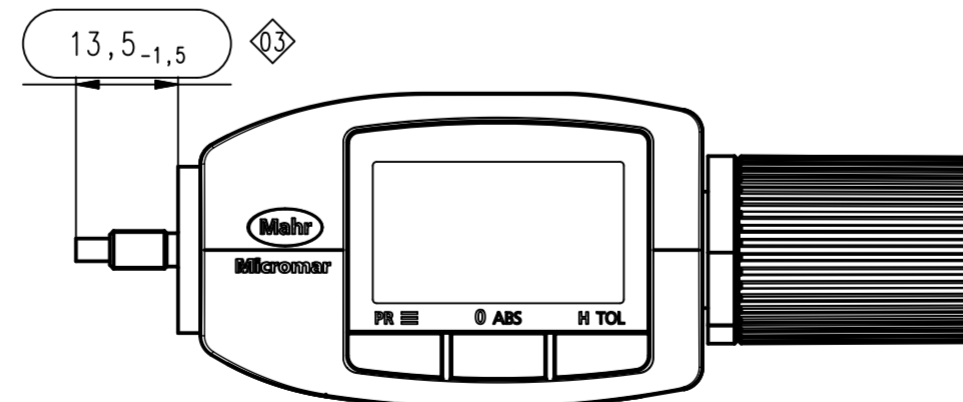
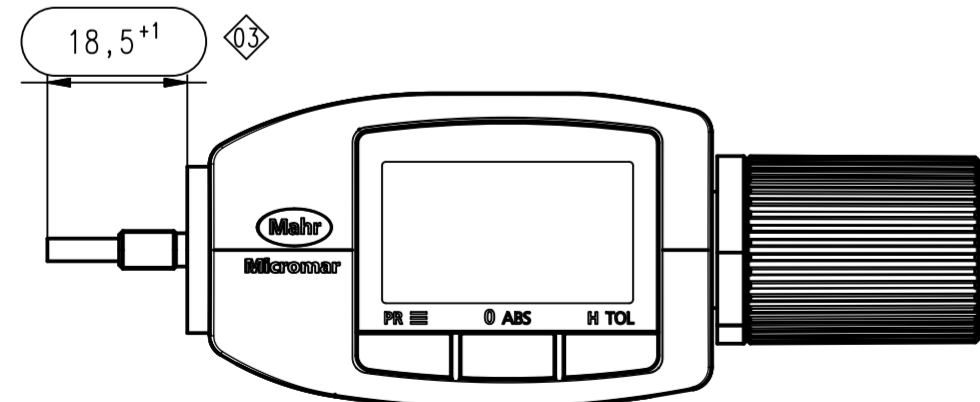

Artikel Nr./Id.-Nr.:	Benennung/Title:	Messbereich/measuring range
4191465	44 EWR-g	6-20 mm
4191466	44 EWR-g	20-100 mm
4191467	44 EWR-g	100-200 mm
4191468	44 EWRi-g	6-20 mm
4191469	44 EWRi-g	20-100 mm
4191470	44 EWRi-g	100-200 mm

Allg. Toleranzen Gen. tolerances ISO 22081 1:1 A B C refer DIN 2769-44 Linear Size: ±12 refer DIN 2769-5 Angular Size: ±13 refer DIN 2769-7 TECs according QM s. Tab. 03		Werkstückkanten Edges DIN ISO 13715 [-0,1 -0,5 0,3 0]		EA30507 Vorg.-Nr./ECC No. MA04/33-	
s. Tab. Artikel-Nr./Item No. 1:1 03 MultiTab/Scale Revision		Grundgerät 44 EWR(i)-g 6-200 mm Basic device 44 EWR(i)-g 6-200 mm		428.301.00.0201.0 Zeichnungs-Nr./Drawing No.	
Material/gefertigt aus/Make from		Härteangabe/Heat Treatment		Mahr GmbH Esslingen Reutlinger Str.48 D-73728 Esslingen	
© 2024 Mahr GmbH Proprietary and Confidential		P. Küster		1 von 4	

800407211

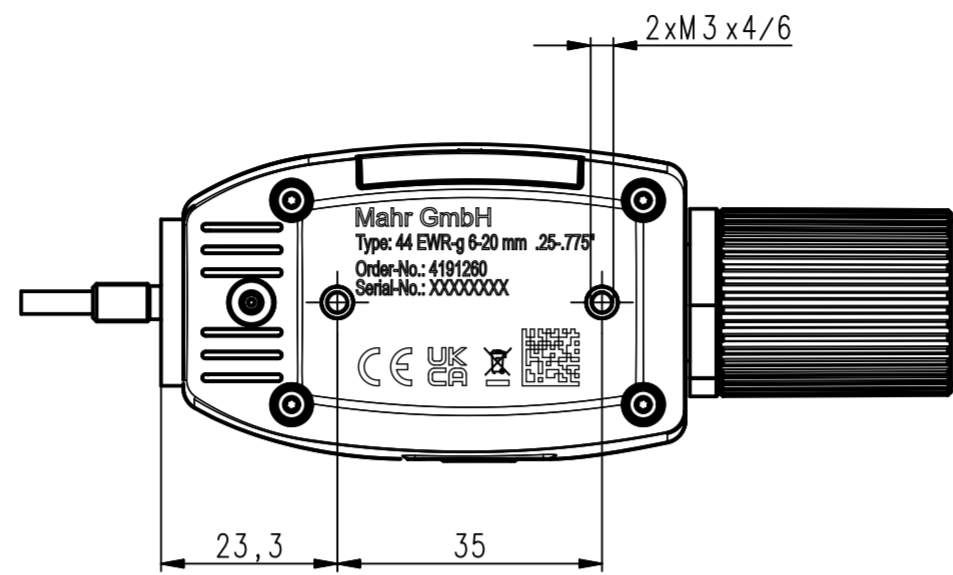
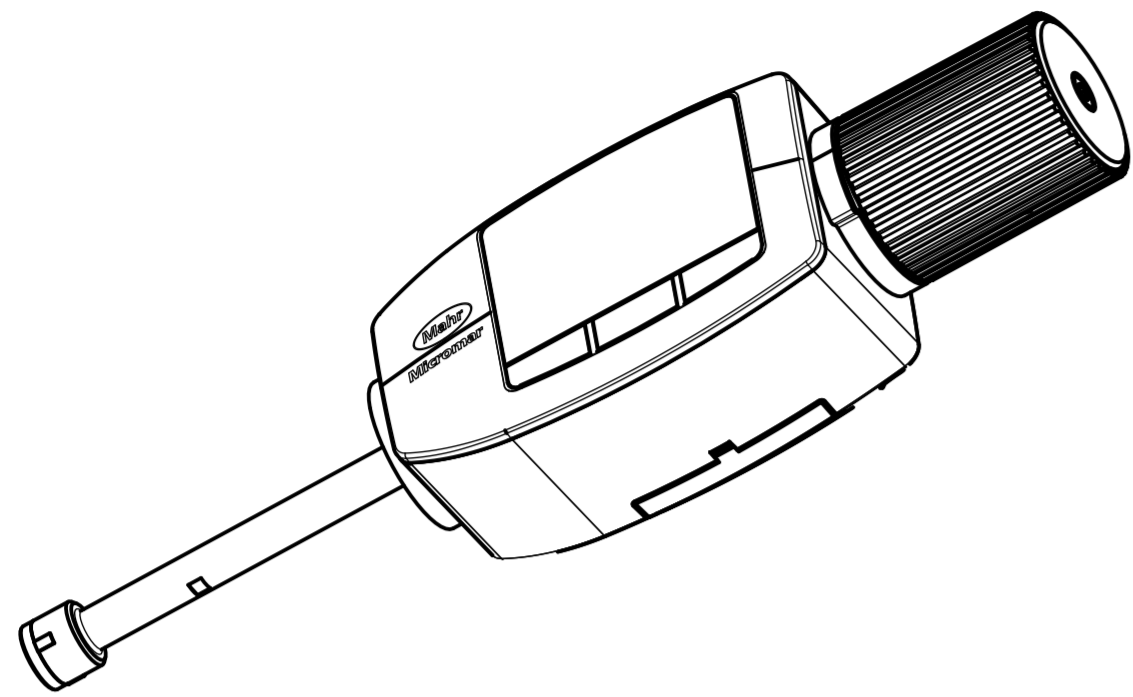

6 - 20 mm

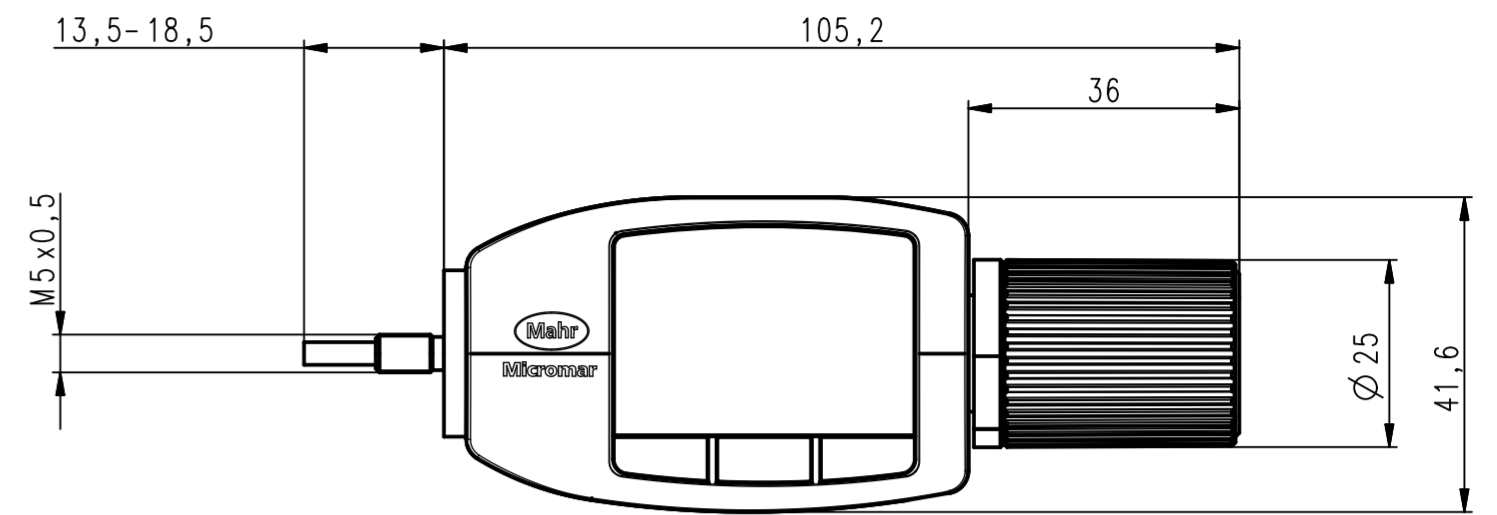

20 -100 mm, 100 - 200 mm

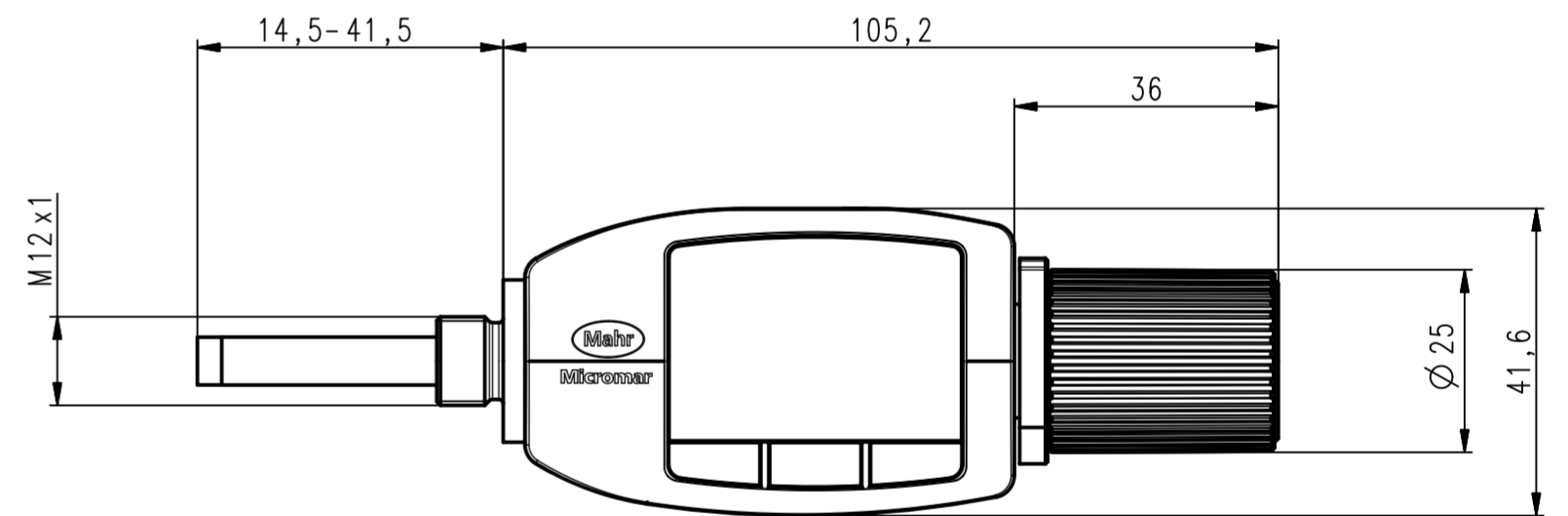
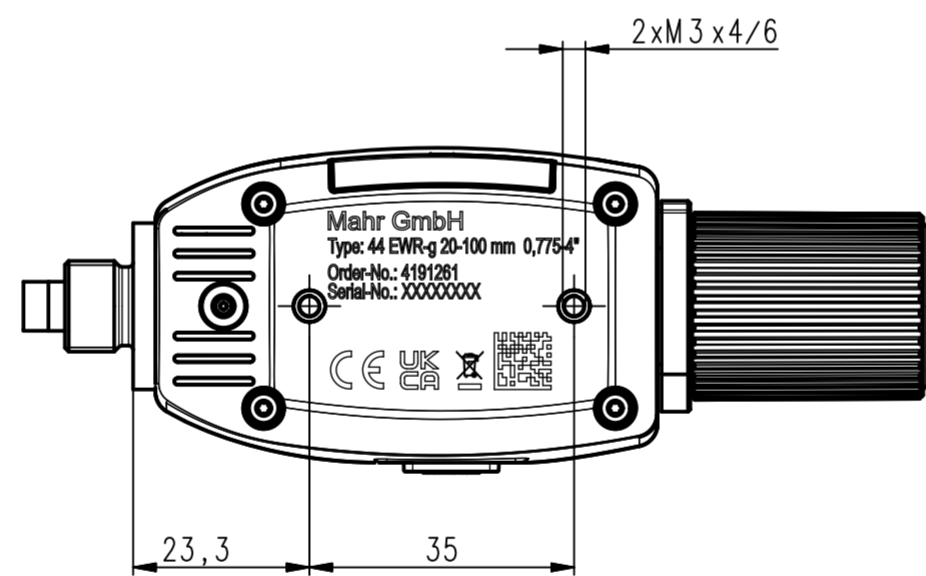
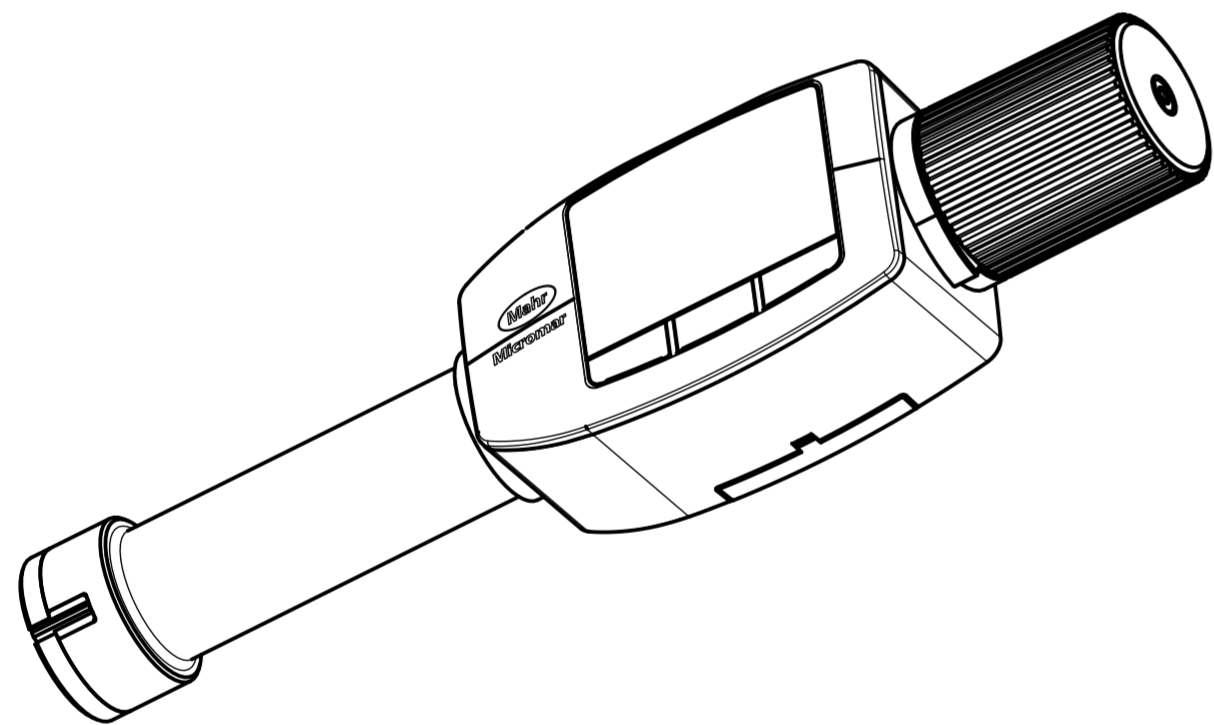

Allg. Toleranzen Gen. tolerances		ISO 22081	Werkstückkanten Edges		$\begin{matrix} -0,1 \\ -0,5 \end{matrix}$ $\begin{matrix} +0,3 \\ 0 \end{matrix}$	EA30507 Vorg.-Nr./EOD No.
Linienart Line style		refer DIN 2769-A4	Oberflächenbehandl./Finish			MA04/33-
Lineare Größe Linear Size		±12 refer DIN 2769-b	Härteangabe/Heat Treatment			Beschreibung/Label
Winkelgröße Angular Size		±13 refer DIN 2769-1	Dim. Tolerierung Dim. tolerancing		Size ISO 14405	428.301.00.0201.0
TECs according GND s. Tab. 03		Material/gefertigt aus/Made from	Zeichnungs-Nr./Drawing No.			A2
s.Tab.		Grundgerät	44 EWR(i)-g 6-200 mm		Mahr GmbH	
1:1		Basic device	44 EWR(i)-g 6-200 mm		Esslingen	
03		Revision	NX		Reutlinger Str.48	
Maßstab/Scale		2020-09-21	P. Küster		D-73728 Esslingen	
© 2024 Mahr GmbH		Proprietary and Confidential		Mahr		

03 Typenschild/type plate: 44 EWR-g und 44 EWRi-g
 Laserbeschriftung/Laser marking front: Arial bold

4191465

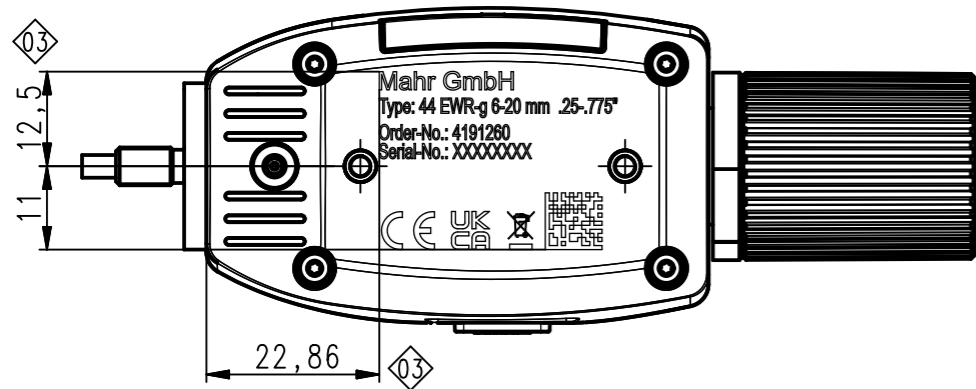

4191468

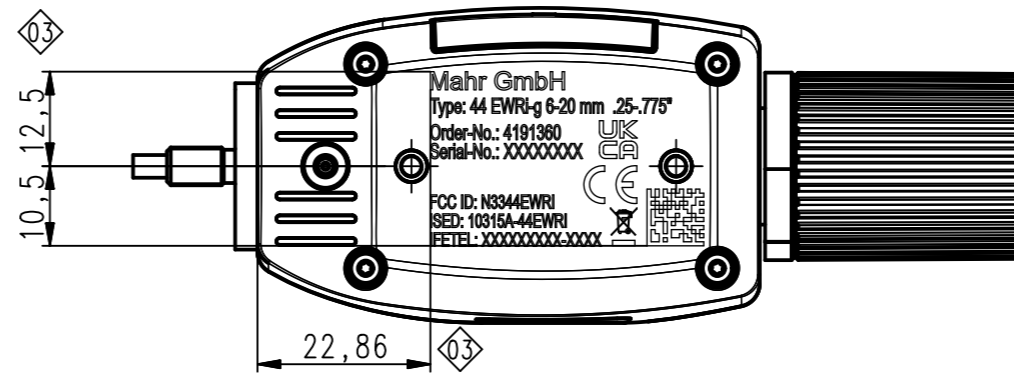

4191466

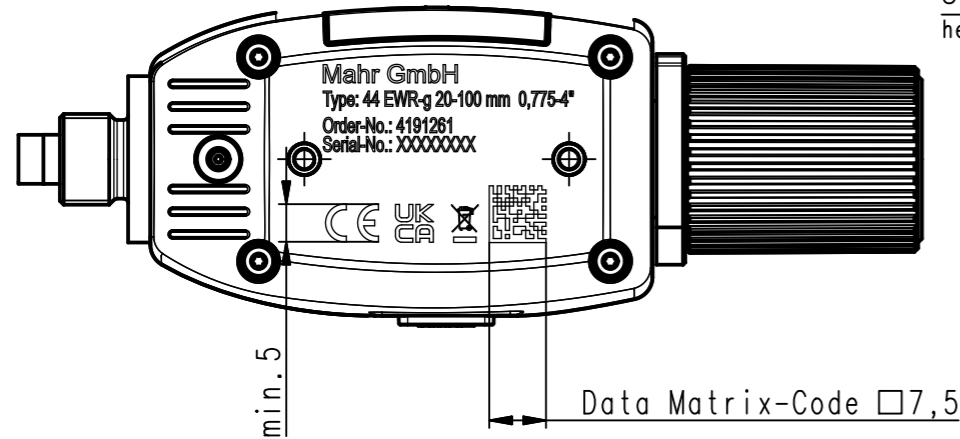

Schrifthöhe 2,4 mm
 heigh of letters 2,4 mm

Schrifthöhe 2,0 mm
 heigh of letters 2,0 mm

Schrifthöhe 1,8 mm
 heigh of letters 1,8 mm

4191469

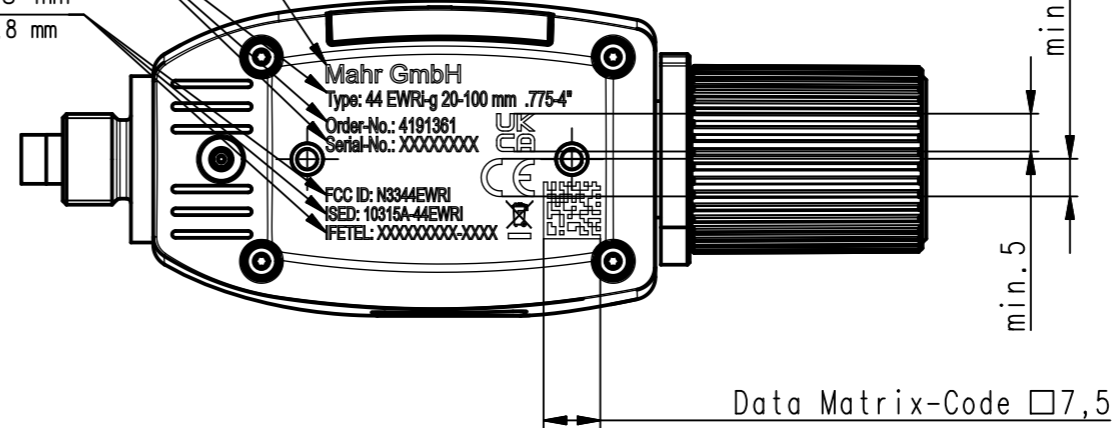

4191467

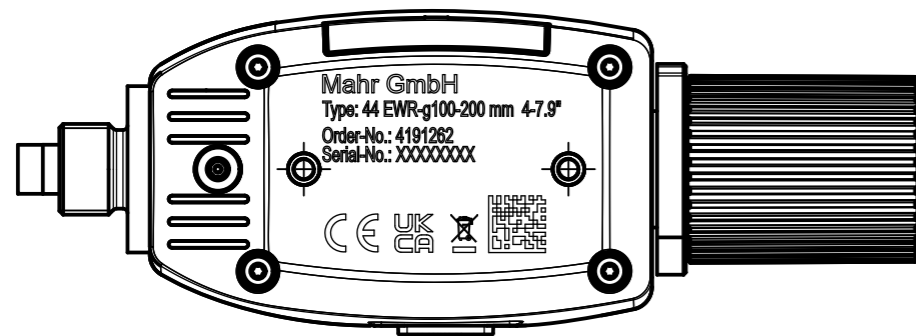

4191470

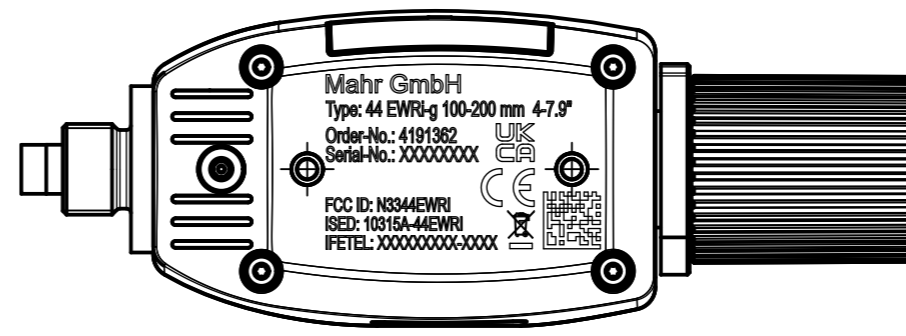

Artikel Nr./ Order No.:	Benennung/ Title:	Messbereich/ Measuring range
4191465	44 EWR-g	6-20 mm
4191466	44 EWR-g	20-100 mm
4191467	44 EWR-g	100-200 mm
4191468	44 EWRi-g	6-20 mm
4191469	44 EWRi-g	20-100 mm
4191470	44 EWRi-g	100-200 mm

Allg. Toleranzen Gen. tolerances ISO 22081		Werkstückkanten Edges DIN ISO 13715		EA30507
\square \square \square refer DIN 2769-A4 Linear Size: \pm t2 refer DIN 2769-b Angular Size: \pm t3 refer DIN 2769-1 TEDs according CAD s.Tab...D3		\square \square \square -0.1 -0.5 \square \square \square +0.3 0		Vorg.-Nr./ECO No. MA04/33-
Oberflächenbehandl./Finish		Härteangabe/Heat Treatment		Dim. Tolerierung Dim. tolerancing. Size ISO 14405
Material/gefertigt aus/Make from		Beschriftg./Label		
s.Tab.		Grundgerät		428.301.00.0201.0
Artikel-Nr./Item No.		Bezeichnung		fin / raw Blatt/Sheet 3 von 4
1:1		44 EWR(i)-g 6 -200 mm		A3
03		Basic device		
Maßstab/Scale Revision		Title		
		44 EWR(i)-g 6 -200 mm		
NX		Name		
gez./dwn.		2020-09-21		
P. Küster		© 2024 Mahr GmbH		
Proprietary and Confidential		Mahr		
		Mahr GmbH		
		Esslingen		
		Reutlinger Str.48		
		D-73728 Esslingen		

A00407211

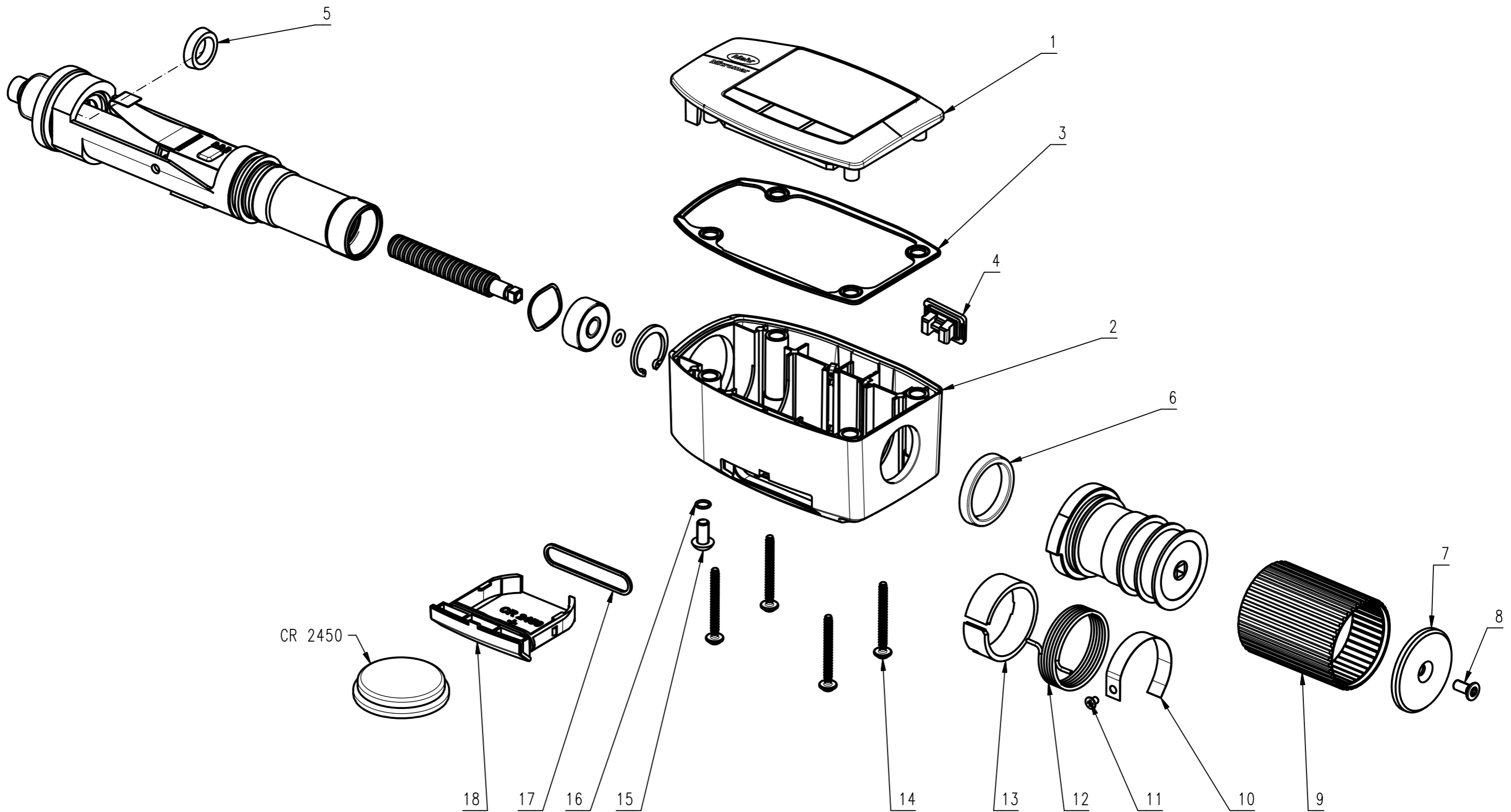

Allg. Toleranzen Gen. tolerances		ISO 22081	Werkstückkanten Edges		-0.1 -0.5	+0.3 0	EA30507
Linear Size: ±12 refer DIN 2769-b		refer DIN 2769-A4	Dim. Tolerierung Dim. tolerancing.		Size ISO 14405		Vorg.-Nr./ECO No. MA04/33-
Angular Size: ±13 refer DIN 2769-1			Härteangabe/Heat Treatment				Beschriftg./Label
TEDs according CAD s.Tab...D3		Material/gefertigt aus/Make from	428.301.00.0201.0		A3		
s.Tab.		Grundgerät	fin / raw		Blatt/Sheet		
Artikel-Nr./Item No.		44 EWR(i)-g 6 -200 mm	Zeichnungs-Nr./Drawing No.		4 von 4		
1:1		03	Basic device		Mahr GmbH		
Maßstab/Scale		Revision	Title		Esslingen		
NX		YYYY-MM-DD	Name		Reutlinger Str.48		
gez./dwn.		2020-09-21	P. Küster		D-73728 Esslingen		
			© 2024 Mahr GmbH		Proprietary and Confidential		

A0040721