

ThinkPad

ThinkPad Enterprise Wireless Display Adapter User Guide

 <http://www.lenovo.com/safety>

Note: Before installing the product, be sure to read the warranty information in Appendix B “Lenovo Limited Warranty” on page 21.

First Edition (April 2014)

© Copyright Lenovo 2014.

LIMITED AND RESTRICTED RIGHTS NOTICE: If data or software is delivered pursuant a General Services Administration “GSA” contract, use, reproduction, or disclosure is subject to restrictions set forth in Contract No. GS-35F-05925.

Contents

Chapter 1. About the wireless display adapter	1	Telephone technical support	19
Product description.	1	Appendix B. Lenovo Limited Warranty.	21
Locating connectors and controls on the wireless display adapter	2	Part 1 - General Terms	21
System requirements	3	Part 2 - Country-specific Terms	23
Chapter 2. Installing the wireless display adapter	7	Part 3 - Warranty Service Information.	26
Chapter 3. Using the wireless display adapter	11	Appendix C. Electronic emission notices	29
Connecting your notebook computer to the wireless display adapter	11	Federal Communications Commission Declaration of Conformity	29
Configuring the wireless display adapter	11	Appendix D. Notices.	41
Updating firmware of the wireless display adapter	12	Recycling information	41
Using the NFC tag with Lenovo QuickDisplay	13	Recycling information for Brazil	41
Using the wireless display adapter with the Windows Media Player through DLNA technology	13	Important WEEE information	42
Chapter 4. Frequently asked questions	15	Export Classification Notice	42
Chapter 5. Troubleshooting	17	Trademarks	42
Appendix A. Service and Support.	19	Appendix E. Restriction of Hazardous Substances Directive (RoHS)	43
Online technical support	19	European Union RoHS	43
		China RoHS.	43
		Turkish RoHS	43
		Ukraine RoHS	43
		India RoHS	43

Chapter 1. About the wireless display adapter

This chapter contains product description, connector and control locations, and system requirements for the ThinkPad® Enterprise Wireless Display Adapter (hereafter called the wireless display adapter).

Product description

The wireless display adapter is a Miracast-certified device that enables you to easily connect your notebook computer to a monitor or a projector using wireless connection. It is compatible with both Video Graphics Array (VGA) analog monitors and High Definition Multimedia Interface (HDMI) monitors. And if you cannot use the wireless connection, you can also expand your workspace to the monitor or projector by connecting the computer to the wireless display adapter with a VGA monitor cable.

Your option package includes the following:

- ThinkPad Enterprise Wireless Display Adapter
- AC power adapter
- USB 2.0 cable
- Near Field Communication (NFC) tag
- Warranty poster

Note: The NFC tag is used to work with the Lenovo® QuickDisplay software.

Contact your place of purchase if any item is missing or damaged. Ensure that you retain the proof of purchase and packing material. They might be required to receive warranty service.

Locating connectors and controls on the wireless display adapter

The following illustrations help you locate the connectors and controls on the wireless display adapter.

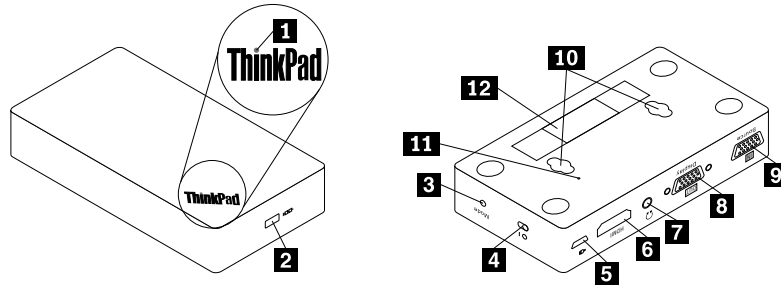

Figure 1. Overview of the wireless display adapter

1 Power indicator	2 Security-lock slot
3 Mode / WPS button	4 Power switch
5 Micro USB 2.0 connector	6 HDMI connector
7 Headset connector	8 VGA-out connector
9 VGA-in connector	10 Hang slot
11 Emergency reset hole	12 Machine type and model label

1 Power indicator

The power indicator is used to indicate the power status of the wireless display adapter. It will be lit in red in five seconds after the wireless display adapter is supplied with power.

2 Security-lock slot

The security-lock slot is used to secure the wireless display adapter with a security cable lock.

Note: The security cable lock is not included in your option package. If necessary, purchase a security cable lock.

3 Mode / WPS button

The Mode / WPS button is used to establish the wireless connection, change the wireless display adapter settings and update firmware. For more information, refer to “Configuring the wireless display adapter” on page 11.

4 Power switch

The power switch is used to turn on or turn off the wireless display adapter.

5 Micro USB 2.0 connector

The micro USB 2.0 connector is used to attach the ac power adapter for power supply to the wireless display adapter.

6 HDMI connector

The HDMI connector is used to connect an external HDMI monitor to the wireless display adapter using an HDMI cable.

7 Headset connector

The headset connector is used to connect a headset or a speaker.

8 VGA-out connector

The VGA-out connector is used to connect an external VGA monitor to the wireless display adapter using a VGA cable.

Note: The HDMI connector and the VGA-out connector cannot be used at the same time. If both of them are connected, only the VGA-out connector functions.

9 VGA-in connector

The VGA-in connector is used to connect your notebook computer to the wireless display adapter using a VGA cable. You can connect your notebook computer to the wireless display adapter either through wireless connection or using the VGA-in connector.

Note: It is not recommended that you use both the wireless connection and the VGA-in connector with multiple notebook computers at the same time. Otherwise only the screen of the notebook computer that is connected to the VGA-in connector will be displayed on the monitor.

10 Hang slot

The hang slots are used to hang the wireless display adapter on the wall with two screws.

Note: The screws are not included in your option package. If necessary, purchase two screws.

11 Emergency reset hole

If the wireless display adapter does not respond, restart the wireless display adapter by inserting a straightened paper clip into the emergency reset hole.

12 Machine type and model label

The machine type and model label identifies your wireless display adapter. When you contact Lenovo for help, the machine type and model information helps support technicians identify your wireless display adapter and provide faster service.

System requirements

Before installing the wireless display adapter, ensure that your notebook computer has one of the following operating systems installed:

- Microsoft® Windows® 7 (32-bit or 64-bit)
- Microsoft Windows 8 (32-bit or 64-bit)
- Microsoft Windows 8.1 (32-bit or 64-bit)

Depending on the operating system, the hardware or software requirements for the wireless display adapter vary. Before installing the wireless display adapter, ensure that your notebook computer meets the specific hardware or software requirements for the operating system installed.

- **For Microsoft Windows 7:** Ensure that your notebook computer has one of the following hardware or software installed:
 - Intel® Wireless Display (Intel WiDi) version 4.2.21 or later
 - Lenovo QuickDisplay (available on some models)
 - A VGA connector
- **For Microsoft Windows 8:** Ensure that your notebook computer has one of the following hardware or software installed:
 - Intel WiDi version 4.2.21 or later
 - A VGA connector
- **For Microsoft Windows 8.1:**
 - If your Windows 8.1 operating system is preinstalled, there is no hardware or software requirements for the use of the wireless display adapter.
 - If the Windows 8.1 operating system is updated from the Windows 8 operating system, you might not be able use the wireless display adapter. One possible reason is that your notebook computer does not include the Miracast driver. Contact the Lenovo Support to see if the problem can be fixed by installing the Miracast driver into your notebook computer.

Note: For the notebook computer models equipped with an NFC reader, you can use the NFC tag with Lenovo QuickDisplay 2.0 for easy wireless connection to the wireless display adapter.

The functionality of wireless connection is affected by the version of the drivers and software. If your notebook computer meets the above requirements, it is important to ensure that the following software or drivers are the most-up-date:

- Lenovo QuickDisplay
- Intel Graphics Driver
- Intel Wireless Driver
- Intel WiDi software

If you need to update the Lenovo QuickDisplay program, go to the Lenovo Support Web site:
<http://www.lenovo.com/support/WDA>

If you need to update the Intel Graphics Driver, Intel Wireless Driver, and Intel WiDi software, you can update them manually or use the Intel WiDi Update Tool.

- The Intel WiDi Update Tool can automatically check and keep the necessary software and drivers most-up-date. To use the Intel WiDi Update Tool, download and install it from Intel Support or from Lenovo Support at: <http://www.lenovo.com/support/WDA>.
- To manually update Intel Graphics Driver, Intel Wireless Driver, and the Intel WiDi software, do the following:
 1. Download and update the Intel Graphics Diver from the Lenovo Support Web site at: <http://www.lenovo.com/support>. Depending on the type and model of your notebook computer, the suitable version of the driver might vary.
 2. Download and update the Intel Wireless Driver from the Lenovo Support Web site at: <http://www.lenovo.com/support>. Depending on the type and model of your notebook computer, the suitable version of the driver might vary.

Attention: Do not download and update the Intel Graphics Driver and Intel Wireless Driver from the Intel Support Web site. The drivers provided on the Intel Support Web site have not been tested by Lenovo. Using them might cause unexpected problems.

3. Download and update the Intel WiDi software from Intel Support or from the Lenovo Support Web site at: <http://www.lenovo.com/support>.

Note: Before installing the updates of the Intel WiDi software, ensure that you have selected **Integrated Graphics** as the graphics card in the basic input/output system code (BIOS) operating system on your notebook computer.

Chapter 2. Installing the wireless display adapter

To install the wireless display adapter to an external monitor, do the following:

1. Put the wireless display adapter on a flat surface, or hang it on the wall as shown in the following illustration.

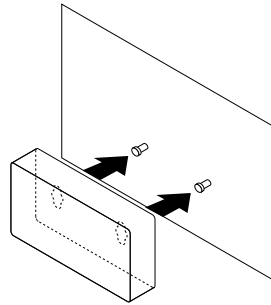

Figure 2. Hanging the wireless display adapter on the wall

2. Turn off the monitor.
3. Connect the wireless display adapter to the ac power adapter with the USB 2.0 cable. Then connect the ac power adapter to an electrical outlet.

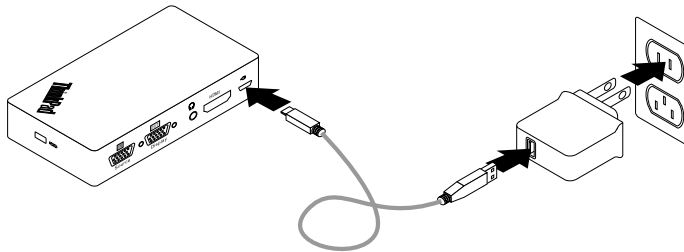

Figure 3. Connecting the wireless display adapter to an electrical outlet

4. Connect the wireless display adapter to the monitor with an HDMI cable or a VGA cable.

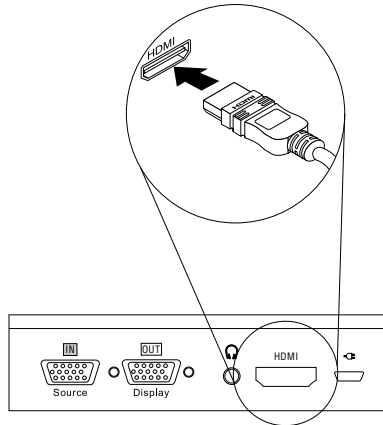

Figure 4. Connecting the wireless display adapter to the monitor with an HDMI cable

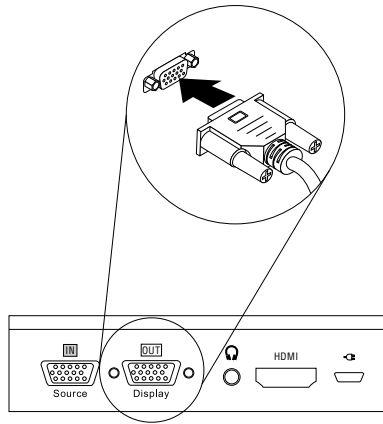

Figure 5. Connecting the wireless display adapter to the monitor with a VGA cable

- Slide the power switch to the on position to turn on the wireless display adapter. Then turn on the monitor.

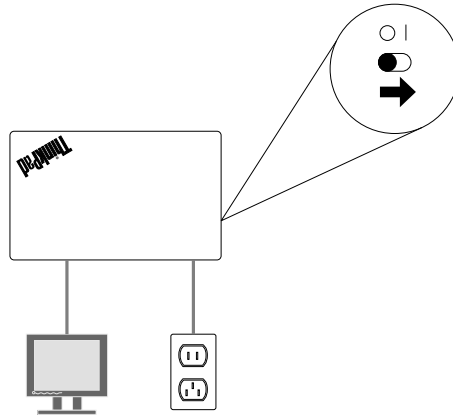

Figure 6. Sliding the power switch to the on position to turn on the wireless display adapter

- Select the source of the monitor on the screen according to the type (HDMI or VGA) of the cable connected.
- The power indicator starts to blink in five seconds. Wait until you see the splash screen on the monitor. The wireless display adapter is ready for use.

Chapter 3. Using the wireless display adapter

This chapter provides information about connecting your notebook computer to the wireless display adapter, configuring the settings and firmware of the wireless display adapter, and using the NFC tag.

Connecting your notebook computer to the wireless display adapter

To connect your notebook computer to the wireless display adapter, do the following:

- **For Windows 7 and Windows 8:**
 1. Start the Intel WiDi program or the Lenovo QuickDisplay program.
 2. In the Intel WiDi window or Lenovo QuickDisplay window, click the wireless display adapter icon in the network list. The wireless display adapter is identified with the name displayed on the monitor screen.
 3. When prompted, enter the Personal Identification Number (PIN) code displayed on the monitor screen or press the Mode / WPS button on the left side of the wireless display adapter. The connection is established and your notebook computer screen is displayed on the monitor. If you want to disconnect your notebook computer from the wireless display adapter, click **Disconnect** under the icon of the wireless display adapter in the Intel WiDi window or Lenovo QuickDisplay window. Then your notebook computer is disconnected from the wireless display adapter.
- **For Windows 8.1:**
 1. Swipe in from the right edge of the notebook computer screen to display the charms.
 2. Click **Devices → Project → Add a wireless display** to search for the wireless display adapter.
 3. In the search result, click the wireless display adapter. The wireless display adapter is identified with the name displayed on the monitor screen.
 4. When prompted, enter the PIN code displayed on the monitor screen or press the Mode / WPS button on the left side of the wireless display adapter. The connection is established and your notebook computer screen is displayed on the monitor. If you want to disconnect your notebook computer from the wireless display adapter, click **Device → Project → Disconnect**. Then your notebook computer is disconnected from the wireless display adapter.

Note: If the wireless display adapter has been connected to your notebook computer before, the wireless display adapter will be displayed in the projector list. Click the wireless display adapter. Then the connection is established automatically.

Configuring the wireless display adapter

This topic provides information about configuring the settings of the wireless display adapter.

You can configure the settings of the wireless display adapter in two modes:

- ManageAP mode
- Recovery mode

Note: It is recommended that you configure the settings of the wireless display adapter in the ManageAP mode. If you fail to do so, configure the settings of the wireless display adapter in the recovery mode.

ManageAP mode

To configure the settings of the wireless display adapter in the ManageAP mode, do the followings:

1. Connect your notebook computer to the wireless display adapter through Wi-Fi connection. The wireless display adapter is identified with the ManageAP SSID name displayed at the bottom-right corner on the monitor screen. And no password is needed.
2. Open the Internet browser and go to the wireless display adapter setting website at: 192.168.16.1.
3. Type the account name and password, and then click **OK**. By default, both the account name and password are admin.
4. Configure the settings of the wireless display adapter to your needs.

Recovery mode

To configure the settings of the wireless display adapter in the recovery mode, do the following:

1. Press and hold the Mode / WPS button, and then turn on the wireless display adapter. The splash screen will be displayed on the monitor in several seconds.
2. Connect your notebook computer to the wireless display adapter through WiFi connection. The wireless display adapter is identified with the ManageAP service set identifier (SSID) name displayed on the monitor screen. And no password is needed.
3. Open the Internet browser and go to the wireless display adapter setting website at: 192.168.16.1.
4. Type the account name and password, and then click **OK**. By default, both the account name and password are admin.
5. Configure the settings of the wireless display adapter to your needs.

Updating firmware of the wireless display adapter

To update firmware of the wireless display adapter, do the following:

Note: Ensure that both the wireless display adapter and the notebook computer are supplied with power while updating firmware of the wireless display adapter.

1. Download the most-up-date firmware to your notebook computer at:
<http://www.lenovo.com/support/WDA>

Note: The versions of firmware used in the ManageAP mode and recovery mode are different. Ensure that you download the correct version of firmware.

2. Connect your notebook computer to the wireless display adapter through Wi-Fi connection. You can establish the connection either in ManageAP mode or in recovery mode. For detailed information, refer to “Configuring the wireless display adapter” on page 11.
3. Go to the wireless display adapter setting website at: 192.168.16.1. Then click the **Firmware** tab.
4. Click **Browse** near the **New Firmware** field to select the firmware that you have downloaded.
5. Click **Upload new Firmware**. Then follow the instructions on the screen to update the firmware of the wireless display adapter.

If you fail to update firmware of the wireless display adapter in the ManageAP mode, update it in the recovery mode or reset the wireless display adapter to the default settings. To reset the wireless display adapter to the default settings, do the following:

1. Go to the wireless display adapter setting website at: 192.168.16.1. Then click the **Basic** tab.
2. Click **Restore Defaults**. The wireless display adapter restarts automatically. Then the wireless display adapter is reset to the default settings.

Using the NFC tag with Lenovo QuickDisplay

The NFC tag is used to establish the radio communications between your notebook computer and the wireless display adapter quickly and conveniently. It can be assigned to only one specific wireless display adapter at a time.

Note: The Windows 8 operating system does not support the NFC tag.

Before using the NFC tag, ensure that your notebook computer has the following hardware and software installed:

- NFC reader
- Lenovo QuickDisplay 1.2 (for Windows 7)
- Lenovo QuickDisplay 2.0 (for Windows 8.1)

Notes:

- The Lenovo QuickDisplay program can be supported by specific models of the notebook computer. If you want to check whether the Lenovo QuickDisplay program can be installed into your notebook computer, go to the Lenovo Support Web site at: <http://www.lenovo.com/support/WDA>.
- If you want to install Lenovo QuickDisplay 2.0 into your notebook computer, ensure that your notebook computer is equipped with the NFC reader. Otherwise the installation will not be successfully completed.

To establish connection between the wireless display adapter and your notebook computer with the NFC tag, do the following:

For Windows 7:

1. Start the Lenovo QuickDisplay program.
2. Scan the NFC tag on the NFC reader.
3. When prompted, press the Mode / WPS button or enter the PIN code displayed on the monitor screen. Then the connection is established automatically.

Note: If your notebook computer has been connected to the wireless display adapter before, the connection is established automatically after scanning the NFC tag on the NFC reader.

For Windows 8.1:

1. Scan the NFC tag on the NFC reader.
2. When prompted, press the Mode / WPS button or enter the PIN code displayed on the monitor screen. Then the connection is established automatically.

Notes:

- If your notebook computer has been connected to the wireless display adapter before, the connection is established automatically after scanning the NFC tag on the NFC reader.
- If the name of the wireless display adapter has been changed before scanning the NFC tag, change the name of the NFC tag in Lenovo QuickDisplay 2.0.

Using the wireless display adapter with the Windows Media Player through DLNA technology

Sometimes your notebook computer (with the Windows 7 operating system) does not have the Intel WiDi program installed, but you need to use the wireless display adapter to display your notebook computer screen on the monitor. In this situation, you might use the wireless display adapter with the Windows Media Player through Digital Living Network Alliance (DLNA) technology. And the wireless display adapter serves as

a Digital Media Receiver (DMR), which pass the content instructed. DLNA is a set of industrial standards for the sharing of digital media information between multimedia devices through a network. The DLNA is verified that it can support the Windows Media Player on the Windows 7 operating system.

To use the wireless display adapter with the Windows Media Player through DLNA technology on the Windows 7 operating system, do the following:

1. Connect your notebook computer with the wireless display adapter. Then start the Windows Media Player program.
2. From the **Stream** menu, select **Turn on media streaming**. Then you are prompted to choose media streaming options for your notebook computer.
3. Click **Turn on media streaming** to show the device list.
4. Click **Allowed** in the **Digital Media Receiver** field. Then click **OK**.
5. Right-click on the video or picture you want to display, and then click **Play To → Digital Media Receiver**. The video or picture is displayed on the monitor.

Chapter 4. Frequently asked questions

The following are a few tips that will help you optimize the use of the wireless display adapter.

What version of the Intel WiDi should be used with the wireless display adapter?

Intel WiDi version 4.2.21 or later.

Can I connect my notebook computer to a Wi-Fi network and to the wireless display adapter at the same time?

Yes. Please connect your notebook computer to a Wi-Fi network first, and then connect it to the wireless display adapter.

Where should I download the latest Intel Graphics Driver, Intel Wireless Driver, and Intel WiDi software?

You can download the latest Intel Graphics Driver, Intel Wireless Driver, and Intel WiDi software at: <http://www.lenovo.com/support>. Depending on the type and model of your notebook computer, the version might vary.

What does the “WPS Auto PBC ” stands for in the wireless display adapter setting website?

If you choose to enable the **WPS Auto PBC** label, you do not have to press the Mode / WPS button or enter the PIN code during the first time of connecting your notebook computer to the wireless display adapter. By default, the **WPS Auto PBC** label is disabled.

Is the wireless display adapter enabled by the High-bandwidth Digital Content Protection (HDCP) technologies?

Yes, it is enabled by HDCP revision 2.0 and HDCP revision 2.1 which support HDMI monitors.

What is the max resolution of the wireless display adapter?

The max resolution of the wireless display adapter is 1920 x 1080 at 30 frames for second (FPS).

What wireless security feature does the wireless display adapter support?

The wireless display adapter supports the Wi-Fi Protected Access II (WPA2) and the Advanced Encryption Standard (AES) with a key size of 128 bits.

What version is the HDMI connector on the wireless display adapter?

HDMI 1.3 connector.

What is the rated output power of the wireless display adapter?

5 Volts 1 Amp through a micro USB connector.

Chapter 5. Troubleshooting

This section contains troubleshooting information for the wireless display adapter. If you encounter any of the following problems when using the wireless display adapter, refer to the corresponding answers.

- **I cannot install the Intel WiDi software into my notebook computer.**

To solve the problem, do the following:

1. Check if the notebook computer meets the system requirements for Intel WiDi at:
<http://supportkb.intel.com/wireless/wireless-display/templates/selfservice/intelwidi/#portal/1026/article/2511>
2. Check if the following software and drivers installed in your notebook computer are the most-up-date:
 - Intel Graphics Driver
 - Intel Wireless Driver
 - Intel WiDi software
3. Check if you have selected **Integrated Graphics** as the graphics card in the BIOS operating system on your notebook computer.

If the problem still persists, contact Lenovo for technical support.

- **My notebook computer has a Realtek Wi-Fi driver, but cannot meet the system requirements for Intel WiDi.**

- Depending on the operating system on your notebook computer, do the following:

- **For Windows 7:** Install the Lenovo QuickDisplay program. The Lenovo QuickDisplay program can be supported by specific models of the notebook computer. To check if the Lenovo QuickDisplay program can be installed into your notebook computer, go to the Lenovo Support Web site at:
<http://www.lenovo.com/support/WDA>.
- **For Windows 8:** Update the operating system to Windows 8.1. Then update the graphics driver and Realtek driver to the latest version at: <http://www.lenovo.com/support>.
- **For Windows 8.1:** Update the graphics driver and Realtek driver to the latest version at:
<http://www.lenovo.com/support>.

- **I cannot connect my notebook computer to the wireless display adapter with the latest Intel WiDi software.**

To solve the problem, do the following:

1. Ensure that the Intel Graphics Driver and the Wi-Fi driver are the most-up-date.
2. Remove the wireless display adapter from the device list of your notebook computer. Then restart the notebook computer.
3. If your notebook computer can be connected to the wireless display adapter when it is *not* connected to any Wi-Fi network, but the connection fails once the notebook computer is connected to a Wi-Fi network, you might have met the dynamic frequency selection (DFS) issue. To solve the DFS issue, refer to the Chapter 5 “Troubleshooting” on page 17.

- **I have met with the DFS issue.**

To solve the DFS issue, do the following:

1. Contact the IT management support to set the Access Point at a Wi-Fi channel in the 2.4 GHz band or at a non-DFS channel in the 5 GHz band.
2. Set your notebook computer to use a Wi-Fi channel in the 2.4 GHz band by doing the following:
 - a. Open the **Device Manager** window.
 - b. Right-click the network adapter of your notebook computer. Then click **Properties**.

- c. In the **Property** field, select **Preferred Band**. Then from the **Value** menu, select **Prefer 2.4 GHz band**. The DFS issue is solved.

- **I cannot connect my notebook computer to the wireless display adapter under Windows 8.1 operating system.**

Check whether the Windows 8.1 operating system is preinstalled in your notebook computer. If the Windows 8.1 operating system is not preinstalled but is updated from Windows 8 operating system, your operating system might *not* have the Miracast driver. Contact the Lenovo Support to see if the problem can be fixed by installing the Miracast driver into your notebook computer.

- **My notebook computer cannot be connected to the wireless display adapter that has been connected before.**

Depending on the operating system on your notebook computer, do the following:

- **For Windows 7:**

1. Click **Control Panel → Devices and Printers**. Then remove the wireless display adapter in the device list.
2. Connect your notebook computer to the wireless display adapter again.

- **For Windows 8 and Windows 8.1:**

1. Swipe in from the right edge of the notebook computer screen to display the charms.
2. Click **Settings → Change PC settings → PC and devices → Devices**. Then remove the wireless display adapter in the projector list.
3. Connect your notebook computer to the wireless display adapter again.

- **The display on the external monitor or projector is either too big or too small.**

When the display on the external monitor or projector is either too big or too small, you need to adjust the size of the display. Start the Intel WiDi program, and then click **Settings → Picture and Sound → Adjust cropping**. You can tune the display by selecting the size from 0 (minimum) to 15 (maximum).

- **The motion responds slowly on the external monitor or projector.**

Start the Intel WiDi program, and then click **Settings → Current Display Settings**. In the **Quality vs Speed** box, select **Prioritize Speed**.

- **The display is blurred or the pointer speed is slow on the external monitor or projector.**

The wireless display adapter requires high bandwidth of the Wi-Fi network. So the possible reasons are:

- Your notebook computer is equipped with a single-band Wi-Fi module, and it is *not* suitable for the wireless display adapter. Connect your notebook computer to the source-in connector on the wireless display adapter with a VGA cable, or change to another notebook computer that supports dual-band WiFi network.
- Congestion occurred in the channel that the wireless display adapter occupies in the 2.4 GHz band. There might be other devices that are using the same channel as the wireless display adapter. You can use another channel in the 2.4 GHz band or in the 5 GHz band.

- **I cannot locate the wireless display adapter in the Wi-Fi network list after I have set my notebook computer to be connected on the 5 GHz band only.**

The 2.4 GHz band is needed for connecting the wireless display adapter. So do not set your notebook computer to use the 5 GHz band only.

- **Some digital media cannot be shared between DLNA devices.**

The digital media format cannot be supported by DLNA.

Appendix A. Service and Support

The following information describes the technical support that is available for your product, during the warranty period or throughout the life of your product. Refer to the Lenovo Limited Warranty for a full explanation of Lenovo warranty terms.

Online technical support

Online technical support is available during the lifetime of a product at:
<http://www.lenovo.com/support>

Product replacement assistance or exchange of defective components also is available during the warranty period. In addition, if your option is installed in a Lenovo computer, you might be entitled to service at your location. A Lenovo technical support representative can help you determine the best alternative.

Telephone technical support

Installation and configuration support through the Customer Support Center will be available until 90 days after the option has been withdrawn from marketing. After that time, the support is cancelled, or made available for a fee, at Lenovo's discretion. Additional support is also available for a nominal fee.

Before contacting a Lenovo technical support representative, please have the following information available: option name and number, proof of purchase, computer manufacturer, model, serial number and manual, the exact wording of any error message, description of the problem, and the hardware and software configuration information for your system.

Your technical support representative might want to walk you through the problem while you are at your computer during the call.

Telephone numbers are subject to change without notice. The most up-to-date telephone list for Lenovo Support is always available at <http://www.lenovo.com/support/phone>. If the telephone number for your country or region is not listed, contact your Lenovo reseller or Lenovo marketing representative.

Appendix B. Lenovo Limited Warranty

L505-0010-02 08/2011

This Lenovo Limited Warranty consists of the following parts:

Part 1 - General Terms

Part 2 - Country-specific Terms

Part 3 - Warranty Service Information

The terms of **Part 2** replace or modify terms of **Part 1** as specified for a particular country.

Part 1 - General Terms

This Lenovo Limited Warranty applies only to Lenovo hardware products you purchased for your own use and not for resale. This Lenovo Limited Warranty is available in other languages at www.lenovo.com/warranty.

What this Warranty Covers

Lenovo warrants that each Lenovo hardware product that you purchase is free from defects in materials and workmanship under normal use during the warranty period. The warranty period for the product starts on the original date of purchase as shown on your sales receipt or invoice or as may be otherwise specified by Lenovo. The warranty period and type of warranty service that apply to your product are as specified in “**Part 3 - Warranty Service Information**” below. This warranty only applies to products in the country or region of purchase.

THIS WARRANTY IS YOUR EXCLUSIVE WARRANTY AND REPLACES ALL OTHER WARRANTIES OR CONDITIONS, EXPRESS OR IMPLIED, INCLUDING, BUT NOT LIMITED TO, ANY IMPLIED WARRANTIES OR CONDITIONS OF MERCHANTABILITY OR FITNESS FOR A PARTICULAR PURPOSE. AS SOME STATES OR JURISDICTIONS DO NOT ALLOW THE EXCLUSION OF EXPRESS OR IMPLIED WARRANTIES, THE ABOVE EXCLUSION MAY NOT APPLY TO YOU. IN THAT EVENT, SUCH WARRANTIES APPLY ONLY TO THE EXTENT AND FOR SUCH DURATION AS REQUIRED BY LAW AND ARE LIMITED IN DURATION TO THE WARRANTY PERIOD. AS SOME STATES OR JURISDICTIONS DO NOT ALLOW LIMITATIONS ON THE DURATION OF AN IMPLIED WARRANTY, THE ABOVE LIMITATION ON DURATION MAY NOT APPLY TO YOU.

How to Obtain Warranty Service

If the product does not function as warranted during the warranty period, you may obtain warranty service by contacting Lenovo or a Lenovo approved Service Provider. A list of approved Service Providers and their telephone numbers is available at: www.lenovo.com/support/phone.

Warranty service may not be available in all locations and may differ from location to location. Charges may apply outside a Service Provider’s normal service area. Contact a local Service Provider for information specific to your location.

Customer Responsibilities for Warranty Service

Before warranty service is provided, you must take the following steps:

- follow the service request procedures specified by the Service Provider;

- backup or secure all programs and data contained in the product;
- provide the Service Provider with all system keys or passwords;
- provide the Service Provider with sufficient, free, and safe access to your facilities to perform service;
- remove all data, including confidential information, proprietary information and personal information, from the product or, if you are unable to remove any such information, modify the information to prevent its access by another party or so that it is not personal data under applicable law. The Service Provider shall not be responsible for the loss or disclosure of any data, including confidential information, proprietary information, or personal information, on a product returned or accessed for warranty service;
- remove all features, parts, options, alterations, and attachments not covered by the warranty;
- ensure that the product or part is free of any legal restrictions that prevent its replacement;
- if you are not the owner of a product or part, obtain authorization from the owner for the Service Provider to provide warranty service.

What Your Service Provider Will Do to Correct Problems

When you contact a Service Provider, you must follow the specified problem determination and resolution procedures.

The Service Provider will attempt to diagnose and resolve your problem by telephone, e-mail or remote assistance. The Service Provider may direct you to download and install designated software updates.

Some problems may be resolved with a replacement part that you install yourself called a “Customer Replaceable Unit” or “CRU.” If so, the Service Provider will ship the CRU to you for you to install.

If your problem cannot be resolved over the telephone; through the application of software updates or the installation of a CRU, the Service Provider will arrange for service under the type of warranty service designated for the product under “**Part 3 - Warranty Service Information**” below.

If the Service Provider determines that it is unable to repair your product, the Service Provider will replace it with one that is at least functionally equivalent.

If the Service Provider determines that it is unable to either repair or replace your product, your sole remedy under this Limited Warranty is to return the product to your place of purchase or to Lenovo for a refund of your purchase price.

Replacement Products and Parts

When warranty service involves the replacement of a product or part, the replaced product or part becomes Lenovo’s property and the replacement product or part becomes your property. Only unaltered Lenovo products and parts are eligible for replacement. The replacement product or part provided by Lenovo may not be new, but it will be in good working order and at least functionally equivalent to the original product or part. The replacement product or part shall be warranted for the balance of the period remaining on the original product.

Use of Personal Contact Information

If you obtain service under this warranty, you authorize Lenovo to store, use and process information about your warranty service and your contact information, including name, phone numbers, address, and e-mail address. Lenovo may use this information to perform service under this warranty. We may contact you to inquire about your satisfaction with our warranty service or to notify you about any product recalls or safety issues. In accomplishing these purposes, you authorize Lenovo to transfer your information to any country where we do business and to provide it to entities acting on our behalf. We may also disclose it where required by law. Lenovo’s privacy policy is available at www.lenovo.com/.

What this Warranty Does not Cover

This warranty does not cover the following:

- uninterrupted or error-free operation of a product;
- loss of, or damage to, your data by a product;
- any software programs, whether provided with the product or installed subsequently;
- failure or damage resulting from misuse, abuse, accident, modification, unsuitable physical or operating environment, natural disasters, power surges, improper maintenance, or use not in accordance with product information materials;
- damage caused by a non-authorized service provider;
- failure of, or damage caused by, any third party products, including those that Lenovo may provide or integrate into the Lenovo product at your request;
- any technical or other support, such as assistance with “how-to” questions and those regarding product set-up and installation;
- products or parts with an altered identification label or from which the identification label has been removed.

Limitation of Liability

Lenovo is responsible for loss or damage to your product only while it is in the Service Provider’s possession or in transit, if the Service Provider is responsible for the transportation.

Neither Lenovo nor the Service Provider is responsible for loss or disclosure of any data, including confidential information, proprietary information, or personal information, contained in a product.

UNDER NO CIRCUMSTANCES, AND NOTWITHSTANDING THE FAILURE OF ESSENTIAL PURPOSE OF ANY REMEDY SET FORTH HEREIN, SHALL LENOVO, ITS AFFILIATES, SUPPLIERS, RESELLERS, OR SERVICE PROVIDERS BE LIABLE FOR ANY OF THE FOLLOWING EVEN IF INFORMED OF THEIR POSSIBILITY AND REGARDLESS OF WHETHER THE CLAIM IS BASED IN CONTRACT, WARRANTY, NEGLIGENCE, STRICT LIABILITY OR OTHER THEORY OF LIABILITY: 1) THIRD PARTY CLAIMS AGAINST YOU FOR DAMAGES; 2) LOSS, DAMAGE OR DISCLOSURE OF YOUR DATA; 3) SPECIAL, INCIDENTAL, PUNITIVE, INDIRECT OR CONSEQUENTIAL DAMAGES, INCLUDING BUT NOT LIMITED TO LOST PROFITS, BUSINESS REVENUE, GOODWILL OR ANTICIPATED SAVINGS. IN NO CASE SHALL THE TOTAL LIABILITY OF LENOVO, ITS AFFILIATES, SUPPLIERS, RESELLERS OR SERVICE PROVIDERS FOR DAMAGES FROM ANY CAUSE EXCEED THE AMOUNT OF ACTUAL DIRECT DAMAGES, NOT TO EXCEED THE AMOUNT PAID FOR THE PRODUCT.

THE FOREGOING LIMITATIONS DO NOT APPLY TO DAMAGES FOR BODILY INJURY (INCLUDING DEATH), DAMAGE TO REAL PROPERTY OR DAMAGE TO TANGIBLE PERSONAL PROPERTY FOR WHICH LENOVO IS LIABLE UNDER LAW. AS SOME STATES OR JURISDICTIONS DO NOT ALLOW THE EXCLUSION OR LIMITATION OF INCIDENTAL OR CONSEQUENTIAL DAMAGES, THE ABOVE LIMITATION OR EXCLUSION MAY NOT APPLY TO YOU.

Your Other Rights

THIS WARRANTY GIVES YOU SPECIFIC LEGAL RIGHTS. YOU MAY HAVE OTHER RIGHTS ACCORDING TO THE APPLICABLE LAWS OF YOUR STATE OR JURISDICTION. YOU MAY ALSO HAVE OTHER RIGHTS UNDER A WRITTEN AGREEMENT WITH LENOVO. NOTHING IN THIS WARRANTY AFFECTS STATUTORY RIGHTS, INCLUDING RIGHTS OF CONSUMERS UNDER LAWS OR REGULATIONS GOVERNING THE SALE OF CONSUMER GOODS THAT CANNOT BE WAIVED OR LIMITED BY CONTRACT.

Part 2 - Country-specific Terms

Australia

“Lenovo” means Lenovo (Australia & New Zealand) Pty Limited ABN 70 112 394 411. Address: Level 10, North Tower, 1-5 Railway Street, Chatswood, NSW, 2067. Telephone: +61 2 8003 8200. Email: lenosyd_au@lenovo.com

The following replaces the same section in Part 1:

What this Warranty Covers:

Lenovo warrants that each hardware product that you purchase is free from defects in materials and workmanship under normal use and conditions during the warranty period. If the product fails due to a covered defect during the warranty period, Lenovo will provide you a remedy under this Limited Warranty. The warranty period for the product starts on the original date of purchase specified on your sales receipt or invoice unless Lenovo informs you otherwise in writing. The warranty period and type of warranty service that apply to your product are set forth below in **Part 3 - Warranty Service Information**.

THE BENEFITS GIVEN BY THIS WARRANTY ARE IN ADDITION TO YOUR RIGHTS AND REMEDIES AT LAW, INCLUDING THOSE UNDER THE AUSTRALIAN CONSUMER LAW.

The following replaces the same section in Part 1:

Replacement Products and Parts:

When warranty service involves the replacement of a product or part, the replaced product or part becomes Lenovo’s property and the replacement product or part becomes your property. Only unaltered Lenovo products and parts are eligible for replacement. The replacement product or part provided by Lenovo may not be new, but it will be in good working order and at least functionally equivalent to the original product or part. The replacement product or part shall be warranted for the balance of the period remaining on the original product. Products and parts presented for repair may be replaced by refurbished products or parts of the same type rather than being repaired. Refurbished parts may be used to repair the product; and repair of the product may result in loss of data, if the product is capable of retaining user-generated data.

The following is added to the same section in Part 1:

Use of Personal Contact Information:

Lenovo will not be able to perform our service under this warranty if you refuse to provide your information or do not wish us to transfer your information to our agent or contractor. You have the right to access your personal contact information and request correction of any errors in it pursuant to the Privacy Act 1988 by contacting Lenovo.

The following replaces the same section in Part 1:

Limitation of Liability:

Lenovo is responsible for loss or damage to your product only while it is in the Service Provider’s possession or in transit, if the Service Provider is responsible for the transportation.

Neither Lenovo nor the Service Provider is responsible for loss or disclosure of any data, including confidential information, proprietary information, or personal information, contained in a product.

TO THE EXTENT PERMITTED BY LAW, UNDER NO CIRCUMSTANCES AND NOTWITHSTANDING THE FAILURE OF ESSENTIAL PURPOSE OF ANY REMEDY SET FORTH HEREIN, SHALL LENOVO, ITS AFFILIATES, SUPPLIERS, RESELLERS, OR SERVICE PROVIDERS BE LIABLE FOR ANY OF THE FOLLOWING EVEN IF INFORMED OF THEIR POSSIBILITY AND REGARDLESS OF WHETHER THE CLAIM IS BASED IN CONTRACT, WARRANTY, NEGLIGENCE, STRICT LIABILITY OR OTHER THEORY

OF LIABILITY: 1) THIRD PARTY CLAIMS AGAINST YOU FOR DAMAGES; 2) LOSS, DAMAGE OR DISCLOSURE OF YOUR DATA; 3) SPECIAL, INCIDENTAL, PUNITIVE, INDIRECT OR CONSEQUENTIAL DAMAGES, INCLUDING BUT NOT LIMITED TO LOST PROFITS, BUSINESS REVENUE, GOODWILL OR ANTICIPATED SAVINGS. IN NO CASE SHALL THE TOTAL LIABILITY OF LENOVO, ITS AFFILIATES, SUPPLIERS, RESELLERS OR SERVICE PROVIDERS FOR DAMAGES FROM ANY CAUSE EXCEED THE AMOUNT OF ACTUAL DIRECT DAMAGES, NOT TO EXCEED THE AMOUNT PAID FOR THE PRODUCT.

THE FOREGOING LIMITATIONS DO NOT APPLY TO DAMAGES FOR BODILY INJURY (INCLUDING DEATH), DAMAGE TO REAL PROPERTY OR DAMAGE TO TANGIBLE PERSONAL PROPERTY FOR WHICH LENOVO IS LIABLE UNDER LAW.

The following replaces the same section in Part 1:

Your Other Rights:

THIS WARRANTY GIVES YOU SPECIFIC LEGAL RIGHTS. YOU ALSO HAVE OTHER RIGHTS AT LAW, INCLUDING UNDER THE AUSTRALIAN CONSUMER LAW. NOTHING IN THIS WARRANTY AFFECTS STATUTORY RIGHTS OR RIGHTS AT LAW, INCLUDING RIGHTS THAT CANNOT BE WAIVED OR LIMITED BY CONTRACT.

For example, our products come with guarantees that cannot be excluded under the Australian Consumer Law. You are entitled to a replacement or refund for a major failure and compensation for any other reasonably foreseeable loss or damage. You are also entitled to have the products repaired or replaced if the products fail to be of acceptable quality and the failure does not amount to a major failure.

New Zealand

The following is added to the same section in Part 1:

Use of Personal Information:

Lenovo will not be able to perform our service under this warranty if you refuse to provide your information or do not wish us to transfer your information to our agent or contractor. You have the right to access your personal information and request correction of any errors in it pursuant to the Privacy Act 1993 by contacting Lenovo (Australia & New Zealand) Pty Limited ABN 70 112 394 411. Address: Level 10, North Tower, 1-5 Railway Street, Chatswood, NSW, 2067. Telephone: 61 2 8003 8200. Email: lensyd_au@lenovo.com

Bangladesh, Cambodia, India, Indonesia, Nepal, Philippines, Vietnam and Sri Lanka

The following is added to Part 1:

Dispute Resolution

Disputes arising out of or in connection with this warranty shall be finally settled by arbitration held in Singapore. This warranty shall be governed, construed and enforced in accordance with the laws of Singapore, without regard to conflict of laws. If you acquired the product in **India**, disputes arising out of or in connection with this warranty shall be finally settled by arbitration held in Bangalore, India. Arbitration in Singapore shall be held in accordance with the Arbitration Rules of Singapore International Arbitration Center ("SIAC Rules") then in effect. Arbitration in India shall be held in accordance with the laws of India then in effect. The arbitration award shall be final and binding on the parties without appeal. Any award shall be in writing and set forth the findings of fact and the conclusions of law. All arbitration proceedings, including all documents presented in such proceedings shall be conducted in the English language. The English language version of this warranty prevails over any other language version in such proceedings.

European Economic Area (EEA)

The following is added to Part 1:

Customers in the EEA may contact Lenovo at the following address: EMEA Service Organisation, Lenovo (International) B.V., Floor 2, Einsteinova 21, 851 01, Bratislava, Slovakia. Service under this warranty for Lenovo hardware products purchased in EEA countries may be obtained in any EEA country in which the product has been announced and made available by Lenovo.

Russia

The following is added to Part 1:

Product Service Life

The product service life is four (4) years from the original date of purchase.

Part 3 - Warranty Service Information

Product Type	Country or Region of Purchase	Warranty Period	Type of Warranty Service
ThinkPad Enterprise Wireless Display Adapter	Worldwide	1 year	1, 4

If required, your Service Provider will provide repair or exchange service depending on the type of warranty service specified for your product and the available service. Scheduling of service will depend upon the time of your call, parts availability, and other factors.

Types of Warranty Service

1. Customer Replaceable Unit (“CRU”) Service

Under CRU Service, the Service Provider will ship CRUs to you at its cost for installation by you. CRU information and replacement instructions are shipped with your product and are available from Lenovo at any time upon request. CRUs that are easily installed by you are called “Self-service CRUs”. “Optional-service CRUs” are CRUs that may require some technical skill and tools. Installation of Self-service CRUs is your responsibility. You may request that a Service Provider install Optional-service CRUs under one of the other types of warranty service designated for your product. An optional service offering may be available for purchase from a Service Provider or Lenovo under which Self-service CRUs would be installed for you. You may find a list of CRUs and their designation in the publication that was shipped with your product or at www.lenovo.com/CRUs. The requirement to return a defective CRU, if any, will be specified in the instructions shipped with a replacement CRU. When return is required: 1) return instructions, a prepaid return shipping label, and a container will be included with the replacement CRU; and 2) you may be charged for the replacement CRU if the Service Provider does not receive the defective CRU from you within thirty (30) days of your receipt of the replacement CRU.

2. On-site Service

Under On-Site Service, a Service Provider will either repair or exchange the product at your location. You must provide a suitable working area to allow disassembly and reassembly of the product. Some repairs may need to be completed at a service center. If so, the Service Provider will send the product to the service center at its expense.

3. Courier or Depot Service

Under Courier or Depot Service, your product will be repaired or exchanged at a designated service center, with shipping at the expense of the Service Provider. You are responsible for disconnecting the product and

packing it in a shipping container provided to you to return your product to a designated service center. A courier will pick up your product and deliver it to the designated service center. The service center will return the product to you at its expense.

4. Customer Carry-In Service

Under Customer Carry-In Service, your product will be repaired or exchanged after you deliver it to a designated service center at your risk and expense. After the product has been repaired or exchanged, it will be made available to you for collection. If you fail to collect the product, the Service Provider may dispose of the product as it sees fit, with no liability to you.

5. Mail-In Service

Under Mail-In Service, your product will be repaired or exchanged at a designated service center after you deliver it at your risk and expense. After the product has been repaired or exchanged, it will be returned to you at Lenovo's risk and expense, unless the Service Provider specifies otherwise.

6. Customer Two-Way Mail-In Service

Under Customer Two-Way Mail-In Service, your product will be repaired or exchanged after you deliver it to a designated service center at your risk and expense. After the product has been repaired or exchanged, it will be made available to you for return shipping at your risk and expense. If you fail to arrange return shipment, the Service Provider may dispose of the product as it sees fit, with no liability to you.

7. Product Exchange Service

Under Product Exchange Service, Lenovo will ship a replacement product to your location. You are responsible for its installation and verification of its operation. The replacement product becomes your property in exchange for the failed product, which becomes the property of Lenovo. You must pack the failed product in the shipping carton in which you received the replacement product and return it to Lenovo. Transportation charges, both ways, shall be at Lenovo's expense. If you fail to use the carton in which the replacement product was received, you may be responsible for any damage to the failed product occurring during shipment. You may be charged for the replacement product if Lenovo does not receive the failed product within thirty (30) days of your receipt of the replacement product.

Appendix C. Electronic emission notices

The following information refers to the ThinkPad Enterprise Wireless Display Adapter.

Federal Communications Commission Declaration of Conformity

ThinkPad Enterprise Wireless Display Adapter - 0A36122, 0A36123, 0A36124, and 0A36125.

Model No.: WMTB-177N

FCC ID: MXF-WMTB-177N

Note: The wireless display adapter (Model: WMTB-177N) underwent certification process for the FCC Part 15 Subpart B compliance under its FCC ID number.

This equipment has been tested and found to comply with the limits for a Class B digital device, pursuant to Part 15 of the FCC Rules. These limits are designed to provide reasonable protection against harmful interference in a residential installation. This equipment generates, uses, and can radiate radio frequency energy and, if not installed and used in accordance with the instructions, may cause harmful interference to radio communications. However, there is no guarantee that interference will not occur in a particular installation. If this equipment does cause harmful interference to radio or television reception, which can be determined by turning the equipment off and on, the user is encouraged to try to correct the interference by one or more of the following measures:

- Reorient or relocate the receiving antenna.
- Increase the separation between the equipment and receiver.
- Connect the equipment into an outlet on a circuit different from that to which the receiver is connected.
- Consult an authorized dealer or service representative for help.

Shielded cables must be used with this unit to ensure compliance with the Class B FCC limits.

Lenovo is not responsible for any radio or television interference caused by using other than specified or recommended cables and connectors or by unauthorized changes or modifications to this equipment. Unauthorized changes or modifications could void the user's authority to operate the equipment.

This device complies with Part 15 of the FCC Rules. Operation is subject to the following two conditions: (1) this device may not cause harmful interference, and (2) this device must accept any interference received, including interference that may cause undesired operation.

Responsible Party:
Lenovo (United States) Incorporated
1009 Think Place - Building One
Morrisville, NC 27560
Phone Number: 919-294-5900



RF Exposure Statement

The radiated output power of the Lenovo ThinkPad Enterprise Wireless Display Adapter is far below the FCC RF exposure limits. To comply with FCC RF exposure compliance requirements, a separation distance of at least 20 cm must be maintained between the antenna of this device and all persons.

Radio Frequency interference requirements

When you use a wireless LAN adapter in the 802.11 a/n transmission mode:

- Each device is restricted to indoor use due to its operation in the 5150 to 5250 MHz frequency range. FCC requires these products to be used indoors for the frequency range 5150 to 5250 MHz to reduce the potential for harmful interference to co-channel Mobile Satellite systems.
- High power radars are allocated as primary users of the 5250 to 5350 MHz and 5650 to 5850 MHz bands. These radar stations can cause interference with and/or damage this device.

The ThinkPad Enterprise Wireless Display Adapter comply with the frequency stability test within its operating temperatures from -5 °C to 40 °C.

Canada - Industry Canada (IC)

ThinkPad Enterprise Wireless Display Adapter - IC ID: 3069B-WMTB177N

Industry Canada Class B emission compliance statement

This Class B digital apparatus complies with Canadian ICES-003.

Avis de conformité à la réglementation d'Industrie Canada

Cet appareil numérique de la classe B est conforme à la norme NMB-003 du Canada.

Low Power License-Exempt Radio Communication Devices (RSS-210)

Operation is subject to the following two conditions: (1) this device may not cause interference, and (2) this device must accept any interference, including interference that may cause undesired operation of the device.

Permis d'émission à faible puissance – Cas des appareils de communications radio

L'utilisation de ce dispositif est autorisée seulement aux conditions suivantes: (1) il ne doit pas produire de brouillage, et (2) l'utilisateur du dispositif doit être prêt à accepter tout brouillage radioélectrique reçu, même si ce brouillage est susceptible de compromettre le fonctionnement du dispositif.

When you use a wireless LAN adapter in the 802.11 a/n transmission mode:

- The devices for the band 5150–5250 MHz are only for indoor usage to reduce potential for harmful interference to co-channel Mobile Satellite systems.
- High power radars are allocated as primary users (meaning they have priority) of 5250–5350 MHz and 5650–5850 MHz and these radars could cause interference and/or damage to LELAN (Licence-Exempt Local Area Network) devices.

Lorsque vous utilisez la carte pour réseau local sans fil en mode de transmission 802.11 a/n:

- Tout appareil destiné à la bande 5150-5250 MHz devra être exclusivement utilisé en intérieur afin de réduire les risques de perturbations électromagnétiques gênantes sur les systèmes de satellite mobile dans un même canal.
- Les radars à forte puissance sont désignés comme les utilisateurs principaux (c'est-à-dire qu'ils sont prioritaires) des bandes 5250-5350 MHz et 5650-5850 MHz. Ils peuvent provoquer des perturbations électromagnétiques sur les appareils de type LELAN (réseau de communication local sans licence) ou les endommager.

Exposure of humans to RF fields (RSS-102)

The ThinkPad Enterprise Wireless Display Adapter employ low gain integral antennas that do not emit RF field in excess of Health Canada limits for the general population; consult Safety Code 6, obtainable from Health Canada's Web site at: <http://www.hc-sc.gc.ca/>.

The radiated energy from the ThinkPad Enterprise Wireless Display Adapter antennas conforms to the IC limit of the RF exposure requirement regarding IC RSS-102, Issue 4.

Conformité des appareils de radiocommunication aux limites d'exposition humaine aux radiofréquences (CNR-102)

Le ThinkPad Enterprise Wireless Display Adapter utilise des antennes intégrales à faible gain qui n'émettent pas un champ électromagnétique supérieur aux normes imposées par Santé Canada pour la population. Consultez le Code de sécurité 6 sur le site Internet de Santé Canada à l'adresse :<http://www.hc-sc.gc.ca/>.

L'énergie émise par les antennes du ThinkPad Enterprise Wireless Display Adapter respecte la limite d'exposition aux radiofréquences telle que définie par Industrie Canada dans la du document CNR-102, version 4.

European Union - Compliance to the Electromagnetic Compatibility Directive

This product is in conformity with the protection requirements of EU Council Directive 2004/108/EC on the approximation of the laws of the Member States relating to electromagnetic compatibility. Lenovo cannot accept responsibility for any failure to satisfy the protection requirements resulting from a non-recommended modification of the product, including the installation of option cards from other manufacturers.

This product has been tested and found to comply with the limits for Class B Information Technology Equipment according to European Standard EN 55022. The limits for Class B equipment were derived for typical residential environments to provide reasonable protection against interference with licensed communication devices.

Lenovo, Einsteinova 21, 851 01 Bratislava, Slovakia

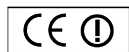

German Class B compliance statement

Deutschsprachiger EU Hinweis:

Hinweis für Geräte der Klasse B EU-Richtlinie zur Elektromagnetischen Verträglichkeit

Dieses Produkt entspricht den Schutzanforderungen der EU-Richtlinie 2004/108/EG (früher 89/336/EWG) zur Angleichung der Rechtsvorschriften über die elektromagnetische Verträglichkeit in den EU-Mitgliedsstaaten und hält die Grenzwerte der EN 55022 Klasse B ein.

Um dieses sicherzustellen, sind die Geräte wie in den Handbüchern beschrieben zu installieren und zu betreiben. Des Weiteren dürfen auch nur von der Lenovo empfohlene Kabel angeschlossen werden. Lenovo übernimmt keine Verantwortung für die Einhaltung der Schutzanforderungen, wenn das Produkt ohne Zustimmung der Lenovo verändert bzw. wenn Erweiterungskomponenten von Fremdherstellern ohne Empfehlung der Lenovo gesteckt/eingebaut werden.

Deutschland:

Einhaltung des Gesetzes über die elektromagnetische Verträglichkeit von Betriebsmitteln

Dieses Produkt entspricht dem „Gesetz über die elektromagnetische Verträglichkeit von Betriebsmitteln“

EMVG (früher „Gesetz über die elektromagnetische Verträglichkeit von Geräten“). Dies ist die Umsetzung der EU-Richtlinie 2004/108/EG (früher 89/336/EWG) in der Bundesrepublik Deutschland.

Zulassungsbescheinigung laut dem Deutschen Gesetz über die elektromagnetische Verträglichkeit von Betriebsmitteln, EMVG vom 20. Juli 2007 (früher Gesetz über die elektromagnetische Verträglichkeit von Geräten), bzw. der EMV EG Richtlinie 2004/108/EC (früher 89/336/EWG), für Geräte der Klasse B.

Dieses Gerät ist berechtigt, in Übereinstimmung mit dem Deutschen EMVG das EG-Konformitätszeichen - CE - zu führen. Verantwortlich für die Konformitätserklärung nach Paragraf 5 des EMVG ist die Lenovo (Deutschland) GmbH, Gropiusplatz 10, D-70563 Stuttgart.

Informationen in Hinsicht EMVG Paragraf 4 Abs. (1) 4:

Das Gerät erfüllt die Schutzanforderungen nach EN 55024 und EN 55022 Klasse B.

English

Hereby, Lenovo (Singapore) Pte. Ltd., declares that the wireless equipment listed in this section are in compliance with the essential requirements and other relevant provisions of Directive 1999/5/EC.

EU Frequency band restriction for a ThinkPad Enterprise Wireless Display Adapter

Usage of this device is limited to indoor in the band 5150 to 5350 MHz (channels 36, 40, 44, 48, 52, 56, 60, 64).

Bulgarian

С настоящото Lenovo (Singapore) Pte. Ltd. декларира, че безжичното оборудване, посочено в този раздел, е в съответствие с основните изисквания и другите уместни условия на Директива 1999/5/EC.

Ограничение в ЕС за честотни ленти за ThinkPad Enterprise Wireless Display Adapter

Употребата на това устройство е ограничена на закрито в диапазона от 5150 до 5350 MHz (каналы 36, 40, 44, 48, 52, 56, 60, 64).

Croatian

Ovime, Lenovo (Singapore) Pte. Ltd., izjavljuje da oprema za bežičnu komunikaciju koja je navedena u ovom odjelu, sukladna je sa nužnim zahtjevima i drugim ograničenjima Direktive 1995/5/EC.

Ograničenje frekvencijskog pojasa za ThinkPad Enterprise Wireless Display Adapter u EU

Korištenje uređaja je ograničeno u zatvorenim prostorima na spekter 5150 do 5350 MHz (kanali 36, 40, 44, 48, 52, 56, 60, 64).

Czech

Lenovo (Singapore) Pte. Ltd. tímto prohlašuje, že bezdrátová zařízení uvedená v této části jsou ve shodě se základními požadavky a dalšími relevantními ustanoveními směrnice 1999/5/EC.

Omezení EU pro frekvenční pásma u produktu ThinkPad Enterprise Wireless Display Adapter

Použití zařízení je omezeno na vnitřní prostory a frekvenční pásmo 5150 až 5350 Mhz (kanály 36, 40, 44, 48, 52, 56, 60, 64).

Danish

Lenovo (Singapore) Pte. Ltd. erklærer hermed, at det trådløse udstyr, der er nævnt i dette afsnit, overholder de væsentlige krav og andre relevante bestemmelser i EU-direktiv 1999/5/EC.

Restriktioner for frekvensbånd i EU for en ThinkPad Enterprise Wireless Display Adapter

Brug af denne enhed er begrænset til indendørs brug i frekvensbåndet 5150 til 5350 MHz (kanal 36, 40, 44, 48, 52, 56, 60, 64).

German

Hiermit erklärt Lenovo (Singapur) Pte. Ltd., dass die drahtlosen Geräte, die in diesem Abschnitt aufgeführt sind, die Voraussetzungen und andere relevanten Richtlinien der Richtlinie 1999/5/EC erfüllen.

EU-Frequenzbandeinschränkung für ThinkPad Enterprise Wireless Display Adapter

Die Verwendung dieses Geräts ist im Innenbereich auf das Frequenzband von 5.150 bis 5.350 MHz (Kanäle 36, 40, 44, 48, 52, 56, 60, 64) beschränkt.

Estonian

Lenovo (Singapore) Pte. Ltd. kinnitab selles jaotises nimetatud traadita side seadmete vastavust direktiivi 1999/5/EÜ põhinõuetele ja nimetatud direktiivist tulenevatele muudele asjakohastele sätetele.

EL-i sagedusala piirang ThinkPad Enterprise Wireless Display Adapter-ile

Seadet on lubatud kasutada siseruumides sagedusalas 5150–5350 MHz (kanalid 36, 40, 44, 48, 52, 56, 60, 64).

Spanish

En este documento, Lenovo (Singapore) Pte. Ltd., declara que el equipo inalámbrico que aparece en esta sección cumple los requisitos esenciales y otras exigencias relevantes de la Directiva 1999/5/EC.

Restricción de banda de frecuencia de la UE para ThinkPad Enterprise Wireless Display Adapter

La utilización de este dispositivo está limitada a interiores en la banda de 5150 a 5350 MHz (canales 36, 40, 44, 48, 52, 56, 60, 64).

Greek

H Lenovo (Singapore) Pte. Ltd. δηλώνει με την παρούσα ότι ο εξοπλισμός ασύρματης σύνδεσης που αναφέρεται σε αυτήν την ενότητα συμμορφώνεται με τις ουσιώδεις απαιτήσεις και άλλες σχετικές διατάξεις της Οδηγίας 1999/5/EK της Ευρωπαϊκής Ένωσης.

Περιορισμός εύρους συχνοτήτων στην ΕΕ για έναν προσαρμογέα ThinkPad Enterprise Wireless Display Adapter

Η χρήση αυτής της συσκευής περιορίζεται σε εσωτερικούς χώρους, στο εύρος συχνοτήτων 5150 - 5350 MHz (κανάλια 36, 40, 44, 48, 52, 56, 60, 64).

French

Par la présente, Lenovo (Singapore) Pte. Ltd. déclare que le matériel sans fil répertorié dans cette section est conforme aux exigences essentielles ainsi qu'aux autres dispositions applicables de la Directive 1999/5/CE.

Restriction liée à la bande de fréquence pour un ThinkPad Enterprise Wireless Display Adapter au sein de l'Union européenne

Ce périphérique doit être utilisé exclusivement à l'intérieur, dans la bande de fréquence de 5150 à 5350 MHz (canaux 36, 40, 44, 48, 52, 56, 60, 64).

Icelandic

Hér með lýsir Lenovo (Singapore) Pte. Ltd því yfir að þráðlausí búnaðurinn sem getið er um í þessum hluta uppfyllir allar kröfur og önnur viðkomandi ákvæði tilskipunar 1999/5/EC.

Takmarkanir ESB á tíðnisviði fyrir ThinkPad Enterprise Wireless Display Adapter

Notkun þessa tækis er takmörkuð við innanhússnotkun á tíðnisviðinu 5150 til 5350 MHz (rásir 36, 40, 44, 48, 52, 56, 60, 64).

Italian

Con la presente, Lenovo (Singapore) Pte. Ltd., dichiara che l'equipaggiamento wireless elencato in questa sezione è conforme ai requisiti essenziali e ad altre disposizioni rilevanti della direttiva 1999/5/EC.

Restrizioni UE sulla banda di frequenza per ThinkPad Enterprise Wireless Display Adapter

L'utilizzo di questo dispositivo è limitato ad ambienti chiusi in banda compresa tra 5150 e 5350 MHz (canali 36, 40, 44, 48, 52, 56, 60, 64).

Latvian

Ar šo uzņēmums Lenovo (Singapūra) Pte. Ltd. paziņo, ka bezvadu aparatūra, kas minēta šajā sadaļā, atbilst Direktīvas 1999/5/EK pamatprasībām un citiem ar to saistītajiem noteikumiem.

EU frekvenču joslu ierobežojums piederumam ThinkPad Enterprise Wireless Display Adapter

Šī ierīce ir paredzēta izmantošanai iekšējās joslās no 5150 līdz 5350 MHz (kanālos 36, 40, 44, 48, 52, 56, 60, 64).

Lithuanian

Šiuo, „Lenovo (Singapore) Pte. Ltd.“, pareiškia, kad šiame skyriuje nurodyta belaidė įranga atitinka svarbiausius 1999/5/EB direktyvos reikalavimus ir kitas susijusias nuostatas.

„ThinkPad Enterprise Wireless Display Adapter“ taikomas ES dažnių juostos apribojimas

Šio prietaiso veikimas patalpoje ribojamas dažnių diapazone nuo 5150 iki 5350 MHz (kanalai: 36, 40, 44, 48, 52, 56, 60, 64).

Dutch

Hierbij verklaart Lenovo (Singapore) Pte. Ltd., dat de draadloze apparatuur die in dit gedeelte worden genoemd, voldoen aan de essentiële vereisten en andere relevante bepalingen van Directive 1999/5/EC.

EU-bepierking van frequentieband voor een ThinkPad Enterprise Wireless Display Adapter

Gebruik van dit apparaat is beperkt tot binnenshuis gebruik in de band van 5150 tot 5350 MHz (kanalen 36, 40, 44, 48, 52, 56, 60, 64).

Norwegian

Lenovo (Singapore) Pte. Ltd. erklærer herved at det trådløse utstyret er i samsvar med de viktigste kravene og andre relevante bestemmelser i EU-direktiv 1999/5/EØF.

EU-begrensninger for frekvensbånd for en ThinkPad Enterprise Wireless Display Adapter

Denne enheten er begrenset til innendørs bruk i frekvensbåndet 5150 til 5350 MHz (kanal 36, 40, 44, 48, 52, 56, 60, 64).

Hungarian

A Lenovo (Szingapúr) Pte. Ltd. ezúton is kijelenti, hogy az itt feltüntetett rádiós eszköz megfelel az 1999/5/EC direktívában megfogalmazott alapvető követelményeknek és vonatkozó ajánlásoknak.

Frekvenciatartományra vonatkozó európai uniós korlátozás a ThinkPad Enterprise Wireless Display Adapterhez

Az eszköz használata beltérre korlátozódik az 5150 - 5350 MHz tartományban (36, 40, 44, 48, 52, 56, 60, 64 csatornák).

Polish

Lenovo (Singapore) Pte. Ltd. deklaruje niniejszym, że urządzenia bezprzewodowe wymienione w tej sekcji są zgodne z zasadniczymi wymaganiami i postanowieniami dyrektywy 1999/5/EC.

Ograniczenie pasma częstotliwości w Unii Europejskiej dotyczące adaptera ThinkPad Enterprise Wireless Display Adapter

Urządzenie jest przeznaczone do używania wewnątrz budynków, w pasmach częstotliwości 5,15 do 5,35 GHz (kanały 36, 40, 44, 48, 52, 56, 60 i 64).

Portuguese

Pelo presente, Lenovo (Singapore) Pte. Ltd., declara que o equipamento sem fios listado nesta secção está em conformidade com os requisitos essenciais e outras provisões relevantes da Directiva 1999/5/EC.

Restrição da banda de frequências da UE aplicável a um ThinkPad Enterprise Wireless Display Adapter

A utilização deste dispositivo está limitada à utilização no interior, na banda de 5150 a 5350 MHz (canais 36, 40, 44, 48, 52, 56, 60, 64).

Romanian

Prin aceasta, Lenovo (Singapore) Pte. Ltd., declară că echipamentul wireless prezentat în această secțiune respectă cerințele esențiale și celelalte prevederi pertinente ale Directivei 1999/5/EC.

Restricția UE privind banda de frecvență a unui adaptor ThinkPad Enterprise Wireless Display Adapter

Utilizarea acestui dispozitiv este limitată la spațiile interioare, în banda 5150-5350 Mhz (canalele 36, 40, 44, 48, 52, 56, 60, 64).

Slovenian

S tem Lenovo (Singapore) Pte. Ltd. izjavlja, da brezžična oprema, opisana v tem razdelku, ustreza bistvenim zahtevam in drugim določbam smernice 1999/5/EC.

Omejitve Evropske unije glede frekvenčnega pasu za vmesnik ThinkPad Enterprise Wireless Display Adapter

Ta naprava je omejena na hišno uporabo v pasu od 5150 do 5350 Mhz (kanali 36, 40, 44, 48, 52, 56, 60, 64).

Slovakian

Týmto spoločnosť Lenovo (Singapore) Pte. Ltd. prehlasuje, že bezdrôtové zariadenia uvedené v tejto časti sú v súlade s nevyhnutnými kritériami a inými príslušnými požiadavkami Smernice 1999/5/EC.

Obmedzenie frekvenčného pásma EÚ pre adaptér ThinkPad Enterprise Wireless Display Adapter

Použitie tohto zariadenia je obmedzené na použitie v interiéroch v pásme 5 150 až 5 350 Mhz (kanály 36, 40, 44, 48, 52, 56, 60, 64).

Finnish

Lenovo (Singapore) Pte. Ltd. ilmoittaa täten, että tässä jaksossa mainittu langaton laitteisto ovat direktiivin 1999/5/EY pakollisten vaatimusten ja direktiivin muiden asiaankuuluvien määräysten mukaiset.

ThinkPad Enterprise Wireless Display Adapterin taajuusalueen rajoitus EU:n alueella

Tämä laite on tarkoitettu käytettäväksi sisätiloissa taajuusalueella 5150 - 5320 MHz (kanavat 36, 40, 44, 48, 52, 56, 60 ja 64).

Swedish

Härmed tillkännager Lenovo (Singapore) Pte. Ltd. att den trådlösa utrustningen som anges i detta avsnitt uppfyller de väsentliga kraven och andra relevanta bestämmelser i direktivet 1999/5/EC.

Frekvensområdesbegränsning inom EU för ThinkPad Enterprise Wireless Display Adapter

Enheten är avsedd för inomhusbruk i frekvensområdet 5150 till 5350 MHz (kanal 36, 40, 44, 48, 52, 56, 60, 64).



Lenovo (Singapore) Pte. Ltd.
151 Lorong Chuan,
#02-01, New Tech Park,
Singapore, 556741
(Tel - 65-6827-1000 & Fax- 65-6827-1100)

EC Declaration of Conformity

For the <<ThinkPad Enterprise Wireless Display Adapter>>
Machine Types: <<Option P/N: 0C52865, Model No.: WMTB-177N>>

We, Lenovo (Singapore) Pte Ltd., declare under sole responsibility that the above products, manufactured by:

Lenovo PC HK Limited.
23/F, Lincoln House, Taikoo Place 979 King's Road,
Quarry Bay, Hong Kong

to which this declaration relates, is in conformity with the requirements of the following EC Directives:

- Council Directive 2006/95/EC on the harmonization of the laws of the Member States relating to electronic equipment designed for use within certain voltage limits.
- Council Directive 2004/108/EC on the approximation of the laws of the Member States relating to electromagnetic compatibility.
- Council Directive 1999/5/EC of the European Parliament and of the council on radio equipment and telecommunications terminal equipment.
- Council Directive 2009/125/EC establishing a framework for the setting of Ecodesign requirements for Energy-related products.
- Council Directive 2011/65/EU on the restriction of the use of certain hazardous substances in electrical and electronic equipment.

Conformity with these Directives has been assessed for this product by demonstrating compliance to the following harmonized standards and/or regulations:

EN 55022:2010+AC:2011 (Class B), EN 55024:2010,
EN 61000-3-2:2006+A1:2009+A2:2009, EN 61000-3-3:2008,
EN 301 489-1 V1.9.2, EN 301 489-17 V2.2.1, EN 300 328 V1.8.1,
EN 301 893 V1.7.1, EN 62311:2008, EN 62209-2:2010, EN 62479:2010,
EN 60950-1:2006+A11:2009+A1:2010+A12:2011
EC 278/2009 Energy related Products (ErP)
EN 50581:2012

Signed:

Date: 19 Feb 2014

Damian Glendinning (Director)

Last two digits of the year in which the CE marking was affixed: ____ 14 ____

Place of issue: Lenovo (Singapore) Pte. Ltd.

European Contact for regulatory topics only:
Lenovo, Digital Park, Einsteinova 21, 851 01 Bratislava, Slovakia
Tel: +421 2 6868 3018 Fax: +421 2 6868 8031

Page 1 of 1

以下の ThinkPad®製品に関する情報が記載されています。

無線LAN

ThinkPad ノートブック・コンピューター	WMTB-177N
ThinkPad Enterprise Wireless Display Adapter	•

日本国内で無線 LAN アダプターをご使用になる場合の注意

本製品が装備する無線アダプターは、電波法および電気通信事業法により技術基準認証を下記のとおり取得しています。本製品に組み込まれた無線設備を他の機器で使用する場合は、当該機器が上記と同じく認証を受けていることをご確認ください。認証されていない機器での使用は、電波法の規定により認められていません。

表 1. 無線

認証申請者名	認証製品名	認証番号
Gemtek Technology Co., Ltd.	WMTB-177N	016-200054

(5 GHz の場合)

ご使用の ThinkPad に IEEE802.11a/n 準拠の無線機器が搭載されている場合は、5.15-5.35 GHz 周波数帯での使用は、電波法の規定により屋内に限られます (屋外での使用は禁じられています)。

(2.4 GHz の場合)

この機器の使用周波数帯では、電子レンジ等の産業・科学・医療用機器のほか工場の製造ライン等で使用されている移動体識別用の構内無線局 (免許を要する無線局) および特定小電力無線局 (免許を要しない無線局) 並びにアマチュア無線局 (免許を要する無線局) が運用されています。

- この機器を使用する前に、近くで移動体識別用の構内無線局及び特定小電力無線局並びにアマチュア無線局が運用されていないことを確認してください。
- 万一、この機器から移動体識別用の構内無線局に対して電波干渉の事例が発生した場合には、速やかに使用周波数を変更するかまたは電波の発射を停止した上で、下記連絡先にご連絡頂き、混信回避のための処置等についてご相談ください。
- その他、この機器からの移動体識別用の特定小電力無線局あるいはアマチュア無線局に対して有害な電波干渉の事例が発生した場合など何かお困りのことが起きたときには、次の連絡先にお問い合わせください。

連絡先: スマートセンター (スマートセンターのご利用方法は、次のホームページでご確認頂けます。 <http://www.lenovo.com/jp/lsmartctr>)



無線 LAN アダプター (IEEE802.11b/g 準拠) の場合

この機器が、2.4 GHz 周波数帯 (2400 から 2483.5 MHz) を使用する直接拡散 (DS) 方式および直交周波数分割多重方式 (OFDM) の無線装置で、干渉距離が約 40 m (定格出力 10 mW/MHz) であることを意味しています。

以上の内容は、「社団法人 電波産業会」ARIB STD-T66の趣旨に基づくものです。

無線 LAN 製品ご使用時におけるセキュリティに関するご注意

無線 LAN では、LAN ケーブルを使用する代わりに、電波を利用してパソコン等と無線アクセスポイント間で情報のやり取りを行うため、電波の届く範囲であれば自由に LAN 接続が可能であるという利点があります。その反

面、電波はある範囲内であれば障害物(壁等)を越えてすべての場所に届くため、セキュリティに関する設定を行っていない場合、以下のような問題が発生する可能性があります。

- 通信内容を盗み見られる 悪意ある第三者が、電波を故意に傍受し、
 - ID やパスワード又はクレジットカード番号等の個人情報
 - メールの内容等の通信内容を盗み見られる可能性があります。
- 不正に侵入される 悪意ある第三者が、無断で個人や会社内のネットワークへアクセスし、
 - 個人情報や機密情報を取り出す(情報漏洩)
 - 特定の人物になりすまして通信し、不正な情報を流す(なりすまし)
 - 傍受した通信内容を書き換えて発信する(改ざん)
 - コンピュータウイルスなどを流しデータやシステムを破壊する(破壊)などの行為をされてしまう可能性があります。

本来、無線 LAN カードや無線アクセスポイントは、これらの問題に対応するためのセキュリティの仕組みを持っているので、無線 LAN 製品のセキュリティに関する設定を行って製品を使用することで、その問題が発生する可能性は少なくなります。

セキュリティの設定を行わないで使用した場合の問題を充分理解した上で、お客様自身の判断と責任においてセキュリティに関する設定を行い、製品を使用することをお奨めします。

使用環境および快適に使用するために

ワイヤレス LAN カードおよび *Bluetooth* デバイスは、ほかの無線装置のように無線周波数電磁波を放射します。しかしながら、これらの無線装置が発する電磁波が人体へ与える影響は、頭部等へ直接接触して使用される携帯電話などの機器とは異なり、とても弱いレベルのものです。

ワイヤレス LAN カードおよび *Bluetooth* デバイスは、無線周波数に関する安全基準や勧告などのガイドラインに従って動作するもので、Lenovo® は、消費者が内蔵ワイヤレス・カードを使用しても安全であると考えます。これらの標準および

勧告は、科学者団体の合意や広範な研究文献を頻繁に検討、調査している科学者のパネルや委員会の審議の結果を反映しています。

状況や環境によって、建物の所有者や組織の代表責任者がワイヤレス LAN カードまたは *Bluetooth* デバイスの使用を制限することがあります。たとえば、次のような場合や場所です。

- 飛行機の搭乗中、病院内、あるいはガソリンスタンド、(電気式発火装置のある)爆発の危険のある場所、医療用インプラント、またはペースメーカーなどの装着式医療用電子機器の近くで、内蔵ワイヤレス・カードを使用すること。
- 他の装置や機能に対して有害と認識または確認されている妨害を起こす危険性がある場合。

特定の場所で(たとえば空港や病院など)ワイヤレス・デバイスの使用が許可されているかどうか分からない場合は、ThinkPad の電源を入れる前に、ワイヤレス LAN カードまたは *Bluetooth* デバイスを使用してもよいかどうかをお尋ねください。

Japan VCCI Class B compliance statement

この装置は、クラスB情報技術装置です。この装置は、家庭環境で使用することを目的としていますが、この装置がラジオやテレビジョン受信機に近接して使用されると、受信障害を引き起こすことがあります。

取扱説明書に従って正しい取り扱いをして下さい。

VCCI-B

Appendix D. Notices

Lenovo may not offer the products, services, or features discussed in this document in all countries. Consult your local Lenovo representative for information on the products and services currently available in your area. Any reference to a Lenovo product, program, or service is not intended to state or imply that only that Lenovo product, program, or service may be used. Any functionally equivalent product, program, or service that does not infringe any Lenovo intellectual property right may be used instead. However, it is the user's responsibility to evaluate and verify the operation of any other product, program, or service.

Lenovo may have patents or pending patent applications covering subject matter described in this document. The furnishing of this document does not give you any license to these patents. You can send license inquiries, in writing, to:

*Lenovo (United States), Inc.
1009 Think Place - Building One
Morrisville, NC 27560
U.S.A.
Attention: Lenovo Director of Licensing*

LENOVO PROVIDES THIS PUBLICATION "AS IS" WITHOUT WARRANTY OF ANY KIND, EITHER EXPRESS OR IMPLIED, INCLUDING, BUT NOT LIMITED TO, THE IMPLIED WARRANTIES OF NON-INFRINGEMENT, MERCHANTABILITY OR FITNESS FOR A PARTICULAR PURPOSE. Some jurisdictions do not allow disclaimer of express or implied warranties in certain transactions, therefore, this statement may not apply to you.

This information could include technical inaccuracies or typographical errors. Changes are periodically made to the information herein; these changes will be incorporated in new editions of the publication. Lenovo may make improvements and/or changes in the product(s) and/or the program(s) described in this publication at any time without notice.

Recycling information

Lenovo encourages owners of information technology (IT) equipment to responsibly recycle their equipment when it is no longer needed. Lenovo offers a variety of programs and services to assist equipment owners in recycling their IT products. For information on recycling Lenovo products, go to:
<http://www.lenovo.com/recycling>

Recycling and disposal information for Japan is available at:
<http://www.lenovo.com/recycling/japan>

Recycling information for Brazil

Declarações de Reciclagem no Brasil

Descarte de um Produto Lenovo Fora de Uso

Equipamentos elétricos e eletrônicos não devem ser descartados em lixo comum, mas enviados à pontos de coleta, autorizados pelo fabricante do produto para que sejam encaminhados e processados por empresas especializadas no manuseio de resíduos industriais, devidamente certificadas pelos órgãos ambientais, de acordo com a legislação local.

A Lenovo possui um canal específico para auxiliá-lo no descarte desses produtos. Caso você possua um produto Lenovo em situação de descarte, ligue para o nosso SAC ou encaminhe um e-mail para: reciclar@lenovo.com, informando o modelo, número de série e cidade, a fim de enviarmos as instruções para o correto descarte do seu produto Lenovo.

Important WEEE information

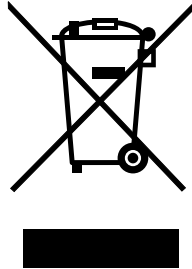

Country specific information is available at:
<http://www.lenovo.com/recycling>

Export Classification Notice

This product is subject to the United States Export Administration regulations (EAR) and has an Export Classification Control Number (ECCN) of EAR99. It can be re-exported except to any of the embargoed countries in the EAR E1 country list.

Trademarks

Lenovo and ThinkPad are trademarks of Lenovo in the United States, other countries, or both.

Microsoft and Windows are trademarks of the Microsoft group of companies.

Intel is a trademark of the Intel Corporation in the United States, other countries, or both.

Miracast is a registered trademark of Wi-Fi Alliance.

Other company, product, or service names may be trademarks or service marks of others.

Appendix E. Restriction of Hazardous Substances Directive (RoHS)

European Union RoHS

Lenovo products sold in the European Union, on or after 3 January 2013 meet the requirements of Directive 2011/65/EU on the restriction of the use of certain hazardous substances in electrical and electronic equipment (“RoHS recast” or “RoHS 2”).

For more information about Lenovo progress on RoHS, go to:
http://www.lenovo.com/social_responsibility/us/en/RoHS_Communication.pdf

China RoHS

The information in the following table is applicable for products manufactured on or after March 1, 2007 for sale in the People’s Republic of China.

Lenovo 电脑选件	有毒有害物质或元素					
	铅 (Pb)	汞 (Hg)	镉 (Cd)	六价铬 (Cr(VI))	多溴联苯 (PBB)	多溴二苯醚 (PBDE)
无线显示适配器	X	O	O	O	O	O
<p>O：表示该有毒有害物质在该部件所有均质材料中的含量均在SJ/T 11363-2006标准规定的限量要求以下。 X：表示该有毒有害物质至少在该部件的某一均质材料中的含量超出SJ/T 11363-2006标准规定的限量要求。 对于销往欧盟的产品，标有“X”的项目均符合欧盟指令2002/95/EC 豁免条款。</p> <p> 在中华人民共和国境内销售的电子信息产品上将印有“环保使用期” (EUP) 符号。圆圈中的数字代表产品的正常环保使用年限。</p>						

Turkish RoHS

The Lenovo product meets the requirements of the Republic of Turkey Directive on the Restriction of the Use of Certain Hazardous Substances in Electrical and Electronic Equipment (EEE).

Турkiye EEE Üçnetmelipine Uygunluk Beyanı

Bu Lenovo ürünü, T.C. Çevre ve Orman Bakanlar'ın “Elektrik ve Elektronik Eşyalarda Bazı Zararlı Maddelerin Kullanımının Sınırlanması Dair Üçnetmelik (EEE)” direktiflerine uygundur.

EEE Üçnetmelipine Uygundur.

Ukraine RoHS

Цим підтверджуємо, що продукція Леново відповідає вимогам нормативних актів України, які обмежують вміст небезпечних речовин

India RoHS

RoHS compliant as per E-Waste (Management & Handling) Rules, 2011.

ThinkPad®