

INSIGNIA™

QUICK SETUP GUIDE

Bluetooth Around Neck Headset

NS-HNECKPLUS

PACKAGE CONTENTS

- Bluetooth in-ear headphones
- Two additional pairs of earbuds (small & large sizes)
- USB charging cable
- Quick Setup Guide

FEATURES

- Comfortable around-the-neck design
- Retractable earbuds for easy storage and transport
- Rechargeable batteries provide up to 12 hours of music playback
- Built-in microphone for phone calls
- Remembers up to eight different devices

Before using your new product, please read these instructions to prevent any damage.

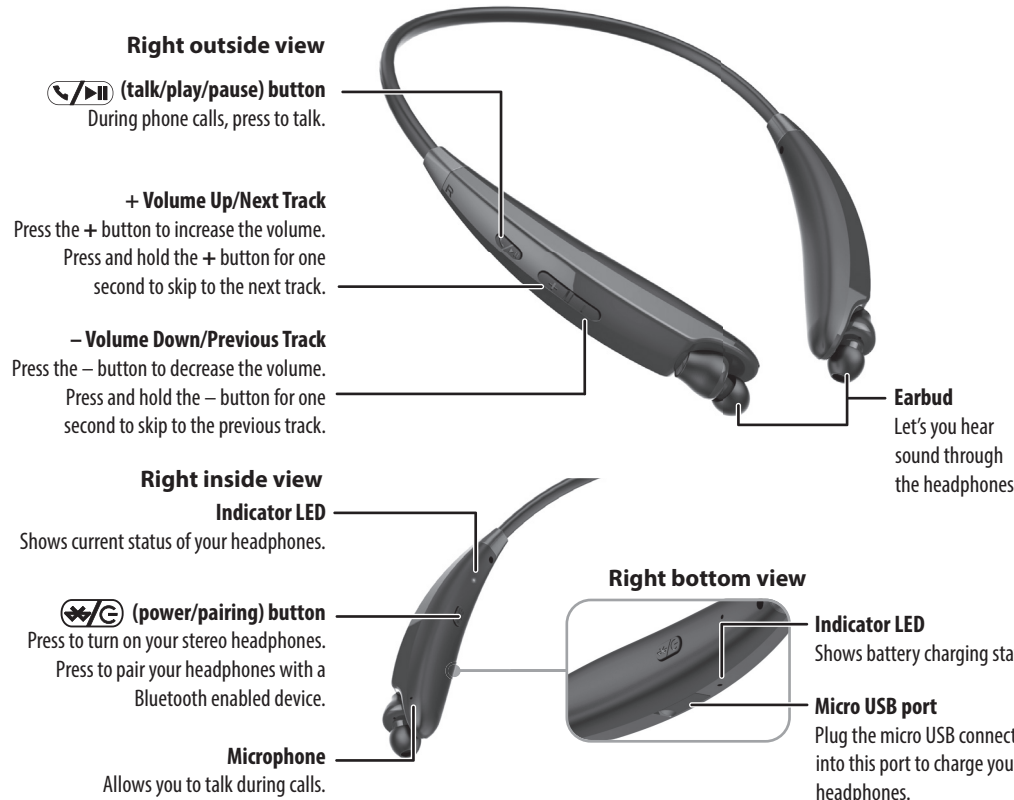

Final flat size: 23.62 x 5.5 in. (600 x 139.7 mm)
 Final fold size: 5.9 x 5.5 in. (150 x 139.7 mm)

BLUETOOTH INDICATIONS

ACTION	OPERATION	LED INDICATION	SOUND
Power on	Press and hold (power button) more than two seconds	Blue LED lights for 1.5 seconds	"power on"
Power off	Press and hold (power button) more than three seconds	Red LED lights for 1.5 seconds	"power off"
Pairing mode	Press and hold (pairing button) more than four seconds in power off mode	Blue and red LED blinking alternately	Two short beeps
Play/Pause	Press and release (talk button)	LED off	
Volume Up/Down	Press and release + or - button	LED off	Two high beeps for maximum volume
Next Track/Previous Track	Press and hold + or - button	LED off	
Incoming call		LED off	Rings and vibrates every two seconds
Answer call	Press (talk button) when a call is incoming	LED off	One long beep
Reject call	Press and hold (talk button) when a call is incoming	LED off	Two long beeps
Redial	Double press (talk button)	LED off	Two short beeps
Reset device list	In power off mode, long press (power button) more than six seconds	Red LED lights for two seconds	Vibrates for two seconds

CHARGING YOUR STEREO HEADPHONES

When the red indicator LED blinks three times every minute and the voice prompt says "battery low," the battery is low. To charge the battery, plug the charging cable into your computer and into the micro USB port on your headphones. The red LED turns on to indicate that the battery is charging and turns off when fully charged.

USING YOUR STEREO HEADPHONES

Turning your stereo headphones on and off

- 1 Place the headphones around your neck and put the earbuds in your ears.
- 2 Press and hold (power button) more than two seconds. The LED blinks blue (when turned on) or red (when turned off) and the voice prompt says "Power on "or "Power off".

PAIRING YOUR STEREO HEADPHONES

Notes:

- Range is 33 feet (10 meters)
- Supports easy pairing
- Prompts you by saying "Your device is connected," when connected
- Supports a battery indicator icon on an iOS device
- Prompts you by saying "Your device is disconnected," when the bluetooth device disconnects.

Pairing with a cell phone or MP3 player

- 1 With your stereo headphones turned off, press and hold (power button) for four seconds. The blue and red LEDs blink alternately.
- 2 On your phone or MP3 player, select **INSIGNIA NS-HNECKPLUS** from the list of discovered devices, then enter the password **0000** (four zeros) (if required) to pair your headphones. For more information on pairing Bluetooth devices to your cell phone or MP3 player, see the device's documentation.

Note: You only have to pair a device once. Your headphones store the device information and automatically reconnect to the device.



Pairing with a computer running Windows

Note: Before you pair the headphones with the computer, make sure that the computer is equipped with Bluetooth. Refer to the computer's documentation or contact the computer manufacturer for more information. If your computer is not Bluetooth compatible, install a Bluetooth USB adapter (dongle).

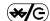
- 1 Turn on Bluetooth on the computer.
- 2 Double-click the **Bluetooth** icon in the system tray, then click **Add a device**.
- 3 With the headphones turned off, press and hold  (power button) for four seconds. The LED blinks blue and red alternately. Pairing mode is activated.
- 4 Double-click the **INSIGNIA NS-HNECKPLUS** icon on the computer or highlight the icon, then click **Next**.
Note: If you are unable to locate the **INSIGNIA NS-HNECKPLUS** icon, click the **Search Again** button.
- 5 If required, enter **0000** (four zeros) in the **Bluetooth security code** field, then click **Next**.
- 6 After the headphones are paired, click **Close**.

Pairing with a Mac computer

Note: Before you pair the headphones with the computer, make sure that the computer is Bluetooth compatible. Refer to the computer's documentation or contact the computer manufacturer for more information. If your computer is not Bluetooth compatible, install a Bluetooth USB adapter (dongle).

- 1 Turn on Bluetooth on the computer.
- 2 Click the **Bluetooth status** menu.
- 3 Click **Set up Bluetooth Device**. The *Bluetooth Setup Assistant* opens.
- 4 Click **Continue**.
- 5 Select **Headset** as the device type, then click **Continue**.
- 6 With the headphones turned off, press and hold  (power button) for four seconds. The LED blinks blue and red alternately. Pairing mode is activated.
- 7 Select **INSIGNIA NS-HNECKPLUS**, then click **Continue**. The computer gathers information.
- 8 Click **Continue**.
- 9 Enter **0000** (four zeros) into the **Passkey** field, then click **Continue**.
- 10 Click **Quit** to finish.
Note: To use your headphones, they must be selected as the default input and output device on the computer.
- 11 Click **System Preferences**, then click **Sound**.
- 12 Under **Input**, select **INSIGNIA NS-HNECKPLUS**, then under **Output**, select **INSIGNIA NS-HNECKPLUS**.



RESETTING YOUR STEREO HEADPHONES

With your headphones turned off, press and hold the power button for six seconds. Your headphones vibrate for two seconds and enter pairing mode.

SPECIFICATIONS

Dimensions:	5.9 × .7 × 6.7 in. (14.9 × 1.8 × 17 cm)
Weight:	56.4 g
Bluetooth version:	Bluetooth 4.1
Supported profiles:	A2DP, AVRCP, HFP, HSP
Frequency spectrum:	2.4 ~ 2.4835 GHz ISM Band
Working distance:	Up to 33 ft. (10 m)
Operating temperature:	23 ~ 122° F (-5 ~ 50° C)
Operating time:	Talk: 10 hours Music: 10 hours of music track playback
Standby time:	Up to 200 hours
Average charging time:	Two hours

TROUBLESHOOTING

No power

- Make sure that the headphones' battery is charged.
- Make sure that your headphones are turned on.

No sound or low volume

- Turn up the volume on your headphones and Bluetooth device. Make sure that your Bluetooth device is not muted.
- Shorten the distance between your headphones and your Bluetooth device.
- Make sure that your Bluetooth device is turned on, Bluetooth is turned on, and INSIGNIA NS-HNECKPLUS is selected.
- Make sure that your headphones are not paired to another Bluetooth device.
- Make sure that your Bluetooth device is not paired to another Bluetooth device.

Cannot establish Bluetooth connection

- Make sure that your headphones are in pairing mode. Press and hold the  button for four seconds to re-enter pairing mode.
- Shorten the distance between your headphones and your Bluetooth device.
- Turn your devices off, then on. Re-pair your headphones and your Bluetooth device.
- Make sure that your headphones are not paired to another Bluetooth device.
- Make sure that your Bluetooth device is not connected to any other device.
- Make sure that your headphones and Bluetooth device are both in pairing mode.
- Make sure that your Bluetooth device supports Bluetooth v4.0.
- Make sure that you have selected INSIGNIA NS-HNECKPLUS on your Bluetooth device.

My Bluetooth device keeps unpairing

- Shorten the distance between your headphones and your Bluetooth device.
- If the battery on your Bluetooth device is low, recharge the battery.
- If the battery on your headphones is low, recharge the battery.

INSIGNIA NS-HNECKPLUS does not appear on my Bluetooth device

- Shorten the distance between your headphones and your Bluetooth device.
- Put your headphones into pairing mode, then refresh your list of Bluetooth devices. For more information, see the documentation that came with your Bluetooth device.

Poor sound quality

- Shorten the distance between your headphones and your Bluetooth device.
- Pair your headphones to a different Bluetooth device.
- Try changing the volume on your Bluetooth device.



LEGAL NOTICES

FCC statement:

This device complies with Part 15 of the FCC Rules. Operation is subject to the following two conditions: (1) this device may not cause harmful interference, and (2) this device must accept any interference received, including interference that may cause undesired operation.

FCC Caution:

Changes or modifications not expressly approved by the party responsible for compliance could void the user's authority to operate the equipment.

FCC Statement:

Note: This equipment has been tested and found to comply with the limits for a Class B digital device, pursuant to Part 15 of the FCC Rules. These limits are designed to provide reasonable protection against harmful interference in a residential installation. This equipment generates, uses, and can radiate radio frequency energy and, if not installed and used in accordance with the instructions, may cause harmful interference to radio communications. However, there is no guarantee that interference will not occur in a particular installation. If this equipment does cause harmful interference to radio or television reception, which can be determined by turning the equipment off and on, the user is encouraged to try and correct the interference by one or more of the following measures:

- Reorient or relocate the receiving antenna.
- Increase the separation between the equipment and receiver.
- Connect the equipment into an outlet on a circuit different from that to which the receiver is connected.
- Consult the dealer or an experienced radio/TV technician for help.

RSS-Gen & RSS-247 Statement:

This device complies with Industry Canada license-exempt RSS standard(s).

Operation is subject to the following two conditions: (1) this device may not cause interference, and (2) this device must accept any interference, including interference that may cause undesired operation of the device.

Le présent appareil est conforme aux CNR d'Industrie Canada applicables aux appareils radio exempts de licence. L'exploitation est autorisée aux deux conditions suivantes : (1) l'appareil ne doit pas produire de brouillage, et (2) l'utilisateur de l'appareil doit accepter tout brouillage radioélectrique subi, même si le brouillage est susceptible d'en compromettre le fonctionnement.

RSS-102 Statement

This equipment complies with Industry Canada radiation exposure limits set forth for an uncontrolled environment.

Cet équipement est conforme à l'exposition aux rayonnements Industry Canada limites établies pour un environnement non contrôlé.

ONE-YEAR LIMITED WARRANTY

Visit www.insigniaproducts.com for details.

CONTACT INSIGNIA:

1-877-467-4289 (U.S. and Canada)
01-800-926-3000 (Mexico)
www.insigniaproducts.com

INSIGNIA is a trademark of Best Buy and its affiliated companies
Distributed by Best Buy Purchasing, LLC
7601 Penn Ave South, Richfield, MN 55423 U.S.A.
©2018 Best Buy. All rights reserved. **Made in China**

