

4

3

2

1

B

B

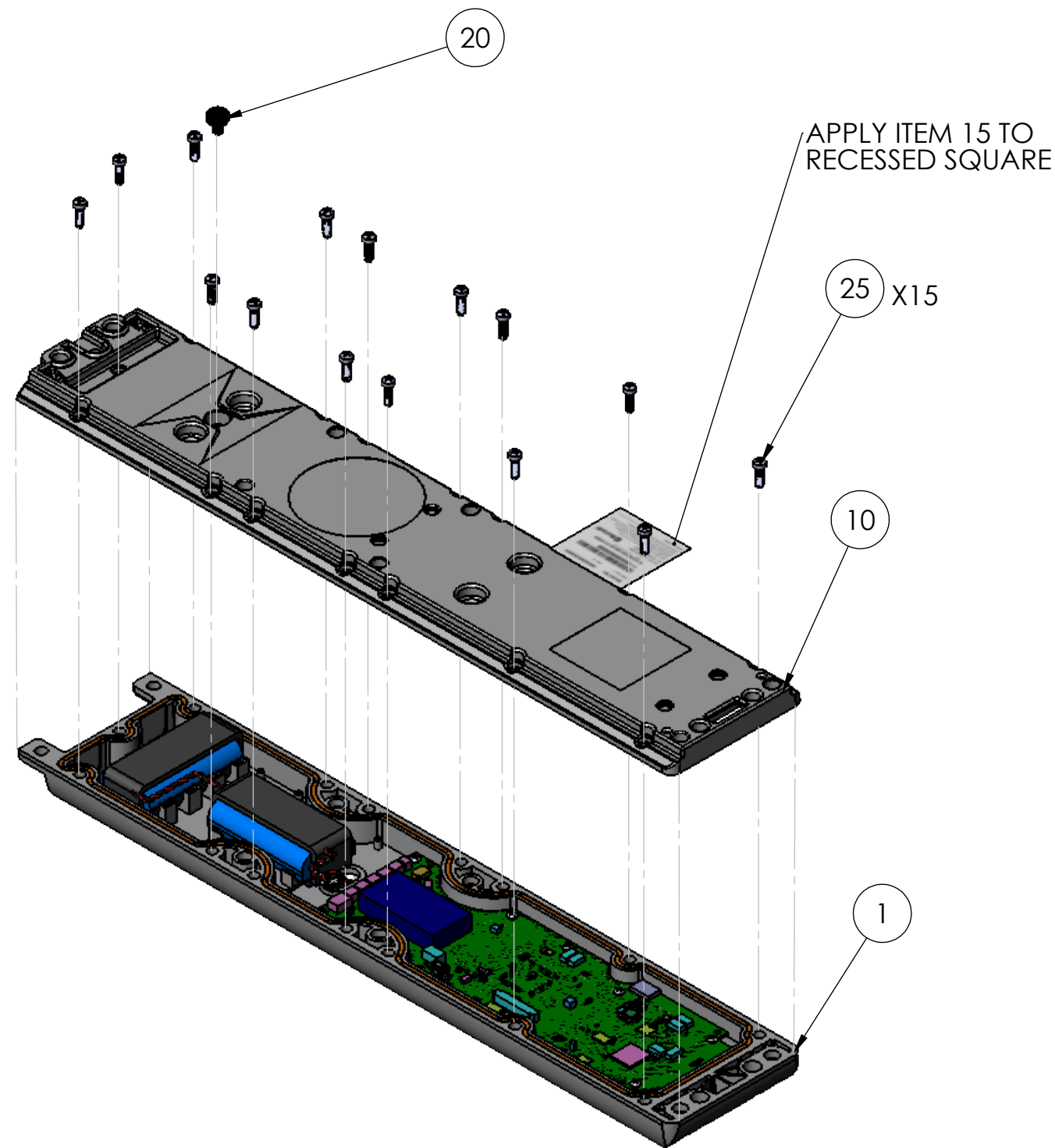

- NOTES:
1. APPLY ITEM 10 TO ITEM 1 SECURE WITH ITEM 25
  2. TORQUE ITEM 25 TO 12IN\*LB FOLLOW TORQUE PATTERN 01047001-T
  3. IP TEST ASSEMBLY PER TE-DOC0009
  4. APPLY ITEM 20 TO ASSEMBLY
  5. TORQUE ITEM 20 TO 2.66IN\*LB
  6. APPLY ITEM 15 TO HOUSING X2
  7. REFERENCE WRK-01047003

A

A

A	ECO SB386 RELEASE REV A NPI BUILD AUTHORIZED			4/8/21	BER		
XA	ECO SB382 INITIAL RELEASE			2/2/21	BER		
REV	DESCRIPTION			DATE	APPROVED		
UNLESS OTHERWISE SPECIFIED:			NAME	DATE	TELULAR		
DIMENSIONS ARE IN INCHES		DRAWN	BER	1/29/2021			
TOLERANCES:		CHECKED	WK	1/29/2021			
FRACTIONAL<MOD-PM>		ENG APPR.	BER	1/29/2021			
ANGULAR: MACH.005+/-		MFG APPR.	KJ	1/29/2021			
BEND .005+/-		Q.A.	WK	1/29/2021	TITLE:  FINAL ASSEMBLY, SKYVUE VUE2000		
TWO PLACE DECIMAL .01+/-		COMMENTS:					
THREE PLACE DECIMAL .005+/-							
INTERPRET GEOMETRIC TOLERANCING PER:							
MATERIAL							
FINISH					SIZE B	DWG. NO. 01047003	REV A
DO NOT SCALE DRAWING					SCALE: 1:3	WEIGHT:	SHEET 1 OF 1

PROPRIETARY AND CONFIDENTIAL  
THE INFORMATION CONTAINED IN THIS DRAWING IS THE SOLE PROPERTY OF SKYBITZ A TELULAR CORPORATION. ANY REPRODUCTION IN PART OR AS A WHOLE WITHOUT THE WRITTEN PERMISSION OF TELULAR ENGINEERING IS PROHIBITED.