

CMANVUE001 SkyBitz SkyVue (VUE2000) Dry Van Install

SkyVue Components

- SkyVue Tracking Device
- SkyVue Mounting Bracket
- 6, 10-32 Tamper Proof Screws
- SkyVue Short Shroud
- 6, 1/8 Inch Sealing Blind Rivets
- 3m Primer 94 Ampoule
- Activation Magnet
- SkyVue Serial Number Sticker

Tools Required:

- Power Drill
- 1/8 Inch Drill Bit
- 5/32 Inch Pin In Hex Tamper Proof Screwdriver
- Blind Rivet Tool
- 50/50 Isopropyl Alcohol/Water Solution
- Clean Rags
- Green Scotch-Brite pad
- Tape Measure

SkyVue Activation

Begin by activating the SkyVue to ensure it receives all its updates by the time the installation is completed. This will help to expedite the installation verification testing required to release the asset into service.

- Remove the SkyVue from the box and make sure it is outdoors with a clear view of the Sky
- To activate the SkyBitz SkyVue, hold the magnet in the location shown until the LED begins to blink rapidly
- Once the LED begins to blink rapidly, hold the magnet in place until the LED changes to a slower blink of about once a second
- This fast to slow blink transition confirms the SkyVue has been activated and should occur within 15 seconds after the fast blink starts

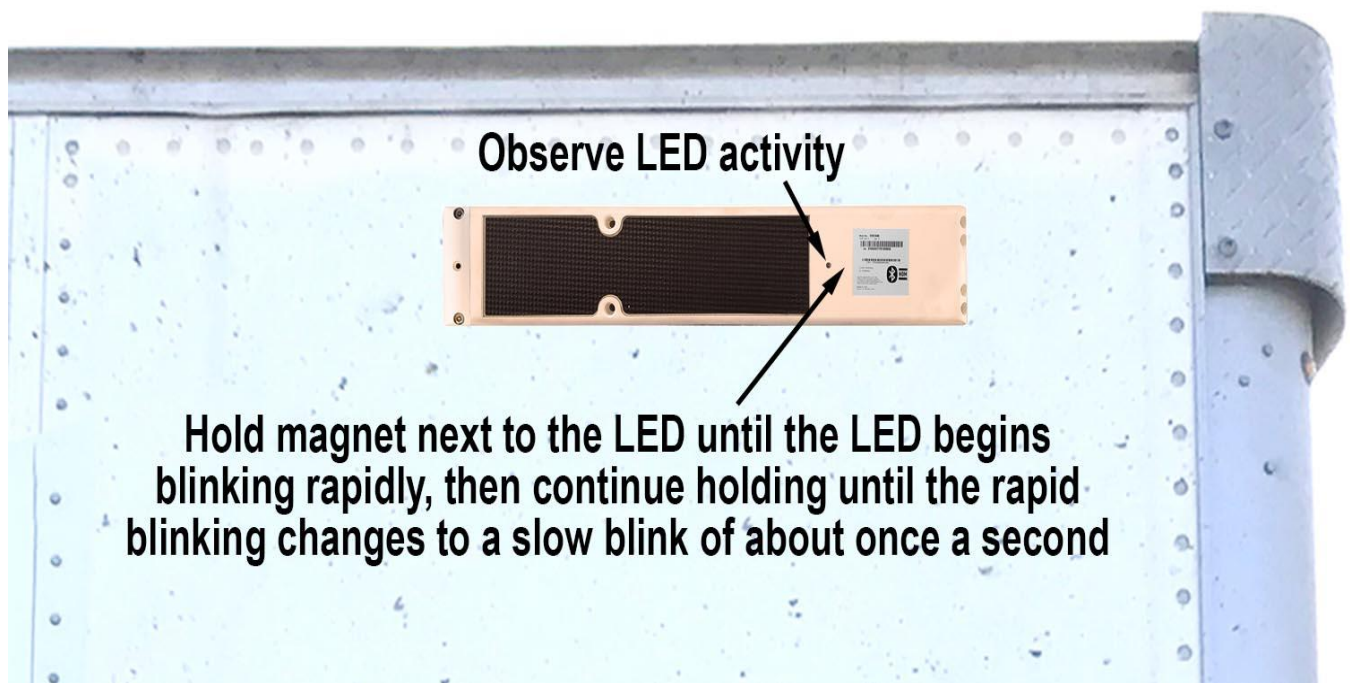

SkyVue Mounting Location

The SkyBitz SkyVue (Model VUE2000) will be mounted to the exterior front wall of a Dry Van Trailer. The locations described below are recommended for optimal solar exposure as well as protection from external damage. The dimensions noted below are guidelines and may be adjusted to avoid mounting on top of any logos or asset identification. For a Plate Nose Trailer, the SkyVue will be mounted to the front wall horizontally, about 3 inches down from the bottom of the top rail, and about 12 inches over from the roadside edge with the connector on the left.

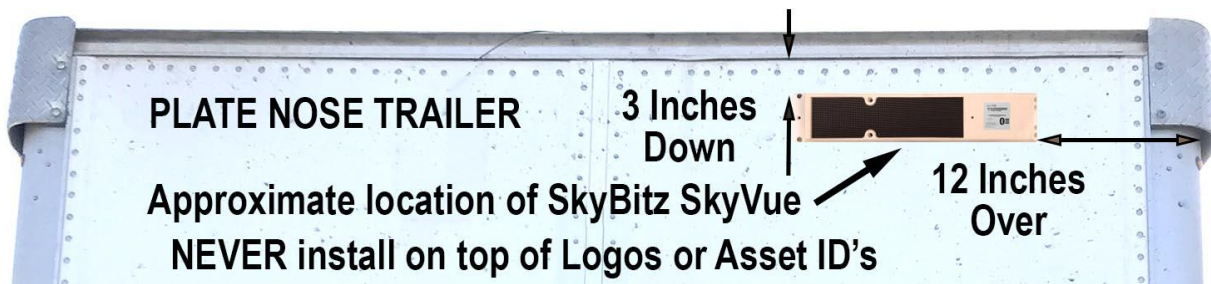

For a Sheet and Post Nose Trailer, the SkyVue will be mounted to the front wall in relatively the same orientation and location unless the location and spacing of the rivets and posts on the front wall prohibit fitting the SkyVue horizontally as described. In some instances, the SkyVue will need to be mounted vertically about 3 inches down from the bottom of the top rail, and about 12 inches from the roadside edge with the connector at the top as shown below.

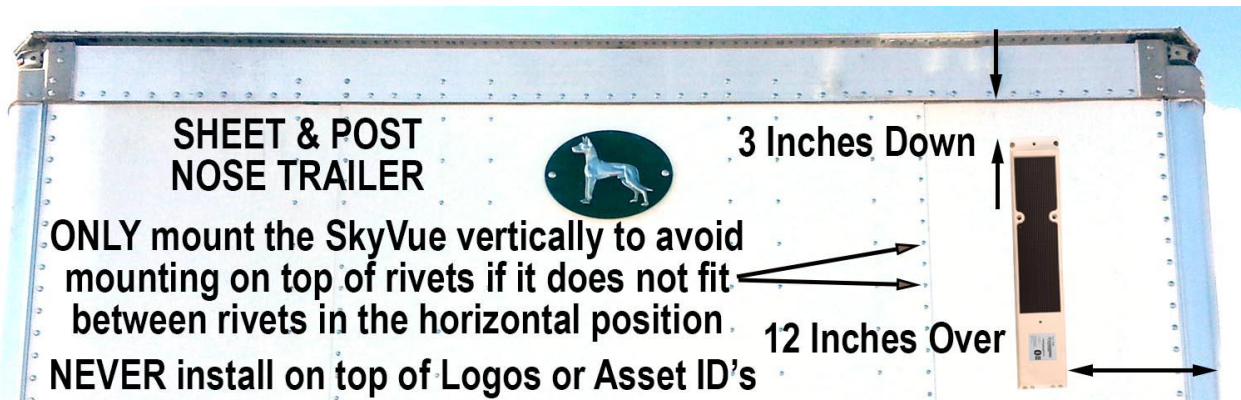

SkyVue Tracking System Installation

- Use the SkyVue bracket as a template to mark the bracket location, and the 3 VHB tape locations on the wall

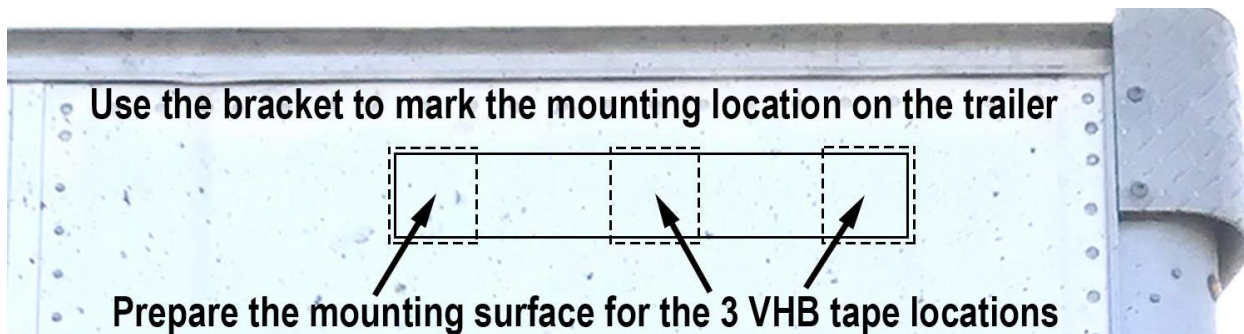

- Prep the trailer wall for the 3 VHB tape mounting surface locations
 - **Clean** with IPA solution
 - **Abrade** lightly with Scotch-Brite pad
 - **Clean again** with IPA solution
 - **Prime** with 3M Primer 94 and wait at least 3 minutes
- Remove the liner from the 3 VHB tape locations on the bracket, place the bracket onto the mounting location on the trailer wall, and firmly press it onto the wall

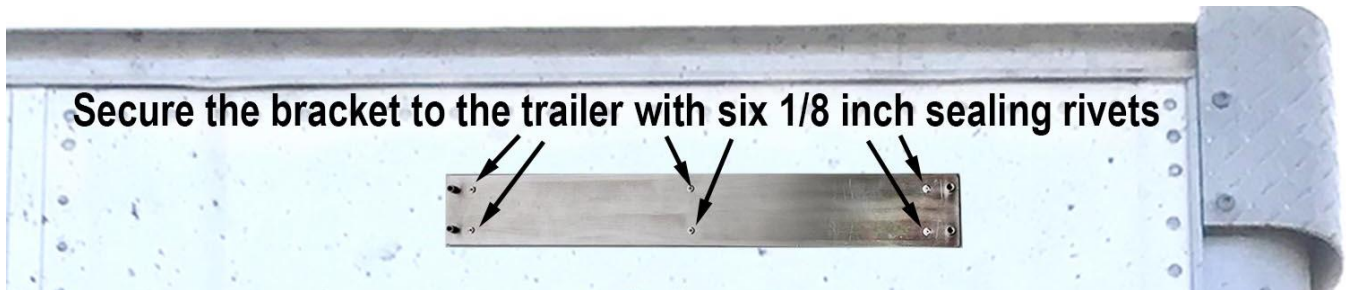

- Use the rivet holes in the bracket as a guide and drill six 1/8-inch holes in the trailer wall
- Secure the bracket to the wall with the six 1/8-Inch sealing rivets
- Orient the SkyVue with the connector on the left for a horizontal install, or with the connector at the top for a vertical install, and install it on the bracket

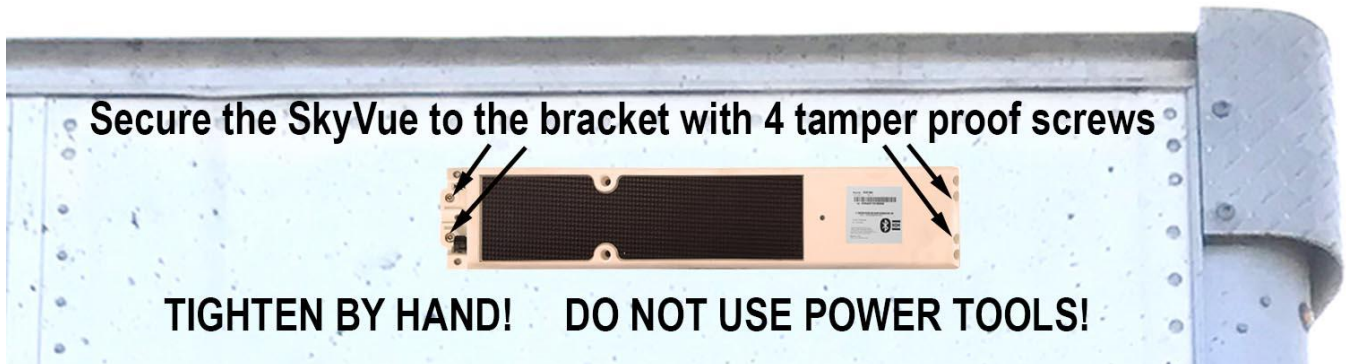

- **Using a hand driver**, secure the SkyVue to the bracket with four, 10-32 tamper proof screws

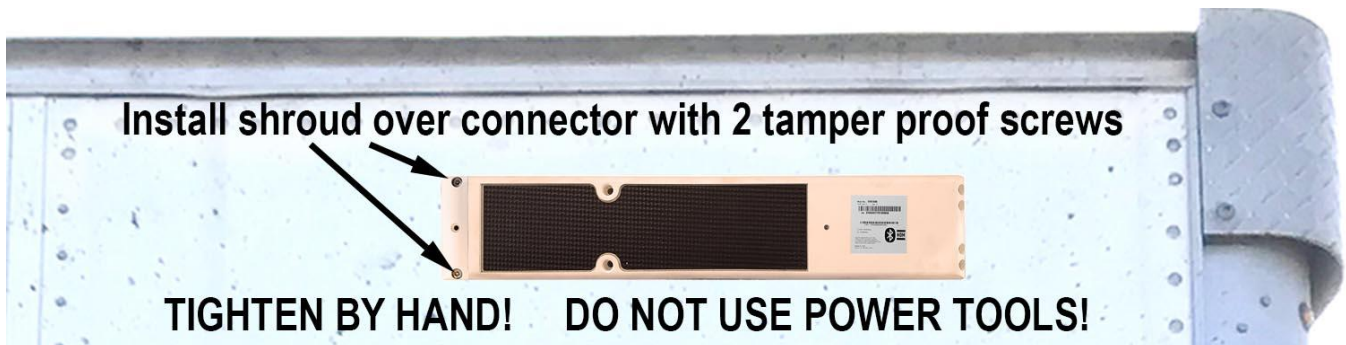

- Fasten the Short Shroud to the SkyVue with two, 10-32 tamper proof screws
- Remove the SkyBitz SkyVue serial number sticker and tape from the SkyVue and adhere the sticker to the trailer front wall near the 7-Way box

SkyVue Asset Association and Install Verification

- Use the SkyBitz SkyMobile App to associate the Asset ID with the SkyVue Serial Number
- Continue using SkyMobile to complete the installation process and confirm the installation was a success
- Contact CustomerCare@SkyBitz.com for SkyBitz SkyMobile App credentials if needed

Changes or modifications to this not expressly approved by Telular could void the user's authority to operate the equipment.

This device complies with part 15 of the FCC Rules. Operation is subject to the following two conditions:

- (1) This device may not cause harmful interference, and
- (2) This device must accept any interference received, including interference that may cause undesired operation.

The device meets RF exposure requirements for FCC and Industry Canada RSS-102 for general population

at 20 CM distance from users and bystanders.

Les modifications apportées à ce projet qui ne sont pas expressément approuvées par Telular pourraient annuler le pouvoir de l'utilisateur d'utiliser l'équipement.

L'appareil est conforme à la partie 15 des règles de la FCC. Le fonctionnement est soumis aux deux conditions suivantes:

- (1) Cet appareil ne peut pas causer d'interférences
- (2) Cet appareil doit accepter toute interférence reçue, y compris les interférences qui peuvent causer un fonctionnement indésirable.

L'appareil répond aux exigences d'exposition aux radiofréquences pour la FCC et Industrie Canada RSS-102 pour la population en général