

## SkyBitz Kinnect/SHB6510 Dry Van Install

### Kinnect Components

- Kinnect Tracking Device
- Kinnect Mounting Bracket
- 6, 10-32 Tamper Proof Screws
- Kinnect Short Shroud
- 6, 1/8 Inch Sealing Blind Rivets
- 3m Primer 94 Ampoule
- Activation Magnet
- Kinnect Serial Number Sticker

### Tools Required:

- Power Drill
- 1/8 Inch Drill Bit
- 5/32 Inch Pin-In Hex Tamper Proof Screwdriver
- Blind Rivet Tool
- 50/50 Isopropyl Alcohol/Water Solution
- Clean Rags
- Green Scotch-Brite pad
- Tape Measurer

### Kinnect Activation

Begin by activating the Kinnect to ensure it receives all its updates by the time the installation is completed. This will help to expedite the installation verification testing required to release the asset into service.

- Remove the Kinnect from the box and make sure it is outdoors with a clear view of the Sky
- To activate the SkyBitz Kinnect, hold the magnet in the location shown until the LED begins to blink rapidly
- Once the LED begins to blink rapidly, hold the magnet in place until the LED changes to a slower blink of about once a second
- This fast to slow blink transition confirms the Kinnect has been activated and should occur within 15 seconds after the fast blink starts

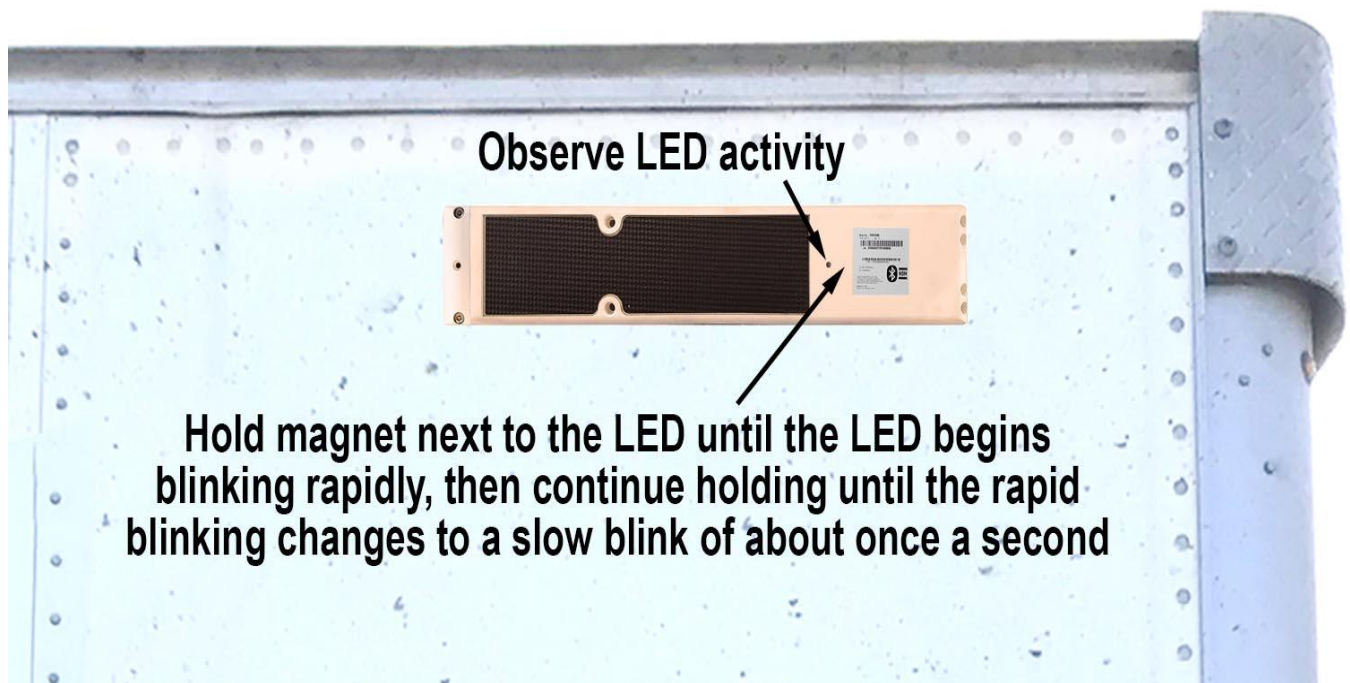

## Kinnect Mounting Location

The SkyBitz Kinnect (Model SHB6510) will be mounted to the exterior front wall of a Dry Van Trailer. The locations described below are recommended for optimal communications with optional SkyBitz wireless sensors such as the SkyBitz SkyCamera and Wireless Multi Sensor. The dimensions noted below are guidelines and may be adjusted to avoid mounting on top of any logos or asset identification. For a Plate Nose Trailer, the Kinnect will be mounted to the front wall horizontally, about 3 inches down from the bottom of the top rail, and about 12 inches over from the roadside edge with the connector on the left.

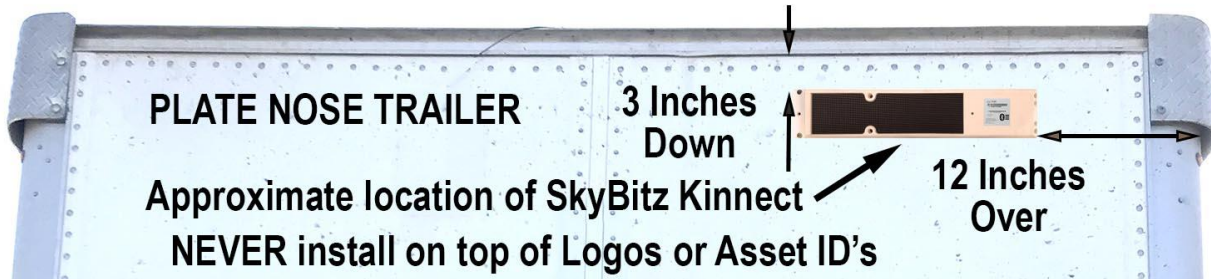

For a Sheet and Post Nose Trailer, the Kinnect will be mounted to the front wall in relatively the same orientation and location unless the location and spacing of the rivets and posts on the front wall prohibit fitting the Kinnect horizontally as described. In some instances, the Kinnect will need to be mounted vertically about 3 inches down from the bottom of the top rail, and about 12 inches from the roadside edge with the connector at the top as shown below.

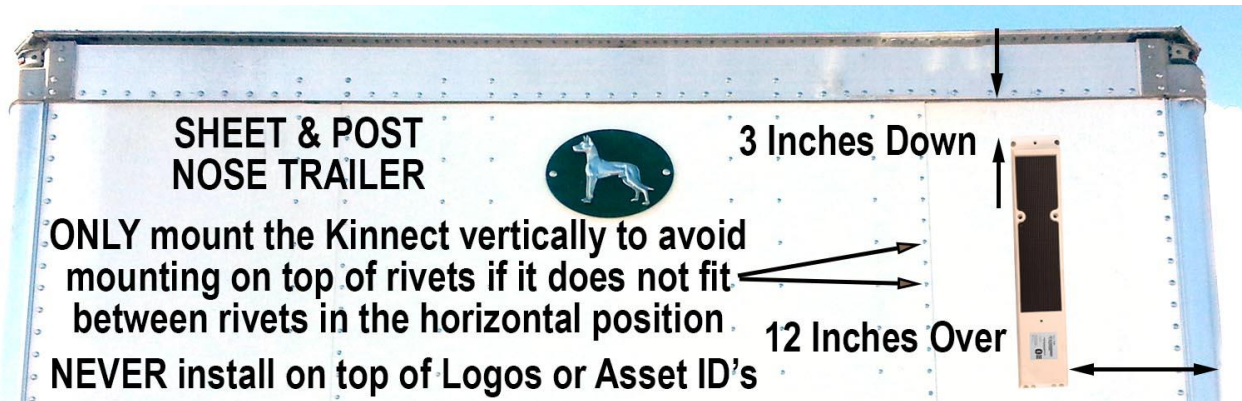

## Kinnect Tracking System Installation

- Use the Kinnect bracket as a template to mark the bracket location, and the 3 VHB tape locations on the wall

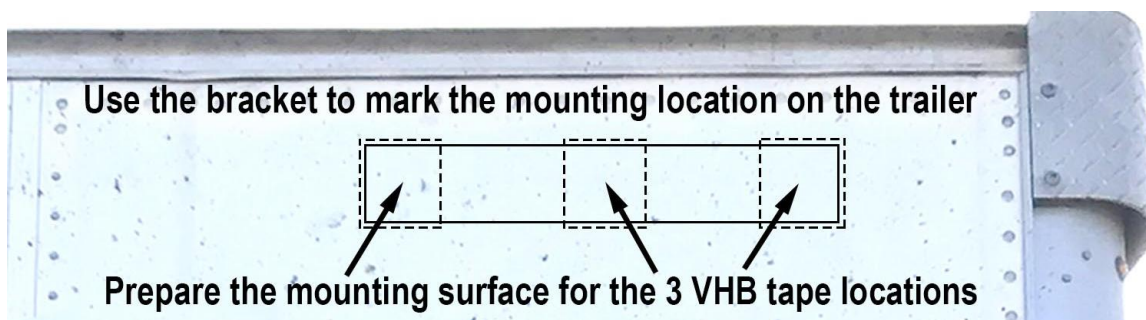

- Prep the trailer wall for the 3 VHB tape mounting surface locations
  - **Clean** with IPA solution
  - **Abrade** lightly with Scotch-Brite pad
  - **Clean again** with IPA solution
  - **Prime** with 3M Primer 94 and wait at least 3 minutes
- Remove the liner from the 3 VHB tape locations on the bracket, place the bracket onto the mounting location on the trailer wall, and firmly press it onto the wall

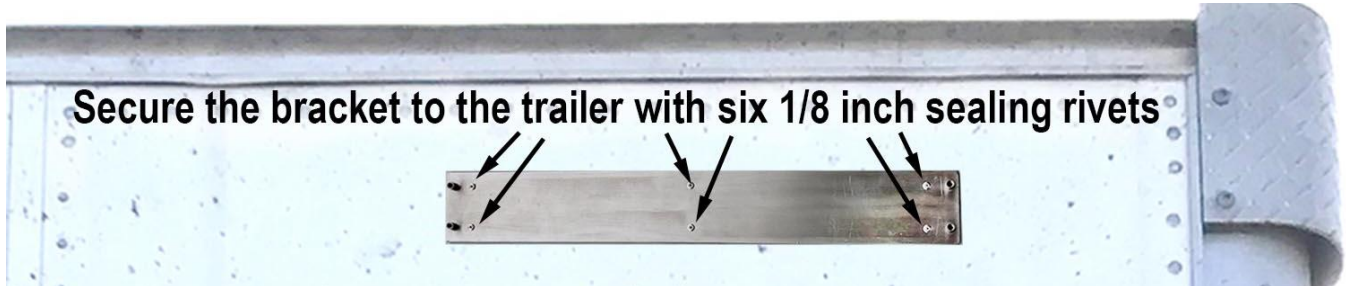

- Use the rivet holes in the bracket as a guide and drill six 1/8-inch holes in the trailer wall
- Secure the bracket to the wall with the six 1/8-Inch sealing rivets
- Orient the Kinnect with the connector on the left for a horizontal install, or with the connector at the top for a vertical install, and install it on the bracket

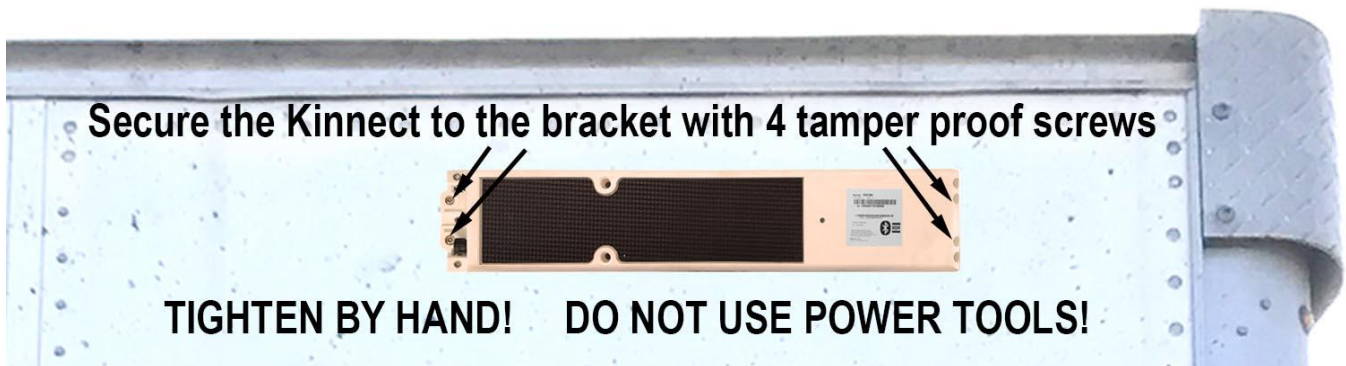

- **Using a hand driver**, secure the Kinnect to the bracket with four, 10-32 tamper proof screws

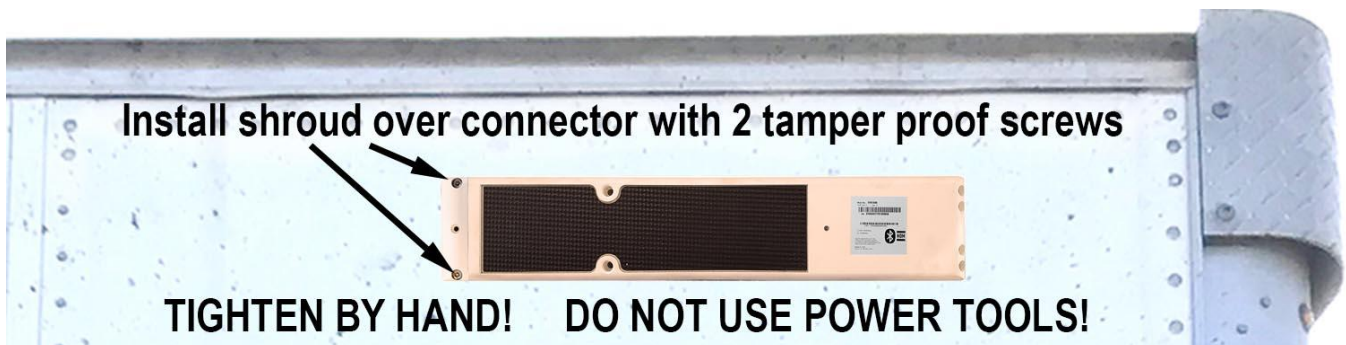

- Fasten the Short Shroud to the Kinnect with two, 10-32 tamper proof screws
- Remove the SkyBitz Kinnect serial number sticker and tape from the Kinnect and adhere the sticker to the trailer front wall near the 7-Way box

## Kinnect Asset Association and Install Verification

- Use the SkyBitz SkyMobile App to associate the Asset ID with the Kinnect Serial Number
- Continue using SkyMobile to complete the installation process and confirm the installation was a success
- Contact [CustomerCare@SkyBitz.com](mailto:CustomerCare@SkyBitz.com) for SkyBitz SkyMobile App credentials if needed

Changes or modifications to this not expressly approved by Telular could void the user's authority to operate the equipment.

This device complies with part 15 of the FCC Rules. Operation is subject to the following two conditions:

- (1) This device may not cause harmful interference, and
- (2) This device must accept any interference received, including interference that may cause undesired operation.

The device meets RF exposure requirements for FCC and Industry Canada RSS-102 for general population

at 20 CM distance from users and bystanders.

Les modifications apportées à ce projet qui ne sont pas expressément approuvées par Telular pourraient annuler le pouvoir de l'utilisateur d'utiliser l'équipement.

L'appareil est conforme à la partie 15 des règles de la FCC. Le fonctionnement est soumis aux deux conditions suivantes:

- (1) Cet appareil ne peut pas causer d'interférences
- (2) Cet appareil doit accepter toute interférence reçue, y compris les interférences qui peuvent causer un fonctionnement indésirable.

L'appareil répond aux exigences d'exposition aux radiofréquences pour la FCC et Industrie Canada RSS-102 pour la population en général