

SAR information on this device is on file with the FCC and can be found under the Display Grant section of www.fcc.gov/oet/ea/fccid.

Prohibition of Co-location

This device and its antenna(s) must not be co-located or operating in conjunction with any other antenna or transmitter.

IMPORTANT NOTE:

Radiation Exposure Statement: This equipment complies with ISED radiation exposure limits set forth for an uncontrolled environment. This equipment should be installed and operated with greater than 20cm between the radiator & your body.

Déclaration d'exposition aux radiations: Cet équipement est conforme aux limites d'exposition aux rayonnements ISED établies pour un environnement non contrôlé. Cet équipement doit être installé et utilisé à plus de 20cm entre le radiateur et votre corps.



WARNING! This equipment must be installed and operated in accordance with provided instructions and the antenna(s) used for this transmitter must be installed to provide a separation distance of at least 20cm from all persons and must not be co-located or operating in conjunction with any other antenna or transmitter.

Compliance Statement of Innovation, Science and Economic Development Canada (ISED)

This device complies with Innovation, Science and Economic Development Canada licence exempt RSS standard(s). Operation is subject to the following two conditions: (1) this device may not cause interference, and (2) this device must accept any interference, including interference that may cause undesired operation of the device.

CAN ICES-003(B)/NMB-003(B)

Déclaration de conformité de Innovation, Sciences et Développement économique Canada (ISED)

Le présent appareil est conforme aux CNR d'Innovation, Sciences et Développement économique Canada applicables aux appareils radio exempts de licence. L'exploitation est autorisée aux deux conditions suivantes : (1) l'appareil ne doit pas produire de brouillage, et (2) l'utilisateur de l'appareil doit accepter tout brouillage radioélectrique subi, même si le brouillage est susceptible d'en compromettre le fonctionnement.

CAN ICES-003(B)/NMB-003(B)

Safety Notices

- Use this product in environments with ambient temperatures between 0°C (32°F) and 40°C (104°F).
- Refer to the rating label on the bottom of your product and ensure your power adapter complies with this rating.
- DO NOT place on uneven or unstable work surfaces. Seek servicing if the casing has been damaged.
- DO NOT place or drop objects on top and do not shove any foreign objects into the product.
- DO NOT expose to or use near liquids, rain, or moisture. DO NOT use the modem during electrical storms.
- DO NOT cover the vents on the product to prevent the system from getting overheated.
- DO NOT use damaged power cords, accessories, or other peripherals.
- If the Adapter is broken, do not try to fix it by yourself. Contact a qualified service technician or your retailer.
- To prevent electrical shock hazard, disconnect the power cable from the electrical outlet before relocating the system.
- DO NOT mount this equipment higher than 2 meters.

Consignes de sécurité

- Utilisez ce produit dans un environnement dont la température ambiante est comprise entre 0°C (32°F) et 40°C (104°F).
- Référez-vous à l'étiquette située au dessous du produit pour vérifier que l'adaptateur secteur répond aux exigences de tension.
- NE PAS placer sur une surface irrégulière ou instable. Contactez le service après-vente si le châssis a été endommagé.
- NE PAS placer, faire tomber ou insérer d'objets sur/dans le produit.
- NE PAS exposer l'appareil à la pluie ou à l'humidité, tenez-le à distance des liquides. NE PAS utiliser le modem lors d'un orage.
- NE PAS bloquer les ouvertures destinées à la ventilation du système pour éviter que celui-ci ne surchauffe.
- NE PAS utiliser de cordons d'alimentation, d'accessoires ou autres périphériques endommagés.
- Si l'adaptateur est endommagé, n'essayez pas de le réparer vous-même. Contactez un technicien électrique qualifié ou votre revendeur.
- Pour éviter tout risque de choc électrique, débranchez le câble d'alimentation de la prise électrique avant de toucher au système.
- NE PAS monter cet équipement à plus de 2 mètres.

The power supply cord(s) must be plugged into socket-outlet(s) that is / are provided with a suitable earth ground.

Los cables de alimentación se deben enchufar a tomas de corriente que estén provistas de una conexión a tierra adecuada.

ASUS

Quick Setup Guide

Gigabit PoE+ VPN Wired Router Router con cable Gigabit PoE+ VPN EBG19P

Router Overview Descripción general del enrutador

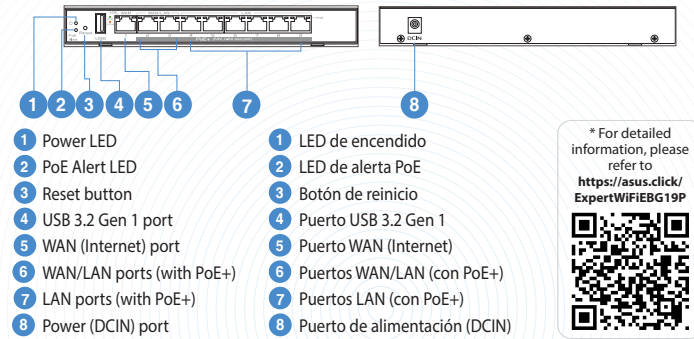

Specifications/Especificaciones:

| | |
|---|--|
| DC Power adapter Adaptador de Energía DC | DC Output: +54V with max 2.778A current Salida de +54V con corriente max 2,778A |
| Operating Temperature Temperatura de Operación | 0~40°C Almacenamiento -20~70°C |
| Operating Humidity Humedad de Operación | 10~95% Almacenamiento 5~95% |
| PoE Type / Tipo PoE | 802.3at, Type 2, PoE+ |

| LED Indicators / Indicadores LED | | | |
|--|--------------------------------------|-----------------|----------------|
| Link/Act LED (Left) LED de enlace/actuación (Izquierda) | PoE LED (Right) LED PoE (Derecha) | | |
| 1G | Green Verde | ON Encendido | Green Verde |
| 100M/10M | Amber Ambar | OFF Apagado | N/A |
| Sending or Receiving data Enviando o recibiendo datos | Blinking Parpadeando | | |

PoE Consideration

The PoE and PoE+ power supplied by the switch is prioritized in ascending port order, with a total PoE and PoE+ power budget of 1233W across port 2 to port 9.

Consideración de PoE

La alimentación PoE y PoE+ suministrada por el conmutador se prioriza en orden ascendente de puertos, con un límite total de alimentación PoE y PoE+ de 1233 W en los puertos 2 a 9.

| Standard / Estándar | 802.af (802.3at Type1) PoE | 802.3at Type2 PoE+ | 802.3bt Type3 4PPoE or PoE++ | 802.3bt Type4 4PPoE or PoE++ |
|---|----------------------------|--------------------|------------------------------|------------------------------|
| Max. power reserved by the device Potencia máxima reservada por el dispositivo | 12.95W | 25.50W | 51W | 71.3W |
| Max. power delivered to the device Potencia máx. suministrada al dispositivo | 15.4W | 30W | 60W | 100W |

1

Reboot modem and ensure its connection is ready**Reiniciar el módem y asegurarse de que su conexión está lista**

Notice: Unplug modem for 10 sec then plug back in

Aviso: Desenchufe el módem durante 10 segundos y vuelva a enchufarlo

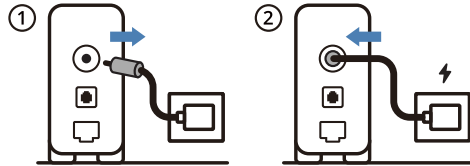

2

Prepare your ASUS router and power it on**Prepara tu enrutador ASUS y enciéndelo**

Once the power LED lights up, it's ready for setup

Una vez que la luz de estado es azul fijo, está listo para la instalación

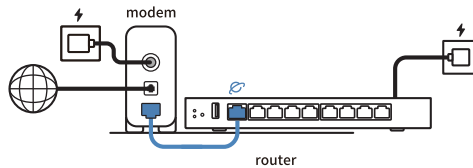

3

[App] Scan the code and download ASUS ExpertWiFi app for setup**[App] Escanea el código y descarga la aplicación ASUS ExpertWiFi para la instalación**

ASUS ExpertWiFi Q

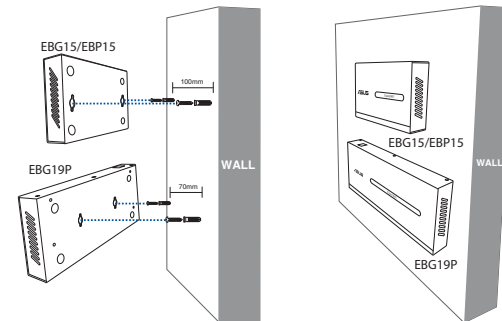
<https://asus.click/asusexpertwifi><https://asus.click/asusexpertwifi>**[Web] Open a web browser and navigate to <http://expertwifi.net> for web setup****[Web] Abra un navegador web y navegue a <http://expertwifi.net> para la instalación de la web****Support Wall Mount****IMPORTANT!** DO NOT mount this equipment higher than 2 meters.**NOTE:** It is recommended to use screws with a size of PA5.7*2mm.**¡IMPORTANTE!** NO coloque este equipo a una altura mayor que los 2 metros.**NOTA:** Se recomienda utilizar tornillos de tamaño PA5.7*2mm.**ASUS Recycling/Takeback Services**

ASUS recycling and takeback programs come from our commitment to the highest standards for protecting our environment. We believe in providing solutions for you to be able to responsibly recycle our products, batteries, other components, as well as the packaging materials. Please go to <http://csr.asus.com/english/Takeback.htm> for the detailed recycling information in different regions.

REACH

Complying with the REACH (Registration, Evaluation, Authorisation, and Restriction of Chemicals) regulatory framework, we published the chemical substances in our products at ASUS REACH website at <http://csr.asus.com/english/REACH.htm>

Federal Communications Commission Statement

This device complies with Part 15 of the FCC Rules. Operation is subject to the following two conditions:

- This device may not cause harmful interference.
- This device must accept any interference received, including interference that may cause undesired operation.

This equipment has been tested and found to comply with the limits for a class B digital device, pursuant to part 15 of the FCC Rules. These limits are designed to provide reasonable protection against harmful interference in a residential installation.

This equipment generates, uses and can radiate radio frequency energy and, if not installed and used in accordance with the instructions, may cause harmful interference to radio communications. However, there is no guarantee that interference will not occur in a particular installation. If this equipment does cause harmful interference to radio or television reception, which can be determined by turning the equipment off and on, the user is encouraged to try to correct the interference by one or more of the following measures:

- Reorient or relocate the receiving antenna.
- Increase the separation between the equipment and receiver.
- Connect the equipment into an outlet on a circuit different from that to which the receiver is connected.
- Consult the dealer or an experienced radio/TV technician for help.

FCC RF Caution Statement

WARNING: Any changes or modifications not expressly approved by the party responsible for compliance could void your authority to operate the equipment.