



Instruction for use

1. Introduction

Congratulations! You have just bought a most sophisticated FM wireless stereo sound system. This system uses the latest FM wireless technology, which gives you complete freedom of movement while enjoying your own favorite music. No more inconvenience from cables or headphone wires! To ensure you get the best performance of your FM stereo sound system, please read this document carefully.

2. Features

- **Wireless transmission** - the FM transmitter transmits the stereo audio signal from your audio or video source to your FM headphone (receiver) without wires.
- **Wide transmission range** - the FM headphone (receiver) receives signals from up to 100 meter away from the FM transmitter.
- **High-frequency radio system** - the FM headphone set uses a high radio frequency as the signal carrier, ensuring a very clear, sharp reception.
- **Automatic Level Control (ALC)** - prevents overload of transmitter over a wide level of input signal.
- **Mute function** - reduces the noise level by 90% when the sound signal is too low or not available. This feature makes it possible to have the noise reduced when e.g. tuning the receiver to the transmitter.
- **Automatic power on/off** - the FM transmitter automatically switches on and starts transmitting when signals are sensed at the input (indicated by a red LED). When there are no signals at the input, the FM transmitter automatically switches off.
- **Rechargeable system** - the FM headphone set incorporates recharge facilities for recharging the batteries.
- **No space limitation** - the FM headphone (receiver) is able to receive signals from the transmitter, even through barriers such as doors, walls and glasses.
- **Multiple headphones with one transmitter** - additional number of headphones and/or wireless speakers can be used with a single transmitter.

3. Components included

In this FM headphone set the following components are included :

- FM transmitter ~~SBC HC320~~
- FM receiver (headphone) ~~SBC HC320~~
- AC/DC adapter 12 Volt / 200 mA
- HiFi audio cable
- Recharge cable
- Rechargeable batteries R03/AAA
- 3.5 mm to 6.3 mm stereo adapter

4. Explanation of Controls

Transmitter

~~1. Antenna~~

2. Power On/Off indication
3. Charge indication
4. Recharge power output, to charge the batteries of the FM headphone
5. Input 3.5 mm stereo connector, for input of audio signal
6. DC input connector to power the FM transmitter
7. Tuning control

Receiver

8. Charge indication
9. Tuning control
10. Power On/Off switch
11. Charge input
12. Volume control



13. Power On/Off indication

5. Installation

- Please ensure that the rated voltage of the AC/DC adapter is the same as the mains power supply. Connect the AC/DC adapter to the mains power supply outlet.
- Insert the DC connector of the AC/DC adapter into the 12 Volt DC input connector located on the rear of FM transmitter, as shown in Figure 2.
- Connect the audio source (CD player, TV, HiFi) to the FM transmitter with the HiFi audio cable as shown in Figure 2.
- Insert the rechargeable batteries supplied (2 x R3 / AAA) into the battery compartment as shown in Figure 3. Ensure that the polarity is correct.

Note : Please ensure that the batteries are fully charged (for 16 hours) before using the FM headphone for the first time. This will guarantee a longer operating lifetime of the batteries.

6. Operation

- Switch on the FM headphone.
- Set the volume control on the FM headphone to maximum.
- Apply an audio signal to the transmitter (using an audio source such as CD player, TV, or HiFi). The FM transmitter will switch on automatically.
- Tune the tuning control on the headphone until signal (audio sound) is at its clearest.
- Adjust the volume of the audio source to the highest acceptable undistorted level.
- While listening, adjust the volume with the control on the headphone to an acceptable level.

7. Recharging

Note : Please ensure that the batteries are fully charged (for 16 hours) before using the FM headphone for the first time. This will guarantee a longer operating lifetime of the batteries.

1. Switch off the power of the headphone before charging.
2. **Note :** Before using the RF/FM headphone for the first time, please ensure that the batteries are fully charged (for 16 hours). This will guarantee a longer operating lifetime of the batteries.
3. Connect the recharge input on the headphone with the charge output on the transmitter via the recharge cable, see figure 3.
4. The charge indication LED on the headphone will light to indicate that the batteries are charging.
5. The batteries are fully charged after charging for at least 12 hours. Do not charge longer than 16 hours this will reduce battery performance.

8. Specifications

System	: Radio Frequency (RF)
Carrier frequency	: Tunable 2410~2473 MHz
Channel select (transmitter)	: Channel 1 - 8 2410~2473 MHz (Channel spacing 9 MHz)
Modulation	: FSK (Modulation Index 0.5)
Radiated output power	: EIRP +10 dBm
Effective transmission range	: 20~40 meter, omni directional (360°)
Input level	: ≤ 4 Volt
Power supply - transmitter	: 12 Volt / 200 mA DC
Power supply - receiver	: 2x R3 (AAA) batteries
Frequency range (headphone)	: 20~20000 Hz
Signal / Noise ratio	: >80 dB
Distortion	: <0.5% THD
Channel separation	: >80 dB

Explanation of Controls

TELECOM

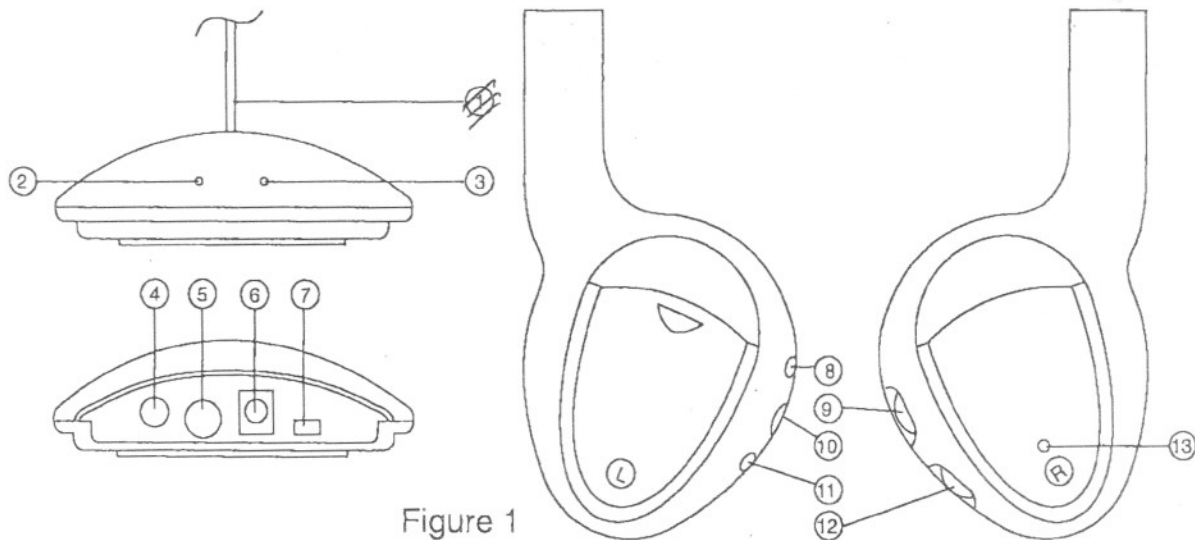
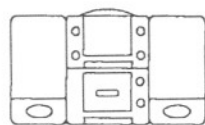

Figure 1



HI FI



C D

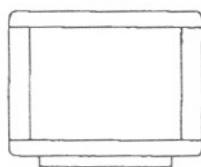

TV SET



CASSETTE

Ø3.5 MM
STEREO
JACK

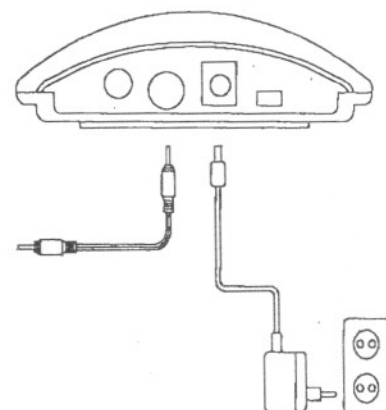

Figure 2

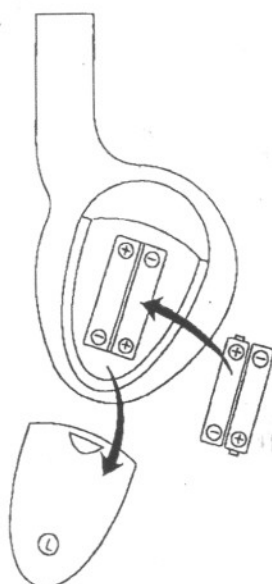

Figure 3

Federal Communication Commission Interference Statement

This equipment has been tested and found to comply with the limits for a Class B digital device, pursuant to Part 15 of the FCC Rules. These limits are designed to provide reasonable protection against harmful interference in a residential installation.

This equipment generates uses and can radiate radio frequency energy and, if not installed and used in accordance with the instructions, may cause harmful interference to radio communications.

However, there is no guarantee that interference will not occur in a particular installation. If this equipment does cause harmful interference to radio or television reception, which can be determined by turning the equipment off and on, the user is encouraged to try to correct the interference by one of the following measures:

- Reorient or relocate the receiving antenna.
- Increase the separation between the equipment and receiver.
- Consult the dealer or an experienced radio/TV technician for help.
- Consult the dealer or an experienced radio/TV technician for help.

FCC Caution: To assure continued compliance, any changes or modifications not expressly approved by the party responsible for compliance could void the user's authority to operate this equipment. (Example - use only shielded interface cables when connecting to computer or peripheral devices).

FCC Radiation Exposure Statement

This equipment complies with FCC RF radiation exposure limits set forth for an uncontrolled environment. This equipment should be installed and operated with a minimum distance of 20 centimeters between the radiator and your body.

This device complies with Part 15 of the FCC Rules. Operation is subject to the following two conditions:

(1) This device may not cause harmful interference, and (2) This device must accept any interference received, including interference that may cause undesired operation.