



# Sight and Sound Assurance Monitor with Extra Receiver

## User Guide

Questions? Comments?  
Missing Parts? Contact Us:

[www.safety1st.com](http://www.safety1st.com)

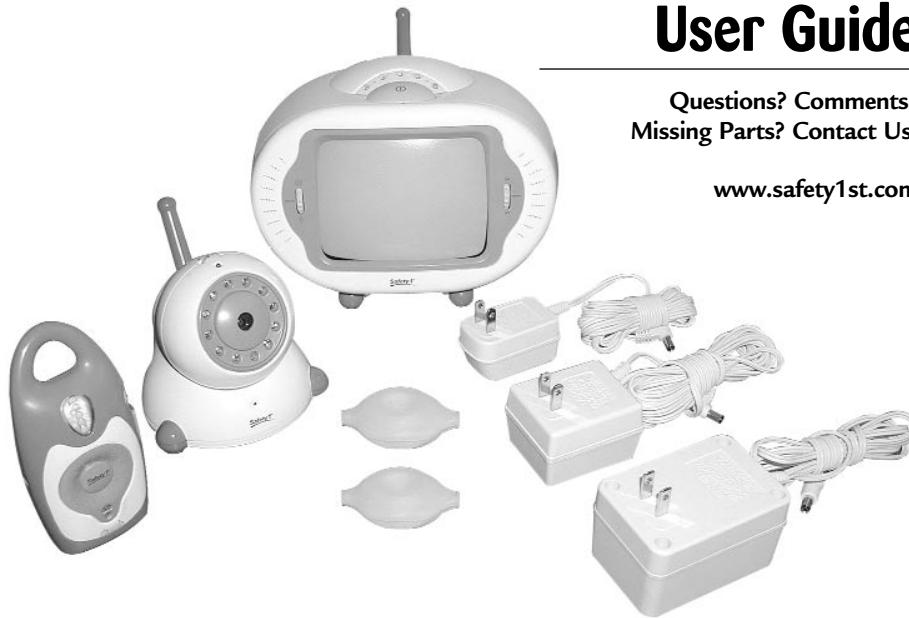

**French Guide: page 14**  
**Mode d'emploi en français : page 14**

**Spanish Guide: page 28**  
**Guía en español: página 28**

©2003 Dorel Juvenile Group  
Made in CHINA  
[www.safety1st.com](http://www.safety1st.com)  
(800) 544-1108

Styles and colors may vary.  
Distributed by Dorel Juvenile Group,  
Inc., Columbus, IN 47201-7494, USA  
In Canada: 12345 Albert-Hudon, Suite  
100, Montreal-N, QC Canada H1G 3K9  
08/03 08037  
Tel: 781-364-3100  
Fax: 781-3643-835

 **WARNING**

**PLEASE READ THE FOLLOWING WARNINGS AND ALL ASSEMBLY INSTRUCTIONS CAREFULLY BEFORE USING THE 900 MHZ SITE AND SOUND ASSURANCE MONITOR. KEEP THESE INSTRUCTIONS FOR FUTURE REFERENCE.**

- The Sight and Sound Assurance Monitor is not intended to replace responsible and proper parental supervision.
- Check your child's activity at regular intervals as this monitor will not alert parents to the silent activities of a child.
- Before using your Safety 1st Sight and Sound Assurance Monitor:
  - Read and follow all instructions carefully.
  - Read and observe all warnings on the product and in this instruction booklet.
- To prevent entanglement with the adapter cord, **NEVER** place the Camera in or near a crib or playpen. **DO NOT** place the Camera on any surface or mount it on any wall where the Camera or its AC adapter cord are within reach of children.
- **ALWAYS KEEP THE CAMERA, MONITOR, RECEIVER AND AC ADAPTERS OUT OF REACH OF CHILDREN.**
- This product is not intended to be used as a medical monitor and its use should not replace adult supervision. It is important that an adult stay within the viewing range of the Sight and Sound Assurance Monitor at all times during use.
- It is essential to check reception regularly. Please see the Testing Reception section for complete instructions.
- The Camera and Monitor are intended for indoor use only.
- **NEVER** use the Camera, Monitor or Receiver near water. For example, do not use near a bathtub, bathroom sink, laundry tub, kitchen sink, in a wet basement, etc.
- Always unplug the AC adapters from wall outlets during long periods of non-use.
- Position the Camera, Monitor and AC adapters to allow adequate ventilation and prevent these components from overheating.
- To prevent overheating, keep the Camera, Monitor and AC adapters away from heat sources such as radiators, heat registers, stoves or other appliances (including amplifiers) which produce heat. Also keep these components out of direct sunlight.
- Use only the AC adapters provided. Use of any other adapters may damage the Camera, Monitor and/or Receiver. Plug the AC adapters into standard household current only (120V AC outlet)! To prevent entanglement and overheating, **DO NOT** use extension cords.
- The AC adapters may become slightly warm to the touch during operation. This is normal.
- Position the AC adapter cords so that they are not walked on or pinched by items placed upon or against them, paying particular attention to cords at AC adapter plugs, wall plugs, and the point at which the cords attach to the Camera, Monitor and Receiver.

- This product should be serviced only by qualified service personnel at Safety 1st when:
  - An AC adapter or its plug is damaged,
  - The Camera, Monitor or Receiver have fallen,
  - Liquid has spilled into the Camera, Monitor or Receiver or
  - The Camera, Monitor or Receiver do not appear to operate normally or exhibit a marked change in performance
- **DO NOT** attempt to service this product beyond that described in the Troubleshooting section at the end of these instructions. All other servicing should be referred to qualified personnel at Safety 1st.

**NOTE:** The LEDs emit IR (infra-red) light that is not harmful.

 **CAUTION** 

**TO REDUCE THE RISK OF ELECTRICAL SHOCK, DO NOT REMOVE COVER OR BACK OF MONITOR OR CAMERA. NO SERVICEABLE PARTS INSIDE. REFER SERVICING TO DOREL JUVENILE GROUP CONSUMER RELATIONS (800) 544-1108.**

 **WARNING** 

**TO REDUCE THE RISK OF FIRE OR ELECTRICAL SHOCK, DO NOT EXPOSE THIS PRODUCT TO WATER OR MOISTURE. NEVER ATTEMPT TO OPEN THE CASE OF EITHER THE MONITOR OR CAMERA. THIS IS DANGEROUS AND WILL VOID THE WARRANTY.**

### FCC Compliance Information

**NOTE:** This equipment has been tested and found to comply with the limits for a Class B digital device, pursuant to Part 15 of the FCC Rules. These limits are designed to provide reasonable protection against harmful interference in a residential installation. This equipment generates, uses and can radiate radio frequency energy and, if not installed and used according to the instructions, may cause harmful interference to radio communications. However, there is no guarantee that interference will not occur in a particular installation. If this equipment does cause harmful interference to radio or television reception, which can be determined by turning the equipment off and on, the user is encouraged to try to correct the interference by one or more of the following measures:

- Re-orient or relocate the receiving antenna,
- Increase the separation between the equipment and receiver,
- Connect the equipment into an outlet on a circuit different from that to which the receiver is connected,
- Consult the dealer or an experienced radio/TV technician for help.

This device complies with Part 15 of the FCC Rules. Operation is subject to the following two conditions: (1) This device may not cause harmful interference, and (2) this device must accept any interference received, including interference that may cause undesired operation.

**CAUTION:** Changes or modifications to this unit not expressly approved by Dorel Juvenile Group could void the user's authority to use the equipment.

## Parts List

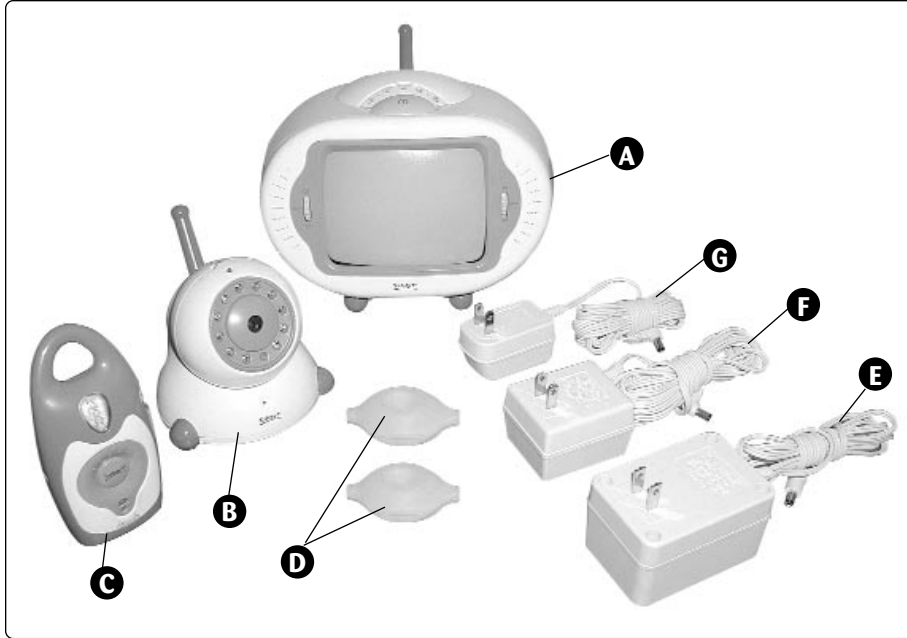

- |                                    |                                    |
|------------------------------------|------------------------------------|
| <b>A</b> Monitor (video receiver)  | <b>E</b> AC adapter (for Monitor)  |
| <b>B</b> Camera                    | <b>F</b> AC adapter (for Camera)   |
| <b>C</b> Receiver (audio receiver) | <b>G</b> AC adapter (for Receiver) |
| <b>D</b> Cord Shorteners (2)       |                                    |

## Keep these instructions for future use

- Do not return this product to the place of purchase. If any parts are missing, or if you are having difficulty using product call Consumer Relations at (800) 544-1108. Or visit our web site at [www.safety1st.com](http://www.safety1st.com).
- Lay out and identify all parts.
- Include the model number and a brief description of the part.
- We will ship replacement parts within two working days (in the United States).

## Installing Your Sight and Sound Assurance Monitor

### Choosing a Location

#### **⚠ WARNING**

- To prevent entanglement, only mount the Camera in a location where it and its AC adapter cord are **OUT OF REACH OF CHILDREN**.
- Allow adequate ventilation of the Camera when mounted on a wall. **DO NOT** mount the Camera directly above heating vents, other heat producing sources or in direct sunlight.
- To prevent entanglement and overheating, **NEVER** use an extension cord.

**1. IMPORTANT:** When choosing a location to set up your Monitor and Camera follow these guidelines:

- For best viewing place your Camera 4-6' (1.5-2m) away from the child.
- Mount the Camera in a location where the camera lens will have an unobstructed view.
- Make certain that the Camera will be mounted so that the AC adapter cord will reach an outlet.
- The Camera can be easily mounted on a wall, or it can be placed on a stable, flat surface, such as a dresser or table top.
- Use the tilt and swivel adjustments to properly aim the Camera.
- Two adults are needed to properly install and test this equipment.
- TEST the reception of the Monitor BEFORE INSTALLING any wall mount screws.
- Place the Monitor far enough away from the Camera so as not to get feedback.
- DO NOT place the Monitor more than 300' (10cm) away from the Camera.

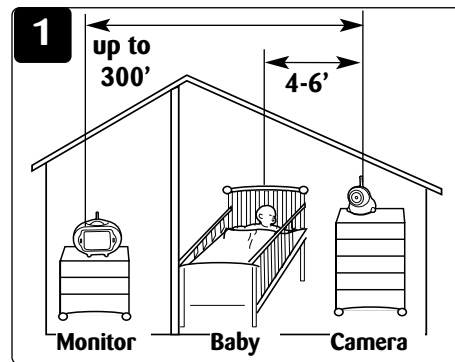

## Installing Your Sight and Sound Assurance Monitor

### Set up your Monitor

1. Locate the Monitor and its AC adapter (largest adapter shown in Figure 1). Connect the AC adapter into the back of the Monitor (Figure 1b). Connect the AC adapter into a power outlet.

**CAUTION:** Ensure that you use the largest AC adapter with the Monitor. DO NOT use an adapter that did not come with this product.

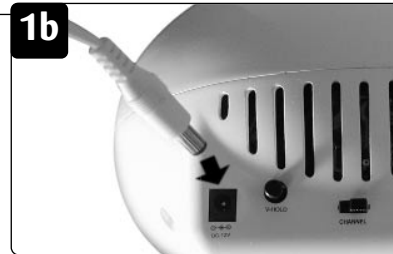

2. Pivot up the feet on the bottom of the Monitor (if desired) and place Monitor on a level surface.

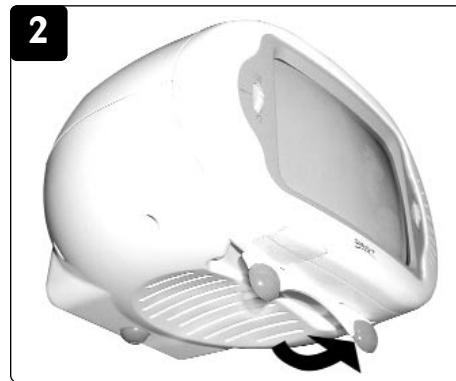

3. Wrap the excess cord in a cord shortener and snap it closed.

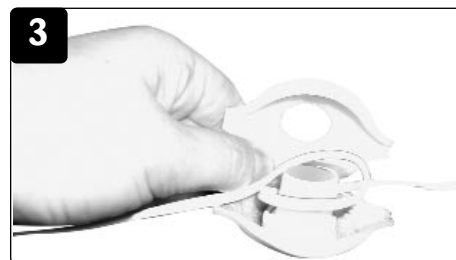

## Installing Your Sight and Sound Assurance Monitor

4. Turn the Monitor on by pressing the button at the top (Figure 4). Adjust the volume to a medium level (Figure 4a). Ensure that the picture is on (Figure 4b). Choose channel I or II on the back of the Monitor (Figure 4c).

**NOTE:** The picture can be turned off with the sound left on if preferred.

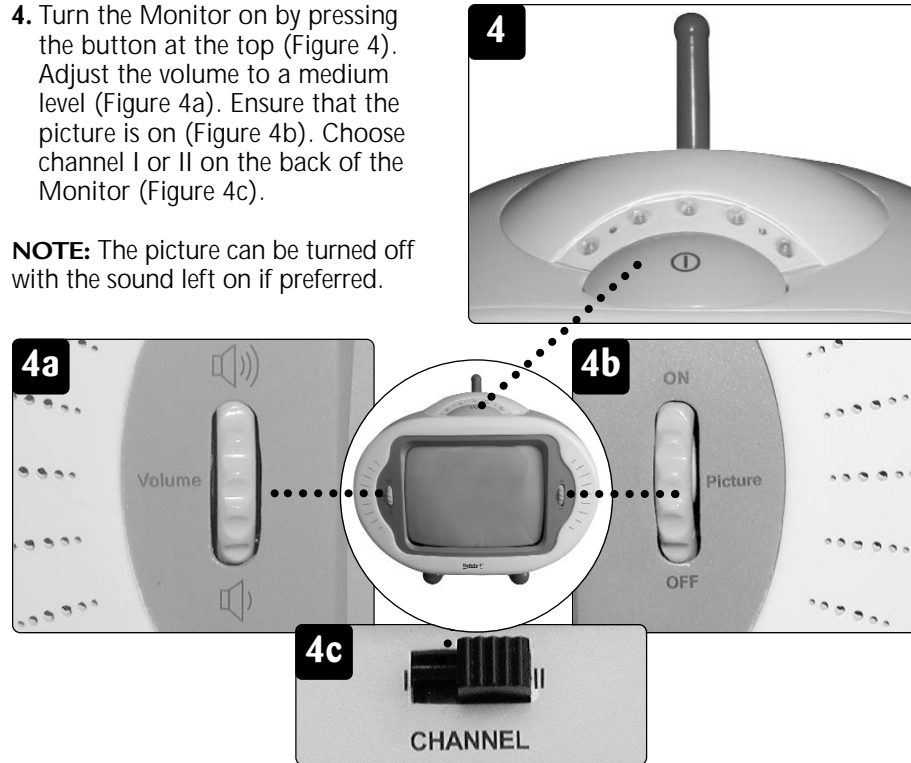

### Set up your Camera

1. Locate the Camera and its AC adapter (medium sized adapter shown in Figure 1). Connect the AC adapter into the bottom of the Camera and route the cable in the slot (Figure 1b). Connect the AC adapter into a power outlet.

**CAUTION:** Ensure that you use the medium sized AC adapter with the Camera. DO NOT use an adapter that did not come with this product.

**CAUTION:** To protect your privacy, always turn the Camera off when not in use. Always remember that you are using public airwaves. Sound and video may be broadcast to other receiving devices. Conversations, even from rooms near the Camera, may be broadcast.

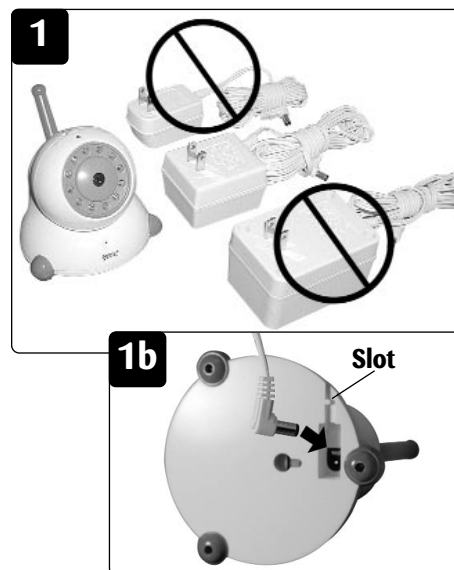

## Installing Your Sight and Sound Assurance Monitor

### Set up your Camera (continued)

- Turn the Camera on by moving the button at the top off the center position and choosing channel I or II to match channel that you selected on the Monitor (Figure 2). The LED will light up.

**NOTE:** Before mounting the camera to a wall or using a cord shortener it is best to test the reception.

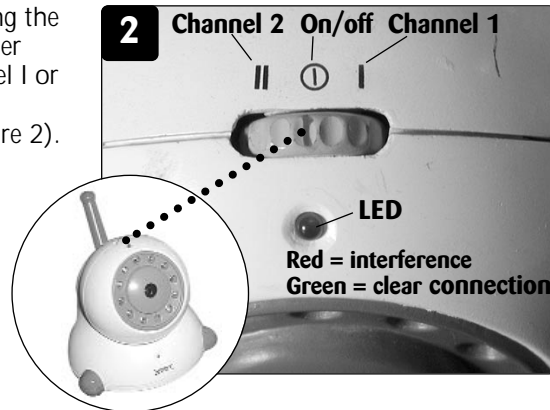

## Operating Your Sight and Sound Assurance Monitor

### **⚠ WARNING**

- It is essential to check reception regularly.

### Testing the Reception

- Have one adult hold the Camera at the desired location while another adult checks the Monitor for the proper sound and reception. It is best to follow these guidelines for good reception:

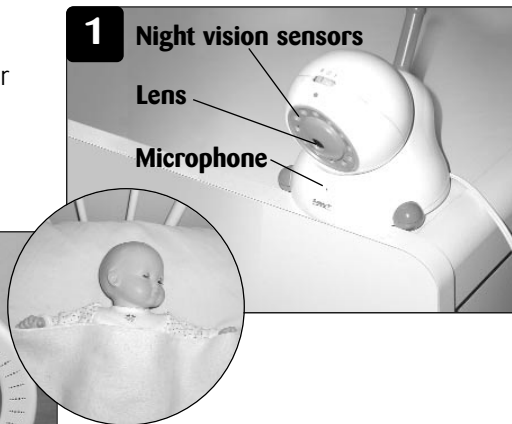



## Operating Your Sight and Sound Assurance Monitor

### Testing the Reception (continued)

#### Guidelines for good reception:

- Use a stuffed animal or doll to focus the Camera on while testing.
- Place your Camera 4-6' (1.5-2m) away from the area of focus.
- Be certain the channels on the Monitor and Camera match.
- Use tilt and swivel adjustments to properly aim the Monitor antenna (Figure 2).
- Use the tilt and swivel adjustments to properly aim the Camera.
- Use the controls on the back of the Monitor to adjust vertical hold, brightness and contrast as needed (Figure 2b).
- Have one adult speak (from a whisper to a yell) into the microphone on the front of the Camera while another checks the volume and the sound LEDs on the top of the Monitor. The louder the volume the more LEDs light up (Figure 2c).
- Place the Monitor far enough away from the Camera so as not to get feedback.
- Do not place the Monitor more than 300' (10cm) away from the Camera.
- If one channel has poor reception try the other channel.
- Test the Automatic Night Vision (infra-red sensors around in the lens) by darkening the room where the Camera is located. The Night Vision LEDs on the Camera will light up.

**NOTE:** It is possible for the Monitor to pick up sounds or display interference from other signal producing devices including other audio or video monitors which broadcast in the 900 MHZ range. To minimize this potential problem, two independent channels have been provided.

If you experience interference while using one channel setting, simply switch the Camera and Monitor to another channel. Selecting a channel is usually a one-time adjustment. If interference persists on both channels, please refer to the Troubleshooting section at the end of these instructions.

**CAUTION:** To protect your privacy, always turn the Camera off when not in use.

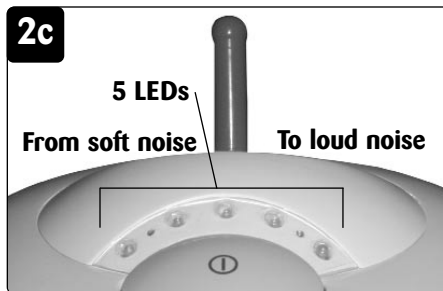
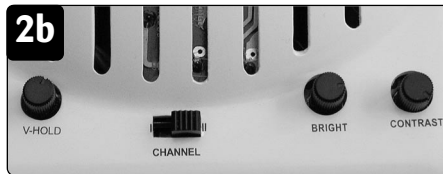

## Operating Your Sight and Sound Assurance Monitor

### Using the Receiver

#### **WARNING**

- It is essential to check reception regularly.
- When using batteries, check batteries regularly. Amber LED indicates the batteries are low. **DO NOT** rely on Receiver when batteries are low.
- **DO NOT** use Receiver over 15' (4.5m) away from the Camera.

**NOTE:** Once the Monitor and Camera are working properly you can use the Receiver for distances up to 15' (4.5m) from the Camera.

#### **For AC Power Use:**

1. Locate the Receiver and its AC adapter (the smallest adapter). Connect the AC adapter into the front of the Receiver. Connect the AC adapter into a power outlet.

**CAUTION:** Ensure that you use the smallest AC adapter with the Receiver. **DO NOT** use an adapter that did not come with this product.

2. Adjust the volume by turning the knob on the side of the Receiver.

**CAUTION:** Test the Receiver before each use.

**NOTE:** The Receiver may use either the AC adapter, batteries or both may be used as a back-up device in case of power failure.

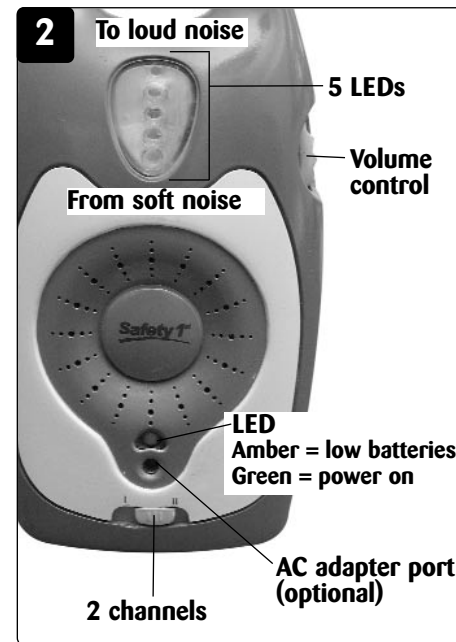

## Operating Your Sight and Sound Assurance Monitor

### For Battery Use:

3. Locate the center screw at the back of the Receiver. Unscrew the screw.

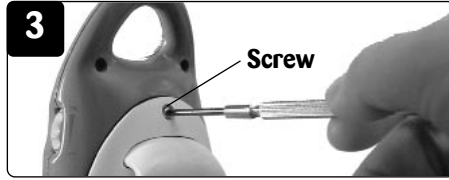

4. Pull off the battery door and insert 4 AAA batteries (see positive and negative diagram on the Receiver). Secure the door with the screw.

**CAUTION:** Amber LED means the batteries are low. DO NOT rely on the receiver when batteries are low.

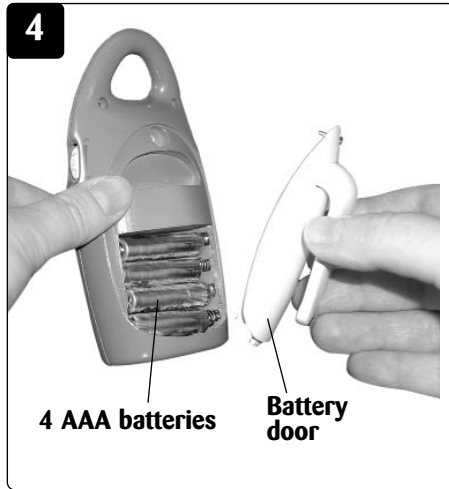

### To Use Belt Clip:

5. Slide the belt clip over your belt (only for use without AC power).



## Troubleshooting

<b>Problem</b>	<b>Possible Cause</b>	<b>Solution</b>
Camera's power indicator light does not light	Camera is not turned on	Slide the button on the Camera top and choose a channel
	Power is turned off	Make certain that any light switches that control the power flow to the wall outlet are on Make certain that house fuses and circuit breakers are on
	AC Adapter not properly connected	Check AC Adapter jack-to-socket and plug-to-outlet connections
Monitor screen does not illuminate and no sound	Monitor is not turned on	Press the Monitor's on/off button at the top of the Monitor
	Power is turned off	Slide Monitor picture switch on Make certain house fuses and circuit breakers are on Make certain that any light switches that control the power flow to the wall outlet are on
	Wrong AC Adapter used AC Adapter not properly connected	Check AC Adapter jack-to-socket and plug-to-outlet connections. Be certain it is plugged into the AC jack (DC 12V IN)
No sound or picture	Channel switches are not on the same setting (I or II)	Check the channel switches on the Camera and the Monitor to confirm they are on the same channel (I or II)
	Signal interference due to other monitors, cellular or cordless telephones, etc.	Try the other channel Turn the Monitor and Camera off, wait a moment then turn them back on
Sound, but no picture (continued)	Video adjustment knobs not properly adjusted	Use the V-Hold, Contrast and Brightness adjustment controls on the Monitor to adjust the picture
	Monitor's picture switch is set off Out of range	Slide Monitor picture switch on Bring Camera unit closer to Monitor
	Camera or Monitor near metal concentration	Test reception by moving the Camera and/or Monitor to different locations throughout the house. Relocate the Camera and/or Monitor
Picture, but no sound	Volume not turned up	Adjust the volume control on the Monitor

## Troubleshooting

Problem	Possible Cause	Solution
Picture flickers in low light	Object too close to Camera	Remove objects that are too close to the Camera or move the Camera/Monitor
	Camera or Monitor near metal concentration	Test reception by moving the Camera and/or Monitor to different locations throughout the house.
	Signal interference due to other monitors, cellular or cordless telephones, etc.	Try the other channel Identify and eliminate the source of interference
Audio feedback (squealing)	Monitor is too close to the Camera	Move the Monitor further away from the Camera
	Volume is set too high	Lower the volume on the Monitor
Dark picture at night	Night Vision LEDs are not functioning properly	With room lights off, check Camera to be certain that all Night Vision LEDs are glowing red. If not, contact the Consumer Relations Department at Safety 1st
Receiver has no sound	Volume not turned up	Adjust the volume control on the Receiver
Receiver not functioning	Batteries are low	If amber LED lights or no LED at all, change the batteries
	Wrong AC adapter used	If you are not using batteries, be certain that you are using the correct AC adapter
	Not within 15' (4.5m) range	Move closer to the Camera

**NOTE:** Do not return this product to the place of purchase. If you are having difficulty using product call Consumer Relations at (800) 544-1108. Or visit our web site at [www.safety1st.com](http://www.safety1st.com).