

Remote and RF Adapter Pairing

**IN ORDER FOR THE REMOTE CONTROL AND RF ADAPTER TO COMMUNICATE, THEY MUST BE PAIRED.
FOLLOW THE INSTRUCTIONS BELOW TO PAIR THE KEYBOARD REMOTE CONTROL WITH THE RF ADAPTER.**

**IN ORDER FOR THE REMOTE CONTROL AND RF ADAPTER TO COMMUNICATE, THEY MUST BE PAIRED.
FOLLOW THE INSTRUCTIONS BELOW TO PAIR THE KEYBOARD REMOTE CONTROL WITH THE RF ADAPTER.**

- 1** Insert RF Adapter into an open USB port
Insert RF Adapter into an open USB port

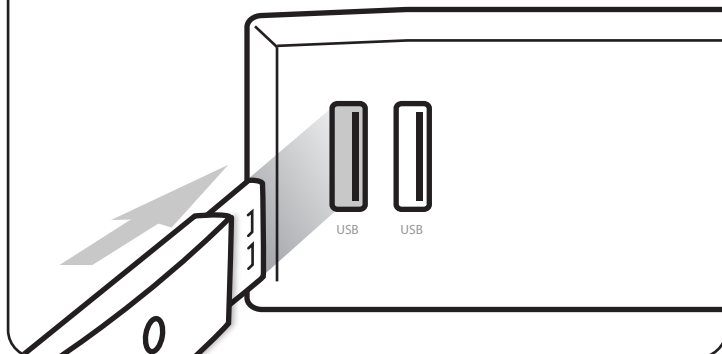

- 2** Press the PAIR button on the RF adapter
Press the PAIR button on the RF adapter

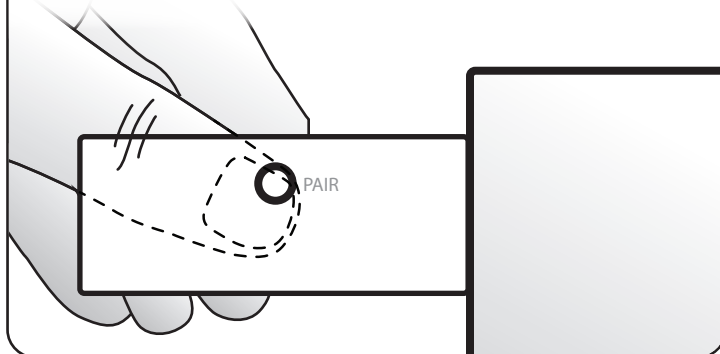

- 3** Press and hold SETUP and NAVIGATE UP buttons simultaneously for 3 seconds
Press and hold SETUP and NAVIGATE UP buttons simultaneously for 3 seconds

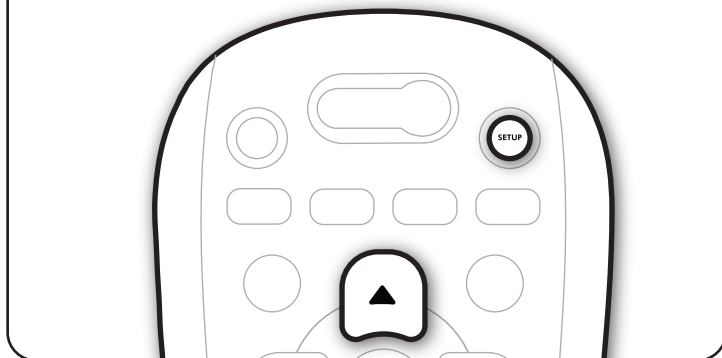

- 4** The POWER key on the remote will blink rapidly while the remote is in RF pairing mode
The POWER key on the remote will blink rapidly while the remote is in RF pairing mode

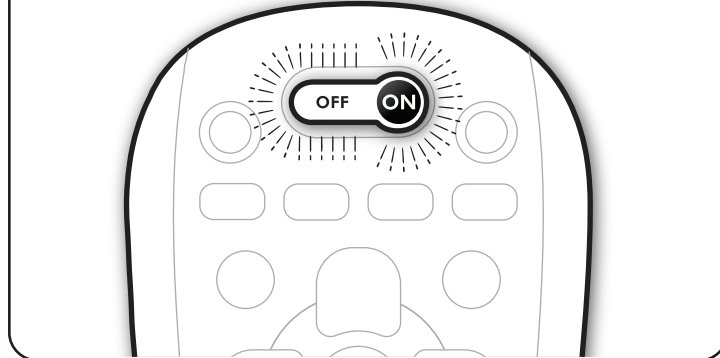

- 5** If pairing is successful, the POWER key on the remote will blink twice
If pairing is successful, the POWER key on the remote will blink twice

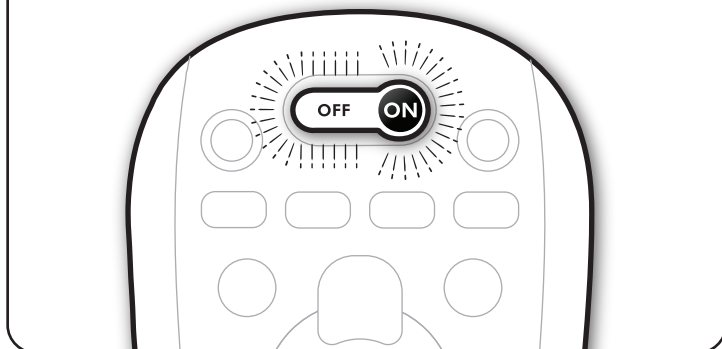

If pairing is not successful, repeat steps 2-5.

Si el televisor no se apaga, repita este proceso utilizando el siguiente código para su marca de TV.



Clear Pairing Information

YOU MAY HAVE TO CLEAR PAIRING INFORMATION IF YOU WISH CREATE A NEW REMOTE/RF ADAPTER PAIRING.

HERE IS HOW TO CLEAR PAIRING INFORMATION ON THE RF ADAPTER AND REMOTE.

YOU MAY HAVE TO CLEAR PAIRING INFORMATION IF YOU WISH CREATE A NEW REMOTE/RF ADAPTER PAIRING.

HERE IS HOW TO CLEAR PAIRING INFORMATION ON THE RF ADAPTER AND REMOTE.

1 With the RF Adapter plugged into a USB port and powered on, press and hold the PAIR button for 5 seconds until the LED blinks 4 times.

With the RF Adapter plugged into a USB port and powered on, press and hold the PAIR button for 5 seconds until the LED blinks 4 times.

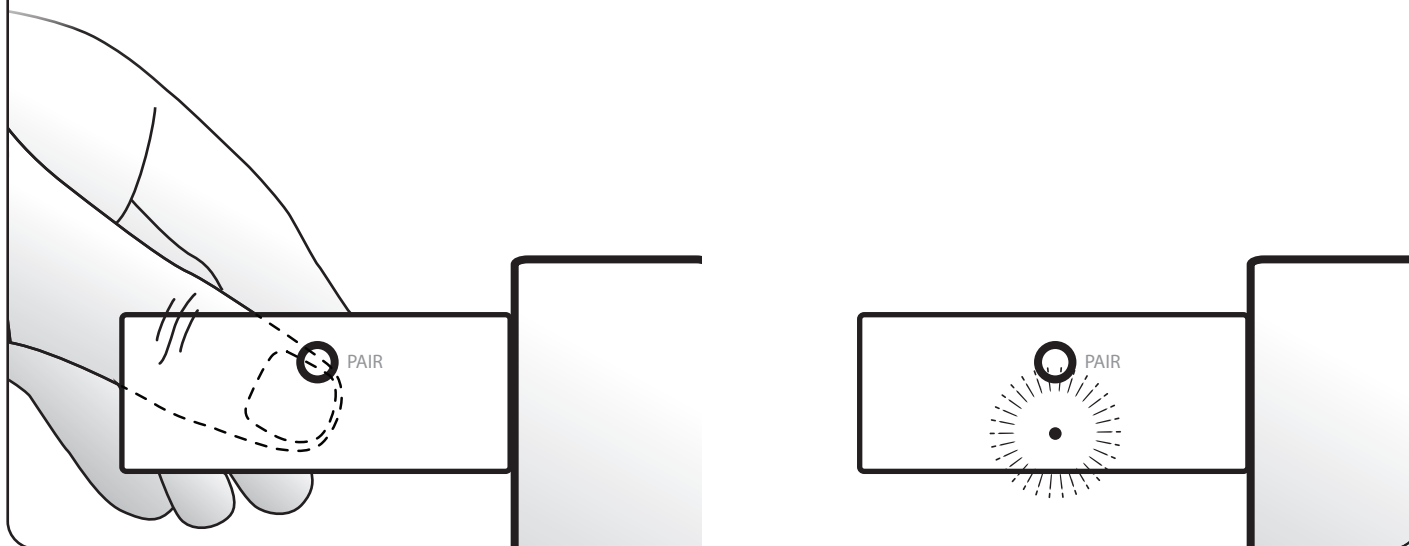

2 Press and hold SETUP and NAV DOWN on the remote control simultaneously until the POWER button blinks four times to confirm pairing information has been cleared.

Press and hold SETUP and NAV DOWN on the remote control simultaneously until the POWER button blinks four times to confirm pairing information has been cleared.

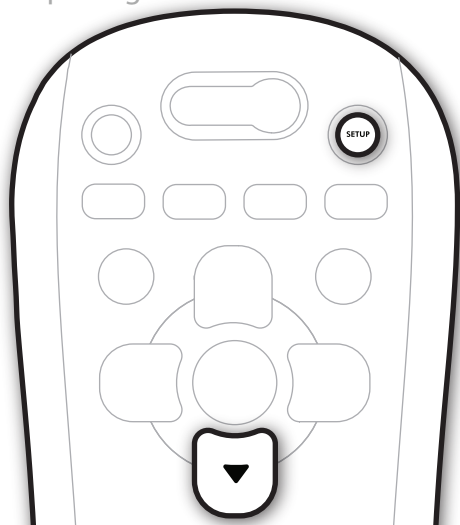

Federal Communication Commission Interference Statement:

This equipment has been tested and found to comply with the limits for a Class B digital device, pursuant to Part 15 of the FCC Rules. These limits are designed to provide reasonable protection against harmful interference in a residential installation. This equipment generates, uses and can radiate radio frequency energy and, if not installed and used in accordance with the instructions, may cause harmful interference to radio communications. However, there is no guarantee that interference will not occur in a particular installation. If this equipment does cause harmful interference to radio or television reception, which can be determined by turning the equipment off and on, the user is encouraged to try to correct the interference by one of the following measures:

- Reorient or relocate the receiving antenna.
 - Increase the separation between the equipment and receiver.
 - Connect the equipment into an outlet on a circuit different from that to which the receiver is connected.
 - Consult the dealer or an experienced radio/TV technician for help.
- This device complies with Part 15 of the FCC Rules. Operation is subject to the following two conditions: (1) This device may not cause harmful interference, and (2) this device must accept any interference received, including interference that may cause undesired operation.

The user is cautioned that changes and modifications made to the equipment without the approval of manufacturer could void the user's authority to operate this equipment

Industry Canada statement: This device complies with RSS-210 of the Industry Canada Rules. Operation is subject to the following two conditions: (1) this device may not cause harmful interference, and (2) this device must accept any interference received, including interference that may cause undesired operation.

Ce dispositif est conforme à la norme CNR-210 d'Industrie Canada applicable aux appareils radio exempts de licence. Son fonctionnement est sujet aux deux conditions suivantes: (1) le dispositif ne doit pas produire de brouillage préjudiciable, et (2) ce dispositif doit accepter tout brouillage reçu, y compris un brouillage susceptible de provoquer un fonctionnement indésirable.