

| BALLOON DESIGNATION SYMBOL | |
|----------------------------|------------------|
| ① | ← ITEM NUMBER |
| ② | ← NOTE REFERENCE |

THIS DOCUMENT CONTAINS PROPRIETARY INFORMATION AND EXCEPT WITH WRITTEN PERMISSION OF DIGI, SUCH INFORMATION SHALL NOT BE PUBLISHED OR DISCLOSED TO OTHERS, OR USED FOR ANY PURPOSE AND THE DOCUMENT SHALL NOT BE COPIED IN WHOLE OR PART

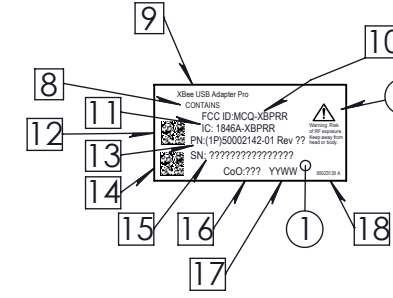

DIRECTION OF PRINT

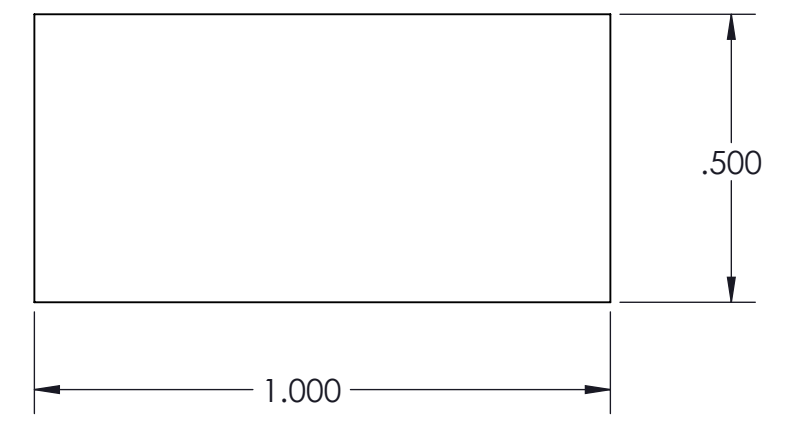

| REVISION HISTORY | | | |
|------------------|-------------|---------|---------|
| REV | DESCRIPTION | DATE | DRW/CHK |
| A | NEW RELEASE | 22FEB23 | TJM/PD |

1. MATERIAL: FOR LABEL STOCK AND RIBBON SEE B.O.M.
2. ADD DIGI P/N, REVISION, DATE CODE, AND VENDOR LOGO USING PERMANENT INK TO THE INNER DIAMETER OF THE ROLL. ALSO MARK THE ROLL WITH A SHELF LIFE/EXPIRATION DATE AS NECESSARY.
3. THE SUPPLIER/MANUFACTURER IS REQUIRED TO IDENTIFY THEIR UL NUMBER AND THE LABEL SYSTEM NUMBER ON THE PACKAGING/PRODUCT LABELS AND CONTAINER LABEL. THIS INFORMATION MAY ALSO BE LISTED ON THE CERTIFICATE OF CONFORMANCE.
4. AT THE TIME OF FABRICATION, MANUFACTURING PROCESS AND MATERIALS SHALL COMPLY WITH THE CURRENT REVISION OF THE FOLLOWING REGULATIONS:
 - EU AND CHINA RoHS DIRECTIVES.
 - REACH SVCH DIRECTIVES.
 - SECTION 1502 OF THE U.S. DOOD-FRANK WALL STREET REFORM AND CONSUMER PROTECTION ACT REGARDING CONFLICT MINERALS.
5. ALL COMPONENT SHIPMENTS TO INCLUDE CERTIFICATE OF CONFORMANCE. COC MUST STATE PARTS ARE BUILT TO DRAWING SPECIFICATIONS.
6. DURABILITY: THE LABEL SYSTEM (SUBSTRATE, INK AND ADHESIVE) SHALL PASS A RUB TEST PER IEC 62368-1.
7. CHEMICAL COMPATIBILITY: THE LABEL SYSTEM SHALL BE COMPATIBLE WITH THE FOLLOWING CHEMICALS AND PROCESSES:
 - CONFORMAL COATING (XYLENE)
 - VAPOR DEGREASING (ENTRON-CE SOLVENT OR EQUIVALENT).
8. FCC EXPLANATION
TEXT "CONTAINS"
FONT = ARIAL NARROW BOLD ; COLOR = BLACK; SIZE = 3 PT.
9. PRODUCT NAME
TEXT "Xbee USB Adapter Pro"
FONT = ARIAL NARROW BOLD ; COLOR = BLACK; SIZE = 3 PT.
10. FCC ID
TEXT "FCC ID: MCQ-XBPRR"
FONT = ARIAL NARROW BOLD ; COLOR = BLACK; SIZE = 4 PT.
11. IC
TEXT "IC: 1846A-XBPRR"
FONT = ARIAL NARROW BOLD ; COLOR = BLACK; SIZE = 4 PT.
12. PART NUMBER - DATA MATRIX - SAMPLE ONLY - .12" SQUARE
DATA: PN: {1P}50002142-01 Rev ?? (MATCHES HUMAN READABLE TEXT)
13. PART NUMBER AND REVISION TEXT
TEXT: "PN:{1P}50002142-01 Rev X?"
FONT = ARIAL NARROW BOLD; COLOR = BLACK; SIZE = 4PT.
14. SERIAL NUMBER - DATA MATRIX - SAMPLE ONLY - .12" SQUARE
DATA: SN: ?????????????????? (MATCHES HUMAN READABLE TEXT)
15. SERIAL NUMBER
TEXT: "SN:?????????????????"
FONT = ARIAL NARROW; COLOR = BLACK; SIZE = 4PT.
16. COUNTRY OF ORIGIN
TEXT: "CoO: ????" CODE DEFINED BY ISO 3166. 3 LETTERS ALL CAPS
FONT = ARIAL NARROW BOLD ; COLOR = BLACK; SIZE = 4 PT.
17. DATE CODE
TEXT: "YYWW"
YY = YEAR
WW = WEEK
FONT = ARIAL NARROW BOLD ; COLOR = BLACK; SIZE = 4 PT.
18. LABEL PART NUMBER AND REVISION
TEXT: "95023130 A"
FONT = ARIAL NARROW BOLD ; COLOR = BLACK; SIZE = 2 PT.
19. SEE B.O.M. FOR SYMBOL IMAGES.

| | | | | |
|-------|-----------|----------------------|------------|--------------------------------|
| DRAWN | T.MILLER | DATE: | 02/22/2023 | |
| | CHECKED | P.DAHL | DATE: | |
| | | DATE: | | TITLE |
| | | DATE: | | Text,1" x 1/2",50002142-01,LBL |
| SIZE | CAGE CODE | DWG NO: | 95023130 | REV |
| D | 08TP3 | | | A |
| SCALE | NTS | DO NOT SCALE DRAWING | SHEET | 1 OF 1 |



LABEL LOCATION