



DENON[®]

DSB-100

PORTABLE PREMIUM SOUND
BLUETOOTH SPEAKER



Quick Start Guide

1. Unpacking the speaker

Carefully unpack your new Envaya Mini speaker and verify that you have the following items.

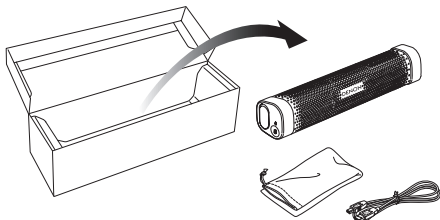

2. Charging the speaker

- ① Open the cap on the left side.
- ② Connect the small end of USB cable to the power input.
- ③ Connect the larger end of the USB cable to a USB to AC power adapter (not included) or the USB port on your computer.

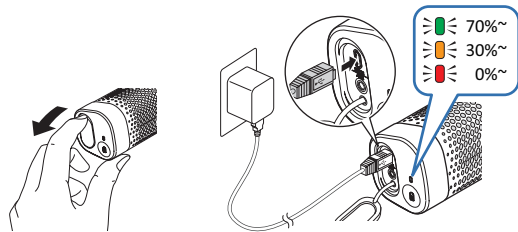

3. Playing Music from your Bluetooth Device (Pairing and Connecting)

① Activate the Bluetooth settings on you mobile phone.



② Select “Envaya Mini” from the list of available Bluetooth devices. In a few seconds you will hear a fast 3 note tone from the speaker indicating that it is connected to your device.

The status indicator remains illuminated.



4. Using the Speakerphone

Answering Calls: Press the ►/|| button on the right side of the speaker .

Ending Calls: Press the ►/|| button again.

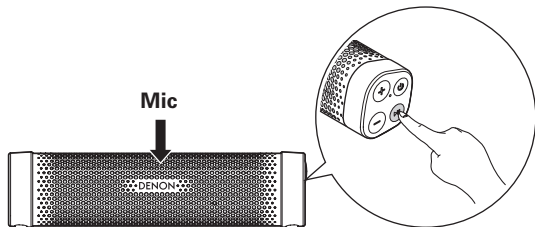

For more information, please visit manuals.denon.com/DSB100/ALL/EN/ to view the complete Owner's Manual for the Envaya Mini wireless speaker. Or when you read the following two-dimensional code, it is possible to access the manual directly.



Basic Troubleshooting

Speaker does not turn on

- To turn on the speaker press and hold the power button for 2 seconds.

Cannot pair a Bluetooth device with the speaker

- If the stereo mini plug cable is inserted, please unplug the cable.
- The Bluetooth device is malfunctioning. Power cycle the device, remove the pairing information and re-pair the speaker to the device.

Speaker is turning off automatically

- No audio is played via Bluetooth for approximately 15 minutes.

Speaker is malfunctioning

- The speaker needs to be reset to the factory default settings. Turn on the speaker. Press and hold the POWER and VOLUME + buttons together for approximately 4 seconds.



DENON

www.denon.com

D&M Holdings Inc.
5411 00000 00AD