

Getac

Input/輸入/額定輸入:19V == 4.74A Model/型號/型号: B300

AC Adapter/電源適配器/交流適配器

CAUTION: For use with power supply model
ADP-90SB BB or ADM-9019M
Pour utiliser avec alimentation modèle
ADP-90SB BB ou ADM-9019M



This device complies with part 15 of the FCC rules. Operation is subject to the following two conditions (1) this device may not cause harmful interference; and (2) this device must accept any interference, received, including interference that may cause undesired operation.

CAUTION:
This surface is hot, avoid continuous body contact and do not place this notebook on your lap while it is operating.

S/N:

REF:

MADE IN CHINA
神基科技股份有限公司/中国制造

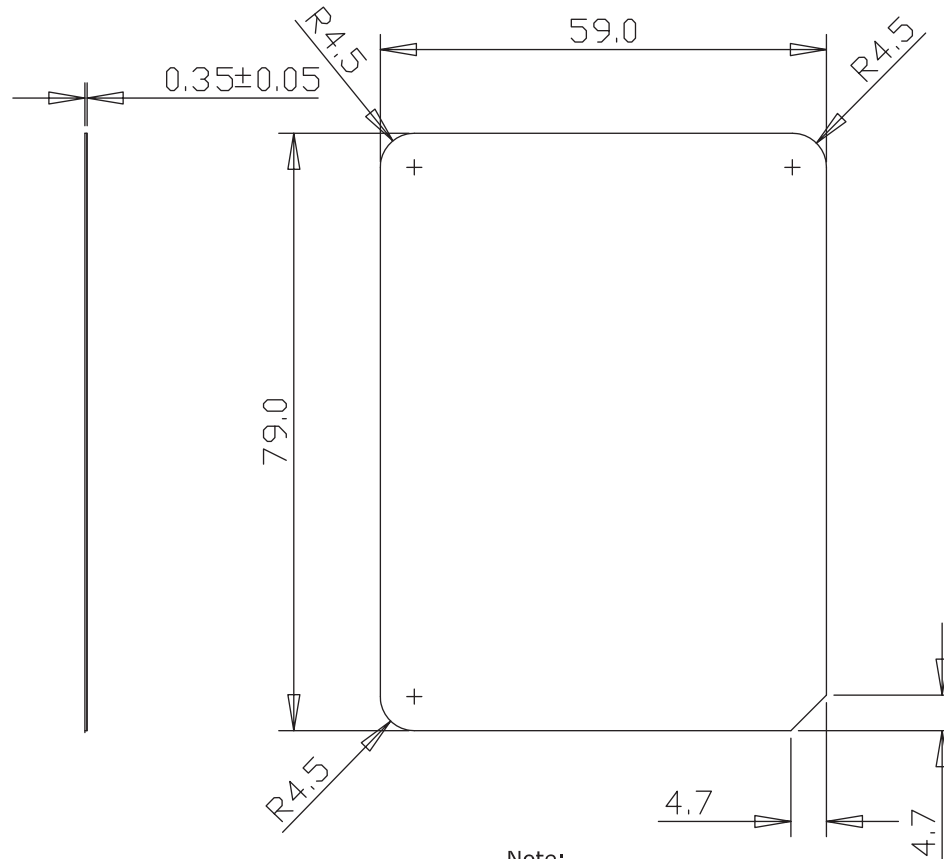

Note:

1. MATERIAL: 霧面PC(FR65),t 0.254,防火係數94-0, IT MUST BE APPROVED BY UL & CSA STANDARD
2. LABEL SHOULD HAVE PRESSURE SENSITIVE ADHESIVE WITH PROTECTIVE RELEASE LINER ON THE BACK SIDE.
3. COLORS:TEXT FOREGROUND : Pantone Cool Gray 3C
BACKGROUND: Pantone black
4. LABEL MANUFACTURER MUST USE A PROCESS & MATERIALS THOSE WHICH HAVE BEEN APPROVED BY UL & CSA
5. ADHESIVE: SONY T4000
6. 依RD承認 SAMPLE 為準
7. 成品需符合GP要求

ITEM	CONTENTS OF CHANGE	RVS	CHK	APV	M/D/Y	TOL ±	Plg	Met	Ins	Por	Cab	Pac	Gas	PCB	DATE	MATERIAL	SEE NOTES	TREATMENT	REMARK						
															Jul-22-2009				TF1-LABEL; RATING,MP, B300						
					//	RANGE	0.1	0.1	0.1	0.2	0.5	1	0.5	0.1	UNIT	MM	SCALE	--	DRAWING NAME	MF	242	8144	000XX	R	00
					//	0~6	0.1	0.1	.15	.25	1	1	0.5	0.1	DRAWN	DESIGNED	CHECKED	APPROVED	MATERIAL NO.						
					//	6~30	0.1	0.1	.15	.25	1	1	0.5	0.1											
					//	30~80	0.1	.15	0.2	0.3	2	1.5	1	0.1											
					//	80~180	.15	.15	.25	0.3	2	2	1	.15											
					//	180~315	.15	0.2	0.3	0.4	2.5	2	1	.15											
					//	315~800	0.2	0.3	0.4	0.5	3	3	2	.15											
															Mitac Technology Corp.										

A

B

C

D

E