

Model 00001

IMPORTANT SAFETY PRECAUTIONS

1. All wiring must in accordance with the National Electrical Code and local electrical codes. A qualified licensed electrician should perform electrical installation.
2. Do not use water or detergents to clean the remote transmitting unit. A dry dust will suitable for most cleaning.
3. Use only to operation one ceiling fan and incandescent light fixture.

PREPARATION:

WARNING: DO not install or use remote control, if any part is damage or missing. Call toll-free: 1-800-295-4448

WARNING: To avoid possible electronic shock, be sure that electricity has been turned off at the circuit breaker or fuse box before wiring.

CAUTION: Only the remote control unit should change fan speeds. Do not use the pull chain to change the fan speeds after installation. As damage could result to your remote control or ceiling fan.

WARNING: To avoid electrical shock, follow all wiring instructions carefully. Any electrical work not described in these instructions should be done or approved by a licensed electrician.

HOW TO INSTALL AND WIRE YOUR RECEIVER

WARNING: To avoid possible electrical shock, be sure that electricity has been turned off at the circuit breaker or fuse box before wiring.

NOTE: Before installing this control, change the factory dip switch setting to your own code (Figure 1). Be sure the dip switch positions of the transmitter and receiver match or the ceiling fan will not function. If you should desire to control more than one fan from the remote transmitting unit, you will need to set the DIP switches in all receivers to the same code. If your ceiling fan remote causes interference with other appliances, you may need to select different combinations to prevent interference with other radio frequency devices.

If The Ceiling Fan Is Already Installed

1. Determine your ceiling fan mounting type (Figure 2). Most installations will be one of these mounting types.
2. Remove the canopy or housing and reverse the installation procedure to the point of "disconnected wires from the ceiling to your fan".

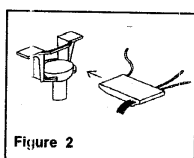

Figure 2

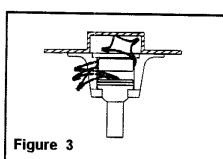

Figure 3

3. Connect the receiver to ceiling fan according to your mounting type (Figure 2 series).
4. Use the two larger wire nuts supplied to connect the receiver and house wiring, then use the three small wire nuts supplied to connect the receiver and ceiling fan wiring. See Wiring Diagram in

Figure 3.

5. Continue you ceiling fan installation according to its provided instructions.

NOTE: Be sure the antenna is positioned so it does not interfere with the ceiling fan's motor (Figure 2 series).

CAUTION: Do not modify or damage the antenna wire as control performance may be reduced.

6. After securing the antenna and wiring, proceed with hanging your ceiling fan according to its instructions.

New Installation of Ceiling Fan Along With Receiver

1. Install the ceiling fan according to its instructions, up to the section of wiring connections.
2. Connect the receiver to the ceiling fan's hanging or mounting bracket per your mounting type (Figure 2 series).
3. Use the two larger wire nuts supplied to connect the receiver and house wiring, then use the three small wire nuts supplied to connect the receiver and ceiling fan wiring. See wiring diagram in Figure 2 series).

NOTE: Be sure the antenna is positioned so it does not interfere with the ceiling fan's motor (Figure 2 series).

Caution: Do not modify or damage the antenna wire as control performance may be reduced.

4. After securing the antenna and wiring, proceed with hanging your ceiling fan according to its instructions.

Before Initial Operation

Use the pull chain to set the fan speed to the HIGH position before using your remote control unit.

Set the ceiling fan light to the ON position before using your remote control unit.

TRANSMITTER PREPARATION

1. Set the security code to match the set mode in the receiver.
2. Install four AAA batteries inside the hand-held remote transmitter.
3. You may mount the wall holder for convenient and safekeeping.

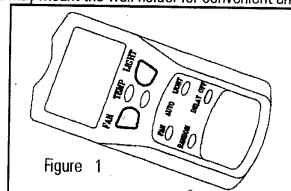

Figure 1

FAN OPERATION

Turn on wall switch

Fan Key: This key changes the fan manually to fixed speeds. Press once for HI; press twice for MD; press three times for LO; press four times for LL and press the fifth time for OFF.

Fan Auto Key: Pressing this key activates the thermostatic control function. The fan speeds change thermostatically dependent upon the room temperature and hand-held remote transmitter's set temperature.

NOTE: When the room temperature is higher than the setting temperature, the fan automatically cycles to a higher setting. Conversely, when the room temperature is lower than the set temperature, the fan will automatically cycle to a lower speed setting.

Automatic Speed Settings Per Room Temperature

- * Room temperature is 3 degrees higher than remote set temperature---automatically to HI-speed setting.
- * Room temperature is 1 to 3 degrees higher than remote set temperature---automatically to MD-speed setting.
- * Room temperature is 1 degree higher to 1 degree lower than remote set temperature---automatically to LO-speed setting.
- * Room temperature is 1 degree lower than remote set temperature---automatically to LL-speed setting.



In the Fan Auto setting, the speeds are automatically controlled. You can not manually control the speeds until you disable the FAN AUTO. You can disable the transmitter in two ways: Press FAN AUTO key again, or by pressing the FAN key.

LIGHT OPERATION

Light Key: This key allows you to dim the lighting output through six brightness levels. Press and holding the key will take the light through its entire cycle.

A quick press of the key and the light will turn off. The next time the key is pressed, the light will turn on the its last brightness level.

Light Auto Key: In this mode, when the room is dark, the light will automatically turn on. After the light is automatically turned on, it will stay on for six hours or until you press the lighting menu key. You may disable the LIGHT AUTO mode by three ways: Press LIGHT AUTO key again, press random. When room light is at a high level, pressing the LIGHT key can also disable LIGHT AUTO function.

Random Key: This sets the fan in a security mode. The light will randomly change illumination levels. To disable this function, press the RANDOM key or LIGHT AUTO.

Delay Off Key: This gives you lighting for 180 seconds after you press this key allowing you to leave the room. You may disable this function by pressing LIGHT key

Temperature Setting: Use the up and down button to set the temperature to affect the fan speed in only the fan auto mode.

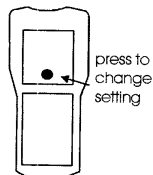

CAUTION: If the transmitter light key or fan key is pressed, all the operating states will handle by transmitter.

Setting other parameters:

SE OF

If changing temperature unit or security code is necessary. User can change those two parameters. First, press this tact switch that on the back of transmitter will takes transmitter to setting mode. If goes to setting mode, you can press up/down key to change temperature units.

CD 106

Press other keys to change the setting status to security code setting mode. The same as temperature units setting, presses up/down key to set the security code to others. Press other keys beside up/down will terminate testing mode.

CAUTION: If the security code is changed, please learning a new code by

the receiver.

How to Learn a new security code:

As the receiver be installed in the first time. It will be no any security code installed inside. When first power on the main units, receiver will echo a series of long beeps. Press LIGHT key or FAN key to control the ceiling fan and then receiver will get this code. After the receiver finished receive this new code, it will echo a series of short beeps.

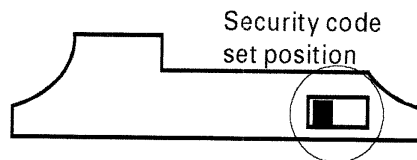
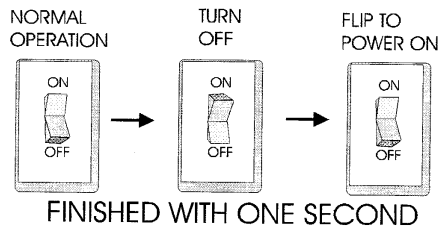

After it you can operation your ceiling fan as normally.

If want to change security codes as this remote controller interference another equipment or interference by others.

1. Flip the master power switch to turn off and flip to turn on as soon as possible. After receiver receive this flip signal it will goes to code learning mode. You just press LIGHT key or FAN to finishe code setting.
2. If there two ceiling fans are connected to same power switch, suggest you by security switch to set the security code. Turn off the ceiling fan power and lower down your canopy. Flip the security code switch to the other side.
3. Be carefully to operation the security code setting mode. There are only one ceiling fan can be entry to the security code setting mode or both of two ceiling fan will use the same code. In other words both two ceiling fan will controlled by the same trasmitter.

Entry learning mode processing of the main unit.

SPECIFICATIONS:

AC:120V/60Hz
LIGHT:250W. Max.
FAN:85W max.