

TEST AND ALINGMENT INSTRUCTIONS

1、 Measuring instruments and test set-up

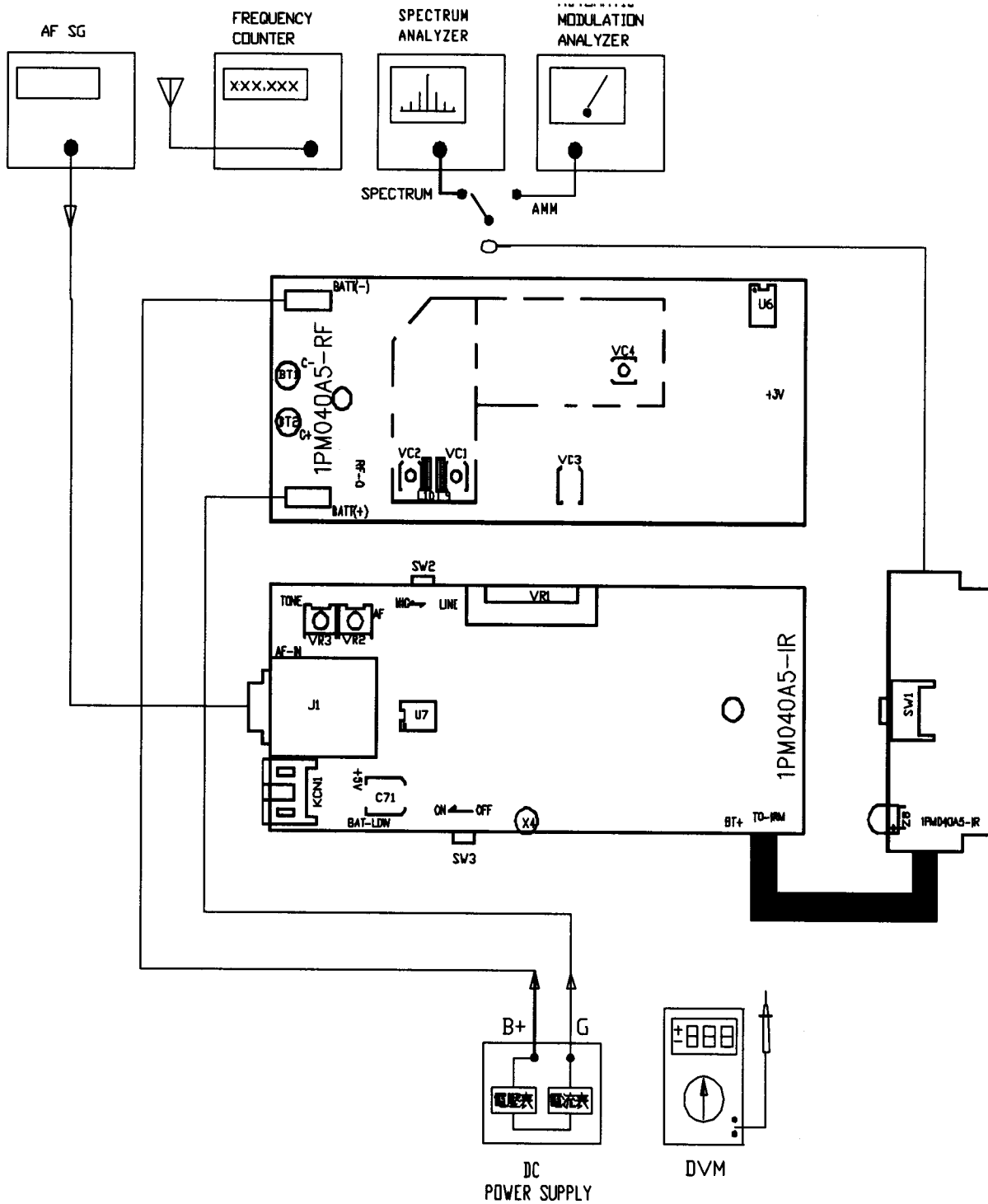

2.Pre-set

- A、 Audio analyzer : 400Hz, -30.3dBV.
- B、 DC power supply : 3V OUT
- C、 Spectrum analyzer : Frequency start 10MHz
Frequency stop 2.9GHz

TEST AND ALINGMENT INSTRUCTIONS

NO	MEASUREMENTA DJUSTMENT	SET-UP	OBSERVATION	TEST POINT	ADJ	NORMAL VALUE
1	"BATT-LOW" LED	DC POWER SUPPLY 3V	"BATT-LOW" LED	BAT+, BAT -	NO	LED flash one time when switch ON
2	DC TO DC	DC POWER SUPPLY 3V	DC VOLTAGE METER	TP6	NO	+6.2V ± 0.2V
3	VOLTAGE REAUATOR 3V	DC POWER SUPPLY 3V	DC VOLTAGE METER	C60 Anode	NO	+3V ± 0.25V
4	VOLTAGE REAUATOR 5V	DC POWER SUPPLY 3V	DC VOLTAGE METER	U6 8Pin	NO	+5V ± 0.25V
5	CENTER FREQ TRACKING VOLTAGE	SET TO CENTER FREQ	DC VOLTAGE METER	VC	VC3	2.5V ± 0.25V
6	RF OUTPUT POWER	SPECTRUM 1.FULL SPAN 2. Att 20dB 3. CENTER FREQ	SPECTRUM ANALYZET	ANT	VC1,VC2	1.PEAK:104~106dBuV 2.SPURIOUS>-50dBc
7	CURRENT DISSIPATION	DC POWER SUPPLY 3V	CURRENT MATER	BAT+ BAT -	NO	61mA~67mA
8	CENTER FREQUENCY	FRQUENCY COUNTER(100Hz RES)	FREQUENCY COUNTER	ANT	VC3	Fo ± 3KHz
9	AF 0 dB COMPANDOR	1. SW4 switch to "GT" 2. AUDIO ANALYZER 400Hz	AUDIO ANALYZER	U7 7Pin	NO	300 mV ± 10mV
10	MODULATION	AUDIO ANALYZER 400Hz	AMM (3.5K LPF)	ANT	VR2	40 ± 1K
11	PREEMPHASIS	AUDIO ANALYZER 10KHz	AMM (15K LPF)	ANT	NO	65 ± 4K
12	TONE DEF (5 DEV)	1.MIC2 (TP5 TO GND) 2.AMM(50K,60K LPF) OR SPECTRUN ANY	AMM OR SPECTRUM ANALYZER MARK Δ TO32K (NEXT PEAK)	ANT	VR3	5K ± 0.3K (AMM) -22.5 ± 0.5dB (SPECTRUN)
13	BATT. LOW DISPLAY	DC VOLTAGE 2.2V DC VOLTAGE 2.0V	LED2 LED2	BAT+ BAT -	NO	Z7 OFF Z7 ON
14	BATT. LOW OFF	DC VOLTAGE 1.9V	LED2	BAT+ BAT -	NO	Z7 ON

T101ACTR03A