

IF IN DOUBT ASK

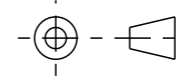

DO NOT SCALE  
DIMENSIONS IN M.M.

REV	CHANGE NO./DATE

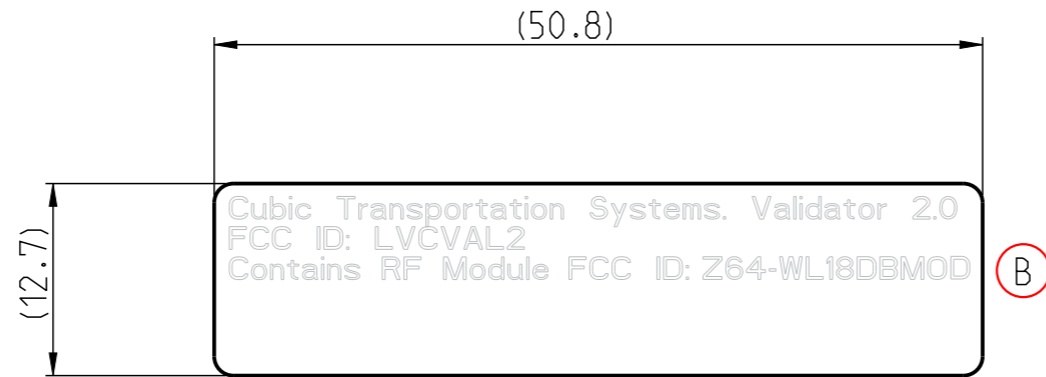

NOTES:

- REMOVE ALL BURRS AND SHARP EDGES.
- MANUFACTURE IN ACCORDANCE WITH CUBIC QS DOC No. 0001-00208.
- B** 3. CREATE LEGIBLE TEXT ON LABEL AS SHOWN. 1.5mm HIGH BLACK TEXT EVENLY SPACED ON WHITE BACKGROUND.
4. TEXT IS AS FOLLOWS:

**B** Cubic Transportation Systems. Validator 2.0  
FCC ID: LVCVAL2  
Contains RF Module FCC ID: Z64-WL18DBMOD

	Pro/ENGINEER MODIFY ONLY
B	ECN: 5300-90812 10-10-19 JC
A	20-3104.20.0066.9902.1 21-03-19 MIP

		<small>CUBIC TRANSPORTATION SYSTEMS LTD. AFC HOUSE, HONEYCROCK LANE SALFORDS, REDHILL SURREY, ENGLAND. RH1 5LA Tel: 01737 782200 Fax: 01737 789759</small>	
MATERIAL	BRADY THT-53-423	UNSPECIFIED TOLERANCES 2 DEC PLACES ±0.1 1 DEC PLACE ±0.2 NO DEC PLACE:- :UPTO INCL 100mm ±0.5 :ABOVE 100mm ±1 ANGLES ±1/2°	SCALE 2:1

REV	CHANGE NO./DATE
DRAWN	DATE
MIP	20-MAR-2019
CHECKED	DATE
APPROVED	DATE
RELEASED	DATE

Copyright © 2019 Cubic Transportation Systems Ltd.  
This document is the copyright of Cubic Transportation Systems Limited and the information therein may be the subject of a pending or granted patent.  
It may not be reproduced or used for any other purpose than for which it is supplied without the written permission of Cubic Transportation Systems Limited.

FORM No. 0001-14713/G	CAD FILE FORMAT Pro/ENGINEER (*.DRW)	TITLE VALIDATOR 2.0 FCC LABEL
--------------------------	---	----------------------------------

DRG.NO. 5300-02356	SHEET 1 OF 1 SHEETS	A3
-----------------------	---------------------	----

