

BATTERY SAFETY INFORMATION

- Use only size "AAA" (LR03) alkaline batteries (10 required).
- Charging of rechargeable batteries should only be done under adult supervision with batteries removed from product.
- Do not mix old and new batteries.
- Do not mix alkaline, standard (carbon-zinc), or rechargeable batteries.
- Be sure to insert the batteries correctly and follow the toy and battery manufacturer's instruction.
- Always remove exhausted or dead batteries from the product.
- Dispose of dead batteries properly: do not burn or bury them.
- Do not attempt to recharge non-rechargeable batteries.
- Avoid short-circuiting battery terminals.
- Remove batteries before placing the unit into storage for a prolonged period of time.

FCC COMPLIANCE

NOTE: This equipment has been tested and found to comply with the limits for a Class B digital device, pursuant to Part 15 of the FCC Rules. These limits are designed to provide reasonable protection against harmful interference in a residential installation. This equipment generates, uses and can radiate radio frequency energy and, if not installed and used in accordance with the instructions, may cause harmful interference to radio communications. However, there is no guarantee that interference will not occur in a particular installation. If this equipment does cause harmful interference to radio or television reception, which can be determined by turning the equipment off and on, the user is encouraged to try to correct the interference by one or more of the following measures:

- Reorient or relocate the receiving antenna.
- Increase the separation between the equipment and receiver.
- Connect the equipment into an outlet on a circuit different from that to which the receiver is connected.
- Consult the dealer or an experienced radio/TV technician for help.

This device complies with Part 15 of the FCC Rules. Operation is subject to the following two conditions: (1) This device may not cause harmful interference, and (2) this device must accept any interference received, including interference that may cause undesired operation.

Caution: Modifications not authorized by the manufacturer may void users authority to operate this device. CAN ICES-3 (B)/NMB-3(B).

LIMITED WARRANTY

The Little Tikes Company makes fun, high quality toys. We warrant to the original purchaser that this product is free of defects in materials or workmanship for one year * from the date of purchase (dated sales receipt is required for proof of purchase). At the sole election of The Little Tikes Company, the only remedies available under this warranty will be the replacement of the defective part or replacement of the product. This warranty is valid only if the product has been assembled and maintained per the instructions. This warranty does not cover abuse, accident, cosmetic issues such as fading or scratches from normal wear, or any other cause not arising from defects in material and workmanship. *The warranty period is three (3) months for daycare or commercial purchasers. U.S.A and Canada: For warranty service or replacement part information, please visit our website at www.little-tikes.com, call 1-800-321-0183 or write to: Consumer Service, The Little Tikes Company, 2180 Barlow Road, Hudson OH 44236, U.S.A. Some replacement parts may be available for purchase after warranty expires—contact us for details. Outside U.S.A and Canada: Contact place of purchase for warranty service. This warranty gives you specific legal rights, and you may also have other rights, which vary from country/state to country/state. Some countries/states do not allow the exclusion or limitation of incidental or consequential damages, so the above limitation or exclusion may not apply to you.



*Let's care for the environment!

The wheelee bin symbol indicates that the product must not be disposed of with other household waste. Please use designated collection points or recycling facilities when disposing of the item. Do not treat old batteries as household waste. Take them to a designated recycling facility.

Please keep this manual as it contains important information.



© The Little Tikes Company, an MGA Entertainment company. LITTLE TIKES® is a trademark of Little Tikes in the U.S. and other countries. All logos, names, characters, likenesses, images, slogans, and packaging appearance are the property of Little Tikes. Little Tikes Consumer Service 2180 Barlow Road Hudson, Ohio 44236 U.S.A. 1-800-321-0183 Printed in China

MGA Entertainment UK Ltd
50 Presley Way
Crownhill
Milton Keynes
MK8 0ES
Bucks, UK
0800 521 558

www.littletikes.com
www.littletikes.co.uk



Visit our website at www.littletikes.com to register your product and to enter our sweepstakes. (No purchase necessary)



Bumper Cars

SKU: 643330

AGES 3+ YEARS
ADULT SUPERVISION RECOMMENDED.
ADULT BATTERY INSTALLATION REQUIRED.

CONTENTS

- A. 2 Little Tikes® RC Bumper Cars
- B. 2 Bumper Car Figures
- C. 2 Remote Controls



A. x2

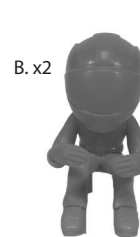

B. x2



C. x2

Illustrations are for reference only. Styles may vary from actual contents.

BATTERY INSTALLATION

Before playing, an adult must install fresh alkaline batteries in the cars and remotes. Here's how:

1. Using a Phillips screwdriver (not included) remove the screws and battery compartment covers from the underside of the cars (Fig.1) and remotes (Fig.2).
2. Install three (3) fresh 1.5V AAA alkaline batteries (not included) into each car making sure the (+) and (-) ends face the proper direction as indicated inside the battery compartments (Fig.3).
3. Replace compartment covers and tighten the screws.
4. Install two (2) fresh 1.5V AAA alkaline batteries (not included) into each remote making sure the (+) and (-) ends face the proper direction as indicated inside the battery compartments (Fig.4).

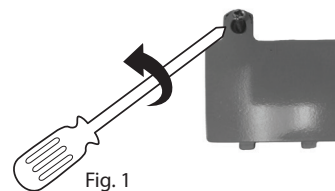

Fig. 1

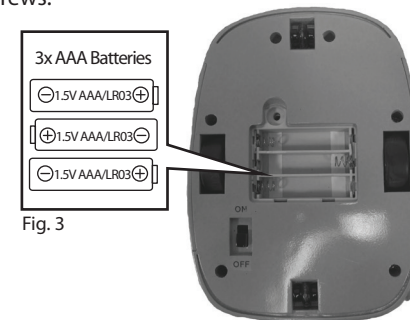

Fig. 3

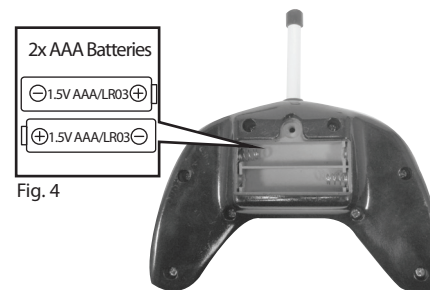

Fig. 4

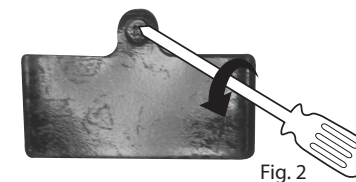
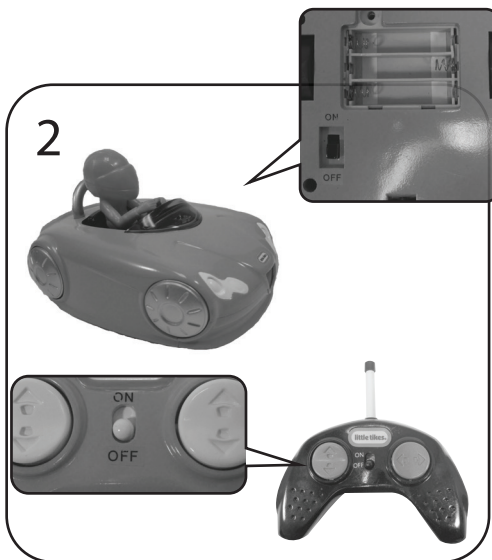

Fig. 2

QUICK START



Insert the figure into the driver's seat of the car making sure it clicks into place. Repeat for the other figure.



After turning on the cars and remotes, use the diagram on page 3 to maneuver the cars.

Note: The color of the remotes will correspond with the color of the cars to indicate which car the remote is controlling.

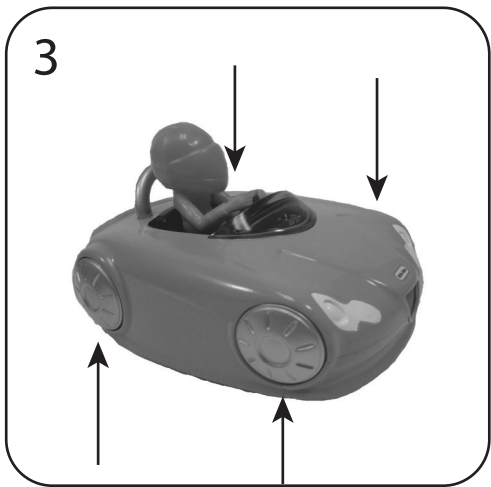

Hit one of the four wheels of the opponent's car.

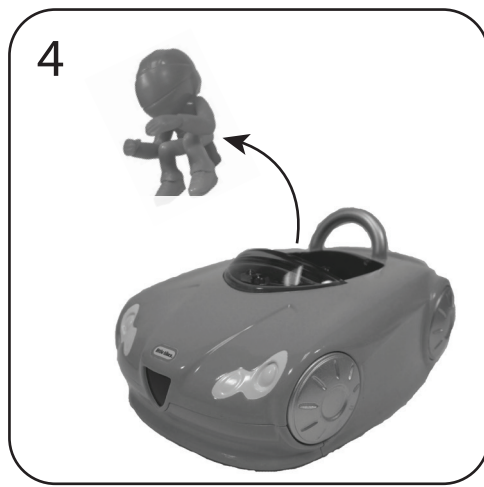

The figure will eject from the driver's seat.

PAIRING AND DRIVING

1. To assure your car will pick up the correct frequency, switch the car ON first, then switch the remote control ON. (Pair the cars and the remote controls one by one.)
2. Place the car on the floor.
3. Press the buttons on the remote control as shown in the diagram below.
NOTE: When finished playing, first turn off the car, then turn off the remote control.

REMOTE CONTROL DIAGRAM



Press both buttons up, car will move forward. (Press both buttons down, car will reverse.)



Press right button up, car will spin to the left. (Press right button down, car will spin backwards to the left.)



Press left button up, car will spin to the right. (Press left button down, car will spin backwards to the right.)



Press and hold buttons as shown, car will spin in a circle. (Press and hold opposite buttons, car will spin in the opposite direction.)

IMPORTANT INFORMATION

- Do not play with cars in the street or where there is vehicular traffic or in heavily traveled areas with pedestrians.
- Do not stand on, sit on or throw cars and remotes as doing so can result in injury to the person and irreparable damage to the units.
- Avoid running cars into furniture, walls, pets, people etc., as doing so may cause injury to the people and pets and irreparable damage to the units.
- Avoid driving the cars through water, mud, etc.
- Keep long hair or loose apparel such as shoestrings away from the rotating wheels.
- It is recommended to drive the cars on hardwood floor.
- Both cars operate under different frequencies (49MHz and 27 MHz) to prevent interference between the remotes and cars.
- Keep the remote controls in range to operate cars correctly.
- If cars run slowly, replace batteries.
- Turn off both cars and remotes after use to conserve battery power.