

STEP 2 : INSTALLATION OF BATTERIES

Once you have charged your Battery Pack, you are now ready to install it into your Land-Sea R/C vehicle! You will also need to insert a standard 9-Volt battery into your Handset.

-LAND-SEA VEHICLE:

1. Remove the two rubber seal attachments from the cockpit window. (see Fig.1)
2. Unscrew the three screws on top of the cockpit window (battery cover) with a Phillips screwdriver. (see Fig.2)
3. Insert a fully charged NiCd Battery Pack with the positive (+) and negative (-) ends facing in the proper direction as indicated inside the compartment (negative should be on top) and slide it towards the front of the vehicle until you hear a click (see Fig.3).
4. Replace the cockpit cover and rubber seal attachments. Failure to do so may result in damage to the vehicle.

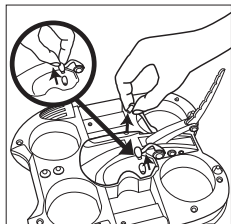

Fig. 1

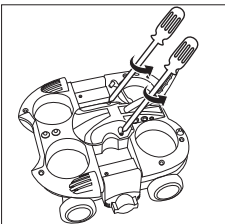

Fig. 2

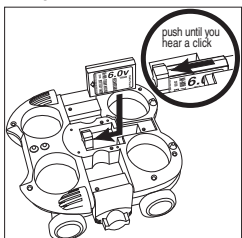

Fig. 3

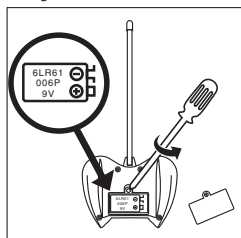

Fig. 4

□ -R/C HANDSET:

1. Unscrew the battery cover on the rear of Handset controller and insert one 9-Volt battery. (see Fig.4)
2. Replace the battery cover and screw.

STEP 3 : USING YOUR LAND-SEA R/C

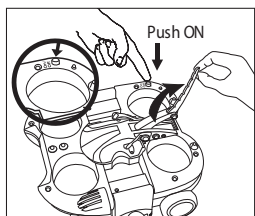

Fig. 5

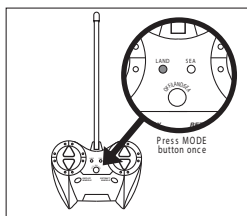

Fig. 6

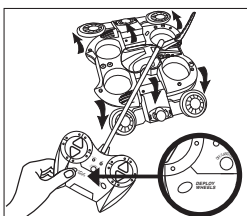

Fig. 7

Once you have fully charged your Land-Sea R/C, you are now ready to control it to go anywhere--- on land or on water!

-TO USE YOUR LAND-SEA R/C ON LAND:

1. Extend the antenna behind the cockpit on the vehicle. (see Fig.5)
2. Press the On/Off button at the vehicle's right-side back to turn the vehicle on and place it on the ground. (see Fig.5)
3. Press the Mode button (OFF/LAND/SEA) on the Handset once (from Off Mode) to engage Land Mode (the Land LED indicator will light up). (see Fig.6) This sends power to the vehicle's wheels.
4. Press and hold the Deploy button to extend the wheels until the wheels are fully extended. (see Fig.7)
5. You will hear a clicking sound when the wheels are fully extended and in the full down position. When you hear the clicking sound, release the Deploy button.
6. Press the Left & Right control buttons to control the Land-Sea R/C to move forward, backward, left & right on land.

TO USE YOUR LAND-SEA R/C AS A TANK! (Land Only)

1. Press the Deploy or Retract button to adjust the wheels so that they are aimed directly upright. This is approximately the mid-way point in the transition from 4x4 to boat and will require a little skill to get it exactly where it should be. (see Fig.10)

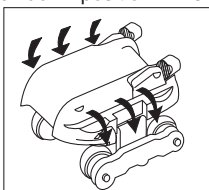

Fig. 8

2. When the wheels are aimed directly upright, turn the vehicle over so that the wheels are touching the ground. Make sure that the antenna is retracted and not touching the ground. (see Fig.8)
3. Use the Handset to control the Land Sea R/C to move forward, backward, left & right on land.

Helpful Hint: If at anytime during the retraction or extension of the wheels, the wheels appear to be "stuck" or not able to complete the full transition from land to sea or back again, simply lift the vehicle by the cockpit and give the handset command again.

Important Note: Do not use your hands to manually switch from Land to Sea mode (and back again) as it may cause damage to the vehicle; always use your Handset.

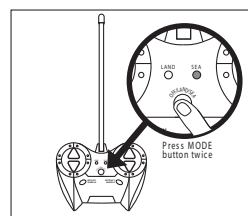

Fig. 9

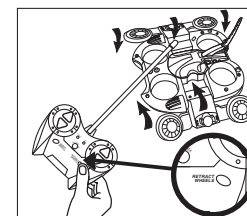

Fig. 10

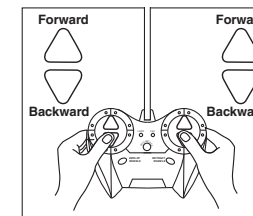

Fig. 11

□ -TO USE YOUR LAND-SEA R/C ON WATER:

1. Extend the antenna behind the cockpit on the vehicle. (see Fig.5)
2. Press the Mode button on the Handset (OFF/LAND/SEA) twice (from Off Mode) to engage Sea Mode (the Sea Mode LED indicator will light up). (see Fig.9) This sends power to the vehicle's boat motor.
3. Make sure your vehicle is turned on. Place your Land-Sea R/C into water.
4. Press and hold the Retract Button to retract the wheels until the wheels are fully retracted. (see Fig.10)
5. You will hear a clicking sound when the wheels are fully retracted and in the full up position. When you hear the clicking sound, release the Retract button.
6. Press the Left & Right control buttons to control the Land-Sea R/C to move forward, backward, left & right in water. (see Fig.11)

NOTE: Although water-resistant, do not submerge your R/C Handset underwater for more than a few seconds as it may cause damage.

Land-Sea R/C can easily make the transition from water to land in just seconds! Here's an example for non-stop R/C fun:

1. Turn your Land-Sea R/C on, place it on the ground, and press the MODE button to engage Land mode.
2. Control your vehicle to go in any direction with the full-function Handset.
3. When you come upon a body of water, simply drive you vehicle into the water until it begins to float.
4. Press the MODE button to engage Sea Mode and press and hold the Retract button until your wheels are fully retracted.
5. Control your vehicle to go anywhere on water with the full-fuction Handset.
6. When you come upon a body of land, simply ride your vehicle onto the turf until it stops.
7. Press the MODE button to engage Land Mode and press and hold the Deploy button until your wheels are fully extended.
8. Once again, control your vehicle to go anywhere on land with the full-function Handset.

STEP 4 : RECHARGING YOUR BATTERY

After approximately 20 minutes, the performance ability of your Land-Sea R/C will decrease. At this time, it is time to charge your Battery Pack. To do so, simply follow these quick and easy steps:

1. Remove the Battery Pack from your Land-Sea RC with a Phillips screwdriver. If it is warm, please allow up to twenty minutes to cool before recharging.
2. Follow the recharging instructions included with your Battery Pack and Charger.