

TROUBLESHOOTING GUIDE

| SYMPTOM            | CAUSE   | SOLUTION   |
|--------------------|---|--|
| No sound           | Headphone is not turned on.                   | Turn on the headphone.                                       |
|                    | Batteries are exhausted.                      | Change batteries.  |
|                    | Transmitter's power is off.                   | Turn on the transmitter's power.                             |
|                    | Headphones' volume is completely turned down. | Turn the volume up.  |
|                    | Automatic"muting"at headphone.                | Move closer to transmitter.                                  |
| Poor sound quality | Headphones' batteries are weak.               | Change batteries.  |
|                    | Out of range                                  | Move closer to transmitter or adjust the transmitter antenna |

SPECIFICATIONS

|                               |   |
|-------------------------------|---|
| Communication level mode      | Radio Frequency(49.86MHz)                         |
| Communication level           | Stereo  |
| Power requirement:            |   |
| Transmitter                   | 12V 100mA AC/DC adapter                           |
| Headphone(receiver)           | 3V (2x1.5V AAA carbon, alkaline, Ni-Cd batteries) |
| Frequency Response            | 30-10000Hz  |
| S/N Ratio                     | 42 dB   |
| Distortion                    | 1%  |
| Max operating distance        | Maximum 25 meters                                 |
| Weight:                       |   |
| Transmitter (without adapter) | 105g  |
| Headphone (without batteries) | 122g  |
| Standard Accessories          | AC/DC power adapter(for transmitter)              |
|                               | 3.5mm to 6.3mm Plug Adapter                       |
|                               | 3.5mm to RCA (stereo) Patch cord                  |

This device complies with Part 15 of the FCC Rules. Operation is subject to the following two conditions:

- 1.This device may not cause harmful interference,and
- 2.This device must accept any interference received.Including interference that may cause undesired operation.

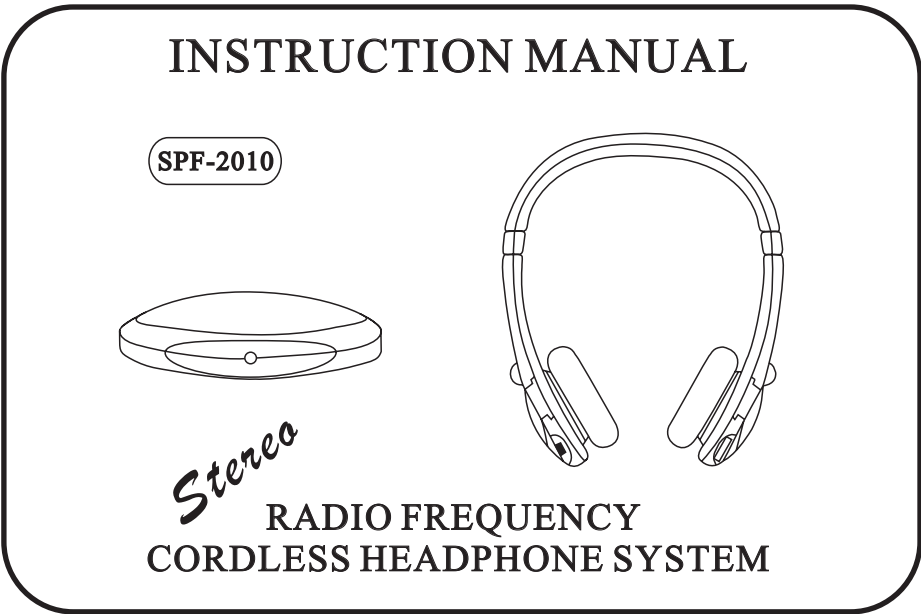

SYSTEM COMPONENTS

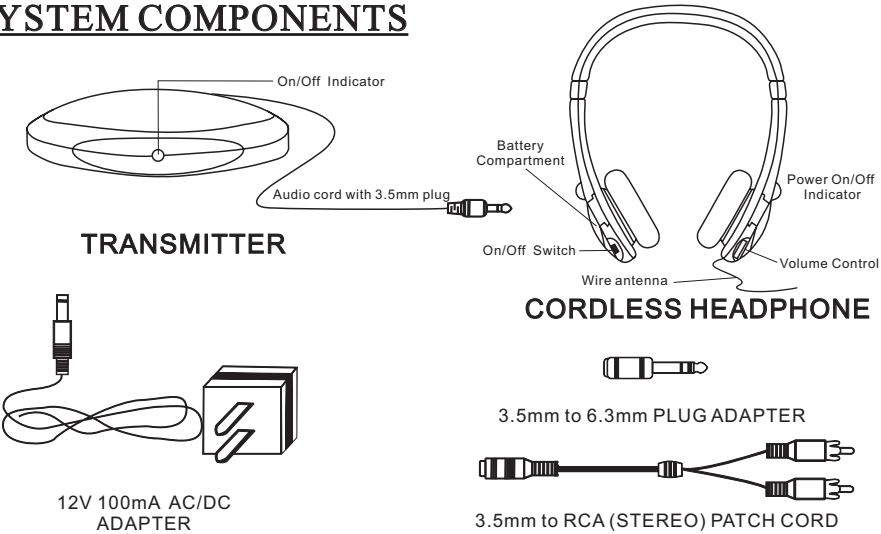

**Caution:** Any changes or modifications not expressly approved by the party responsible for compliance could void the user's authority to operate the equipment.

## INSTALLATION

For the following illustration, we use television as the audio source equipment. For actual usage, you may select any type of audio source equipment for connection.

### I. Equipment with 3.5mm phone jack

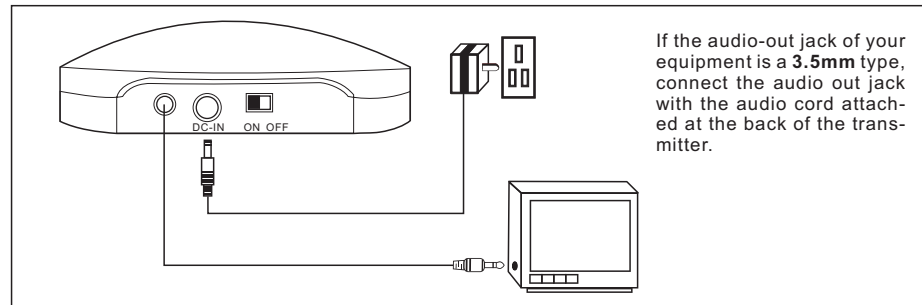

### II. Equipment with 6.3mm phone jack

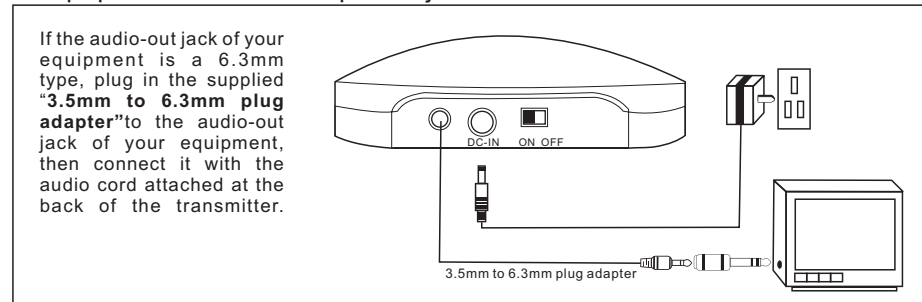

### III. Equipment with RCA jack

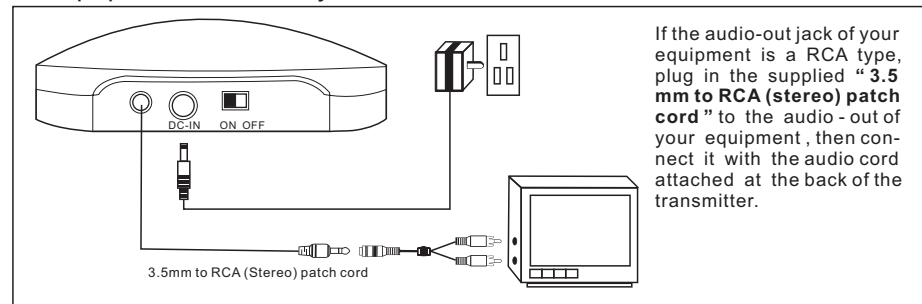

## IMPORTANT: CONNECTION TO MONO EQUIPMENT

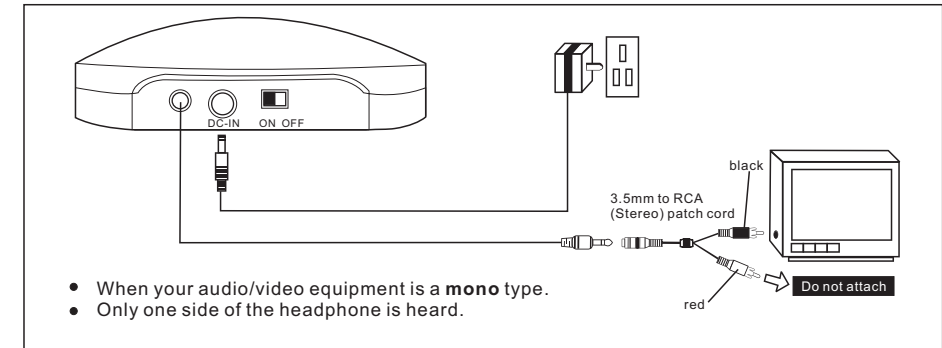

## POSITION OF THE TRANSMITTER

This cordless headphone system is designed for indoor use within a distance of 25 meters between the transmitter and the receiver.

**Note:** Do not place the transmitter in a location near sources such as radiators, heater, or any place subject to direct sunlight or vibration.

## OPERATION

1. Turn on your audio equipment and the transmitter. You will be able to see the LED power indicator light go on.
2. Set the volume of your audio equipment at medium level.
3. Turn on the headphone receiver, the LED, power indicator should go on. Adjust the size of the headphone by pulling up or down on each side until it fits on your head comfortably. Adjust the audio volume as desired.

## BATTERY CHANGE

1. Make sure headphone receiver is off.
2. Slide open battery compartment cover.
3. Insert two AAA (1.5V) batteries with the (+) and (-) poles correctly aligned into the battery compartment. Alkaline type or Ni-Cd rechargeable type batteries are recommended.
4. Close the battery compartment.

