



ITM. / ART. 2006134
ITM. / ART. 1487544
ITM. / ART. 1487019
ITM. / ART. 1486906
Ready-to-Play® Series

Lionel
Ready-to-Play® Train Set
Owner's Manual

Assembly required
Batteries not included



WARNING:

**CHOKING HAZARD-Small parts.
Not for children under 3 years.**

IMPORTANT, RETAIN FOR FUTURE REFERENCE: READ CAREFULLY

FCC and RSS Statements

Warning: Changes or modifications to this unit not expressly approved by the party responsible for compliance could void the user's authority to operate the equipment.

.....

NOTE: This equipment has been tested and found to comply with the limits for a Class B digital device, pursuant to Part 15 of the FCC Rules. These limits are designed to provide reasonable protection against harmful interference in a residential installation. This equipment generates, uses and can radiate radio frequency energy and, if not installed and used in accordance with the instructions, may cause harmful interference to radio communications.

However, there is no guarantee that interference will not occur in a particular installation. If this equipment does cause harmful interference to radio or television reception, which can be determined by turning the equipment off and on, the user is encouraged to try to correct the interference by one or more of the following measures:

- Reorient or relocate the receiving antenna.
- Increase the separation between the equipment and receiver.
- Consult the dealer or an experienced radio/TV technician for help.

This device complies with Part 15 of the FCC Rules. Operation is subject to the following two conditions: (1) this device may not cause harmful interference, and (2) this device must accept any interference received, including interference that may cause undesired operation.

Model Numbers:

Berkshire: 7-12100

General: 7-12102

4-6-0: 7-12103

Remote: 7-12105

This device contains licence-exempt transmitter(s)/receiver(s) that comply with Innovation, Science and Economic Development Canada's licence-exempt RSS(s). Operation is subject to the following two conditions: (1) This device may not cause interference, and (2) This device must accept any interference, including interference that may cause undesired operation of the device.

- **Always purchase the correct size and grade of battery most suitable for the intended use.**
- **Always replace the whole set of batteries at one time, taking care not to mix old and new ones, or batteries of different types.**
- **Clean the battery contacts and also those of the device prior to battery installation.**
- **Ensure the batteries are installed correctly with regard to polarity (+ and -).**
- **Remove batteries from product during periods of non-use. Battery leakage can cause corrosion and damage to this product.**
- **Remove used batteries promptly.**
- **For recycling and disposal of batteries, and to protect the environment, please check the internet or your local phone directory for local recycling centers and/or follow local government regulations.**

Joining the track sections

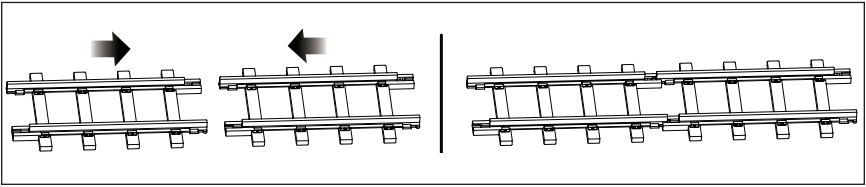

Layouts

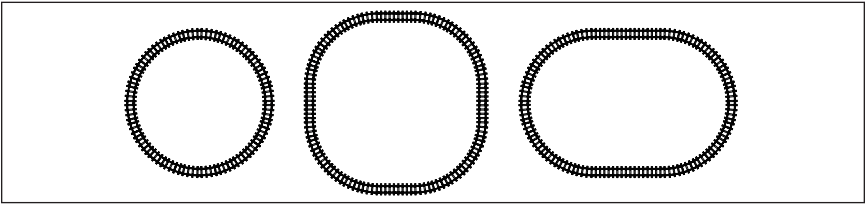

Additional track is now available to create new layouts. SOLD SEPARATELY.

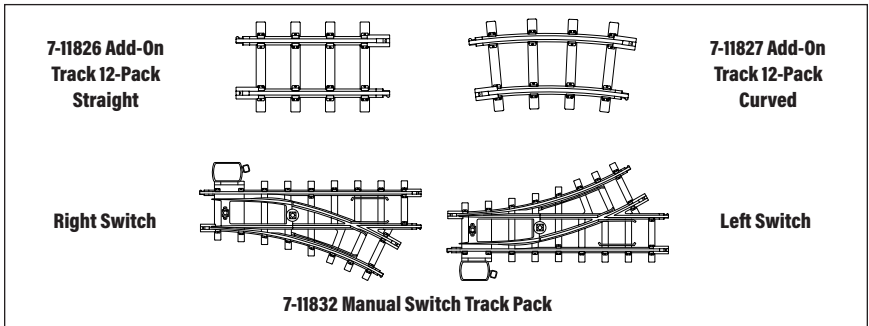

Installing AAA batteries into the Wireless Controller

Important! 3 AAA batteries required (not included).

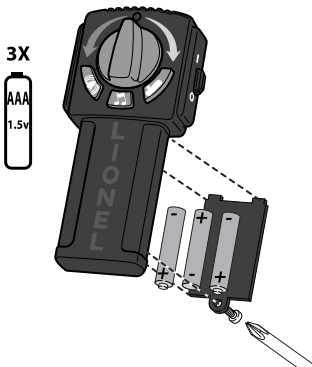

Important!

REMOVE ALL BATTERIES WHEN THE TRAIN WILL NOT BE USED FOR AN EXTENDED PERIOD OF TIME. LIONEL'S LIMITED WARRANTY DOES NOT COVER DAMAGE TO YOUR WIRELESS CONTROLLER CAUSED FROM LEAKING BATTERIES.

Important!

When you are not operating the train, slide the On/Off switch to the OFF position to conserve the battery life.

Important!

6 C batteries required (not included).

Important!

Remove all batteries when the train will not be used for an extended period of time. Lionel's Limited Warranty does not cover damage to the locomotive caused from leaking batteries.

Important!

Use Alkaline 'C' batteries. Use only new batteries. Never mix new and used batteries or use different types of batteries together.

Installing 'C' batteries into the Berkshire Locomotive (The Polar Express)

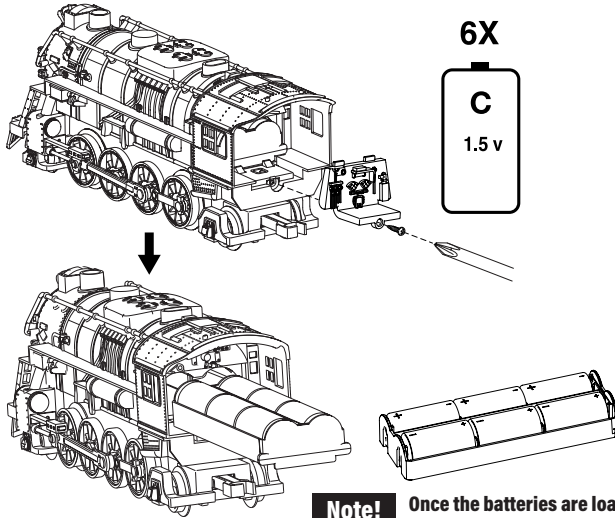

Note!

Once the batteries are loaded, the screw should be tightened all the way to ensure that the battery contacts stay in place between the battery holder and the spring contacts.

Installing 'C' batteries into the 4-6-0 Locomotive (Hogwarts Express)

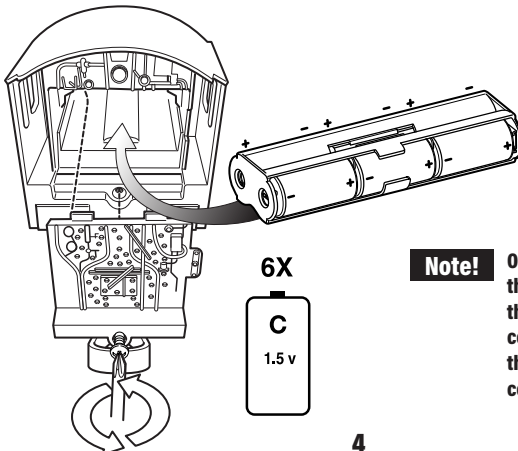

Note!

Once the batteries are loaded, the screw should be tightened all the way to ensure that the battery contacts stay in place between the battery holder and the spring contacts.

Important! 6 C batteries required (not included).

Important! Remove all batteries when the train will not be used for an extended period of time. Lionel's Limited Warranty does not cover damage to the locomotive caused from leaking batteries.

Important! Use Alkaline 'C' batteries. Use only new batteries. Never mix new and used batteries or use different types of batteries together.

Installing 'C' batteries into the General Locomotive (Mickey Mouse & Toy Story)

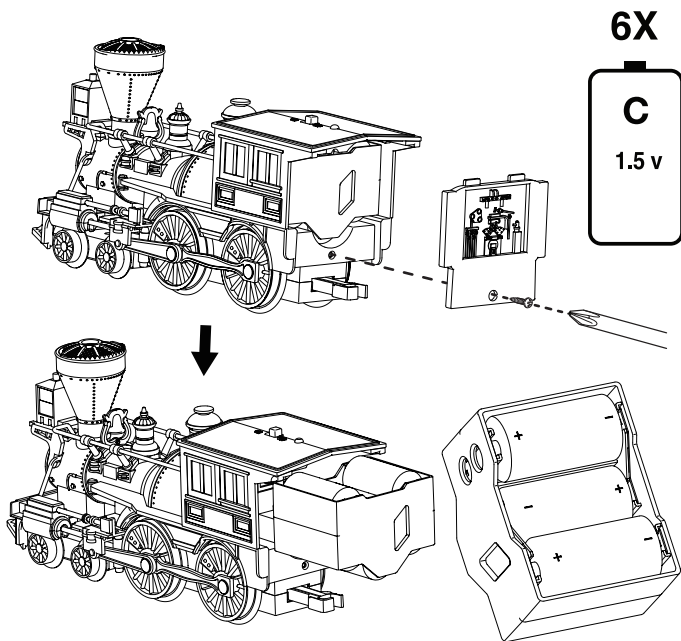

Note!

Once the batteries are loaded, the screw should be tightened all the way to ensure that the battery contacts stay in place between the battery holder and the spring contacts.

Connecting the locomotive and train cars together

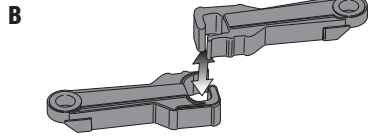
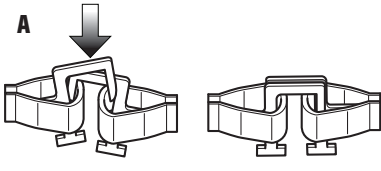

Attaching the included coupler extenders (System B ONLY)

If you are experiencing difficulty keeping the train cars connected to one another, snap the coupler extenders onto each coupler arm as depicted in the image to the right. This should help prevent the train cars from becoming un-coupled.

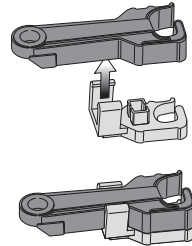

Power activation button on the locomotive

Note! The engine will beep until the remote turns on.

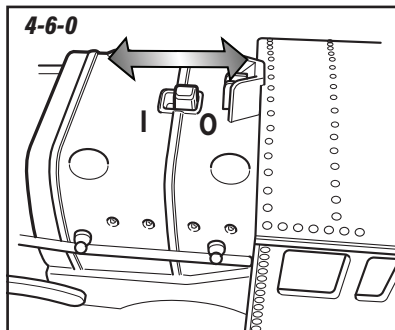
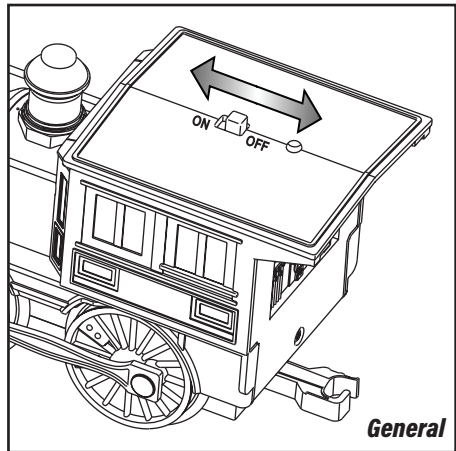
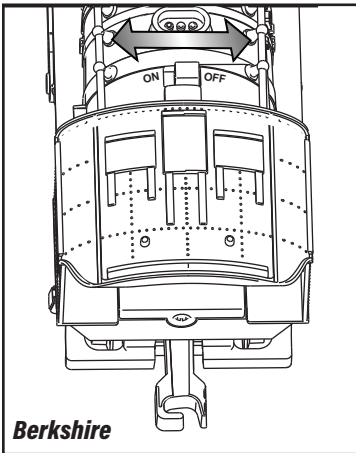

Operating your wireless controller

Note! LEAVING THE WIRELESS CONTROLLER POWER ON WHEN NOT IN USE WILL DRAIN THE CONTROLLER'S BATTERY.

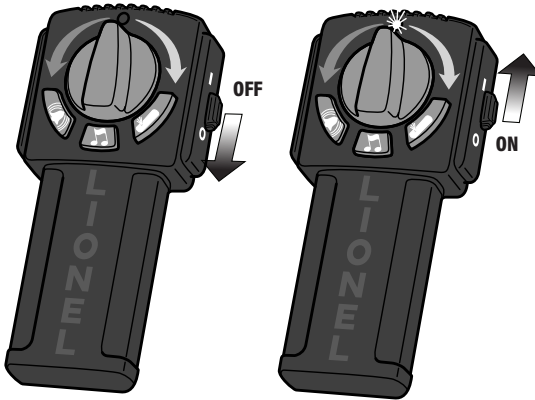

FORWARD



STOP



REVERSE



BELL



ANNOUNCEMENT



WHISTLE



DO NOT RETURN TO STORE

For help with assembly or warranty service call our toll free number:

1-800-4-LIONEL (454-6635)

Monday through Friday

9AM to 6PM EDT

Language Spoken: English

This product is covered by a ONE year limited warranty effective from the date of purchase against defects in materials and workmanship.

AUSTRALIA: Our goods come with guarantees that cannot be excluded under the Australian Consumer Law. You are entitled to a replacement or refund for a major failure and for compensation for any other reasonably foreseeable loss or damage. You are also entitled to have the goods repaired or replaced if the goods fail to be of acceptable quality and the failure does not amount to a major failure.

Distributed by: Costco Wholesale Corporation P.O. Box 34535 Seattle, WA 98124-1535 USA 1-800-774-2678 www.costco.com	Costco Wholesale Canada Ltd.* 415 W. Hunt Club Road Ottawa, Ontario K2E 1C5, Canada 1-800-463-3783 www.costco.ca * faisant affaire au Quebec sous le nom les Entrepôts Costco	Importado por: Importadora Primex S.A. de C.V. Blvd. Magnocentro No. 4 San Fernando La Herradura Huixquilucan, Estado de México C.P. 52765 RFC: IPR-930907-S70 (55)-5246-5500 www.costco.com.mx	Costco Wholesale Australia Pty Ltd 17-21 Parramatta Road Lidcombe NSW 2141 Australia www.costco.com.au
Costco Wholesale UK Ltd / Costco Online UK Ltd Hartspring Lane Watford, Herts WD25 8JS United Kingdom 01923 213113 www.costco.co.uk	Costco Wholesale Spain S.L.U. Poligono Empresarial Los Gavilanes C/ Agustín de Betancourt, 17 28906 Getafe (Madrid) España NIF: B86509460 900 111 155 www.costco.es	Costco Wholesale Iceland hf. Kauptún 3-7, 210 Gardabaer Iceland www.costco.is	Costco France 1 avenue de Bréhat 91140 Villebon-sur-Yvette France 01 80 45 01 10 www.costco.fr
Costco Wholesale Japan Ltd. 3-1-4 Ikegami-Shincho Kawasaki-ku, Kawasaki-shi, Kanagawa 210-0832 Japan 0570-200-800 www.costco.co.jp	Costco Wholesale Korea, Ltd. 40, Iljik-ro Gwangmyeong-si Gyeonggi-do, 14347, Korea 1899-9900 www.costco.co.kr	Costco Wholesale New Zealand Limited 2 Gunton Drive Westgate Auckland 0814 New Zealand	Costco (China) Investment Co., LTD. Room 1003, Block 2, 2388 Xiupu Road, Pudong New Area, Shanghai China 201315 +86-21-6257-7065



© 2021 LIONEL L.L.C., CONCORD, NC 28027
UNITED STATES OF AMERICA
PRINTED IN CHINA



MADE IN CHINA

The following Lionel marks are used throughout this Owner's Manual and are protected under law. All rights reserved. Lionel. Ready-to-Play®



BOM #: 05-MAN-L-FCC-21

Size: (L)5.5" x (H)8.5"

Date: 2021-05-04

FCC Statements

Warning: Changes or modifications to this unit not expressly approved by the party responsible for compliance could void the user's authority to operate the equipment.

NOTE: This equipment has been tested and found to comply with the limits for a Class B digital device, pursuant to Part 15 of the FCC Rules. These limits are designed to provide reasonable protection against harmful interference in a residential installation. This equipment generates, uses and can radiate radio frequency energy and, if not installed and used in accordance with the instructions, may cause harmful interference to radio communications.

However, there is no guarantee that interference will not occur in a particular installation. If this equipment does cause harmful interference to radio or television reception, which can be determined by turning the equipment off and on, the user is encouraged to try to correct the interference by one or more of the following measures:

- Reorient or relocate the receiving antenna.
- Increase the separation between the equipment and receiver.
- Consult the dealer or an experienced radio/TV technician for help.

This device complies with Part 15 of the FCC Rules. Operation is subject to the following two conditions: (1) this device may not cause harmful interference, and (2) this device must accept any interference received, including interference that may cause undesired operation.

Model Numbers:

Berkshire: 712100

General: 712102

Thomas: 712104

Diesel: 712101

4-6-0: 712103

Remote: 712105

RSS Statements

This device contains licence-exempt transmitter(s)/receiver(s) that comply with Innovation, Science and Economic Development Canada's licence-exempt RSS(s). Operation is subject to the following two conditions: (1) This device may not cause interference. (2) This device must accept any interference, including interference that may cause undesired operation of the device.

Cet appareil comprend des émetteurs/récepteurs exemptés de licence conformes aux normes CNR d'Innovation, Sciences et Développement économique Canada. Son fonctionnement est assujéti aux deux conditions suivantes :

1. **Cet appareil ne doit pas causer de brouillage.**
2. **Cet appareil doit accepter tout brouillage reçu, y compris le brouillage pouvant entraîner un mauvais fonctionnement de l'appareil.**

• Do not mix alkaline, standard (carbon-zinc), or rechargeable (nickle-cadmium) batteries.
• Different types of batteries or new and used batteries are not to be mixed.
• Only batteries of the same or equivalent type as recommended are to be used.
• Batteries are to be inserted with correct polarity.
• Exhausted batteries are to be removed from the toy.
• The supply terminals are not to be short-circuited.
• Dispose of battery(ies) safely.
• Do not dispose of this product in a fire. The batteries inside may explode or leak.
• Non-rechargeable batteries are not to be recharged.
• Rechargeable batteries are to be removed from the toy before being charged.
• Rechargeable batteries are only to be used under adult supervision.

• Ne pas combiner des piles alcalines, standard (carbone-zinc) ou rechargeables (nickel-cadmium).
• Ne jamais combiner des piles neuves et usagées, ni utiliser différents types de piles.
• Utiliser uniquement des piles du même type ou de type équivalent à celles qui sont recommandées.
• Les pôles de pile doivent être insérés dans le bon sens, en respectant la polarité.
• Les piles déchargées doivent être enlevées du jouet.
• Les bornes d'alimentation ne doivent pas être court-circuitées.
• Mettre les piles au rebut de façon sécuritaire.
• Ne pas jeter ce produit au feu. Les piles à l'intérieur pourraient exploser ou fuir.
• Ne pas recharger les piles non rechargeables.
• Les piles rechargeables doivent être enlevées du jouet avant d'être rechargées.
• Les piles rechargeables doivent être chargées seulement sous la surveillance d'un adulte.

• No mezcle baterías alcalinas, estándar (de zinc-carbón) o recargables (níquel-cadmio).
• No se deben mezclar baterías de distinto tipo o baterías nuevas y usadas.
• Sólo deben utilizarse baterías del mismo tipo o del tipo equivalente recomendado.
• Las baterías deben insertarse con la polaridad correcta.
• Las baterías gastadas deben extraerse del juguete.
• Los terminales de alimentación no deben ponerse en cortocircuito.
• Deseche las baterías de forma segura.
• No incinerar este producto. Las baterías que contiene pueden explotar o sufrir derrames.
• Las baterías no recargables no se deben recargar.
• Las baterías recargables deben extraerse del juguete antes de recargarse.
• Las baterías recargables solo deben utilizarse bajo la supervisión de una persona adulta.

WARNING:
CHOKING HAZARD-Small parts.
Not for children under 3 years.

AVERTISSEMENT :
RISQUE D'ÉTOUFFEMENT – Petites pièces.
Ne convient pas aux enfants de moins de 3 ans.

ADVERTENCIA:
PELIGRO DE ASFIXIA - Piezas pequeñas.
No apto para niños menores de 3 años.



**DO NOT RETURN TO STORE
NE PAS RETOURNER AU MAGASIN
NO DEVOLVER A LA TIENDA**

For help with assembly or warranty service call our toll free number:

Pour obtenir de l'aide pour l'assemblage ou le service sous garantie, appelez notre numéro sans frais :

Para obtener ayuda respecto al ensamblaje o el servicio de garantía, llame sin costo al:

1-800-4-LIONEL (454-6635)

Monday through Friday

9AM to 6PM

Language Spoken: English

This product is covered by a ONE year limited warranty effective from the date of purchase against defects in materials and workmanship.

AUSTRALIA: Our goods come with guarantees that cannot be excluded under the Australian Consumer Law. You are entitled to a replacement or refund for a major failure and for compensation for any other reasonably foreseeable loss or damage. You are also entitled to have the goods repaired or replaced if the goods fail to be of acceptable quality and the failure does not amount to a major failure.



MADE IN CHINA

©2021 LIONEL L.L.C., CONCORD, NC 28027
UNITED STATES OF AMERICA
PRINTED IN CHINA



The following Lionel marks are used throughout this Owner's Manual and are protected under law. All rights reserved. Lionel®, Ready-to-Play®



IMPORTANT

READ THIS MANUAL before attempting to operate the device.
SAVE THIS MANUAL. This manual contains important operating instructions for this device.

PARTS DETAIL

LOCOMOTIVE

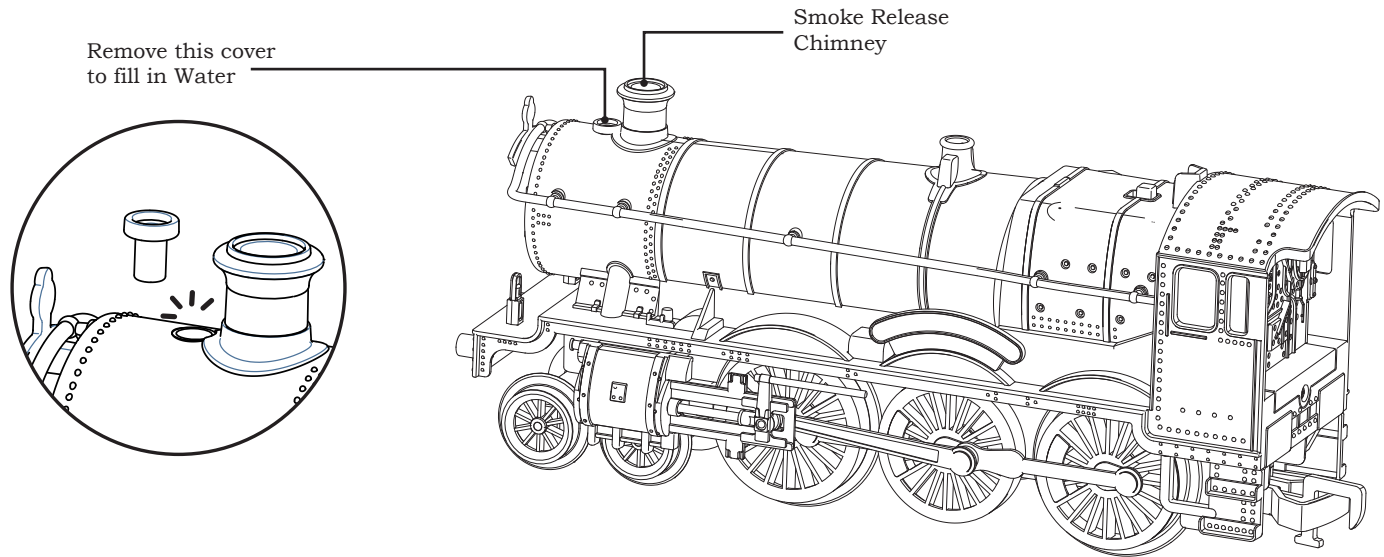

INSTRUCTIONS

1. Turn the Switch on Locomotive to **ON** position, and turn the Switch on Remote Controller to **ON** position. Then the train is ready to go.
2. Please use the dropper that comes with this set to add Water to the Locomotive. Please only add around 6 drops in an empty water container.
DO NOT over fill the water container.
3. Only use this product with clean, room temperature water.
4. Do not use salt water or soapy water.
5. After playing, remove the water cover and put the Locomotive upside-down to remove any remaining water.
6. For better Battery life, turn the Switch on Locomotive to **OFF** position, and turn the Switch on Remote Controller to **OFF** position after play.