

**Medtronic**  
**97745**

50

TUV  
C  
MIL  
US

MR

USA Rx only  
FCC ID: LF597745  
IC:3408D-MPPGR4

CE  
0123

The label features a Medtronic logo at the top left. Below the product name '97745', there are several icons: a '50' in a circle, the TÜV MIL US logo, a person icon, a crossed-out trash can, a wireless signal icon, an information 'i' icon, and an MR icon. At the bottom, there is regulatory information for the USA and a CE mark with the number 0123.

M947531A003

REVISIONS					
REV	DESCRIPTION	ECO NO	DATE	DFG	APVD
A	DOCUMENT RELEASE	12-01808	02MAY12	CEP	CF

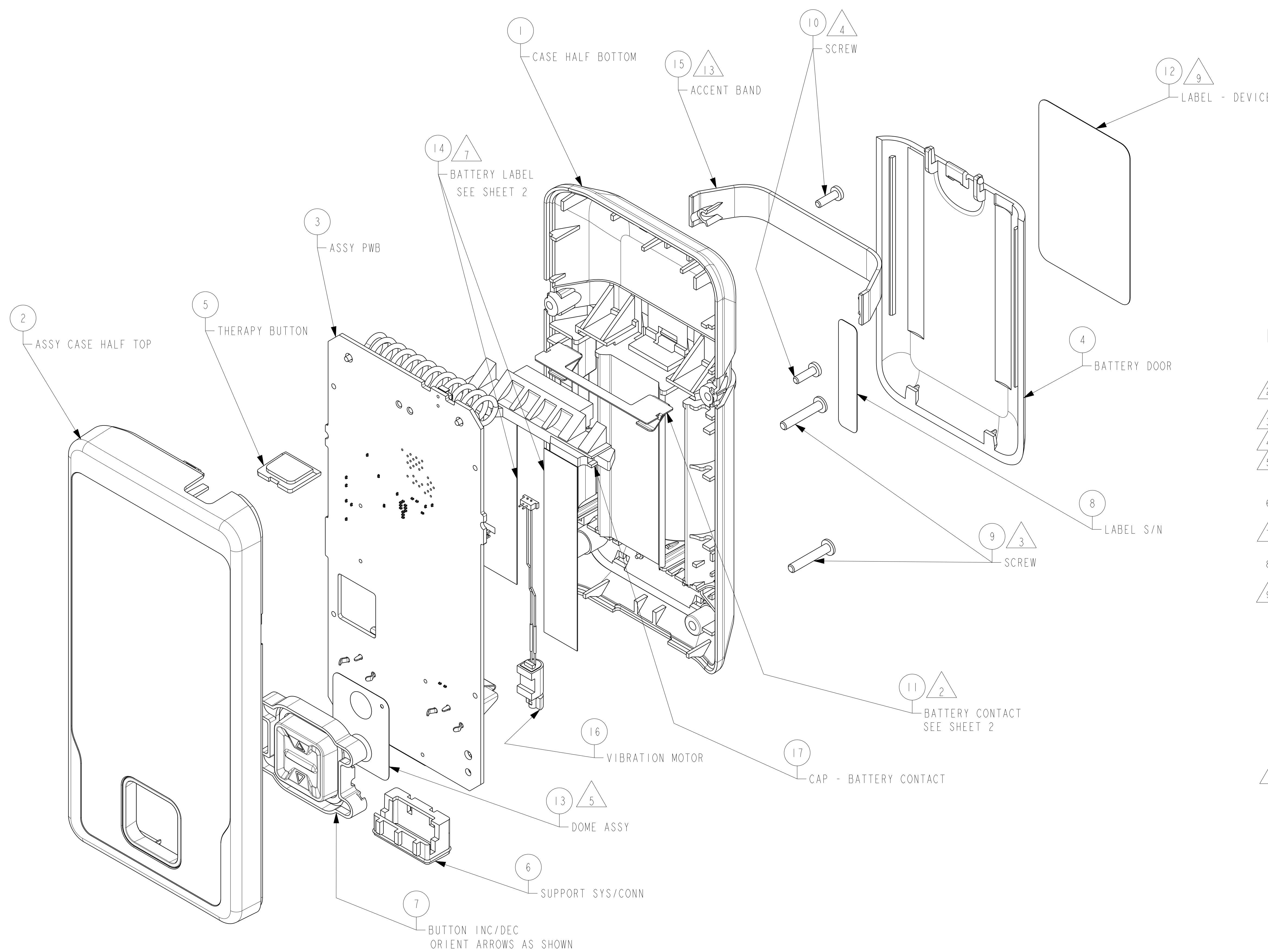

NOTES

- 1 ASSEMBLY SHALL MEET ALL REQUIREMENTS CONTAINED IN THE RELATED ENGINEERING BILL OF DOCUMENTS, BILL OF MATERIALS AND SPECIFICATIONS.
- 2 PRESS-FIT BATTERY CONTACT INTO CASE HALF BOTTOM. BATTERY CONTACT MUST BE FULLY SEATED AGAINST STOPS IN CASE HALF BOTTOM.
- 3 TIGHTEN SCREWS F/N 9 TO 2.00±.05 LB-IN TORQUE.
- 4 TIGHTEN SCREWS F/N 10 TO 1.50±.05 LB-IN TORQUE.
- 5 CLEAN DOME CONTACT AREAS ON PWB WITH ISOPROPYL ALCOHOL PRIOR TO ASSEMBLING DOME SHEET TO PWB. REMOVE DOME SHEET FROM RELEASE LINER AND LOCATE ON PCB WITH PROVIDED TOOLING HOLES.
- 6 LCD FLEX TAIL AND VIBRATOR MOTOR TO BE CONNECTED TO RESPECTIVE RECEPTAL ON PCB.
- 7 LABELS TO BE LOCATED WITHIN SILK SCREEN OUTLINES ON PCB. ORIENTATION TO MATCH SILK SCREEN POLAIRITY INDICATORS
- 8 SERIAL NUMBER / BARCODE LABEL TO BE ADHERED TO RECESS IN CASE BOTTOM ASSEMBLY.
- 9 LABEL TO BE APPLIED TO RECESS IN BATTERY DOOR. ORIENTATION TO BE RIGHT READING, AND SAME DIRECTION AS LOGO ON ACCENT BAND.
- 10 REMOVE ADHESIVE LINER ON ACCENT BAND BEFORE INSTALLING. ACCENT BAND TO BE FULLY SEATED ON CASE HALF BOTTOM.
- 11 A PROTECTIVE FILM SHALL BE PLACED OVER LCD LENS. SUPPLIER LABELS ON THE PROTECTIVE FILM ARE ALLOWED, BUT CANNOT BE PLACED OVER DISPLAY AREA.
- 12 UPON APPROVAL BY MEDTRONIC, INC. OF THE INITIAL DESIGN, ANY PROCESS CHANGES, DESIGN CHANGES OR DEVIATIONS CONSIDERED BY THE MANUFACTURER SHALL BE SUBMITTED TO MEDTRONIC, INC. IN WRITING FOR REVIEW. IF CHANGES ARE SUBMITTED FOR APPROVAL, THE INFORMATION SUBMITTED SHALL INCLUDE A COMPLETE DESCRIPTION OF THE CHANGE AND THE EFFECT THE CHANGE WILL HAVE ON ALL CHARACTERISTICS OF THE DEVICE/MATERIAL. UPON REQUEST, THE MANUFACTURER SHALL SUBMIT SAMPLES OF THE PROPOSED DEVICE/MATERIAL FOR THE EVALUATION AND APPROVAL BY MEDTRONIC, INC.
- 13 CLEAN MATING AREA ON CASE HALF BOTTOM CORRESPONDING TO ADHESIVE AREA ON ACCENT BAND WITH ISOPROPYL ALCOHOL PRIOR TO ASSEMBLY.

<p>MEDTRONIC NEUROMODULATION MINNEAPOLIS, MINNESOTA USA</p> <p>MEDTRONIC CONFIDENTIAL THIS DOCUMENT IS THE PROPERTY OF MEDTRONIC, INC. AND MUST BE ACCOUNTED FOR. INFORMATION HEREON IS CONFIDENTIAL. DO NOT REPRODUCE IT, REVEAL IT TO UNAUTHORIZED PERSONS OR SEND IT OUTSIDE MEDTRONIC WITHOUT PROPER AUTHORIZATION</p>	TITLE		DEVICE ASSEMBLY - PTM, INTELLIS	
	DATE	DO NOT SCALE	DIMENSIONS ARE IN INCHES	
	23MAR12	PRINT	THE CAD DATA FOR THIS PART NUMBER CAN BE MADE AVAILABLE UPON REQUEST	
	DRAFTING			
	ENGINEERING	C. PETERS		
	C. FERRARO			
UNSPECIFIED DRAWING PRACTICES PER ASME Y14.5M, 1994	X.X ± .1	TYPE	FIRST DESIGNED FOR	
	X.XX ± .01	-	MODEL	NEXT ASSY
THIRD ANGLE PROJECTION	X.XXX ± .005	SIZE	DOCUMENT NUMBER	REV SHEET
	X.XXXX ± .0005	D	M951956A	A 1 of 2
	ANGLES ± 1.0°			

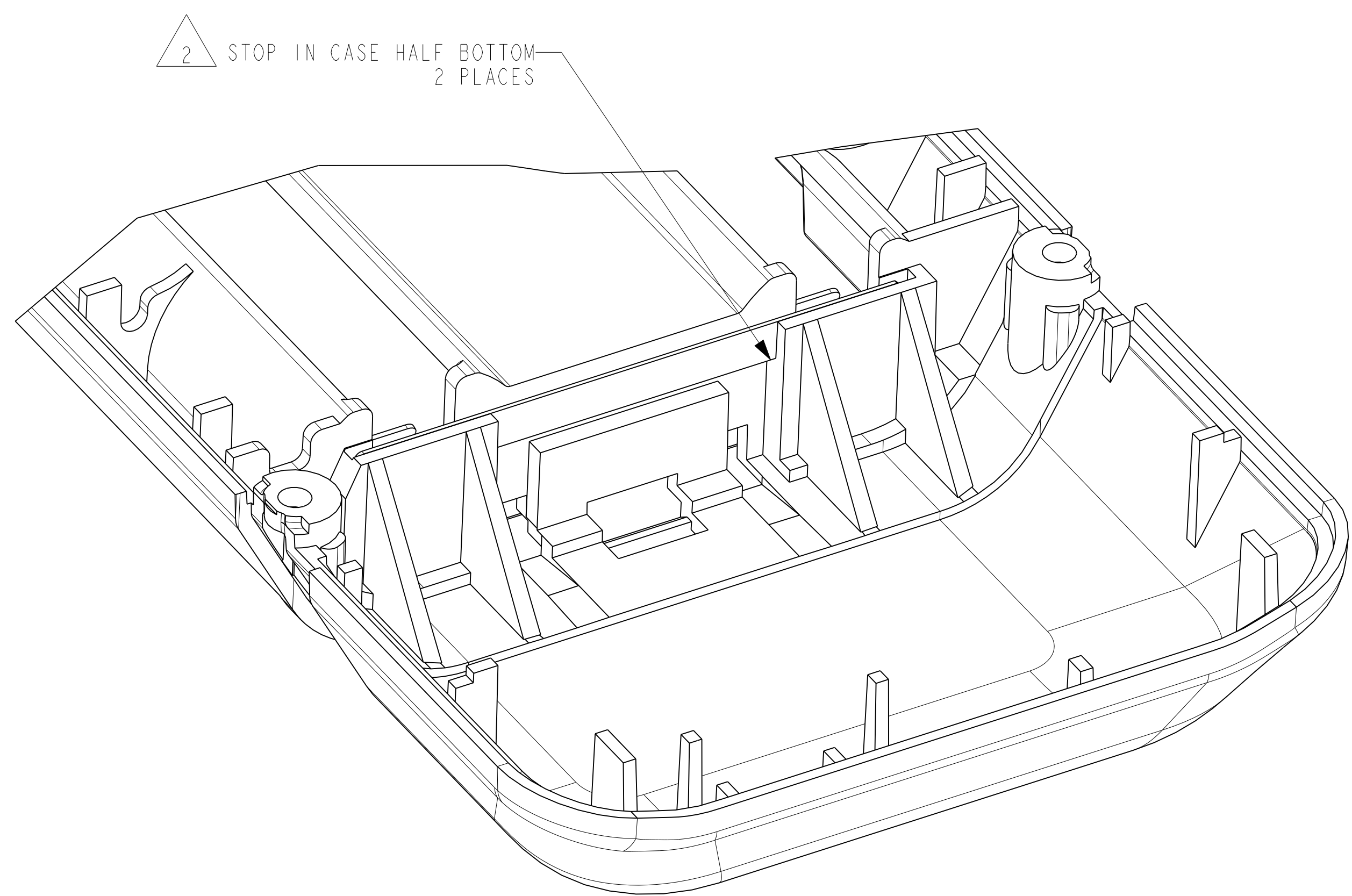

VIEW SHOWN WITH F/N 17 REMOVED  
SCALE 4.000

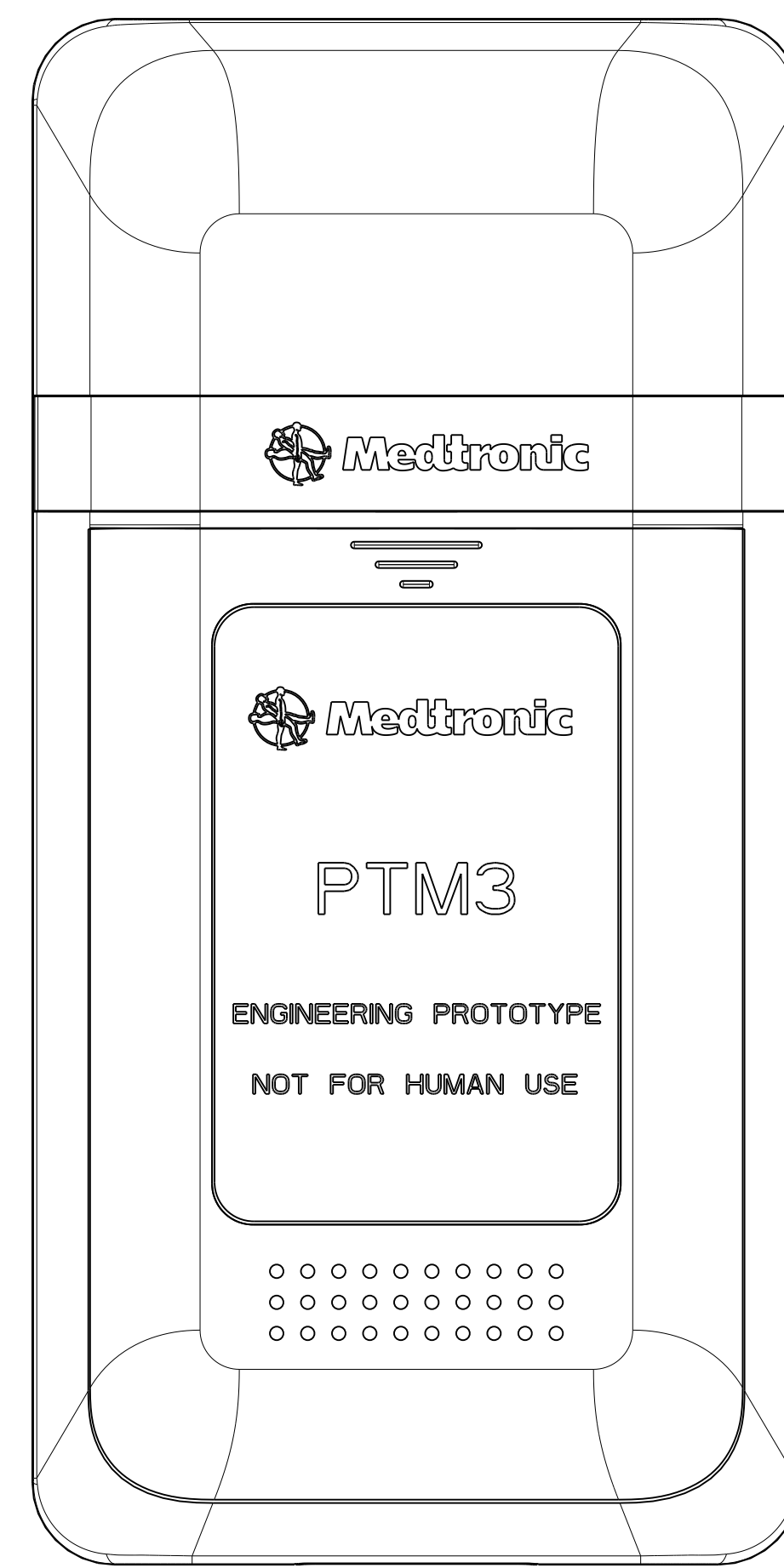

9

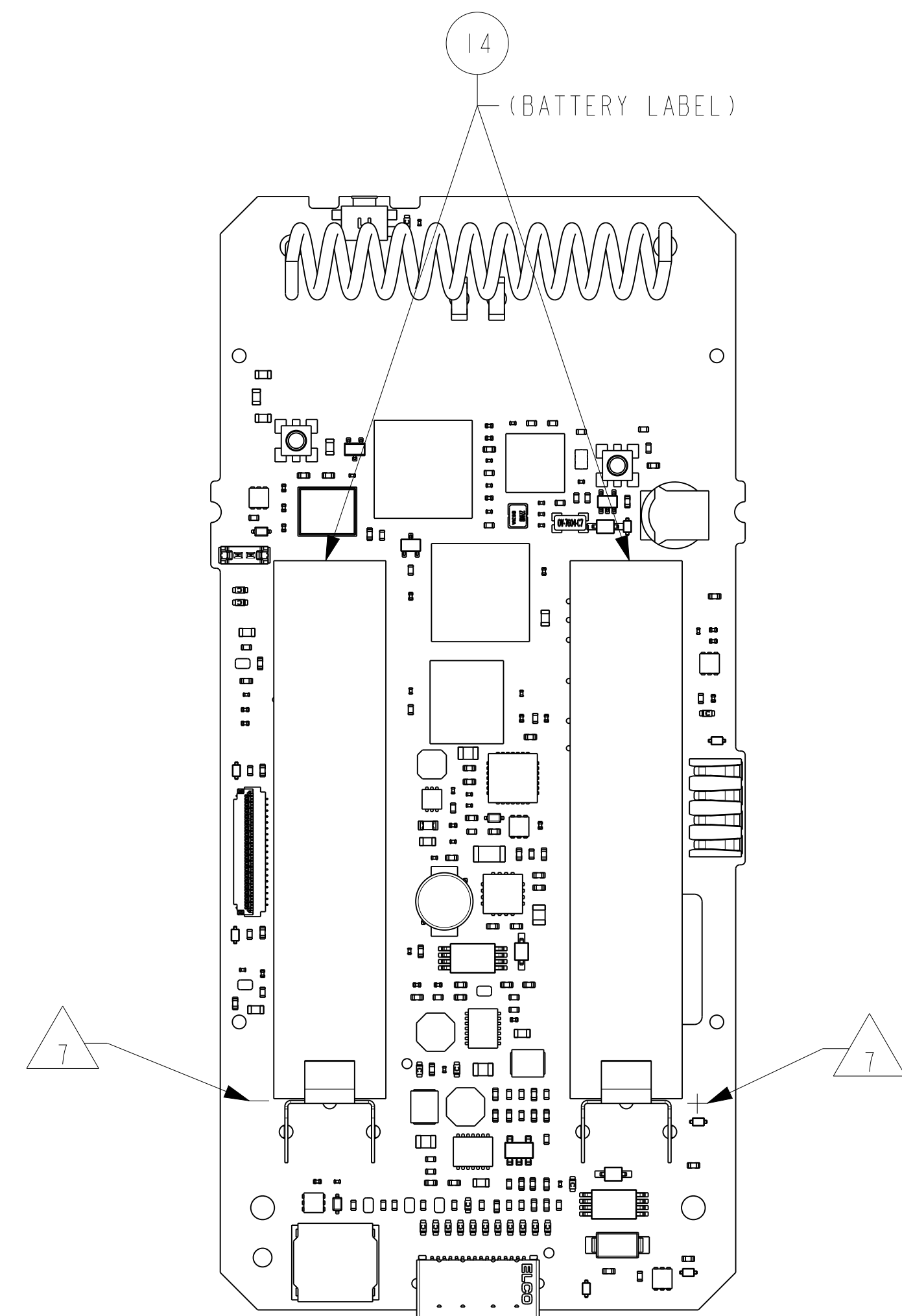

MEDTRONIC CONFIDENTIAL			
SIZE	DOCUMENT NUMBER	REV	SHEET
D	M951956A	A	2 of 2

M951956A

PRO/ENGINEER