

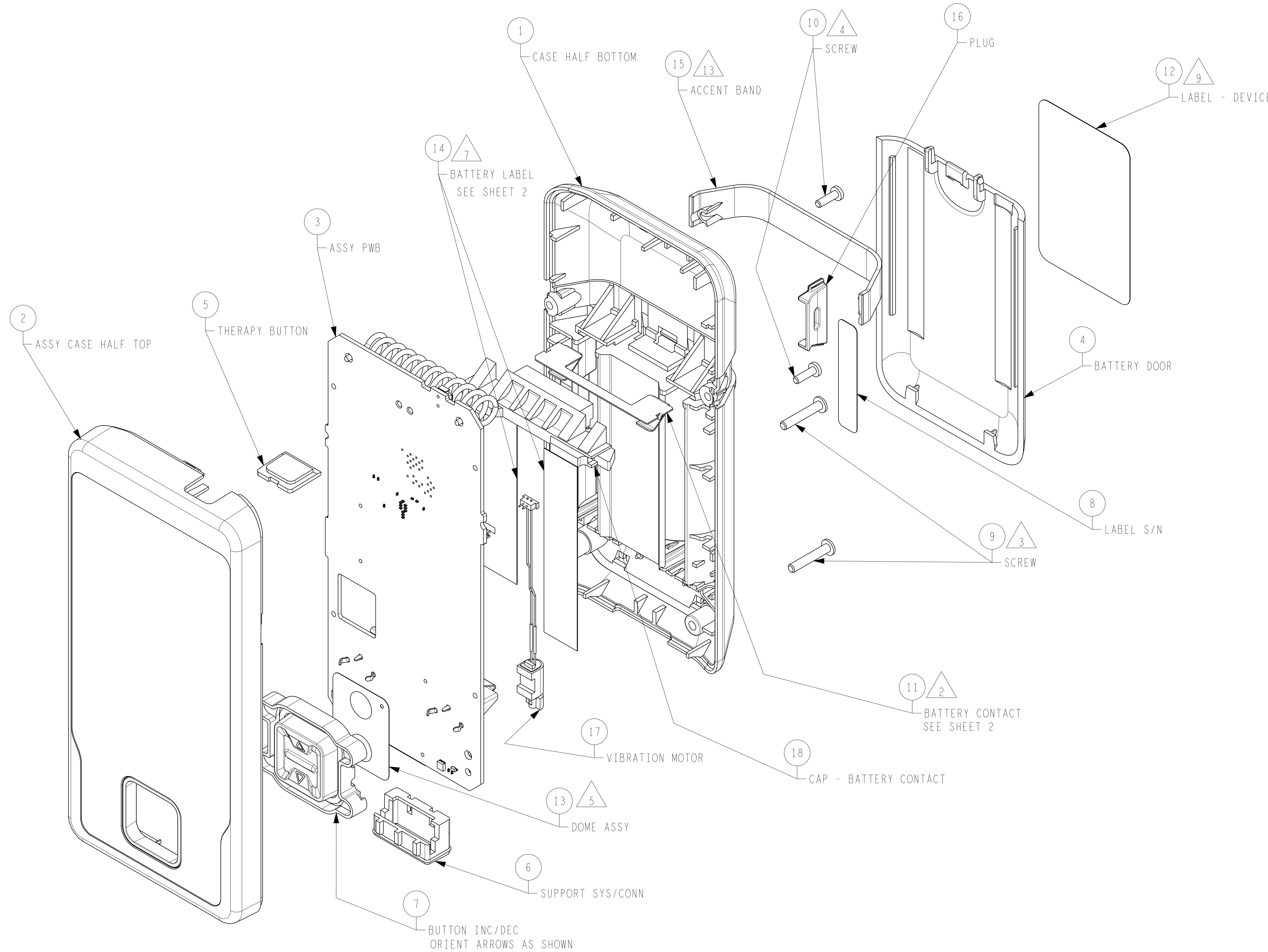

M947531A002

REVISIONS					
REV	DESCRIPTION	ECO NO	DATE	DFG	APVD
A	DOCUMENT RELEASE	11-02726	01JUL11	CEP	DL
B	CHANGED NOTES 3 AND 4	11-05471	17DEC11	CEP	CF
C	CHANGED NOTE 11	12-01881	01MAY12	CEP	CF



NOTES

- ASSEMBLY SHALL MEET ALL REQUIREMENTS CONTAINED IN THE RELATED ENGINEERING BILL OF DOCUMENTS, BILL OF MATERIALS AND SPECIFICATIONS.
- PRESS-FIT BATTERY CONTACT INTO CASE HALF BOTTOM. BATTERY CONTACT MUST BE FULLY SEATED AGAINST STOPS IN CASE HALF BOTTOM.
- TIGHTEN SCREWS F/N 9 TO 2.00±.05 LB-IN TORQUE.
- TIGHTEN SCREWS F/N 10 TO 1.50±.05 LB-IN TORQUE.
- CLEAN DOME CONTACT AREAS ON PWB WITH ISOPROPYL ALCOHOL PRIOR TO ASSEMBLING DOME SHEET TO PWB. REMOVE DOME SHEET FROM RELEASE LINER AND LOCATE ON PCB WITH PROVIDED TOOLING HOLES.
- LCD FLEX TAIL AND VIBRATOR MOTOR TO BE CONNECTED TO RESPECTIVE RECEPTICAL ON PCB.
- LABELS TO BE LOCATED WITHIN SILK SCREEN OUTLINES ON PCB. ORIENTATION TO MATCH SILK SCREEN POLAIRITY INDICATORS
- SERIAL NUMBER / BARCODE LABEL TO BE ADHERED TO RECESS IN CASE BOTTOM ASSEMBLY.
- LABEL TO BE APPLIED TO RECESS IN BATTERY DOOR. ORIENTATION TO BE RIGHT READING, AND SAME DIRECTION AS LOGO ON ACCENT BAND.
- REMOVE ADHESIVE LINER ON ACCENT BAND BEFORE INSTALLING. ACCENT BAND TO BE FULLY SEATED ON CASE HALF BOTTOM.
- A PROTECTIVE FILM SHALL BE PLACED OVER LCD LENS. SUPPLIER LABELS ON THE PROTECTIVE FILM ARE ALLOWED, BUT CANNOT BE PLACED OVER DISPLAY AREA.
- UPON APPROVAL BY MEDTRONIC, INC. OF THE INITIAL DESIGN, ANY PROCESS CHANGES, DESIGN CHANGES OR DEVIATIONS CONSIDERED BY THE MANUFACTURER SHALL BE SUBMITTED TO MEDTRONIC, INC. IN WRITING FOR REVIEW. IF CHANGES ARE SUBMITTED FOR APPROVAL, THE INFORMATION SUBMITTED SHALL INCLUDE A COMPLETE DESCRIPTION OF THE CHANGE AND THE EFFECT THE CHANGE WILL HAVE ON ALL CHARACTERISTICS OF THE DEVICE/MATERIAL. UPON REQUEST, THE MANUFACTURER SHALL SUBMIT SAMPLES OF THE PROPOSED DEVICE/MATERIAL FOR THE EVALUATION AND APPROVAL BY MEDTRONIC, INC.
- CLEAN MATING AREA ON CASE HALF BOTTOM CORRESPONDING TO ADHESIVE AREA ON ACCENT BAND WITH ISOPROPYL ALCOHOL PRIOR TO ASSEMBLY.

 <small>MEDTRONIC NEUROMODULATION MINNEAPOLIS, MINNESOTA USA</small>	TITLE		
	DEVICE ASSEMBLY - PTM3, 8836		
<small>MEDTRONIC CONFIDENTIAL THIS DOCUMENT IS THE PROPERTY OF MEDTRONIC, INC. AND MUST BE ACCOUNTED FOR. INFORMATION HEREON IS CONFIDENTIAL. DO NOT REPRODUCE IT, REVEAL IT TO UNAUTHORIZED PERSONS OR SEND IT OUTSIDE MEDTRONIC WITHOUT PROPER AUTHORIZATION</small>	DATE	DD NOT SCALE	DIMENSIONS ARE IN INCHES
	01APR10	PRINT	
<small>UNSPECIFIED DRAWING PRACTICES PER ASME Y14.5M, 1994</small>	TYPE	FIRST DESIGNED FOR	
	X.X ± .1	MODEL	NEXT ASSY
<small>THIRD ANGLE PROJECTION</small>	SIZE	DOCUMENT NUMBER	REV SHEET
	X.XXX ± .005	M937021A	C 1 of 2
	X.XXXX ± .0005		
	ANGLES ± 1.0°		

8 7 6 5 4 3 2 1

D

D

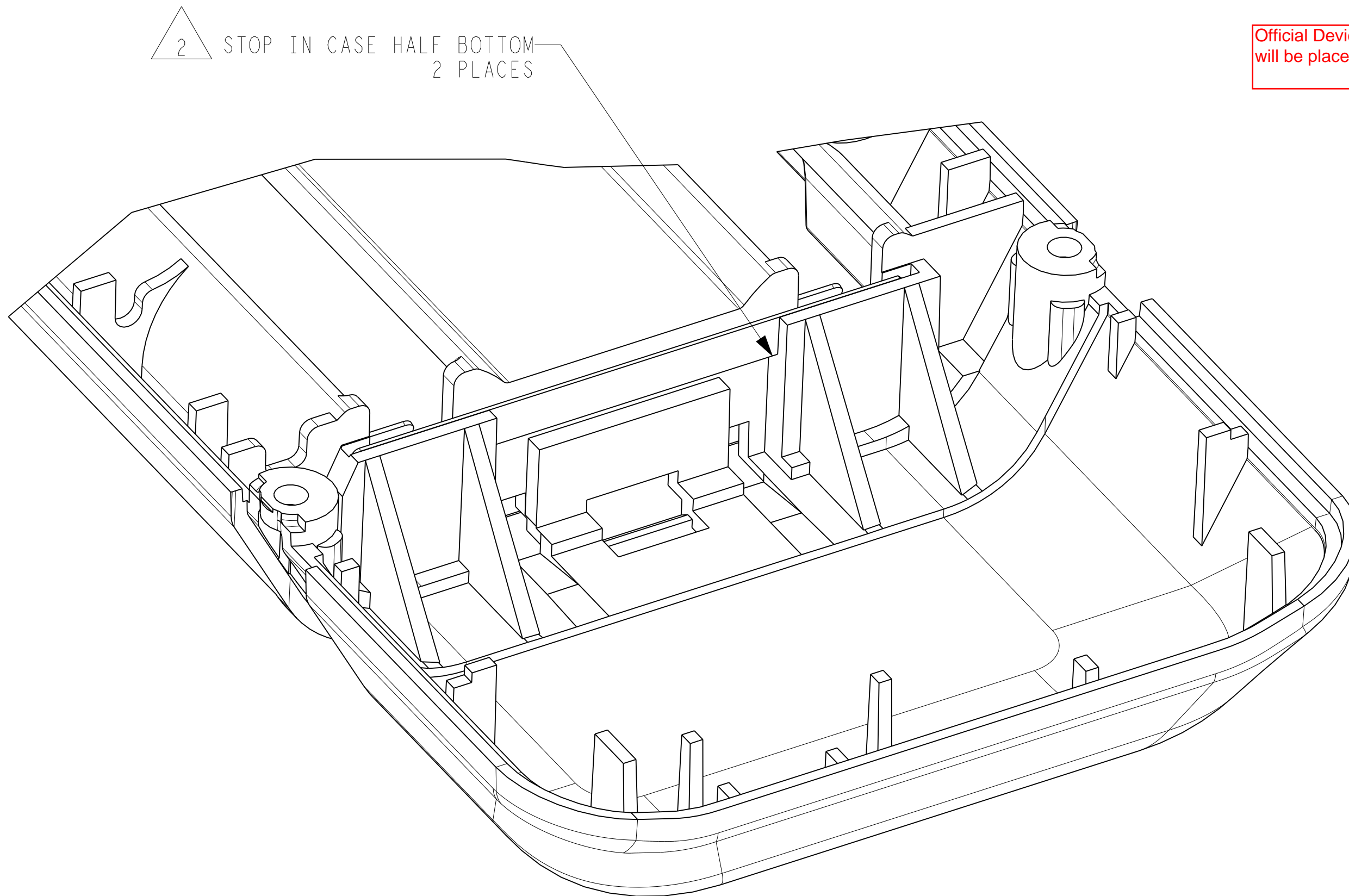

Official Device label  
will be placed here.

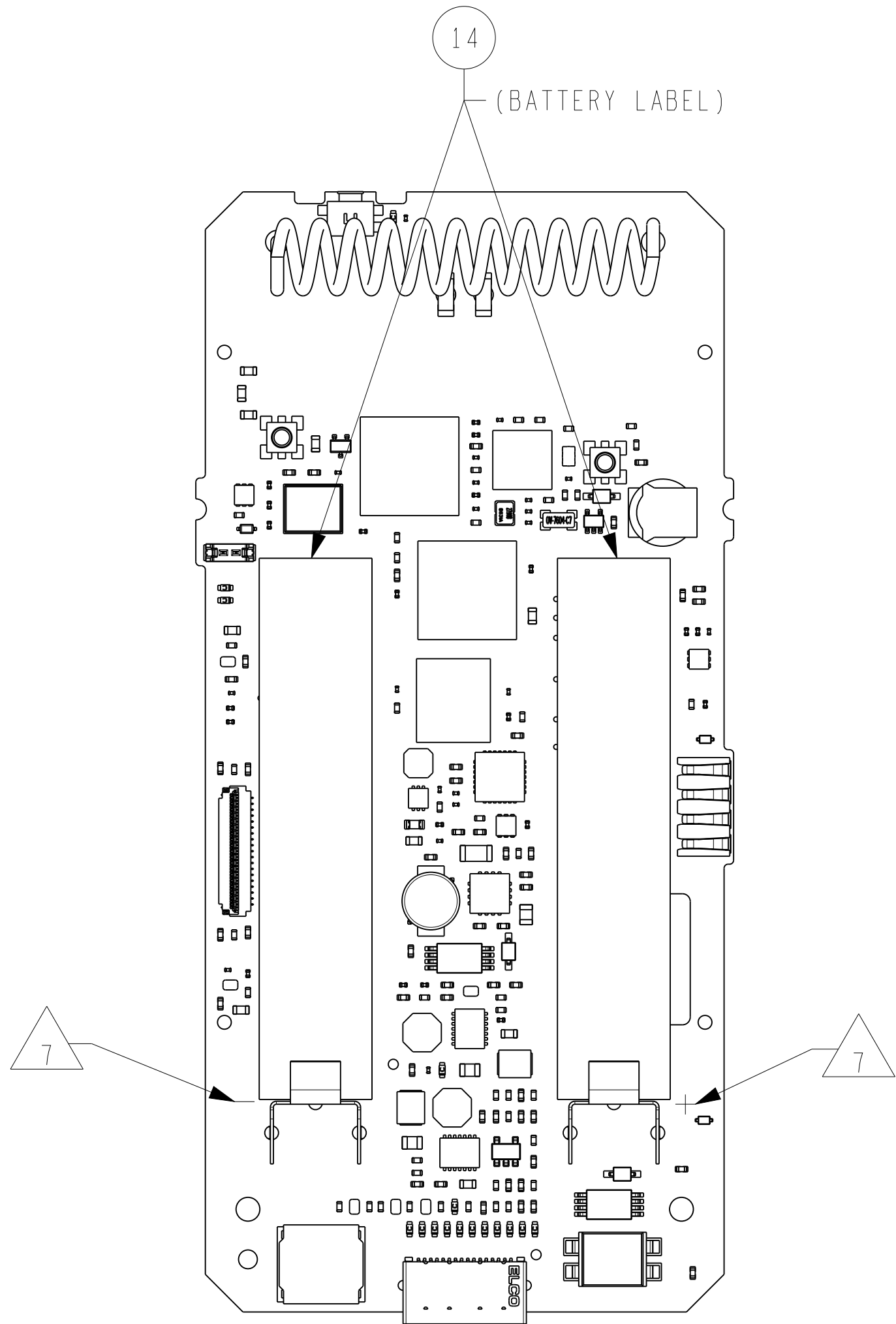
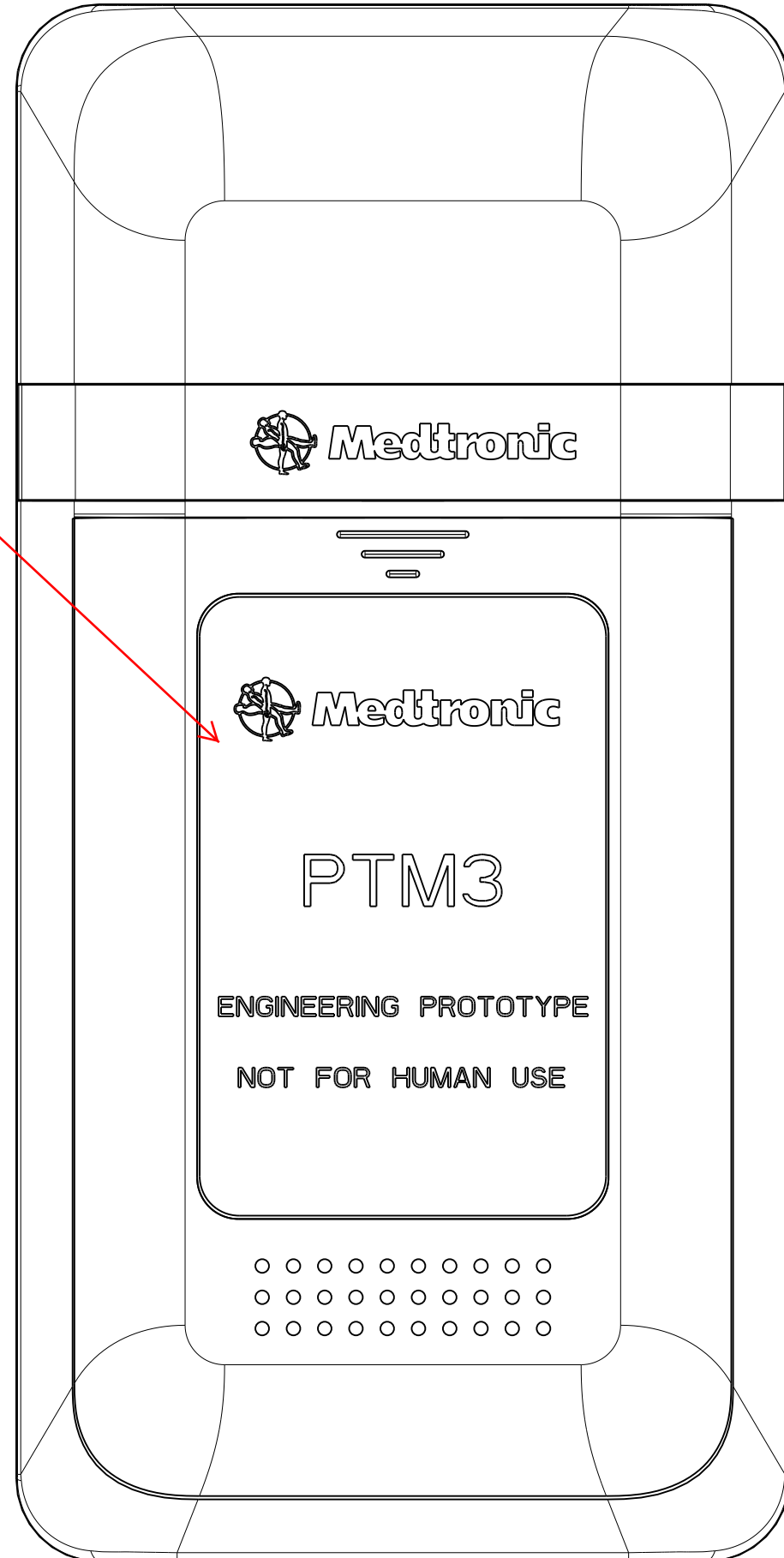

VIEW SHOWN WITH F/N 18 REMOVED  
SCALE 4.000

9

7

7

C

C

B

B

A

A

8 7 6 5 4 3 2 1

MEDTRONIC CONFIDENTIAL			
SIZE	DOCUMENT NUMBER	REV	SHEET
D	M937021A	C	2 of 2

M937021A

PRO/ENGINEER