



# ARTWORK - 100%POD

PART No: 47-109007-01 REV.A0
ARTWORK No: 56-107437-01 REV.A0
DWG: 471-100200-01 Rev.A0(BLANK LBL POD)
CUSTOM NAME: Jeff H
ARTWORK PROOF: #1

SCALE 1:1

Model: IW9165E-B  
 Input: 24-48V $\overline{\text{=}}$ , 0.9A-0.4A  
 PoE in: 42.5-57V $\overline{\text{=}}$ , 0.5A-0.4A  
 -40°C ≤ Ta ≤ 70°C

**FC**

This device complies with Part 15 of the FCC Rules. Operation is subject to the following two conditions:  
 (1) this device may not cause harmful interference, and  
 (2) this device must accept any interference received, including interference that may cause undesired operation.

FCC ID: LDKIW9165E

**UL** LISTED E145532

<http://cisco-returns.com>  
 Cisco Systems, Inc.  
 170 West Tasman Drive  
 San Jose, CA 95134 USA

47-109007-01\_A0

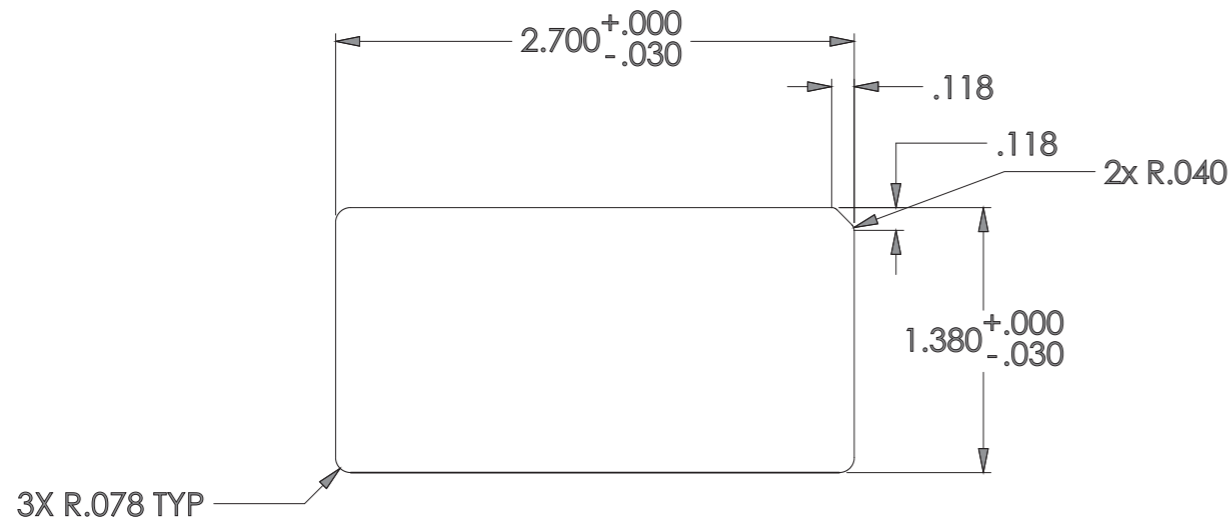

200% FOR CLARITY

Model: IW9165E-B  
 Input: 24-48V $\overline{\text{=}}$ , 0.9A-0.4A  
 PoE in: 42.5-57V $\overline{\text{=}}$ , 0.5A-0.4A  
 -40°C ≤ Ta ≤ 70°C

**FC**

This device complies with Part 15 of the FCC Rules. Operation is subject to the following two conditions:  
 (1) this device may not cause harmful interference, and  
 (2) this device must accept any interference received, including interference that may cause undesired operation.

FCC ID: LDKIW9165E

**UL** LISTED E145532

<http://cisco-returns.com>  
 Cisco Systems, Inc.  
 170 West Tasman Drive  
 San Jose, CA 95134 USA

47-109007-01\_A0

**NOTES:**

A) Material 345T-J1 SILVER (CCL)  
 Mat Ref:  
 Laminate: N/A  
 Ribbon: DBS4000 (BLACK)

B) COLORS	C) FONTS
1)	
2)	
3)	
4)	

**IMPORTANT**

DELIVERY TIME CAN ONLY BE MET WITH YOUR COOPERATION. PLEASE ENSURE THE ARTWORK PROOF IS CHECKED CAREFULLY FOR LAYOUT, WORDING, SPELLING, SIZE, COLOR, ETC., THEN, RETURNED WITHIN 24 HOURS, TO ENSURE DELIVERY SCHEDULES ARE MET. THE COLORS DISPLAYED ON THIS PROOF MAY NOT BE ACCURATE; REFER TO PMS OR CISCO COLOR BOOK REFERENCES STATED FOR TRUE REPRESENTATION.

LABEL FINISHED COPY:

LABELS/TILE:  
 TILES/PACK: Roll do not exceed 8" diameter  
 LABELS/PACK: Roll form  
 Matrix Strip:  Y  N

**Please check the following: Layout, Text (Graphics), Color callout(s), Dimensions**

Approved     Changes noted - second proof required (indicate changes)

Signature: \_\_\_\_\_ Date \_\_\_\_\_

Dimensions are shown in imperial (inches) Tolerances unless otherwise specified are:			
Dimensions Tolerance:	± 0.011" ± 0.30 mm		
P2C Tolerance:	± 0.011" ± 0.30 mm		
POD Tolerance:	± 0.060" ± 1.50 mm		
UNIT: MM			
SCALE: 1:1	SHEET: 1 of 1	ORIGINATION Naymik	CHECK BY DATE 7/13/23

CCL REF. No.	Rev.	Description	ECN