

--REVISION--				
REV	DESCRIPTION	ECN	APPROVE	
			MECH	MFG
01	PRELIMINARY RELEASE	Exxxxxx	TPS	
02	UPDATED	3/5/14	TS	
03	UPDATED TORQUE LEVELS	3/24	TS	
04	ADDED LABELS AND INSUL.	5/20	TS	

20 TORQUE 72-84 IN-LBS

4X 12
4X 11
4X 21 TORQUE 72-84 IN-LBS
TORQUE TO 1/2 FINAL VALUE THEN REPEAT SEQUENCE TO FULL VALUE

VENT PORT (ITEM 16) USED FOR PRESSURE TESTING AT COMPLETION OF ASSEMBLY, THE UNIT WILL NEED TO BE VERIFIED FOR PRESSURE SUSTAINABILITY. THE PROCEDURE IS AS FOLLOWS;

1. USE "VENT" PORT TO PRESSURIZE UNIT
2. PRESSURIZE UNIT TO 5 ±0.2 PSI
3. UNIT MUST NOT SHOW ANY PRESSURE DROP IN 15 SECONDS.
4. IF UNIT DOES NOT PASS PRESSURE TEST, ISOLATE SOURCE OF LEAKAGE AND DOCUMENT. THEN VERIFY THAT GASKET IS IN PLACE AT LEAKAGE SOURCE AND IF APPLICABLE THE PLUG OR SCREWS HAS/HAVE SUFFICIENT TORQUE.
5. INSTALL VENT (ITEM 6) TORQUE TO 5-7 IN-LB

ASSEMBLY SEQUENCE;

1. ATTACH COVER (ITEM 6) TO CHASSIS ASSEMBLY USING 4X M8 BOLTS AND WASHERS. FOLLOW TORQUE SEQUENCE SHOWN
2. PG13.5 PLUG (ITEM 20)
3. ATTACH ORING (ITEM 14) TO LIGHTPIPE (ITEM 13), CAREFULLY THREAD INTO CHASSIS, TOP OF LIGHTPIPE SHOULD BE FLUSH TO SLIGHTLY RECESSED WHEN FULLY INSTALLED
4. ATTACH LABELS AS SHOWN
5. INSTALL VENT (ITEM 16) AFTER PRESSURE TEST.

13 TORQUE 3-3.5 IN-LBS
ENSURE THAT O-RING IS FULLY SEATED

NOTES: (UNLESS OTHERWISE SPECIFIED)

1. THIS IS A COMPUTER GENERATED DOCUMENT. ALL CHANGES MUST BE MADE IN THE MASTER DATABASE ONLY.
2. SHEET DESCRIPTIONS:
SHT 1: COVER AND LABEL ATTACH
SHT 2: CHASSIS PREPERATION
SHT 3: MOTHERBOARD AND INTERFACE CARD INSTALLATION
SHT 4: MOTHERBOARD HEATSINK INSTALLATION
SHT 5: POWER SUPPLY INSTALLATION
SHT 6: BBU INSTALLATION
SHT 7: RF CABLE CONFIGURATION
3. SEE APPROPRIATE BOM 68-5314-XX (1 RF PORT) OR 68-5321-XX (2 RF PORTS) FOR ITEM NUMBERS.
4. SHALL MEET MECHANICAL ACCEPTANCE SPEC 95-0669-XX, CLASS C.

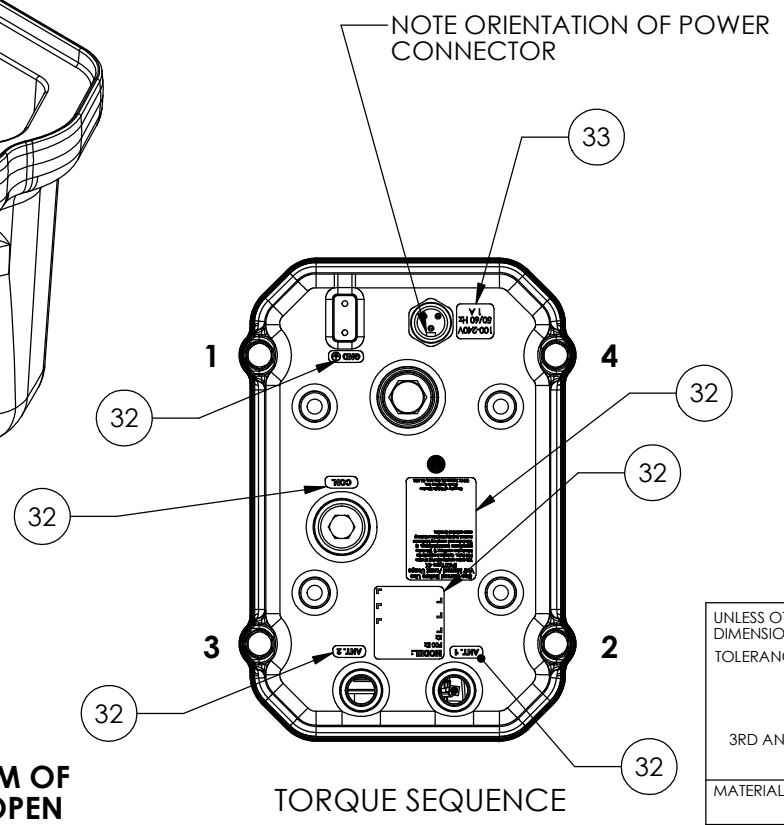

WARNING !
IF UNIT NEEDS TO BE OPENED, WAIT A MINIMUM OF 5 MINUTES AFTER REMOVING AC POWER TO OPEN

UNLESS OTHERWISE SPECIFIED DIMENSIONS ARE IN INCHES: TOLERANCES: X.X = ±.030 X.XX = ±.015 X.XXX = ±.005 ANGULAR = ± 0°30'		THIS DRAWING CONTAINS INFORMATION WHICH IS THE PROPRIETARY PROPERTY OF CISCO SYSTEMS. THIS DRAWING IS CONFIDENTIAL AND ITS CONTENTS MAY NOT BE DISCLOSED WITHOUT PRIOR WRITTEN CONSENT OF CISCO SYSTEMS.			
3RD ANGLE PROJECTION		APPROVAL	DATE	REFDWG, FINAL, ASSY ADVANCED, BR-RE	
MATERIAL:	DES:				
FINISH:	ENG: T. Spivey	1/27/14		SIZE DWG NO.	REV
	MFG:			B 62-26779-01	04
DO NOT SCALE DRAWING		SCALE: 1:1	MODEL FILE: 62-26779-XX	SHT 1 OF 7	CAD TYPE: SOLIDWORKS