

# RTS

RIM Testing Services  
ID Label Location

FCC ID: L6ARBQ40GW

IC: 2503A-RBQ40GW

Model: RBQ41GW

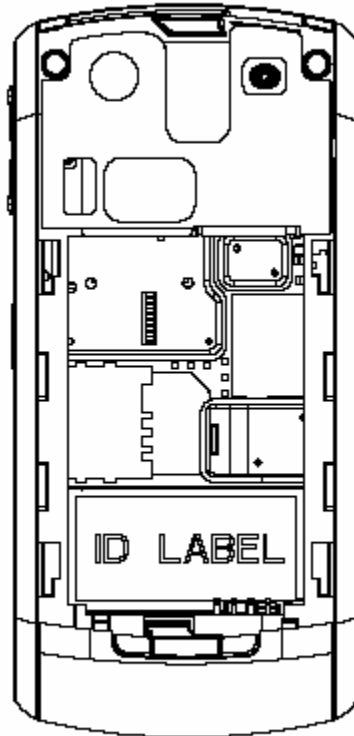

---

This report shall NOT be reproduced except in full without the written consent of RIM Testing Services (RTS)

A division of Research In Motion Limited.

Copyright 2005-2007

Page 1 of 1

# RTS

RIM Testing Services  
ID Label Artwork

FCC ID: L6ARBQ40GW

IC: 2503A-RBQ40GW

Model: RBQ41GW

PRD-XXXXX-XXX RBQ41GW  
BlackBerry XXXX  
IC: 2503A-RBQ40GW  
FCC ID: L6ARBQ40GW  
BT MAC:XX XX XX XX XX XX  
Patents: [www.rim.net/patents](http://www.rim.net/patents)  
IMEI:123456789012345

 **CE0168**  
 **I.T.E. US LISTED 89NN**  
  
DMY  
PIN: ABCDEFAB  
Made In XXXXXX



This report shall NOT be reproduced except in full without the written consent of RIM Testing Services (RTS)

A division of Research In Motion Limited.

Copyright 2005-2007

Page 1 of 1