



**SONY**<sup>®</sup>

3-864-804-11 (1)

# *Digital Portable Cellular Telephone*

---

Operating Instructions



D · W A V E  
**Zuma**

*CM-Z200*



# Welcome to the CM-Z200

## Menu map

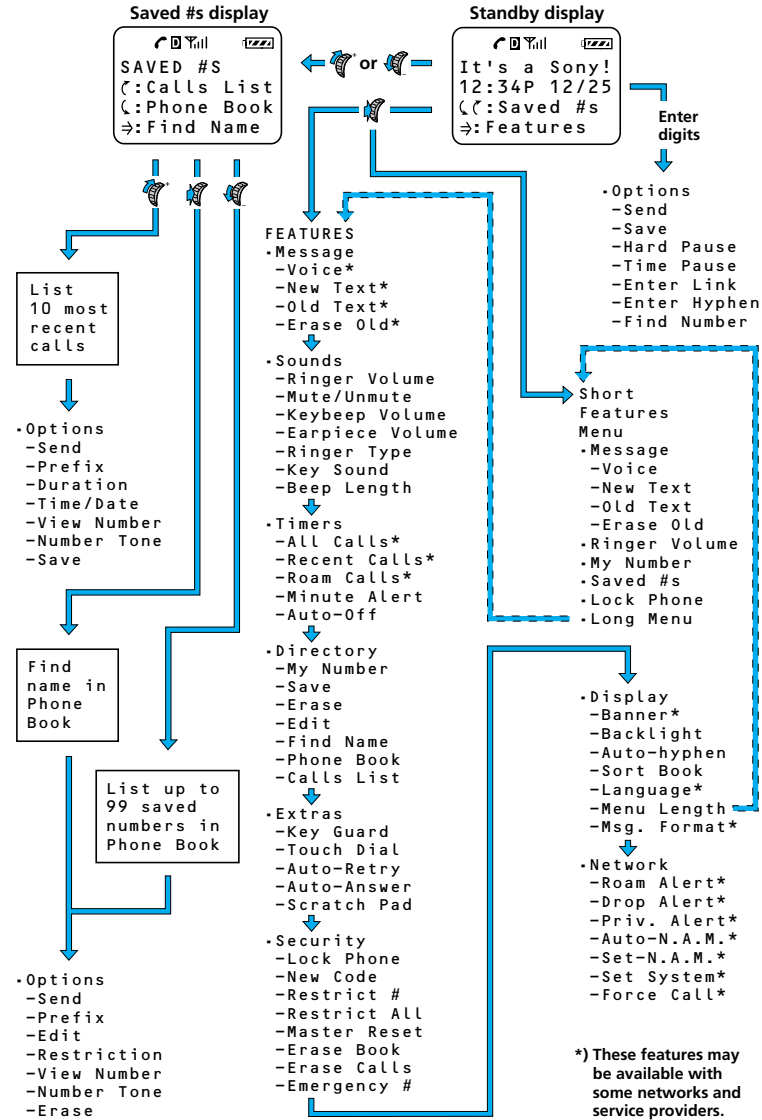

## 1.2



### Easy dialing

You can easily make a call using a number from the Phone Book or the Calls List. First, turn the Jog Dial either up or down one time to search phone numbers. Then scroll down to view saved numbers in the Phone Book or scroll up to view your most recently called numbers in the Calls List. Simply open the arm microphone to call the number you choose.

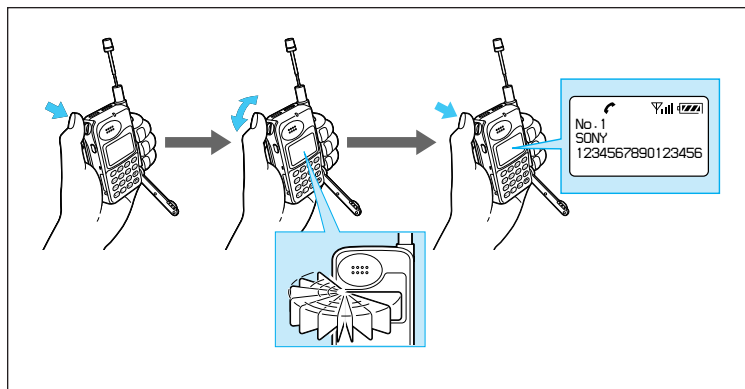

### Easy menu access

You can easily access your phone's settings through the Features menu. Press the Jog Dial again to view the options of each menu item.

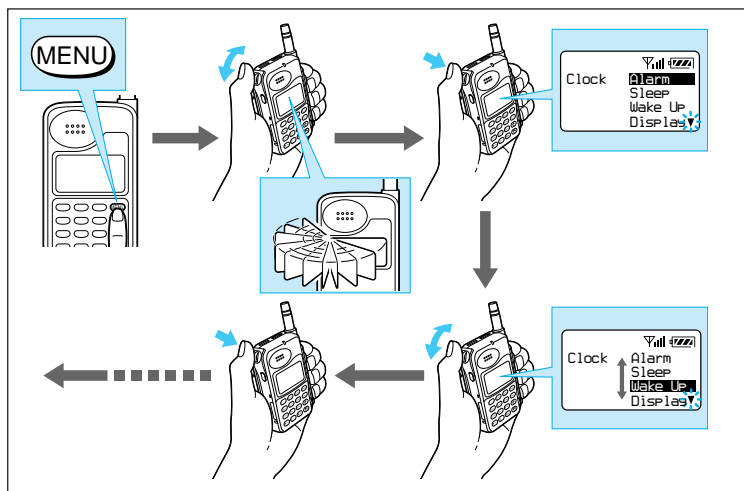

1.3



Before operating the CM-Z200 portable cellular/PCS telephone, please read this manual thoroughly and retain it for future reference. If your usage includes in-vehicle operation, it is recommended that you refer to the Installation/Connections/Operation manual for the optional accessory kits.

**DISPOSAL OF LITHIUM ION BATTERY**

LITHIUM ION BATTERY. DISPOSE OF PROPERLY.

You can return your unwanted lithium ion batteries to your nearest Sony Service Center or Factory Service Center.

**Note:** In some areas the disposal of lithium ion batteries in household or business trash may be prohibited.

For the Sony Service Center nearest you call 1-800-222-SONY (United States only).  
For the Sony Factory Service Center nearest you call 416-499-SONY (Canada only).



**WARNING**

To prevent fire or shock hazard, do not expose the unit to rain or moisture.  
To avoid electrical shock, do not open the cabinet. Refer servicing to qualified personnel only.

**FCC CAUTION STATEMENT**

You are cautioned that any changes or modifications not expressly approved in this manual could void your authority to operate this equipment.

**Owner's record**

The model number, regulatory number, and serial number are located on a nameplate inside the battery compartment. Record the serial number in the space provided below. Refer to these numbers whenever you call your dealer regarding this product.

Model No.: CM-Z200                      Serial No.: \_\_\_\_\_

**1.4**





# Table of contents

Rules and regulations .....	1.6
Safety precautions .....	1.7
<b>Getting Started</b>	
Unpacking your phone .....	2.1
Looking at your phone .....	2.2
Charging the battery pack .....	2.4
<b>Basic Calling Operations</b>	
Turning the phone on .....	3.1
Making calls .....	3.2
Receiving calls .....	3.3
<b>Advanced Calling Operations</b>	
Storing phone numbers in the Phone Book .....	4.1
Calling from the Phone Book .....	4.6
Searching the Phone Book .....	4.8
Calling from the Calls List .....	4.10
Sending DTMF signals from the Phone Book .....	4.11
<b>Features Menu</b>	
About the Features menu .....	5.1
Messages .....	5.2
Sounds .....	5.7
Timers .....	5.10
Directory .....	5.12
Extras .....	5.16
Security .....	5.18
Display .....	5.22
Network .....	5.25
<b>Additional Information</b>	
Troubleshooting .....	6.1
Accessories .....	6.2
Specifications .....	6.3
List of menu items .....	6.4
Glossary .....	6.6
Index .....	6.8

Getting Started

Basic Calling Operations

Advanced Calling Operations

Features Menu

Additional Information





## Rules and regulations

The U.S. Federal Communications Commission and the Industry Canada regulate cellular/PCS telephone service in their respective countries. It is important for you, the cellular/PCS telephone user, to observe the applicable regulations when operating your cellular/PCS telephone in either country. In addition to these U.S. and Canadian federal regulations, you may be bound also by certain state, provincial, territorial, and local rules and regulations, as well as by your cellular/PCS carrier's tariff (the rates, terms, and conditions of its service). If you wish to use your cellular/PCS telephone in both the U.S. and Canada, please consult with your System Operator.

Furthermore, you should remember that your cellular/PCS telephone is a *radiotelephone*, — i.e., it combines both wireline technology, as used in your home or office telephone system, *and* radio technology — and that the scope of regulations and precautions is therefore broader than the scope of regulations and precautions relating to wireline-only telephone usage.

Some of the major points of consideration are set out below. Please note, however, that these "Rules and Regulations" and "Safety Precautions" sections do not constitute legal advice, and are intended merely for general information purposes. If you have specific questions, please contact your cellular/PCS carrier (System Operator).

**License** — If your home system is in the U.S., you do not require a separate license to operate your cellular/PCS telephone; obtaining a cellular/PCS telephone access number is sufficient to register you as a user. If your home system is in Canada, a separate license is required; your carrier will assist you

in the licensing process. If you wish to use your cellular/PCS telephone on both sides of the border, please contact your cellular/PCS carrier (System Operator).

**Equipment modifications** — The U.S. Federal Communications Commission has type-approved the model of cellular/PCS telephone which you have purchased, and has allocated a specific frequency range for cellular/PCS service. No changes or adjustments are to be made to your cellular/PCS telephone.

The radio equipment shall be made available for inspection upon request by representatives of the FCC or licensees.

**Denial of service** — A cellular/PCS carrier may deny service temporarily or terminate service for violation of any government regulations or violation of its tariff.

**Privacy** — As a telephone user, you have come to assume a certain standard of privacy when you place or receive a telephone call via the traditional wireline systems. However, because cellular/PCS telephones utilize radio transmissions to effect calls, the same standard cannot always be assured. While it is unlawful for any unauthorized person to divulge or use any information obtained from intercepting or "listening in on" conversations intended for others, you should not assume that your conversation is completely secure. Commercially available scanning equipment can permit a third party to monitor the radio channels used for cellular/PCS telephone calls.

**Interference** — No person shall interfere with, or cause interference to, any radio communication or signal.

### 1.6



## Safety precautions

### IMPORTANT

#### For safe and efficient operation of your phone, observe these guidelines.

Your dual mode (analog/digital CDMA) hand-held portable cellular/PCS telephone uses both analog frequency modulation (FM) technology and digital Code Division Multiple Access (CDMA) technology. CDMA is a newer radio frequency (RF) technology than the FM technology that has been used for radio communications for decades.

Your dual mode portable cellular/PCS telephone is a radio transmitter and receiver. When the phone is ON, it receives and sends out radio frequency (RF) energy. The phone operates in the frequency range of 824 MHz to 894 MHz. When you use your phone, the cellular/PCS system handling your call controls the mode of operation (analog or digital CDMA) and the power level at which your phone transmits. In the analog mode, the power is continuously transmitted at a level that can range from about 6 mW to about 600 mW. In the digital CDMA mode, the power is transmitted as a digitally coded waveform at a rate varying from 100 Hz to 800 Hz. The average power can range from about 0.01  $\mu$ W to about 300 mW.

#### Exposure to radio frequency energy

Research on health effects from RF energy has focused for many years on FM radio technology. That research and studies regarding newer radio technologies, such as CDMA, have found no credible scientific evidence that adverse health effects result from the use of cellular/PCS telephones.

The Institute of Electrical and Electronics Engineers (IEEE) in 1991, and The American National Standards Institute (ANSI) in 1992, updated the 1982 ANSI Standard for safety levels with respect to human exposure to RF energy. Over 120 scientists, engineers, and physicians from universities, government health agencies, and industry, reviewed the available research and developed this updated Standard. In March 1993, the U.S. Federal Communications Commission (FCC) proposed the adoption of this updated Standard.

The design of your phone complies with this updated Standard. Of course, if you want to limit RF exposure even further than the updated ANSI Standard, you may choose to control the duration of your calls and operate your phone in the most power efficient manner.

#### Efficient phone operation

For your phone to operate at the lowest power level consistent with satisfactory call quality, please observe the following guidelines:

Your phone has an extendable antenna; extend it fully whenever possible for maximum efficiency.

Hold the phone as you would any other telephone. While speaking directly into the mouthpiece, position the antenna up and over your shoulder.

Do not hold the antenna when the phone is in use. Holding the antenna affects call quality and may cause the phone to operate at a higher power level than needed.



### Antenna care and replacement

Do not use the phone with a damaged antenna. If a damaged antenna comes into contact with the skin, a minor burn may result. Replace a damaged antenna immediately. Take your phone to an authorized service center for repair.

Use only the supplied or approved antenna. Unauthorized antennas, modifications, or attachments could impair call quality, damage the phone, and violate FCC regulations.

### Driving

Check the laws and regulations on the use of cellular/PCS telephones in the areas where you drive. Always obey them. Also, when using your phone while driving, please:

- pay full attention to driving;
- use hands-free operation, if available;
- pull off the road and park before making or answering a call, if driving conditions so require.

### Electronic devices

Most modern electronic equipment is shielded from RF energy. However, RF energy from cellular/PCS telephones may affect some electronic equipment.

RF energy may affect improperly installed or inadequately shielded electronic operating and entertainment systems in motor vehicles. Check with the manufacturer or its representative to determine if these systems are adequately shielded from external RF energy. You should also check with the manufacturer of any equipment that has been added to your vehicle.

### Medical devices

Consult the manufacturer of any personal medical devices (such as pacemakers, hearing aids, etc.) to determine if they are adequately shielded from external RF energy. Your physician may be able to assist you in obtaining this information.

Turn your phone OFF in health care facilities when regulations posted in the areas instruct you to do so. Hospitals or health care facilities may be using equipment that could be sensitive to external RF energy.

### Aircraft

Turn your phone OFF before boarding any aircraft.

- Use it on the ground only with crew permission.
- Do not use in the air.

To prevent possible interference with aircraft systems, U.S. Federal Aviation Administration (FAA) regulations require you to have permission from a crew member to use your phone while the plane is on the ground. To prevent interference with aircraft communication systems, FCC regulations prohibit using your phone while the plane is in the air.

### Children

Do not allow children to play with your phone. It is not a toy. Children could hurt themselves or others (by poking themselves or others in the eye with the antenna, for example). Children also could damage the phone or make calls that increase your telephone bill.



## 1.8







### **Blasting areas**

To avoid interfering with blasting operations, turn your unit OFF when in a "blasting area" or in areas posted: "Turn off two-way radio." Construction crews often use remote control RF devices to set off explosives.

### **Potentially explosive atmospheres**

Turn your phone OFF when in any area with a potentially explosive atmosphere. It is rare, but your phone or its accessories could generate sparks. Sparks in such areas could cause an explosion or fire resulting in bodily injury or even death.

Areas with a potentially explosive atmosphere are often, but not always, clearly marked. They include fueling areas such as gas stations; below deck on boats; fuel or chemical transfer or storage facilities; areas where the air contains chemicals or particles, such as grain, dust, or metal powders; and any other area where you would normally be advised to turn off your vehicle's engine.

Do not transport or store flammable gas, liquid, or explosives in the compartment of your vehicle which contains your phone or accessories.

In the United States, vehicles using liquefied petroleum gas (such as propane or butane) must comply with the National Fire Protection Standard (NFPA-58). For a copy of this standard, contact the National Fire Protection Association, One Batterymarch Park, Quincy, MA 02269, Attn: Publication Sales Division.

In Canada, vehicles using liquefied petroleum gas (such as propane or butane) must comply with the Canadian Gas Association (CAN/CGS-B149.2). For a copy of this standard, contact the Canadian Standards Association, 178 Rexdale Blvd., Etobicoke, ON M9W 1R3, Attn.: Standard Sales Department.





**(this page intentionally left blank)**





# Unpacking your phone

Carefully unpack your phone and check the contents using this list. If there is something missing, please contact your nearest Sony dealer.

Getting Started

CM-Z200 Telephone (1)



QN-029BPL Li-Ion Battery Pack (1)



Hand Strap (1)

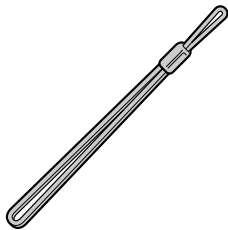

QN-001AC AC Adapter (1)

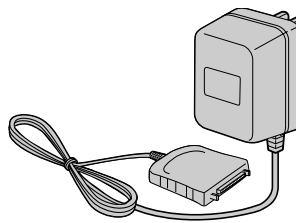

**Note:** Different AC adapters may be provided outside North America.

## Attaching the hand strap

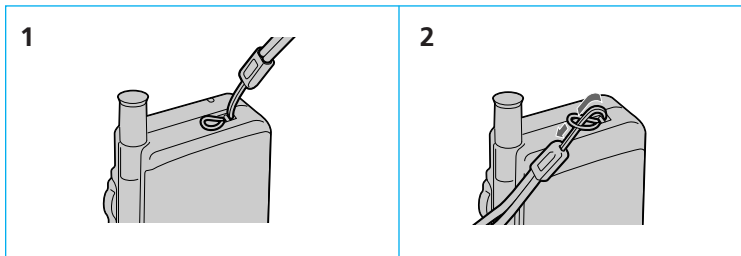

2.1



## Looking at your phone

For further information, refer to the page numbers indicated in parentheses ( ).

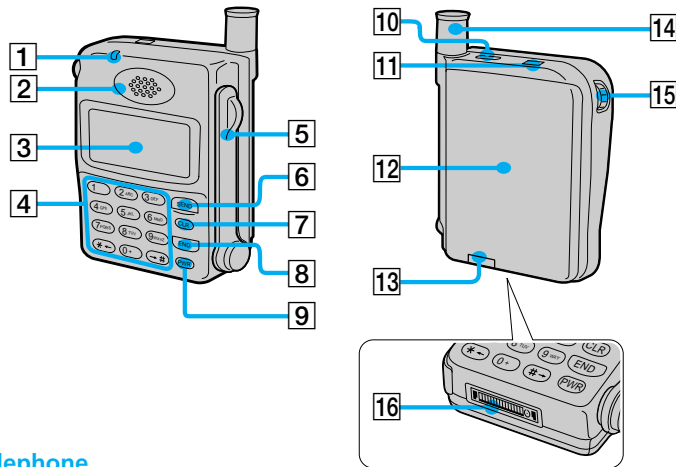

### Telephone

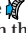
- 1 Call alert indicator (XX)**  
Lights when there is an incoming call.
- 2 Earpiece**
- 3 Display (XX)**
- 4 Number buttons and  $\leftarrow$ / $\rightarrow$  buttons (XX, XX, XX)**  
Use the number buttons to enter letters and numbers. Press and hold a number button for touch dialing. Use the  $\leftarrow$ / $\rightarrow$  buttons to move the cursor when you are entering letters.
- 5 Arm microphone**  
Open to make/receive a call. Close to end a call.
- 6  $\rightarrow$  button (XX to XX)**  
Press to make outgoing calls and to receive incoming calls when the arm microphone is open.
- 7  $\leftarrow$  (clear) button (XX, XX)**  
Press to clear the last or all entered digits on the display, or to exit the current mode of operation.
- 8  $\rightarrow$  button (XX)**  
Press to end calls. Also cancels operations and returns the phone to standby mode.
- 9  $\rightarrow$  (power) button (XX)**  
Press to turn the phone on or off.
- 10 Ringer speaker**  
Allows ringer sounds to be heard.
- 11 Hand strap attachment (XX)**
- 12 Battery pack (XX)**
- 13 Battery pack release tab (XX)**  
Slide up to remove the battery pack.
- 14 Antenna (XX)**
- 15 Jog Dial™ navigator (XX)**  
Push and turn for menu navigation and for changing settings on menus. In this manual, the  icon indicates that you should push the Jog Dial navigator in towards the center of the phone.
- 16 Connector (XX)**  
Use to connect the phone to either the AC adapter or to one of the other accessories available for your phone.

## 2.2



## Display

The top row of the display contains icons that inform you of the current status of your phone. The bottom four rows of the display are for text such as phone numbers, names, and operational prompts. Each row displays a maximum of 12 characters.

Getting Started

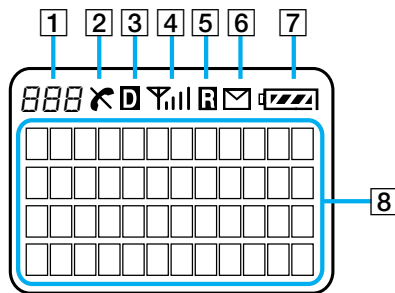

**1 Short character display**

Shows settings such as the number of the currently displayed Menu, as well as Phone Book and Calls List memory locations.

**2 (in-use) / (out-of-service) icon (XX, XX, XX)**

The in-use icon appears during a call. A slash through the in-use icon appears when no signal is received. You cannot make or receive calls when the out-of-service icon is visible.

**3 (digital) icon**

Appears when your phone is receiving a digital signal.

**4 (signal strength) icon (XX)**

Tells you the approximate strength of the signal being received.

**5 (roam) icon (XX)**

Appears when you are roaming outside your home service area.

**6 (message) icon (XX)**

Appears when you have new text or voice mail messages pending. The icon flashes if the new message is urgent.

**7 (battery) icon (XX, XX)**

Shows the approximate amount of charge power remaining in the battery pack. Recharge the battery pack before it is fully discharged.

**8 Character display**

Prompts various actions, and then displays the results. It also shows phone numbers and names.



## 2.3





## Charging the battery pack

Charge the battery before using the phone. A new battery is not fully charged. To charge the battery, attach the battery pack to the phone, then connect the supplied AC adapter.

### Attaching the battery pack

**1** Hook the battery pack onto the top of the phone ①, and ease the battery pack down ②.

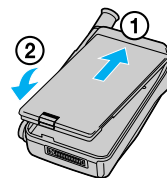

**2** Snap the battery pack in place.

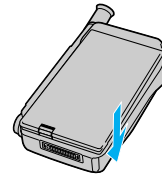

To remove the battery pack

**1** Push the battery pack release tab upwards.

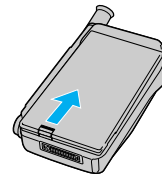

**2** Lift up the bottom of the battery pack ①, and pull it out ②.

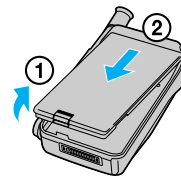

## 2.4



## Charging the battery

Connect the AC adapter to the phone and the other end to a standard AC outlet as illustrated below. The charging time is approximately 3.5 hours. You can charge the battery pack with the phone turned on, but charging will take longer.

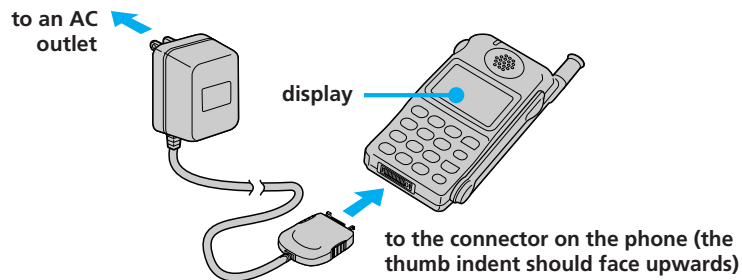



Getting Started

### When the power is turned on

As the battery pack charges, the battery icon () indicates that the phone is charging.

### When the power is turned off

The message `Battery is Charging` is displayed, and  pulses. When the battery pack is fully charged, the message `Charging is Complete` is displayed, and  stops pulsing.

#### Notes

- If you make or receive a call when the battery pack is not charged sufficiently, the call will be cut off. In that case, you will hear an alarm, indicating that the battery is low.
- You can turn on the phone without the battery pack, but you cannot make or receive a call, even if you connect the AC adapter to an AC outlet.

#### Notes on charging

- When you charge the battery pack, avoid:
  - charging for long periods of time, since this reduces battery life.
  - charging in temperatures below 32°F (0°C) or over 104°F (40°C).
  - charging the battery in direct sunlight or in places with high humidity (such as a bathroom).
- Do not use any battery pack other than the one specified in these instructions.
- It is normal for the battery pack to become warm during charging or after use.
- The supplied AC adapter is not intended to be serviced. In the event of a malfunction, it should be replaced.

#### Notes on the battery pack

- Do not dispose of the battery pack in a fire or short-circuit it. Doing so may cause the battery pack to leak or get hot, which could cause personal injury.
- Do not try to disassemble the battery pack.

## 2.5





## Checking the battery

	CDMA mode	Analog mode
In standby mode	40 hours	11 hours
In use continuously	2.3 hours	1 hours

### Battery condition

The battery icon indicates the battery level as follows (when the power is on):

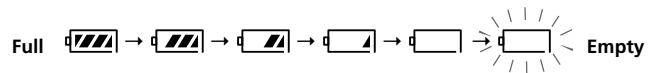

Note that the battery icon displays the approximate charge level and that the consumption may vary depending on conditions of use, such as ambient temperature, network coverage, and usage patterns.

### When the battery is empty

The battery icon flashes and a warning message is displayed. A beep sounds, indicating that the battery is low. Shortly thereafter, the phone turns off. Recharge the battery as soon as possible.



## 2.6







## Turning the phone on

To use your phone, the power must be turned on. It is preferable to extend the antenna, since this maximizes signal strength and minimizes interference.

### Extending the antenna

Hold the end of the antenna and pull up until fully extended.

### To retract the antenna

Push the antenna down until it is fully retracted.

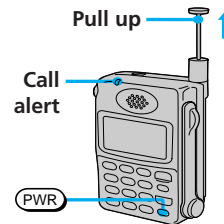

### Turning the power on

Hold down **PWR** for about one second. The call alert indicator lights up, a beep sounds, and the phone starts searching for a signal. When the phone has found a service signal, the standby display appears and the call alert indicator goes off. Now the phone is ready to use.

### To check the digital service

The digital service icon (D) appears when your phone is operating in digital or CDMA mode. If a digital signal is not available, your phone will look for a cellular or analog signal. Some networks may allow you to force your phone to operate in analog mode (see "Forcing the phone into analog mode" on page XX).

### To check the signal strength

The signal strength icon indicates various levels of signal strength. It is best to make calls when the signal is strong, although calls can be made when the signal strength is weak.



### If you are out of the service area

The out-of-service icon (K) appears, and the phone searches for a service signal. If a signal cannot be found, the phone enters power save mode. It will "wake up" automatically at intervals (based on carrier network settings) to search for a service signal.

### Turning the power off

Hold down **PWR** for about one second.





## Making calls

You can call any number up to 32 digits from within a service area. The out-of-service icon (📵) indicates that you are outside the service area.

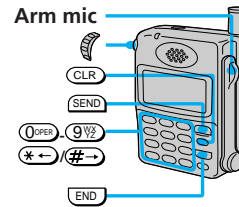

### 1 Use the number buttons to enter the number.

If you enter the wrong digit, press **CLR** to back up. To clear all entered digits, press **END** or hold down **CLR** to return to the standby display.

### 2 If the arm microphone is closed, open it to dial. If the arm microphone is open, press **SEND** to dial.

The phone dials the number you have entered. The 📞 icon appears. When the call is connected, the call timer appears and displays the elapsed time.

### 3 Press **END** or close the arm microphone to end the call when you are finished.

The 📞 icon disappears and the final elapsed call time flashes for 10 seconds. The standby display automatically reappears.

#### Tips

- When dialing, you can insert a pause to attach a DTMF (Dual Tone Multiple Frequency) number to the number you are calling (see page XX).
- If Auto-Hyphen is turned on, the phone number is hyphenated automatically as you enter the digits (see page XX).
- If Minute Alert is turned on, a beep sounds at intervals (based on the setting you select) throughout the call (see page XX).

#### To adjust the earpiece volume during a call

To increase the volume, turn 📞 up.  
Turn 📞 down to decrease the volume.

#### Tip

In addition, you can adjust the volume using the Volume menu (see page XX).

#### To mute/unmute the microphone during a call

Push and hold 📞.

#### Tip

In addition, you can mute the microphone using the Volume menu (see page XX).

#### To redial the last number

On the standby display, press **SEND** when the arm microphone is open. The number you dialed last is redialed automatically.

## 3.2





## Receiving calls

You can receive calls as long as the out-of-service icon (🚫) is not displayed. The 🚫 icon indicates that you are outside the service area.

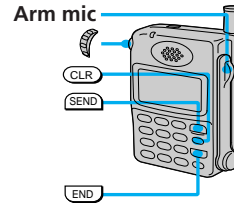

When you receive a call, the ringer sounds or the phone vibrates. Incoming Call flashes on the display, and the call alert indicator blinks.

**1 If the arm microphone is closed, open it to answer the call. If the arm microphone is open, press any button except **PWR** to answer the call.**

When the call is connected, the call timer appears and displays the elapsed time.

**2 Press **END** or close the arm microphone to end the call when you are finished.**

The 🚫 icon disappears, and the final elapsed call time flashes for 10 seconds. The standby display automatically reappears.

### Tips

- While the phone is ringing, turn 🔊 down to lower the ringer volume.
- Using the Jog Dial navigator, you can adjust the earpiece volume or mute the microphone during a call (see pages XX and XX).
- If you turn off the ringer volume (see page XX), you will not hear the ringer sound. The message *-Ringer Off-* is displayed on the standby display.

### If the caller supports caller ID

The caller's phone number appears on the display when you receive a call if both the caller and the carrier support this feature.

If the caller supports caller ID and the number matches a Phone Book entry, the name that you stored with the number (if any) is displayed also.

### If you miss a call

If you miss an incoming call, the message *You have missed XX calls.* appears on the display. To return to the standby display, either press **CLR**, **END**, or 🚫. If the caller supported caller ID, the caller's number is stored in the Calls List (see page XX).



## Storing phone numbers in the Phone Book

Your phone features a built-in Phone Book memory, in which you can store up to 99 (01–99) phone numbers with names. You can dial stored numbers quickly by recalling them from the Phone Book (see page XX).

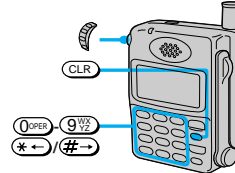



Each phone number can contain up to 32 digits, and each name up to 12 characters. This section shows how to store, edit, and erase Phone Book numbers quickly.

**1 On the standby display, use the number buttons to enter the number.**  
The number appears on the display. In addition, you can store hyphens, pauses, and links with your Phone Book entries (see page XX).

**2 Push .**  
The Options menu appears.

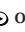
**3 Turn  to select Save, then push .**  
The message Enter a Name appears on the display, prompting you for a name to accompany the number.

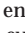
**4 Use the number buttons to enter the name.**  
If you press the same button in quick succession, you will scroll through the characters available on that button. (See the “Alphanumeric table” on page 29.) For the next entry, wait until the cursor moves one step to the right or use /  or  to move the cursor and insert spaces between characters. If you enter the wrong character, press  to clear the character highlighted by the cursor.

### To enter “SONY”



Press  four times to enter an “S.”

Press  three times to enter an “O.” Wait until the cursor moves one step to the right for the next entry.

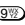
Press  twice to enter an “N.”

Press  three times to enter a “Y.”

**5 When you are finished, push  to store the phone number and name.**  
The message Save in location XX? appears on the display, indicating the first available memory location.

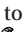
**6 Push  to store the new number in the first available memory location.**  
If you want to store it in another location, turn  to select the desired location or enter the location number, then push . A confirmation message appears, followed by the status of the Phone Book.

### Tip

In addition, you can use the Directory menu to store Phone Book numbers (see page XX).



### Alphanumeric table (English)

Each time you press a number button, the letters/numbers appear as follows:

Button	Sequence
1	- " . ' , & ( ) : 1
2	A B C a b c 2
3	D E F d e f 3
4	G H I g h i 4
5	J K L j k l 5
6	M N O m n o 6
7	P Q R S p q r s 7
8	T U V t u v 8
9	W X Y Z w x y z 9
0	0

#### Tip

When you change your phone's language setting (see page XX), a different set of characters becomes available. See the Spanish, Portuguese or French operating instructions to view the alphanumeric table of each language.

#### To enter a hyphen, pause, or link

In addition to digits, you can insert hyphens, time pauses, hard pauses, and links into the phone number of a Phone Book entry. (See page 36 for information on releasing a pause or link during a call.)

**Hyphens:** Turn off the autohyphenation feature (see page XX) when you want to enter a hyphen manually; for example, when you store a number that doesn't follow the US/Canada standard. Autohyphenation will be turned off for that number.

**Pauses:** A time pause (**T**) sends additional digits about two seconds after a call is connected. A hard pause (**H**) allows you to send additional digits after a call is connected. For example, you may want to enter a phone number in your Phone Book as follows: 1-800-555-1212**H**123. The hard pause character in the phone number allows you to dial the extension 123 after you have reached 1-800-555-1212.

**Links:** You can join two or more Phone Book entries (for example, a doctor's phone number and your medical record number). Once you have specified the first entry, you insert a link. Then you specify the second number by entering its memory location number.

#### 1 While entering digits, push

The Options menu appears on the display.

#### 2 Turn to select which information to enter, then push .

After inserting a hyphen, pause, or link, the display returns to number entry mode.

## 4.2





To enter	Select	The display shows
a hard pause	Hard Pause	<b>H</b>
a time pause	Time Pause	<b>T</b>
a link	Enter Link	<b>L</b>
a hyphen	Enter Hyphen	-

#### If the Phone Book is full

If there are no memory locations available, a message indicates that the memory is full. After entering a name, a message prompts you to specify a memory slot to overwrite. To cancel, hold down or just press **CLR**.

#### Editing stored information

You can edit the name, phone number, and memory location of specific entries stored in the Phone Book.

##### 1 On the standby display, turn **⏻** once.

The Saved #s display appears.

##### 2 Turn **⏻** down to select Phone Book .

The first entry in the Phone Book appears.

##### 3 Turn **⏻** to select the entry that contains the information you want to edit.

The contents of the selected memory location are displayed.

##### 4 Push **⏻**.

The Options menu appears.

##### 5 Turn **⏻** to select Edit, then push **⏻**.

The Edit menu appears.

##### 6 Turn **⏻** to select the item you want to edit, then push **⏻**.

The stored information that corresponds to the selected item appears.

To change	Select
the name	Name
the phone number	Phone #
the memory location	Location #

(continues)

## 4.3





## 7 Enter the new information.

Enter new information the same way you stored original information (see page XX). The old information is overwritten.

## 8 When you are finished, push .

A message confirms that your changes have been saved.

### Tip

In addition, you can use the Directory menu to edit Phone Book numbers (see page XX).

## Erasing a phone number

You can erase stored Phone Book entries. If the selected entry is restricted, you must enter the four-digit lock code before you can erase it (see page XX).

### 1 On the standby display, turn down twice to select Phone Book.

The first Phone Book entry is displayed.

### 2 Turn to find the Phone Book entry you want to erase.

The contents of the selected memory location are displayed.

### 3 Push .

The Options menu appears.

### 4 Turn to select Erase, then push .

A message appears, prompting you to confirm the erasure.

### 5 Push again.

The selected entry is erased. After a few seconds, the standby display reappears.

### Tips

- You can also use the Directory menu to erase one Phone Book entry at a time (see page XX).
- Use the Security menu to erase all Phone Book entries at once (see page XX).

## Restricting Phone Book entries

You can restrict individual Phone Book entries or the entire Phone Book so that access can be gained only by entering a lock code (see page 74). The phone numbers of restricted entries will not be displayed.

### 1 Select the Phone Book entry that you want to restrict, then push .

The Options menu appears.

### 2 Turn to select Restrict, then push .

The selected entry is displayed.

### 3 Push to restrict the selected entry.

Now the selected entry is restricted. After a few seconds, the standby display reappears.

## 4.4





#### To unrestrict an entry

**1 Select the Phone Book entry that you want to unrestrict.**

The message <number is restricted> indicates a restricted entry.

**2 Push .**

The Options menu appears.

**3 Turn  to select Restrict, then push .**

A message appears, prompting you to enter the lock code. (See page XX for information on lock codes.)

**4 Use the number buttons to enter the lock code.**

Now the selected entry is unrestricted. After a few seconds, the standby display reappears.

**Tip**

You can also use the Security menu to restrict/unrestrict Phone Book entries (see page XX).







## Calling from the Phone Book

You can dial frequently used numbers quickly from the Phone Book using the Jog Dial navigator. Also, by using speed/touch dialing, you only need to press a few buttons to dial.

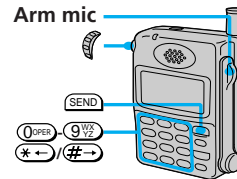

### 1 On the standby display, turn once.

The Saved #s display appears.

### 2 Turn down to select Phone Book.

The first entry in the Phone Book appears.



### 3 Turn to select the desired Phone Book entry.

The contents of the selected entry are displayed.

### 4 Open the arm microphone if it is closed. If the arm microphone is open, push twice or press .

The phone dials the number stored in the selected Phone Book entry. The  icon appears.

#### Tips

- You can use the Prefix feature to add a prefix to a phone number. For example, you can prepend "1-213" to the saved number "555-1212".
- You can search for a phone number by name or memory location (see pages XX and XX).
- Whenever the phone number is displayed, you can call it by pushing  or  or by opening the arm microphone.
- If the phone number of a selected Phone Book entry is too long to fit on the screen, you can still view the overflow digits by selecting *View Number* on the Options menu.

#### To release a pause or link during a call

If a Phone Book entry contains hard pauses or links, only the digits up to the first hard pause or link are displayed. To dial the rest of the selected entry (and release the pause or link), push . For a time pause, wait two seconds. The phone dials the rest of the entry automatically. (See page 30 for additional information on pauses and links.)

## 4.6



### Speed dialing

To dial quickly, you can enter the Phone Book memory location numbers. The phone calls the number stored in the corresponding location.

- 1 Use the number buttons to enter the memory location number.**
- 2 To dial the number, open the arm microphone. If the arm microphone is already open, press **SEND**.**  
The phone dials the number that corresponds to the memory location you entered.

### Touch dialing

You can dial a phone number stored in the Phone Book without pressing **SEND**. Before using this feature, make sure that Touch Dial on the Extras menu is set to on (see page XX).

- 1 Use the number buttons to enter the memory location number.**
- 2 Hold down the last digit of the memory location number for about two seconds when the arm microphone is already open.**  
The phone dials the number that corresponds to the memory location you entered.







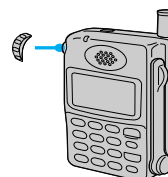

## Searching the Phone Book

To locate a desired Phone Book entry, you can search by name, phone number, or memory location. You can search the Phone Book either alphabetically or for a string of characters.



### Searching alphabetically

When you enter only one character, the phone lists all entries that begin with the entered character.



- 1 From the standby display, turn  once.**  
The Saved #s display appears.
- 2 Push .**  
The Search display appears.
- 3 Enter only the first letter of the name you want to find.**
- 4 Push .**  
All Phone Book entries that begin with the entered character are displayed alphabetically.
- 5 Turn  to view the next entry.**

#### Tip

In addition, you can use the Directory menu to search the Phone Book by name (see page XX).

### Searching for a string of characters

When you enter two or more characters, the phone searches for entries that contain those characters. The results are displayed starting from the lowest memory location number.

- 1 From the standby display, turn  once.**  
The Saved #s display appears.
- 2 Push .**  
The Search display appears.
- 3 Enter at least two characters.**

## 4.8





#### 4 Push .

The entries containing the selected string are displayed starting from the lowest memory location number.

#### 5 Turn to view the next entry in the search string.

##### Note

If the search string does not contain punctuation or a space, the phone scans only the first characters of the words in the matching entries.

### Searching by memory location

The phone searches for a memory location that matches the entered digit(s), and displays a list of options.

#### 1 On the standby display, enter the memory location (a maximum of two digits).

#### 2 Push .

The Options menu appears.

#### 3 Turn up to select Recall Loc#, then push .

The Phone Book entry stored in the selected memory location is displayed. If the entered location is empty, this is indicated on the display. After a few seconds, the standby display reappears.

##### Tip

You can also use the Directory menu to search the Phone Book by memory location (see page XX).

### Searching for a phone number

The phone lists all entries that contain the entered digit(s).

#### 1 On the standby display, enter at least three digits of the phone number you want to find.

#### 2 Push .

The Options menu appears.

#### 3 Turn up to select Find Number, then push .

The Phone Book lists and displays all entries matching the entered digits. Depending on the Sort Book setting (see page XX), the entries are listed either alphabetically or by memory location.

#### 4 Turn to view the next entry that contains the search string.

If a matching Phone Book entry is not found, this is indicated on the display. After a few seconds, the standby display reappears.

## 4.9





## Calling from the Calls List

Information on the ten most recent outgoing calls, incoming calls, scratch pad entries, and missed calls are stored in the phone's Calls List. If you call the same number twice in a row, only the most recent call is stored in the Calls List.

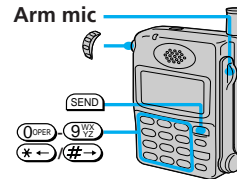

### 1 On the standby display, turn once.

The Saved #s display appears.

### 2 Turn up to go to Calls List.

Information on the most recent call appears.

### 3 Turn to select the entry you want.

The contents of the selected entry are displayed.

### 4 Open the arm microphone if it is closed. If the arm microphone is open, push twice or press .

The phone dials the selected Calls List entry. The icon appears.

#### Tips

- In addition, you can dial by pressing (when the arm microphone is open) after selecting the entry in step 3 on page XX.
- If the selected entry contains a pause or a link, only the digits up to the pause or link are dialed. To release pauses and links, see page 36.

#### To view detailed information of Calls List entries

In addition, you can view the digits of a phone number that do not fit on the screen, the duration of the call, or the time and date of the call by using the Options menu in step 4 on page XX.

To view	Select
digits that do not fit on the screen	View Number
the duration of the call	Duration
the time and date of the call	Time/Date

#### To save the number to the Phone Book

Select **Save** from the Options menu (step 4 on page XX) by pushing the Jog Dial navigator.

## 4.10





## Sending DTMF signals from the Phone Book

You can send DTMF (Dual Tone Multiple Frequency) signals to access electronic services (such as telephone banking) when dialing numbers from the Phone Book.

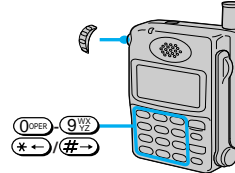

Dual Tone Multiple Frequency is also known as “touch-tone.” A tone is generated when you press a telephone button (number, \*, or #). It can be used to access answering machines, pagers, telephone banking services, data services, and other electronic services.

### 1 During a call, search for the Phone Book entry that contains the numbers you want to send.

The selected entry is displayed. Use the Directory menu to search for the Phone Book entry (see pages XX and XX).

### 2 Push .

The Options menu appears.

### 3 Turn to select Number Tone, then push .

A DTMF signal, containing the entered digits, is sent in a burst.

#### Tips

- You can send a DTMF signal only during a call.
- To enter and send numbers one by one during a call, use the number buttons to send the DTMF number.
- To change the length of the DTMF transmission, see “Setting the keybeep length” on page XX.



**(this page intentionally left blank)**





## About the Features menu

You can use the Features menu to activate the special features of your phone. For a list of submenus and settings, see “List of menu items” on page XX or “Menu map” on page XX. Several features on the Features menu are dependent on your service provider and the network your phone is operating on. Network-dependent features are marked with an asterisk (\*) on page 1.2 and pages 6.X-6.X. Check with your service provider to see if these features are available in your area.

### Navigating the Features menu

See “Menu map” on page 1.2 and the navigation illustrations on page 1.3 for basic information on how to navigate the various Features menus. For more detailed information on each menu item, see the section on that feature in the pages that follow.

### To exit from the Features menu

Press **END** or hold down **CLR** to return to the standby display.

### To return to the previous display

Press **CLR**. To go back further, press **CLR** again.

### Tips

- If you reach the last menu item and try to turn **▲** further, a beep indicates that you have reached the end of the menu. To view other menu items, turn **▲** in the opposite direction.
- The standby display automatically reappears after 30 seconds of inactivity.
- Each menu item can be accessed quickly from the standby display by pushing **▲** and then pushing the number of the menu item. The item number then appears in the upper left corner of the display in step 3. For example, you can access the backlight setting by pushing **▲** followed by **759** and **2460**.





## Messages

This section contains information on the Short Messaging Service (SMS). This feature may allow you to receive voice or text messages. Contact your service provider to see if this service is available in your area.

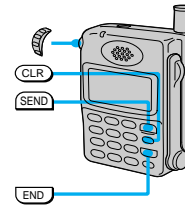

### Receiving messages

To receive messages, the phone must be turned on. The phone supports three types of messages: MESSAGE indicates a text message; PAGE typically contains only digits; VOICE MAIL is a voice mail notification, and indicates the number of new voice mail messages stored in your voice mailbox.

#### When you receive a message

The message icon (✉) appears on the display and the call alert indicator flashes, accompanied by audible alerts. The first line indicates message type and priority. If the message is urgent, the message type is flanked by asterisks (\*) and followed by an exclamation mark (!). If you press any key, this display disappears. The message icon (✉) remains displayed as long as there are unread messages.

#### Tips

- If you receive duplicate messages, the phone deletes the older one and stores the new one with the indication DUPLICATE.
- If the ringer volume is set to vibration, the phone emits a vibration instead of an audible ring when you receive a message.

### Checking message storage capacity

#### Voice mail messages

Voice mail messages are stored remotely by your service provider. Check with your service provider to find out the maximum number and size of voice mail messages that can be stored.

#### Text messages

A text message must contain at least one character, and can be up to 200 characters long. The number of messages that can be stored depends on the size of the messages. You can store approximately 12 large messages or 45 small messages.

#### **WARNING**

When you receive a new message and your phone does not have enough memory to store it, the phone erases old messages that are not locked.

## 5.2





### If the memory becomes full

The phone issues a warning when the memory is 75% full. At this point, you should erase expendable messages (see page XX).

If the memory becomes completely full or your phone does not have enough memory to receive an incoming message, new messages are rejected.

### Accessing messages

#### 1 Push twice from the standby display.

The Message menu appears, indicating the number of the following types of messages, respectively:

- Voice mail messages (see page XX).
- Unread text messages and pagers (see page XX).
- Text messages and pagers that you have already read but are still stored in memory (see page XX).

### Reading voice mail notification messages [F11]

#### 1 Push to select Voice from the Message menu.

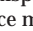
The Voice display appears, indicating the number of voice messages stored in your voice mailbox. Press  to go back to the Message menu.

#### 2 Turn to scroll through the message.

#### To dial a callback number

#### 1 After reading a voice mail notification message, open the arm microphone if it is closed. If the arm microphone is open, push to see the Options menu.

#### 2 Push again to dial the callback phone number.

The phone dials the callback phone number which is attached to the message.

#### Tip

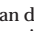
In addition, you can dial the callback number by pressing  from the Messages display or when reading a voice mail notification message if the arm microphone is open.





### To erase a voice message

- 1 After reading a voice mail notification message, push** .  
The Options menu appears.
- 2 Turn to select Erase Msg, then push .**  
The voice mail notification message is erased. The Message menu reappears, indicating that there are currently no voice mail notification messages stored in memory.

### Reading new text messages [F12]

You can read both new and old messages stored in memory. Urgent messages are listed above non-urgent ones, with the most recent entries first. After reading messages, you can protect or erase them.

- 1 Turn to select New Text from the Message menu, then push .**  
The first message is displayed. An asterisk (\*) indicates an urgent message. If there are no new messages, this is indicated on the display. Push to return to the Message menu.
- 2 Turn to scroll through the message.**  
If you do not scroll, the display automatically scrolls down. A hollow box (□) indicates the end of the message.
- 3 To proceed to the next message, push when you reach the end of the message.**  
The Options menu appears. To return to the standby display, press **END**.
- 4 Turn to select Next Msg, then push .**  
The next message is displayed. If there are no more messages, the Message menu reappears.

### To return to the previous message

In step 4 above, select Prev Msg from the Options menu.

#### Note

Once you reach the end of the message and go to the next message, the previous message is stored as an old message.

### Reading old text messages [F13]

The most recent messages are listed first.

- 1 Turn to select Old Text from the Message menu, then push .**  
A list of old messages is displayed. A dot (•) indicates the beginning of each message. A lock icon (🔒) indicates that the message is locked (see page XX). If a number is too long to fit, an ellipsis (...) is used.

## 5.4





**2 Turn  to scroll through the list of old messages.**



**3 To read the selected message, push .**

The selected message is displayed.

**4 Turn  to scroll through the message.**

If you do not scroll, the display automatically scrolls down to the end of the message, which is indicated with a hollow box (□).

**5 When you have read the message, press  to return to the list of old messages.**

To read the next message, push  to go to the Options menu, then select Next Msg. To read the previous message, push  to go to the Options menu, then select Prev Msg.

#### To protect a text message

You can lock a message to protect it from being erased.

**1 After reading a message, push .**

The Options menu appears.

**2 Turn  to select Lock Msg, then push .**



A message indicates that the message is now locked.

#### Note

The phone does not erase locked messages automatically. When there is not enough memory for incoming messages, you must erase the locked messages manually.

#### To respond to a text message

**1 After reading a text message, open the arm microphone if it is closed.**

**2 If the arm microphone is open, push  to see the Options menu. Turn  to select Send, then push .**

The phone dials the callback phone number which is attached to the message. If a callback number is not attached to the message, no call is made and a message indicates that a callback number is not available.

#### Tip

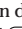
In addition, when viewing a text message or the list of old messages, you can dial the callback phone number simply by opening the arm microphone, or pressing  when the arm microphone is already open.





#### To save the callback number



**1 After reading a message, push .**

The Options menu appears.

**2 Turn  to select Save Number, then push .**

A message appears, prompting you for a name to accompany the number.

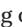

**3 Use the number buttons to enter the name.**

If you press the same button in quick succession, the letter you just entered changes. (See the "Alphanumeric table" on page XX.) Use / or  to move the cursor and to insert spaces between characters. If you enter the wrong character, press  to clear the character highlighted by the cursor.

**4 When you are finished, push  to store the phone number and name.**

A confirmation message appears.

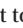
**5 Push  to store the new number in the first available memory location.**

If you want to store it in another location, turn  to select the desired location, then push . A confirmation message appears, followed by the status of the Phone Book.

#### To erase a text message



**1 After reading a text message, push .**

The Options menu appears.

**2 Turn  to select Erase Msg, then push .**

The message is erased.

#### Erasing old text messages [F14]

**1 Turn  down to select Erase Old from the Message menu, then push .**

The Erase Old menu appears.

**2 Press  to erase old messages.**

All unlocked old messages are erased. To go back to the Message menu without erasing the messages, push . If you erase all old messages, it will be indicated on the Message menu.

#### Tip

To erase a locked message, select Erase Msg from the Options menu of that message.

## 5.6







## Sounds

You can adjust the volume of the ringer, keybeep, and earpiece on the Sounds menu. In addition, you can select the type of sounds heard when the phone rings and when you press buttons. (See page XX for instructions on how to reach the Sounds menu.)

### Adjusting the ringer volume [F21]

- 1 Push  to select Ringer Vol from the Sounds menu.**  
The Ringer Vol. menu appears.
- 2 Turn  up to raise the ringer volume, and down to lower it.**  
You can select from six ringer volume settings: off, low, med. (medium), high, escalate, and vibration.
- 3 Push  to enter the new setting.**  
The standby display reappears.

#### If you turn off the ringer volume





The message –Ringer Off– is displayed at the top of the screen when the standby display appears.

#### Tips

- While the phone is ringing, turn down to lower the ringer volume for that call.
- If you set the ringer volume to *escalate*, the telephone rings twice at a low volume, then once at medium volume, and thereafter at a high volume.
- If you set the ringer volume to *vibration*, the telephone emits a vibration instead of an audible ring.
- If the telephone is used with a hands-free car kit or charging accessory, the *vibration* setting is not available.

### Muting/unmuting the microphone [F22]





You can mute/unmute the phone during a call directly, without using the Sounds menu by pushing and holding . In addition, you can mute/unmute the microphone during a call using the Sounds menu. This feature is available only during a call.

- 1 During a call, turn  to select Sounds from the Features menu, then push .**  
The Sounds menu appears.
- 2 Push  to select Mute/UnMute.**  
Now the microphone is muted.
- 3 To unmute the microphone, push .**  
The Sounds menu reappears.
- 4 Push  to select Mute/UnMute.**  
Now the microphone is unmuted.







### Adjusting the keybeep volume [F23]

You can adjust the volume of the beep that sounds when you press a button.

- 1 Turn  to select **Keybeep Vol** from the **Sounds** menu, then push .  
The Keybeep Vol menu appears.
- 2 Turn  up to raise the keybeep volume, and down to lower it.  
You can select from four keybeep volume settings: off, low, med. (medium), and high.
- 3 Push  to enter the new setting.  
The standby display reappears.





### Adjusting the earpiece volume [F24]

You can adjust the earpiece volume during a call by turning . In addition, you can adjust the volume as follows:

- 1 Turn  to select **Earpiece Vol** from the **Sounds** menu, then push .  
The Earpiece Vol menu appears.
- 2 Turn  up to raise the earpiece volume, and down to lower it.  
There are seven earpiece volume settings ranging from 1 to 7. A higher number indicates higher volume.
- 3 Push  to enter the new setting.  
The standby display reappears.

### Setting the ringer type [F25]

You can set the type of beep that sounds for an incoming call.





- 1 Turn  to select **Ringer Type** from the **Sounds** menu, then push .  
The Ringer Type menu appears.
- 2 Turn  to select the ringer type.  
You can select from five different ringer settings. The ringer sounds every time you turn .
- 3 Push  to enter the new setting.  
The standby display reappears.

## 5.8



### Setting the keybeep type [F26]

You can set the beep that sounds when you press a button to either a tone or a click. Tones sound similar to DTMF tones, and clicks are indicated by single beeps.





- 1 Turn  to select Key Sound from the Sounds menu, then push .**  
The Key Sound menu appears.
- 2 Turn  to select the keybeep type.**  
You can select tones or clicks.
- 3 Push  to enter the new setting.**  
The standby display reappears.

#### Note

DTMF tones are sent to the other party during a call even if you set the keybeep type to clicks.

### Setting the keybeep length [F27]

You can set the length of the beep that sounds when you press a button. This setting affects both the keybeep feedback and DTMF transmission tones. The phone sends a short DTMF burst (default) or plays every tone of the DTMF signal as long as the key is held down.

- 1 Turn  to select Beep Length from the Sounds menu, then push .**  
The Beep Length menu appears.
- 2 Turn  to select the keybeep length.**  
You can select standard or long.
- 3 Push  to enter the new setting.**  
The standby display reappears.







## Timers

---

You can check call durations on the Timers menu. In addition, you can set the phone to alert you every minute of a call, and make the phone turn itself off automatically.





### Checking the duration of all calls [F31]

You can view the total duration of all calls. This information cannot be reset.

- 1 Turn  to select All Calls from the Timers menu, then push .  
The All Calls display appears.
- 2 Push  to go back to the standby display.





### Checking and resetting the duration of recent calls [F32]

You can view the total duration of the most recent calls.

- 1 Turn  to select Recent Calls from the Timers menu, then push .  
The Recent Calls display appears.
- 2 Press  to reset, or hold down  to go back to the standby display.  
If you choose to reset, the counter of recent calls and the corresponding durations are reset.

### Checking and resetting the duration of roam calls [F33]

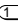
You can view the total duration of the most recent roam calls.

- 1 Turn  to select Roam Calls from the Timers menu, then push .  
The Roam Calls display appears.
- 2 Press  to reset, or hold down  to go back to the standby display.  
If you choose to reset, the counter of recent roam calls and the corresponding durations are reset.





## 5.10









### Setting the minute alert [F34]

You can set the phone to alert you ten seconds before every full minute.

- 1 Turn  to select Minute Alert from the Timers menu, then push .**  
The Minute Alert menu appears.
- 2 Turn  to select the desired alert time.**  
You can select from four settings: off, before min, each min, and every 5 min. If you select before min, the phone alerts you 10 seconds before every full minute.
- 3 Push  to enter the new setting.**  
The standby display reappears.

### Setting the phone to automatically turn off [F35]

You can set the phone to automatically turn itself off after a specified duration.

- 1 Turn  to select Auto-Off from the Timers menu, then push .**  
The Auto-Off menu appears.
- 2 Turn  to select the duration before the phone powers off automatically.**  
You can select from never, in 3 hours, in 2 hours, in 1 hour, and in 30 mins. If you select never, the phone does not turn itself off automatically.
- 3 Push  to enter the new setting.**  
A confirmation message appears.

#### Notes

- If you press any button or operate the Jog Dial navigator, the timer is reset and the countdown starts over.
- The phone does not turn itself off automatically during a call.
- If the Auto-Off timer is set, the phone turns off after a user-specified duration and the countdown Off:xx:xx:xx is displayed.
- Once the phone turns off, the setting will revert to never.







## Directory

---











You can use the Directory menu to check your phone number, as well as store, erase, and edit phone numbers and names in the Phone Book. Also, you can use this menu to view the Calls List.

### Checking your phone number [F41]

- 1 Push  to select My Number from the Directory menu.**  
The My Phone # display appears, showing your phone's number.
- 2 Push  to exit this feature.**  
The standby display reappears.

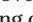
### Storing phone numbers [F42]

For quick and easy dialing, the Phone Book allows you to store up to 99 phone numbers.

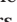
- 1 Turn  to select Save from the Directory menu, then push .**
- 2 Use the number buttons to enter the phone number, then push .**  
The Options menu appears. (See the "Alphanumeric table" on page XX.)
- 3 Turn  to select Save, then push .**  
A message appears, prompting you for a name to accompany the number.
- 4 Use the number buttons to enter the name.**  
Use / to move the cursor or to insert spaces between characters. If you enter the wrong character, press  to clear the character highlighted by the cursor. (See the "Alphanumeric table" on page XX.)
- 5 When you are finished, push  to store the phone number and name.**  
A message appears, prompting you to specify the new memory location.
- 6 Push  to store the new number in the first available memory location.**  
If you want to store it in another location, turn  to select the desired location, then push . A confirmation message appears, followed by the status of the Phone Book.

#### Tip

In addition, you can use the Options menu to store Phone Book numbers (see page XX).

## 5.12







### Erasing a phone number [F43]

You can erase stored Phone Book entries. If the selected entry is restricted, you must enter the four-digit lock code to erase it (see page XX).

**1 Turn  to select Erase from the Directory menu, then push .**

A message appears, prompting you for the Phone Book entry to be erased.

**2 Turn  to select the entry you want to erase, then push .**

A message appears, prompting you to confirm that the selected Phone Book entry should be erased. In addition, you can use the number buttons to select the entry to be erased.

**3 Push  again.**

The selected entry is erased. After a few seconds, the standby display reappears.

**Tips**

- Also, you can use the Options menu to erase one Phone Book entry at a time (see page XX).
- Use the Security menu to erase all Phone Book entries at once (see page XX).

### Editing stored information [F44]

You can edit the name, phone number, and memory location of specific entries stored in the Phone Book. If the selected entry is restricted, you must enter the four-digit lock code to edit it (see page XX).

**1 Turn  to select Edit from the Directory menu, then push .**



A message appears, prompting you for the Phone Book entry to be edited.

**2 Turn  to select the entry that contains the information you want to edit.**

In addition, you can use the number buttons to select the entry to be edited. A message appears, prompting you to confirm that the selected Phone Book entry should be edited.

**3 Push  again.**

The Edit menu appears.

**4 Turn  to select the item you want to change, then push .**

You can change the name, phone number, or memory location by selecting Name, Phone #, or Location #, respectively. The stored information that corresponds to the selected item appears.

**5 Enter the new information.**

The old information is overwritten.

## 5.13





**6 When you are finished, push .**

The Options menu reappears when you edit the phone number. New information is saved when you edit the name or memory location.

**7 Turn  to select Save, then push .**

A message appears, confirming that your changes have been saved.

**Tip**

In addition, you can use the Options menu to edit Phone Book entries (see page XX).

**Searching the Phone Book by name [F45]**

You can find name entries in the Phone Book by searching alphabetically or for a string of characters.

**Tip**

In addition, you can use the Options menu to search the Phone Book by names (see pages XX and XX).

**To search alphabetically**

When you enter only one character, the phone lists all entries that begin with the entered character.

**1 Turn  to select Find Name from the Directory menu, then push .**

The Search display appears, prompting you for a search string.

**2 Enter only the first letter of the name you want to find.**

**3 Push .**

All Phone Book entries are displayed alphabetically, starting from the ones that begin with the entered character.

**4 Turn  to view the next entry.**

**To search for a string of characters**

When you enter two or more characters, the phone searches for entries that contain the entered string. The results are displayed starting from the lowest memory location number.

**1 Turn  to select Find Name from the Directory menu, then push .**

The Search display appears, prompting you for a search string.

**2 Enter at least two characters.**

**3 Push .**

The entries containing the selected string are displayed starting from the lowest memory location number.

**4 Turn  to view the next entry.**



**5.14**





### Searching the Phone Book by memory location [F46]

You can find memory locations easily.





- 1 Turn  to select Phone Book from the Directory menu, then push .**  
A message appears, prompting you for a search string.
- 2 Use the number buttons to enter the memory location number.**  
The Phone Book entry that matches the search string is displayed.  
If the selected entry is empty, the display shows the message Phone Book storage location XX is empty. After a few seconds, the standby display reappears.

#### Tips

- You can also use the Options menu to find Phone Book memory locations (see page XX).
- You can also turn  to scroll through the entire Phone Book instead of entering the memory location number in step 2.

### Viewing the Calls List [F47]

You can view Calls List entries easily.

- 1 Turn  to select Calls List from the Directory menu, then push .**  
If the Calls List is empty, the display shows the message Calls List is empty.
- 2 Turn  to view the Calls List entries.**  
The most recent entry is displayed first. To view the rest of the ten most recent entries, turn .

#### Tip

You can also view the Calls List from the standby display (see page XX).

#### To place a call

Press **SEND** in step 2. You can also push  to go to the Options menu, then select Send and push .





## Extras

---

On the Extras menu, you can set the phone to enable touch dialing, redial automatically, and answer incoming calls automatically or at the press of any button. Also, you can use this menu to lock the keypad and to jot down phone numbers.

### Preventing accidental operation [F51]

When the microphone is closed, you can lock the keypad by pushing and holding  from the standby display. You can also lock the keypad from the Features menu, as described below. Locking the keypad offers low-level security. For example, it disables accidental dialing when you keep the phone in your pocket.

**1 Turn  to select Key Guard from the Extras menu.**

The Key Guard menu appears.

**2 Push .**

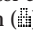
A message appears, confirming that the keypad is locked. After a few seconds, the standby display reappears. The keypad lock icon () and the text **Keyguard On** indicates that the keypad is locked.

#### To unlock the keypad

**1 Press , , and  in quick succession.**

#### To unlock the keypad temporarily

**1 Open the arm microphone.**

The keypad becomes unlocked.

**2 Close the arm microphone.**

The keypad is locked again.

#### To answer an incoming call when the keypad is locked

Just open the arm microphone.

**Tip**

The backlight and keybeeps are turned off when the keypad is locked.

### Activating touch dialing [F52]

If you want to use the touch dialing feature (see page XX), set to on.

**1 Turn  to select Touch Dial from the Extras menu, then push .**

The Touch Dial menu appears.

**2 Turn  to select on or off.**

**3 Push  to enter the new setting.**

The standby display reappears.





## 5.16









### Setting the phone to redial automatically [F53]

You can set the interval for redialing. If the attempt to dial is not successful, the phone tries to redial it up to five times every three seconds.

- 1 Turn  to select Auto-Retry from the Extras menu, then push .**  
The Auto-Retry menu appears.
- 2 Turn  to select on or off.**  
If you select off, the phone does not try to redial automatically.
- 3 Push  to enter the new setting.**  
The standby display reappears.





### Setting the phone to answer automatically [F54]

You can set the phone to answer calls automatically. If you turn auto-answering on, the phone answers incoming calls on the second ring when the phone is used in conjunction with a hands-free car kit or a portable hands-free car kit.

- 1 Turn  to select Auto-Answer from the Extras menu, then push .**  
The Auto-Answer menu appears.
- 2 Turn  to select on or off.**
- 3 Push  to enter the new setting.**  
The standby display reappears.  
The message -AutoAnswer- is displayed on the standby display when you select on and the phone is in the hands-free car kit.

### Using the scratch pad [F55]

Your phone has a scratch pad feature, which is useful for writing down phone numbers temporarily. The phone doesn't send DTMF tone when you enter digits to the scratch pad.

- 1 Turn  to select Scratch Pad from the Extras menu, then push .**  
The Scratch Pad display appears, prompting you to enter a phone number.
- 2 Use the number buttons to enter the digits.**
- 3 Push .**  
The Options menu appears. Besides storing digits, you can enter hyphens, pauses, and links (see page XX).
- 4 Turn  to select Store&Exit, then push .**  
The information is stored as a scratch pad entry in the Calls List. When the Calls List reaches more than 10 list items, the oldest entries will be deleted as needed to make room for new entries.







## Security

---

You can restrict unauthorized access to your phone and the information it holds. Also, on the Security menu, you can reset menu settings to default and store emergency numbers. Unlike other items on the Features menu, accessing the Security menu requires a lock code when you select it from the menu. A typical default lock code is either the last four digits of your phone number or 0000.

### Preventing others from using your phone [F61]

This option lets you set when the phone will be locked. When the phone is locked, carrying out most operations requires entering the lock code; you can still answer incoming calls and dial 911 or other stored emergency numbers.

**1 Push  to select Lock Phone from the Security menu.**

The Lock Phone menu appears.

**2 Turn  to select when the phone will be locked.**

You can select never, on power-up, or right now. If you select never, the phone is available for use at any time without a lock code. If you select on power-up, the phone is locked every time you turn it on.

**3 Push  to enter the new setting.**

The standby display reappears. The message  $\Rightarrow$ :Unlock indicates that the phone is locked.

### To unlock the phone

On the standby display, push . When prompted, enter the lock code.

### Setting a new lock code [F62]

The lock code must be entered every time you want to unlock the phone, and also when you want to access restricted numbers.

**1 Turn  to select New Code from the Security menu, then push .**

The Enter New Code display appears, prompting you to enter a new lock code.

**2 Use the number buttons to enter a lock code.**

The lock code must be exactly four digits long.

**3 Push  to store the new lock code in memory.**

A confirmation display appears.

**Note**

Keep a record of your lock code. If you forget it, contact your service provider.





## 5.18





### Restricting a Phone Book entry [F63]

You can restrict access to individual Phone Book entries.

- 1 Turn  to select Restrict # from the Security menu, then push .**  
A message appears, prompting you to specify Phone Book entry to restrict.
- 2 Turn  to select the Phone Book entry that you want to restrict.**
- 3 Push  to restrict the selected entry.**  
Now the selected entry is restricted.

#### To unrestrict an entry

To select the entry you want to unrestrict, follow the procedure above for restricting an entry.

#### Notes





- The phone number of a restricted entry is not displayed when you view the Phone Book and make a call.
- Restricted entries are not listed or displayed after a digit string search (see pages XX and XX).
- Calling, editing, and erasing a restricted entry requires the four-digit lock code.

#### Tip

Also, you can use the Options menu to restrict/unrestrict Phone Book entries (see page XX).

### Restricting all Phone Book entries [F64]

You can restrict access to all Phone Book entries. All operations that involve Phone Book entries require the four-digit lock code (see page XX).

- 1 Turn  to select Restrict All from the Security menu, then push .**  
The Restrict All menu appears.
- 2 Turn  to set restriction of all Phone Book entries on or off.**
- 3 Push  to enter the new setting.**  
The standby display reappears.

#### Note



If you restricted some entries by using Restrict #, they are still restricted when you turn off Restrict All.





### Reverting to default settings [F65]

You can reset all menu settings to the defaults. This does not affect Phone Book or Calls List entries.

**1 Turn  to select Master Reset from the Security menu, then push .**  
The Master Reset display appears.

**2 Press  to revert to the factory defaults, or push  to keep the current settings.**

If you revert to the factory defaults, all your custom menu settings are erased.

### Erasing all Phone Book entries [F66]

You can erase all Phone Book entries at once.



**1 Turn  to select Erase Book from the Security menu, then push .**  
The Erase Book display appears.



**2 Press  to erase all Phone Book entries, or push  to quit without erasing.**

If you erase all entries, a message appears to confirm this.

### Erasing all Calls List entries [F67]

You can erase all Calls List entries at once.

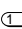
**1 Turn  to select Erase Calls from the Security menu, then push .**  
The Erase Calls display appears.

**2 Press  to erase all Calls List entries, or push  to quit without erasing.**

If you erase all entries, a message appears to confirm this.





## 5.20





### Storing emergency numbers [F68]

You can use the Security menu to store up to three emergency numbers other than 911 (which you cannot erase). You can call these numbers even when the phone is locked.

- 1 Turn  to select Emergency # from the Security menu, then push .**  
The first Emergency # display appears.
- 2 Turn  to select the emergency memory location, then push .**  
A message appears, prompting you to enter the phone number for the emergency entry.
- 3 Use the number buttons to enter the number.**
- 4 Push  to store the emergency number.**  
The entered emergency number is stored in memory. To store other emergency numbers, repeat the above procedure.  
To go back to the standby display, hold down **CLR**.









## Display

---

You can use the features on the Display menu to change the appearance of the on-screen display.

### Setting the banner [F71]

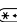
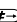



You can change what the banner reads.

- 1 Push  to select Banner from the Display menu.**  
The Banner display appears. The current banner text is displayed.
- 2 Push  again to start editing.**  
A message appears, prompting you to enter a new banner.
- 3 Use the number buttons and /  or  to enter the new banner text.**  
The banner can be up to 12 characters long. For details on character entry, see the “Alphanumeric table” on page XX.
- 4 Push  to save the new banner.**  
The standby display reappears. Your new banner is displayed.



### Setting the backlight [F72]

You can adjust the duration of the backlight on the display and keypad.

- 1 Turn  to select Backlight from the Display menu, then push .**  
The Backlight menu appears.
- 2 Turn  to select how long the backlight is on after the last press of a button.**  
You can select from several time periods; the backlight will remain on for the set duration. If the phone is used with a hands-free car kit or a charging accessory, the added option of **always on** leaves the backlight on.
- 3 Push  to enter the new setting.**  
The standby display reappears.



## 5.22





### Setting autohyphenation [F73]

You can turn the autohyphenation feature on and off. If you turn it on, entered numbers are hyphenated according to the US/Canada standard (eleven digits which include a long distance identifier, an area code, a three-digit community code, and a four-digit location code, for example, 1-800-555-1212).

- 1 Turn to select Auto-Hyphen from the Display menu, then push . The Auto-Hyphen menu appears.
- 2 Turn to select on or off.
- 3 Push to enter the new setting. The standby display reappears.

#### Note

Autohyphenation is not fully deactivated when a pause or link is entered. All entered hyphens up to the pause/link will remain.

### Sorting the Phone Book [F74]

You can determine how the Phone Book will be displayed, and also set the phone to sort the entries either alphabetically or by memory location.

- 1 Turn to select Sort Book from the Display menu, then push . The Sort Book menu appears.
- 2 Turn to set the sorting preferences. You can choose to sort the Phone Book by Loc. # (by location) or alphabetic (alphabetically).
- 3 Push to enter the new setting. The standby display reappears.

### Selecting the language [F75]

You can change the language used on the displays.





- 1 Turn to select Language from the Display menu, then push . The Languages menu appears.
- 2 Turn to select the language. English, Spanish, French and/or Portuguese may be available, depending on your area.
- 3 Push to enter the new setting. The standby display reappears.





### Setting the menu length [F76]

You can set the menu length (long or short). The short menu displays only the most common items on the Features menu; the long menu displays all items.

- 1 Turn  to select Menu Length from the Display menu, then push .**  
The Menu Length menu appears.
- 2 Turn  to set the menu length.**  
You can select short or long.
- 3 Push  to enter the new setting.**  
The standby display reappears.

#### Items on the short menu



The short menu contains the following items:

- Message (see page XX)
- Ringer Vol. (see page XX)
- My Number (see page XX)
- Saved #s (see pages XX, XX, XX)
- Lock Phone (see page XX)
- Long Menu (see page XX)

#### Note





The item Saved #s contains the items Find Name (see page XX), Phone Book (see page XX), and Calls List (see page XX).

#### To return to the long menu

On the short menu, turn  to select Long Menu, then push .

### Setting the message format [F77]

You can choose among formats that determine how your phone displays incoming messages.

- 1 Turn  to select Msg. Format from the Display menu, then push .**  
The Msg. Format menu appears.
- 2 Turn  to set the message format.**  
You can select none, partial or full. If you select none, the message is displayed exactly as it was received. If you select partial, lines with more than 12 characters are wrapped. If you select full, consecutive whitespace characters (such as double spaces) and carriage returns are replaced with a single space.
- 3 Push  to enter the new setting.**  
The standby display reappears.

## 5.24





## Network

On the Network menu, you can set the phone to alert you when the roaming status changes, when a call is dropped, or when enhanced voice privacy is lost.

### Setting the roaming alert [F81]

Your phone is roaming when you use it outside of the home area. Roaming access to a different carrier and the types of calls you can make varies with the agreement between your “home” carrier and the currently serving carrier. Check with your service provider for details about roaming in a specific area.

**1 Push  to select Roam Alert from the Network menu.**

The Roam Alert menu appears.

**2 Turn  to select on or off.**

**3 Push  to enter the new setting.**

The standby display reappears.

#### When you enter another service area

The roaming icon () appears on the display. A beep accompanies the icon if you have turned the roam alert on.

#### If you leave any valid service area

A message appears, indicating that you are outside the area serviced by your “home” carrier or other valid service areas. The out-of-service icon () also appears.

### Setting the drop alert [F82]

If the signal fades, your phone may drop the ongoing call. You can choose to be alerted by an audible alarm when a call is dropped.

**1 Turn  to select Drop Alert from the Network menu, then push .**

The Drop Alert menu appears.

**2 Turn  to select on or off.**

**3 Push  to enter the new setting.**

The standby display reappears.

#### When a call is dropped

The roaming icon () appears on the display. A beep accompanies the icon if you have turned the drop alert on.







### Setting the voice privacy alert [F83]

Some networks and service providers offer a voice privacy feature. This feature encrypts transmissions to and from your phone for added privacy. A display appears to indicate if enhanced voice privacy is lost during a call. You can choose to have an audible alarm accompany this display.

- 1 Turn to select **Priv. Alert** from the **Network** menu, then push .
- The Priv. Alert menu appears.
- 2 Turn to select **on** or **off**.
- 3 Push to enter the new setting.
- The standby display reappears.

#### If enhanced voice privacy is lost

A message appears, and is accompanied by a beep if you have turned on the voice privacy alert.

#### When enhanced voice privacy is regained

A message appears, and is accompanied by a beep when enhanced voice privacy is regained and you have turned on the voice privacy alert.

#### Note

The network automatically turns on enhanced voice privacy if it is available. You do not have to change your phone settings. For details, contact your service provider.

### Switching NAM's [F84]

Your phone allows you to store up to two NAM's (Number Assignment Modules). To add or remove NAM's, contact your service provider who will change the NAM's for you.

- 1 Turn to select **NAM Select** from the **Network** menu, then push .
- The NAM Select menu appears.
- 2 Turn to select how the NAM's will be switched.
- If you select **auto**, the phone switches from one NAM to the other if it enters a service provider's coverage area that matches one of your NAM settings. If you select another setting, you must switch manually if the phone enters a service provider's coverage area that matches the other NAM setting.
- 3 Push to enter the new setting.
- The standby display reappears.

## 5.26





### Selecting system priority [F85]

If you leave the service area of a carrier from which the phone is currently receiving signals, the phone automatically starts searching for another carrier. You can control the order in which the phone searches for a carrier.

**1 Turn  to select Set System from the Network menu, then push .**

The Set System menu appears.

**2 Turn  to set the preferences.**

You can select **standard**, **home side**, **roam side**, or **home only**. If you select **standard**, the phone searches for the system to which you subscribe first, then searches for an alternate system. If you select **home side**, the phone searches for the system to which you subscribe in all regions of coverage. If you select **roam side**, the phone searches only for an alternate system. If you select **home only**, the phone searches for the system to which you subscribe only in your home region.

**3 Push  to enter the new setting.**

The standby display reappears.

### Forcing the phone into analog mode [F86]

You can force the phone into analog mode for the next outgoing or incoming call.

**1 Turn  to select Force Call from the Network menu, then push .**

The Force Call menu appears.

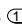
**2 Press  to force the phone into analog mode, or push  to stay in digital mode.**

After a few seconds, the standby display reappears. Your phone stays in analog mode for 10 minutes, or until you terminate the call or turn off the phone.

#### Note

Your phone generally stays in digital mode as long as digital service signals are received. The phone switches to analog mode when an analog service but no digital service is available, even if you do not perform the procedure above.





**(this page intentionally left blank)**





# Troubleshooting

Problem	Cause/Remedy	Page
Nothing appears on the display.	• The phone is off. Turn the phone on.	20
	• Battery is fully discharged. Recharge the battery.	17
The out-of-service icon (📶) appears.	• The phone is outside the service area, or the signal is too weak. Extend the antenna fully.	21
Nothing happens when you press the buttons.	• The buttons may be locked.	69
	• The phone may be locked. Enter the lock code to unlock the phone.	74
The call does not go through.	• Check the signal strength.	20
	• If the 📶 icon is displayed, there is no service. See above.	21
	• Check the number.	23
	• Press <b>SEND</b> .	23
	• Listen for a busy signal.	—
You can hear the other party, but the other party cannot hear you.	• The microphone may be muted. Unmute the microphone.	24, 56
You hear the other party only faintly.	• Adjust the earpiece volume. If possible, also reduce the noise around you.	24,
		57
The call is cut off (“dropped”).	• You could be outside the coverage area. Redial the number. If the problem continues, contact your carrier. Also see “The out-of-service icon (📶) appears” on page 88.	21
You hear an alternate high/low tone.	• You are attempting to use the phone in an area without service.	21
	• Extend the antenna fully.	20
	• Let the 📶 icon disappear, then try to dial.	21
You forgot the lock code.	• Try 0000, 1234 (commonly used as defaults), or the last four digits of your own number.	74
	• See your authorized dealer or service provider.	—
You hear a fast busy tone.	• This can result from any one of the following:	—
	– The phone is improperly programmed.	21
	– The phone is out of range.	—
	– All channels are busy.	20
You cannot place or receive calls.	• Make sure that the phone is turned on, and that the out-of-service icon is not displayed.	20
	• Check the system settings. If you are roaming, consult your service provider concerning roaming agreements.	83

Additional Information

## 6.1





## Accessories

---

### Supplied accessories

- QN-029BPL Li-Ion Battery Pack (1)
- QN-001AC AC Adapter (1)  
(other AC adapters may be provided outside North America)
- Hand strap (1)

### Optional accessories

- QN-008CLA Rapid Charging Cigarette Lighter Adapter
- QN-009TA Travel Adapter
- QN-012DAS Interface Cable and FoneBook™ PLUS Software
- QN-020TCL Combination Travel Adapter/Cigarette Lighter Adapter
- QN-021BCD Dual Slot Battery Charger
- QN-023DCS Desktop Charger Speakerphone
- QN-024HC Auto Travel Holder
- QN-025PHK Portable Hands-Free Car Kit
- QN-026HS Phone Holster
- QN-027LC Carrying Case
- QN-028SKT Starter Kit
- QN-029BPL Li-Ion Battery Pack
- QN-030HFK Hands-Free Car Kit

Call 1-800-488-SONY (7669) to order additional accessories (USA only). All accessories may not be available at press time.

## 6.2



## Specifications

---

### Frequency range

Transmit: 824 to 849 MHz

Receive: 869 to 894 MHz

### Dimensions

3.6 × 2.4 × 1.0 inches (h/w/d)

(not including antenna)

(91 × 62 × 26 mm)

### Mass (weight)

Approx. 5.3 oz (150 g)

(including battery)

### RF power output

CDMA mode: 0.01 μW to 200 mW

AMPS mode: 6 mW to 600 mW

### Operational temperature

-22°F to +140°F

(-30°C to +60°C)

(excluding battery pack)

Design and specifications are subject to change without notice.

Additional Information

6.3



## List of menu items

This section lists the Features menu and its submenus. You can use the Features menu to activate the special features of your phone.

Menu Item	Settings	Page
F11 Voice*	—	48
F12 New Text*	—	49
F13 Old Text*	—	51
F14 Erase Old*	—	54
F21 Ringer Vol.	off / low / medium /high / escalate / vibration	55
F22 Mute/UnMute	mutes or unmutes the microphone	56
F23 Keybeep Vol	off / low / medium / high	57
F24 Earpiece Vol	1 / 2 / 3 / 4 / 5 / 6 / 7	57
F25 Ringer Type	standard / option 1 to 4	58
F26 Key Sound	tones / clicks	58
F27 Beep Length	standard / long	59
F31 All Calls*	total call time, number of calls	60
F32 Recent Calls*	total call time, number of calls	60
F33 Roam Calls*	total call time, number of calls	60
F34 Minute Alert	off / before min. / each min. / every 5 min	60
F35 Auto-Off	never / in 3 hours / in 2 hours / in 1 hour / in 30 mins	61
F41 My Number	—	62
F42 Save	—	62
F43 Erase	—	64
F44 Edit	—	64
F45 Find Name	—	66
F46 Phone Book	No default entries	67
F47 Calls List	No default entries	68
F51 Key Guard	—	69
F52 Touch Dial	on / off	70
F53 Auto-Retry	on / off	70
F54 Auto-Answer	on / off	71
F55 Scratch Pad	—	72

## 6.4



Menu Item	Settings	Page
F61 Lock Phone	never / on power-up / right now	73
F62 New Code	0000	74
F63 Restrict #	No default numbers	74
F64 Restrict All	on / off	75
F65 Master Reset	—	76
F66 Erase Book	—	76
F67 Erase Calls	—	76
F68 Emergency #	No defaults for #1 to #3	77
F71 Banner*	No default banner	78
F72 Backlight	off / for 7 secs / for 15 secs / always on	79
F73 Auto-hyphen	on / off	80
F74 Sort Book	by loc. # / alphabetic	81
F75 Language*	English / French / Spanish / Portuguese	81
F76 Menu Length	long / short	82
F77 Msg. Format*	none / partial / full	82
F81 Roam Alert	on / off	83
F82 Drop Alert*	on / off	84
F83 Priv. Alert*	on / off	85
F84 NAM Select*	auto / set-N.A.M. #1 / set-N.A.M. #2	85
F85 Set System*	standard / home side / roam side / home only	85
F86 Force Call*	—	85

\*) These features may be available with some networks and service providers. Check with your service provider to see if these features are available in your area.







## Glossary

---

### A

#### **Automatic answer**

Feature that automatically answers calls.

#### **Automatic retry**

Feature that automatically redials a call when a "System Busy" indication is received.

### B

#### **Banner**

Message at the top of the standby display.

### C

#### **Calls List**

See "Phone Book."

#### **Carrier**

A company that provides PCS telephone service.

#### **CDMA**

Code Division Multiple Access. A spread-spectrum approach to digital transmission. With CDMA, each conversation is digitized, and then tagged with a code. The mobile phone receives only the signal with the appropriate code.

#### **Coverage area**

The geographic area covered by one carrier. If you travel outside a carrier's area, you cannot receive service from that carrier. Also see "Roam."

### D

#### **Dropped call**

A call terminated because of a deep, long fade or because the user left the coverage area.

#### **DTMF**

Dual Tone Multiple Frequency, also known as "touch-tone." Tone generated when you press a telephone button (number, \*, or #). Can be used to access answering machines, pagers, telephone banking services, data services, and other electronic services.

### E

#### **ESN**

Electronic Serial Number. The unique identification number of your telephone. The telephone transmits this number to the base station every time a call is placed.

#### **Emergency number**

In addition to the general emergency number (911 for the U.S.A. and Canada), three phone numbers can be stored as emergency numbers in your telephone. You can dial these numbers and 911 even when the phone is locked.

### H

#### **Home area**

The area of the home system to which you subscribe.

### I

#### **Incoming call**

A call received by your telephone.

### L

#### **Lock**

Prevents unauthorized calls by requiring the user to enter a code to use the phone. Even if the phone is locked, you can call any of the emergency numbers or answer incoming calls.

### M

#### **Memory**

A storage area for names and phone numbers. Also see "Phone Book."

#### **Menu**

The menu allows you to change or see the settings of your phone. You can access it from the standby display or during a call. See "List of menu items" on page 90 for an overview of this feature.

#### **Minute alert**

This alert beeps periodically during a call to help you keep track of the length of the call.

## 6.6



## N

### **NAM**

Number Assignment Module. Portion of your telephone's memory programmed to contain information about your subscription to the carrier. Your telephone can have up to two NAM's.

## P

### **Pause**

You can enter pause codes in the phone number memory data. Use this feature when accessing an answering machine, voice mail system, electronic banking system, etc. When a pause is inserted between two groups of digits, the phone will pause before dialing the next set of digits, allowing you to wait until your counterpart is ready to accept the string.

### **Phone Book**

You can store up to 99 numbers in Phone Book memory, location number 01 to number 99. An additional recent number memory (Calls List) stores the last ten used phone numbers.

## R

### **Roam**

Your phone is roaming when you use it outside of the home area. Availability of roaming access to a different carrier and types of calls you can make varies with the agreement between your home carrier and serving carrier. Check with your carrier for details about roaming in a specific area.

## S

### **Scratch pad**

Allows you to enter a number and store it in the Calls List.

### **Service area**

Region covered by a PCS service. Also see "Coverage area."

### **SMS**

Short Messaging Service. An extended service offered by carriers that allows you to receive text messages on your phone. Check with your carrier for details.

### **Speed dialing**

Making a call using Phone Book memory locations. Also see "Phone Book."

## T

### **Touch dialing**

A quick way of making a call using a number stored in a Phone Book memory location. Also see "Speed dialing."

### **Touch-tone**

See "DTMF."

## V

### **Voice mail**

An extended service, offered by carriers, that allows you to retrieve voice mail messages stored in your voice mailbox. Check with your carrier for details.

### **Volume**

You can adjust the volume of keybeep, ringer, and earpiece.





# Index

## A

AC adapter 11, 17  
Antenna 20  
Arm microphone 12  
Automatic  
  Answer 71  
  Hyphenation 80  
  Retry 70  
  Redial 70

## B

Backlight 79  
Banner 78  
Battery pack  
  Charging 16  
  Checking 19  
  Attaching/removing 16  
Battery charge contacts 17  
Battery pack release tab 13  
Battery icon 15, 17

## C

Calling  
  Calls List 41, 68  
  Dropped call 84  
  Ending calls 23, 25  
  Making calls 23  
  Receiving calls 25  
  Recent number 41  
  Redialing 24, 70  
  Restrictions 34, 74  
  Roaming 83  
  Speed dialing 37  
  Touch dialing 37, 70  
Carrier 83, 86  
CDMA (Code Division Multiple Access) 6  
Character display 14  
Clearing. *See* Deleting  
Coverage area 83  
Cursor 28, 63

## D

Dialing. *See* Calling  
Deleting  
  Calls List entries 77  
  Characters 28, 63  
  Message 54  
  Phone Book entries 33, 64  
  Phone numbers 33, 64  
  Voice mail 48  
Digital icon 14  
Display 14

Display settings  
  Accessing 44  
  Autohyphenation 80  
  Backlight 79  
  Banner 78  
  Time 60  
Displays  
  Calling 23  
  Menu 21  
  Hyphens/pauses/links 30  
  Menu setting 82  
  Security 73  
  Standby 21  
Dropped call 84  
DTMF (Dual Tone Multiple  
  Frequency) 43

## E

Earpiece 24, 57  
Editing  
  Emergency numbers 77  
  Phone numbers 31, 64  
Emergency numbers 77  
Enabling  
  Lock 69  
  Touch dialing 70  
Ending a call 23, 25  
Entering  
  Hyphens 30  
  Links 30  
  Pauses 30  
Erasing. *See* Deleting  
ESN (Electronic Serial Number) 93  
Extra features  
  Accessing 69  
  Changing DTMF transmission 58  
  Enabling touch dialing 70  
  Muting the microphone 56  
  Using the scratch pad 71  
  Setting auto-answer 71  
  Setting auto-retry 70

## F

Finding. *See* Searching

## H

Hand strap  
  Attaching 11  
Hyphens  
  Autohyphenation 80  
  Entering manually 30

## 6.8



## I

Incoming call 25  
In-use icon 23, 25

## K

Keybeep 58

## L

Laws  
Rules and regulations 4  
Lock code 74

## M

Making calls 23  
Manual  
Answer 25  
Call 23  
Hyphenation 30  
Redial 24  
Memory  
Deleting 33, 64  
Editing 31, 64  
Number searching 38, 39, 66  
Storing 28, 63  
Menus  
Accessing 21  
Message icon 46  
Messages  
Calling back 49  
Displaying 46  
Erasing 54  
Locking 52  
Message list 47  
Receiving 46  
Microphone 24, 56  
Minute alert 60  
Multiple city registration 94  
Muting the microphone 24, 56

## N

Number buttons 23, 27

## O

Out-of-service icon 21, 83  
Overflow digits  
Viewing 42

## P

Pause 30  
Phone Book 27, 35, 38, 62  
Power  
Turning off 21  
Turning on 20  
Prefix 4.6

## Q

Quitting. *See* Power

## R

Receiving  
Calls 25  
Messages 46  
Voice mail 48  
Recent number memory  
Calling recent numbers 41  
Clearing call memory 76  
Redialing  
Auto retry 70  
Last dialed number 24  
Restriction 34, 74  
Ringer  
Volume 55  
Roam 83  
Roam icon 83  
Roaming agreement 83  
Rules and regulations 4

## S

Safety precautions 6  
Scratch pad 72  
Scrolling  
Menus 22  
Message 50  
Message list 51  
Searching  
For a name 66  
For a number 39, 40  
For a message 51  
Security functions  
Accessing 73  
Clearing call memory 77  
Emergency numbers 77  
Lock mode 73  
New lock code 74  
Restriction 74





---

Sending. *See* Calling  
Service area 83  
Signal strength icon 20  
Special characters 29  
Standby display 21  
System settings  
    Accessing 83

## T

Text Message. *See* Messages  
Touch dialing  
    Enabling 70  
Troubleshooting 88  
Turning phone on 20

## V

Voice mail notification  
    Accessing 47  
    Receiving 48  
Voice Privacy 85  
Volume  
    Adjusting 55



## 6.10





**SONY Wireless Hotline Number  
(USA only)**

If you have any questions or comments,  
please call:  
**SONY WIRELESS HOTLINE**  
**1-800-578-SONY (7669)**

You can also visit the  
**SONY WIRELESS WEBSITE** at  
**[www.sony.com/wireless](http://www.sony.com/wireless)**

© 1998 Sony Electronics Inc. All rights reserved. Reproduction without written consent expressly prohibited. Sony and Jog Dial are trademarks of Sony. All other trademarks are the property of their respective owners. Design and specifications are subject to change without notice. Talk and standby times are subject to change.

Printed in USA

