

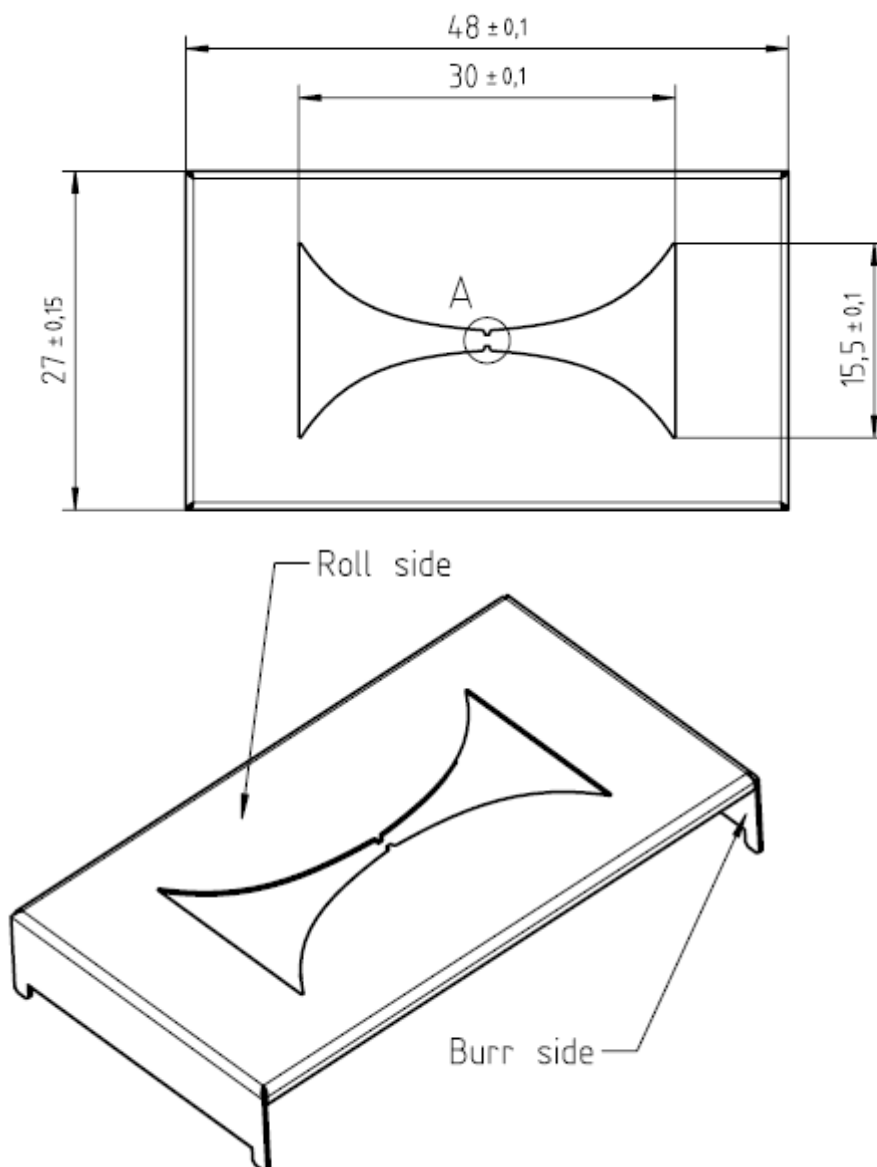

# QPS WALK2000 ANTENNA SPECIFICATION

## 1 Mechanical Drawing





2 Farfield Radiation Plots

f [GHz]	New design Phi=90°	New design Phi=0°
3.5	<div><p>Farfield Realized Gain Abs (Phi=90)</p><p>Frequency = 3.5 GHz Main lobe magnitude = 1.76 dBi Main lobe direction = 0.0 deg. Angular width (3 dB) = 63.8 deg. Side lobe level = -3.6 dB</p></div>	<div><p>Farfield Realized Gain Abs (Phi=0)</p><p>Frequency = 3.5 GHz Main lobe magnitude = 1.76 dBi Main lobe direction = 0.0 deg. Angular width (3 dB) = 67.8 deg.</p></div>
4	<div><p>Farfield Realized Gain Abs (Phi=90)</p><p>Frequency = 4 GHz Main lobe magnitude = 3.89 dBi Main lobe direction = 0.0 deg. Angular width (3 dB) = 63.4 deg. Side lobe level = -4.6 dB</p></div>	<div><p>Farfield Realized Gain Abs (Phi=0)</p><p>Frequency = 4 GHz Main lobe magnitude = 3.89 dBi Main lobe direction = 0.0 deg. Angular width (3 dB) = 66.5 deg.</p></div>

