

-MARQUAGE P/N SUIVANT NOMENCLATURE.
 -MARKING P/N FOLLOW PART LIST.

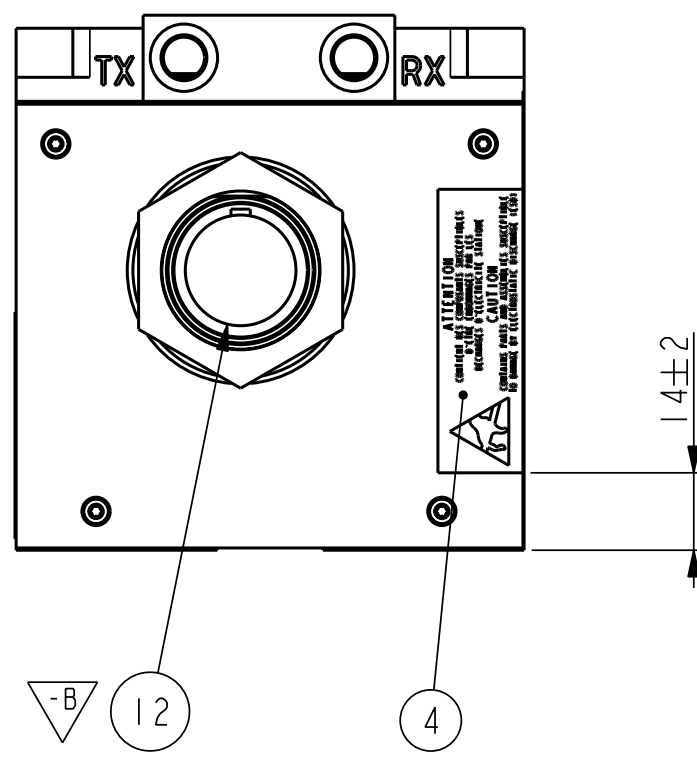
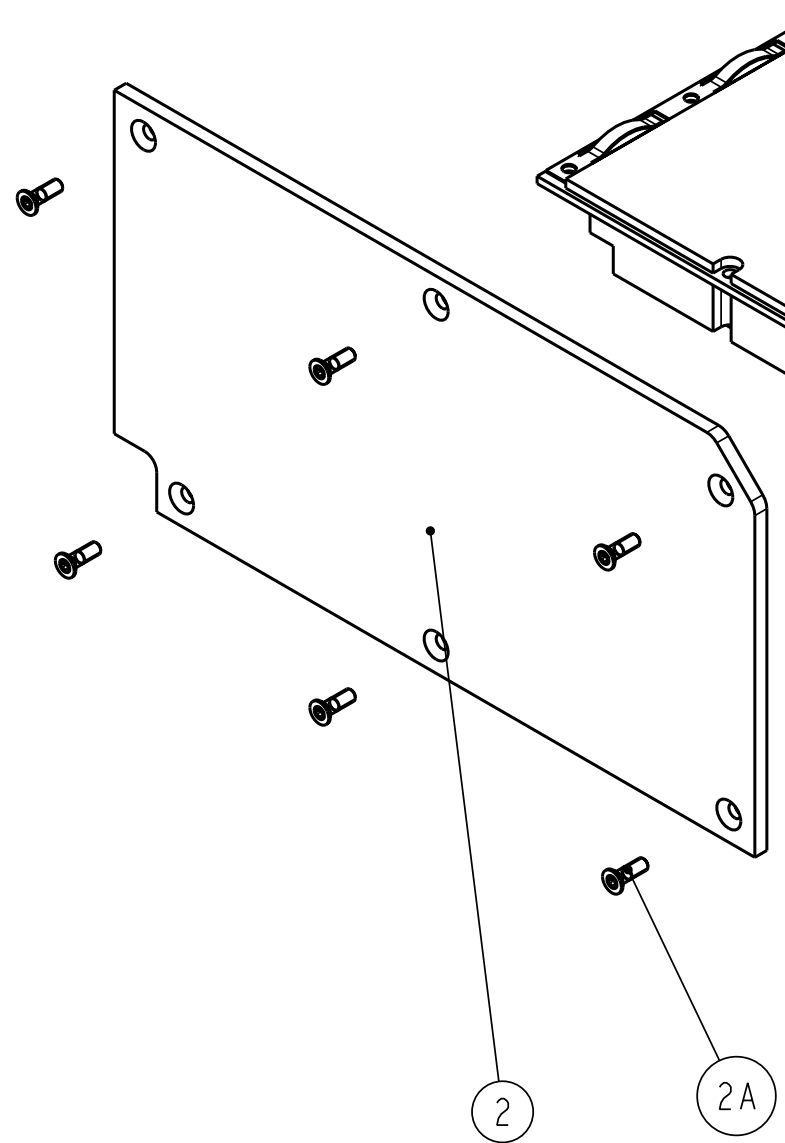
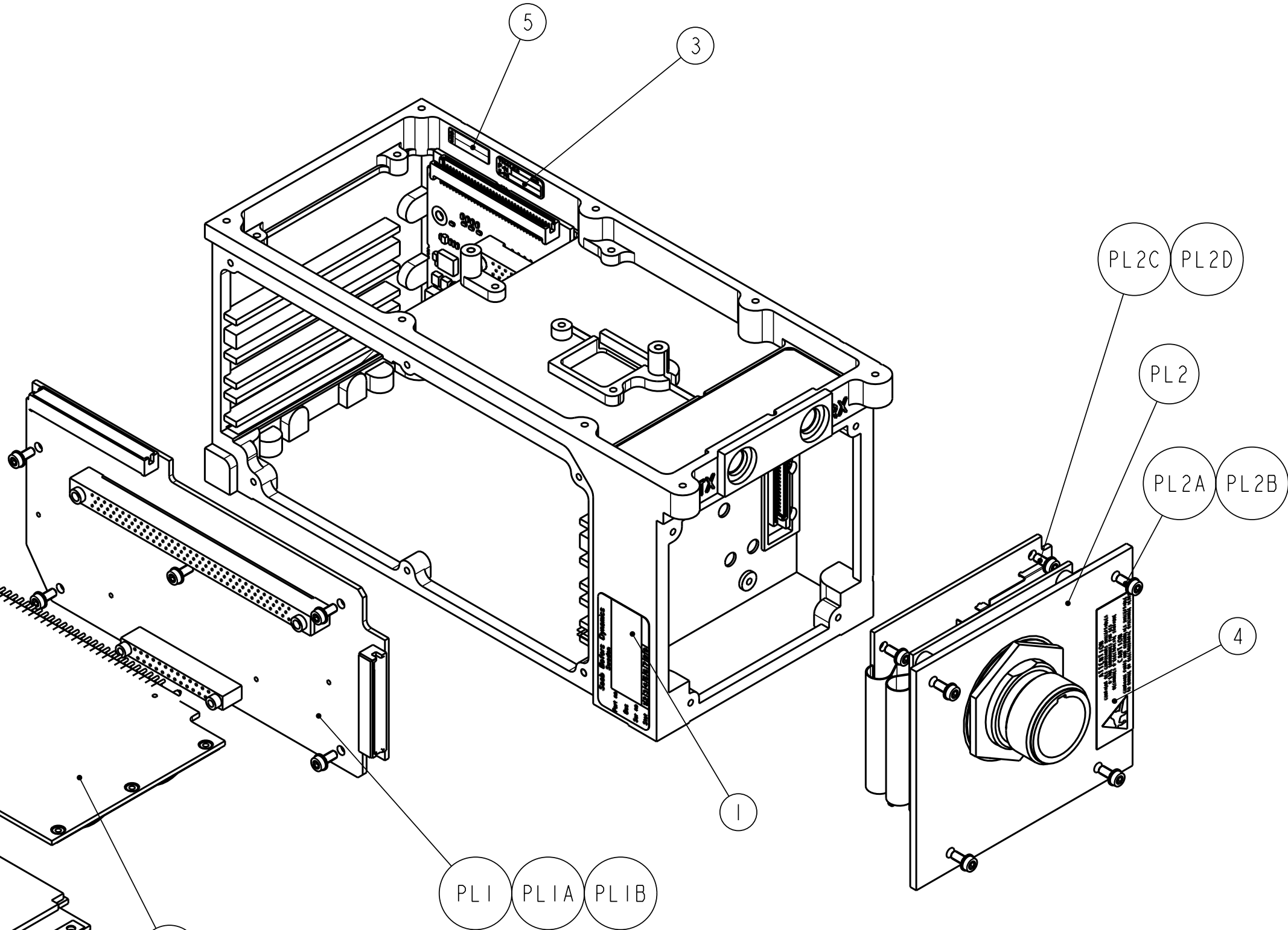

NOTA :
 FREINAGE DE LA VISSERIE AVEC LE REP 400
 BRAKING SCREWS WITH REP 400
 COUPLE DE SERRAGE DES VIS M2,5 : 0,8 N.m
 TIGHTENING TORQUE FOR SCREWS M2,5 : 0,8 N.m

LES EVOLUTIONS DOIVENT ETRE INCORPOREES A PARTIR DE LA CONCEPTION XAO Pro/ENGINEER Wildfire 3
 THE CHANGES MUST BE INTEGRATED STARTING FROM THE CAX SOFTWARE Pro/ENGINEER Wildfire 3

ECO 11837	-B	Ajout Rep. 12	GIRAUD	2008-10-09	OUVRARD
	-A	Ajouter couple de serrage	MARKART	2008-01-09	OUVRARD
No EVOL	REV.	Nbr/Qty	EVOLUTION/CHANGE		DESS./DRAWN DATE VERIF./CHECKED
MATIERE/MATERIAL :			TOL. GEN.		EHELLE 4/5 SCALE
TRAITEMENT/TREATMENT :			ISO2768 : mK		
FINITION/FINISH :			GEN. TOL.		
DESSINE/DRAWN SPIESS	DATE 2007-04-10	VERIFIE/CHECKED LEBRUN	DATE 2007-04-10	APPROUVE/APPROVED LEBRUN	DATE 2007-04-10

TITRE: **CHASSIS NUMERIQUE**
 TITLE: **DIGITAL CHASSIS**

THALES THALES COMMUNICATIONS F0057	NUMERO DOCUMENT/DOCUMENT NUMBER	FORMAT/SIZE	PAGE
	61939729-040	A2	1/1
-B REV			