

Plug-In Lighting Module with Repeater

Model PR-318

1. INTRODUCTION

Thank you for your purchase of a SkylinkHome™ lighting receiver, Plug-In Lighting Module with Repeater, Model PR-318. This receiver module allows you to wirelessly turn on and off, dim and brighten different lighting fixtures with the SkylinkHome™ lighting transmitters. It also repeats signal in order to extend the operating range.

The Plug-In Lighting Module with Repeater PR-318 can communicate with up to 16 transmitters, so user has the option to add more transmitters to the system, such as more remote controls, or motion sensors etc.

All wireless signal communications within the SkylinkHome™ lighting system are based on rolling code technology to ensure highest security is used.

The following items are included in this package:

- Plug-In Lighting Module with Repeater
- User's Instructions

Plug-In Lighting Module with Repeater



2. SETUP

Simply plug the Plug-In Lighting Module with Repeater to an AC electrical outlet, then plug in a light that you would like to operate to the socket on the Plug-In Lighting Module with Repeater. You may place the antenna in the upright position to have the best reception.

Note: Lighting Load

The Plug-In Lighting Module with Repeater is designed to operate maximum load of 300W at 120VAC. It can dim incandescent light and designated dimming compact fluorescent light. Do not connect other kinds of loading or loading that exceeds this maximum rating.

Follow the programming instructions below to get started.

3. PROGRAMMING TRANSMITTERS (TC SERIES) / SENSORS

In order to operate the Plug-In Lighting Module with Repeater remotely with a transmitter or sensor, it must be programmed to the Plug-In Lighting Module with Repeater. Each module can be operated by up to 16 different transmitters (or 16 different command signals).

There are 3 operating modes with the Plug-In Lighting Module with Repeater:

- 1) On / Off Mode - When a valid signal is received, it will toggle the load, i.e. turning off or on the light
- 2) Flashing Mode - When a valid signal is received, the light will flash for a specific period of time, which is the time defined in the timer duration. This works as an alert indication.
- 3) Timer Mode - When a valid signal is received, the load will be on for a specific period of time, from 1 minute, 5 minutes, 15 minutes, 30 minutes, and 60 minutes. This is mainly for energy saving, turning lights on only when the movement is detected (with optional motion sensor) or when a transmitter is activated.

You can program multiple transmitters / sensors to the module and each transmitter / sensor can operate in its own mode.

To program a transmitter / Sensor into the Plug-In Lighting Module with Repeater, follow the instructions below.

1. Plug in a load to the Plug-In Lighting Module with Repeater.
2. Plug in the module to an AC electrical outlet, the red LED flashes once quickly. The connected load (i.e. light) will be on automatically.
3. Press and hold the SET button for about 3 seconds, until the red LED flashes once. You may now release the SET button.
4. The red LED will continue to flash for about 15 seconds. You can now decide the operating mode of the transmitter that you plan to program.

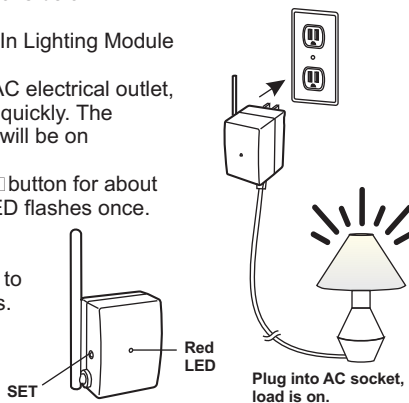

3. PROGRAMMING TRANSMITTERS (TC SERIES) / SENSORS (CONT)

Operating Mode	LED Indication
On / Off	One Flash
Flashing	Two Flashes
Timer	Steadily On

5. If you are programming a transmitter for On / Off operation, follow steps A) to C). Otherwise, go to step 6.
 - A. Press the PROG button on the back of the TC transmitter with a sharp object.
 - B. Press the button on the TC transmitter that you would like to program into the module.
 - C. Once the transmitter is programmed, the red LED on the module flashes quickly then stops flashing, indicating you have successfully programmed the transmitter to the module.
 - D. You may operate the light with the programmed transmitter.
6. If you are programming a transmitter for Flashing operation, continue to hold the SET button for another 6 seconds, until the LED flashes twice at a time. Otherwise, go to step 8.
7. You may now follow steps 5A) to 5C) to complete the programming sequence.
8. If you are programming a transmitter for Timer operation, continue to hold the SET button for another 6 seconds, until the LED is on steadily.
9. You may now follow steps 5A) to 5C) to complete the programming sequence.

Note: To program other transmitters/sensors (besides TC transmitter), please refer to the instructions of the transmitters/sensors.

Note: You must complete the programming sequence within the 15-second interval, otherwise, the module will quit from programming mode and you need to start again from step 1 if the red LED is off.

You may follow the same instructions to program additional transmitters or sensors to operate the receiver module.

4. SET TIMER DURATION

As mentioned, the timer can be set to the following durations, 1 minute, 5 minutes, 10 minutes, 30 minutes, and 60 minutes.

This timer duration is used for both under Flashing Operation Mode and Timer Operation Mode.

There is only one timer setting, so all transmitters that are programmed in timer mode and flashing mode will have the same timer duration. To set the timer duration, follow the instructions below:

1. Plug in the module to an AC socket so it is powered on properly.
2. Turn off the connected load by a programmed transmitter. The load must be off in order to set the timer duration.
3. Press and hold the SET button for 3 seconds, the red LED flashes once. The number of flash indicates the timer duration:

Number of Flash	Timer Duration
1	1 min.
2	5 min.
3	15 min.
4	30 min.
5	60 min.

4. Continue to hold the SET button until it reaches the desired setting. The status will change every 6 seconds, i.e. hold onto the SET button for another 6 seconds, you will see the number of flashes changes from 1 to 2, 2 to 3 etc.

Note: Once the number of flash reaches 5, it will stay at this setting. If you would like to go back to other settings, such as 1 flash, release the button and repeat from step 1 to start over.

Once a transmitter (button) is programmed in timer mode or flashing mode, activating this programmed transmitter (button) will turn on the light for the specified timer duration.

During a timer count down, if the module receives another signal for timer operation, the timer will start again and overrides the previous timer, therefore, extending the on period by another timer interval.

5. OPERATING MODES

The Plug-In Lighting Module with Repeater can control the light in 2 different operating modes.

- 1) On / Off Mode - Allows operating the light either on and off, without dimming function.
- 2) Dimming Mode - Allows operating the light in on, off and dimming (dim / brighten) modes. Light must be either incandescent light and designated dimming compact fluorescent light.

The factory default operating mode is On/Off mode. However, if your light is dimmable, you may change the operating mode to Dimming Mode. To change the operating modes, please follow the instructions below.

1. Turn on the light by the programmed transmitter.
2. Press and hold onto a button on the transmitter that is programmed to the module for 10 seconds.
3. The light will flash. If it flashes once, that means it is in On / Off Mode. If the light flashes twice, that means it is in Dimming Mode.
4. Repeating step 3 above will toggle the setting between On / Off Mode and Dimming Mode.

6. ON / OFF OPERATION

The PR-318 Plug-In Lighting Module with Repeater allows on / off operation, when the programmed button is activate, it will transmit a signal to toggle its current status. For example, if a signal is received when the light is off, that signal will turn on the light.

Note:

When used with Compact Fluorescent Light, if there is flickering when you switch off the light, it is recommended you replace a different Compact Fluorescent Light with higher quality.

7. BRIGHTNESS CONTROL OPERATION

Besides turning on and off the light, you may also control the brightness of the light if the receiver module and the light bulb is dimmable, i.e. either incandescent light and designated dimming compact fluorescent light.

To change the brightness, first turn on the light.

Press and hold the programmed button on the transmitter will change its brightness. Hold onto the button until the desired brightness is reached, then release the button.

Press and hold the same button again on the transmitter to change the brightness again in the opposite way (i.e. Dim to brighten or brighten to dim), until the desired brightness is reached, then release the button.

8. FLASHING OPERATING MODE

If a transmitter or a sensor is programmed to the Plug-In Lighting Module with Repeater under the flashing mode, when that transmitter is activated, the light connected will flash for the predetermined timer interval. After the timer interval, the light will be off.

9. TIMER OPERATING MODE

If a transmitter or a sensor is programmed to the Plug-In Lighting Module with Repeater under the timer mode, when that transmitter is activated, the light connected will be on for the predetermined timer interval. After the timer interval, the light will be off.

10. ZONE OPERATION

Zone Operation On / Off

A Zone Command allows you to operate multiple lights at the same time in the same zone. You may turn On or Off a zone.

To activate the zone command, simply press [Zone On] or [Zone Off], then the zone number.

Pressing [Zone On] then [1] will turn on all lights in zone 1.

Pressing [Zone Off] then [3] will turn off all lights in zone 3.

10. ZONE OPERATION (CONT)

Programming Zone Command

Enter [Zone On] + [Zone Number] during step 5B of the programming sequence (ensure on / off operating mode is selected), the Zone Command signal would be programmed. Repeat this step for all the receiver modules in the same zone.

Zone Operation Brightness Control

You can also change the brightness of all the lights in that zone, if the receiver modules and lights connected are dimmable.

[Zone On] represents increase in brightness level, i.e. Brightening
[Zone Off] represents decrease in brightness level, i.e. Dimming

Press [Zone On] then hold [1] will brighten all lights in zone 1, release the button at the desired brightness level or it will stop until they are at the maximum brightness.

Press [Zone Off] then hold [1] will dim all lights in zone 1, release the button at the desired brightness level or it will stop until they are at the minimum brightness.

11. ERASING TRANSMITTERS FROM THE MODULE

You may erase a transmitter or sensor from the module, but you cannot erase a specific device, you must erase all the wireless devices, then program the ones you want to keep. Follow the instructions below to erase programmed transmitters / sensors.

1. Power off the Plug-In Lighting Module with Repeater by removing it from the AC socket.
2. Press and hold the SET button, while holding onto the SET button, plug in the module to an AC socket.
3. The red LED will be on first, then flashes rapidly for 1 second.
4. You may release the SET button, the light connected to the module is now on, indicating you have successfully erased all the devices from the lighting receiver.
5. You may remove the module from the socket to power it off completely.

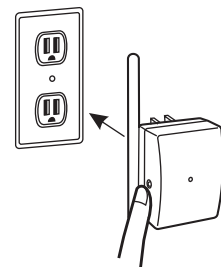

Press and hold the SET button while plugging it in to an AC socket

12. REPEATER

The Plug-In Lighting Module with Repeater can also repeat wireless signals from other SkylinkHome™ lighting system devices. This increases the operating distance or eliminates dead spots.

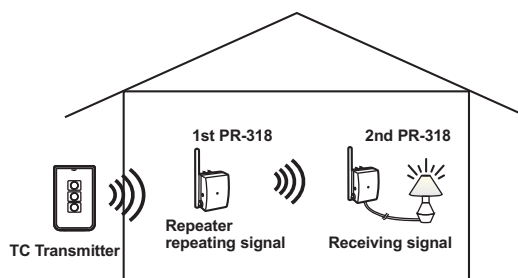

As a general rule of thumb, if you are experiencing dead spots, you may place the Plug-In Lighting Module with Repeater in the middle of the house to see if you can eliminate the dead spots. If so, you can leave the Plug-In Lighting Module with Repeater in the middle of the house. If the dead spot still exceeds, you can place the Plug-In Lighting Module with Repeater somewhere between the transmitter and the receiver until you experience no dead spots.

You can have a maximum number of 3 repeaters operating in one premises. However, unless it is necessary, it is suggested to keep the number of repeater to as few as possible to reduce the number of wireless signals.

13. REPEATER (CONT)

If you do not experience dead spot, it is recommended that you switch off the repeating function. The factory default setting is off for the repeater function. You can skip this step if you do not experience dead spot.

If you have multiple repeaters, it is important to set the delay time of each repeater to be different in order to avoid signal collision. The delay time is how soon the signal will be repeated after receiving it. There are 4 settings for the delay time.

Switch Position	Results	When to use this setting:
1 (Most Left)	No Repeat Function	If you do not experience dead spot
2	Very slight delay, ~0.1 second	For the first repeater
3	Slight delay, ~0.5 second	For the second repeater
4 (Most Right)	Long delay, ~ 1 second	For the third repeater

To change the setting, remove the screw on the back of the Plug-In Lighting Module with Repeater and remove the door. Place the switch position at the desired setting. After selecting the switch position, secure the door with the screw.

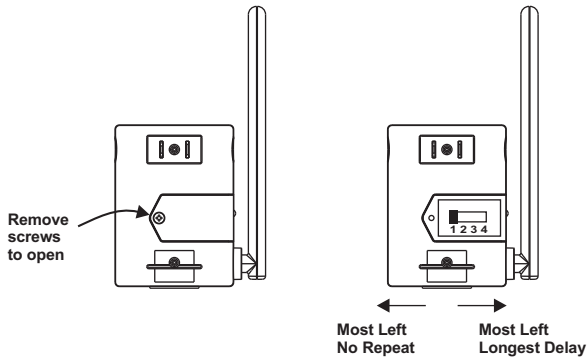

14. TECHNICAL SPECIFICATIONS

Input Voltage: 120V AC, 60Hz
Standby Current: 5mA
Maximum Load: 300W at 120AVC
Operating Frequency: 318MHz

15. FCC

The Remote Control is approved by the FCC and it complies with Part 15 of the FCC Rules. Its operation is subject to the following two conditions :

1. This device may not cause harmful interference.
2. This device must accept any interference that may cause undesired operation.

WARNING:

Changes or modifications to this unit not expressly approved by the party responsible of compliance could void the user's authority to operate the equipment.

16. CUSTOMER SERVICE

If you would like to order Skylink's products or have difficulty getting them to work or download latest information and user manual, please :

1. visit our FAQ section at www.skylinkhome.com, or
 2. email us at support@skylinkhome.com, or
 3. call our toll free at 1-800-304-1187 from Monday to Friday, 9 am to 5 pm EST.
- Fax (800) 286-1320



CUSTOMER SERVICE

17 Sheard Avenue, Brampton, Ontario, Canada L6Y 1J3
Email: support@skylinkhome.com
<http://www.skylinkhome.com>
P/N. 1012701
Patent Pending
©2010 SKYLINK GROUP

17. ACCESSORIES

The SkylinkHome™ Lighting System consists of many other devices from multiple button transmitters, Motion Sensor, various receivers such as Wall Switch Receiver, Plug-in Receiver with Repeater, Outdoor Receiver, Dimmer Module etc. Please visit Skylink website at www.skylinkhome.com for more information.