

# Garage Door Remote Control Model 318TR

## 1. INTRODUCTION

Model 318TR is designed to control your garage door opener with the keychain remote control. Please follow the instructions below to set up the operation code for both transmitter and receiver. The instruction will also show you how the receiver should be connected to the push button of your existing garage door opener.

In this package, you will find a transmitter with 12V alkaline battery, a receiver, a red / black wire, user's instructions, connector removing tool.

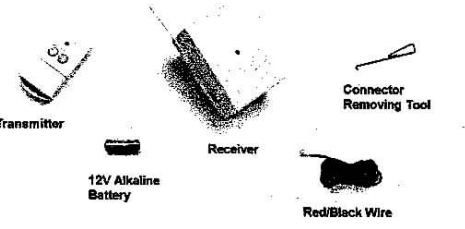

## 3. INSTALLATION

- Unplug the power cord from your existing garage door opener to avoid triggering the door accidentally during installation.
- Open your existing wall mounted garage door opener push button housing. The push button is usually secured by 2 screws, removing these 2 screws allows you to open the push button housing.
- Connect the red / black wire included in this package to the 2 terminals and tighten as shown. If your push button has more than 2 terminals, attach the red / black wire to the same two terminals that the wire from the garage door opener is connected to. **DO NOT REMOVE ANY WIRES.**
- Plug in the other end of the red / black wire to the receiver as shown.
- Plug in the receiver to a near by 120V AC electrical outlet.
- Plug in the power cord of your garage door opener.
- Press the push button to examine the additional wiring does not affect the its original operation.
- Activate the transmitter by pressing its button will activate the garage door opener.

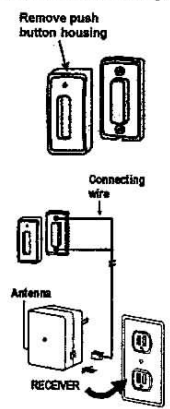

## 2. SET UP THE OPERATION CODE FOR BOTH TRANSMITTER AND RECEIVER

You should randomly set the operation code for your remote control to avoid controlling others garage door openers, or letting others to control yours. Therefore, it is important to set the code connectors to a randomly selected combination. Following the instructions below to set the operation code.

- Pry off the battery cover on the transmitter with a coin, as shown.
- You will see 9 connectors labeled from "1" to "9", as shown.
- You can randomly remove some of these connectors and leaving some connectors in place. A connector can be removed with a removing tool, as shown.
- If the connector is placed on the top and middle posts, that column is set on " + ". If the connector is placed on the middle and bottom posts, that column is set on " - ". If the connector is removed completely, (not placed on any posts), it is set to " 0 " or the neutral position. (see diagram for examples of how to set a column to the three different positions). When removing a connector to set a column to the neutral position, save the connector in case you change the code at a later date.

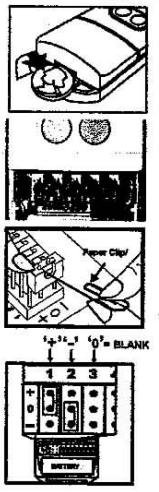

- After setting up the code connectors on the transmitter, you are ready to set the same code on the receiver.
- Remove the screw that holds the connector cover, and pry off the cover.
- You will see 10 connectors underneath the cover. For connectors "1" to "9", set them up in the exact same way as you have on the transmitter, i.e. if you removed connector "1" on the transmitter, you should also remove connector "1" on the receiver.
- For connector "10" on the receiver, set the connector on "+" if you are using button "1" to control this receiver. If you are planning to use button "2" to control this receiver, you need to remove this connector. See figure below.

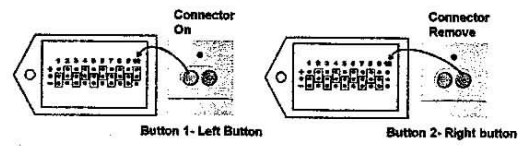
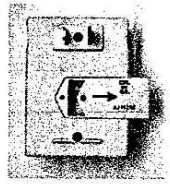

## FCC

This device complies with Part 15 of the FCC Rules. Operation is subject to the following two conditions: (1) This device may not cause harmful interference, and (2) This device must accept any interference received, including interference that may cause undesired operation.

**WARNING:**  
Changes or modifications to this unit not expressly approved by the party responsible for compliance could void the user's authority to operate the equipment.

**NOTE:**  
This equipment has been tested and found to comply with the limits for a Class B digital device, pursuant to Part 15 of the FCC Rules. These limits are designed to provide reasonable protection against harmful interference in a residential installation. This equipment generates, uses and can radiate radio frequency energy and, if not installed and used in accordance with the instructions, may cause harmful interference to radio communications.

However, there is no guarantee that interference will not occur in a particular installation. If this equipment does cause harmful interference to radio or television reception, which can be determined by turning the equipment off and on, the user is encouraged to try to correct the interference by one or more of the following measures:

- Reorient or relocate the receiving antenna.
- Increase the separation between the equipment and receiver.
- Connect the equipment into an outlet on a circuit different from that to which the receiver is connected.
- Consult the dealer or an experienced radio/TV technician for help.

## 4. OPERATION

Once you have finished setting up the code connectors and installing the receiver to your existing garage door opener, the Model 318TR installation is completed.

To activate your garage door opener, simply press the desired button on the transmitter, it will activate the garage door opener and open / close your garage door.

## 5. ADDITIONAL RECEIVER

Since there are 2 buttons on your transmitter, the other button can be used to control another Skylink garage door receiver Model 318R (sold separately). This button can also be used to control plug in lighting with Skylink Plug-in lighting control Model SW318R (sold separately).

## 6. ADDITIONAL TRANSMITTER

You can add as many additional transmitters as you want to control the same receiver. Simply set the same operation code on all transmitter with the same code setting on the receiver. All these transmitters can operate the receiver. These transmitters Model 318T from Skylink can be purchased separately. Skylink also offers Model 318KT, keyless entry system to work with your Model 318TR. For more information, please visit our website at [www.skylinkhome.com](http://www.skylinkhome.com)

## WARRANTY

If, within one year from date of purchase, this product should be defective (except battery), due to faulty workmanship or material repaired or replaced, without charge. Proof of purchase is required.

## NOTE

If you would like to order Skylink's product or have difficulty getting Skylink's Garage Door Monitor to work, please :  
1. visit our website FAQ at [www.skylinkhome.com](http://www.skylinkhome.com), or  
2. email us at [support@skylinkhome.com](mailto:support@skylinkhome.com) (reply within 24 hrs), or  
3. call our toll free at 1-800-304-1187 from Monday to Friday, 9 am to 5 pm EST.

**CUSTOMER SERVICE**  
2213 Dunwin Drive Mississauga, Ontario, L5L 1X1, CANADA  
TEL (905)808-9223 FAX (905)808-8744  
Email: [support@skylinkhome.com](mailto:support@skylinkhome.com) (Reply within 24 hrs), or  
Customer Service : (800)304-1187 From 9am to 5pm EST (Mon-Fri)  
<http://www.skylinkhome.com>  
PIN: 101A206 Rev.0  
Patent no. D390895 Patents Pending  
©2003 SKYLINK GROUP