

# Houselink® Garage Door Remote Control

Model 18TR

## 1. INTRODUCTION

In this package, you will find a keychain transmitter with 12V alkaline battery, a garage door receiver, a red / black wire and a mounting bracket.

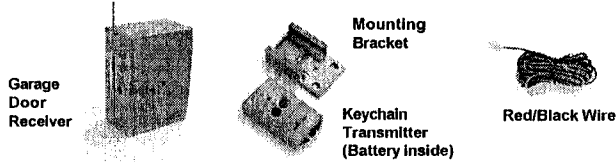

## 2. INSTALLATION

The following instructions will show you how to install the receiver. After installing, the keychain transmitter (already programmed to the receiver) can be used to operate your garage door opener.

You need to locate 2 things inside your garage to install the receiver:

- 1) the wall-mounted door control;
- 2) an electrical outlet, select an electrical outlet different from the one already connected to the power cord of the garage door opener to reduce the chance of interference. The further distance between the receiver and the garage door opener, the less interference between 2 devices.

*Note: The length of the red/black wire is 15ft, so the receiver must be plugged into an electrical outlet that is within 15ft of the wall mounted door control. If there is no electrical outlet within 15ft of the wall mounted door control, an extension cord can be used for temporary installation. Longer wire is available, please contact our customer service for further information.*

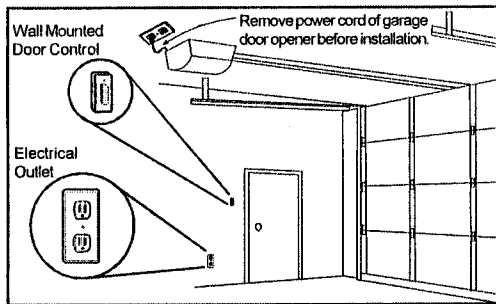

**WARNING** Unplug the power cord of your garage door opener before installation to ensure power is not connected.

- 1 Remove the wall-mounted door control from the wall by removing the screws. Connect the stripped ends of the Red/Black wire to the 2 terminals (2 screws) on the back of the wall mounted door control. (Polarity does not matter.)

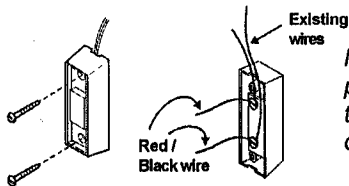

*Note: There should be another pair of wires connected to the 2 terminals already. Do not remove/disconnect these existing wires.*

*Note: If you see no screws mounting the wall mounted door control, the screws are probably under-neath the front cover. Remove the front cover by pressing onto the tabs on top of the cover.*

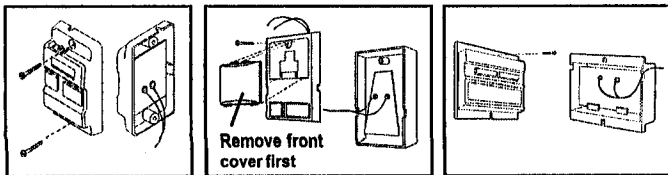

Different wall-mounted door controls

## 2. INSTALLATION (CONT)

Plug in the connector end of the Red/Black wire to the 18R receiver. Note the orientation of the male & female connector.

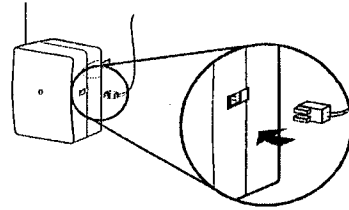

- 3 Plug the receiver into an electrical outlet inside the garage. The red light on the receiver should be on after being plugged into an electrical outlet.

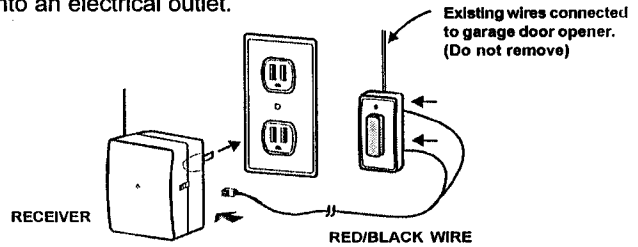

*Note: Alternative wiring options are available, the receiver can be connected directly to the opener's motor. Please contact customer service for further information regarding alternative wiring options.*

- 4 Re-connect the power cord of the Garage Door Opener.
- 5 The Left button on the transmitter has been programmed to operate the receiver. Activate this button will trigger the receiver therefore opens the garage door.

## 3. TROUBLE SHOOTING

**Q:** Door opener does not react after pressing the button on the transmitter ?

- A:**
- Ensure when the button on the transmitter is pressed, the red light on the transmitter comes on. Otherwise, check if the battery is inserted properly.
  - The left button on the transmitter should be pressed, not the right button
  - If the red light on the receiver flashes when you press the left button on the transmitter, but the door opener does not respond, please ensure the red/black wire is successfully connected from the receiver to the wall mounted door control.
  - Ensure the wires that are previously connected to the wall mounted door control are not loose.

## 4. PROGRAMMING ADDITIONAL TRANSMITTERS TO THE RECEIVER

Additional transmitters (sold separately) can be programmed to the receiver so more than one transmitter can operate the receiver. A maximum number of 15 transmitters can be programmed to one receiver.

Follow the instructions below to program additional transmitters:

- 1 Plug in the receiver into an electrical outlet, the red light on the receiver will be on.
- 2 Press and hold the learn button on the receiver until the end of step 3. The red light will flash during the learning process.
- 3 Activate the transmitter by pressing its button that you would like to program to the receiver, the red LED on the receiver will be turned off if it learns the signal.
- 4 You may now release the learn button on the receiver, and the red light will be on steadily. The learning process is completed and you may activate the programmed transmitter, which will operate the garage door receiver.

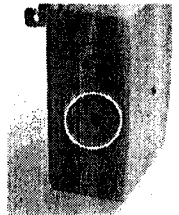

Refer to 8) Additional Transmitters for more info on different transmitters that can be added to the 18TR system.

## 5. ERASE PROGRAMMED TRANSMITTER(S)

Programmed transmitters can be erased by following the instructions below:

- 1) Unplug the receiver from an electrical outlet.
- 2) Press and hold the learn button on the receiver.
- 3) While holding down the learn button, plug the receiver into an powered electrical outlet. The red light will flash rapidly, which indicates all the programmed transmitters have been erased. You now release the learn button.

Note: When performing the erase operation, all the programmed transmitters will be erased. This operation cannot erase an individual transmitter.

## 6. BATTERY

12 volt alkaline battery (size 23A) (included). It is time to change the battery when the red LED on the transmitter does not turn on when either button is pressed.

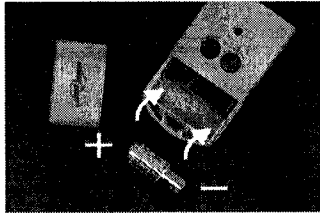

## 7. ADDITIONAL RECEIVER

There are 2 buttons on the Model 18TN Keychain Transmitter, the other button can be used to control another Houselink® Garage Door Receiver Model 18R (sold separately), or Houselink® Wireless Switch Receiver Model SW-18R (sold separately).

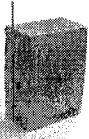

## 8. ADDITIONAL TRANSMITTERS

A maximum number of 15 transmitters can be added to the 18R receiver. There are 3 different transmitters that can be added:

- 1) 4-button Transmitter Model 18-T4, controlling up to 4 receivers (Garage Door Receiver, or Wireless Switch Receiver).
- 3) Keypad Transmitter Model 18K, operate 18R receiver with your personal password.

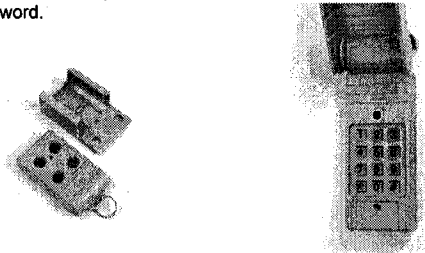

## 9. CAUTION

**RISK OF ELECTRICAL SHOCK. FOR INDOOR USE ONLY.**  
**CAUTION: DISCONNECT POWER BEFORE CODE CHANGING.**  
**REPLACE COVER AFTER CODE CHANGING.**

Maximum Rating:  
Input : 120VAC 60Hz 2W

## 10. FCC

This device complies with Part 15 of the FCC Rules. Operation is subject to the following two conditions: (1) This device may not cause harmful interference, and (2) This device must accept any interference received, including interference that may cause undesired operation.

**WARNING:**  
Changes or modifications to this unit not expressly approved by the party responsible for compliance could void the user's authority to operate the equipment.

**NOTE:**  
This equipment has been tested and found to comply with the limits for a Class B digital device, pursuant to Part 15 of the FCC Rules. These limits are designed to provide reasonable protection against harmful interference in a residential installation. This equipment generates, uses and can radiate radio frequency energy and, if not installed and used in accordance with the instructions, may cause harmful interference to radio communications.

However, there is no guarantee that interference will not occur in a particular installation. If this equipment does cause harmful interference to radio or television reception, which can be determined by turning the equipment off and on, the user is encouraged to try to correct the interference by one or more of the following measures:

- Reorient or relocate the receiving antenna.
- Increase the separation between the equipment and receiver.
- Connect the equipment into an outlet on a circuit different from that to which the receiver is connected.
- Consult the dealer or an experienced radio/TV technician for help.

## 11. WARRANTY

If, within one year from date of purchase, this product should become defective (except battery), due to faulty workmanship or materials, it will be repaired or replaced, without charge. Proof of purchase and a Return Authorization are required.

## 12. CUSTOMER SERVICE

If you would like to order Skylink's products or have difficulty getting them to work, please :

1. visit our FAQ website at [www.skylinkhome.com](http://www.skylinkhome.com), or
2. email us at [support@skylinkhome.com](mailto:support@skylinkhome.com) (reply within 24 hrs), or
3. call our toll free at 1-800-304-1187 from Monday to Friday, 9 am to 5 pm EST.  
Fax +800 286-1320

## CUSTOMER SERVICE

17 Sheard Avenue, Brampton, Ontario, Canada L6Y 1J3  
1100 East Valencia Drive, Fullerton, CA 92831 USA

Tel: (714) 224-4321

Email: [support@skylinkhome.com](mailto:support@skylinkhome.com) (Reply within 24 hrs)

<http://www.skylinkhome.com>

P/N: 101A206-002 Rev.2

©2003 SKYLINK GROUP