

# CEILING FAN REMOTE CONTROLLER OPERATION AND INSTALLATION INSTRUCTIONS

(Please keep this instruction pamphlet.)

## HANDSET TRANSMITTER OPERATION

Activating the Learning process: Turn on the receiver power, press and hold the LEARN key (on the back of the transmitter) for 1~3S. Refer to FIG. 2

Light (if installed) will flash twice and off. This confirms that the learning setting is active and ok.

Transmitter use 2 pcs AAA/1.5V batteries.

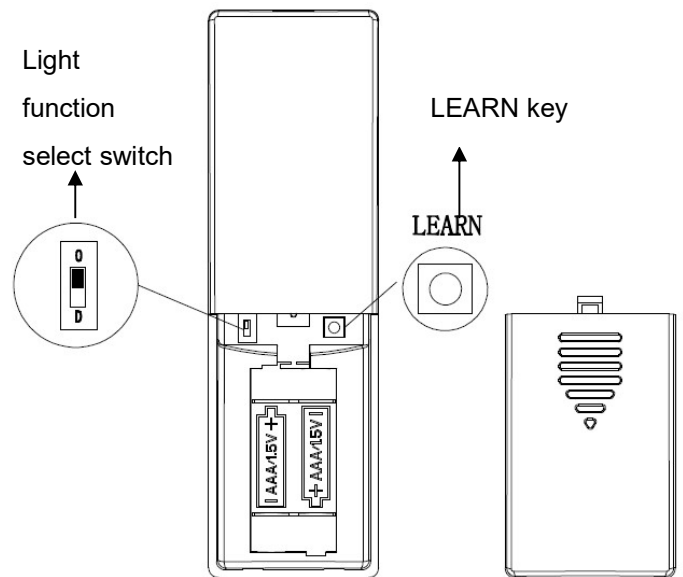

FIG. 2

## LIGHT FUNCTION SELECT SWITCH

If the ceiling fan has fluorescent lighting, please slide the "light function select switch" to "O" position. If the ceiling fan has incandescent, halogen lighting or dimmerable LED, please slide the "light function select switch" to "D" position. (FIG. 2)

## FUNCTIONS:



: Turn off the ceiling fan.



: Turn on the fan at high speed.



: Turn on the fan at medium speed.



: Turn on the fan at low speed.



: Turn on the fan at lower speed.



: The fan will turn off after 2 hours automatically.



: The fan will turn off after 4 hours automatically.



: The fan will turn off after 6 hours automatically.



ON/OFF-Turn the light on or off.

DIMMER-Press and hold to dim or brighten light to the desired level and release.

(Incandescent or halogen or dimmerable LED only and light function select switch on "D" position.)

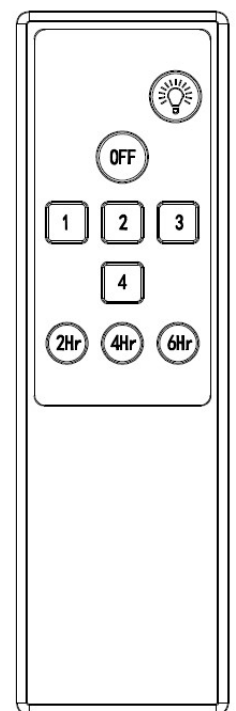

TR262B

## To assure continued FCC compliance:

### FEDERAL COMMUNICATIONS COMMISSION INTERFERENCE STATEMENT

This equipment has been tested and found to comply with the limits for a Class B digital device, pursuant to Part 15 of the FCC Rules. These limits are designed to provide reasonable protection against harmful interference in a residential installation. This equipment generates, uses and can radiate radio frequency energy and, if not installed and used in accordance with the instructions, may cause harmful interference to radio communications. However, there is no guarantee that interference will not occur in a particular installation. If this equipment does cause harmful interference to radio or television reception, which can be determined by turning the equipment off and on, the user is encouraged to try to correct the interference by one or more of the following measures:

--Reorient or relocate the receiving antenna. --Increase the separation between the equipment and receiver. --Connect the equipment into an outlet on a circuit different from that to which the receiver is connected. --Consult the dealer or an experienced radio/TV technician for help.

#### **CAUTION:**

Any changes or modifications not expressly approved by the grantee of this device could void the user's authority to operate the equipment.

#### **FCC ID : KUJCE10705**

This device complies with Part 15 of the FCC Rules. Operation is subject to the following two conditions: (1) This device may not cause harmful interference, and (2) this device must accept any interference received, including interference that may cause undesired operation.