

DAIMLER

Messdaten Hermes-Antennen für Zertifizierung  
RD/UKR, 09.08.2017

# W177

Spoiler-Antenne A247 905 75 00 (Hermes 3G/4G)

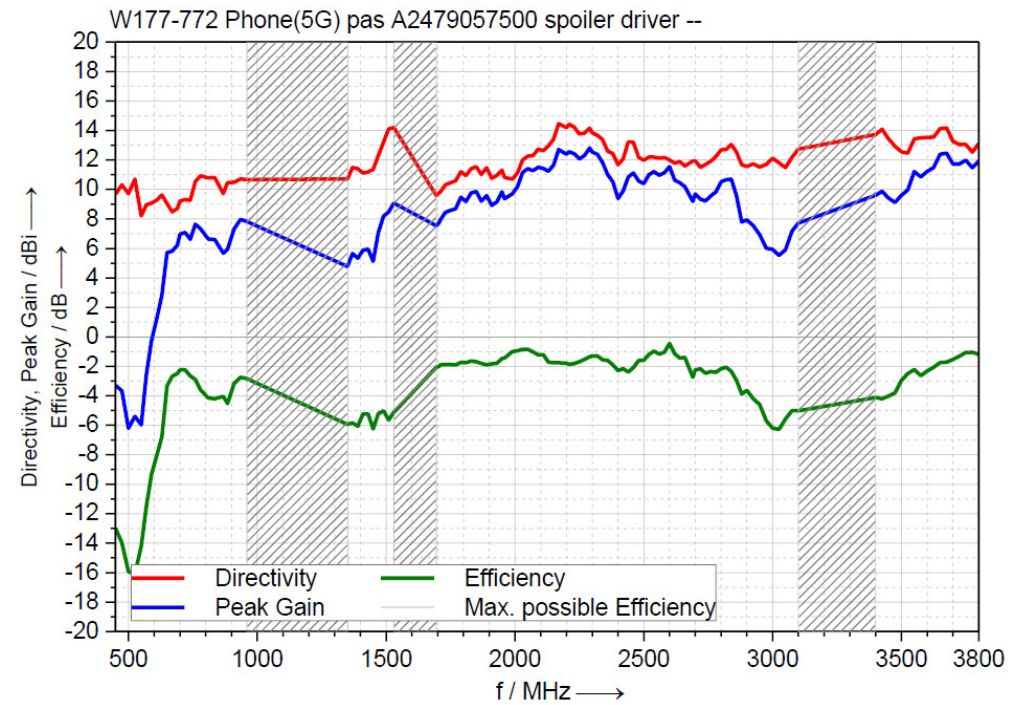
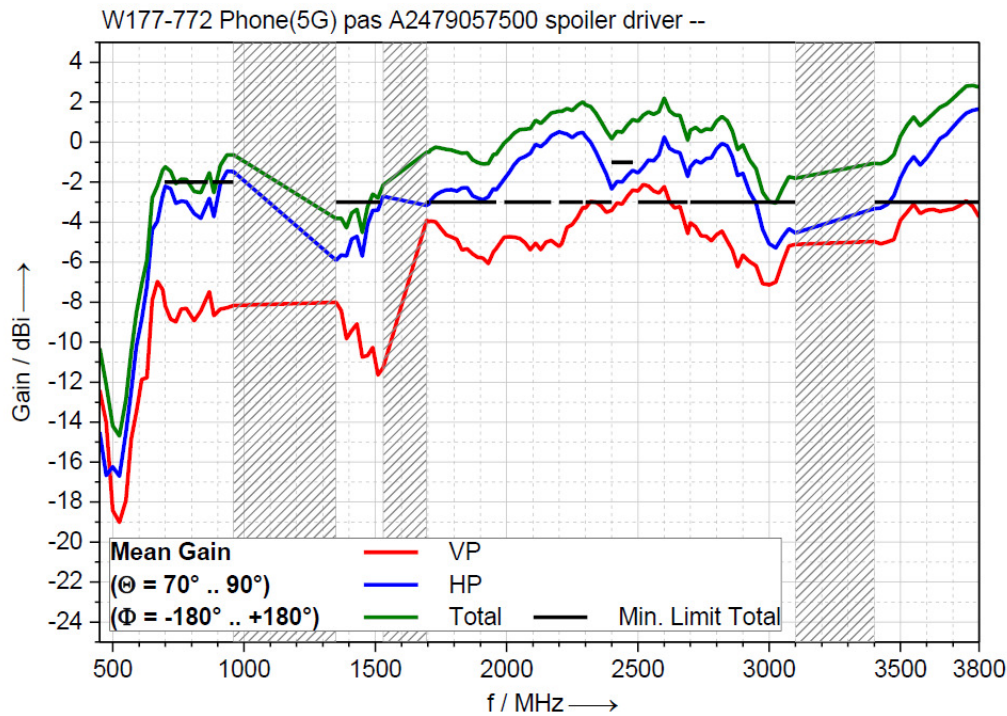
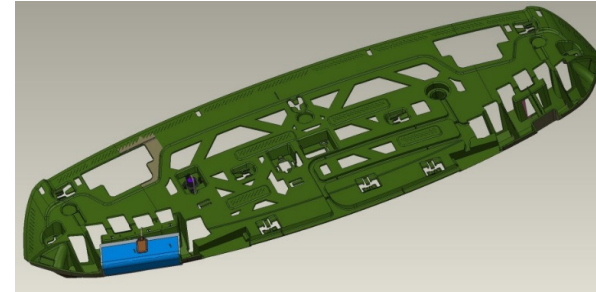

Mean Gain ( $\theta=70^\circ \dots 90^\circ$ ): Mittelung des Gewinns in der Elevation  $\theta=70^\circ \dots 90^\circ$  über den gesamten Azimuth ( $\phi=-180^\circ \dots 180^\circ$ ):

# W177

Rückwandtürantenne A156 905 09 02 (Hermes 4G)

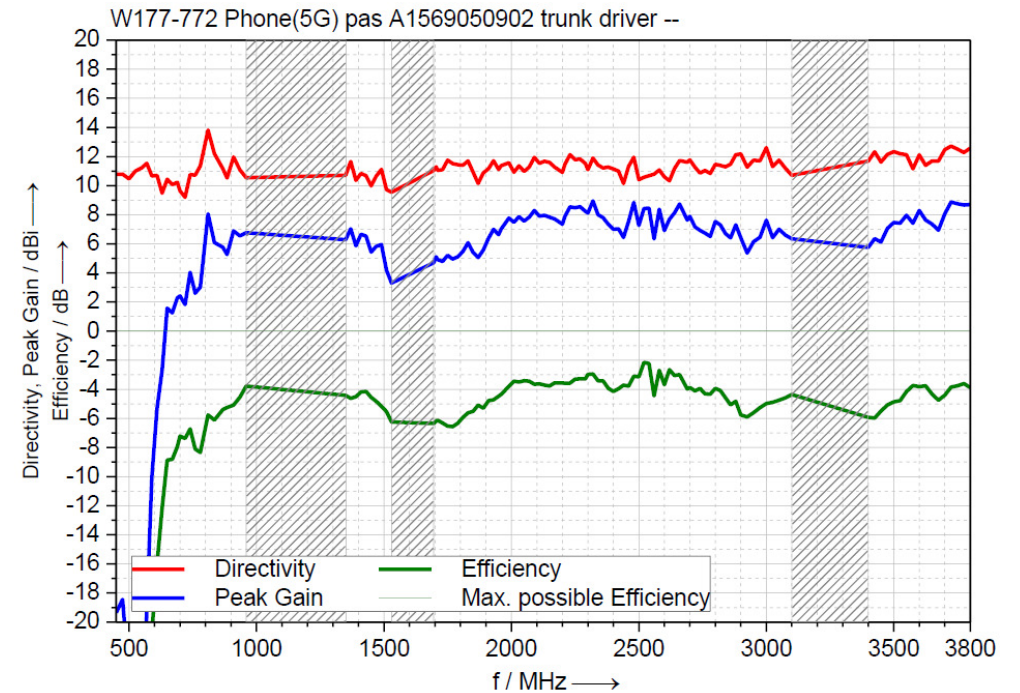
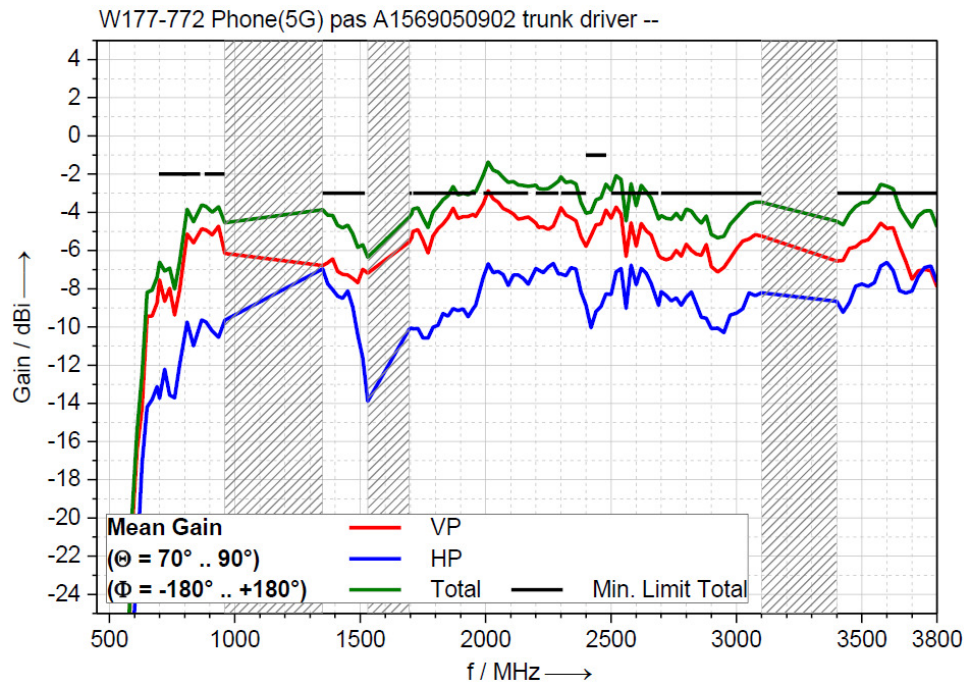
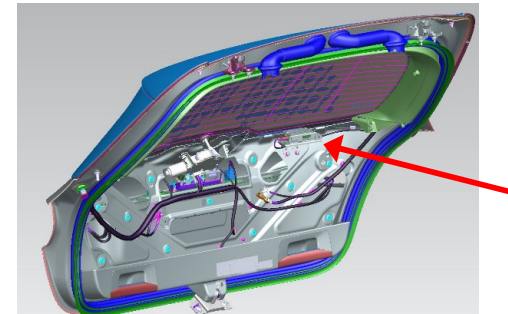

Mean Gain ( $\theta=70^\circ \dots 90^\circ$ ): Mittelung des Gewinns in der Elevation  $\theta=70^\circ \dots 90^\circ$  über den gesamten Azimuth ( $\phi=-180^\circ \dots 180^\circ$ ):



# W213

Hutablagenantenne A213 905 28 03 (Hermes 3G/4G)

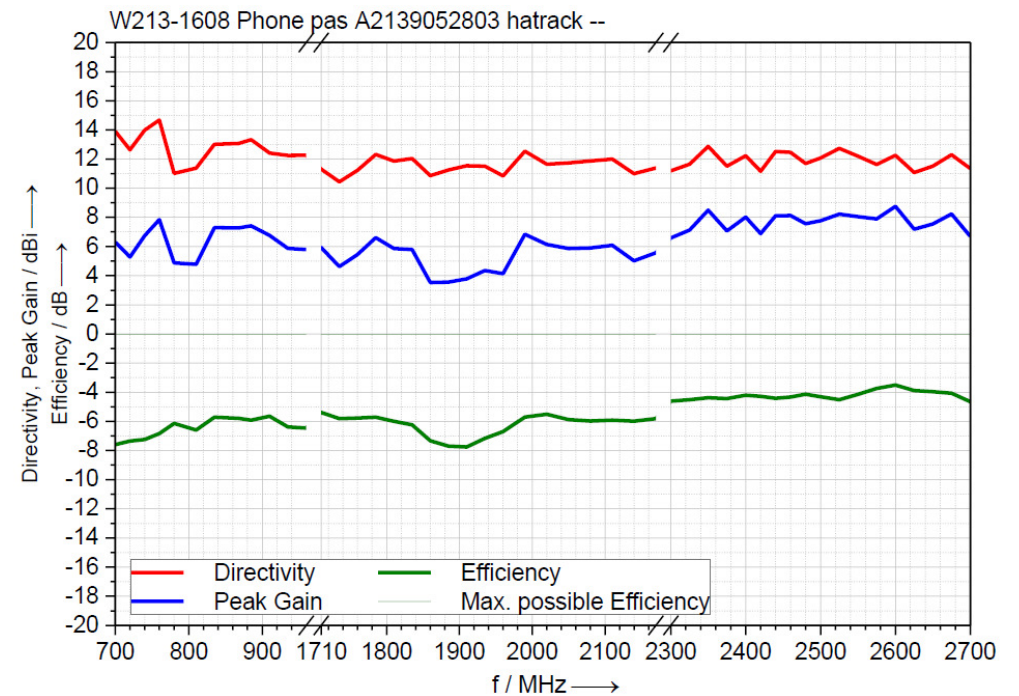
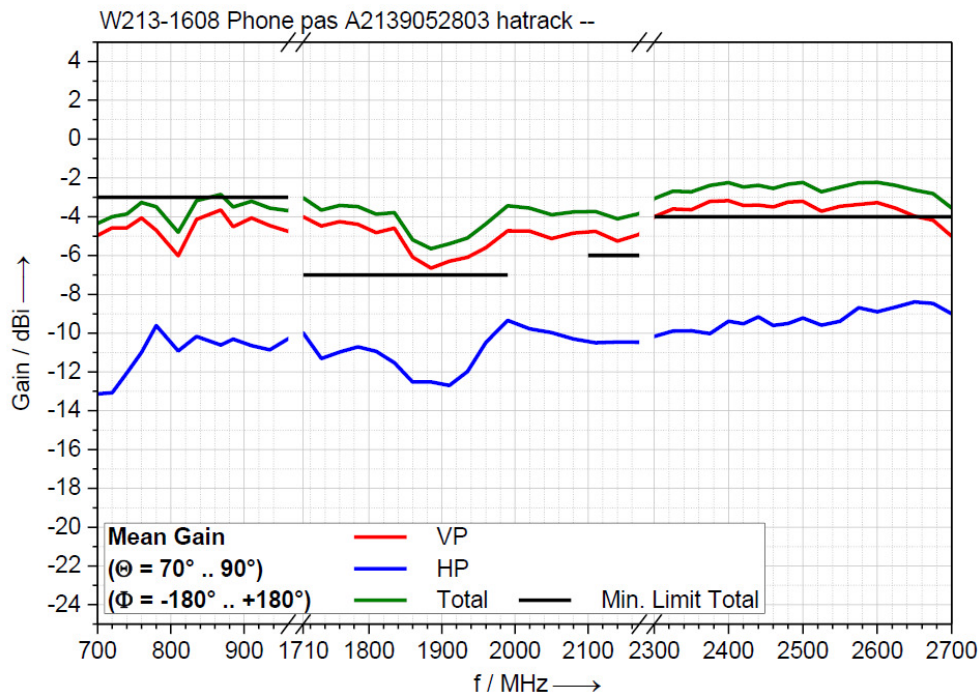

Mean Gain ( $\theta=70^\circ \dots 90^\circ$ ): Mittelung des Gewinns in der Elevation  $\theta=70^\circ \dots 90^\circ$  über den gesamten Azimuth ( $\phi=-180^\circ \dots 180^\circ$ ):

# W213

Schwarzdruckantenne links A213 905 95 00 (Hermes 4G)

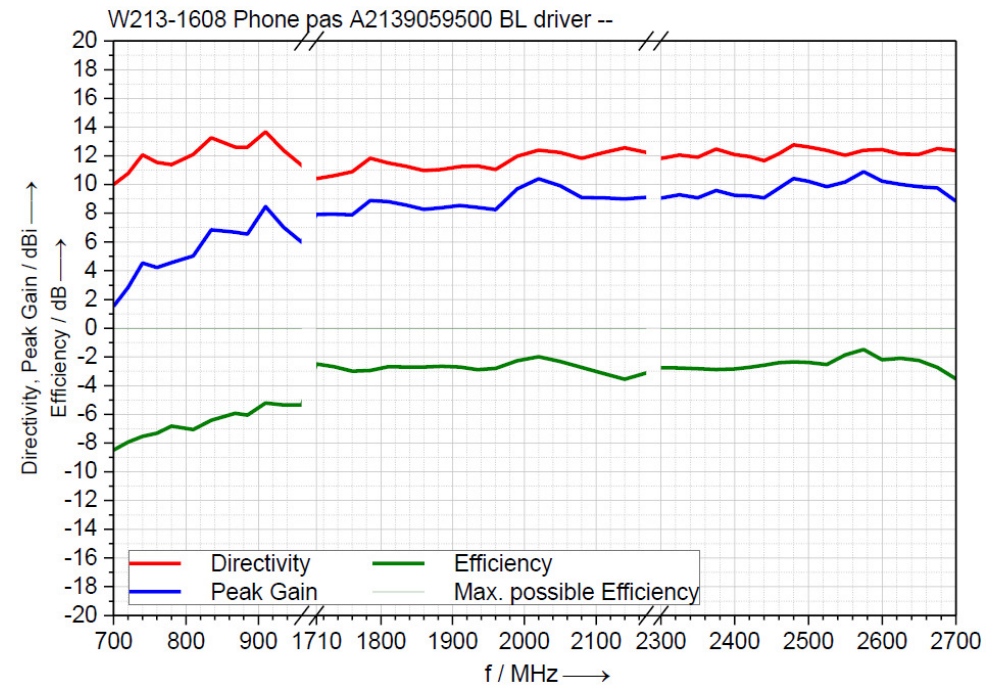
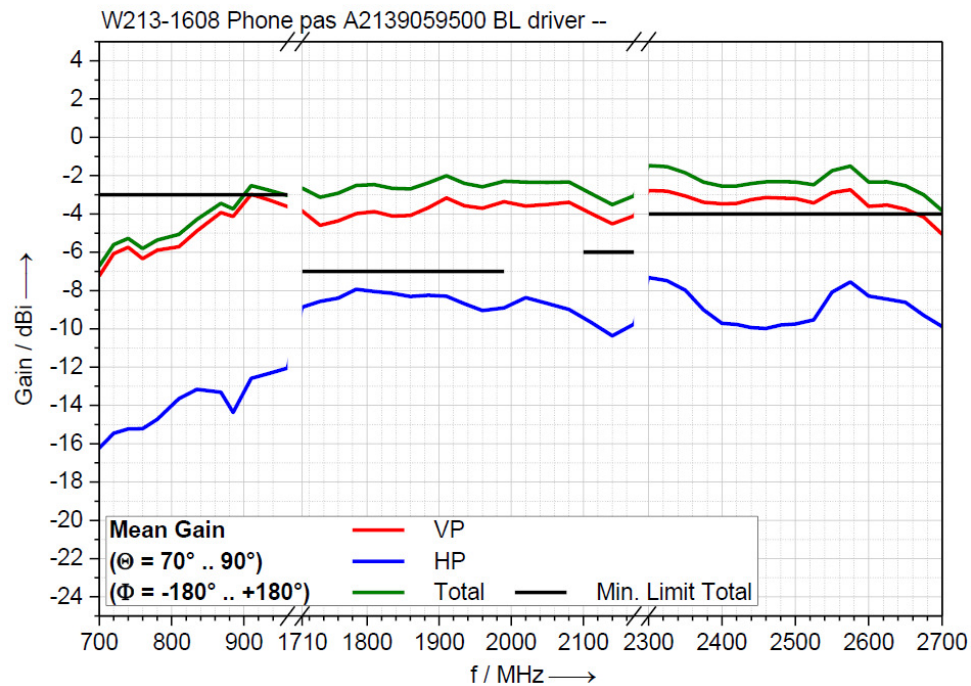

Mean Gain ( $\theta=70^\circ \dots 90^\circ$ ): Mittelung des Gewinns in der Elevation  $\theta=70^\circ \dots 90^\circ$  über den gesamten Azimuth ( $\phi=-180^\circ \dots 180^\circ$ ):

# Backup